



RETURN BIDS TO:

RETOURNER LES SOUMISSIONS À:

**Bid Receiving - PWGSC / Réception des soumissions -
TPSGC**

11 Laurier St./11 rue Laurier

Place du Portage, Phase III

Core 0B2 / Noyau 0B2

Gatineau, Québec K1A 0S5

**SOLICITATION AMENDMENT
MODIFICATION DE L'INVITATION**

The referenced document is hereby revised; unless otherwise indicated, all other terms and conditions of the Solicitation remain the same.

Ce document est par la présente révisé; sauf indication contraire, les modalités de l'invitation demeurent les mêmes.

Comments - Commentaires

Vendor/Firm Name and Address

**Raison sociale et adresse du
fournisseur/de l'entrepreneur**

Issuing Office - Bureau de distribution

Construction Services Division/Division des services de
construction

140 O'Connor Street

140, rue O'Connor

Ontario

Ottawa

K1A 0S5

Title - Sujet Building B	
Solicitation No. - N° de l'invitation M7594-194770/A	Amendment No. - N° modif. 001
Client Reference No. - N° de référence du client M7594-194770	Date 2019-02-04
GETS Reference No. - N° de référence de SEAG PW-\$\$\$FG-362-76252	
File No. - N° de dossier fg362.M7594-194770	CCC No./N° CCC - FMS No./N° VME
Solicitation Closes - L'invitation prend fin at - à 02:00 PM on - le 2019-03-06	Time Zone Fuseau horaire Eastern Standard Time EST
F.O.B. - F.A.B. Plant-Usine: <input type="checkbox"/> Destination: <input checked="" type="checkbox"/> Other-Autre: <input type="checkbox"/>	
Address Enquiries to: - Adresser toutes questions à: Kelly, Jessica	Buyer Id - Id de l'acheteur fg362
Telephone No. - N° de téléphone () - ()	FAX No. - N° de FAX () -
Destination - of Goods, Services, and Construction: Destination - des biens, services et construction:	

Instructions: See Herein

Instructions: Voir aux présentes

Delivery Required - Livraison exigée	Delivery Offered - Livraison proposée
Vendor/Firm Name and Address Raison sociale et adresse du fournisseur/de l'entrepreneur	
Telephone No. - N° de téléphone Facsimile No. - N° de télécopieur	
Name and title of person authorized to sign on behalf of Vendor/Firm (type or print) Nom et titre de la personne autorisée à signer au nom du fournisseur/ de l'entrepreneur (taper ou écrire en caractères d'imprimerie)	
Signature	Date

The following changes to the tender documents are effective immediately. This amendment will form part of the contract documents.

Amendment 001 is issued for the following:

- (1) Bidders' Question and Response;
- (2) Issue Addendum 1; and
- (3) Issue Addendum 2.

(1) Bidder Question & Answer

QUESTION # 1:

According to the Footing Schedule on drawing S110 the top of footing is 110.100 making the underside elevation of WF01: 109.800. Upon review of Section 4 of drawing A402 the underside of the footing is 108.800 making the top of footing elevation: 109.100. What is the correct underside of footing elevation?

ANSWER # 1:

Please refer to Addendum No. 02.

QUESTION # 2:

Is the parking lot detailed in C201 in the project scope. If so could we get a more detailed plan with regards to landscaping and furnishings.

ANSWER # 2:

Bid as per plans and specification. Refer to A100, note 1.

QUESTION # 3:

I realize that the size of the generator pad is to be coordinated with electrical, however for tendering purposes would you please provide a length and width.

ANSWER # 3:

Bid as per plans and specification. Refer to A102, detail 3.

QUESTION # 4:

Would you please provide the type, thickness and extent of the rigid insulation located under the generator concrete slab.

ANSWER # 4:

Bid as per plans and specification. Refer to A102, detail 5.

QUESTION # 5:

The furniture plan notes that “furniture and equipment graphically denoted as halftone and dashed lines are N.I.C.” The trouble I am having is that some furniture is shown as both halftone and darkened trueline.

ANSWER # 5:

Bid as per plans and specification. Refer to the schedule under Drawing Notes on A700.

QUESTION # 6:

There is furniture and equipment that is listed in the schedule on drawing A700 that appears to be having to be supplied by the GC yet there is no corresponding Spec section for these items; ie: Glass dry erase boards (WB1-WB4), Bulletin board (BB1-BB2) to name a few.

ANSWER # 6:

Bid as per plans and specification.

WB1 to WB4: Section 08 80 00, article 2.1.4.

BB1 and BB2: Section 09 21 16, article 2.1.6.

SH and SH2: Section 10 56 13.

RK1 and RK2: Refer to Addendum #02.

QUESTION # 7:

The structured cabling appears to be by the GC to employ, however, the third note on Drawing T101 reads such that “fibre optic cables with LC connectors N.I.C for cable contractor. Fibre must be installed by audio video contractor.” Who is this contractor? What is his scope of work? How does this impact the scope of work for the structured cabling trade?

ANSWER # 7:

Please refer to Addendum No. 02.

QUESTION #8:

Regarding the Roof Anchor system: Spec states the number of supports and cable but the drawings show nothing. From what I can see they want the system around the green roof. Could I have this confirmed with the mark up provided.

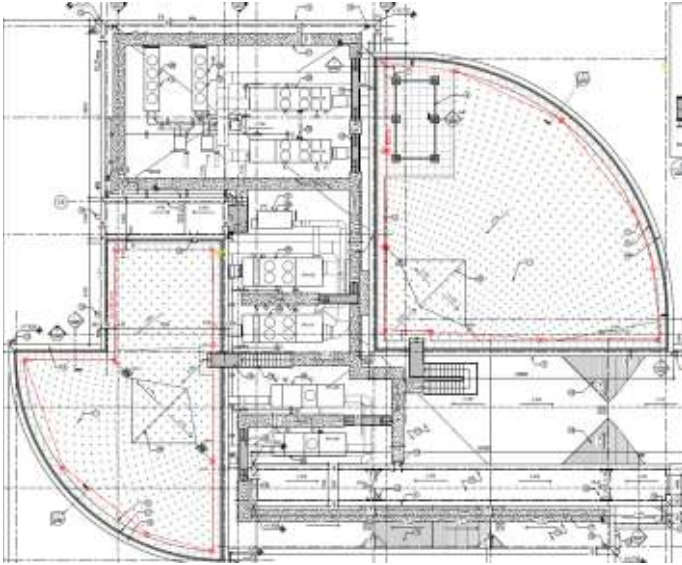

ANSWER # 8:

Bid as per plans and specification. Refer to Section 07 72 69.

ALL OTHER TERMS AND CONDITIONS REMAIN THE SAME

Solicitation No. - N° de l'invitation
M7594-194770

Amd. No. - N° de la modif.
001

Buyer ID - Id de l'acheteur
FG 362

Client Ref. No. - N° de réf. du client
20194770

File No. - N° du dossier
FG362 M7594-194770

CCC No./N° CCC - FMS No./N° VME
1005007

ADDENDUM 01

The following changes in the bid documents are effective immediately. This addendum will form part of the contract documents.

SPECIFICATIONS

Section 01 00 10 – General Instructions:

1. **ADD:** New article 1.2.3 to read:

Notification to Access Work Areas:

- .1 Access to spaces on campus managed by the Building Manager (BGIS):
 - .1 Contractor personnel accessing Building B construction zone, Electrical Room, Mechanical Room, LAN room, power and communication duct banks via manholes must submit a correctly filled-in Third Party Work Notification Permit to BGIS Property Manager and Departmental Representative at least five (5) business days prior to commencement of work, except as noted below.
 - .2 See BGIS Third Party Work Notification Permit form at Appendix 'B'.
 - .3 Submit the Third Party Work Notification Permit form to the correct BGIS Property Manager as follows. Names and contact information will be provided after contract award.
- .2 Electrical Room: Submit BGIS Third Party Work Permit Notification five (5) business days in advance. For disconnections or switchovers, submit ten (10) business days in advance. For shutdown, submit thirty (30) business days in advance. Escort required.
- .3 Mechanical Room: Submit BGIS Third Party Work Permit Notification five (5) business days in advance. For disconnections or switchovers, submit ten (10) business days in advance. For shutdown, submit thirty (30) business days in advance. Escort required.
- .4 LAN Room: Submit BGIS Third Party Work Permit Notification five (5) business days in advance. For disconnections or switchovers, submit ten (10) business days in advance. For shutdown, submit thirty (30) business days in advance. Escort required.
- .5 Access to Duct Bank via Manholes: Submit BGIS Third Party Work Permit Notification five (5) business days in advance. Escort required.

2. **ADD:** New article 1.2.4 to read:

Notifications for Escort:

- .1 The request for escort will be initiated by the Departmental Representative upon receipt of the BGIS Third Party Work Notification Permit and as per the information contained in the Work Notification Permit.
- .2 The cost of the escort will be paid by the Departmental Representative.
- .3 The contractor should notify Departmental Representative two (2) business days in advance of scheduled time to cancel escort request in order to avoid unnecessary cost.

Appendix:

1. **ADD:** New Appendix B:
See attached Appendix B.

Appendix B

BGIS THIRD PARTY WORK NOTIFICATION PERMIT

3 pages

Appendix B



Downloaded and Printed Copies are Not Controlled

Document Number: HS 289 02 RP1

Revision Date: Jan 31, 2017

Revision #: 3.0

THIRD PARTY WORK NOTIFICATION PERMIT

PURPOSE: To maintain a safe working environment for employees, building occupants, contractors and visitors. All work activities managed by PSPC, Security or Tenants that require contractor access to any part of BGIS managed facilities must have a Third Party Work Notification Permit.

INSTRUCTION

1. Fill in all relevant fields completely. Forms with blank fields may be rejected.
2. E-mail the completed form to the email address listed for your region on the final page.
3. Await BGIS approval and confirmation of work space allocation prior to commencement of work.
4. Retain a copy of the approved Third Party Work Notification Permit.

NOTE: To ensure timely approval, please submit the Work Notification Permit at least 48 hours prior to the anticipated start time or work activities.
Questions regarding the Work Notification Permit process can be sent to the region specific email address or your BGIS Property Manager.

LOCATION OF WORK

Province/Territory: City:

Floor / Room Number:

Building (Name & Address):

PROJECT MANAGER (Third Party Buyer of Service):

Work Requested By:

Work Order # or Project # (If Applicable):

DATE & DURATION OF THE WORK (Any work scheduled for longer than a ONE week period will require subsequent Work Notification Permits)								
Schedule of Work		Work hours						
<input type="checkbox"/> Day Time	<input type="checkbox"/> After Hours	Monday	Tuesday	Wednesday	Thursday	Friday	Saturday	Sunday
Start Date								
End Date								

Provide a detailed description of the work to be conducted.

WORK DESCRIPTION (DETAILED):

Will life safety systems be impacted or impaired (fire alarm or other)?

Will other building systems be impacted or impaired (HVAC, lighting, elevator, etc.)?

IN CASE OF SITE EMERGENCY, CONTACT LOCAL EMERGENCY SERVICES AND

BGIS AT 1-877-445-0611

Appendix B



Downloaded and Printed Copies are Not Controlled

Document Number: HS 289 02 RP1

Revision Date: Jan 31, 2017

Revision #: 3.0

PROJECT MANAGER REVIEW (Third Party Buyer of Service)

Name of Reviewer:	<input type="text"/>	
Date of Review:	<input type="text"/>	Authorized? <input type="text"/>
Comments:	<input type="text"/>	
Signature:	<input type="text"/>	

BGIS HEALTH & SAFETY REVIEW

Name of Reviewer:	<input type="text"/>	
Date of Review:	<input type="text"/>	Authorized? <input type="text"/>
Signature:	<input type="text"/>	

BGIS FACILITIES REVIEW

Name of Reviewer:	<input type="text"/>	
Date of Review:	<input type="text"/>	Authorized? <input type="text"/>
Signature:	<input type="text"/>	

EMAIL COMPLETED WORK NOTIFICATION PERMITS TO THE ADDRESS LISTED FOR YOUR REGION

Region	Region Description	Email Address
Atlantic Canada	Newfoundland, PEI, NB, NS	ALT-RP1workpermit@Brookfieldgis.com
Quebec	Quebec Other Than Gatineau	QC-RP1workpermit@Brookfieldgis.com
National Capital Area	Ottawa, Gatineau	NCA-RP1workpermit@Brookfieldgis.com
Ontario	Ontario Other Than Ottawa, Renfrew, Pakenham	ON-RP1workpermit@Brookfieldgis.com
Western Canada	Manitoba, Saskatchewan, Alberta	WEST-RP1workpermit@Brookfieldgis.com
Pacific Canada	British Columbia, Yukon	PAC-RP1workpermit@Brookfieldgis.com

**IN CASE OF SITE EMERGENCY, CONTACT LOCAL EMERGENCY SERVICES AND
BGIS AT 1-877-445-0611**

Appendix B



Downloaded and Printed Copies are Not Controlled

Document Number: HS 289 02 RP1

Revision Date: Jan 31, 2017

Revision #: 3.0

RISK ASSESSMENT

Please note, Risk Assessment is intended only to prompt the form approver. It is the responsibility of employer requesting the work (Buyer of Service) to ensure controls are in place and monitored.

	Yes / No	If Yes, See Associated Controls	Control
Requires access to a secure area where escort may be needed?	<input type="checkbox"/>		1. Shutdown notice required.
Requires access to confined space or restricted space?	<input type="checkbox"/>	4	2. Hot Work Permit & Fire Watch required.
Requires work from heights?	<input type="checkbox"/>	4	3. Review of asbestos & hazardous materials survey.
Requires energy isolation? (LOTO - Lock Out/Tag Out is the isolation of energy from the system)	<input type="checkbox"/>	4	4. Additional High Hazard Permit (LOTO or Confined Space)
Requires Hot Work? (Work that could produce a source of ignition, such as a spark or open flame. Examples of hot work include welding, cutting, grinding and the use of non-explosion proof electrical equipment.)	<input type="checkbox"/>	2, 4, 5	5. Notify Fire Department / Fire Alarm Monitoring Company
Will life safety systems be impacted (fire alarm or other)?	<input type="checkbox"/>	5	
Could generate noise or odors?	<input type="checkbox"/>		
Requires obstruction of building access or egress?	<input type="checkbox"/>		
Involves electrical or mechanical disruption?	<input type="checkbox"/>	1, 4	
Have asbestos & hazardous materials surveys been reviewed by those conducting work?	<input type="checkbox"/>	3	
Will asbestos / other hazardous materials be disrupted during work activities?	<input type="checkbox"/>	3	
Involves working around or with hazardous chemicals?	<input type="checkbox"/>		
Work taking place at heritage site?	<input type="checkbox"/>		
Will loading dock access be required?	<input type="checkbox"/>		
Will freight elevator access be required?	<input type="checkbox"/>		

PERMIT HOLDER DETAILS

Company Name:

Contact Number:

IN CASE OF SITE EMERGENCY, CONTACT LOCAL EMERGENCY SERVICES AND

BGIS AT 1-877-445-0611

End of Addendum No. 1

Solicitation No. - N° de l'invitation
M7594-194770

Amd. No. - N° de la modif.
001

Buyer ID - Id de l'acheteur
FG 362

Client Ref. No. - N° de réf. du client
20194770

File No. - N° du dossier
FG362 M7594-194770

CCC No./N° CCC - FMS No./N° VME
1005007

ADDENDUM 02

The following changes in the bid documents are effective immediately. This addendum will form part of the contract documents.

SPECIFICATIONS

Section 03 23 00 – ROCK ANCHORS:

- .1 **REPLACE:** Article 1.5.5 to read:

Submit site survey showing the location of installed anchors with dimensions to nearest gridlines.

Section 27 10 05 – STRUCTURED CABLING FOR COMMUNICATIONS:

- .1 **REPLACE:** Article 2.1.1 to read:

RK1:

- .2 **REPLACE:** Article 2.1.2 to read:

RK2:

DRAWINGS

Drawing S110 – SCHEDULES / NOMENCLATURES:

- .1 **REPLACE:** FOOTING SCHEDULE / NOMENCLATURE DES EMPATTEMENTS with:

FOOTING SCHEDULE / NOMENCLATURE DES DES EMPATTEMENTS			
MARK / MARQUE	SIZE (LxWxD) / GROSSEUR (LxWxD)	REINFORCING / OUVRAGE DE RENFORT	TOP OF FOOTING / PARTIE SUPÉRIOR DE L'EMPATTEMENT
F01	1200x1200x500	7-15M B.E.W. (HOOKED E.E.) / 7-15M B.E.W. (CROCHET À CHAQUE EXTRÉMITÉ)	EL. 109.100
F02	900x900x300	4-15M B.E.W. (HOOKED E.E.) / 4-15M B.E.W. (CROCHET À CHAQUE EXTRÉMITÉ)	EL. 109.100
F03	1500x1500x600	11-15M B.E.W. (HOOKED E.E.) / 11-15M B.E.W. (CROCHET À CHAQUE EXTRÉMITÉ)	EL. 109.100
WF01	600x300	3-15B CONT. / 3-15B CONT.	EL. 109.100

Drawing T101 – TELECOMMUNICATIONS PLAN / PLANS DE TÉLÉCOMMUNICATION :

- .1 **REPLACE:** Replace in Legend:

☒# FIBRE FURNITURE OUTLET: WITH # MULTIMODE FIBRE OPTIC CABLES WITH LC CONNECTORS N.I.C. FIBRE SUPPLY AND INSTALLATION BY OTHERS UNDER SEPARATE POST-CONSTRUCTION CONTRACT. / PRISE MOBILIER FIBRE: AVEC # CÂBLES MULTIMODE À FIBRES OPTIQUES AVEC CONNECTEURS LC N.I.C. APPROVISIONNEMENT EN FIBRES ET INSTALLATION PAR DES TIERS EN VERTU D'UN CONTRAT DISTINCT ACCORDÉ APRÈS LA CONSTRUCTION.

End of Addendum No. 02