

PARSONS

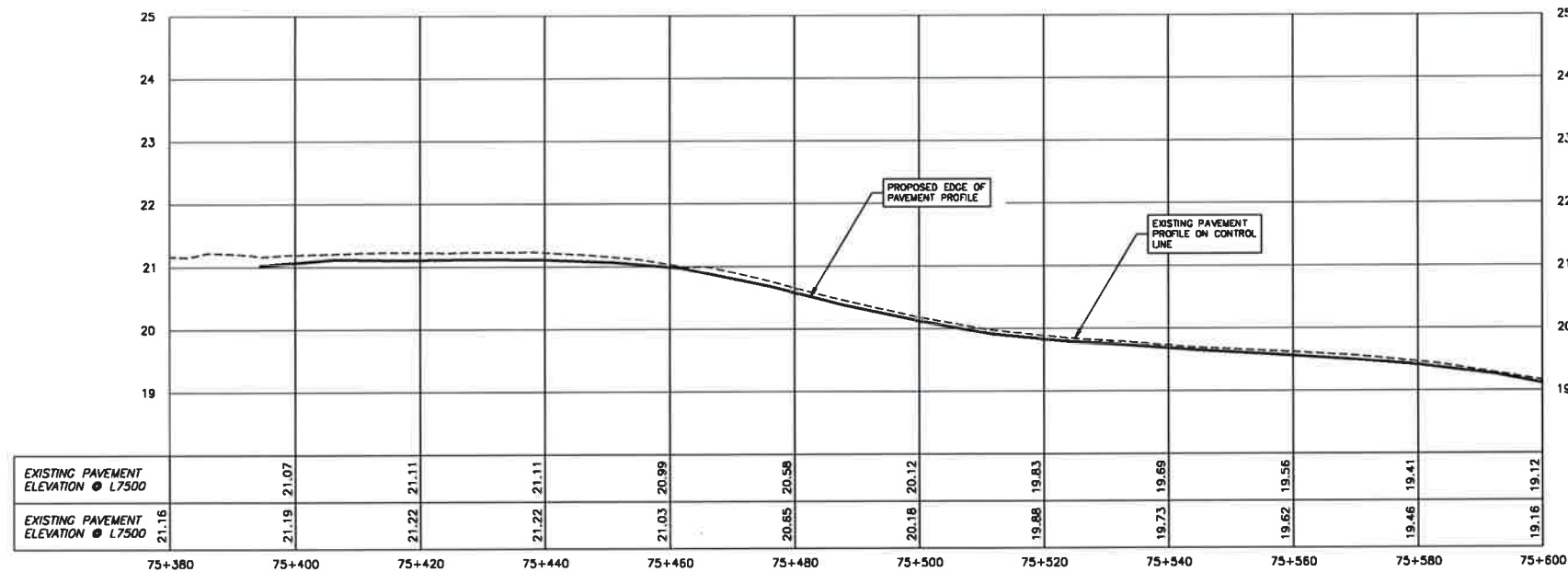
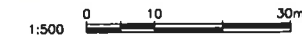
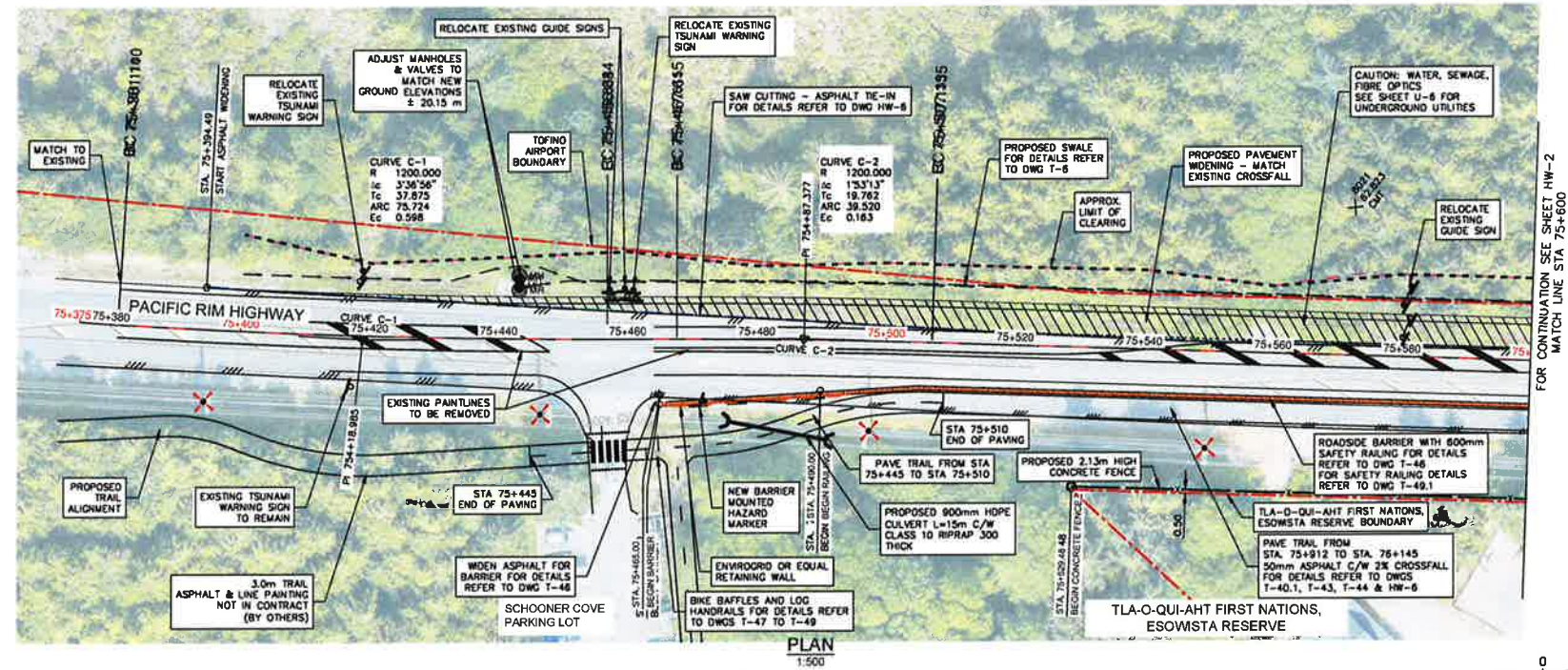

PACIFIC TRAVERSE TRAIL GENERAL NOTES:

- SURVEY DATA IS BASED UPON THE UTM NAD83 COORDINATE SYSTEM.
- THE CONTRACTOR SHALL ADHERE TO ALL ENVIRONMENTAL REGULATIONS AS SPECIFIED IN THE CONTRACT.
- THE FINAL TRAIL ALIGNMENT SHALL BE ESTABLISHED IN THE FIELD BY DEPARTMENTAL REPRESENTATIVE.
- EXACT LOCATIONS AND SIZES OF RETAINING WALLS SHOWN IN PLAN TO BE CONFIRMED IN FIELD BY DEPARTMENTAL REPRESENTATIVE.
- FOR TYPICAL TRAIL SECTIONS SEE DRAWINGS T-40.1, T-40.2, T-41, T-43, T-44 & T-46
- FOR HAND RAILS AND ACCESS BARRIERS SEE DRAWING T-46
- FOR CONSTRUCTION SIGNAGE DRAWINGS SEE DRAWING HW-4 & HW-5
- FOR CONSTRUCTION DRAWING TYPICAL DETAILS SEE DRAWING HW-6
- FOR BRIDGES SEE STRUCTURAL DRAWINGS S-1.1 TO S-5.11
- FOR RETAINING WALLS AND FILL SLOPES SEE DRAWINGS W-4.1 TO W-4.3 & W-5.1 TO W-5.6
- FOR TRAFFIC SIGNAGE DETAILS REFER TO SPECIFICATION: TRAFFIC SIGNAGE 32 17 25
- FOR PAVEMENT MARKING REFER TO SPECIFICATION: PAVEMENT MARKING 32 17 23
- FOR REMOVAL OF PAVEMENT MARKINGS REFER TO SPECIFICATION: REMOVAL OF PAVEMENT MARKINGS 32 10 11
- FOR ASPHALT PAVEMENT REFER TO SPECIFICATION: ASPHALT PAVING 32 12 16
- FOR PAVEMENT TACK COAT REFER TO SPECIFICATION: ASPHALT TACK COAT 32 12 13.16
- FOR TRAFFIC BARRIER SPECIFICATIONS REFER TO SPECIFICATION: TRAFFIC BARRIERS 34 17 13
- THE CONTRACTOR MUST NOT LOCATE ANY EQUIPMENT, LABOUR OR MATERIALS WITHIN THE FIRST NATION RESERVE BOUNDARIES
- SEE ALSO SCHOONER COVE PARKING LOT DWG PL-2.1.

LEGEND

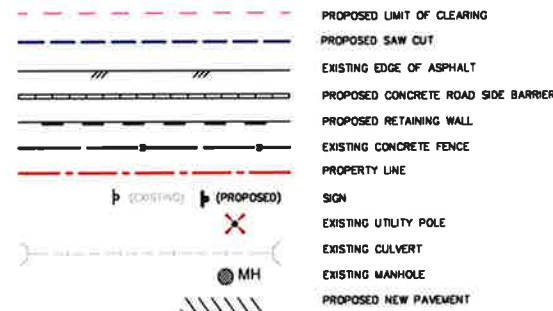

Issue No.	Issue Date	Description
3	18/12/2018	ISSUED FOR TENDER
2	26/11/2018	ISSUED FOR TENDER
1	26/11/2017	ISSUED FOR TENDER
0	26/11/2017	ISSUED FOR TENDER

Parcs Canada L'Agence Parcs
Agency Canada
Western and Northern Region Ouest et Nord du Canada

Projet Titre du projet
TOFINO
PACIFIC RIM NATIONAL PARK RESERVE
?apsclik fasli
"Ups-cheek ta-shee"
"Going in the right direction on the trail"

Designed by/Concept par
DON CHALMERS / 2017-06
Drawn by/Dessiné par
DAVID COX / 2017-11
PCA Project Manager/Technical Authority
Administrateur de Projets APC
JACKIE HICKS

Drawing Title/Titre du dessin
?apsclik fasli (Ups-cheek ta-shee)
"Going in the right direction on the trail"
HIGHWAY 4 PLAN AND PROFILE
ESOWSTA CURVE
STA 75+380 TO 75+600

Project No./No. du projet
PCA #1622
Sheet/Feuille
HW-1
OF 19
Revision/Revisé
3



PARSONS

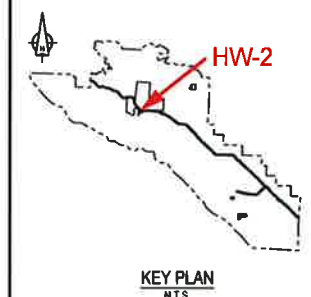
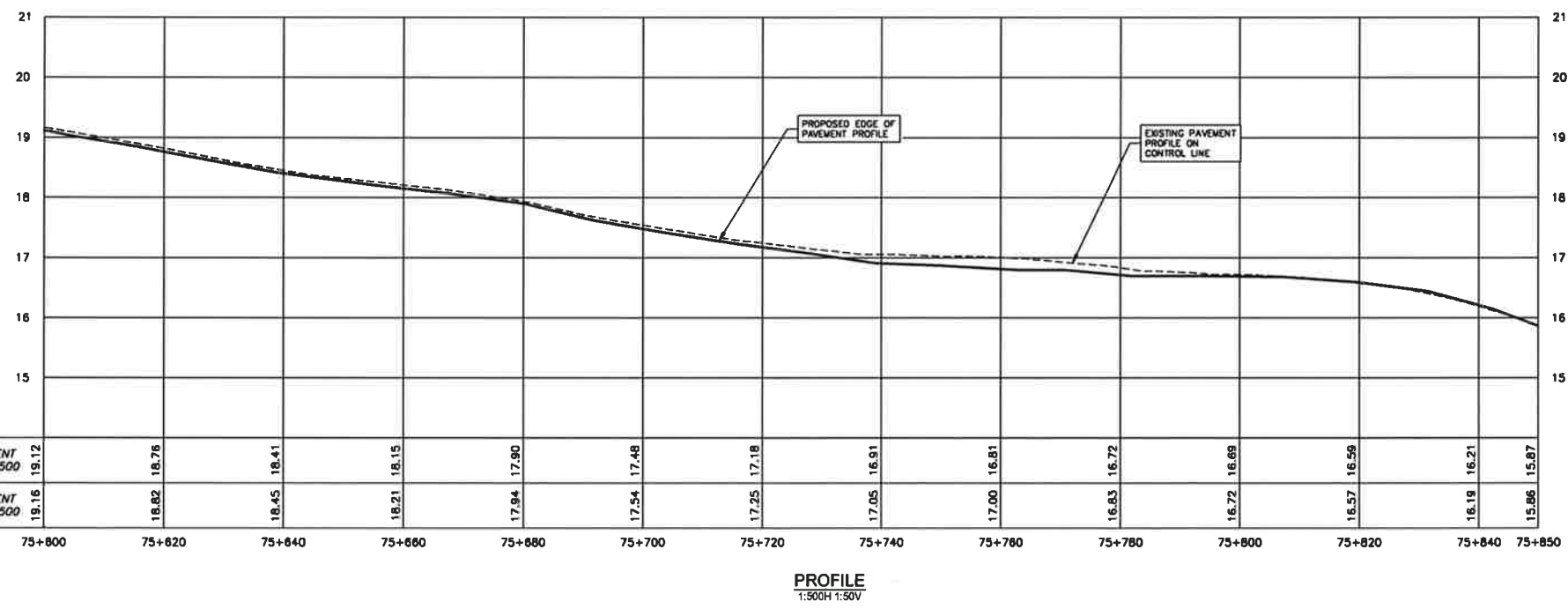
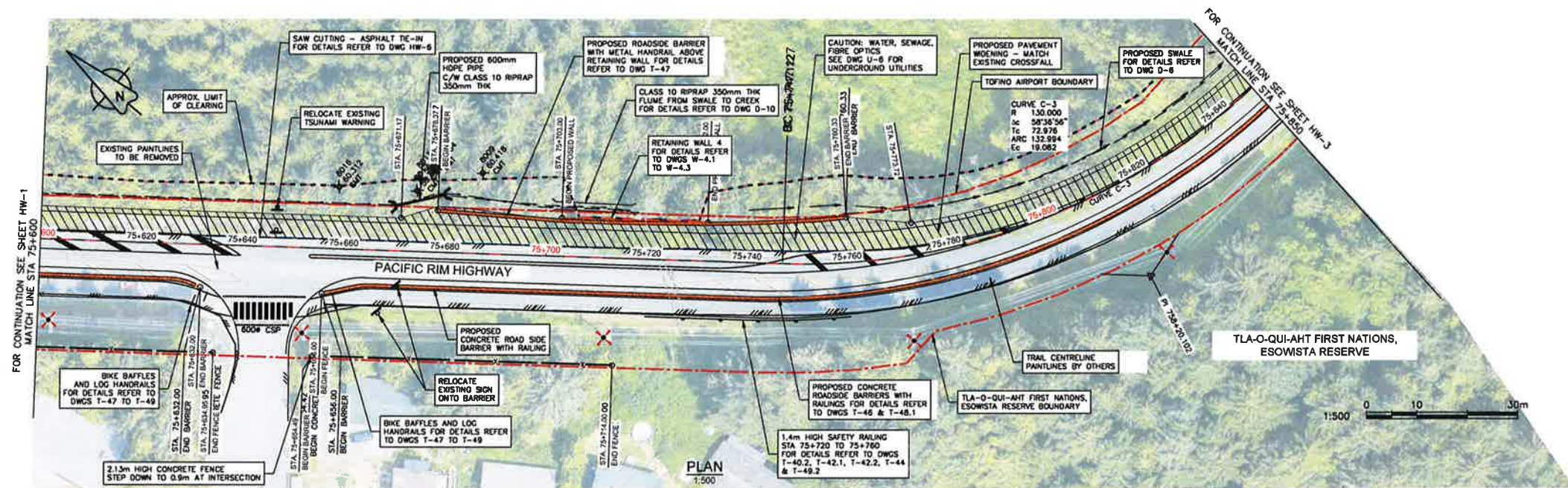

Revision/Description	Date/Date
3	14/12/2018
2	28/11/2018
1	25/11/2017
0	28/11/2017

Parks Canada L'Agence Parcs
Agency Canada
Western and Northern Region Ouest et Nord du Canada

Project title/Titre du projet
**TOFINO
PACIFIC RIM
NATIONAL PARK RESERVE
?apscilik tašil
(Ups-cheek ta-shée)
"Going in the right
direction on the trail"**

Designed by/Conçu par
DON CHALMERS / 2017-08
Drawn by/Dessiné par
DAVID COX / 2017-11
PCA Project Manager/Travaux de gestion
Administrateur de Projets PCA
JACKIE HICKS

Drawing title/Titre du dessin
**?apscilik tašil (Ups-cheek ta-shée)
"Going in the right direction on the
trail"
HIGHWAY 4 PLAN AND PROFILE
ESOWSTA CURVE
STA 75+800 TO 75+850**

Project No./No. de projet PCA #1522	Sheet/Feuille HW-2 OF 19	Revision no./No. de révision 3
---	---------------------------------------	--

05/11/2018 - PROJECT DATA 2018-10-15/PROJETS DE TRAVAU 2018-10-15 - SHEETS 001-1-3 BEING PUBLISHED ON 2018/12/18 11:30 AM BY PCHALMERS

- PACIFIC TRAVERSE TRAIL GENERAL NOTES:**
- SURVEY DATA IS BASED UPON THE UTM NAD83 COORDINATE SYSTEM.
 - THE CONTRACTOR SHALL ADHERE TO ALL ENVIRONMENTAL REGULATIONS AS SPECIFIED IN THE CONTRACT.
 - THE FINAL TRAIL ALIGNMENT SHALL BE ESTABLISHED IN THE FIELD BY DEPARTMENTAL REPRESENTATIVE.
 - EXACT LOCATIONS AND SIZES OF RETAINING WALLS SHOWN IN PLAN TO BE CONFIRMED IN FIELD BY DEPARTMENTAL REPRESENTATIVE.
 - FOR TYPICAL TRAIL SECTIONS SEE DRAWINGS T-40.1, T-40.2, T-41, T-43, T-44 & T-46
 - FOR HAND RAILS AND ACCESS BARRIERS SEE DRAWING T-46
 - FOR CONSTRUCTION SIGNAGE DRAWINGS SEE DRAWING HW-4 & HW-5
 - FOR CONSTRUCTION DRAWING TYPICAL DETAILS SEE DRAWING HW-6
 - FOR BRIDGES SEE STRUCTURAL DRAWINGS S-1.1 TO S-5.11

- FOR RETAINING WALLS AND FILL SLOPES SEE DRAWINGS W-4.1 TO W-4.3 & W-5.1 TO W-5.6
- FOR TRAFFIC SIGNAGE DETAILS REFER TO SPECIFICATION: TRAFFIC SIGNAGE 32 17 25
- FOR PAVEMENT MARKING REFER TO SPECIFICATION: PAVEMENT MARKING 32 17 23
- FOR REMOVAL OF PAVEMENT MARKINGS REFER TO SPECIFICATION: REMOVAL OF PAVEMENT MARKINGS 32 10 11
- FOR ASPHALT PAVEMENT REFER TO SPECIFICATION: ASPHALT PAVING 32 12 16
- FOR PAVEMENT TACK COAT REFER TO SPECIFICATION: ASPHALT TACK COAT 32 12 13.16
- FOR TRAFFIC BARRIER SPECIFICATIONS REFER TO SPECIFICATION: TRAFFIC BARRIERS 34 17 13
- THE CONTRACTOR MUST NOT LOCATE ANY EQUIPMENT, LABOUR OR MATERIALS WITHIN THE FIRST NATION RESERVE BOUNDARIES
- SEE ALSO SCHOONER COVE PARKING LOT DWG PL-2.1.

LEGEND

	PROPOSED LIMIT OF CLEARING
	PROPOSED SAW CUT
	EXISTING EDGE OF ASPHALT
	PROPOSED CONCRETE ROAD SIDE BARRIER
	PROPOSED RETAINING WALL
	EXISTING CONCRETE FENCE
	PROPERTY LINE
	SIGN
	EXISTING UTILITY POLE
	EXISTING CULVERT
	EXISTING MANHOLE
	PROPOSED NEW PAVEMENT

PROFESSIONAL
OF
D. G. CHALMERS
BRITISH
COLUMBIA
DEC 18 2018

PARSONS

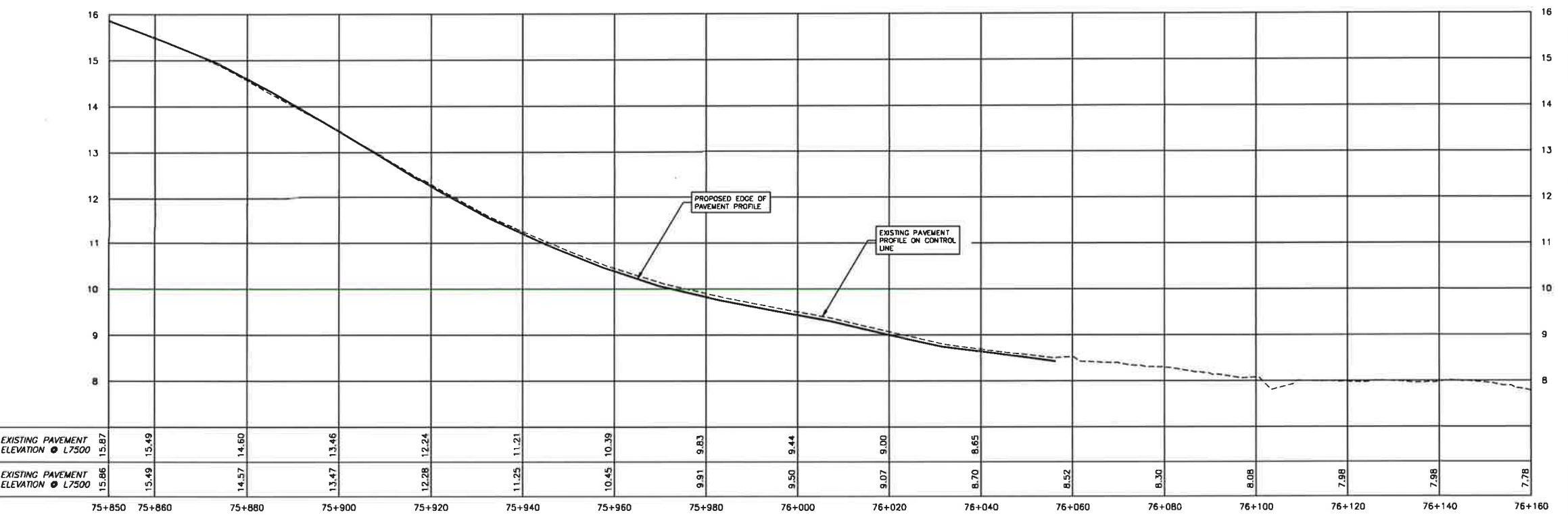
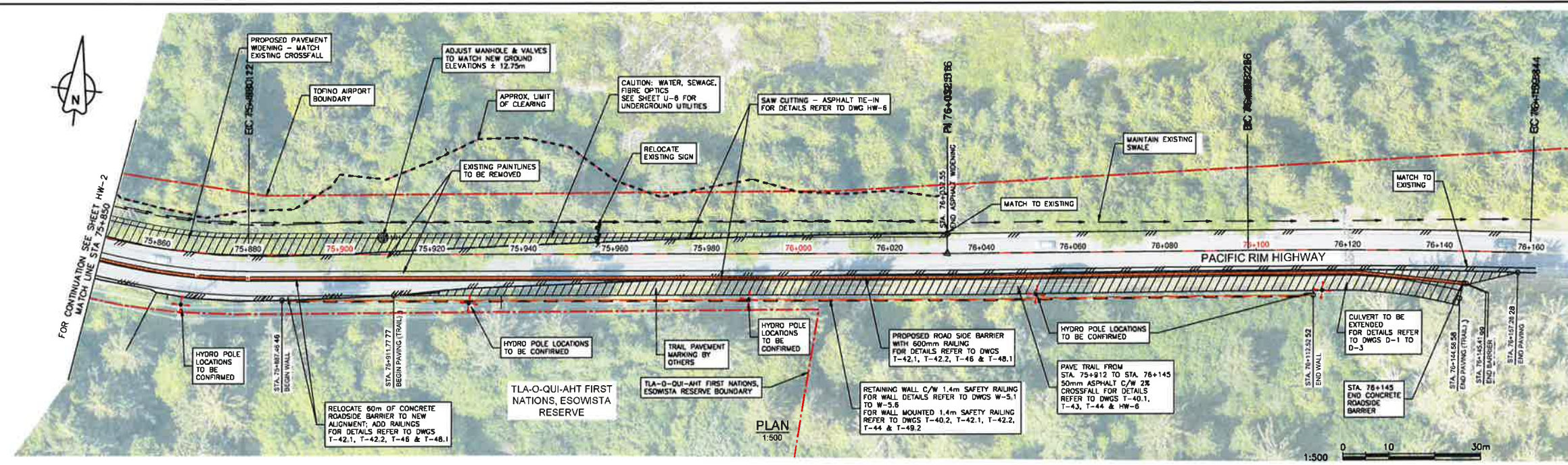

Issue No.	Description/Description	Date/Date
3	ISSUED FOR TENDER	14/12/2014
2	ISSUED FOR TENDER	28/11/2014
1	ISSUED FOR TENDER	30/11/2013
0	ISSUED FOR TENDER	24/11/2013

Client/Client
Parks Canada L'Agence Parcs
Agency Canada
Western and Northern Region Ouest et Nord du Canada

Project Title/Titre du projet
TOFINO
PACIFIC RIM
NATIONAL PARK RESERVE
ʔapscik fasii
(Ups-cheek ta-shee)
"Going in the right
direction on the trail"

Designed by/Conçue par
DON CHALMERS / 2017-06
Drawn by/Dessiné par
DAVID COX / 2017-11
PCA Project Manager/Responsable du projet
JACQUE HICKS

Drawing Title/Titre du dessin
ʔapscik fasii (Ups-cheek ta-shee)
"Going in the right direction on the trail"
HIGHWAY 4 PLAN AND PROFILE
ESOWISTA CURVE
STA 75+850 TO 76+160

Project No./No. du projet
PCA #1522
Sheet/Feuille
HW-3
Revision no./No. de révisión
3
OF 19

PACIFIC TRAVERSE TRAIL GENERAL NOTES:

- SURVEY DATA IS BASED UPON THE UTM NAD83 COORDINATE SYSTEM.
- THE CONTRACTOR SHALL ADHERE TO ALL ENVIRONMENTAL REGULATIONS AS SPECIFIED IN THE CONTRACT.
- THE FINAL TRAIL ALIGNMENT SHALL BE ESTABLISHED IN THE FIELD BY DEPARTMENTAL REPRESENTATIVE.
- EXACT LOCATIONS AND SIZES OF RETAINING WALLS SHOWN IN PLAN TO BE CONFIRMED IN FIELD BY DEPARTMENTAL REPRESENTATIVE.
- FOR TYPICAL TRAIL SECTIONS SEE DRAWINGS T-40.1, T-40.2, T-41, T-43, T-44 & T-46
- FOR HAND RAILS AND ACCESS BARRIERS SEE DRAWING HW-4 & HW-5
- FOR CONSTRUCTION SIGNAGE DRAWINGS SEE DRAWING HW-6
- FOR BRIDGES SEE STRUCTURAL DRAWINGS S-1.1 TO S-5.11
- FOR RETAINING WALLS AND FILL SLOPES SEE DRAWINGS W-4.1 TO W-4.3 & W-5.1 TO W-5.6
- FOR TRAFFIC SIGNAGE DETAILS REFER TO SPECIFICATION: TRAFFIC SIGNAGE 32 17 25
- FOR PAVEMENT MARKING REFER TO SPECIFICATION: PAVEMENT MARKING 32 17 23
- FOR REMOVAL OF PAVEMENT MARKINGS REFER TO SPECIFICATION: REMOVAL OF PAVEMENT MARKINGS 32 10 11
- FOR ASPHALT PAVEMENT REFER TO SPECIFICATION: ASPHALT PAVING 32 12 16
- FOR PAVEMENT TACK COAT REFER TO SPECIFICATION: ASPHALT TACK COAT 32 12 13.16
- FOR TRAFFIC BARRIER SPECIFICATIONS REFER TO SPECIFICATION: TRAFFIC BARRIERS 34 17 13
- THE CONTRACTOR MUST NOT LOCATE ANY EQUIPMENT, LABOUR OR MATERIALS WITHIN THE FIRST NATION RESERVE BOUNDARIES
- SEE ALSO SCHOONER COVE PARKING LOT DWG PL-2.1.

LEGEND

- PROPOSED LIMIT OF CLEARING
- PROPOSED SAW CUT
- EXISTING EDGE OF ASPHALT
- PROPOSED CONCRETE ROAD SIDE BARRIER
- PROPOSED RETAINING WALL
- EXISTING CONCRETE FENCE
- PROPERTY LINE
- SIGN
- EXISTING UTILITY POLE
- EXISTING CULVERT
- EXISTING MANHOLE
- PROPOSED NEW PAVEMENT



PARSONS

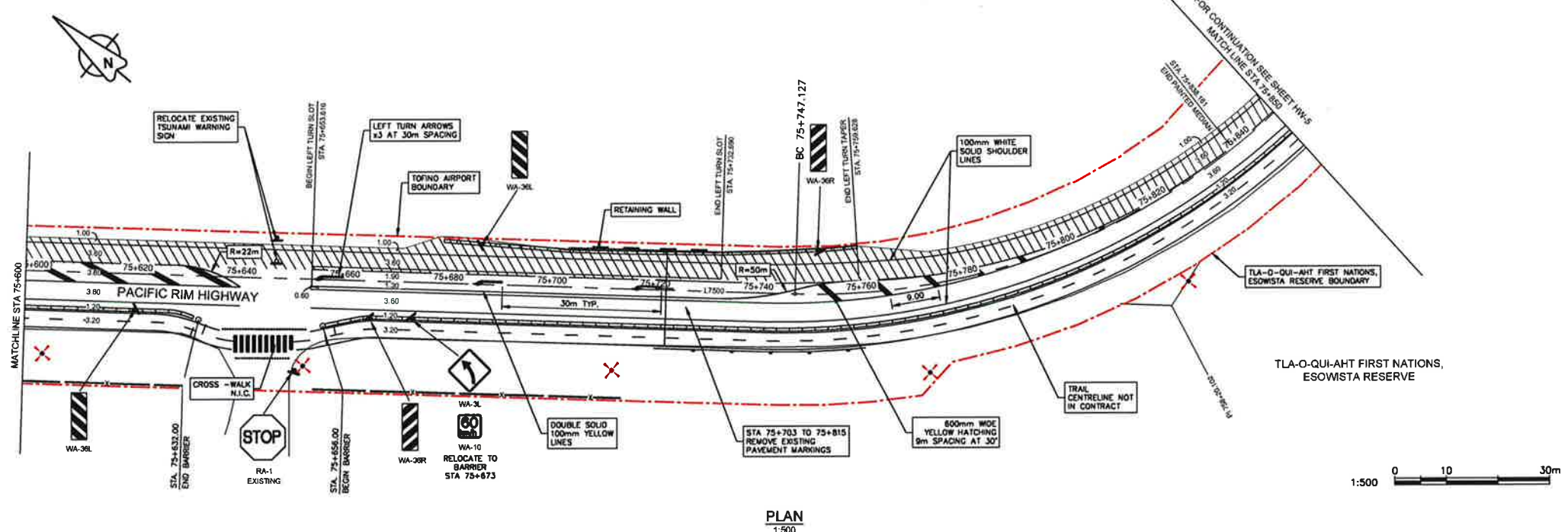
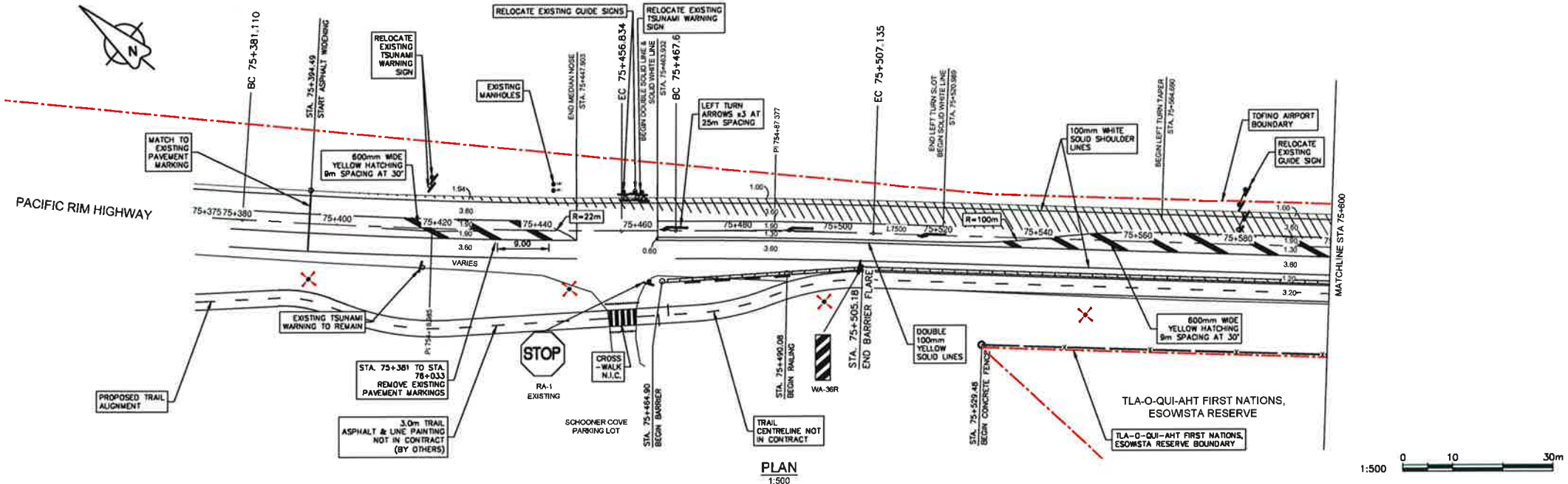

Revision/Description	Date/Date
3	ISSUED FOR TENDER 18/11/2017
2	ISSUED FOR TENDER 28/11/2017
1	ISSUED FOR TENDER 28/11/2017
0	ISSUED FOR TENDER 28/11/2017

Client / client
Parks Canada L'Agence Parcs
Agency Canada
Western and Northern Region Ouest et Nord du Canada

Project title/Titre du projet
TOFINO
PACIFIC RIM NATIONAL PARK RESERVE
?apsclik fasli (Ups-cheek ta-shée)
"Going in the right direction on the trail"

Consultant Signature Only
Designed by/Conçue par
DON CHALMERS / 2017-04
Drawn by/Dessiné par
DAVID COX / 2017-11

PCA Project Manager/Responsable du projet
Administrateur du Projet APC
JACKIE HICKS
Drawing title/Titre du dessin
?apsclik fasli (Ups-cheek ta-shée)
"Going in the right direction on the trail"
HIGHWAY 4 PAVEMENT MARKINGS AND SIGNAGE PLANS
ESOWSTA CURVE
STA 75+400 TO 75+850

Project No./No. du projet
PCA #1622
Sheet/Feuille
HW-4
of 19
Revision No./No. de révis.
3

- PACIFIC TRAVERSE TRAIL GENERAL NOTES:**
1. SURVEY DATA IS BASED UPON THE UTM NAD83 COORDINATE SYSTEM.
 2. THE CONTRACTOR SHALL ADHERE TO ALL ENVIRONMENTAL REGULATIONS AS SPECIFIED IN THE CONTRACT.
 3. THE FINAL TRAIL ALIGNMENT SHALL BE ESTABLISHED IN THE FIELD BY DEPARTMENTAL REPRESENTATIVE.
 4. EXACT LOCATIONS AND SIZES OF RETAINING WALLS SHOWN IN PLAN TO BE CONFIRMED IN FIELD BY DEPARTMENTAL REPRESENTATIVE.
 5. FOR TYPICAL TRAIL SECTIONS SEE DRAWING T-40.1, T-40.2, T-41, T-43, T-44 & T-46
 6. FOR HAND RAILS AND ACCESS BARRIERS SEE DRAWING T-46
 7. FOR CONSTRUCTION SIGNAGE DRAWINGS SEE DRAWING HW-4 & HW-5
 8. FOR CONSTRUCTION DRAWING TYPICAL DETAILS SEE DRAWING HW-6
 9. FOR BRIDGES SEE STRUCTURAL DRAWINGS S-1.1 TO S-5.11

10. FOR RETAINING WALLS AND FILL SLOPES SEE DRAWINGS W-4.1 TO W-4.3 & W-5.1 TO W-5.8
11. FOR TRAFFIC SIGNAGE DETAILS REFER TO SPECIFICATION: TRAFFIC SIGNAGE 32 17 25
12. FOR PAVEMENT MARKING REFER TO SPECIFICATION: PAVEMENT MARKING 32 17 23
13. FOR REMOVAL OF PAVEMENT MARKINGS REFER TO SPECIFICATION: REMOVAL OF PAVEMENT MARKINGS 32 10 11
14. FOR ASPHALT PAVEMENT REFER TO SPECIFICATION: ASPHALT PAVING 32 12 16
15. FOR PAVEMENT TACK COAT REFER TO SPECIFICATION: ASPHALT TACK COAT 32 12 13.18
16. FOR TRAFFIC BARRIER SPECIFICATIONS REFER TO SPECIFICATION: TRAFFIC BARRIERS 34 17 13
17. THE CONTRACTOR MUST NOT LOCATE ANY EQUIPMENT, LABOUR OR MATERIALS WITHIN THE FIRST NATION RESERVE BOUNDARIES



PWSOC - A1 - 8413584

PARSONS

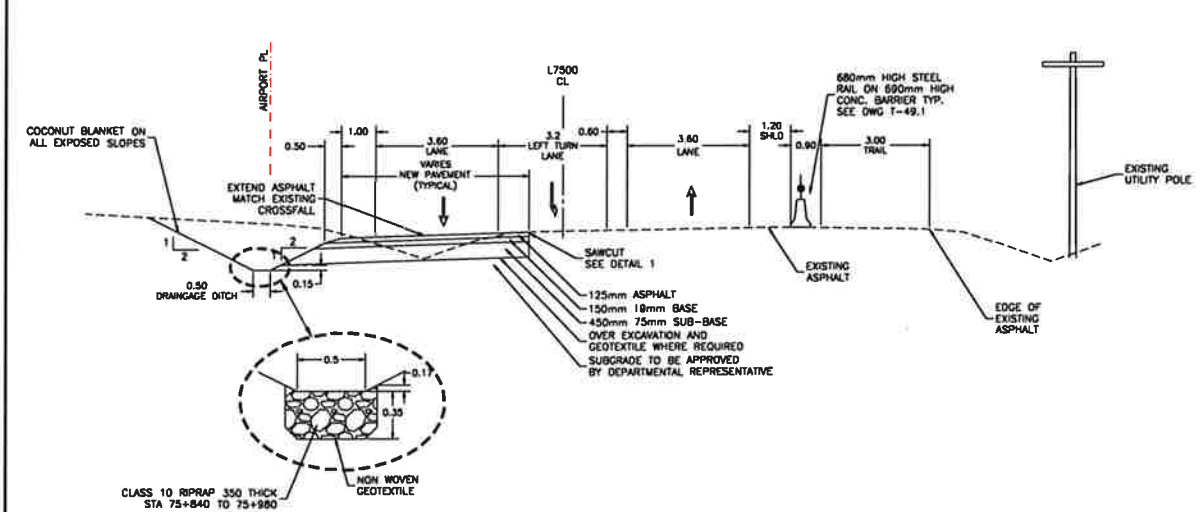

TYPICAL SECTION
STA 75+500 TO STA
75+700 & STA 75+800 TO
STA 75+920

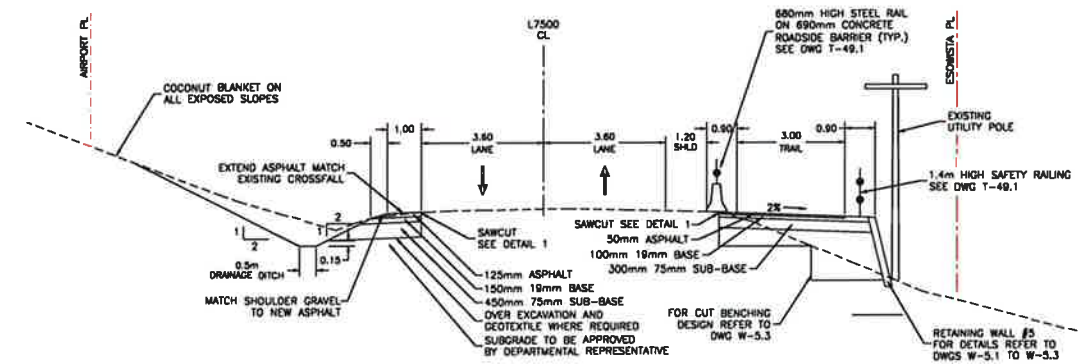

TYPICAL SECTION
STA 75+920 TO STA
76+120

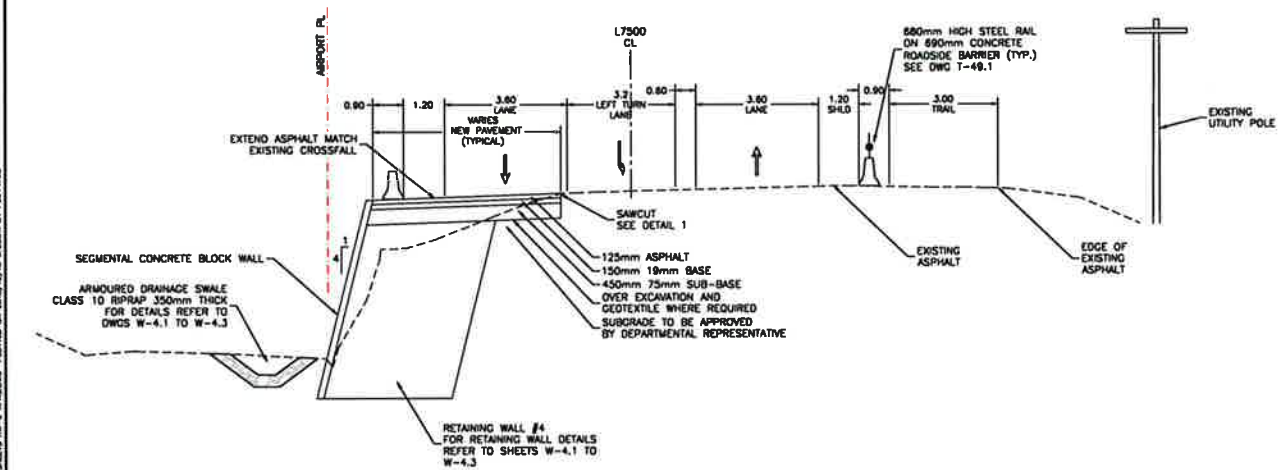

TYPICAL SECTION
STA 75+700 TO STA
75+800

NOTES:

1. FOR ROADSIDE CONC. BARRIERS SEE SHEETS T-46, T-47 AND T-48.1
2. FOR 600mm HIGH STEEL RAIL SEE SHEET T-49.1
3. FOR 1400mm HIGH SAFTY RAIL SEE SHEET T-49.2

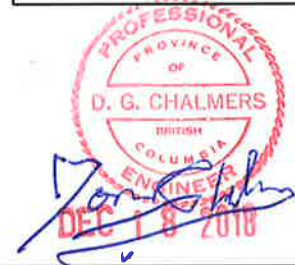
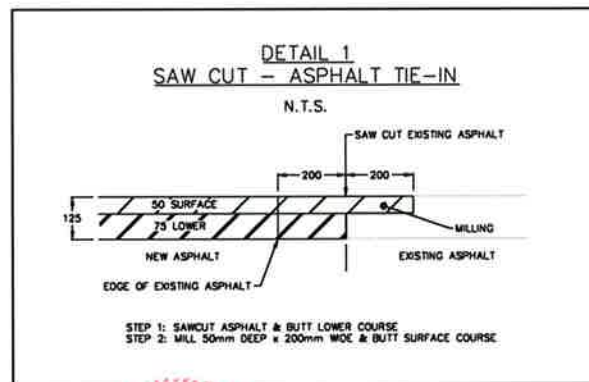

Revision/Description	Date/Date
3	ISSUED FOR TENDER 18/12/2018
2	ISSUED FOR TENDER 28/11/2018
1	ISSUED FOR TENDER 30/11/2017
0	ISSUED FOR TENDER 08/11/2017

Parks Canada L'Agence Parcs
Agency Canada
Western and Northern Region Ouest et Nord du Canada

Projet/Titre du projet
TOFINO
PACIFIC RIM NATIONAL PARK RESERVE
?apsclik fasli
(Ups-cheek ta-shee)
"Going in the right direction on the trail"

Designed by/Concept par
DON CHALMERS / 2017-08
Drawn by/Dessiné par
DAVID COX / 2017-11
PCA Project Manager/Responsible Authority
Administrateur de Projets APC
JACKIE HICKS

Drawing Title/Titre du dessin
?apsclik fasli (Ups-cheek ta-shee)
"Going in the right direction on the trail"
HIGHWAY 4 - ESOWSTA CURVE
TYPICAL SECTIONS

Project No./No. de projet PCA #1522	Sheet/Feuille HW-6 of 19	Revision No./No. de révision 3
--	--------------------------------	-----------------------------------

03/10/2018 - PROJEC 04 - PACIFIC RIM NATIONAL PARK RESERVE - HW-6 - MILLING PLANTED ON 20/11/18 @ 2:28pm BY PROJ-10

PARSONS

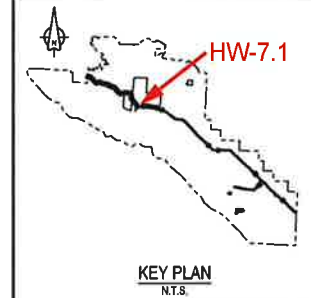

Revision/Modification	Description/Description	Date/Date
1	ISSUED FOR TENDER	18/11/2017
0	ISSUED FOR TENDER	08/11/2017

Parks Canada L'Agence Parcs
Agency Canada
Western and Northern Region Ouest et Nord du Canada

Projet titre/Titre du projet
**TOFINO
PACIFIC RIM
NATIONAL PARK RESERVE
?apscik fasli
(Ups-cheek ta-shee)
"Going in the right
direction on the trail"**

Consultant Signature Only
Designed by/Concepi par
DON CHALMERS / 2017-08
Drawn by/Deasine par
DAVID COX / 2017-11
PCA Project Manager/Contrat Authority
Administrateur de Projets APC
JACKIE HICKS

Drawing title/Titre du dessin
?apscik fasli (Ups-cheek ta-shee)
"Going in the right direction on the
trail"
HIGHWAY 4 ESOWISTA CURVE
WIDENING - TYPICAL SECTIONS
STA 75+400 TO 75+440

Project No./No. de projet PCA #1522	Sheet/Feuille HW-7.1	Revision No./ No. de 1
---	--------------------------------	-------------------------------------

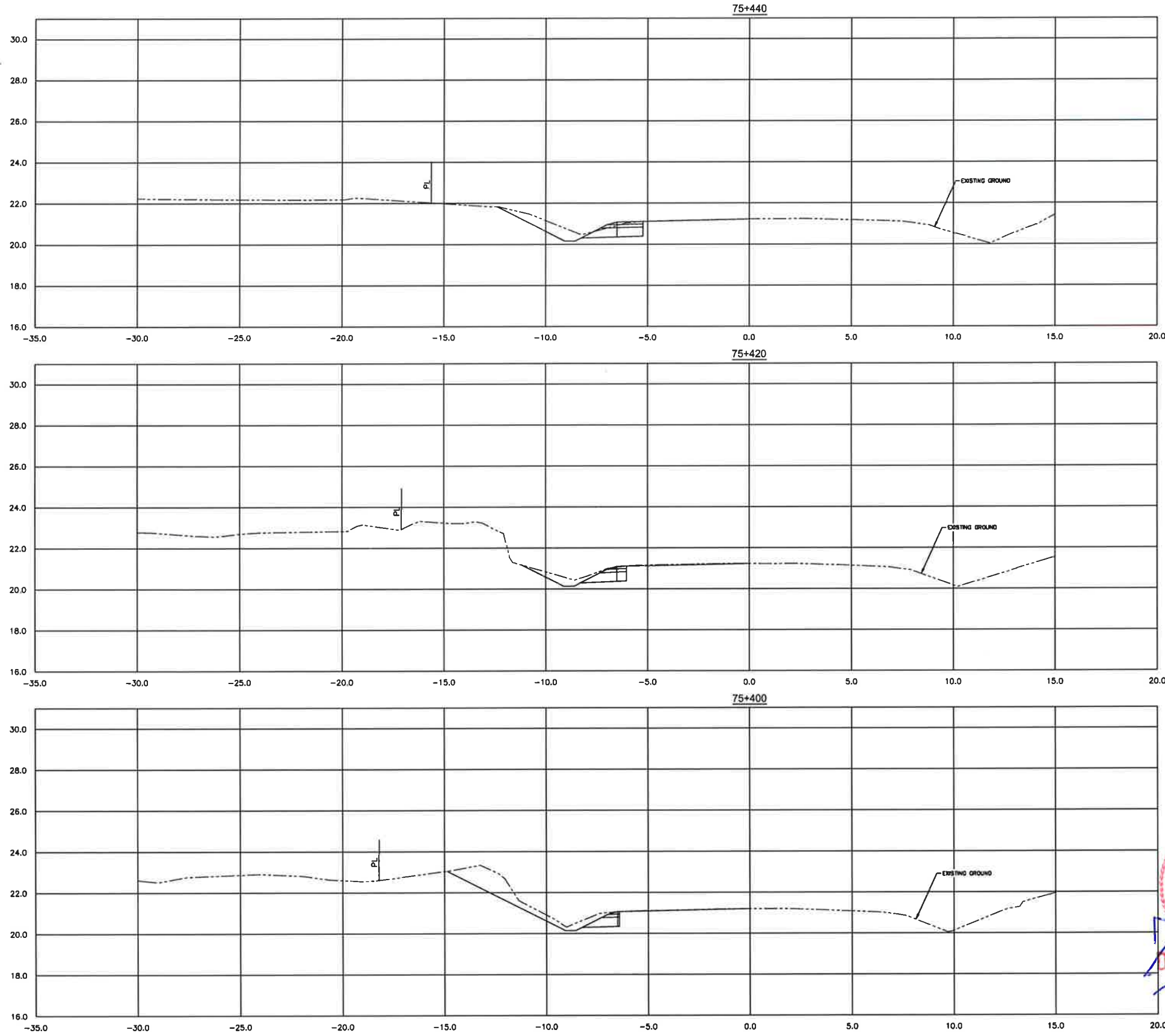

**PROFESSIONAL
ENGINEER
OF
BRITISH COLUMBIA**
[Signature]
DEC 18 2018



© 2018 PARSONS - PROJET 1522 - HW-7.1 - PACIFIC RIM NATIONAL PARK RESERVE - TYPICAL SECTIONS - WIDENING - STA 75+400 TO 75+440 - DRAWN BY: DON CHALMERS



PARSONS

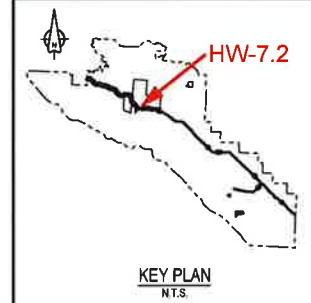

Priority/ Sequence	Description/Description	Date/Date
1	ISSUED FOR TENDER	18/12/2016
2	ISSUED FOR TENDER	26/11/2017

Client/Client
Parks Canada L'Agence Parcs
Agency Canada
Western and Northern Region Ouest et Nord
du Canada

Project title/Titre du projet
TOFINO
PACIFIC RIM
NATIONAL PARK RESERVE
?apsclik tašli
(Ups-cheek ta-shee)
"Going in the right
direction on the trail"

Designated by/Conçue par
DON CHALMERS / 2017-08
Drawn by/Dessiné par
DAVID COX / 2017-11
PCA Project Manager/Responsable Autorité
Administrateur de Projets APC
JACKIE HICKS

Drawing title/Titre du dessin
?apsclik tašli (Ups-cheek ta-shee)
"Going in the right direction on the
trail"
HIGHWAY 4 ESOWSTA CURVE
WIDENING - TYPICAL SECTIONS
STA 75+460 TO 75+500

Project No./No. de projet	Sheet/Feuille	Drawing no./ no. du dessin
PCA #1522	HW-7.2	1
of 18		

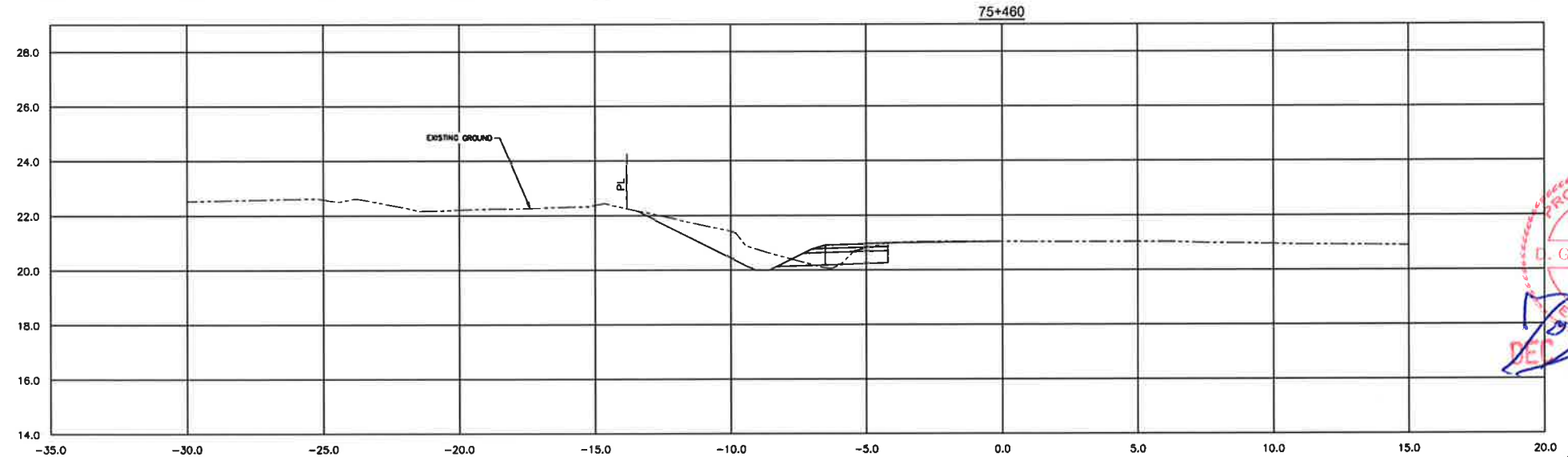
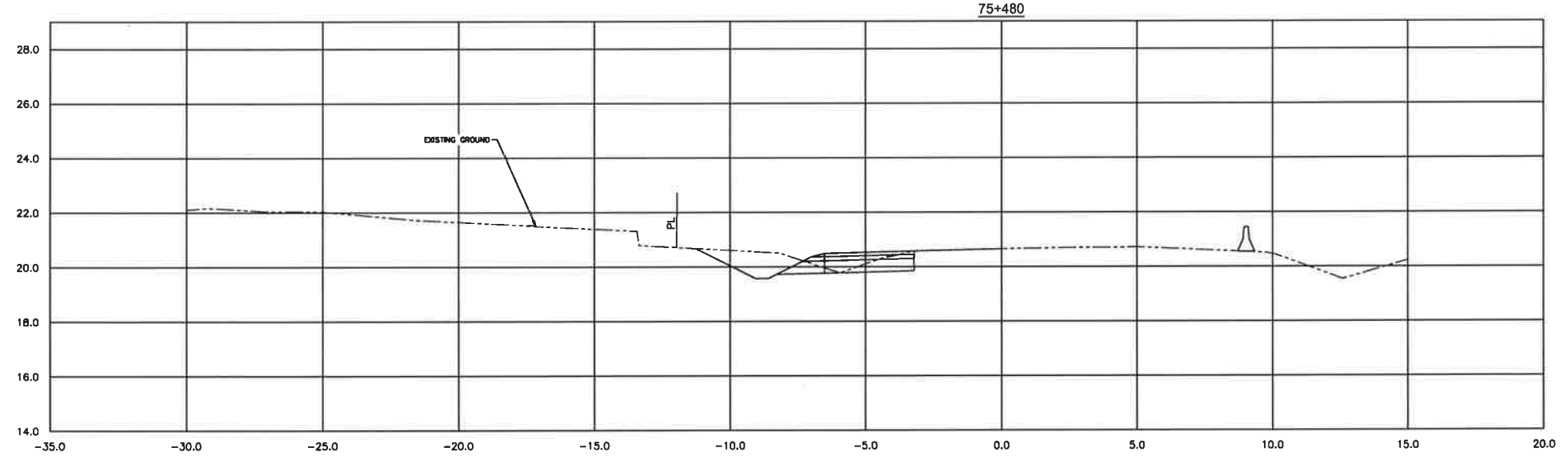
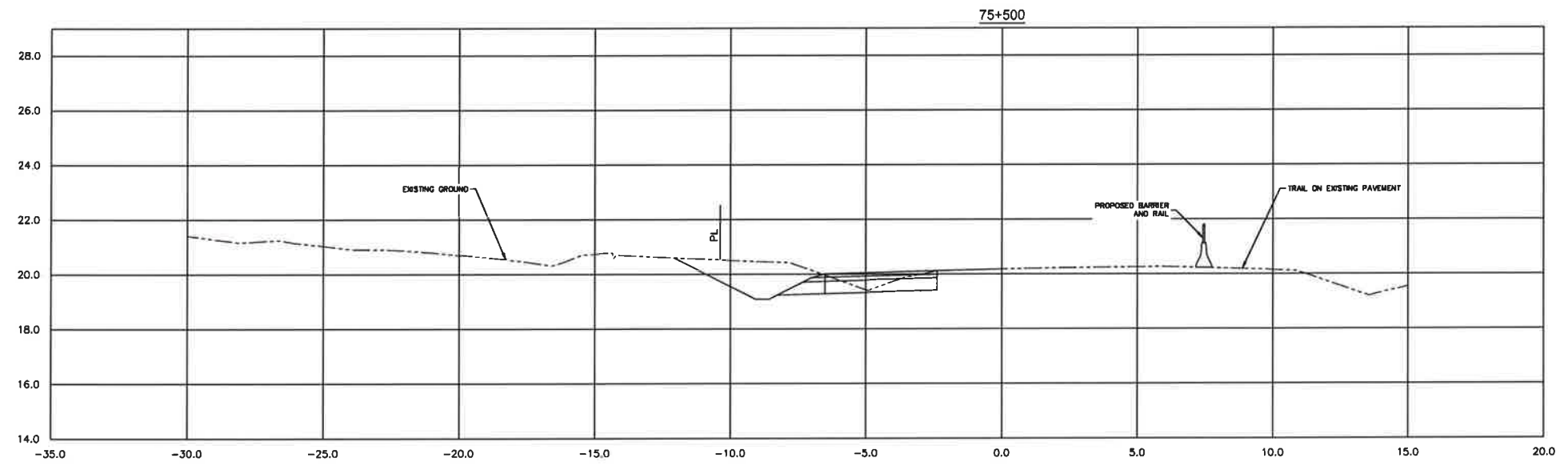

PROFESSIONAL
PROVINCE
OF
D. G. CHALMERS
BRITISH
COLUMBIA
ENGINEER
DEC 1 8 2018



D:\V\1522152 - PCA - HW-7.2\HW-7.2 - TYPICAL SECTIONS\HW-7.2 - TYPICAL SECTIONS.dwg PLOTTED ON 2018/12/18 9:20am BY PCHALMERS



PARSONS

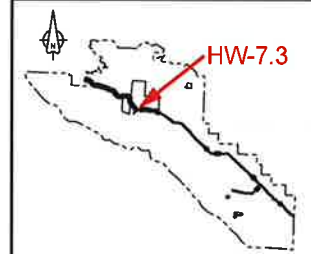
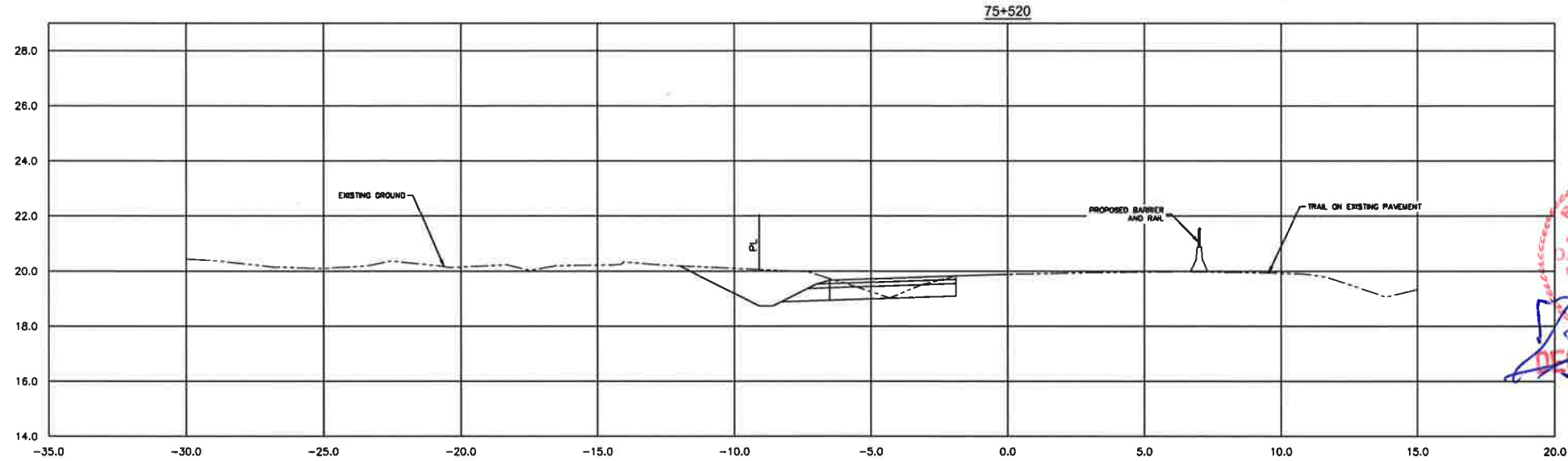
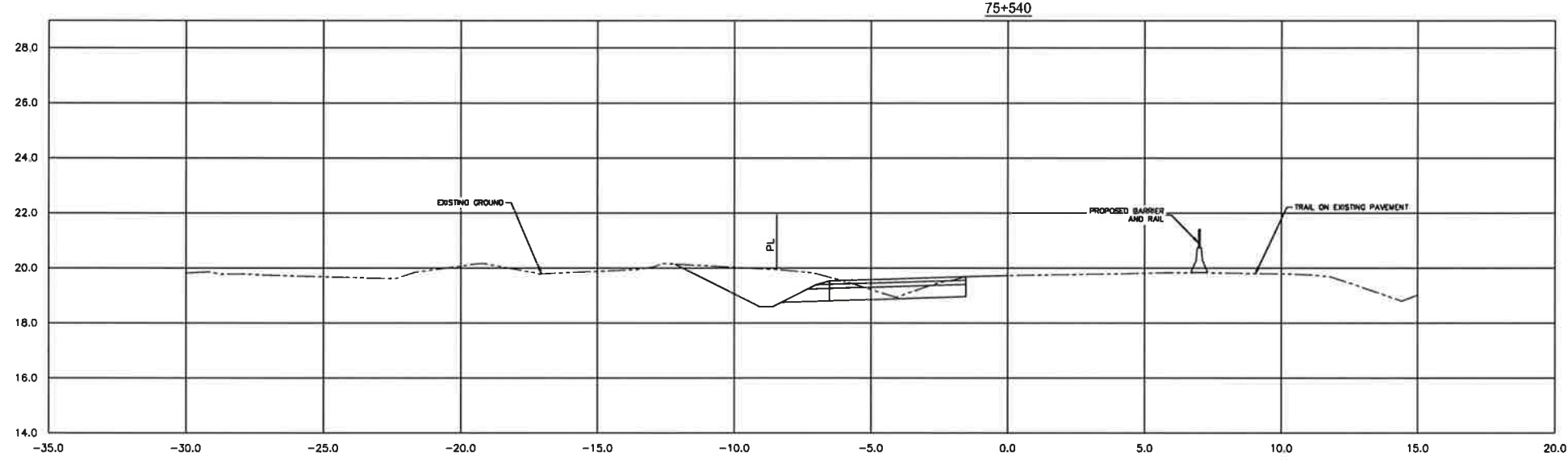
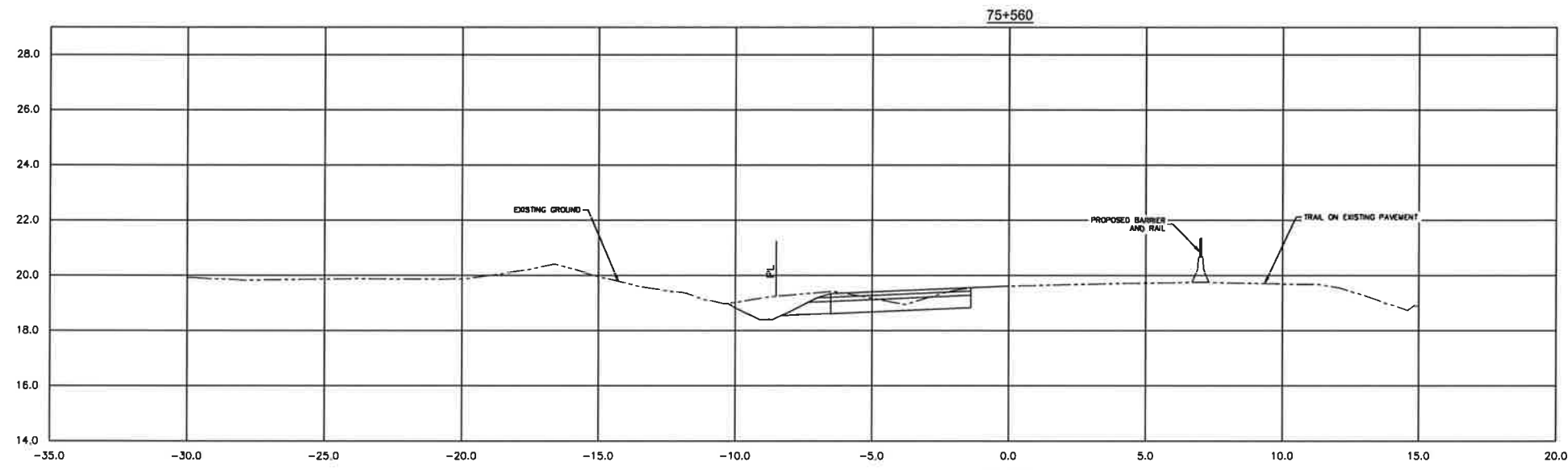

Version/Revision	Description/Description	Date/Date
1	ISSUED FOR TENDER	15/12/2018
0	ISSUED FOR TENDER	26/11/2017

Client/Client

**Parks Canada L'Agence Parcs
Agency Canada**

Western and Northern Region Ouest et Nord du Canada

Projet/Title du projet

**TOFINO
PACIFIC RIM
NATIONAL PARK RESERVE
?apsçlik fašil
(Ups-cheek ta-shee)
"Going in the right
direction on the trail"**

Designed by/Conçeu par
DON CHALMERS / 2017-08

Drawn by/Dessiné par
DAVID COX / 2017-11

PCA Project Manager/Technicien Authority
Administrateur de Projets APC
JACKIE HICKS

Drawing title/Titre du dessin

**?apsçlik fašil (Ups-cheek ta-shee)
"Going in the right direction on the
trail"
HIGHWAY 4 ESOWISTA CURVE
WIDENING - TYPICAL SECTIONS
STA 75+520 TO 75+560**

Project No./No. du projet
PCA #1522

Sheet/Feuille
HW-7.3

Revision no./
No. de révisión
1

of 19

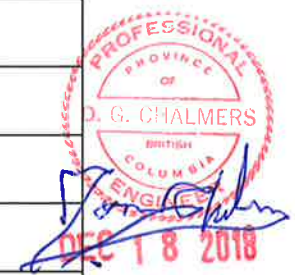

© 1/1/2018 - P:\0001 - PCA #1522 - HW-7.3 - TYPICAL SECTIONS - WIDENING - STA 75+520 TO 75+560 - BY: DON CHALMERS



PARSONS

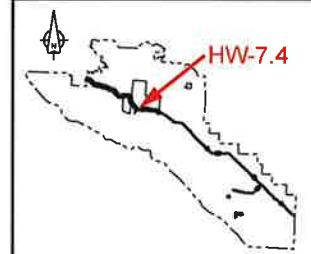
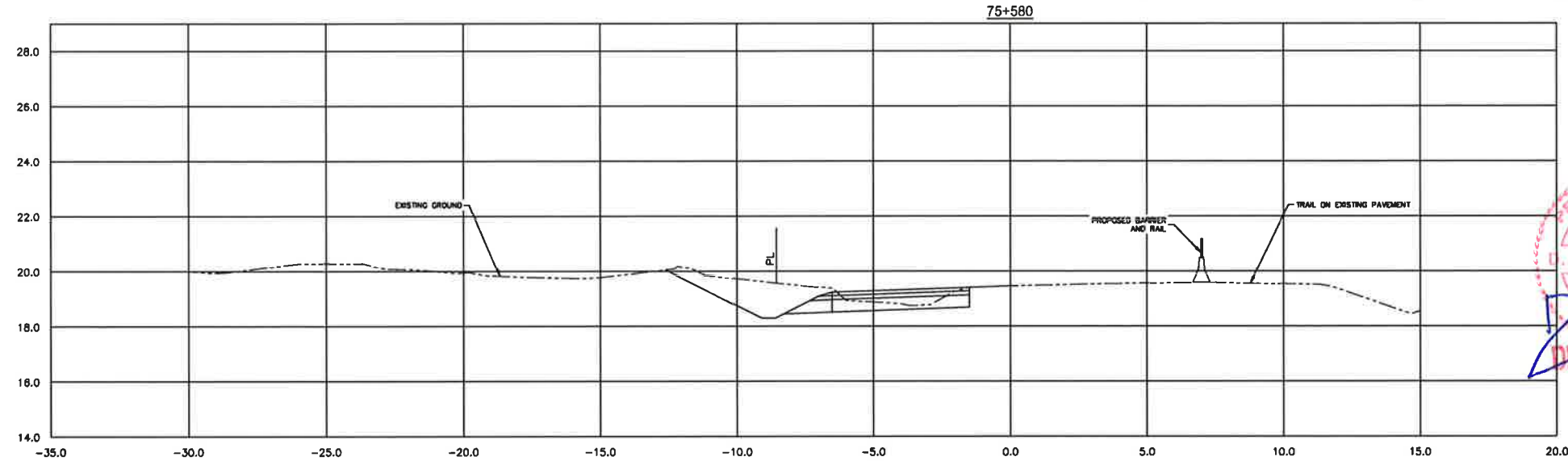
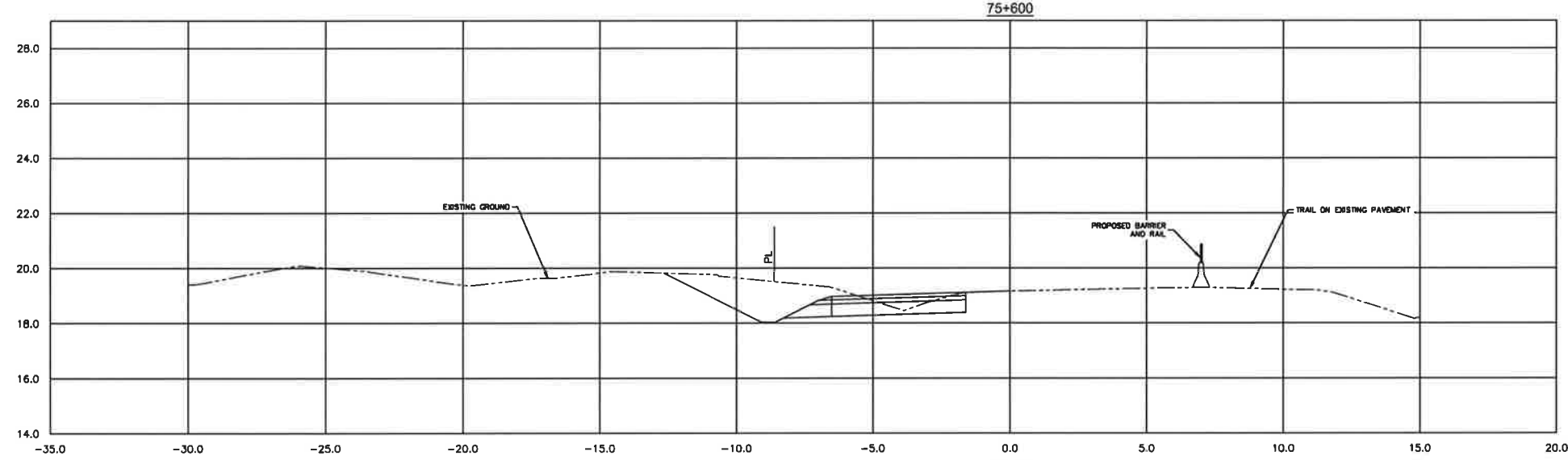
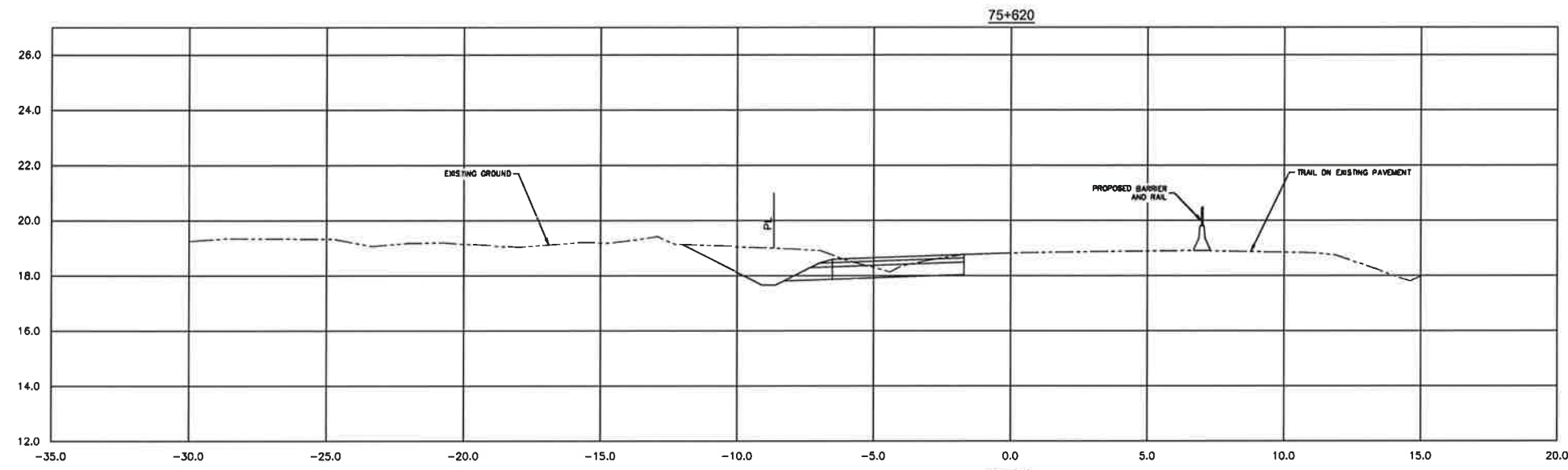

KEY PLAN
N.T.S.

1	ISSUED FOR TENDER	16/12/2018
2	ISSUED FOR TENDER	26/11/2017
Description / Description		
Client / Client		

Parks Canada L'Agence Parcs
 Agency Canada
 Western and Northern Region Ouest et Nord du Canada

Projet site/Titre du projet
TOFINO
PACIFIC RIM NATIONAL PARK RESERVE
ʔapsčlił ʔasłi
(Ups-cheek ta-shee)
"Going in the right direction on the trail"

Consultant Signature Only
 Designed by/Conçue par
 DON CHALMERS / 2017-08
 Drawn by/Dessiné par
 DAVID COX / 2017-11
 PCA Project Manager/Responsable du projet
 Administrateur de Projets APC
 JACKIE HICKS

DON G. CHALMERS
 BRITISH COLUMBIA
 DEC 18 2018

Drawing site/Titre de dessin
ʔapsčlił ʔasłi (Ups-cheek ta-shee)
"Going in the right direction on the trail"
HIGHWAY 4 ESOWISTA CURVE WIDENING - TYPICAL SECTIONS
 STA 75+580 TO 75+620

Project No./No. de projet	Sheet/Feuille	Drawing no./No. de dessin
PCA #1522	HW-7.4 of 10	1



24/11/2018 - PMSG 504-55/PAZAC INVASIVE MANAUNO/UNO/30-PT1-34ETS-CONDS SECTION REVIZING ADPTED ON 2018/12/18 @ 3:00 PM BY PMSG/TAC

PARSONS

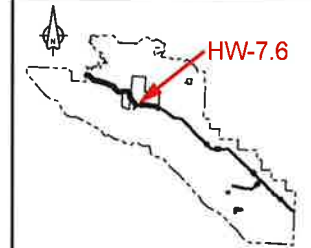
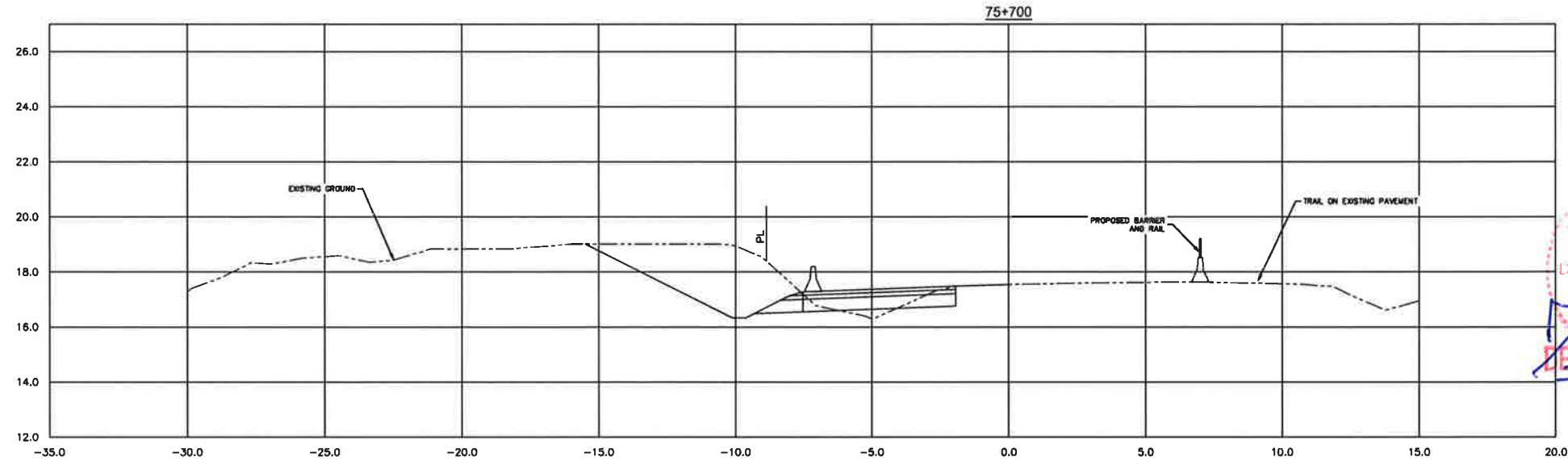
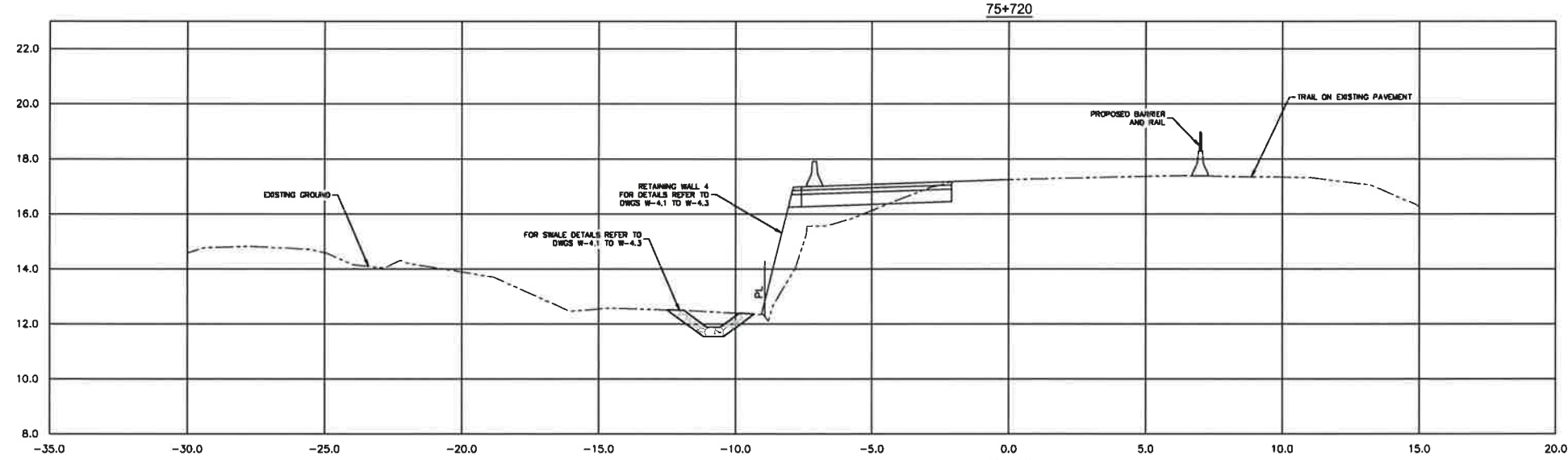
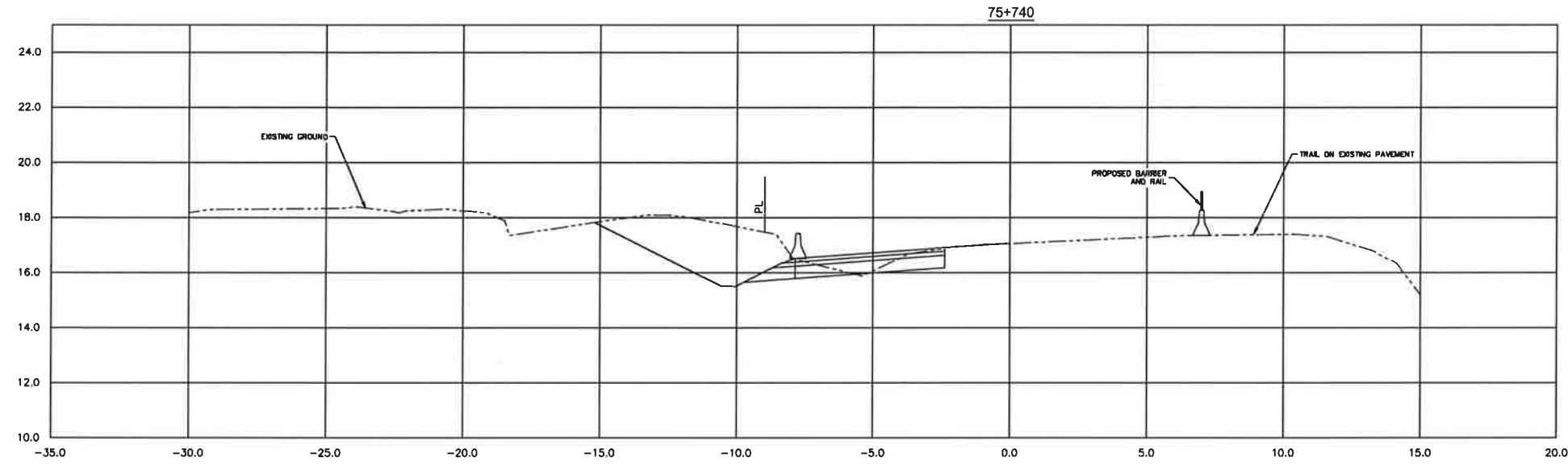

Item No.	Description/Description	Date/Date
1	ISSUES FOR TENDER	18/12/2018
2	ISSUES FOR TENDER	18/11/2018

Client/Client

**Parcs Canada L'Agence Parcs
Agency Canada**

Western and Northern Region Ouest et Nord du Canada

Project Site/Titre du projet

**TOFINO
PACIFIC RIM
NATIONAL PARK RESERVE
?apsclik fašil
(Ups-cheek ta-shee)
"Going in the right
direction on the trail"**

Consultant Signature Only

Designed by/Conçue par
DON CHALMERS / 2017-08

Drawn by/Dessiné par
DAVID COX / 2017-11

PCA Project Manager/Technical Authority
Administrateur de Projets APC
JACQUE HICKS

Drawing Site/Titre du dessin

**?apsclik fašil (Ups-cheek ta-shee)
"Going in the right direction on the
trail"
HIGHWAY 4 ESOWISTA CURVE
WIDENING - TYPICAL SECTIONS
STA 75+700 TO 75+740**

Project No./No. de projet
PCA #1522

Sheet/Feuille
HW-7.6

Revision no./
La Révision
1

of 19

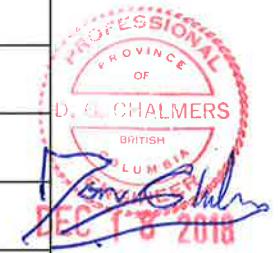

© 2018 PARSONS BRINCKERHOFF INC. ALL RIGHTS RESERVED. THIS DRAWING IS THE PROPERTY OF PARSONS BRINCKERHOFF INC. AND IS NOT TO BE REPRODUCED OR TRANSMITTED IN ANY FORM OR BY ANY MEANS, ELECTRONIC OR MECHANICAL, INCLUDING PHOTOCOPYING, RECORDING, OR BY ANY INFORMATION STORAGE AND RETRIEVAL SYSTEM.



PARSONS

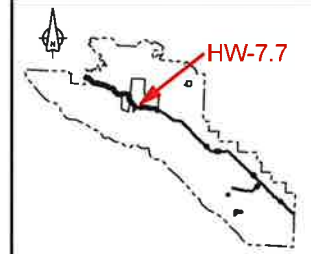
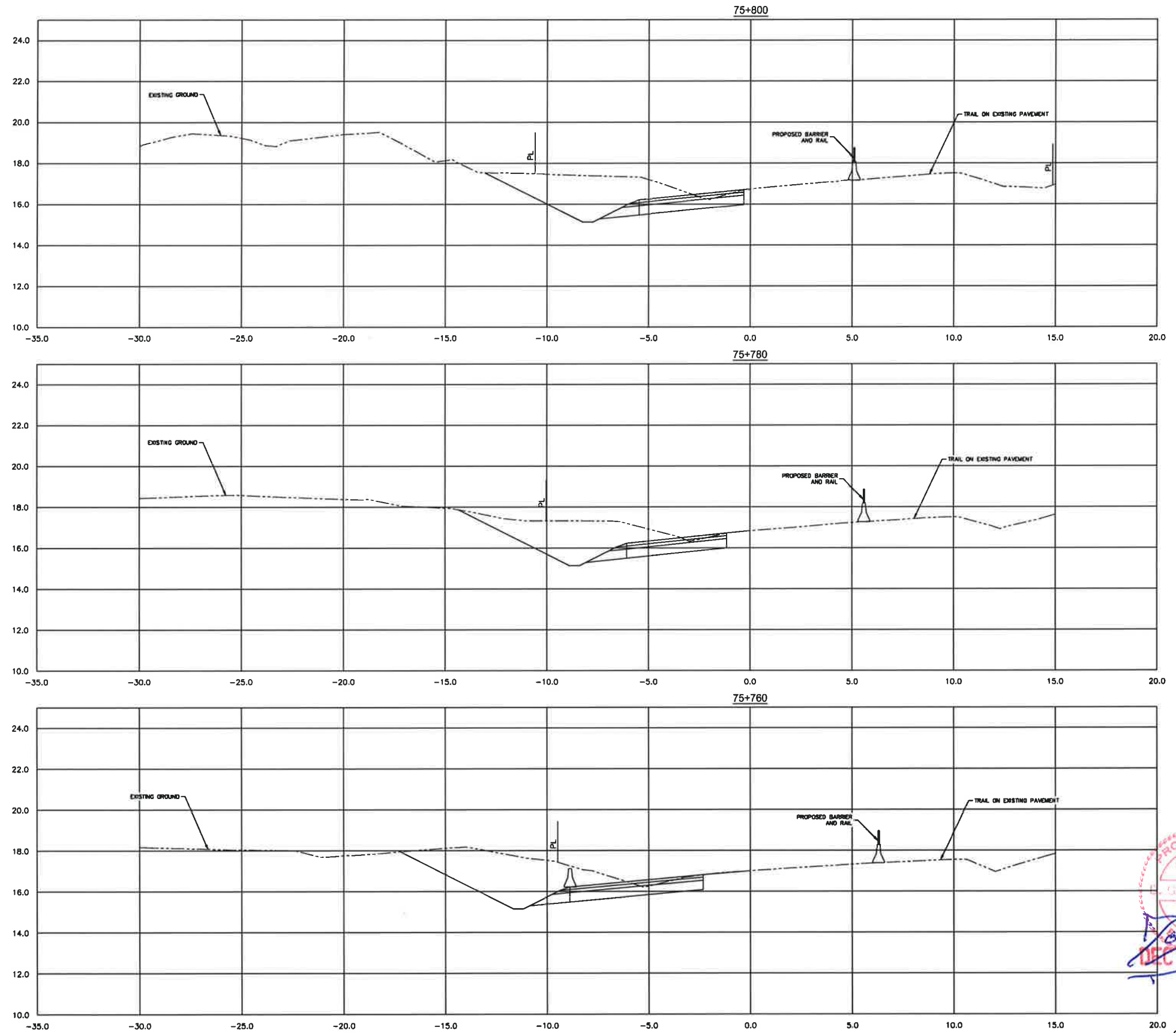

Revision/	Description/Description	Date/Date
1	ISSUED FOR TENDER	18/12/2018
0	ISSUED FOR TENDER	26/11/2017

Client/Client
Parks Canada L'Agence Parcs
 Agency Canada
 Western and Northern Region Ouest et Nord du Canada

Projet/Title du projet
TOFINO
PACIFIC RIM NATIONAL PARK RESERVE
ʔapsɬik ʔasɬi (Ups-cheek ta-shee)
"Going in the right direction on the trail"

Consultant Signature Only
 Designed by/Conçue par
 DON CHALMERS / 2017-08
 Drawn by/Dessiné par
 DAVID COX / 2017-11
 PCA Project Manager/Responsable du projet APC
 JACKIE HICKS

Drawing title/Title du dessin
ʔapsɬik ʔasɬi (Ups-cheek ta-shee)
"Going in the right direction on the trail"
HIGHWAY 4 ESOWSTA CURVE
WIDENING - TYPICAL SECTIONS
 STA 75+760 TO 75+800

Project No./No. de projet	Sheet/Feuille	Drawing No./No. de dessin
PCA #1522	HW-7.7	1

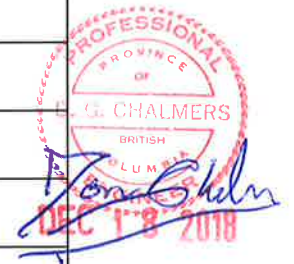

© 2018 PARSONS BRINCKERHOFF INC. ALL RIGHTS RESERVED. THIS DOCUMENT IS THE PROPERTY OF PARSONS BRINCKERHOFF INC. AND IS NOT TO BE REPRODUCED OR TRANSMITTED IN ANY FORM OR BY ANY MEANS, ELECTRONIC OR MECHANICAL, INCLUDING PHOTOCOPYING, RECORDING, OR BY ANY INFORMATION STORAGE AND RETRIEVAL SYSTEM.



PARSONS

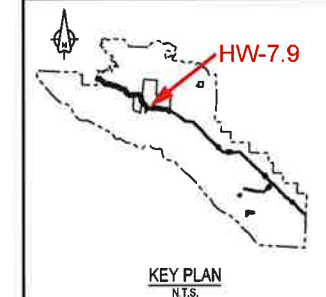
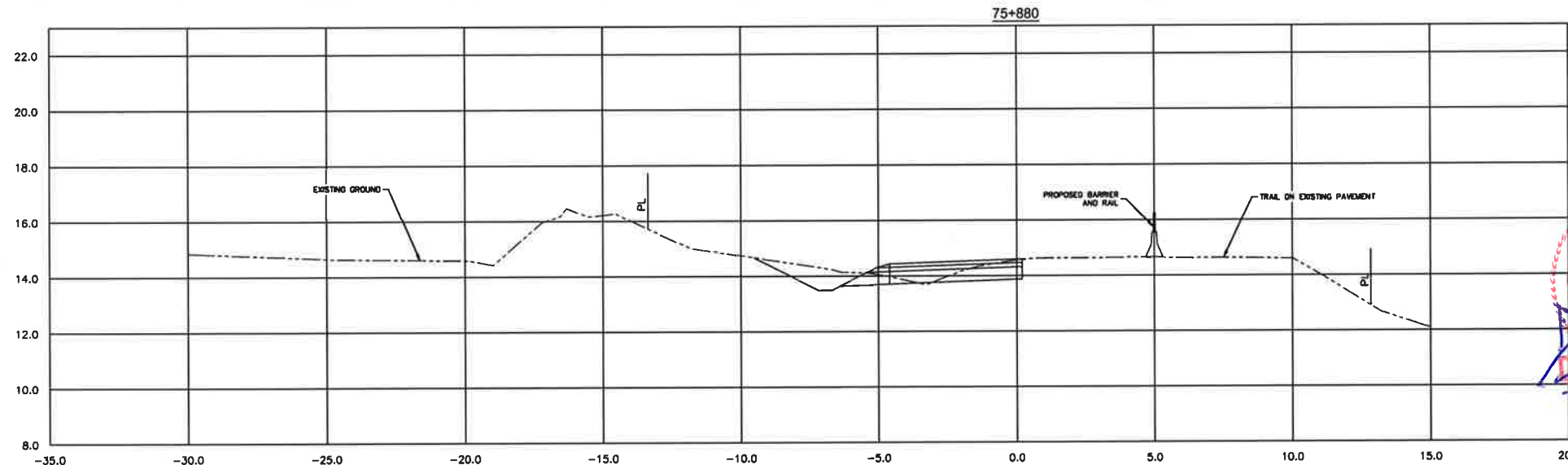
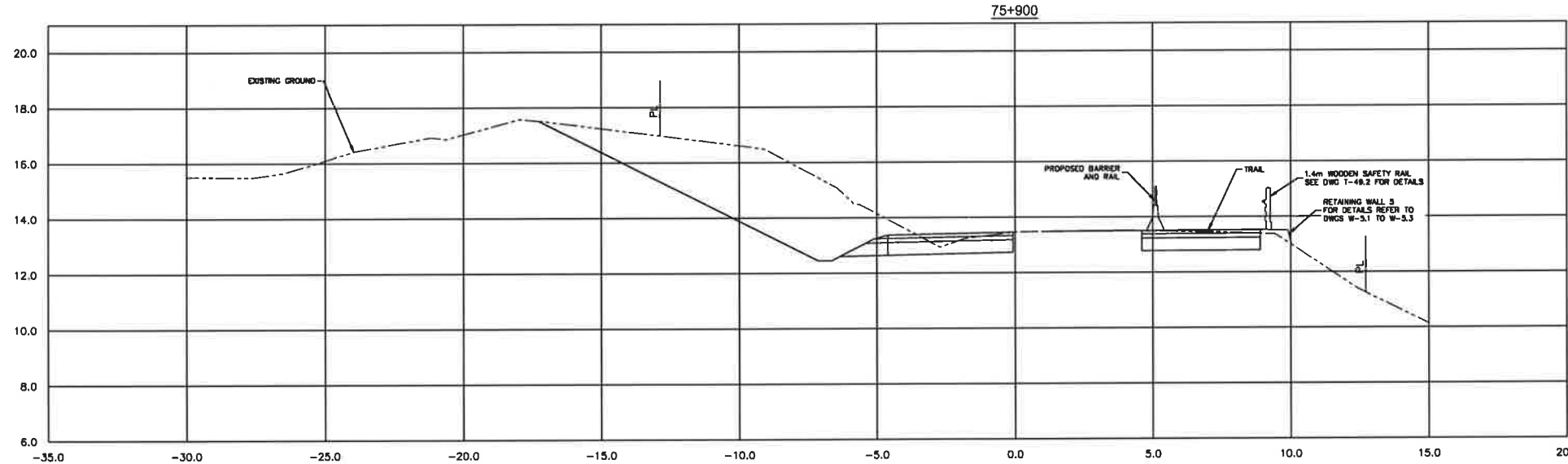
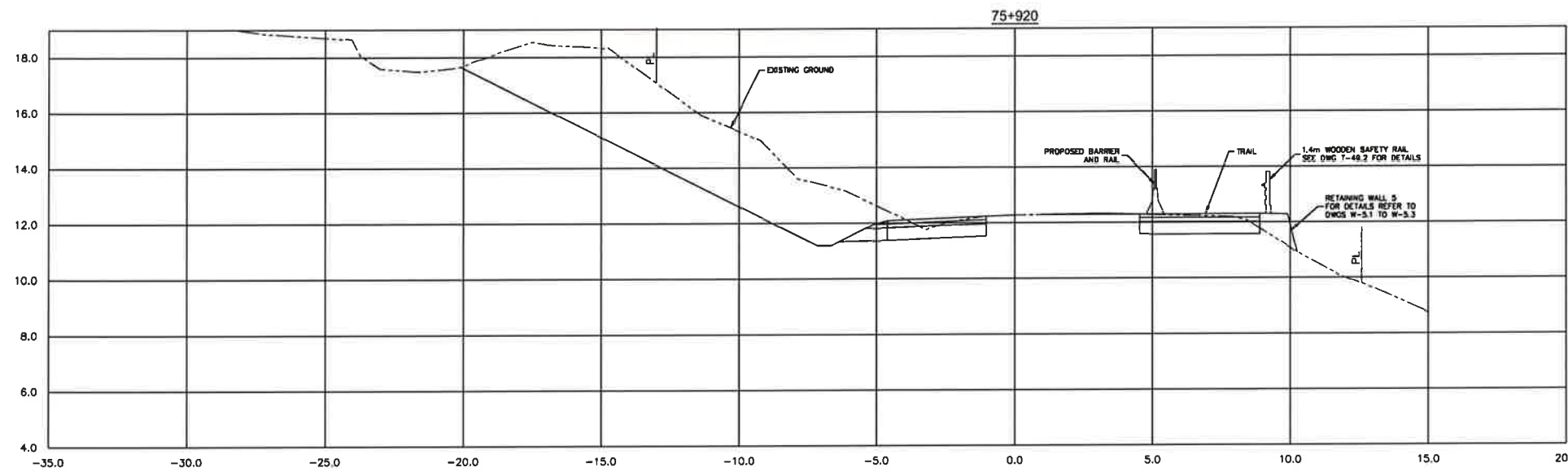

Revision/	Description/Description	Date/Date
1	ISSUED FOR TENDER	18/12/2018
2	ISSUED FOR TENDER	28/11/2017

Client/Client
Parcs Canada L'Agence Parcs
 Agency Canada
 Western and Northern Region Quest et Nord du Canada

Project title/Titre du projet
TOFINO
PACIFIC RIM NATIONAL PARK RESERVE
?apscilik faali (Ups-cheek ta-shee)
"Going in the right direction on the trail"

Designed by/Conçue par
 DON CHALMERS / 2017-06
 Drawn by/Dessiné par
 DAVID COX / 2017-11
 PCA Project Manager/Responsable du projet
 Administrateur de Projets APC
 JACKIE HICKS

Drawing title/Titre du dessin
?apscilik faali (Ups-cheek ta-shee)
"Going in the right direction on the trail"
HIGHWAY 4 ESOWSTA CURVE WIDENING - TYPICAL SECTIONS
 STA 75+880 TO 75+920

Project No./No. de projet
PCA #1622
 Sheet/Feuille
HW-7.9
 Revision no./Le Révision
1
 OF 19

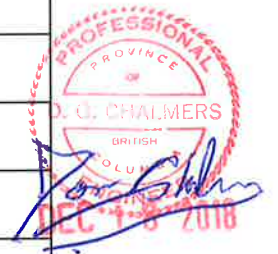

G:\TYM\2017-11-16\PCA\1622\HW-7.9\HW-7.9-01-SHEETS-CROSS SECTIONS REVISIONS PLOTTED ON 2018/12/18 8:33am BY PRODMINE



PARSONS

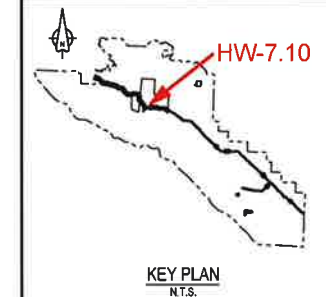
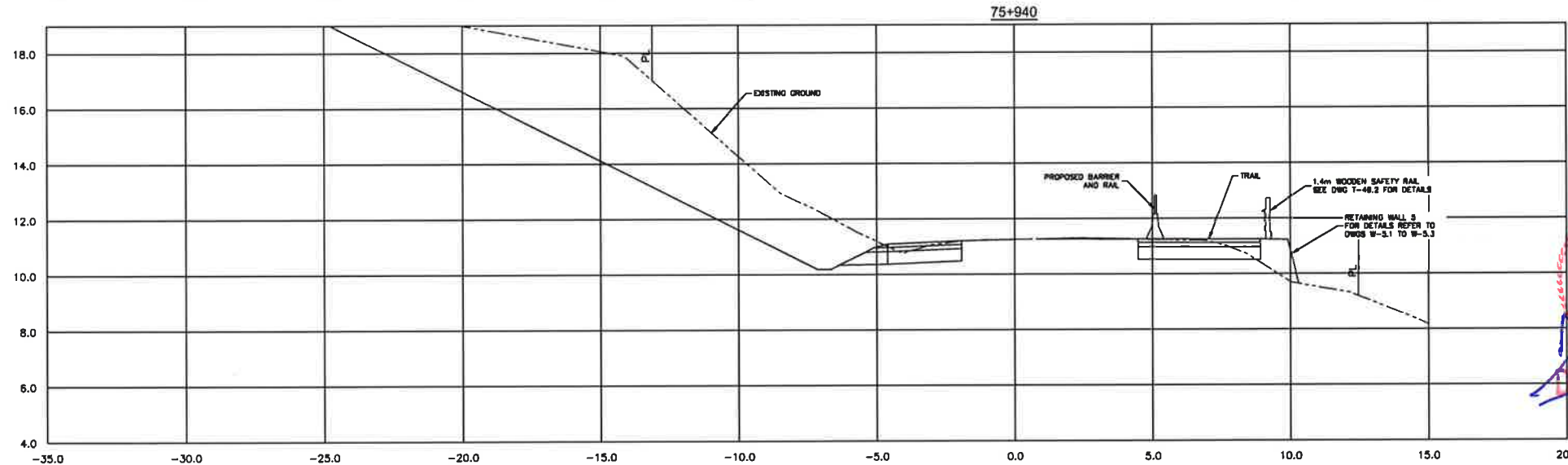
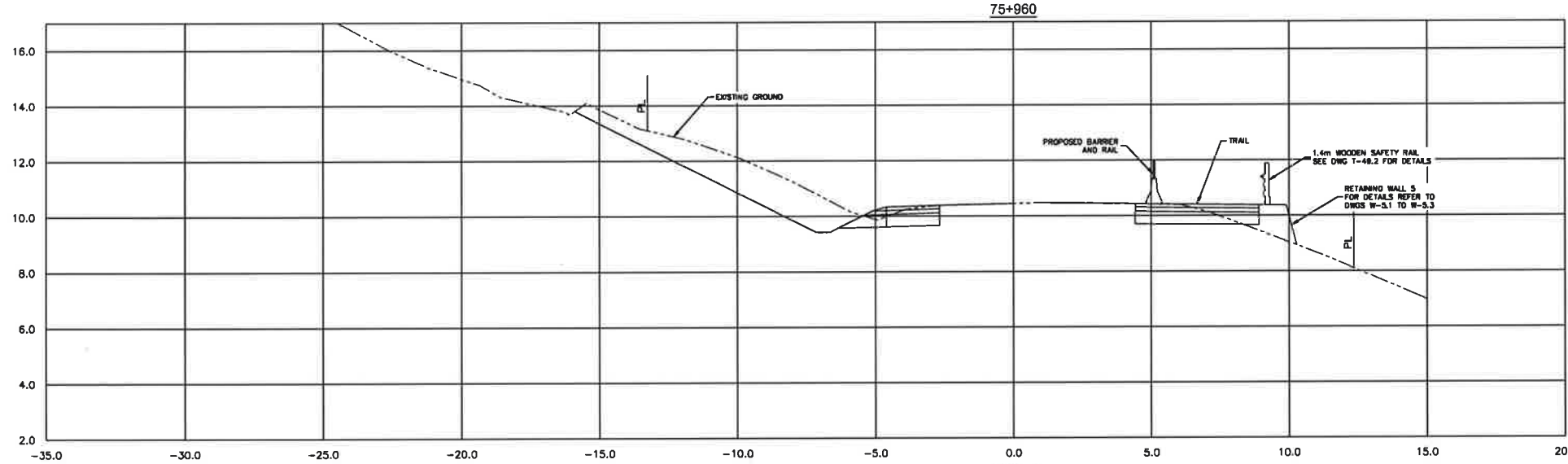
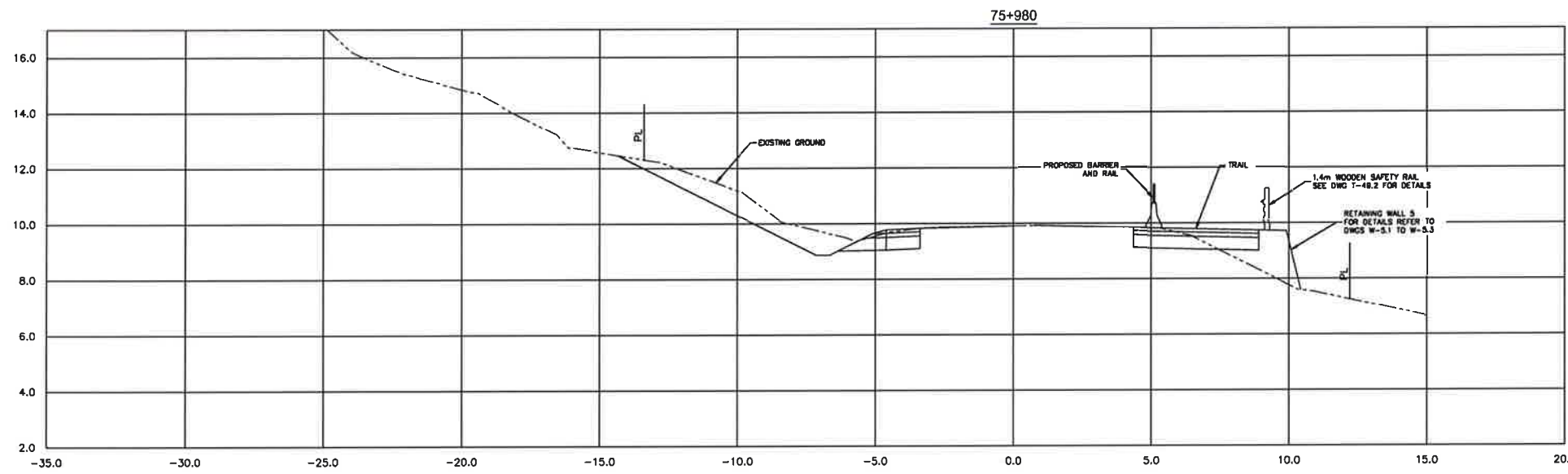

NO.	ISSUED FOR TENDER	DATE
1	ISSUED FOR TENDER	8/13/2016
2	ISSUED FOR TENDER	9/11/2017
3	ISSUED FOR TENDER	11/11/2017
4	ISSUED FOR TENDER	11/11/2017

Client/Client	Parks Canada L'Agence Parcs Canada Western and Northern Region Ouest et Nord du Canada
---------------	--

Project Title/Titre du projet
TOFINO
PACIFIC RIM
NATIONAL PARK RESERVE
?apsčłk fašł
(Ups-cheek ta-shėe)
"Going in the right
direction on the trail"

Designed by/Concepť par
DON CHALMERS / 2017-06
Drawn by/Dessiné par
DAVID COX / 2017-11
PCA Project Manager/Responsable de Projet APC
Administrateur de Projets APC
JACKIE HICKS

Drawing Title/Titre de dessin
?apsčłk fašł (Ups-cheek ta-shėe)
"Going in the right direction on the
trail"
HIGHWAY 4 ESOWISTA CURVE
WIDENING - TYPICAL SECTIONS
STA 75+940 TO 75+980

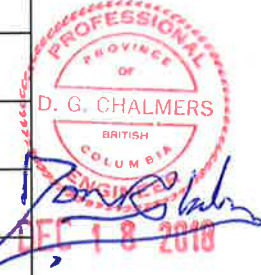

Project No./No. de projet PCA #1522	Sheet/Feuille HW-7.10 OF 19	Revision no./Leļ Revizyon no. 1
--	-----------------------------------	------------------------------------

PARSONS

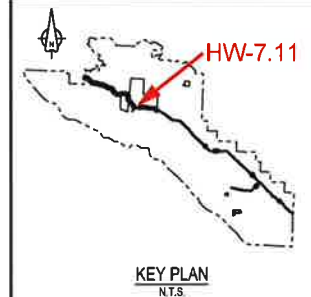
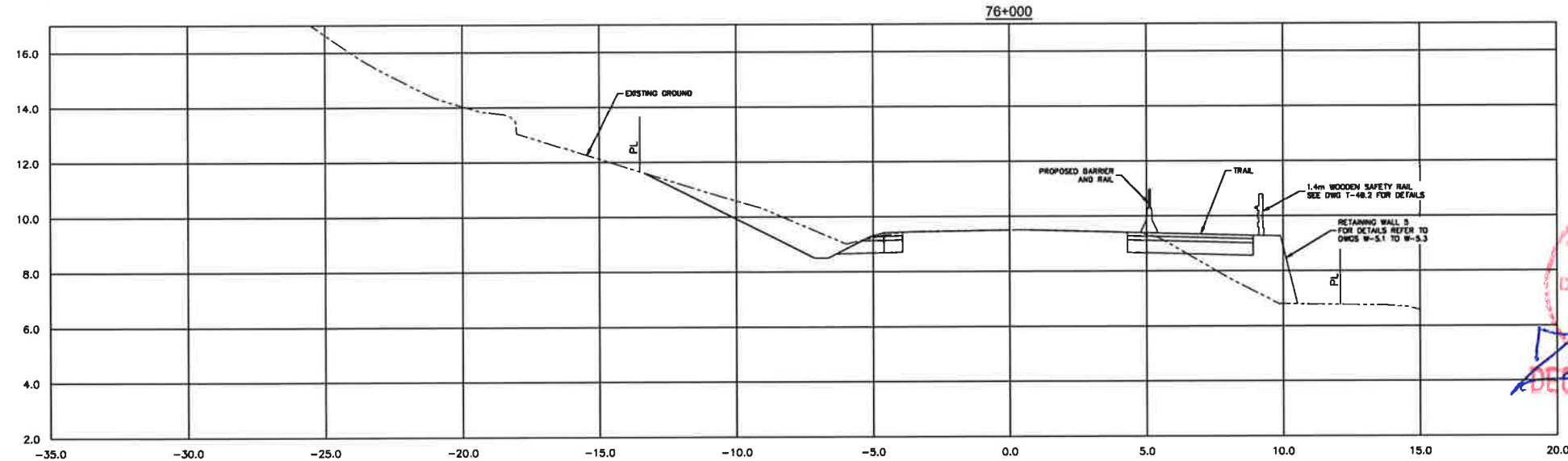
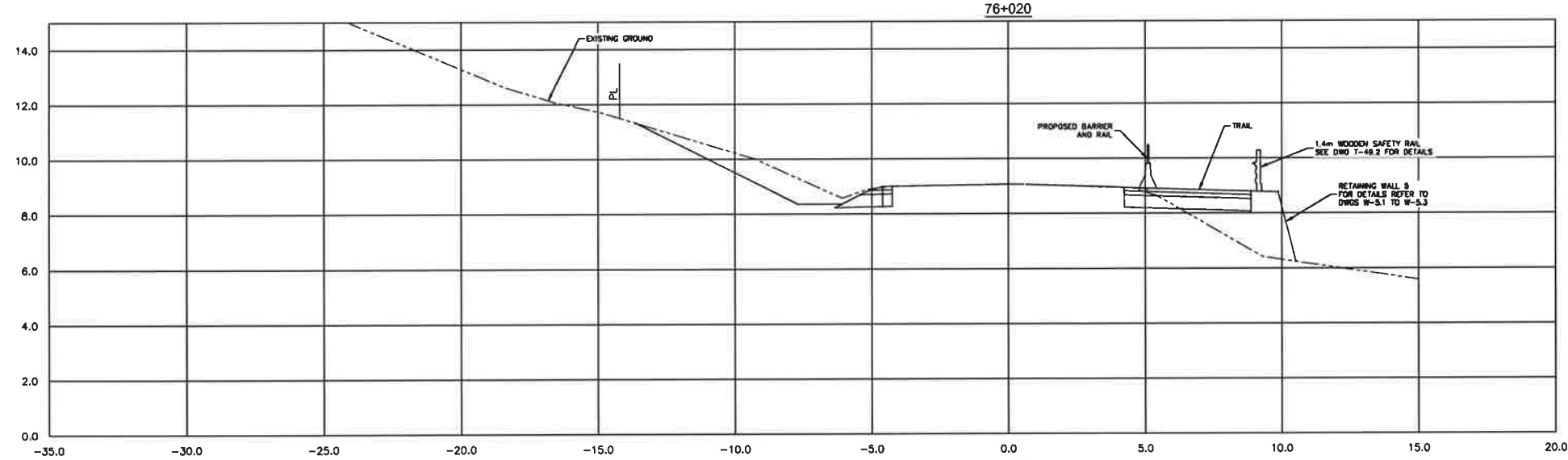
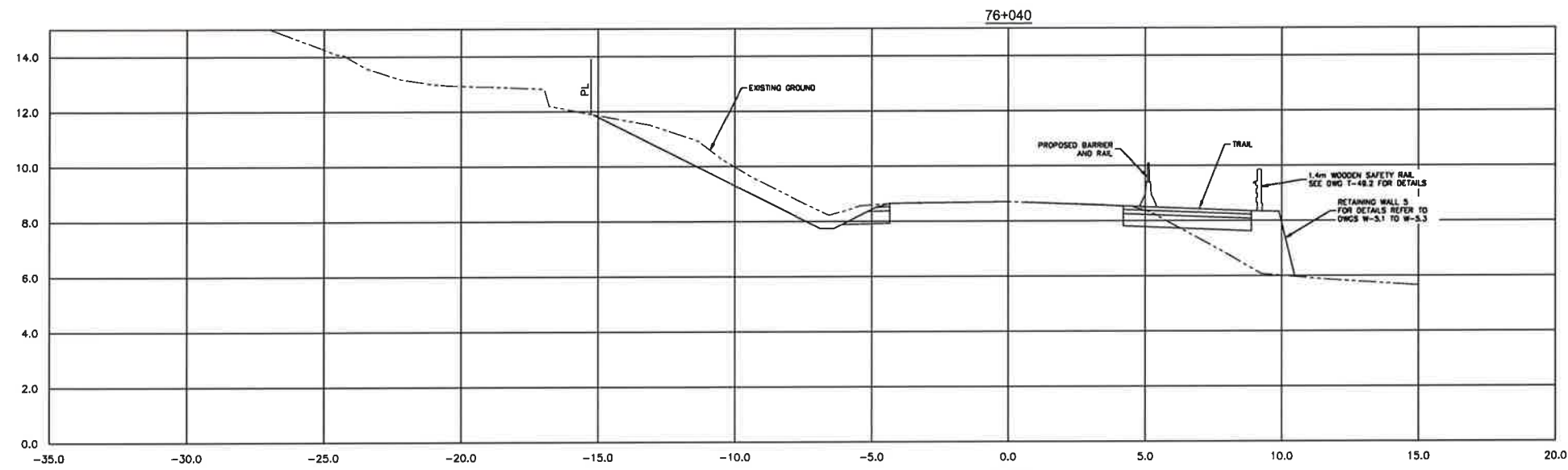

Revision/Description	Date/Date
1	ISSUED FOR TENDER 18/12/2018
0	ISSUED FOR TENDER 06/11/2017

Client/Client
Parks Canada L'Agence Parcs
Agency Canada
Western and Northern Region Ouest et Nord du Canada

Project title/Titre du projet
TOFINO
PACIFIC RIM
NATIONAL PARK RESERVE
?apscilik fasli
(Ups-cheek ta-shee)
"Going in the right direction on the trail"

Designed by/Conçue par
DON CHALMERS / 2017-08
Drawn by/Dessiné par
DAVID COX / 2017-11
PCA Project Manager/Technical Authority
Administrateur de Projets APC
JACKIE HICKS

Drawing title/Titre du dessin
?apscilik fasli (Ups-cheek ta-shee)
"Going in the right direction on the trail"
HIGHWAY 4 ESOWISTA CURVE
WIDENING - TYPICAL SECTIONS
STA 76+000 TO 76+040

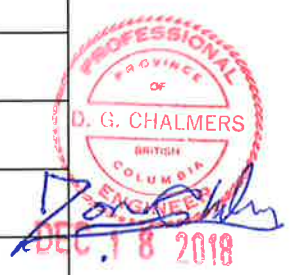

Project No./No. de projet PCA #1522	Sheet/Feuille HW-7.11	Revision no./ no. de révision 1
--	--------------------------	--

03/11/2018 10:51 AM - PROJECT: PACIFIC RIM NATIONAL PARK RESERVE - TOFINO - CURVE WIDENING - TYPICAL SECTIONS - STA 76+000 TO 76+040 - DRAWN BY: DON CHALMERS



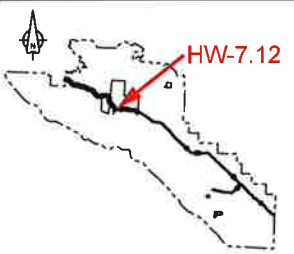
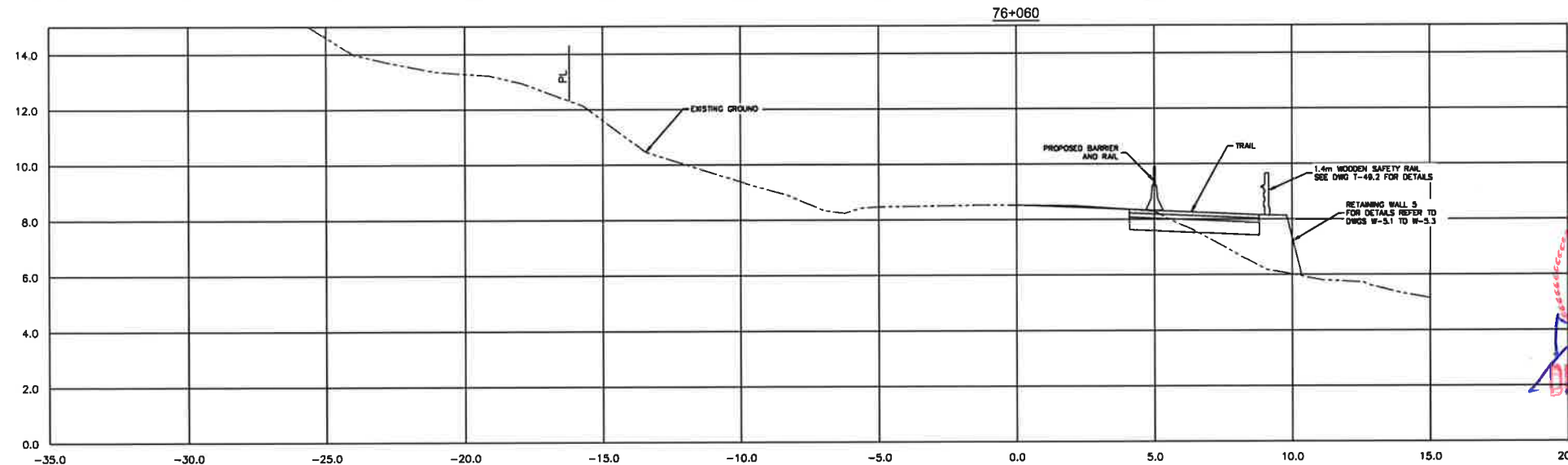
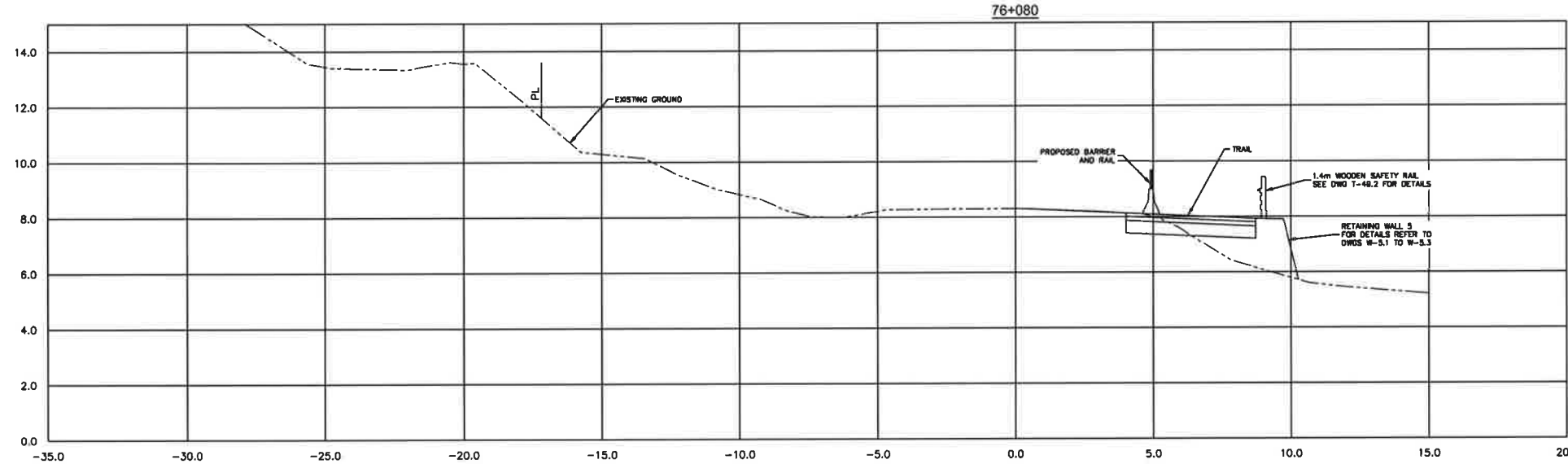
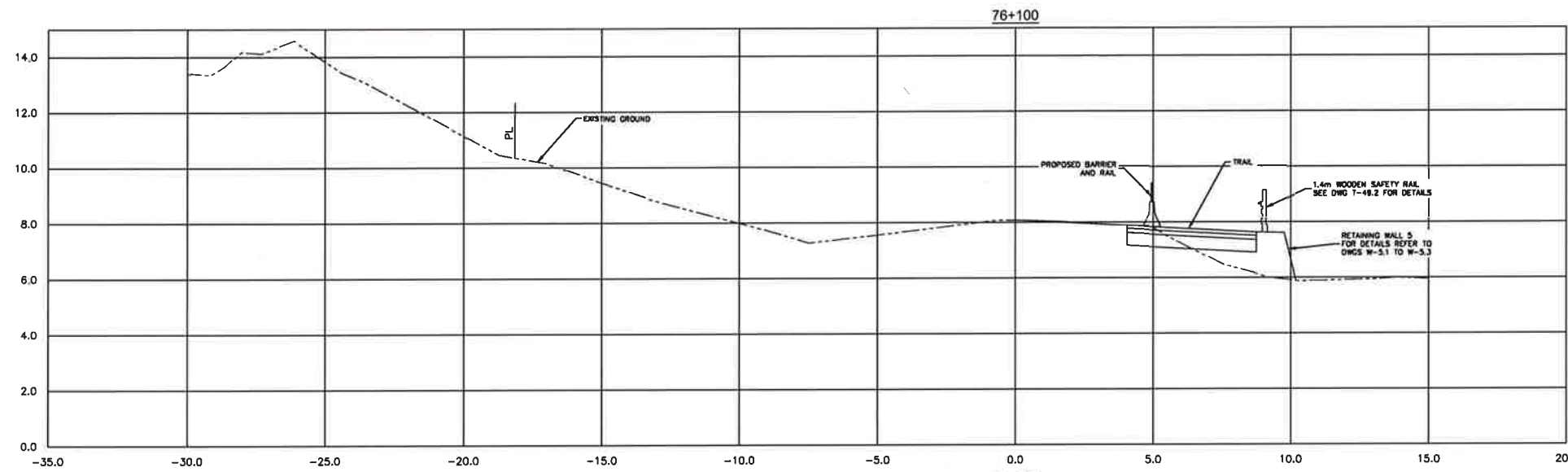

KEY PLAN
N.T.S.

1	ISSUED FOR TENDER	10/12/2016
2	ISSUED FOR TENDER	06/11/2017

Client/Client:
 Parks Canada / L'Agence Parcs
 Agency / Canada
 Western and Northern Region / Ouest et Nord du Canada

Projet /Titre du projet:
TOFINO
PACIFIC RIM NATIONAL PARK RESERVE
?apscilik fašii (Ups-cheek ta-shee)
"Going in the right direction on the trail"

Designed by/Conçue par:
 DON CHALMERS / 2017-06
 Drawn by/Dessiné par:
 DAVID COX / 2017-11
 PCA Project Manager/Responsable technique:
 Administrateur de Projets APC
 JACKIE HICKS



Drawing title/Titre du dessin:
?apscilik fašii (Ups-cheek ta-shee)
"Going in the right direction on the trail"
HIGHWAY 4 ESOWISTA CURVE
WIDENING - TYPICAL SECTIONS
 STA 76+060 TO 76+100

Project No./No. du projet:
 PCA #1522
 Sheet / Feuille:
HW-7.12
 Revision No./No. de Révision:
 1
 OF 19



0 L:\V\146371 - PACIFIC RIM NATIONAL PARK RESERVE - HW-7.12 - SHEETS - CROSS SECTIONS - REVISED - 2017\12\16 - 8:30 AM BY: PCHALMERS

PARSONS

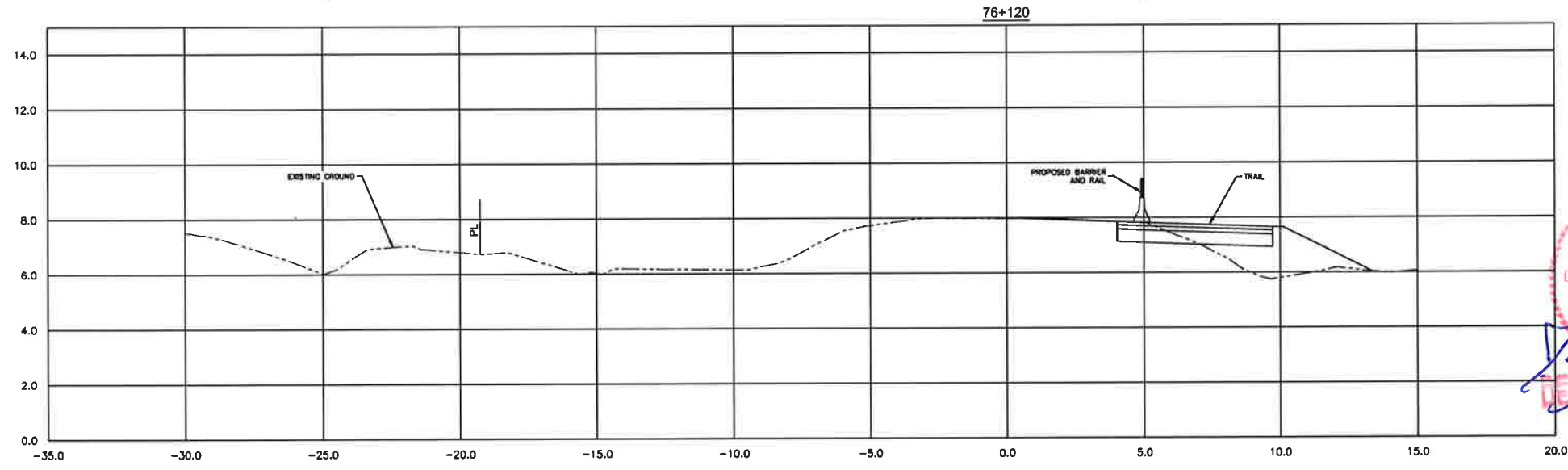
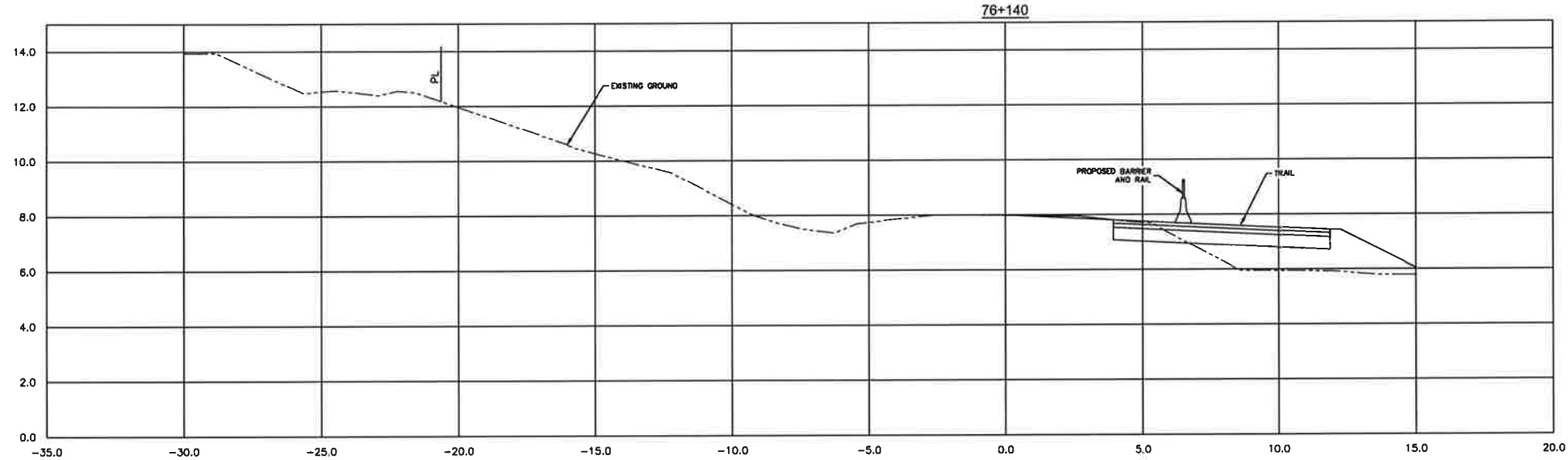
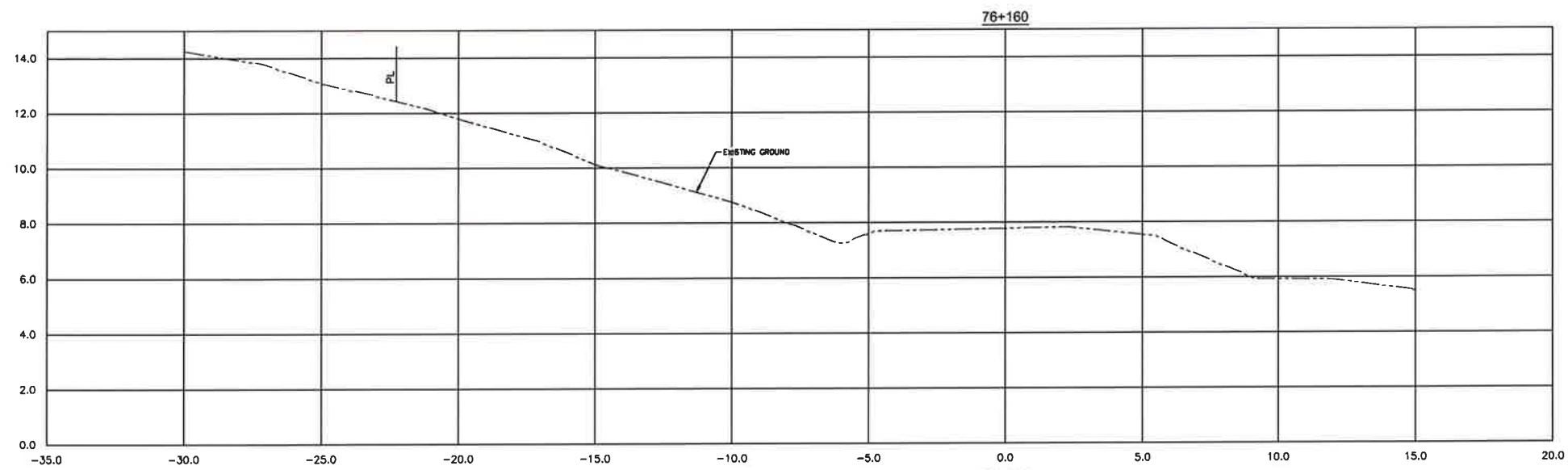

Version / Révision	Description / Description	Date / Date
1	ISSUED FOR TENDER	18/12/2018
0	ISSUED FOR TENDER	28/11/2017

Client / client
 Parks Canada L'Agence Parcs
 Agency Canada
 Western and Northern Region Ouest et Nord
 du Canada

Projet site/Titre du projet
TOFINO
PACIFIC RIM
NATIONAL PARK RESERVE
 ?apscilik tasii
 (Ups-cheek ta-shee)
 "Going in the right
 direction on the trail"

Designed by/Conçu par
 DON CHALMERS / 2017-06
 Drawn by/Dessiné par
 DAVID COX / 2017-11
 PCA Project Manager/Technical Authority
 Administrateur de Projets APC
 JACKIE HICKS

Drawing title/Titre du dessin
 ?apscilik tasii (Ups-cheek ta-shee)
 "Going in the right direction on the
 trail"
HIGHWAY 4 ESOWISTA CURVE
WIDENING - TYPICAL SECTIONS
 STA 76+120 TO 76+160

Project No./no. du projet PCA #1522	Sheet / feuille HW-7.13	Revision / révision 1
---	-----------------------------------	------------------------------------

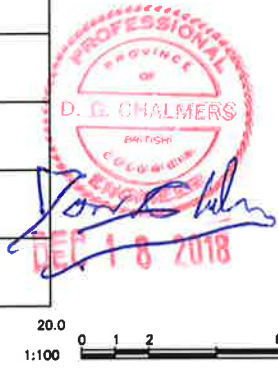

G:\V\161217 - PRCO 2014-17\WORKBOOKS\76+120 TO 76+160\17-11-SHEETS-CROSS SECTIONS\SECTION 76+140.DWG PLOTTED ON 2018/12/18 8:28 AM BY PCHALMERS