

PARSONS

NOTES:

1. LENGTH OF CULVERT TYPICALLY 8.0m. END OF CULVERT TO BE MAXIMUM 0.25 m FROM TOE OF SLOPE. LENGTH OF CULVERT MAY VARY ACCORDINGLY.
2. REMOVE ORGANICS UNDER PROPOSED CULVERT ALIGNMENT AND SUBEXCAVATE TO APPROVED SUBGRADE AS DIRECTED BY GEOTECHNICAL ENGINEER TO PLACE GRANULAR BEDDING.
3. MINIMUM 100 mm OF GRANULAR BEDDING TO SUPPORT CULVERT PER TYPICAL TRENCH DETAIL.
4. RIP RAP APRON TO BE CLASS 10 RIP RAP AT MINIMUM 300mm DEEP AT APRON AND AROUND CULVERT. APPROVED FISHERIES GRAVEL TO BE USED IN THE STREAMBED WHERE REQUIRED, AS DIRECTED BY THE DEPARTMENTAL REPRESENTATIVE.
5. COVER PROTRUDING CULVERT END WITH FILL AND VEGETATE AS DIRECTED BY THE DEPARTMENTAL REPRESENTATIVE.
6. FOR EROSION AND SEDIMENT ISSUES, INSTALL EROSION CONTROL BLANKETS WHERE NEEDED AS DIRECTED BY THE DEPARTMENTAL REPRESENTATIVE AND OWNERS'S ENVIRONMENTAL MONITOR.
7. IN-STREAM WORKS MAY PROCEED ONLY UNDER DFO APPROVAL. PERMIT TO BE SECURED BY THE DEPARTMENTAL REPRESENTATIVE AND OWNER'S ENVIRONMENTAL MONITOR.
8. WORKS WITHIN THE RIPARIAN AREA TO BE IN COMPLIANCE WITH THE ENVIRONMENTAL PROCEDURES SPECIFICATION 01-35-43.
9. FOR CULVERT LOCATIONS REFER TO DRAWINGS D-1 & D-2.
10. AMPHIBIAN MODIFIED CULVERTS NOTED IN DRAWINGS D-1 & D-2 TO BE FILLED WITH NATIVE SOIL INSTEAD OF SPAWNING GRAVEL AND POSITIONED TO ENCOURAGE AMPHIBIAN PASSAGE AS DIRECTED BY DEPARTMENTAL REPRESENTATIVE AND OWNER'S ENVIRONMENTAL MONITOR. AMPHIBIAN MODIFIED CULVERTS WITH A DIAMETER OF 600mm TO BE FILLED WITH 200mm OF NATIVE SOIL TO ACHIEVE A MINIMUM CLEARANCE OF 400mm. AMPHIBIAN CULVERTS WITH A DIAMETER GREATER THAN 600mm TO BE FILLED WITH 300mm OF NATIVE SOIL.

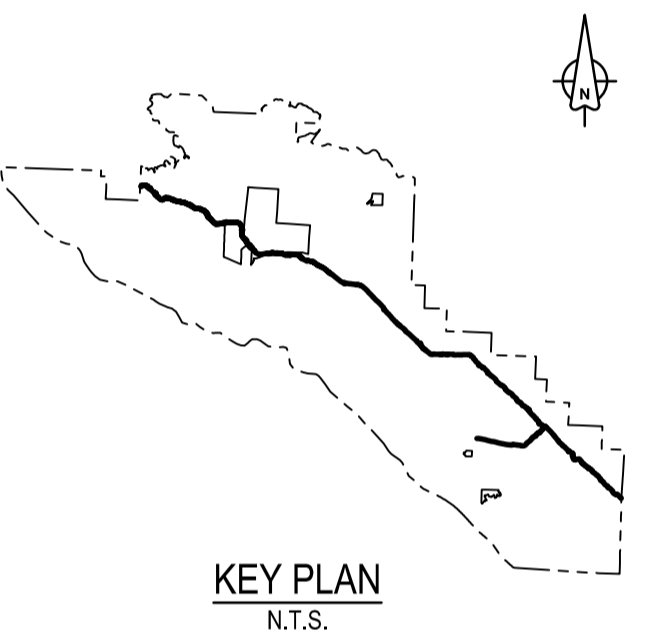
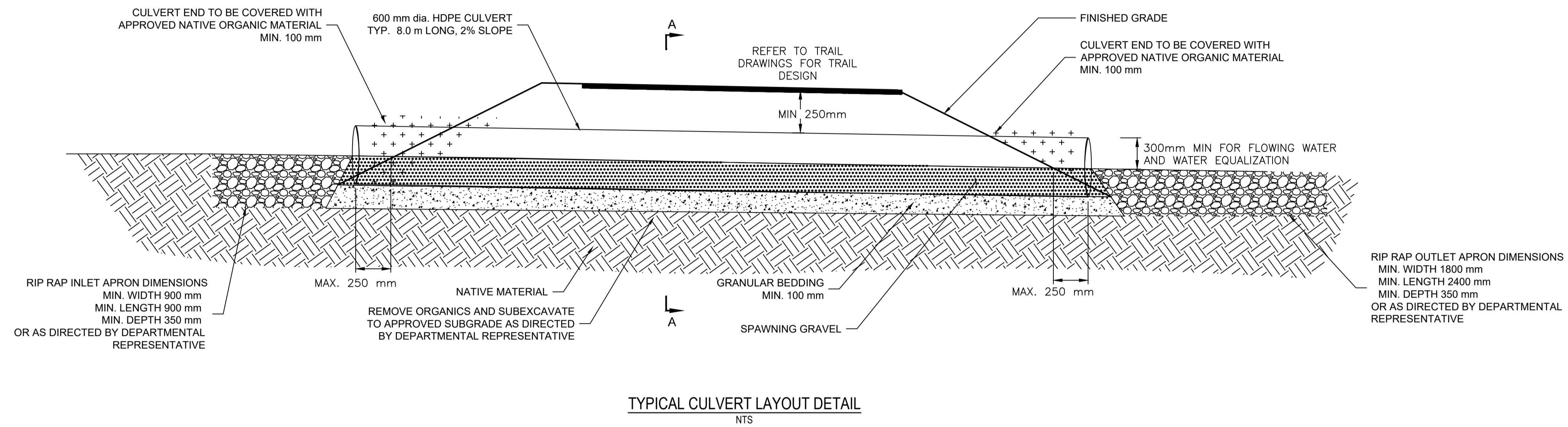

Revision/	Description/Description	Date/Date
2	ISSUED FOR TENDER	18/12/2016
1	ISSUED FOR TENDER	30/11/2017
0	ISSUED FOR TENDER	27/10/2017

Client/client
Parks Canada L'Agence Parcs
Agency Canada
Western and Northern Region Ouest et Nord du Canada

Project title/Titre du projet
**TOFINO
PACIFIC RIM
NATIONAL PARK RESERVE
?apsciiik tašii
(Ups-cheek ta-shee)
"Going in the right
direction on the trail"**

Consultant Signature Only
Designed by/Concept par
ALEX MCBRIDE / 2017-03-10
Drawn by/Dessiné par
DAVID COX / 2017-03-11
PCA Project Manager/Technical Authority
Administrateur de Projets APC
JACKIE HICKS

Drawing title/Titre du dessin
**?apsciiik tašii (Ups-cheek ta-shee)
"Going in the right direction on the
trail"
TRAIL DESIGN
TYPICAL HDPE CULVERT DETAIL**

Project No./No. du projet PCA #1522	Sheet/Feuille D-5 OF	Revision no./La Révision no. 2
---	-----------------------------------	--

