

PARSONS

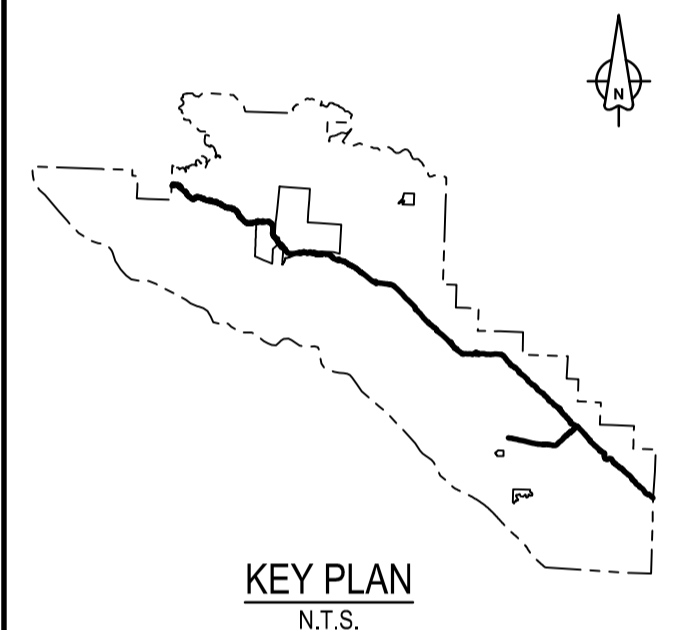

Revision/	Description/Description	Date/Date
3	ISSUED FOR TENDER	08/12/2016
2	ISSUED FOR TENDER	09/11/2016
1	ISSUED FOR TENDER	06/11/2017
0	ISSUED FOR TENDER	07/10/2017

Client/client
Parks Canada L'Agence Parcs
Agency Canada
Western and Northern Region Ouest et Nord du Canada

Project title/Titre du projet
**TOFINO
PACIFIC RIM
NATIONAL PARK RESERVE
ᑭᐱᓂᓕᓴᓴ ᓂᓱᓴᓴ
(Ups-cheek ta-shee)
"Going in the right
direction on the trail"**

Designed by/Concept par
DON CHALMERS / 2017-10
Drawn by/Dessiné par
DAVID COX / 2017-10
PCA Project Manager/Technical Authority
Administrateur de Projets APC
JACKIE HICKS

Drawing title/Titre du dessin
**ᑭᐱᓂᓕᓴᓴ ᓂᓱᓴᓴ (Ups-cheek ta-shee)
"Going in the right direction on the
trail"
TRAIL DESIGN
TEMPORARY ACCESS POINTS**

Project No./No. du projet PCA #1522	Sheet/Fauille D-9 OF	Revision no./ La Révision no. 3
---	-----------------------------------	--

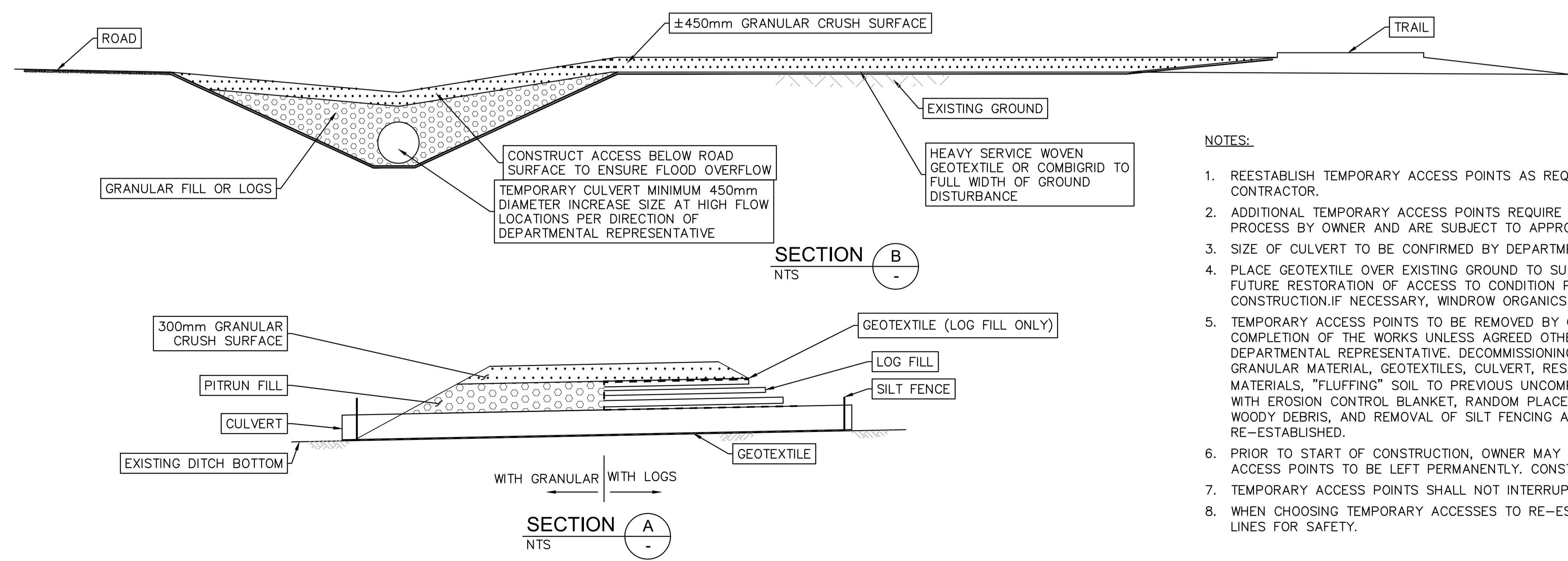
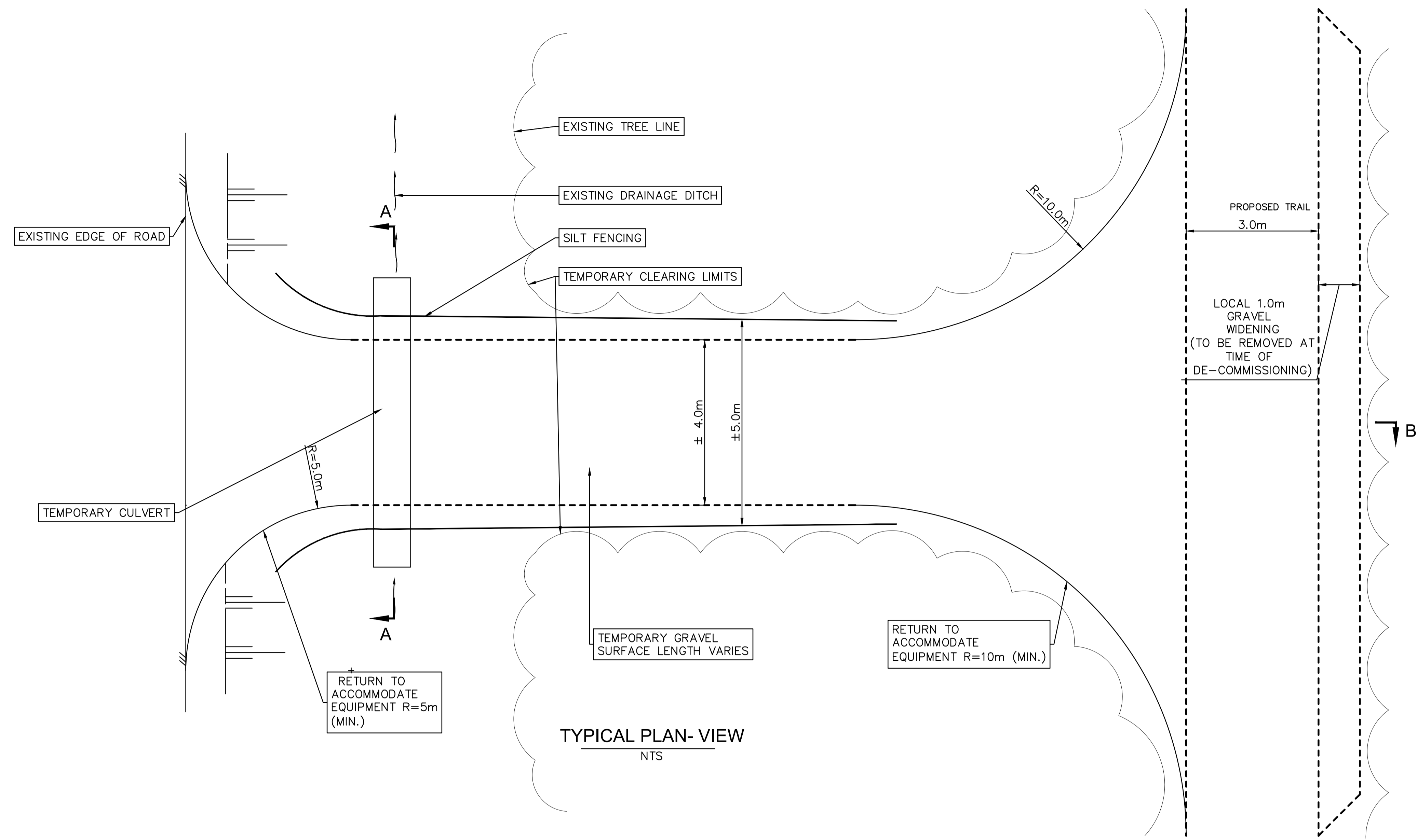

- NOTES:
1. REESTABLISH TEMPORARY ACCESS POINTS AS REQUIRED. CLEARED BY PREVIOUS CONTRACTOR.
 2. ADDITIONAL TEMPORARY ACCESS POINTS REQUIRE UP TO 30 DAY REVIEW PROCESS BY OWNER AND ARE SUBJECT TO APPROVAL.
 3. SIZE OF CULVERT TO BE CONFIRMED BY DEPARTMENTAL REPRESENTATIVE.
 4. PLACE GEOTEXTILE OVER EXISTING GROUND TO SUPPORT TRAFFIC AND AID IN FUTURE RESTORATION OF ACCESS TO CONDITION PRIOR TO ANY CONSTRUCTION. IF NECESSARY, WINDROW ORGANICS TO SIDE. DO NOT REMOVE.
 5. TEMPORARY ACCESS POINTS TO BE REMOVED BY CONTRACTOR UPON COMPLETION OF THE WORKS UNLESS AGREED OTHERWISE BY THE DEPARTMENTAL REPRESENTATIVE. DECOMMISSIONING WILL INCLUDE: REMOVAL OF GRANULAR MATERIAL, GEOTEXTILES, CULVERT, RESPREADING OF ANY WINDROWED MATERIALS, "FLUFFING" SOIL TO PREVIOUS UNCOMPACTED DENSITY, COVERING WITH EROSION CONTROL BLANKET, RANDOM PLACEMENT OF LOGS AND LARGE WOODY DEBRIS, AND REMOVAL OF SILT FENCING AFTER THE AREA IS RE-ESTABLISHED.
 6. PRIOR TO START OF CONSTRUCTION, OWNER MAY DESIGNATE SOME TEMPORARY ACCESS POINTS TO BE LEFT PERMANENTLY. CONSTRUCT TO TRAIL STANDARDS.
 7. TEMPORARY ACCESS POINTS SHALL NOT INTERRUPT OVERLAND FLOOD PATHS.
 8. WHEN CHOOSING TEMPORARY ACCESSES TO RE-ESTABLISH. CONSIDER SITE LINES FOR SAFETY.

D:\N\03121 - PWGSC - 2016-10-19\PALETTE TRAVERSE TRAIL\DWG\03121-PTT-SHEET D-9 TEMPORARY ACCESS POINTS BLDG.WG PLOTTED ON 2016/12/17 2:49pm BY 000429C