

PARSONS

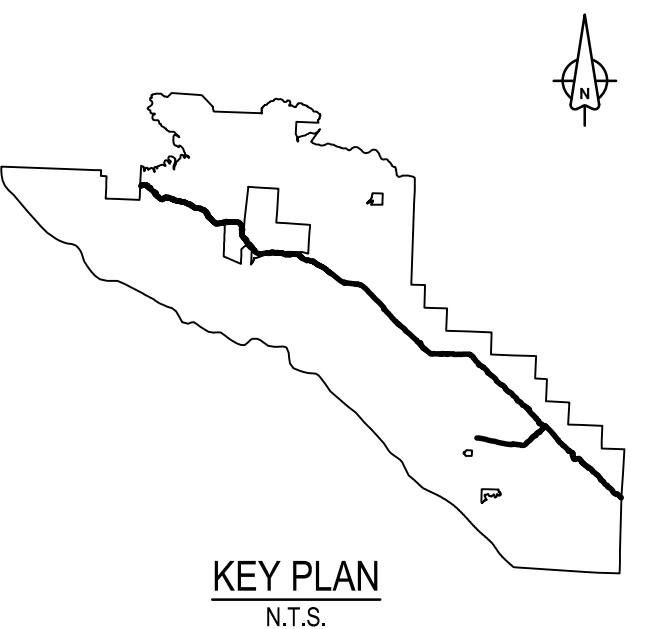

Revision/	Description/Description	Date/Date
2	ISSUED FOR TENDER	18/12/2014
1	ISSUED FOR TENDER	30/11/2017
0	ISSUED FOR TENDER	27/10/2017

Client/client
Parks Canada Agency L'Agence Parcs Canada Western and Northern Region Ouest et Nord du Canada

Project title/Titre du projet
TOFINO
PACIFIC RIM NATIONAL PARK RESERVE
ʔapsc̓iik tašii
“Going in the right direction on the trail”

Designed by/Concept par
 ALEX MCBRIDE / 2017-03-10
 Drawn by/Dessiné par
 DAVID COX / 2017-03-11
 PCA Project Manager/Technical Authority
 Administrateur de Projets APC
 JACKIE HICKS

Drawing title/Titre du dessin
ʔapsc̓iik tašii (Ups-cheek ta-shee)
“Going in the right direction on the trail”
TRAIL DESIGN
 TYPICAL DITCH CONNECTION DETAIL

Project No./No. du projet	Sheet/Feuille	Revision no./La Révision no.
PCA #1522	D-6 OF	2

NOTES:

1. TYPICAL DITCH DETAIL TO BE USED WHERE CULVERT OUTLET MUST BE TIED IN TO EXISTING CHANNEL.
2. D = DIAMETER OF CULVERT UPSTREAM. DITCH GEOMETRY TO BE DEFINED RELATIVE TO D AS INDICATED ON THE DETAIL, OR AS DIRECTED BY THE DEPARTMENTAL REPRESENTATIVE.
3. REUSE EXCAVATED MATERIAL TO SHAPE SLOPES OF CHANNEL. MATCH EXISTING CHANNEL GEOMETRY WHERE THE NEW DITCH ALIGNMENT CONNECTS TO THE EXISTING DITCH.
4. WHERE REQUIRED, APPROVED FISHERIES GRAVEL TO BE USED INSTEAD OF GRANULAR MATERIAL IN THE DITCH AS DIRECTED BY THE DEPARTMENTAL REPRESENTATIVE AND OWNER'S ENVIRONMENTAL MONITOR.
5. DISTURBED AREAS TO BE COVERED IN COCONUT EROSION CONTROL MATTING ABOVE THE HIGH WATER MARK AS DIRECTED BY DEPARTMENTAL REPRESENTATIVE AND OWNER'S ENVIRONMENTAL MONITOR.
6. IN-STREAM WORKS MAY PROCEED ONLY UNDER DFO APPROVAL IF REQUIRED. PERMIT TO BE SECURED BY THE DEPARTMENTAL REPRESENTATIVE.
7. WORKS WITHIN THE RIPARIAN AREA TO BE IN COMPLIANCE WITH THE ENVIRONMENTAL PROCEDURES SPECIFICATION 01-35-43.

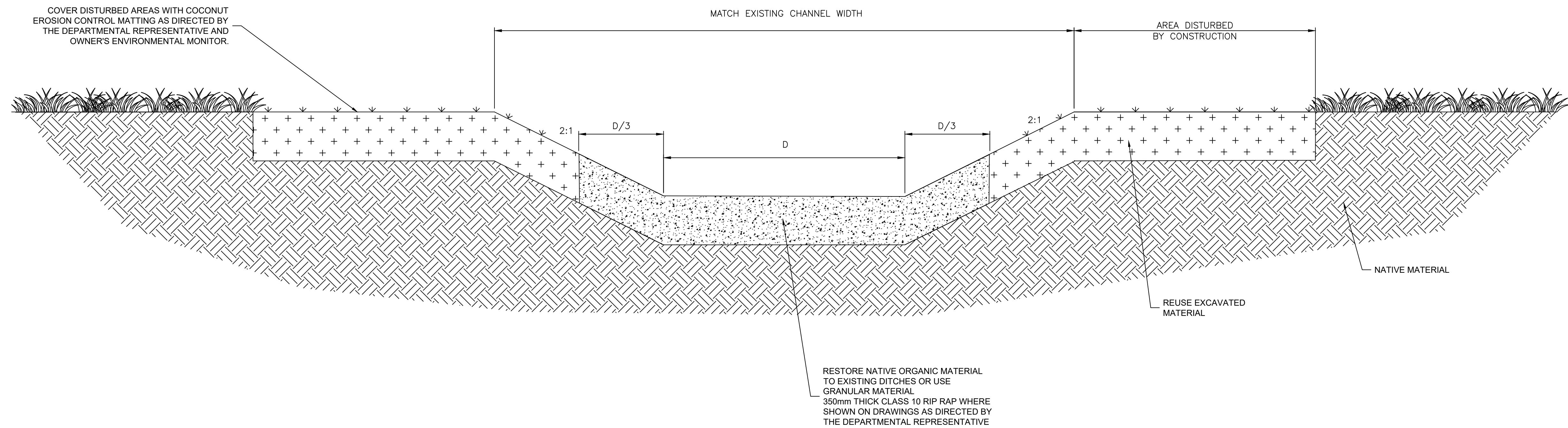

TYPICAL DITCH SECTION DETAIL
 N.T.S.

