



RETURN BIDS TO:

RETOURNER LES SOUMISSIONS À:

Travaux publics et Services gouvernementaux
Canada

Place Bonaventure, portail Sud-Oue

800, rue de La Gauchetière Ouest

7^e étage, suite 7300

Montréal

Québec

H5A 1L6

FAX pour soumissions: (514) 496-3822

**SOLICITATION AMENDMENT
MODIFICATION DE L'INVITATION**

The referenced document is hereby revised; unless otherwise indicated, all other terms and conditions of the Solicitation remain the same.

Ce document est par la présente révisé; sauf indication contraire, les modalités de l'invitation demeurent les mêmes.

Comments - Commentaires

Vendor/Firm Name and Address

Raison sociale et adresse du
fournisseur/de l'entrepreneur

Issuing Office - Bureau de distribution

Travaux publics et Services gouvernementaux Canada

Place Bonaventure, portail Sud-Oue

800, rue de La Gauchetière Ouest

7^e étage, suite 7300

Montréal

Québec

H5A 1L6

Title - Sujet Cloisons Grillagées	
Solicitation No. - N° de l'invitation W0106-18S036/A	Amendment No. - N° modif. 001
Client Reference No. - N° de référence du client W0106-18S036	Date 2019-05-02
GETS Reference No. - N° de référence de SEAG PW-\$MTA-225-15318	
File No. - N° de dossier MTA-8-41376 (225)	CCC No./N° CCC - FMS No./N° VME
Solicitation Closes - L'invitation prend fin at - à 02:00 PM on - le 2019-06-05	
Time Zone Fuseau horaire Heure Avancée de l'Est HAE	
F.O.B. - F.A.B. Plant-Usine: <input type="checkbox"/> Destination: <input type="checkbox"/> Other-Autre: <input type="checkbox"/>	
Address Enquiries to: - Adresser toutes questions à: Dubé, Stéphane	Buyer Id - Id de l'acheteur mta225
Telephone No. - N° de téléphone (514) 603-9967 ()	FAX No. - N° de FAX (514) 496-3822
Destination - of Goods, Services, and Construction: Destination - des biens, services et construction:	

Instructions: See Herein

Instructions: Voir aux présentes

Delivery Required - Livraison exigée	Delivery Offered - Livraison proposée
Vendor/Firm Name and Address Raison sociale et adresse du fournisseur/de l'entrepreneur	
Telephone No. - N° de téléphone Facsimile No. - N° de télécopieur	
Name and title of person authorized to sign on behalf of Vendor/Firm (type or print) Nom et titre de la personne autorisée à signer au nom du fournisseur/ de l'entrepreneur (taper ou écrire en caractères d'imprimerie)	
Signature	Date

AMENDMENT 001

The purpose of this amendment to publish the following:

- Partitions plans
- Product specifications

Product specifications

	<ul style="list-style-type: none"> • 14 gauge steel • Painted steel 	<ul style="list-style-type: none"> • SH <ul style="list-style-type: none"> ◦ Tubular "T" shape, 1 1/4" wide face and 2" deep. ◦ Two types of perforations on the sides, at every 1" c/c: square in order to fasten shelf clips and round for panels and other accessories. ◦ Complete with round holes every 12" c/c on the face for fastening braces, panels and other accessories. • SR <ul style="list-style-type: none"> ◦ Same post as the SH but with additional trapezoidal perforations on the face for attaching beams and other accessories. 	<ul style="list-style-type: none"> • Hollow center of the Spider post allows for installation of juxtaposed accessories at the same height. • Same post is used at the front and at the back. • Can serve as common post thanks to its symmetrical shape. • Shelves are fixed to the post and are adjustable every 1" c/c. • SR <ul style="list-style-type: none"> ◦ Can serve as common post in applications with shelving, Mini-racking and multi-level shelving or a combination of all three. 	<p>Varies depending on the layout and the components being used. Contact Customer Service.</p>	<p>Heights: 39", 51", 75", 87", 99", 111" & 123"</p>
	<ul style="list-style-type: none"> • 18 gauge steel • Painted steel 	<ul style="list-style-type: none"> • Fabricated with single fold on one side and double on the other side. • 4 embossed areas with holes in order to install on posts. • Single brace used for depths 15" to 24", double brace used for depth 30" to 48 1/2". 	<ul style="list-style-type: none"> • Can be welded or bolted to post 	<p>N/A</p>	<p>Height: 4 3/4" (Mini-racking depth once assembled 15" to 24": nominal dim. + 1/4" 30" to 48 1/2": nominal dim. + 1/2"</p>
	<ul style="list-style-type: none"> • 12 gauge steel • Painted steel 	<ul style="list-style-type: none"> • Open "C" channels fabricated with folds in such a manner as to allow for different decking (steel shelves or wood top) • Face height: 2 1/2" offers a higher load capacity. • Have 2 hooks on each extremity to install beams on posts. • Adjustable every 2" c/c. • Lower fold has 5 rectangular holes for insertion of tie bars • Beams are locked into place with security fasteners which prevent beams from coming off the posts 	<ul style="list-style-type: none"> • 2 beams can be installed side-by-side in the trapezoid perforations on the face of the posts for an installation of two units in a row. • Label holder can be used. 	<p>From 1225 lb to 1925 lb depending on the decking (refer to chart in general brochure).</p>	<p>Widths: according to mini-racking. Widths: according to mini-racking for 96" uncut wood panel.</p>
	<ul style="list-style-type: none"> • 14 gauge galvanized steel 	<ul style="list-style-type: none"> • Formed in a "C" fold with 2 hooks (to fasten to beams) • Is installed between the front and back beams. 	<ul style="list-style-type: none"> • No tools required for installation. 	<p>Refer to chart in general brochure.</p>	<p>Width: 1" Depths: according to mini-racking. Height: 1 11/16"</p>
	<ul style="list-style-type: none"> • 20 gauge steel • Painted steel 	<ul style="list-style-type: none"> • Front and back folds form structural beams (3/4"W x 1 1/4"H), closed by welding at every 4" c/c. • Sides are made with single folds 1 1/4" H. • Perforations on the sides of the shelves are for bolting side reinforcers or bolting to the posts. • Perforations in the front for the insertion of front reinforcers and for corner gussets • Top of shelf perforated at every 3" c/c for insertion of partial shelf dividers and shelf dividers 	<ul style="list-style-type: none"> • Shelves are made of structural steel (40 grade according to ASTM A 1008). • Shelf can be bolted in place to prevent accidental lifting. 	<p>Varies depending on the dimension of the shelf and the addition of reinforcers. Refer to chart in general brochure S01.</p>	<p>Widths: nominal dim. - 1/2" Depths: nominal dim. - 1/4"</p>

N° de l'invitation - Solicitation No.
W0106-18S036/A
N° de réf. du client - Client Ref. No.
W0106-18S036

N° de la modif - Amd. No.
001
File No. - N° du dossier
MTA-8-41376

Id de l'acheteur - Buyer ID
MTA225
N° CCC / CCC No./ N° VME - FMS

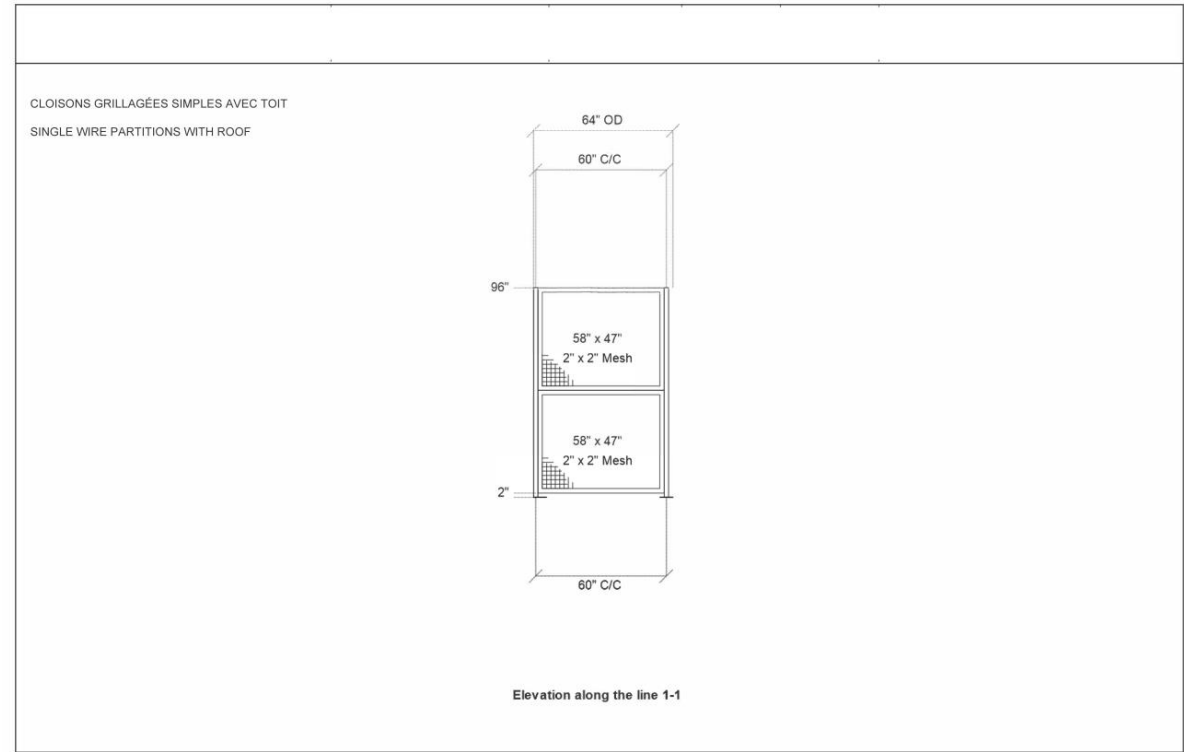
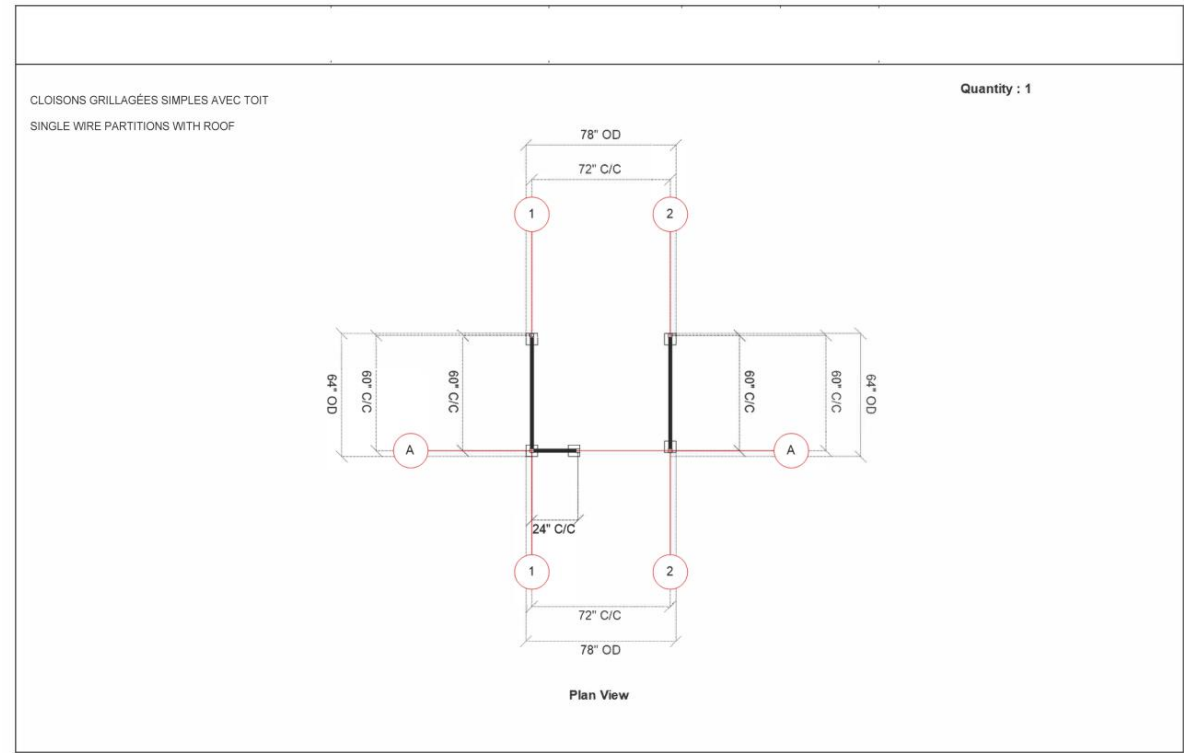

N° de l'invitation - Solicitation No.
W0106-18S036/A
N° de réf. du client - Client Ref. No.
W0106-18S036

N° de la modif - Amd. No.
001
File No. - N° du dossier
MTA-8-41376

Id de l'acheteur - Buyer ID
MTA225
N° CCC / CCC No./ N° VME - FMS

CLOISONS GRILLAGÉES SIMPLES AVEC TOIT
SINGLE WIRE PARTITIONS WITH ROOF

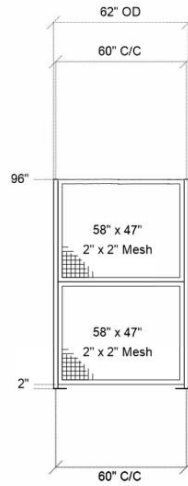

Elevation along the line 2-2

CLOISONS GRILLAGÉES SIMPLES AVEC TOIT
SINGLE WIRE PARTITIONS WITH ROOF

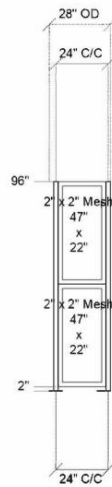

Elevation along the line A-A

N° de l'invitation - Solicitation No.
W0106-18S036/A
N° de réf. du client - Client Ref. No.
W0106-18S036

N° de la modif - Amd. No.
001
File No. - N° du dossier
MTA-8-41376

Id de l'acheteur - Buyer ID
MTA225
N° CCC / CCC No./ N° VME - FMS

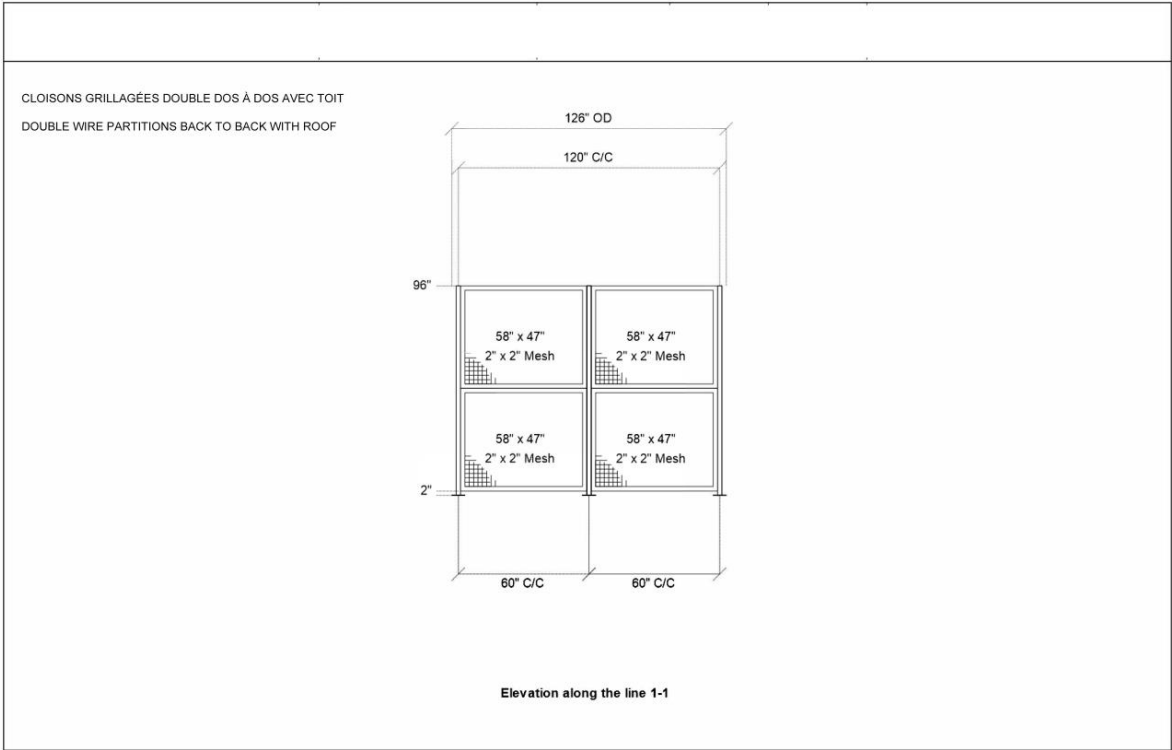
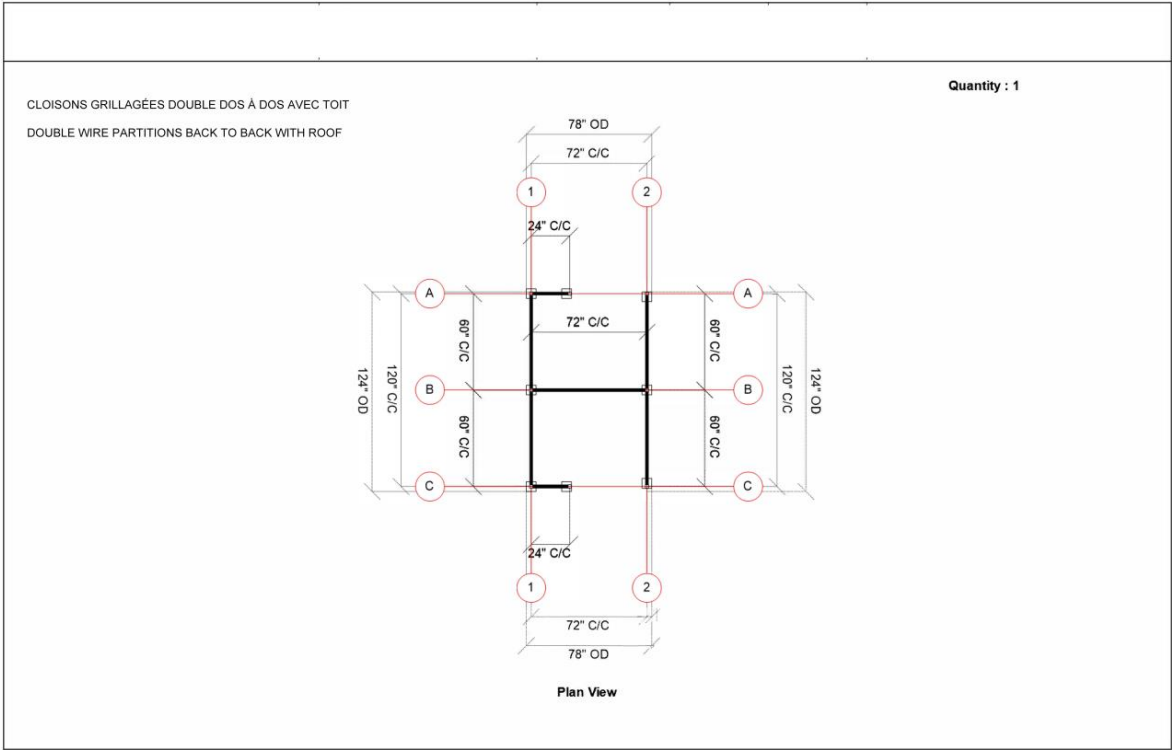

N° de l'invitation - Solicitation No.
W0106-18S036/A
N° de réf. du client - Client Ref. No.
W0106-18S036

N° de la modif - Amd. No.
001
File No. - N° du dossier
MTA-8-41376

Id de l'acheteur - Buyer ID
MTA225
N° CCC / CCC No./ N° VME - FMS

CLOISONS GRILLAGÉES DOUBLE DOS À DOS AVEC TOIT
DOUBLE WIRE PARTITIONS BACK TO BACK WITH ROOF

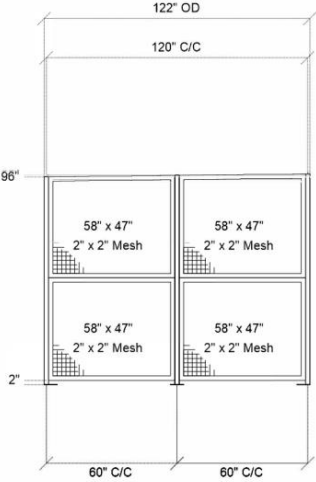

Elevation along the line 2-2

CLOISONS GRILLAGÉES DOUBLE DOS À DOS AVEC TOIT
DOUBLE WIRE PARTITIONS BACK TO BACK WITH ROOF

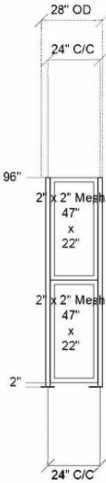

Elevation along the line A-A

N° de l'invitation - Solicitation No.
W0106-18S036/A
N° de réf. du client - Client Ref. No.
W0106-18S036

N° de la modif - Amd. No.
001
File No. - N° du dossier
MTA-8-41376

Id de l'acheteur - Buyer ID
MTA225
N° CCC / CCC No./ N° VME - FMS

CLOISONS GRILLAGÉES DOUBLE DOS À DOS AVEC TOIT
DOUBLE WIRE PARTITIONS BACK TO BACK WITH ROOF

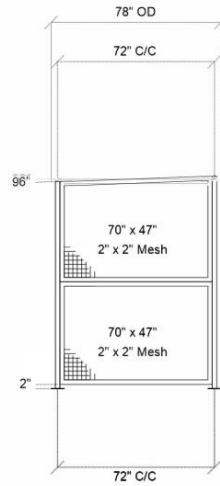

Elevation along the line B-B

CLOISONS GRILLAGÉES DOUBLE DOS À DOS AVEC TOIT
DOUBLE WIRE PARTITIONS BACK TO BACK WITH ROOF

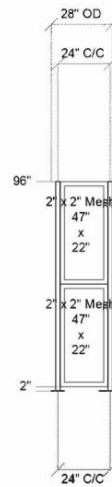

Elevation along the line C-C

N° de l'invitation - Sollicitation No.
W0106-18S036/A
N° de réf. du client - Client Ref. No.
W0106-18S036

N° de la modif - Amd. No.
001
File No. - N° du dossier
MTA-8-41376

Id de l'acheteur - Buyer ID
MTA225
N° CCC / CCC No./ N° VME - FMS

CLOISONS GRILLAGÉES DOUBLE CÔTE À CÔTE AVEC TOIT
DOUBLE WIRE PARTITIONS SIDE BY SIDE WITH ROOF

Quantity : 1

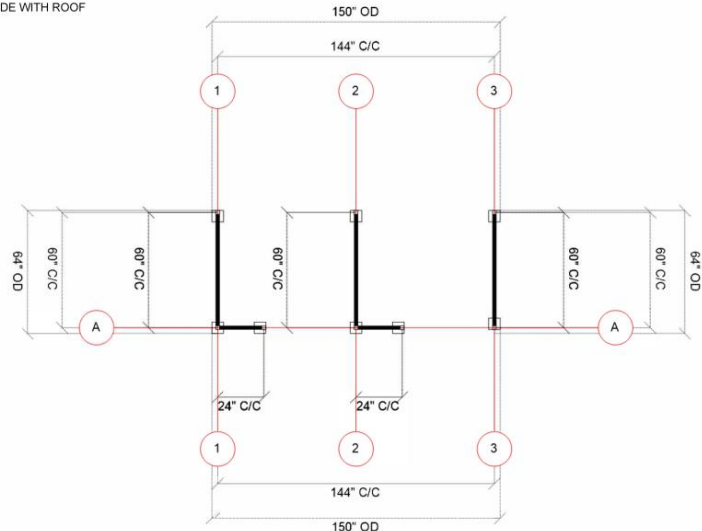

Plan View

CLOISONS GRILLAGÉES DOUBLE CÔTE À CÔTE AVEC TOIT
DOUBLE WIRE PARTITIONS SIDE BY SIDE WITH ROOF

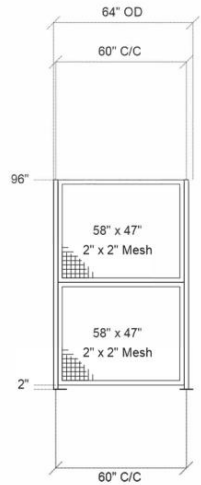

Elevation along the line 1-1

N° de l'invitation - Solicitation No.
W0106-18S036/A
N° de réf. du client - Client Ref. No.
W0106-18S036

N° de la modif - Amd. No.
001
File No. - N° du dossier
MTA-8-41376

Id de l'acheteur - Buyer ID
MTA225
N° CCC / CCC No./ N° VME - FMS

CLOISONS GRILLAGÉES DOUBLE CÔTE À CÔTE AVEC TOIT
DOUBLE WIRE PARTITIONS SIDE BY SIDE WITH ROOF

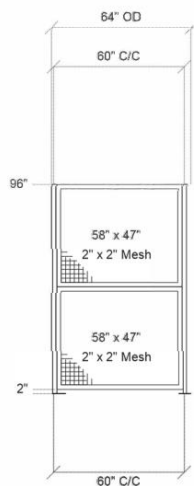

Elevation along the line 2-2

CLOISONS GRILLAGÉES DOUBLE CÔTE À CÔTE AVEC TOIT
DOUBLE WIRE PARTITIONS SIDE BY SIDE WITH ROOF

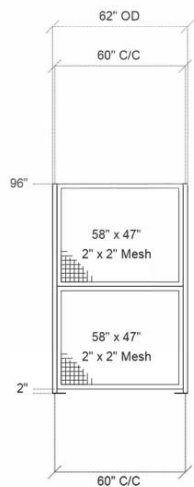

Elevation along the line 3-3

N° de l'invitation - Solicitation No.
W0106-18S036/A
N° de réf. du client - Client Ref. No.
W0106-18S036

N° de la modif - Amd. No.
001
File No. - N° du dossier
MTA-8-41376

Id de l'acheteur - Buyer ID
MTA225
N° CCC / CCC No./ N° VME - FMS

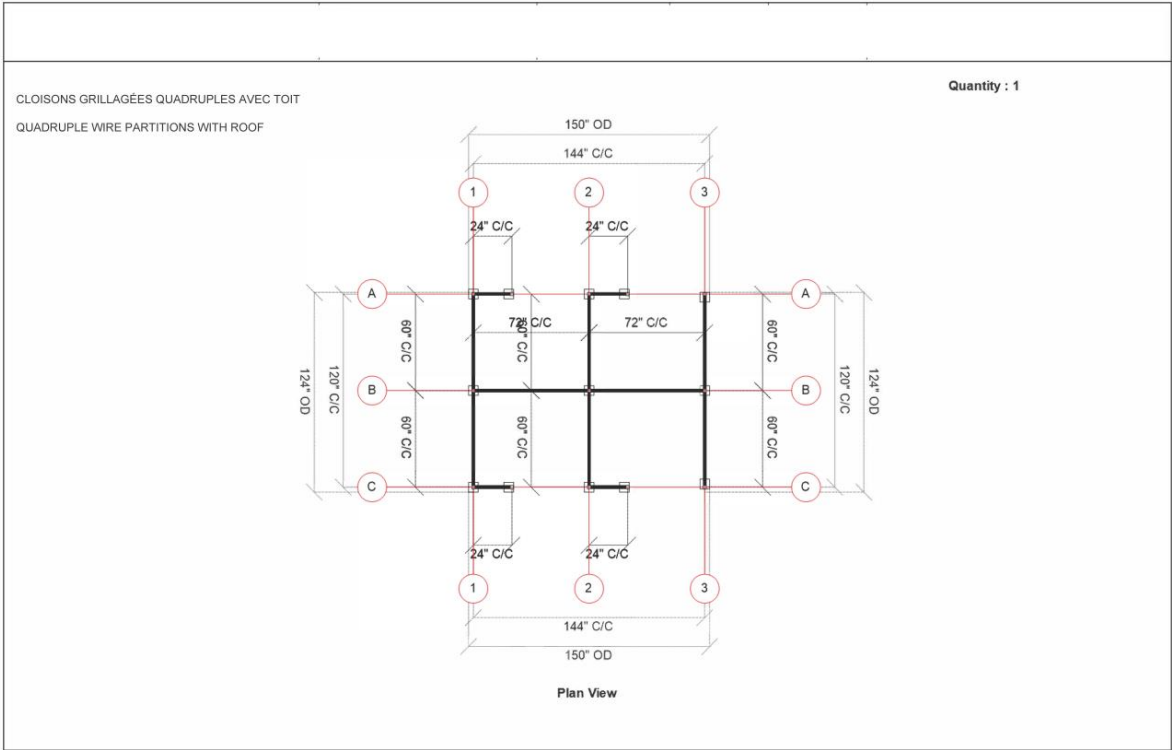
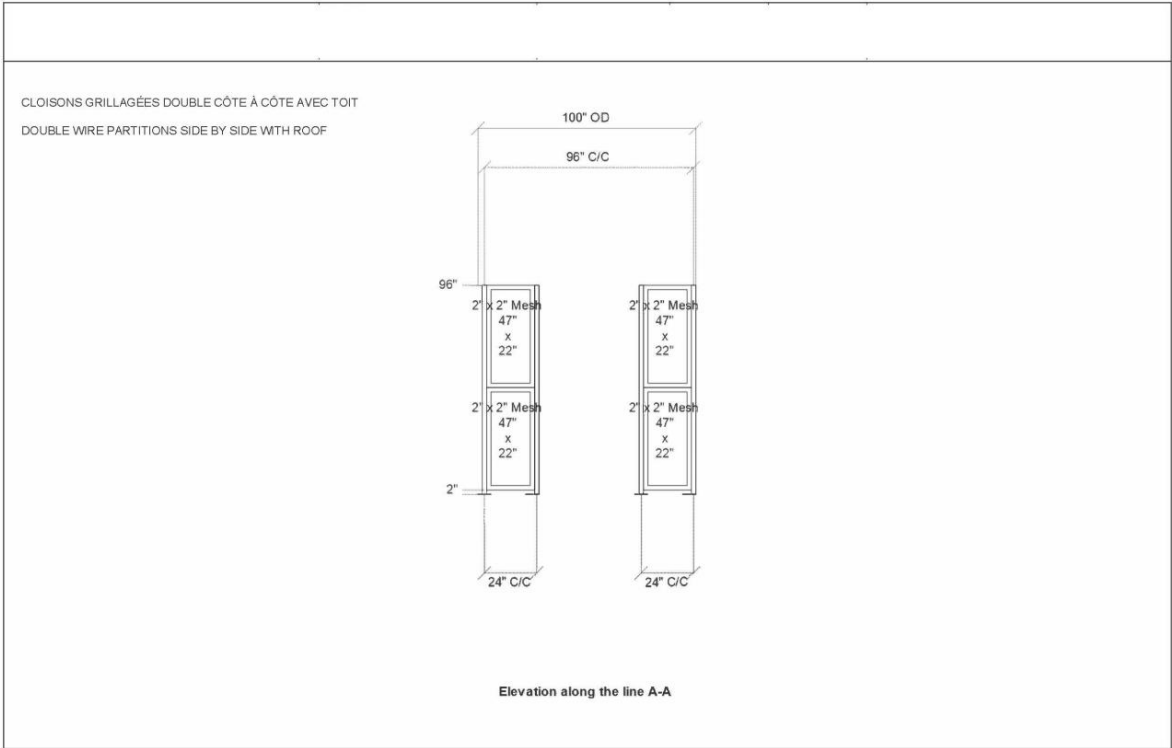

N° de l'invitation - Solicitation No.
W0106-18S036/A
N° de réf. du client - Client Ref. No.
W0106-18S036

N° de la modif - Amd. No.
001
File No. - N° du dossier
MTA-8-41376

Id de l'acheteur - Buyer ID
MTA225
N° CCC / CCC No./ N° VME - FMS

CLOISONS GRILLAGÉES QUADRUPLES AVEC TOIT
QUADRUPLE WIRE PARTITIONS WITH ROOF

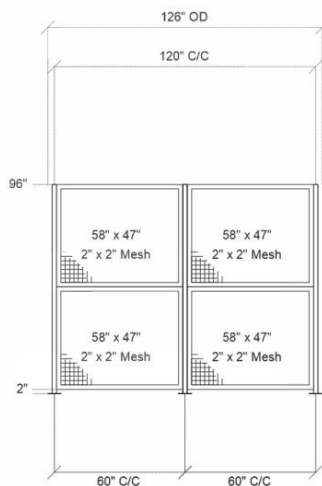

Elevation along the line 1-1

CLOISONS GRILLAGÉES QUADRUPLES AVEC TOIT
QUADRUPLE WIRE PARTITIONS WITH ROOF

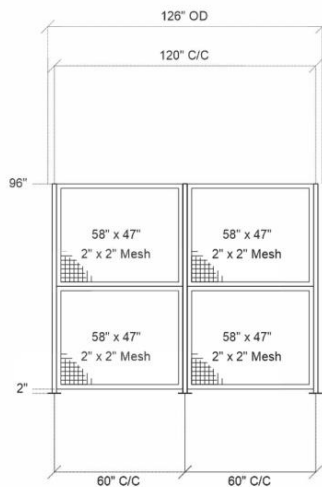

Elevation along the line 2-2

N° de l'invitation - Solicitation No.
W0106-18S036/A
N° de réf. du client - Client Ref. No.
W0106-18S036

N° de la modif - Amd. No.
001
File No. - N° du dossier
MTA-8-41376

Id de l'acheteur - Buyer ID
MTA225
N° CCC / CCC No./ N° VME - FMS

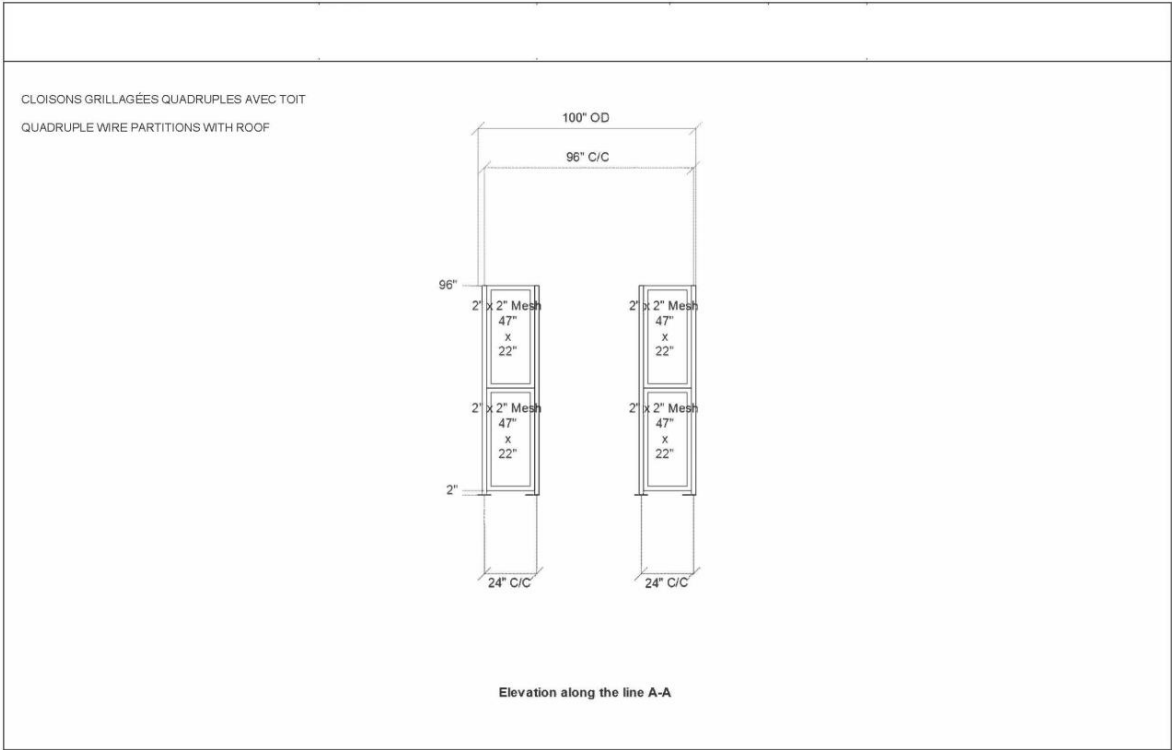
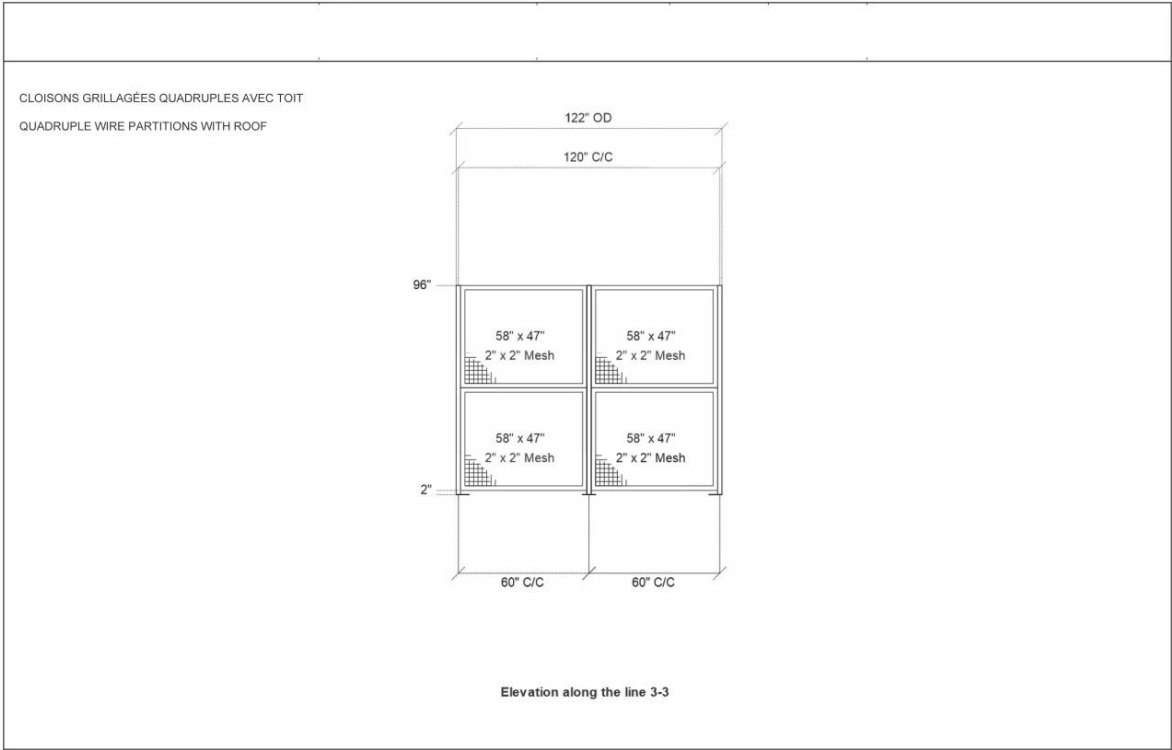

N° de l'invitation - Sollicitation No.
W0106-18S036/A
N° de réf. du client - Client Ref. No.
W0106-18S036

N° de la modif - Amd. No.
001
File No. - N° du dossier
MTA-8-41376

Id de l'acheteur - Buyer ID
MTA225
N° CCC / CCC No./ N° VME - FMS

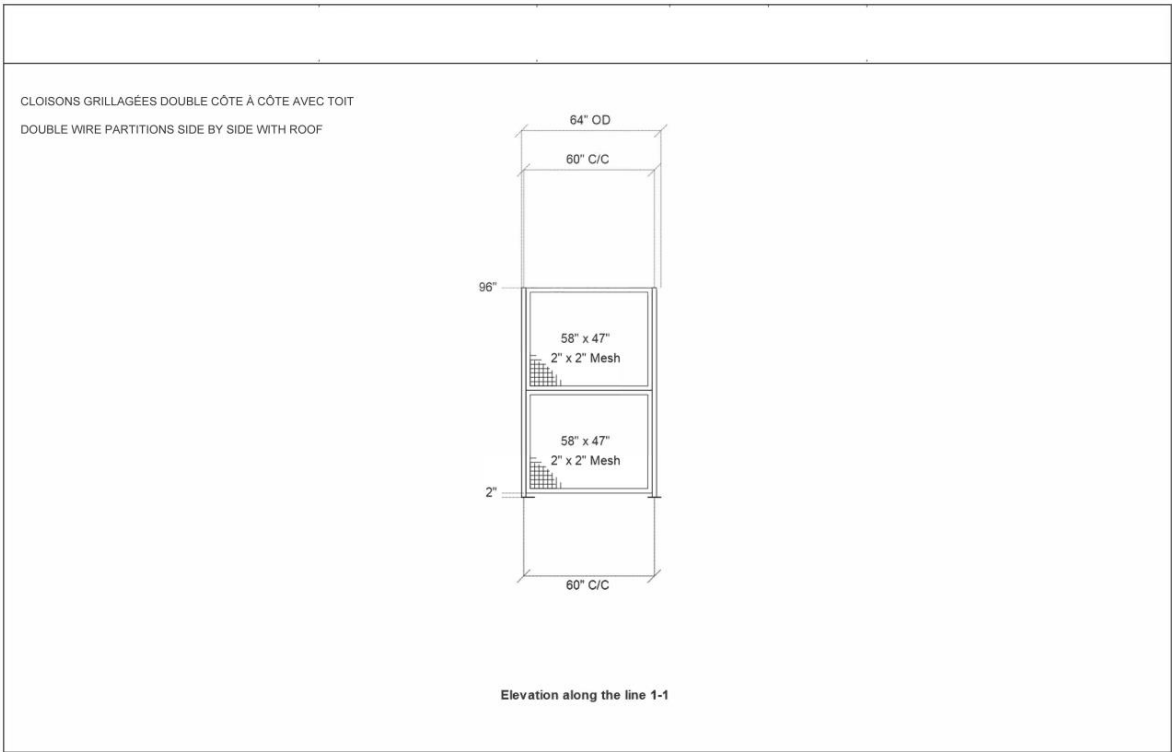
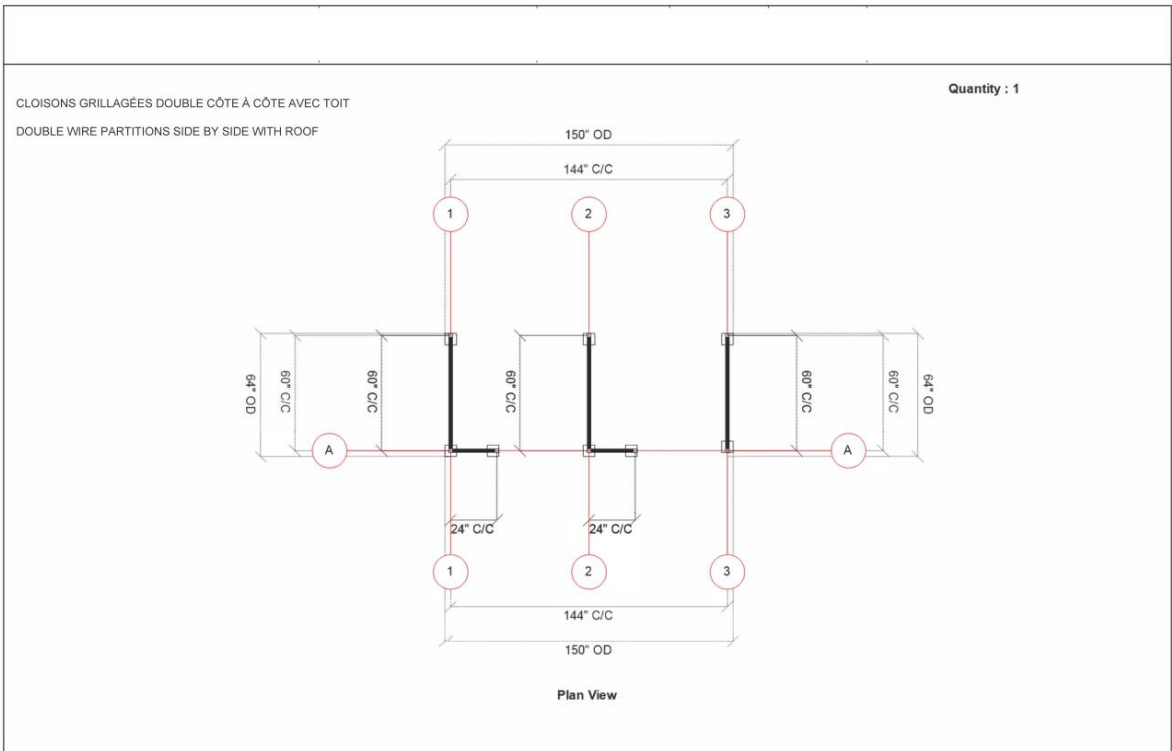

N° de l'invitation - Sollicitation No.
W0106-18S036/A
N° de réf. du client - Client Ref. No.
W0106-18S036

N° de la modif - Amd. No.
001
File No. - N° du dossier
MTA-8-41376

Id de l'acheteur - Buyer ID
MTA225
N° CCC / CCC No./ N° VME - FMS

CLOISONS GRILLAGÉES DOUBLE CÔTE À CÔTE AVEC TOIT
DOUBLE WIRE PARTITIONS SIDE BY SIDE WITH ROOF

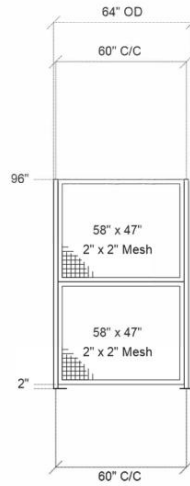

Elevation along the line 2-2

CLOISONS GRILLAGÉES DOUBLE CÔTE À CÔTE AVEC TOIT
DOUBLE WIRE PARTITIONS SIDE BY SIDE WITH ROOF

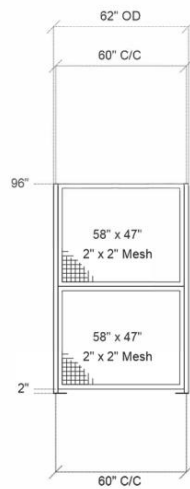

Elevation along the line 3-3

N° de l'invitation - Sollicitation No.
W0106-18S036/A
N° de réf. du client - Client Ref. No.
W0106-18S036

N° de la modif - Amd. No.
001
File No. - N° du dossier
MTA-8-41376

Id de l'acheteur - Buyer ID
MTA225
N° CCC / CCC No./ N° VME - FMS

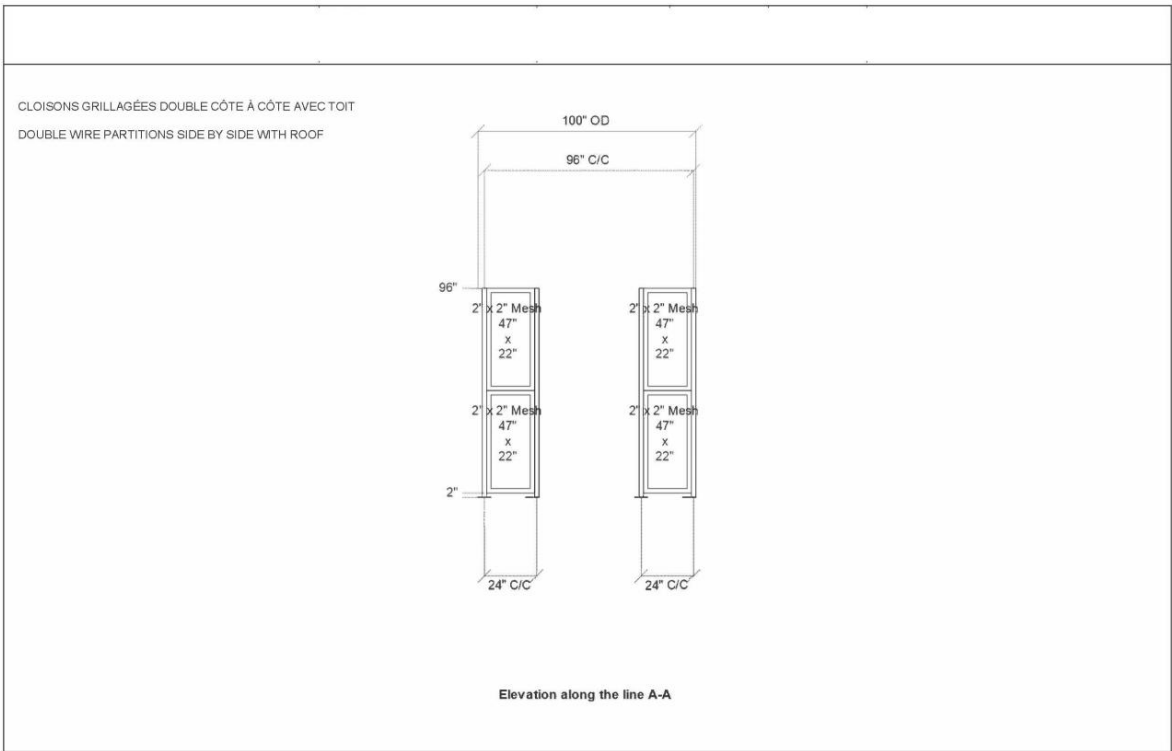

+++++

All others terms and conditions remain unchanged.