

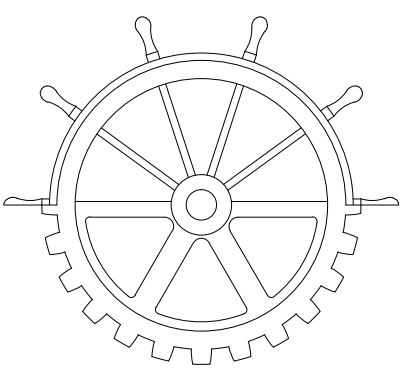

Public Services and Procurement Canada  
Services publics et Approvisionnement Canada



Ontario Region  
Parks Canada Infrastructure Directorate  
Heritage Canals and Engineering Works  
  
Région de l'Ontario  
Direction de l'infrastructure de Parcs Canada  
Canaux historiques et travaux d'ingénierie



Parks Canada    Parcs Canada

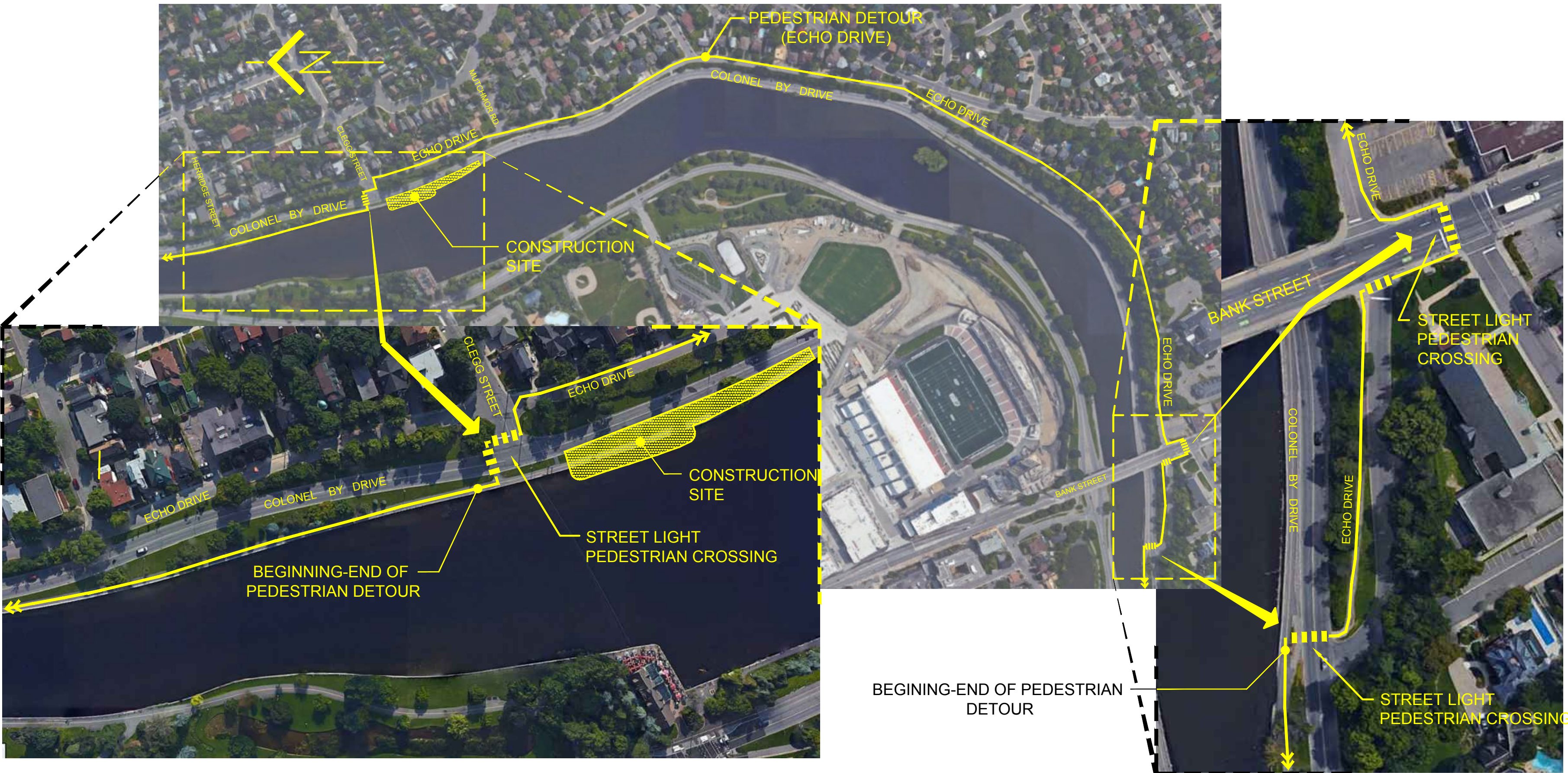
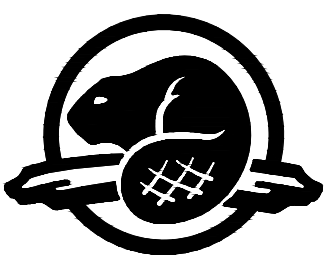

PEDESTRIAN DETOUR

# RIDEAU CANAL - OTTAWA

## WALL REPAIRS

### CLEGG STREET 2019

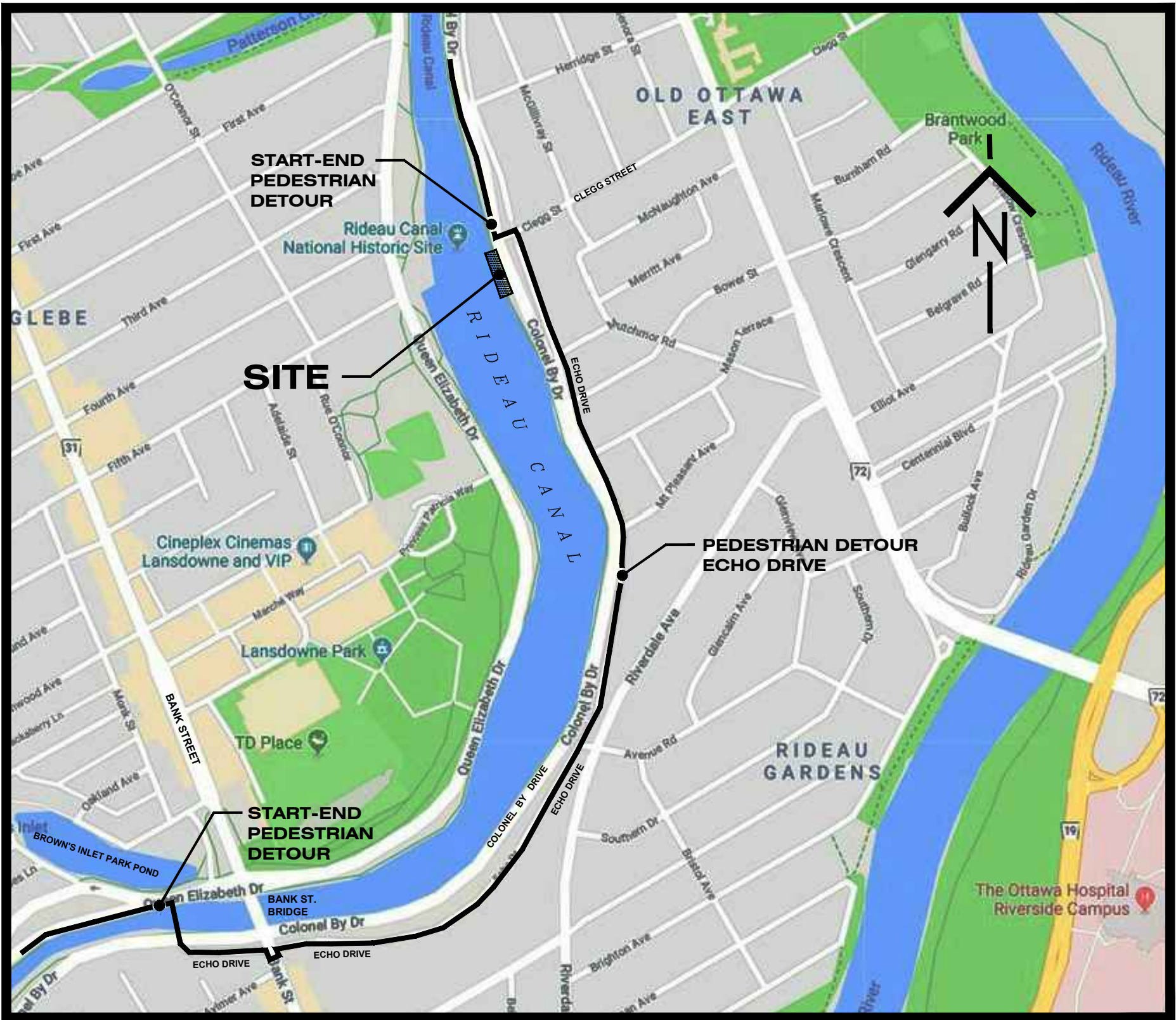

LOCATION PLAN  
NTS

#### LIST OF DRAWINGS

- 100 COVER SHEET
- 101 SITE PLAN AND SECTIONS
- 102 WALL ELEVATION AND STORM DRAIN DETAIL
- 103 NEW POSTS AND RAILING - DETAILS

ISSUED FOR TENDER  
27-05-2019

Canada

PWGSC PROJECT NUMBER  
R.079197.049  
HCEW DRAWING REFERENCE NUMBER  
CORID 16/R5



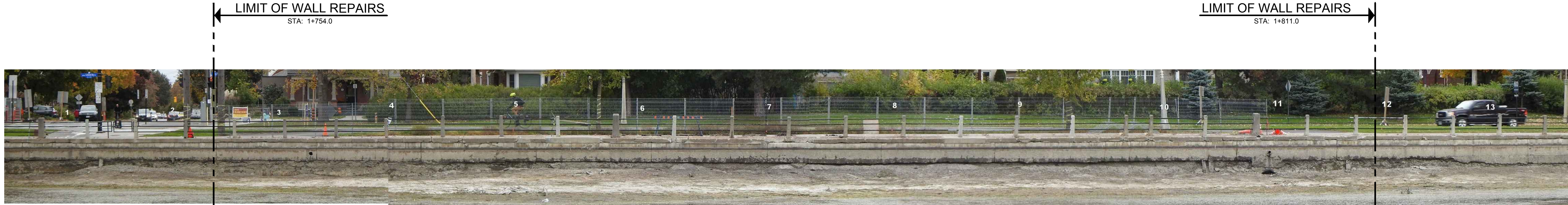
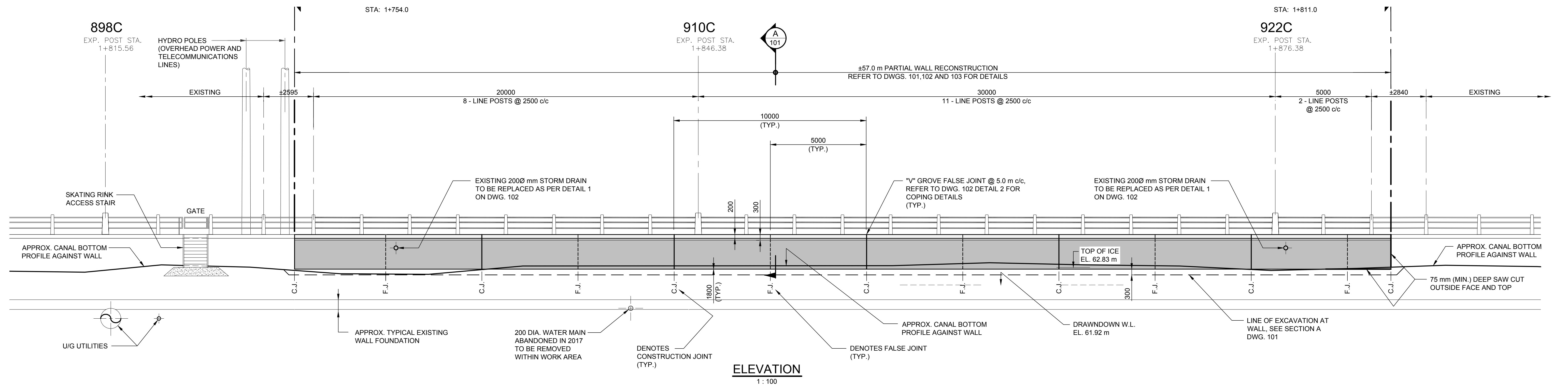

CANAL WALL PHOTO NOT IN SCALE IS ONLY REPRESENTATION OF EXISTING CONDITIONS (OCTOBER 2016)  
N.T.S.

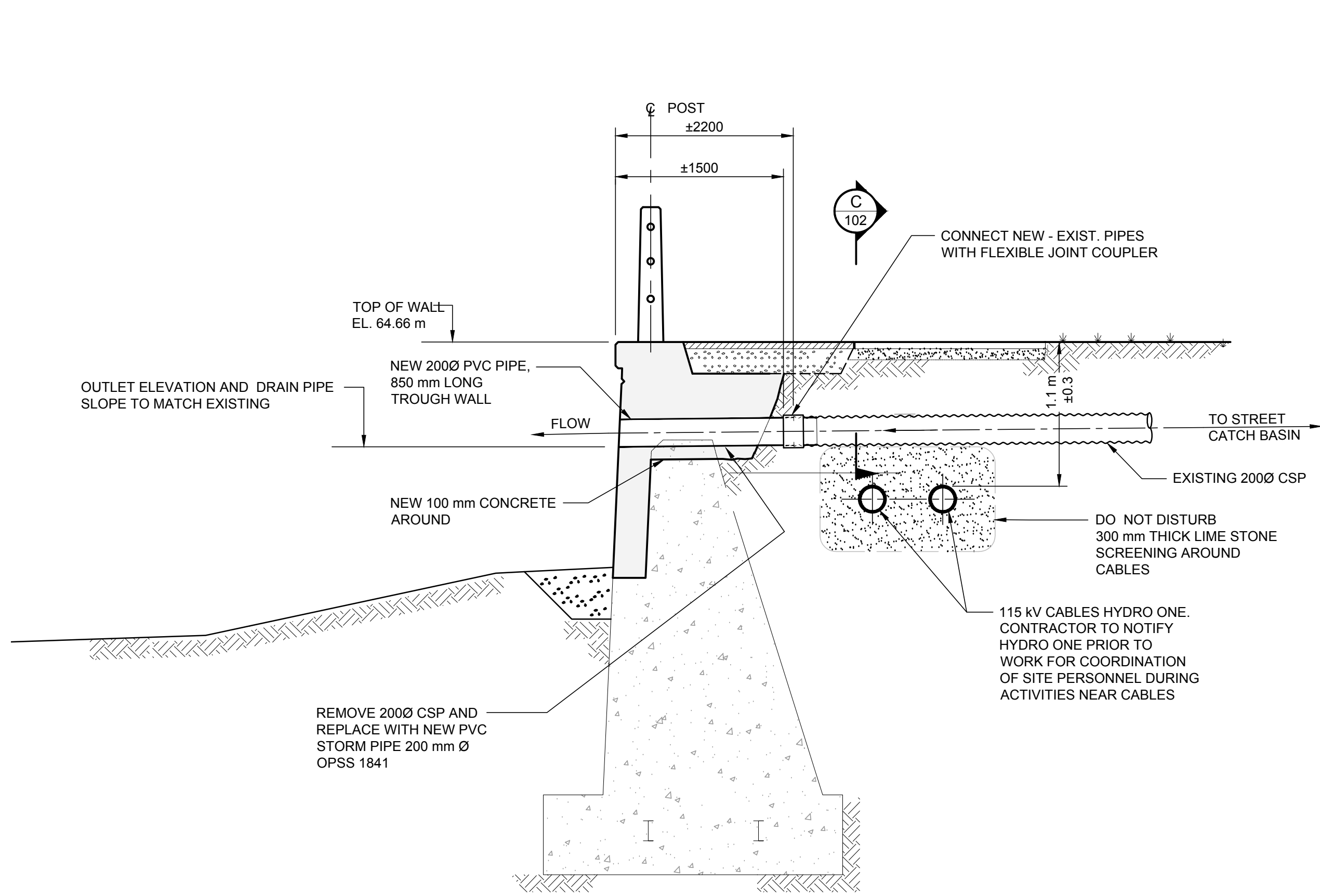

NEW STREET STORM DRAIN CONNECTION  
AT WALL REFACING - DETAIL 1  
1: 30 (2 LOCATIONS) 102

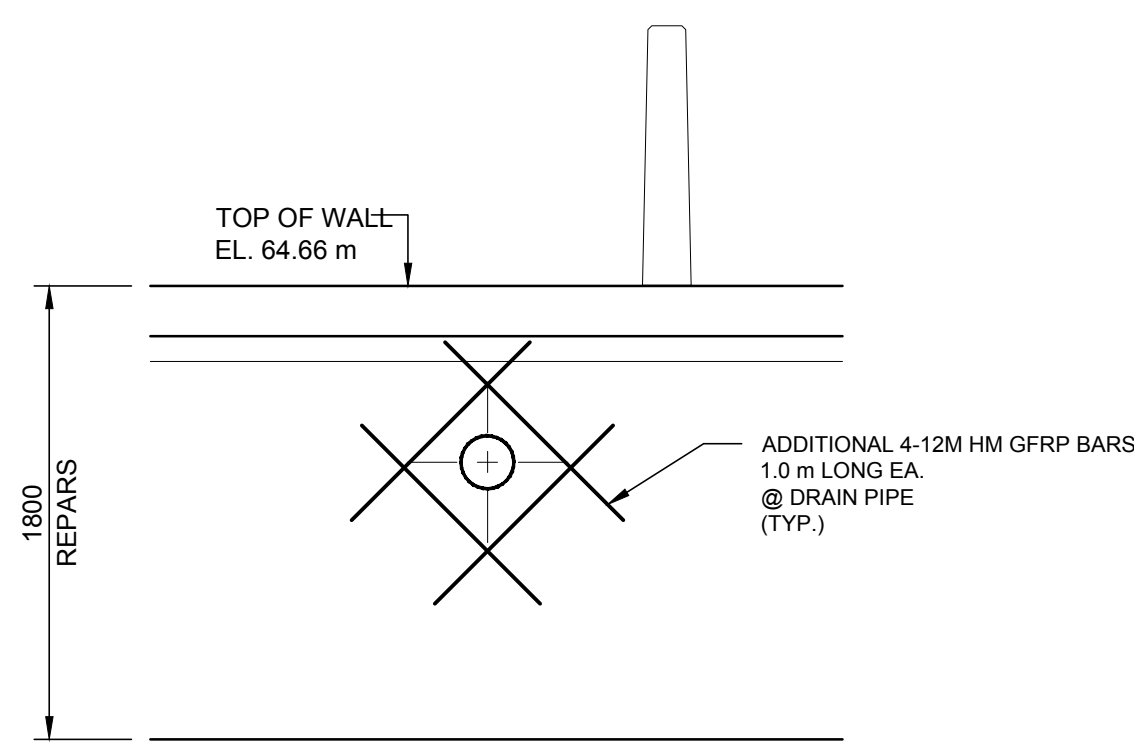

DETAIL 3 1: 50 102

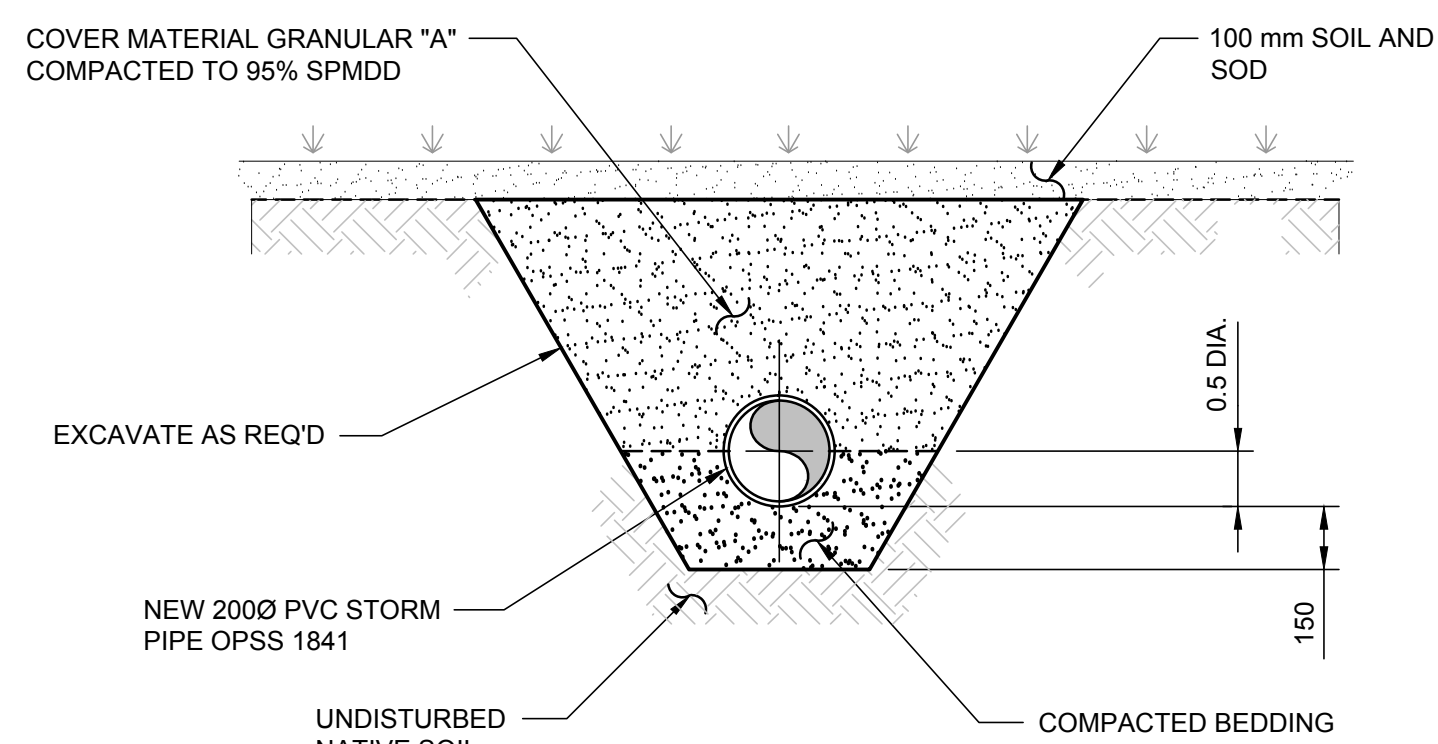

SECTION C 1: 50 102

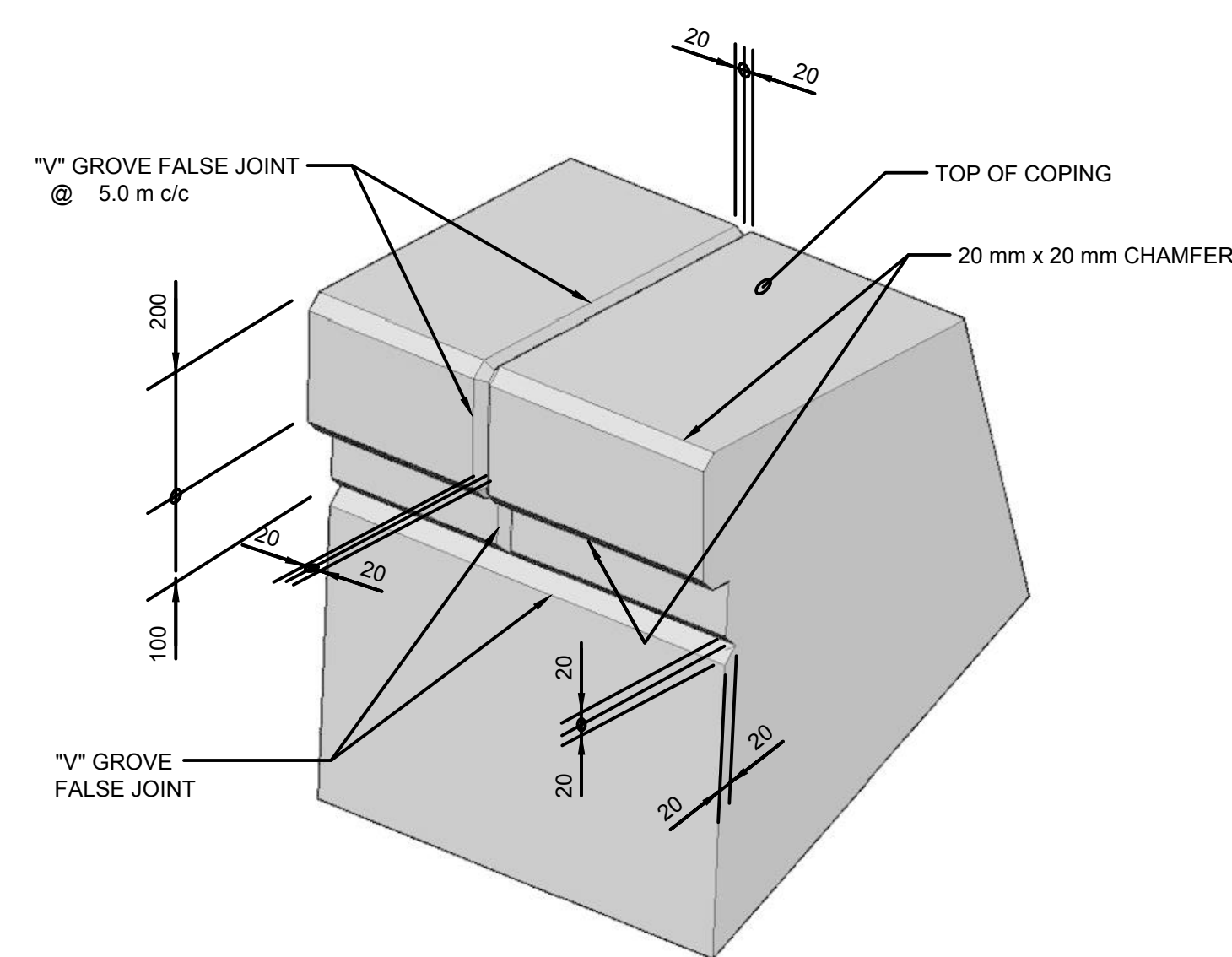

WALL COPING DETAIL 2 102  
N.T.S.



Canada

#### GENERAL NOTES:

- ALL STATION (STA+169.69) ARE IN METERS.
- ALL OTHER MEASUREMENTS ARE IN MILLIMETERS.
- SITE LAYOUT BASED ON SITE INSPECTION, SURVEYS CONDUCTED ON SITE, FIELD MEASUREMENTS AND BACKGROUND INFORMATION
- ELEVATIONS AND COORDINATES SHOWN ON DWG. 101 ARE BASED ON SURVEY CONDUCTED IN FEB. 2017 ELEVATIONS AND COORDINATES WERE ESTABLISHED
- SALVAGE AND REINSTALL EXISTING BENCHES, GARBAGE CONTAINERS AND SIGNS. REFER TO SPECIFICATIONS FOR DETAILS (REMOVAL SECTION 02 41 21)
- DETOUR/ WARNING SIGNS AND TEMPORARY FENCING BLOCKING EXISTING BIKE PATH SHALL BE LUMINATED
- PATHWAY WITHIN WORK LIMITS TO BE USED AS CONSTRUCTION WORKING AREA, PROTECT FROM DAMAGE. IF DAMAGED, REINSTATE TO ORIGINAL CONDITION OR BETTER
- DETOUR SIGNS @ SOUTH END OF PEDESTRIAN PATHWAY NEAR BANK STREET TO CLEARLY INDICATE CLOSURE AND ACCESS LIMITATION
- CONTRACTOR TO VERIFY AND CONFIRM LOCATION OF CATCH BASIN DRAINAGE OUTLETS DURING INITIAL WINTER DRAWDOWN PRIOR TO COMMENCEMENT OF WORK
- COPING "V" GROVE FALSE JOINTS @ 5.0 METERS SPACING.
- NEW COPING ELEVATIONS TO MATCH EXISTING.
- SPACING OF HANDRAIL POSTS TO MATCH EXISTING.
- ALL NEW EXPOSED CONCRETE EDGES TO HAVE 20mm CHAMFER UNLESS NOTED.
- MINIMUM COVER FOR REINFORCING STEEL IS 75mm UNLESS NOTED
- 75 mm MINIMUM SAW CUT TO BE COMPLETED AT ALL CONCRETE REMOVAL LIMITS

#### LEGEND:

909C STANDARD EXPANSION POST PCA DESIGNATED NUMERATION

2.	ISSUED FOR TENDER	C.U.	27-05-2019
1.	ISSUED FOR CLIENT REVIEW	C.U.	10-01-2019
No.	Description	Drawn By Des. Par	Date

Revision / Révision

Do not scale drawings.  
Verify all dimensions and conditions on site and immediately notify the Departmental Representative of all discrepancies.

A	A Detail number Numéro du détail
B	B Location dwg. number Numéro sur dessin

Project title / Titre du projet

RIDEAU CANAL - OTTAWA  
WALL REPAIRS  
CLEGG STREET 2019

Drawing title / Titre du dessin

WALL ELEVATION  
AND STORM DRAIN  
DETAIL

Drawn by / Dessiné par HENRYK CHRZANOWSKI	Designed by / Conçu par CHRIS UCHWAT, P.Eng.
Approved by / Approuvé par LUC BÉRIEULT, P.Eng.	Drawing Date / Date du dessin DECEMBER 2018

Project Number / Numéro du projet R.079197.049	Drawing Number/ Numéro du Dessin 102 Sheet Feuille 3 of 4
---	---

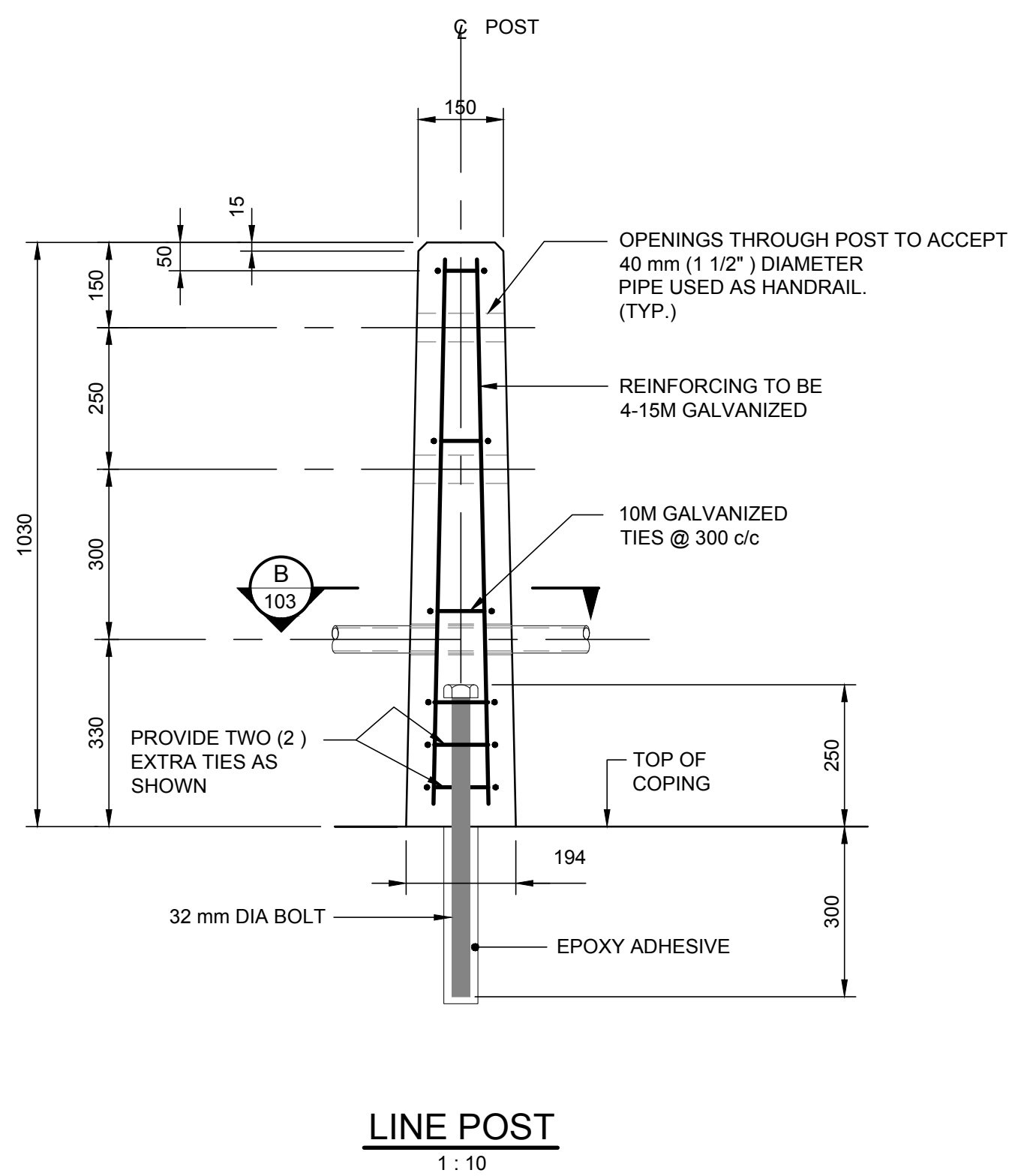

LINE POST  
1:10

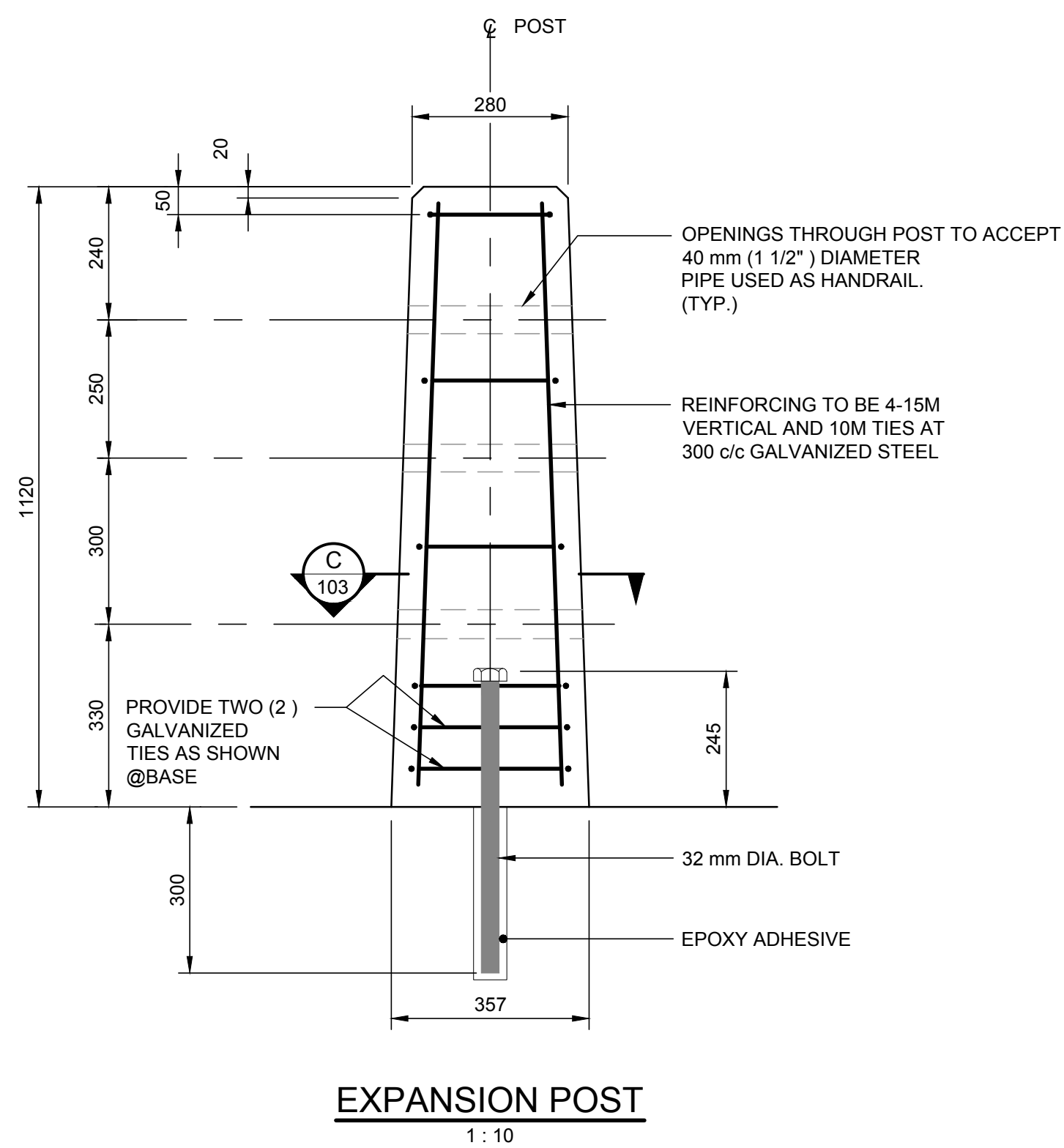

EXPANSION POST  
1:10

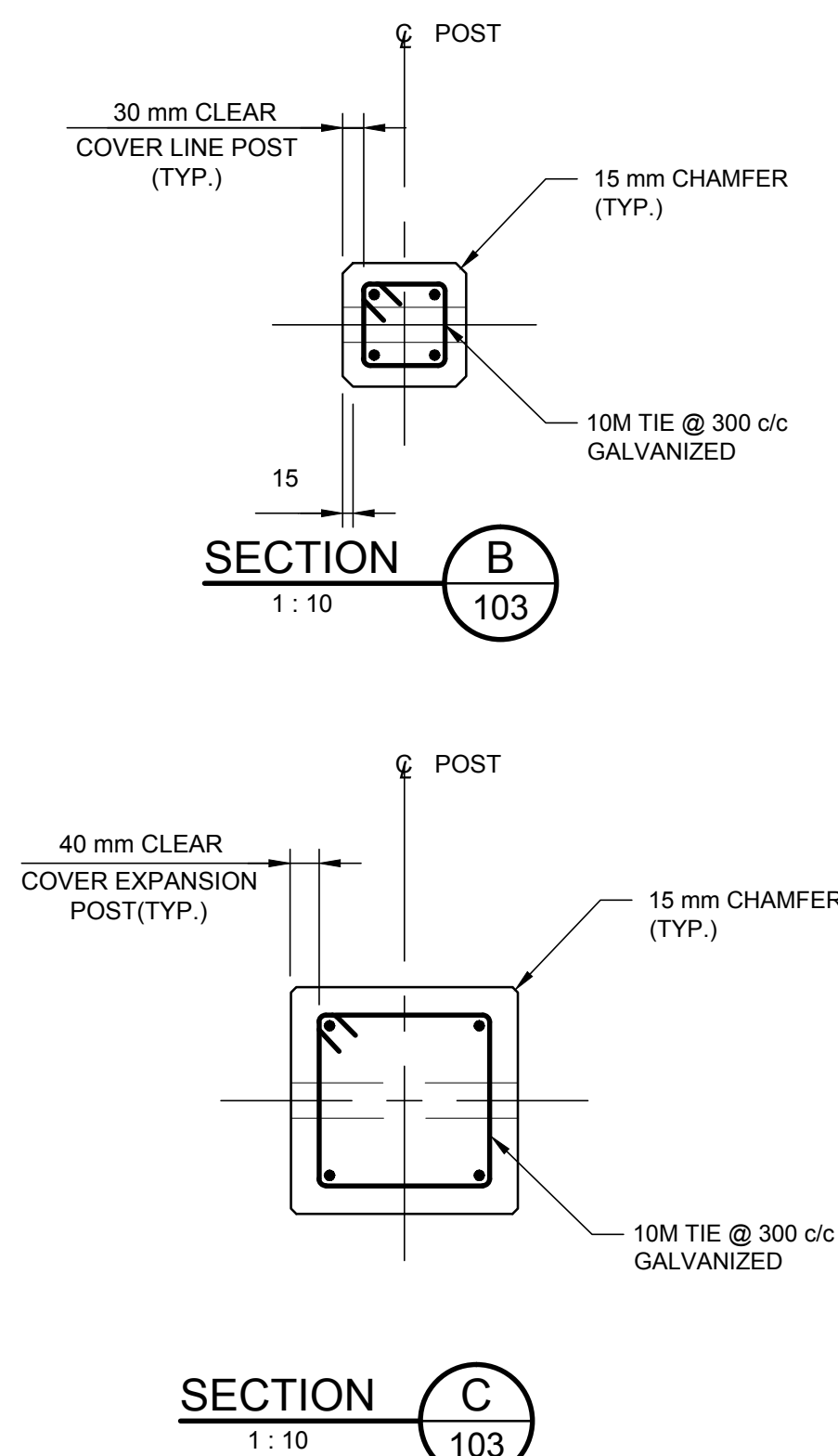

SECTION B  
1:10

SECTION C  
1:10

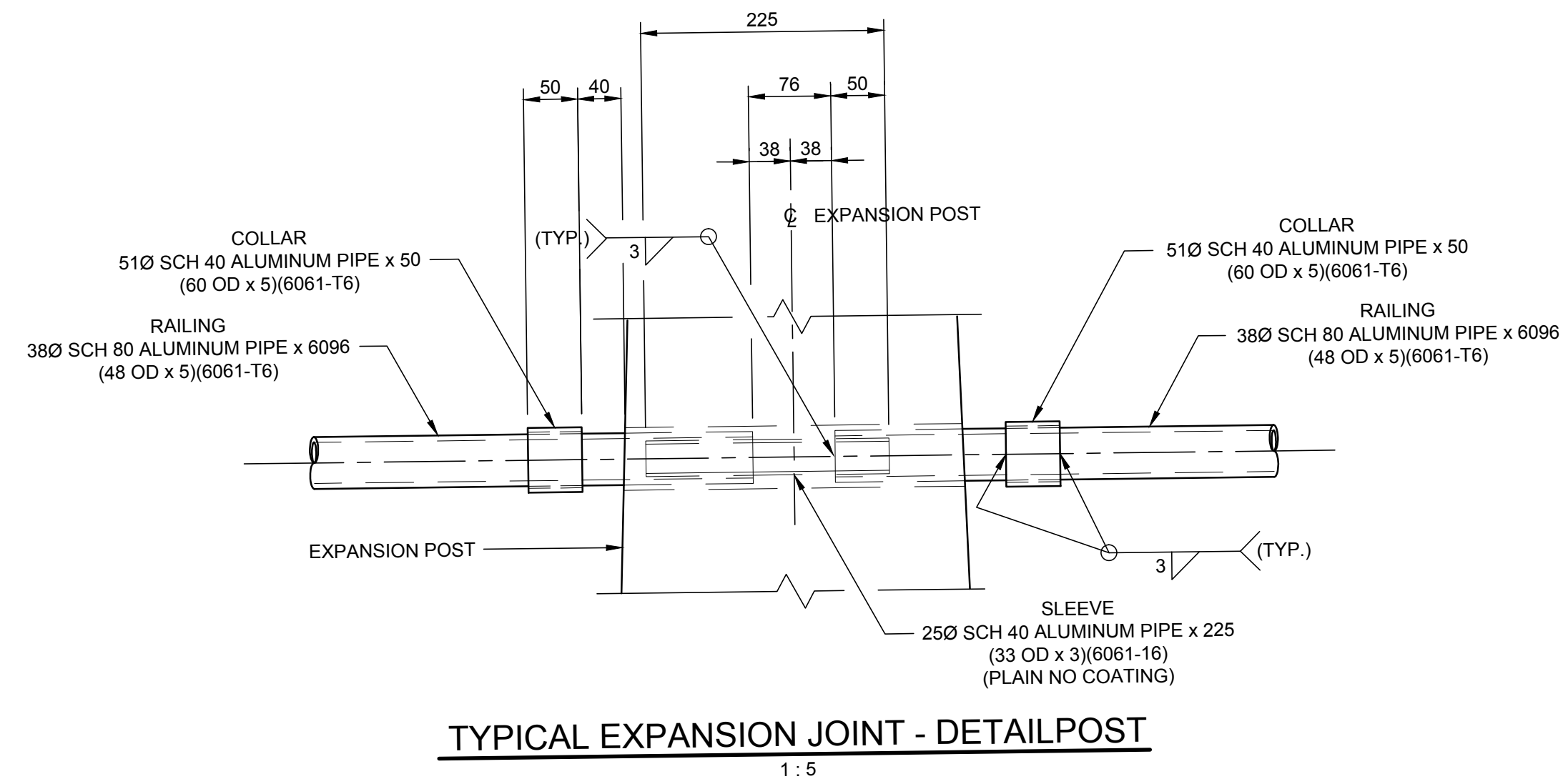

TYPICAL EXPANSION JOINT - DETAIL POST  
1:5

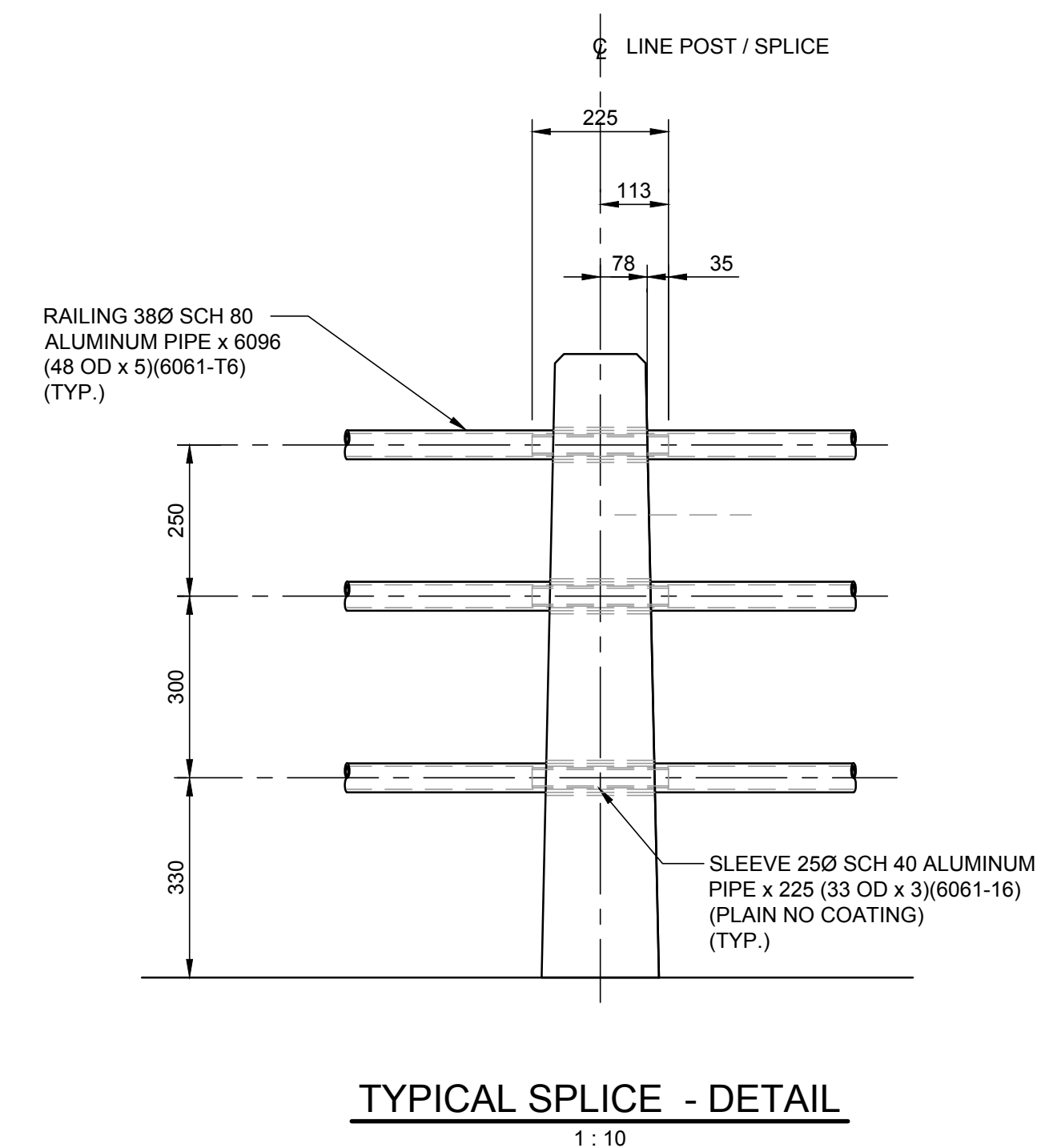

TYPICAL SPLICE - DETAIL  
1:10

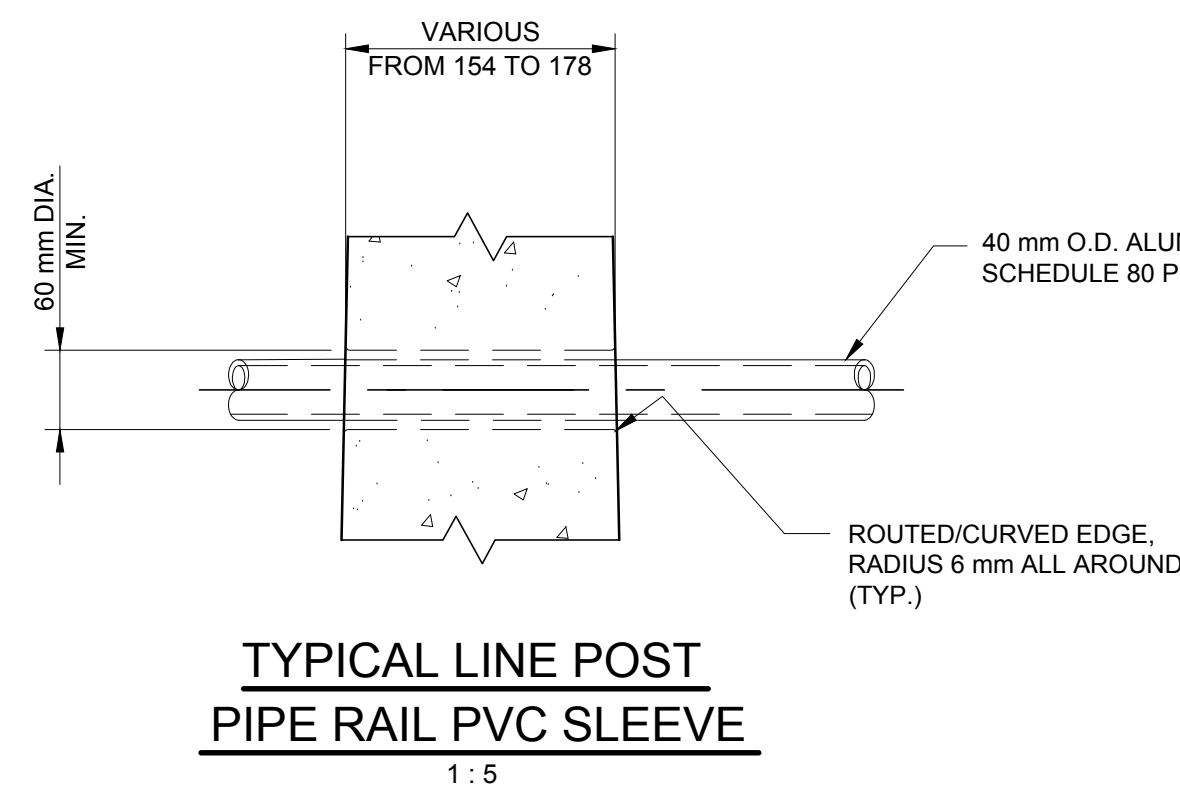

TYPICAL LINE POST  
PIPE RAIL PVC SLEEVE  
1:5

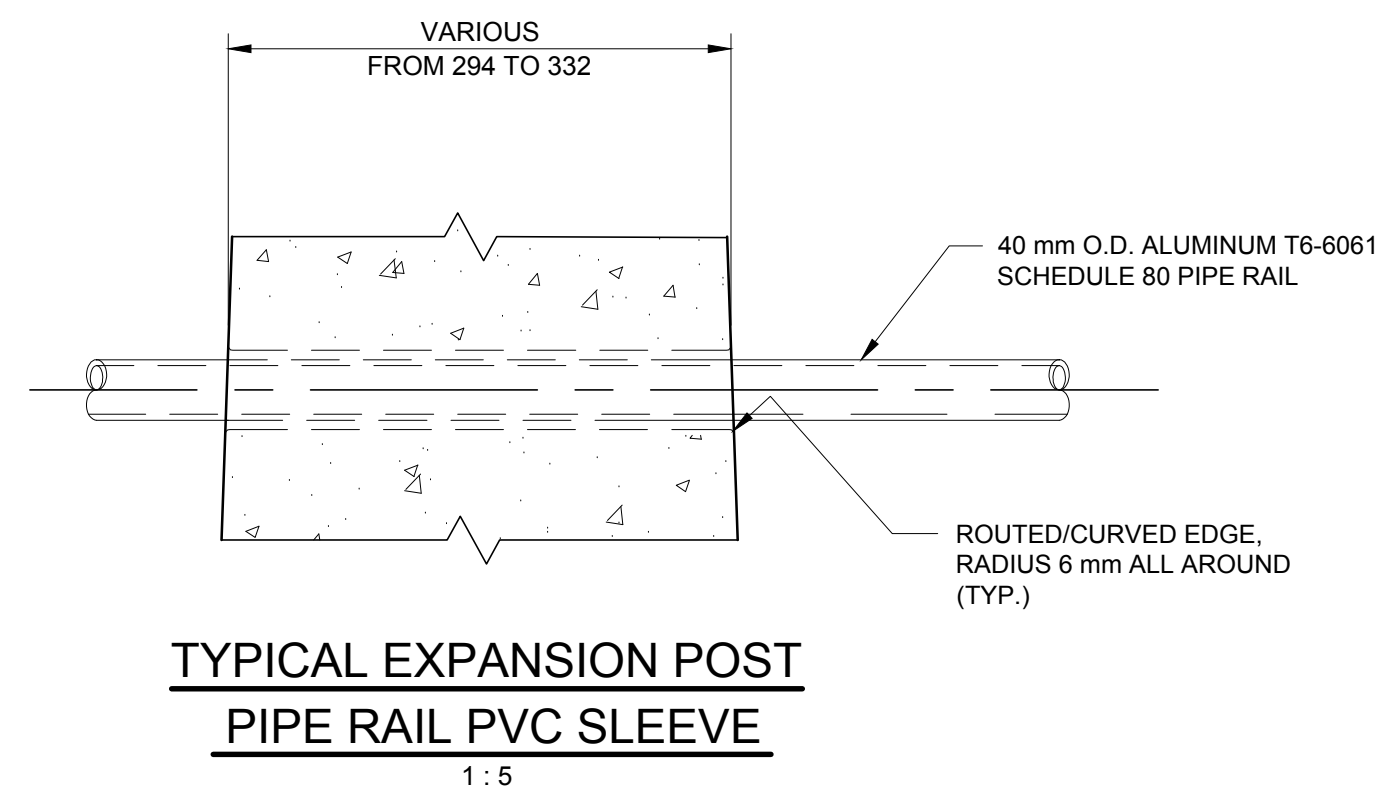

TYPICAL EXPANSION POST  
PIPE RAIL PVC SLEEVE  
1:5

CONCRETE POST DETAILS  
1:10

1  
103

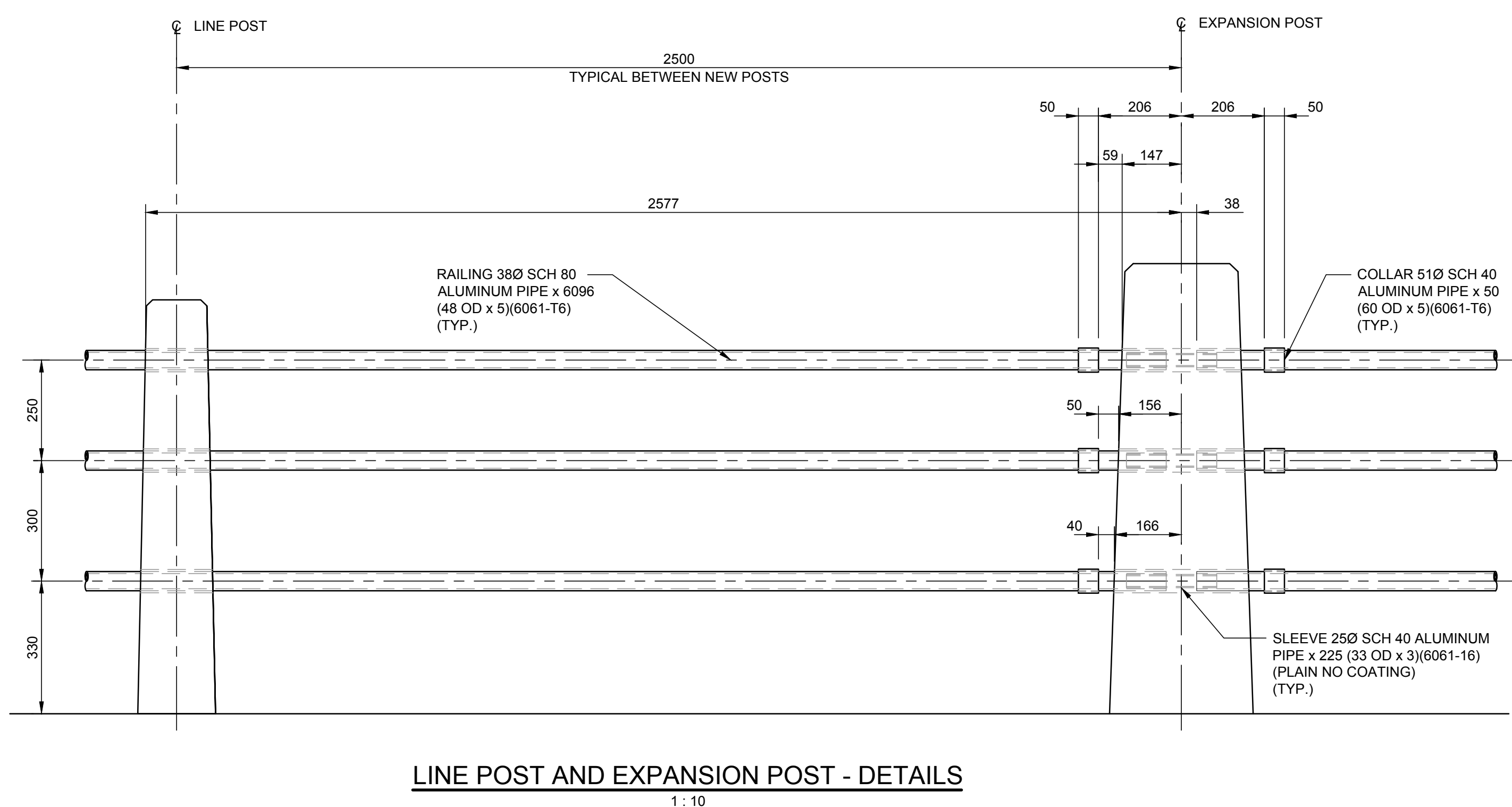

LINE POST AND EXPANSION POST - DETAILS  
1:10

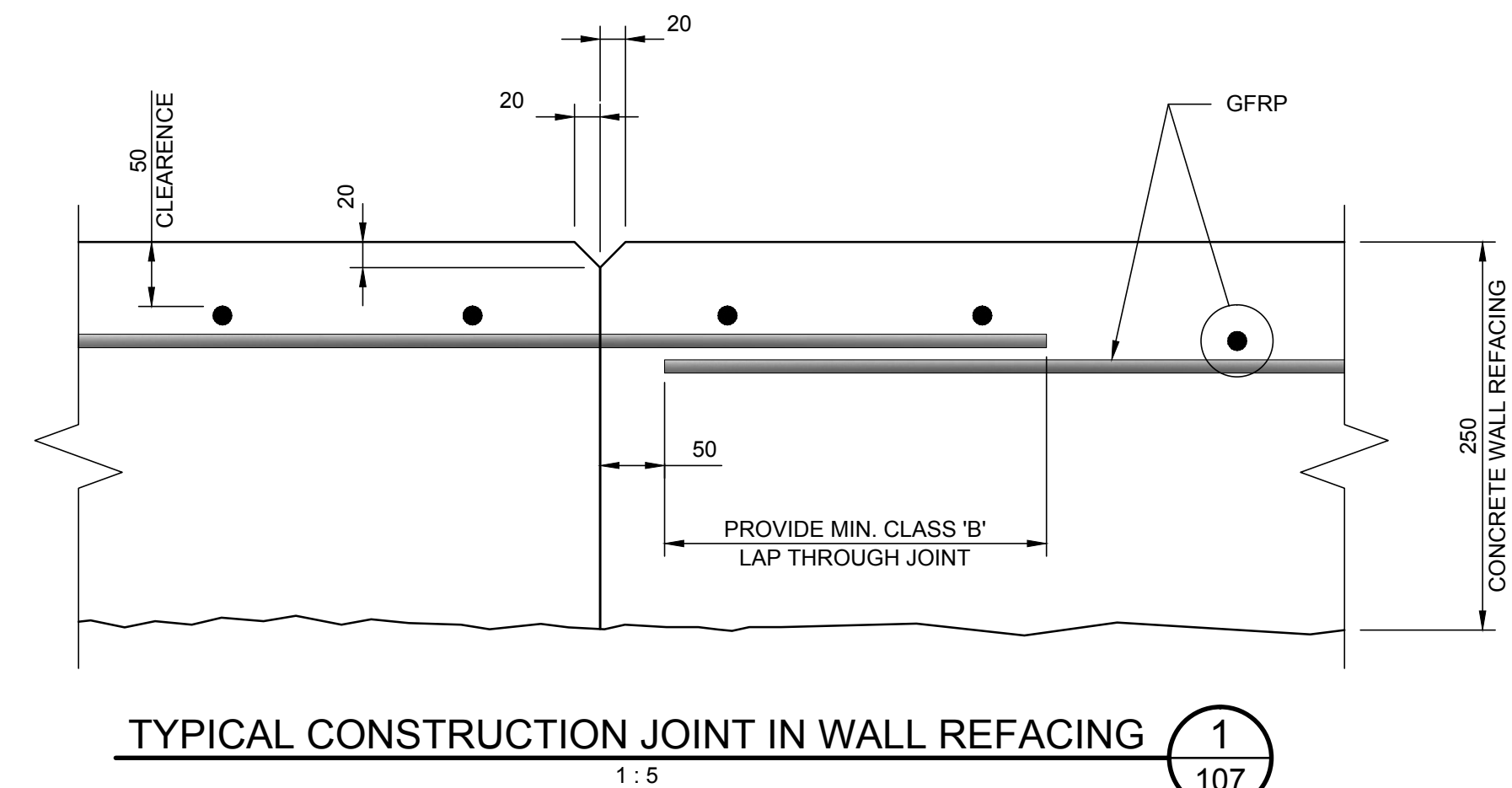

TYPICAL CONSTRUCTION JOINT IN WALL REFACING  
1:5

1  
107

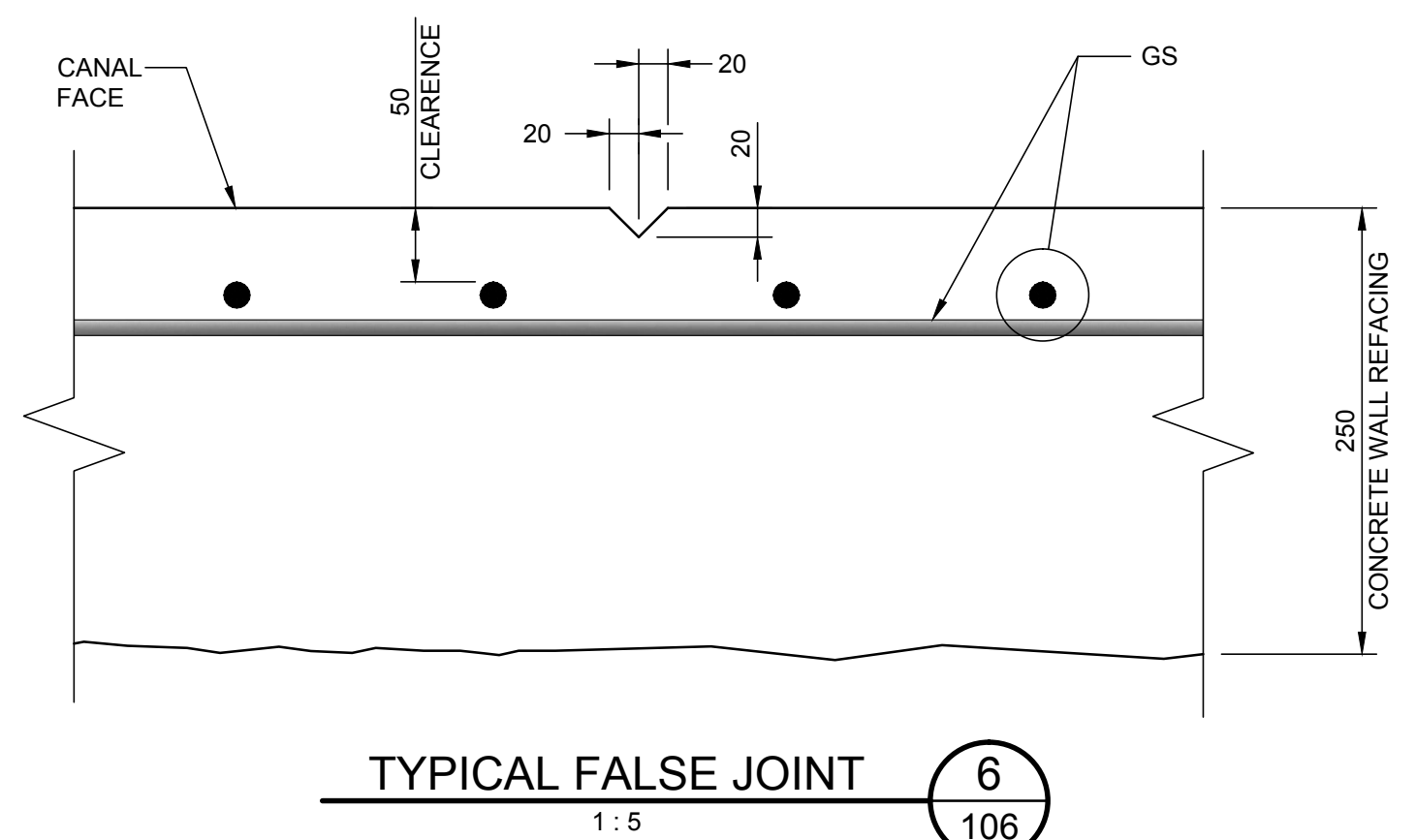

TYPICAL FALSE JOINT  
1:5

6  
106

2.	ISSUED FOR TENDER	C.U.	27-05-2019
1.	ISSUED FOR CLIENT REVIEW	C.U.	10-01-2019
No.	Description	Drawn By Des. Par	Date
Revision / Révision			
Do not scale drawings. Verify all dimensions and conditions on site and immediately notify the Departmental Representative of all discrepancies.			
A	A Detail number Numéro du détail		
B	B Location dwg. number Numéro sur dessin		

Project title / Titre du projet

RIDEAU CANAL - OTTAWA  
WALL REPAIR  
CLEGG STREET 2019

Drawing title / Titre du dessin

NEW POSTS AND  
RAILING - DETAILS

Drawn by / Dessiné par HENRYK CHRZANOWSKI	Designed by / Conçu par CHRIS UCHWAT, P.Eng.
Approved by / Approuvé par LUC BÉRIAL, P.Eng.	Drawing Date / Date du dessin DECEMBER 2018

Project Number / Numéro du projet R.079197.049	Drawing Number / Numéro du Dessin 103 Sheet Feuille 4 of 4
---	--