



**RETURN BIDS TO:
RETOURNER LES SOUMISSIONS À:**

**Bid Receiving - PWGSC / Réception des
soumissions - TPSGC**
11 Laurier St./11, rue Laurier
Place du Portage, Phase III
Core 0B2 / Noyau 0B2
Gatineau, Québec K1A 0S5
Bid Fax: (819) 997-9776

**REQUEST FOR PROPOSAL
DEMANDE DE PROPOSITION**

**Proposal To: Public Works and Government
Services Canada**

We hereby offer to sell to Her Majesty the Queen in right of Canada, in accordance with the terms and conditions set out herein, referred to herein or attached hereto, the goods, services, and construction listed herein and on any attached sheets at the price(s) set out therefor.

**Proposition aux: Travaux Publics et Services
Gouvernementaux Canada**

Nous offrons par la présente de vendre à Sa Majesté la Reine du chef du Canada, aux conditions énoncées ou incluses par référence dans la présente et aux annexes ci-jointes, les biens, services et construction énumérés ici sur toute feuille ci-annexée, au(x) prix indiqué(s).

Comments - Commentaires

Vendor/Firm Name and Address

**Raison sociale et adresse du
fournisseur/de l'entrepreneur**

Issuing Office - Bureau de distribution

Furniture Division/Division des ameublements
L'Esplanade Laurier,
East Tower 7th Floor
Tour est 7^e étage,
140 O'Connor, Street,
140 O'Connor, rue O'Connor,
Ottawa
Ontario
K1A 0R5

Title - Sujet Workspaces, Cat. 1, 2, 5 and Cat. 6	
Solicitation No. - N° de l'invitation EP076-200248/A	Date 2019-08-15
Client Reference No. - N° de référence du client 20200248	
GETS Reference No. - N° de référence de SEAG PW-\$\$PQ-999-77596	
File No. - N° de dossier pq999.EP076-200248	CCC No./N° CCC - FMS No./N° VME
Solicitation Closes - L'invitation prend fin at - à 02:00 PM on - le 2019-09-03	Time Zone Fuseau horaire Eastern Daylight Saving Time EDT
F.O.B. - F.A.B. Plant-Usine: <input type="checkbox"/> Destination: <input checked="" type="checkbox"/> Other-Autre: <input type="checkbox"/>	
Address Enquiries to: - Adresser toutes questions à: MacCuaig, Shannon	Buyer Id - Id de l'acheteur pq999
Telephone No. - N° de téléphone (613) 697-0956 ()	FAX No. - N° de FAX () -
Destination - of Goods, Services, and Construction: Destination - des biens, services et construction: See herein	

Instructions: See Herein

Instructions: Voir aux présentes

Delivery Required - Livraison exigée See Herein	Delivery Offered - Livraison proposée
Vendor/Firm Name and Address Raison sociale et adresse du fournisseur/de l'entrepreneur	
Telephone No. - N° de téléphone Facsimile No. - N° de télécopieur	
Name and title of person authorized to sign on behalf of Vendor/Firm (type or print) Nom et titre de la personne autorisée à signer au nom du fournisseur/ de l'entrepreneur (taper ou écrire en caractères d'imprimerie)	
Signature	Date

TABLE OF CONTENTS

Section 1 – Invitation and Instructions to Bidders

Section 2 – Resulting Contract including a list of required goods and services

SECTION 1 – INVITATION AND INSTRUCTIONS TO BIDDERS

Step 1. For Tier 2 and Tier 3 only (If Tier 1, skip this step and proceed with step 2)

Is this a Manufacturer Product Specific Procurement? No.

Step 2. ☒ Competitive

For competitive Requirements when only one bid is received:

A bid must comply with the requirements of the bid solicitation and meet all mandatory technical evaluation criteria to be declared responsive. The responsive bid with the lowest evaluated price will be recommended for award of a contract.

For Competitive Requirements when only one bid is received:

The Bidder must provide the following information AFTER bid closing, if requested to do so by Canada:

- One or more of the following price justifications:
 1. a current published price list indicating the percentage discount available to Canada; or
 2. a copy of paid invoices for the like quality and quantity of the goods, services or both sold to other customers; or
 3. a price breakdown showing the cost of direct labour, direct materials, purchased items, engineering and plant overheads, general and administrative overhead, transportation, etc., and profit; or
 4. any other supporting documentation as requested by Canada.

Step 3. ☒ General

Terms of the RFB:

This RFB is issued pursuant to the Supplier's Furniture for Workspaces Supply Arrangement (SA) that forms part of the series of SAs issued by PWGSC with the number E60PQ-140003/PQ. The terms and conditions in the Supplier's SA apply to and form part of this RFB. Bidders who submit a bid agree to be bound by those terms and conditions as well as the terms and conditions in this RFB.

The WTCM is the Workspaces Terms and Conditions Manual that contains all terms and conditions in full text that form part of individual RFBs under this SA.

The Bidder must provide the following information WITH the bid:

- The information requested by Canada in Annex A herein.

The Bidder must also provide the information at article 4 below at the time indicated in article 3.

Security Requirement:

1. Conditions
 - a. the Bidder must hold a valid organization security (VOS) clearance as indicated in Annex B;
 - b. the Bidder's proposed individuals requiring access to classified or protected information, assets or sensitive work site(s) must meet the security requirement as indicated in Annex B.
2. For additional information on security requirements, bidders should refer to the Canadian Industrial Security Directorate (CISD), Industrial Program of Public Works and Government Services Canada (<http://ssi-iss.tpsgc-pwgsc.gc.ca/index-eng.html>) website.
3. The conditions in article 1 above must be met by the Bidder (the checked box applies):
 - a. ☐ by the closing date of the bid;
 - b. ☒ before the award of a contract. Bidders are reminded to obtain the required security clearance promptly. Any delay in the award of a contract to allow the successful bidder to obtain the required clearance will be at the entire discretion of the Contracting Authority.
4. Bidders are to supply the following information, as a minimum, to demonstrate compliance with the Security Requirement.
 - a. The Bidder's valid VOS clearance number issued by CISD;
 - b. The name of all individuals who will require access to classified or protected information, assets or sensitive work sites. It is desirable to also include their date of birth, their middle name, and their security clearance number issued by CISD.

RFB Issued by:	
Identified User's (IU) Department/Agency/Crown Corporation: Contact for this RFB:	See Section 2, article 4.1 below.
RFB Closing - Submit Bid: Bids must be submitted on the date and at the time indicated below.	
By no later than date and time:	See Cover Page
To physical location	See Cover Page
Additional Bid Submission option epost Connect service:	Please contact PWGSC Bid Receiving Unit via email to open an epost Connect conversation. TPSGC.DGAreceptiondessoumissions-ABBidReceiving.PWGSC@tpsgc-pwgsc.gc.ca
RFB Enquiries	
Unless a different period is listed in the adjacent column, Bidders may submit enquires about the RFB to the Contracting Authority five business days prior to the RFB closing date. Enquiries received after the timeline indicated may not be answered.	5 business days

SECTION 2 - RESULTING CONTRACT CLAUSES

1.	Terms and Conditions of the Contract	
	The terms and conditions of Parts 6B and 6C of the Supplier's SA within the series E60PQ-140003/PQ apply to and form part of this Contract.	
2.	Security Requirement (the checked article applies)	
2.1	The applicable security requirement(s) is (are) set out in the Security Requirement Check List attached as Annex B of this contract. The Contractor must fulfill the security requirements by meeting the terms below.	
a.		Contractor may be escorted; possession of security clearance not required. Contractor personnel MAY NOT ENTER NOR PERFORM WORK ON sites where PROTECTED or CLASSIFIED information or assets are kept, without an escort provided by the department or agency for which the work is being performed.
b.	x	Possession of security clearance(s) is required. The Contractor must meet the security clearance requirements contained in the clausung in Annex B herein.
c.		There is no security requirement associated with this contract.
3.	Requirement	
3.1	The Contractor must perform the Work listed in Annex A herein.	
4.	Authorities	
4.1	Contracting Authority (IU)	
	Name:	Shannon MacCuaig
	Title:	Supply Specialist
	Department/Agency/Crown Corporation:	Public Services and Procurement Canada
	Address:	140 O'Connor Street Ottawa, Ontario K1P 0R5
	Telephone No.:	613-697-0956
	E-mail address:	shannon.maccuaig@pwgsc.gc.ca
4.2	Project Authority [To be completed at contract award] <i>The Project Authority (PA) is the representative of the department or agency for whom the Work is being carried out under the Contract including the provision to approve the authority to proceed for delivery and installation and is responsible for all matters concerning the technical content of the Work under the Contract.</i> <i>In addition, the PA is also responsible for ensuring that the Supplier's employees and subcontractors requiring access to the site adhere to the allocated time for the Supplier to access the site to deliver and install the furniture in accordance with the master schedule held by the General Contractor (a representative of Canada or a service provider(s) under contract with the Government of Canada).</i>	
	Name:	
	Title:	
	Department/Agency/Crown Corporation:	
	Address:	
	Telephone No.:	
	E-mail address:	
4.3	Contractor's Representative	
	As set out in Annex A, Table 9 below.	

Solicitation No. - N° de l'invitation
EP076-200248/A
Client Ref. No. - N° de réf. du client
EP076-200248

Amd. No. - N° de la modif.
File No. - N° du dossier
pq999 EP076-200248

Buyer ID - Id de l'acheteur
pq999
CCC No./N° CCC - FMS No./N° VME

5.	Method of Payment	
	The checked box applies. If the Contractor's SA indicates acceptance for payment by credit card, that method may be used in conjunction with the following.	
		Single Payment
	x	Multiple Payment
6.	Invoicing	
	Further to the Invoicing terms of the WTCM document, the Contractor will deliver the original and one copy of the invoice to the following address for certification and payment:	
	Name of the organization and contact: [To be completed at contract award]	
	Address:	

ANNEX A
REQUIREMENT and BASIS OF PAYMENT

1. Category Selection

Combined Categories Rule:

For reasons of compatibility, the following categories will be combined for evaluation and contract award purposes:

The rule only applies to the categories below that are checked. The unchecked categories will be evaluated separately and may be awarded to multiple suppliers;

☒ **Category 1**

☒ **Category 2**

☒ **Category 5**

Design Upgrade Rule:

The IU may exercise an option to upgrade products up to 20% of each Category product total before Applicable Taxes after contract award.

The Design Upgrade amount is used at the discretion of the Project Authority (PA) **prior to the manufacturing/ordering of the products**, the PA will provide the Contractor with a written notice of Canada's Design Upgrade choices for each of the product(s) to be upgraded. The Contractor will provide the pricing of the upgraded product(s) to a maximum of 20% of each Category Contract Price of Table 8. The Contracting Authority will issue an amendment to the contract with the Design Upgrades and pricing.

The Supplier certifies that all the Design Upgraded products offered will conform to all specifications and meet the testing requirements detailed in the Specifications of the Supply Arrangement.

Design Upgrade: is the process of replacing a product with a more innovative or enhanced version of the same product.

NSA:

NSA products can be incorporated in the RFB and must not exceed 30% of the firm quantity by category. NSA items must be added to the category that is most closely related and must be generic.

The requirement includes the following categories of work:

a. Category 1 – Interconnecting Panels and Freestanding Systems

☒ Category 1a – Interconnecting Panels (Refer to Annex C)

☒ Category 1b – Supporting components and freestanding furniture

RULE: Metal Storage

Identified Users may procure metal storage products forming part of Category 1 when the metal storage products will be part of a requirement for a workstation(s)/work point(s). If this rule does not apply, Category 3 must be used for the metal storage products forming part of this category.

Solicitation No. - N° de l'invitation
EP076-200248/A
Client Ref. No. - N° de réf. du client
EP076-200248

Amd. No. - N° de la modif.
File No. - N° du dossier
pq999 EP076-200248

Buyer ID - Id de l'acheteur
pq999
CCC No./N° CCC - FMS No./N° VME

-
- b. ☒ Category 2 – Freestanding Height Adjustable Desk / Table Products
 - c. ☒ Category 5 – Ancillary and Lighting Products
 - d. ☒ Category 6 - Support Space – Collaborative Furniture

RULE: Category 6 can be further subdivided by space or like product in order to increase or allow competition. Space is defined as a location available for a particular purpose such as a meeting room space or a collaborative space. Like products are defined as products with similar design and construction. If NSA products form part of the requirement, the IU must validate the 30% NSA prior to subdividing the category. NSA products can be added to any subdivide or in its own subdivide.

Category 6 will be subdivided into 3 sections (A, B and C) in the Product Table for Category 6.

- e. ☒ NSA Product(s) – Categories: 1b & 6

2. Product and Pricing Tables

Site Inspection Date: To be coordinated with Project Authority after contract award. (Refer to Annex A article 4 of the SA for Site Inspection and Documentation instructions.)

INSTRUCTIONS TO BIDDERS: Bidders are to complete Sections B of the tables identified by the IU in this article as well as Tables 8 and 9. **Bidders must provide a complete product offering for each category, or CAT 6 sub-divide they wish to submit a bid in order to be compliant.**

****Refer to article 6A.7 for instructions on how to submit products that are not approved in product listing. ****
In a resulting contract, the term "Bid" means the Supplier's commitment, the term "Bidder" means "Contractor".

Product Categories: 1, 2 & 5

Table 1 – Product Table

Section A - IU REQUIREMENT				Section B – SUPPLIER’S BID		
#	GoCUID	Description of Product (Additional product details may be inserted, if required as per 6B.4.1 of the SA)	Qty	Supplier Part Number	Firm Unit Price \$	Extended Total [Qty x Price] \$
Category 1A						
1	Refer to Annex C and Floor Plans.					\$
Category 1B						
2	1bFFHREN24L48WNOLNY	TYPE: SU1	85		\$	\$
Category 2						
3	2WSSREXXL30L48BELXX	TYPE: HSU1	109		\$	\$
4	2WSSREXXL30L60BELXX	TYPE: HSU2	3		\$	\$
5	2WSSDEXXL30L48BELXX	TYPE: HSU3	6		\$	\$
6	2B2LREXXL30L60BELFA	Wire management trough below worksurfaces, individual fabric privacy screens. TYPE: BP4	3		\$	\$
7	2B3LREXXL30L60BELFA	Wire management trough below worksurfaces, individual fabric privacy screens. TYPE: BP6	5		\$	\$
Category 5						
8	5MOADUARMGRMMTXXXXX	TYPE: MA1	148		\$	\$
9	5TLTDSKBAACUSBXXXXX	2 duplex power and 2 USB ports TYPE: TL1	159		\$	\$
10	5PMOWKSMTACUSBXXXXX	2 duplex power and 2 USB ports TYPE: PM1	159		\$	\$
11	5PMOFSTFMACUSBXXXXX	2 duplex power and 2 USB ports TYPE: PM2	13		\$	\$

NSA products (must not exceed 30% of the firm quantity by category)

The Supplier signs, and certifies that all the NSA products offered will conform to all specifications and meet the testing requirements detailed at Annex D.

Section A - IU REQUIREMENT			Section B – SUPPLIER'S BID		
#	NSA Product(s) Description	Qty	Supplier Part Number	Firm Unit Price \$	Extended Total [Qty x Price] \$
12	Similar to GoCUID 1BFFHREC24L72WNOANY 460mm width x 1829mm length x standard height. Rectangular free-standing work surface, T-legs, No modesty panel. TYPE: SU2	10		\$	\$
13	Similar to GoCUID 1BFFHREN24L30WNOLNY. 610mm width x 610mm length x standard height. Rectangular work surface, panel mounted. TYPE: SU4	85		\$	\$
			Product Total		\$

Table 2 - Delivery

Section A - IU REQUIREMENT				Section B – SUPPLIER'S BID	
Product Item # from Table 1	Location	Estimated Date** (Y/M/D)	Desired Time*	Supplier will supply and deliver as per below**	Firm Lot Price \$
1-13	141 Colonnade Road Nepean, Ontario K2E 7L9 1 st and 2 nd Floor	2019-11-01	Normal Business Hours	_____ : weeks	\$
<p>*Normal Business Hours 8:00 – 17:00, as per SA, Annex A, article 5</p> <p>**The Project Authority (PA) will provide the supplier the authority to proceed prior to the finalized delivery date taking into consideration the delivery time provided by the supplier. Canada will not be responsible if the supplier chooses to proceed without the PA authorization.</p> <p>Supplier and Project Authority to coordinate before ordering and coordination purposes.</p>				Delivery Total:	\$

Table 3 – Installation

Section A - IU REQUIREMENT				Section B – SUPPLIER'S BID	
Product Item # from Table 1	Location	Estimated Date** (Y/M/D)	Desired Time*	Supplier will install as per below**	Firm Lot Price \$
1-13	141 Colonnade Road Nepean, Ontario K2E 7L9 1 st and 2 nd Floor	From November 4 th to November 15 th , 2019.	Normal Business Hours	_____ : weeks from date of supply and delivery	\$
<p>*Normal Business Hours 8:00 – 17:00, as per SA, Annex A, article 5</p> <p>**The Project Authority (PA) will provide the supplier the authority to proceed prior to the finalized installation date taking into consideration the installation time provided by the supplier. Canada will not be responsible if the supplier chooses to proceed without the PA authorization.</p> <p>Supplier and Project Authority to coordinate before ordering and coordination purposes.</p>				Installation Total:	\$

Solicitation No. - N° de l'invitation
EP076-200248/A
Client Ref. No. - N° de réf. du client
EP076-200248

Amd. No. - N° de la modif.
File No. - N° du dossier
pq999 EP076-200248

Buyer ID - Id de l'acheteur
pq999
CCC No./N° CCC - FMS No./N° VME

Table 4 – Optional Product
Table 5 – Optional Delivery
Table 6 – Optional Installation

☒ Not Applicable
☒ Not Applicable
☒ Not Applicable

Table 7 – Standard Finishes and Canada's Facilities to Accommodate the Delivery and Certifications

1.	Standard Finishes	
1.1	<p>IU is to consult the Supplier's Website identified in Part 6A of the SA to view the available finishes.</p> <p>Within ten business days of the contract award, the Project Authority will provide the Contractor with a written notice of Canada's finish choices for each of the product(s) in Annex A.</p> <p>The Contractor will deliver the products corresponding to Canada's choice of specific finishes(s). No additional charge will be applied to Canada.</p>	
2.	<p>Canada's Facilities to Accommodate the Delivery <i>The Supplier's employees and subcontractors requiring access to the site must adhere to the health and safety plans established for the site, in addition to any laws in effect in the jurisdiction where the work is being performed.</i></p> <p><i>During the period of the contract, a representative of Canada or a service provider(s) under contract with the Government of Canada may request the list of employees and subcontractors requiring access to the site to perform the work and their security statuses. Information must be provided in the timeframe prescribed in order to ensure that the supply, delivery and installation of the furniture aligns with the master schedule.</i></p>	
2.1	Loading Dock/Location	
A	Location	141 Colonnade Rd, Nepean ON K2E7L9
B	Dock	See images attached
C	Lift	N/A
D	Door	[Size – 9' H x 8' W]
E	Freight Elevator	It's a passenger elevator. Dimensions (currently protected) = 64" wide x 48" deep.
F	Other (specify, if any)	
3.	Continuance of Certifications	
	<p>The Bidder certifies that by submitting a bid in response to the RFB, the Bidder, and any of the Bidder's members if the Bidder is a Joint Venture, continues to comply with all of the following certifications listed in Parts 6A and 6B of the Bidder's SA for Work Spaces.</p> <p>Canada may request copies of environmental certification(s) prior to contract award within a time period specified by the Identified User.</p>	
3.1	Integrity Provisions	
3.2	Federal Contractor's Program for Employment Equity	
3.4	Product Conformance	
3.5	Price Certification (In accordance with the SA, Part 6B)	

Solicitation No. - N° de l'invitation
EP076-200248/A
Client Ref. No. - N° de réf. du client
EP076-200248

Amd. No. - N° de la modif.
File No. - N° du dossier
pq999 EP076-200248

Buyer ID - Id de l'acheteur
pq999
CCC No./N° CCC - FMS No./N° VME

Table 8 - Bid Evaluation and Contract Total *(Canada may complete if not completed by the Bidder)*

1	Firm Product Total (Table 1)	\$
2	Firm Delivery Total (Table 2)	\$
3	Firm Installation Total (Table 3)	\$
4	Optional Product Total (Table 4)	n/a
5	Optional Delivery Total (Table 5)	n/a
6	Optional Installation Total (Table 6)	n/a
7	Hardware Total as per article 1.5 of Annex A-1 of SA <i>(if Applicable)</i>	\$
8	Total Evaluated (Bid) Price* (1 + 2 + 3 + 4 + 5 + 6 + 7) <i>[to be removed at contract award]</i>	\$
9	Contract Price(1+2+3+7): <i>[applicable at contract award only]</i>	\$
10	Applicable Tax(es): <i>[applicable at contract award only]</i>	\$
11	Total Estimated Cost (9+10): <i>[applicable at contract award only]</i>	\$

* Applicable taxes extra.

Table 9 – Bidder's Authorized Representative

1.	Bidder's Authorized Representative for the Bid and the Contract	
	Name:	Telephone:
		E-Mail:
		Other:

Product Category: 6A

Table 1 – Product Table

Section A - IU REQUIREMENT				Section B – SUPPLIER'S BID		
#	GoCUID	Description of Product (Additional product details may be inserted, if required as per 6B. 4.1 of the SA)	Qty	Supplier Part Number	Firm Unit Price \$	Extended Total [Qty x Price] \$
Category 6 A						
1	6MMTSMROPL36XXXWNNX	TYPE: TA1	7		\$	\$
2	6CCMVAROPL30XXXPNXX	TYPE: TA2	1		\$	\$
3	6MTRFTRECL30L48WYYY	Power & data TYPE: TA5	48		\$	\$
4	6CSTVAROPL24XXXJNXX	TYPE: TA7	22		\$	\$
5	6CCTVAROPL30XXXJNXX	TYPE: TA8	6		\$	\$
6	6CLTVAREXLW7<36ONXX	TYPE: TA9	25		\$	\$
7	6CKIVAREGL30L72TYXX	Power & data TYPE: TA12	12		\$	\$
8	6CMUHADSRL54L78XYXX	Power & data TYPE: TA13	8		\$	\$
9	6MTRXTRELL30L60WYYY	Power & data TYPE: TA17	4		\$	\$
10	6ZFHLXX18L60HSDSDKX	TYPE: CR1	4		\$	\$
11	6KBSCHxxSY15XXXPOYX	TYPE: ST1	28		\$	\$

Table 2 - Delivery

Section A - IU REQUIREMENT				Section B – SUPPLIER'S BID	
Product Item # from Table 1	Location	Estimated Date** (Y/M/D)	Desired Time*	Supplier will supply and deliver as per below**	Firm Lot Price \$
1-11	141 Colonnade Road Nepean, Ontario K2E 7L9 1 st and 2 nd Floor	2019-11-01	Normal Business Hours	_____ : weeks	\$
<p>*Normal Business Hours 8:00 – 17:00, as per SA, Annex A, article 5</p> <p>**The Project Authority (PA) will provide the supplier the authority to proceed prior to the finalized delivery date taking into consideration the delivery time provided by the supplier. Canada will not be responsible if the supplier chooses to proceed without the PA authorization.</p> <p>Supplier and Project Authority to coordinate before ordering and coordination purposes.</p>				Delivery Total:	\$

Solicitation No. - N° de l'invitation
EP076-200248/A
Client Ref. No. - N° de réf. du client
EP076-200248

Amd. No. - N° de la modif.
File No. - N° du dossier
pq999 EP076-200248

Buyer ID - Id de l'acheteur
pq999
CCC No./N° CCC - FMS No./N° VME

Table 3 – Installation

Section A - IU REQUIREMENT				Section B – SUPPLIER'S BID	
Product Item # from Table 1	Location	Estimated Date** (Y/M/D)	Desired Time*	Supplier will install as per below**	Firm Lot Price \$
1-11	141 Colonnade Road Nepean, Ontario K2E 7L9 1 st and 2 nd Floor	From November 4 th to November 15 th , 2019.	Normal Business Hours	_____ : weeks from date of supply and delivery	\$
<p>*Normal Business Hours 8:00 – 17:00, as per SA, Annex A, article 5</p> <p>**The Project Authority (PA) will provide the supplier the authority to proceed prior to the finalized installation date taking into consideration the installation time provided by the supplier. Canada will not be responsible if the supplier chooses to proceed without the PA authorization.</p> <p>Supplier and Project Authority to coordinate before ordering and coordination purposes.</p>				Installation Total:	\$

Table 4 – Optional Product
Table 5 – Optional Delivery
Table 6 – Optional Installation

☒ Not Applicable
☒ Not Applicable
☒ Not Applicable

Table 7 – Standard Finishes and Canada's Facilities to Accommodate the Delivery and Certifications

1.	Standard Finishes	
1.1	<p>IU is to consult the Supplier's Website identified in Part 6A of the SA to view the available finishes.</p> <p>Within ten business days of the contract award, the Project Authority will provide the Contractor with a written notice of Canada's finish choices for each of the product(s) in Annex A.</p> <p>The Contractor will deliver the products corresponding to Canada's choice of specific finishes(s). No additional charge will be applied to Canada.</p>	
2.	<p>Canada's Facilities to Accommodate the Delivery</p> <p><i>The Supplier's employees and subcontractors requiring access to the site must adhere to the health and safety plans established for the site, in addition to any laws in effect in the jurisdiction where the work is being performed.</i></p> <p><i>During the period of the contract, a representative of Canada or a service provider(s) under contract with the Government of Canada may request the list of employees and subcontractors requiring access to the site to perform the work and their security statuses. Information must be provided in the timeframe prescribed in order to ensure that the supply, delivery and installation of the furniture aligns with the master schedule.</i></p>	
2.1	Loading Dock/Location	
A	Location	141 Colonnade Rd, Nepean ON K2E7L9
B	Dock	See images attached
C	Lift	N/A
D	Door	[Size – 9' H x 8' W]
E	Freight Elevator	It's a passenger elevator. Dimensions (currently protected) = 64" wide x 48" deep.
F	Other (specify, if any)	
3.	Continuance of Certifications	
	<p>The Bidder certifies that by submitting a bid in response to the RFB, the Bidder, and any of the Bidder's members if the Bidder is a Joint Venture, continues to comply with all of the following certifications listed in Parts 6A and 6B of the Bidder's SA for Work Spaces.</p> <p>Canada may request copies of environmental certification(s) prior to contract award within a time period specified by the Identified User.</p>	
3.1	Integrity Provisions	
3.2	Federal Contractor's Program for Employment Equity	
3.4	Product Conformance	
3.5	Price Certification (In accordance with the SA, Part 6B)	

Solicitation No. - N° de l'invitation
EP076-200248/A
Client Ref. No. - N° de réf. du client
EP076-200248

Amd. No. - N° de la modif.
File No. - N° du dossier
pq999 EP076-200248

Buyer ID - Id de l'acheteur
pq999
CCC No./N° CCC - FMS No./N° VME

Table 8 - Bid Evaluation and Contract Total *(Canada may complete if not completed by the Bidder)*

1	Firm Product Total (Table 1)	\$
2	Firm Delivery Total (Table 2)	\$
3	Firm Installation Total (Table 3)	\$
4	Optional Product Total (Table 4)	n/a
5	Optional Delivery Total (Table 5)	n/a
6	Optional Installation Total (Table 6)	n/a
7	Hardware Total as per article 1.5 of Annex A-1 of SA <i>(if Applicable)</i>	\$
8	Total Evaluated (Bid) Price* (1 + 2 + 3 + 4 + 5 + 6+ 7) <i>[to be removed at contract award]</i>	\$
9	Contract Price (1+2+3+7): <i>[applicable at contract award only]</i>	\$
10	Applicable Tax(es) : <i>[applicable at contract award only]</i>	\$
11	Total Estimated Cost (9+10): <i>[applicable at contract award only]</i>	\$

* Applicable taxes extra.

Table 9 – Bidder's Authorized Representative

1.	Bidder's Authorized Representative for the Bid and the Contract		
	Name:	Telephone:	
		E-Mail:	
		Other:	

Solicitation No. - N° de l'invitation
EP076-200248/A
Client Ref. No. - N° de réf. du client
EP076-200248

Amd. No. - N° de la modif.
File No. - N° du dossier
pq999 EP076-200248

Buyer ID - Id de l'acheteur
pq999
CCC No./N° CCC - FMS No./N° VME

Product Category: 6B

Table 1 – Product Table

Section A - IU REQUIREMENT				Section B – SUPPLIER'S BID		
#	GoCUID	Description of Product	Qty	Supplier Part Number	Firm Unit Price \$	Extended Total [Qty x Price] \$
Category 6 B						
1	6MMTSMREPL30L48WNNX	TYPE: TA4	1		\$	\$
2	6MMTSMROPL30XXXWNNX	TYPE: TA3	4		\$	\$
3	6MMTMDREOL36L96WYXX	Power & data TYPE: TA6	10		\$	\$
4	6CKIVAREGL30L60PYXX	Power & data TYPE: TA10	1		\$	\$
5	6CKIVAREGL30L72PYXX	Power & data TYPE: TA11	1		\$	\$
6	6CCMVAROPL36XXXPNNX	TYPE: TA14	1		\$	\$
7	6MMTMDREOL36L72WYXX	Power & data TYPE: TA15	7		\$	\$
8	6SBBTWXXLUW3G19LMNN	With 355mm mid-height seat back, 1200mm – 1250mm length, no power. TYPE: BQ1A	30		\$	\$
9	6SBBTHXXLUW5G19LMYY	Privacy screen on one side only, 3 seats, bolster and high back screen 1800mm – 1850mm in length. Privacy screen height must be 1372mm above finished floor. TYPE: BQ4 	2		\$	\$
10	6SLCWAXXWUXXXXXMXXX	TYPE: LC2	8		\$	\$
11	6SLCOAXXFUXXXXXMXXX	High back lounge chair, armless, fixed base, fabric, must be from same series as item 19 - upholstered stool (OT5). Chair back height to be 762mm minimum from seat top. TYPE: LC3	9		\$	\$
12	6SLCOAXXWUXXXXXMXXX	TYPE: LC1	18		\$	\$
13	6STCWRXXLUXXXXXNNX	TYPE: CH3R	21		\$	\$
14	6STCWLXXLUXXXXXNNX	TYPE: CH3L	16		\$	\$
15	6SUOPRXXLUXXXXLNNN	TYPE: OT2	13		\$	\$

Solicitation No. - N° de l'invitation
EP076-200248/A
Client Ref. No. - N° de réf. du client
EP076-200248

Amd. No. - N° de la modif.
File No. - N° du dossier
pq999 EP076-200248

Buyer ID - Id de l'acheteur
pq999
CCC No./N° CCC - FMS No./N° VME

16	6SUOLRXXLUXXXXXLNNN	TYPE: OT3	4		\$	\$
17	6SUCROXXLUX8XXXLXXX	TYPE: OT4	21		\$	\$
18	6SUSROXXLUX8XXXLXXX	TYPE: OT1	25		\$	\$
19	6SUSROXXLUX8XXXLXXX	Upholstered stool, solid round seat, must be from same product line as lounge chair (LC3). TYPE: OT5	9		\$	\$
20	6SMORBXXLU25G19LYNN	High back, 915mm – 1067mm length, fabric. LC5 & LC6 must have the same height backs. TYPE: LC5	9		\$	\$
21	6SMPRBXXLU25G19LYNN	High back, 1524mm – 1676mm length, with power. LC5 & LC6 must have the same height backs. TYPE: LC6	5		\$	\$
22	6LWBFWWXXXXXXXNNN	TYPE: WB1	5		\$	\$
23	6LMMDMWSXDW8XXXNNN	TYPE: MS1	5		\$	\$
24	6LFSUPXXXXW8XXXTXXX	TYPE: FS1	18		\$	\$
25	6KBSBHxxSY15XXXROYX	TYPE: ST2	24		\$	\$
26	6KKCSAxxSP16XXXMOYX	TYPE: CH4	49		\$	\$
27	6SMPCBXXLU37G19LYNN	Include same power and data requirement as 6SMOCBXXLU37G19LYNN. Back height must be 1271mm – 1321mm above finished floor. TYPE: LC4	8		\$	\$

NSA products (must not exceed 30% of the firm quantity by category)

The Supplier signs, and certifies that all the NSA products offered will conform to all specifications and meet the testing requirements detailed at Annex D.

Section A - IU REQUIREMENT			Section B – SUPPLIER'S BID		
#	NON-SA Product(s)	Qty	Supplier Part Number	Firm Unit Price** \$	Extended Total [Qty x Price] \$
28	305mm deep counter surface attached to seat back of curvilinear, modular lounge seating – back (LC4). Length of counter surface must match length of modular seat back curve. Counter surface product must be compatible with modular lounge seat. Type: SU3	5		\$	\$
29	Similar to product 6MMTMDREOL36L72WYNX (TA15), without power and USB provisions. TYPE: TA16	2		\$	\$
30	Similar to product 6SBBTWXXLUW3G19LLNN – ganging banquette seat without arms, with power. 355mm mid-height seat back, 1200mm – 1250mm length. TYPE: BQ1B	14		\$	\$
31	Similar to product 6SBBTHXXBUW5G19LLYN – ganging banquette seat without arms, with power. 355mm mid-height seat back, 1829mm length. TYPE: BQ2	16		\$	\$

Solicitation No. - N° de l'invitation
EP076-200248/A
 Client Ref. No. - N° de réf. du client
EP076-200248

Amd. No. - N° de la modif.
 File No. - N° du dossier
pq999 EP076-200248

Buyer ID - Id de l'acheteur
pq999
 CCC No./N° CCC - FMS No./N° VME

32	Similar to product 6SBBTHXXBUW5G19LLYN , – ganging banquette seat without arms, with power, with bolster and high back privacy screen, 1800mm – 1850mm length. Privacy screen height must be 1372mm above floor finish. TYPE: BQ3	4		\$	\$
			Product Total		\$



Table 2 - Delivery

Section A - IU REQUIREMENT				Section B – SUPPLIER'S BID	
Product Item # from Table 1	Location	Estimated Date** (Y/M/D)	Desired Time*	Supplier will supply and deliver as per below**	Firm Lot Price \$
1-32	141 Colonnade Road Nepean, Ontario K2E 7L9 1 st and 2 nd Floor	2019-11-01	Normal Business Hours	_____ : weeks	\$
*Normal Business Hours 8:00 – 17:00, as per SA, Annex A, article 5 **The Project Authority (PA) will provide the supplier the authority to proceed prior to the finalized delivery date taking into consideration the delivery time provided by the supplier. Canada will not be responsible if the supplier chooses to proceed without the PA authorization. Supplier and Project Authority to coordinate before ordering and coordination purposes.				Delivery Total:	\$

Table 3 – Installation

Section A - IU REQUIREMENT				Section B – SUPPLIER'S BID	
Product Item # from Table 1	Location	Estimated Date** (Y/M/D)	Desired Time*	Supplier will install as per below**	Firm Lot Price \$
1-32	141 Colonnade Road Nepean, Ontario K2E 7L9 1 st and 2 nd Floor	From November 4 th to November 15 th , 2019	Normal Business Hours	_____ : weeks from date of supply and delivery	\$
<p>*Normal Business Hours 8:00 – 17:00, as per SA, Annex A, article 5</p> <p>**The Project Authority (PA) will provide the supplier the authority to proceed prior to the finalized installation date taking into consideration the installation time provided by the supplier. Canada will not be responsible if the supplier chooses to proceed without the PA authorization.</p> <p>Supplier and Project Authority to coordinate before ordering and coordination purposes.</p>				Installation Total:	\$

Table 4 – Optional Product

☒ Not Applicable

Table 5 – Optional Delivery

☒ Not Applicable

Table 6 – Optional Installation

☒ Not Applicable

Table 7 – Standard Finishes and Canada's Facilities to Accommodate the Delivery and Certifications

1.	Standard Finishes	
1.1	<p>IU is to consult the Supplier's Website identified in Part 6A of the SA to view the available finishes.</p> <p>Within ten business days of the contract award, the Project Authority will provide the Contractor with a written notice of Canada's finish choices for each of the product(s) in Annex A.</p> <p>The Contractor will deliver the products corresponding to Canada's choice of specific finishes(s). No additional charge will be applied to Canada.</p>	
2.	<p>Canada's Facilities to Accommodate the Delivery</p> <p><i>The Supplier's employees and subcontractors requiring access to the site must adhere to the health and safety plans established for the site, in addition to any laws in effect in the jurisdiction where the work is being performed.</i></p> <p><i>During the period of the contract, a representative of Canada or a service provider(s) under contract with the Government of Canada may request the list of employees and subcontractors requiring access to the site to perform the work and their security statuses. Information must be provided in the timeframe prescribed in order to ensure that the supply, delivery and installation of the furniture aligns with the master schedule.</i></p>	
2.1	Loading Dock/Location	
A	Location	141 Colonnade Rd, Nepean ON K2E7L9
B	Dock	See images attached
C	Lift	N/A
D	Door	[Size – 9' H x 8' W]
E	Freight Elevator	It's a passenger elevator. Dimensions (currently protected) = 64" wide x 48" deep.
F	Other (specify, if any)	
3.	Continuance of Certifications	
	<p>The Bidder certifies that by submitting a bid in response to the RFB, the Bidder, and any of the Bidder's members if the Bidder is a Joint Venture, continues to comply with all of the following certifications listed in Parts 6A and 6B of the Bidder's SA for Work Spaces.</p> <p>Canada may request copies of environmental certification(s) prior to contract award within a time period specified by the Identified User.</p>	
3.1	Integrity Provisions	
3.2	Federal Contractor's Program for Employment Equity	
3.4	Product Conformance	
3.5	Price Certification (In accordance with the SA, Part 6B)	

Solicitation No. - N° de l'invitation
EP076-200248/A
Client Ref. No. - N° de réf. du client
EP076-200248

Amd. No. - N° de la modif.
File No. - N° du dossier
pq999 EP076-200248

Buyer ID - Id de l'acheteur
pq999
CCC No./N° CCC - FMS No./N° VME

Table 8 - Bid Evaluation and Contract Total (Canada may complete if not completed by the Bidder)

1	Firm Product Total (Table 1)	\$
2	Firm Delivery Total (Table 2)	\$
3	Firm Installation Total (Table 3)	\$
4	Optional Product Total (Table 4)	n/a
5	Optional Delivery Total (Table 5)	n/a
6	Optional Installation Total (Table 6)	n/a
7	Hardware Total as per article 1.5 of Annex A-1 of SA <i>(if Applicable)</i>	\$
8	Total Evaluated (Bid) Price* (1 + 2 + 3 + 4 + 5 + 6+ 7) <i>[to be removed at contract award]</i>	\$
9	Contract Price(1+2+3+7): <i>[applicable at contract award only]</i>	\$
10	Applicable Tax(es): <i>[applicable at contract award only]</i>	\$
11	Total Estimated Cost (9+10): <i>[applicable at contract award only]</i>	\$

* Applicable taxes extra.

Table 9 – Bidder's Authorized Representative

1.	Bidder's Authorized Representative for the Bid and the Contract		
	Name:	Telephone:	
		E-Mail:	
		Other:	

Solicitation No. - N° de l'invitation
EP076-200248/A
Client Ref. No. - N° de réf. du client
EP076-200248

Amd. No. - N° de la modif.
File No. - N° du dossier
pq999 EP076-200248

Buyer ID - Id de l'acheteur
pq999
CCC No./N° CCC - FMS No./N° VME

Product Category: 6C

NSA products <i>(Must not exceed 30% of the firm quantity by category)</i>					
The Supplier signs, and certifies that all the NSA products offered will conform to all specifications and meet the testing requirements detailed at Annex D.					
Section A - IU REQUIREMENT			Section B – SUPPLIER’S BID		
#	NON-SA Product(s)	Qty	Supplier Part Number	Firm Unit Price** \$	Extended Total [Qty x Price] \$
1	<p>Group work pod, with sofa and privacy screen</p> <p><u>Dimensions</u></p> <p>Overall height including privacy screen(s) must be a minimum of 1194mm (47in.) and a maximum of 1372mm (54in.). Overall diameter foot print of unit must comply with the layout on the floor plan.</p> <p><u>Power and Data</u></p> <p>The « pod » offered in Category 6 will not accept Interconnecting Systems Furniture Panels as a solution for this unit.</p> <p><u>Supports</u></p> <p>Corner of the screens must be rounded, screens which connect at a square or 90 degree angle are not acceptable.</p> <p>Item FP1, FP2 and GWP1 of this list must be from same Manufacture and furniture series.</p> <p>TYPE: GWP1</p>	1		\$	\$

2	<p>Individual private lounge chair with screen and tablet arm</p> <p><u>Description</u></p> <p>Freestanding unit including upholstered lounge chair with privacy screens(s) must be from the same product series.</p> <p>The lounge chair must fit and follow the curvilinear interior shape of the screens.</p> <p><u>Dimensions</u></p> <p>Overall height including privacy screen(s) must be a minimum of 1194mm (47in.) and a maximum of 1372mm (54in.). Overall diameter foot print of unit must comply with the layout on the floor plan.</p> <p><u>Power and Data</u></p> <p>Must provide a combination power & USB outlet located on the chair, easily accessible to the user, The « pod » offered in Category 6 will not accept Interconnecting Systems Furniture Panels as a solution for this unit.</p> <p><u>Supports</u></p> <p>Corner of the screens must be rounded, screens which connect at a square or 90 degree angle are not acceptable.</p> <p>Support for the work surface must be formed to the privacy screen and must have the appearance to be supported by the screen, however it's freestanding.</p> <p>Item FP1, FP2 and GWP1 of this list must be from same Manufacture and furniture series.</p> <p>TYPE: FP1</p>	13		\$	\$
3	<p>Individual private lounge chair (FP1). Must have additional privacy screen extension and tablet arm.</p> <p><u>Dimensions</u></p> <p>Overall height including privacy screen(s) must be a minimum of 1194mm (47in.) and a maximum of 1372mm (54in.). Overall diameter foot print of unit must comply with the layout on the floor plan</p> <p><u>Power and Data</u></p> <p>Must provide a combination power & USB outlet located on the chair, easily accessible to the user. The « pod » offered in Category 6 will not accept Interconnecting Systems Furniture Panels as a solution for this unit.</p>	5		\$	\$

Solicitation No. - N° de l'invitation
EP076-200248/A
Client Ref. No. - N° de réf. du client
EP076-200248

Amd. No. - N° de la modif.
File No. - N° du dossier
pq999 EP076-200248

Buyer ID - Id de l'acheteur
pq999
CCC No./N° CCC - FMS No./N° VME

<p><u>Supports</u></p> <p>Corner of the screens must be rounded, screens which connect at a square or 90 degree angle are not acceptable.</p> <p>Item FP1, FP2 and GWP1 of this list must be from same Manufacture and furniture series.</p> <p>TYPE: FP2</p>				
		Product Total	\$	

Table 2 - Delivery

Section A - IU REQUIREMENT				Section B – SUPPLIER'S BID	
Product Item # from Table 1	Location	Estimated Date** (Y/M/D)	Desired Time*	Supplier will supply and deliver as per below**	Firm Lot Price \$
1-3	141 Colonnade Road Nepean, Ontario K2E 7L9 1 st and 2 nd Floor	2019-11-01	Normal Business Hours	_____ : weeks	\$
<p>*Normal Business Hours 8:00 – 17:00, as per SA, Annex A, article 5</p> <p>**The Project Authority (PA) will provide the supplier the authority to proceed prior to the finalized delivery date taking into consideration the delivery time provided by the supplier. Canada will not be responsible if the supplier chooses to proceed without the PA authorization.</p> <p>Supplier and Project Authority to coordinate before ordering and coordination purposes.</p>				Delivery Total:	\$

Table 3 – Installation

Section A - IU REQUIREMENT				Section B – SUPPLIER'S BID	
Product Item # from Table 1	Location	Estimated Date** (Y/M/D)	Desired Time*	Supplier will install as per below**	Firm Lot Price \$
1-3	141 Colonnade Road Nepean, Ontario K2E 7L9 1 st and 2 nd Floor	From November 4 th to November 15 th , 2019	Normal Business Hours	_____ : weeks from date of supply and delivery	\$
<p>*Normal Business Hours 8:00 – 17:00, as per SA, Annex A, article 5</p> <p>**The Project Authority (PA) will provide the supplier the authority to proceed prior to the finalized installation date taking into consideration the installation time provided by the supplier. Canada will not be responsible if the supplier chooses to proceed without the PA authorization.</p> <p>Supplier and Project Authority to coordinate before ordering and coordination purposes.</p>				Installation Total:	\$

Table 4 – Optional Product
Table 5 – Optional Delivery
Table 6 – Optional Installation

☒ Not Applicable
☒ Not Applicable
☒ Not Applicable

Table 7 – Standard Finishes and Canada's Facilities to Accommodate the Delivery and Certifications

1.	Standard Finishes	
1.1	<p>IU is to consult the Supplier's Website identified in Part 6A of the SA to view the available finishes.</p> <p>Within ten business days of the contract award, the Project Authority will provide the Contractor with a written notice of Canada's finish choices for each of the product(s) in Annex A.</p> <p>The Contractor will deliver the products corresponding to Canada's choice of specific finishes(s). No additional charge will be applied to Canada.</p>	
2.	<p>Canada's Facilities to Accommodate the Delivery <i>The Supplier's employees and subcontractors requiring access to the site must adhere to the health and safety plans established for the site, in addition to any laws in effect in the jurisdiction where the work is being performed.</i></p> <p><i>During the period of the contract, a representative of Canada or a service provider(s) under contract with the Government of Canada may request the list of employees and subcontractors requiring access to the site to perform the work and their security statuses. Information must be provided in the timeframe prescribed in order to ensure that the supply, delivery and installation of the furniture aligns with the master schedule.</i></p>	
2.1	Loading Dock/Location	
A	Location	141 Colonnade Rd, Nepean ON K2E7L9
B	Dock	See images attached
C	Lift	N/A
D	Door	[Size – 9' H x 8' W]
E	Freight Elevator	It's a passenger elevator. Dimensions (currently protected) = 64" wide x 48" deep.
F	Other (specify, if any)	
3.	Continuance of Certifications	
	<p>The Bidder certifies that by submitting a bid in response to the RFB, the Bidder, and any of the Bidder's members if the Bidder is a Joint Venture, continues to comply with all of the following certifications listed in Parts 6A and 6B of the Bidder's SA for Work Spaces.</p> <p>Canada may request copies of environmental certification(s) prior to contract award within a time period specified by the Identified User.</p>	
3.1	Integrity Provisions	
3.2	Federal Contractor's Program for Employment Equity	
3.4	Product Conformance	
3.5	Price Certification (In accordance with the SA, Part 6B)	

Table 8 - Bid Evaluation and Contract Total (Canada may complete if not completed by the Bidder)

1	Firm Product Total (Table 1)	\$
2	Firm Delivery Total (Table 2)	\$
3	Firm Installation Total (Table 3)	\$
4	Optional Product Total (Table 4)	n/a
5	Optional Delivery Total (Table 5)	n/a
6	Optional Installation Total (Table 6)	n/a
7	Hardware Total as per article 1.5 of Annex A-1 of SA <i>(if Applicable)</i>	\$
8	Total Evaluated (Bid) Price* (1 + 2 + 3 + 4 + 5 + 6 + 7) <i>[to be removed at contract award]</i>	\$
9	Contract Price (1+2+3+7): <i>[applicable at contract award only]</i>	\$
10	Applicable Tax(es): <i>[applicable at contract award only]</i>	\$
11	Total Estimated Cost (9+10): <i>[applicable at contract award only]</i>	\$

* Applicable taxes extra.

Solicitation No. - N° de l'invitation
EP076-200248/A
Client Ref. No. - N° de réf. du client
EP076-200248

Amd. No. - N° de la modif.
File No. - N° du dossier
pq999 EP076-200248

Buyer ID - Id de l'acheteur
pq999
CCC No./N° CCC - FMS No./N° VME

Table 9 – Bidder’s Authorized Representative

1.	Bidder’s Authorized Representative for the Bid and the Contract	
	Name:	Telephone:
		E-Mail:
		Other:

Solicitation No. - N° de l'invitation
EP076-200248/A
Client Ref. No. - N° de réf. du client
EP076-200248

Amd. No. - N° de la modif.
File No. - N° du dossier
pq999 EP076-200248

Buyer ID - Id de l'acheteur
pq999
CCC No./N° CCC - FMS No./N° VME

ANNEX B
SECURITY REQUIREMENTS

The security requirements set out in the attached Security Requirements Check List (SRCL) and in the terms below apply to and form part of the Contract.

1. The Contractor/Offeror must, at all times during the performance of the Contract/Standing Offer, hold a valid Designated Organization Screening (DOS), issued by the Canadian Industrial Security Directorate (CISD), Public Works and Government Services Canada (PWGSC).
2. The Contractor/Offeror personnel requiring access to sensitive work site(s) must EACH hold a valid RELIABILITY STATUS, granted or approved by CISD/PWGSC.
3. Subcontracts which contain security requirements are NOT to be awarded without the prior written permission of CISD/PWGSC.
4. The Contractor/Offeror must comply with the provisions of the:
 - a) Security Requirements Check List and security guide (if applicable), attached at Annex B;
 - b) *Industrial Security Manual* (Latest Edition).

Solicitation No. - N° de l'invitation
EP076-200248/A
Client Ref. No. - N° de réf. du client
EP076-200248

Amd. No. - N° de la modif.
File No. - N° du dossier
pq999 EP076-200248

Buyer ID - Id de l'acheteur
pq999
CCC No./N° CCC - FMS No./N° VME



Government
of Canada

Gouvernement
du Canada

Contract Number / Numéro du contrat

EP076 20 0248

Security Classification / Classification de sécurité
UNCLASSIFIED

SECURITY REQUIREMENTS CHECK LIST (SRCL)

LISTE DE VÉRIFICATION DES EXIGENCES RELATIVES À LA SÉCURITÉ (LVERS)

PART A - CONTRACT INFORMATION / PARTIE A - INFORMATION CONTRACTUELLE			
1. Originating Government Department or Organization / Ministère ou organisme gouvernemental d'origine		Public Works and Government Services Canada	
2. Branch or Directorate / Direction générale ou Direction		Real Property Branch	
3. a) Subcontract Number / Numéro du contrat de sous-traitance		3. b) Name and Address of Subcontractor / Nom et adresse du sous-traitant	
4. Brief Description of Work / Brève description du travail 141 Colonnade 1&2 Floor Fit-up (SA Cat)			
5. a) Will the supplier require access to Controlled Goods? Le fournisseur aura-t-il accès à des marchandises contrôlées?		<input checked="" type="checkbox"/> No Non	<input type="checkbox"/> Yes Oui
5. b) Will the supplier require access to unclassified military technical data subject to the provisions of the Technical Data Control Regulations? Le fournisseur aura-t-il accès à des données techniques militaires non classifiées qui sont assujetties aux dispositions du Règlement sur le contrôle des données techniques?		<input checked="" type="checkbox"/> No Non	<input type="checkbox"/> Yes Oui
6. Indicate the type of access required / Indiquer le type d'accès requis			
6. a) Will the supplier and its employees require access to PROTECTED and/or CLASSIFIED information or assets? Le fournisseur ainsi que les employés auront-ils accès à des renseignements ou à des biens PROTÉGÉS et/ou CLASSIFIÉS? (Specify the level of access using the chart in Question 7. c) (Préciser le niveau d'accès en utilisant le tableau qui se trouve à la question 7. c)		<input checked="" type="checkbox"/> No Non	<input type="checkbox"/> Yes Oui
6. b) Will the supplier and its employees (e.g. cleaners, maintenance personnel) require access to restricted access areas? No access to PROTECTED and/or CLASSIFIED information or assets is permitted. Le fournisseur et ses employés (p. ex. nettoyeurs, personnel d'entretien) auront-ils accès à des zones d'accès restreintes? L'accès à des renseignements ou à des biens PROTÉGÉS et/ou CLASSIFIÉS n'est pas autorisé.		<input type="checkbox"/> No Non	<input checked="" type="checkbox"/> Yes Oui
6. c) Is this a commercial courier or delivery requirement with no overnight storage? S'agit-il d'un contrat de messagerie ou de livraison commerciale sans entreposage de nuit?		<input checked="" type="checkbox"/> No Non	<input type="checkbox"/> Yes Oui
7. a) Indicate the type of information that the supplier will be required to access / Indiquer le type d'information auquel le fournisseur devra avoir accès			
Canada <input type="checkbox"/>		NATO / OTAN <input type="checkbox"/>	Foreign / Étranger <input type="checkbox"/>
7. b) Release restrictions / Restrictions relatives à la diffusion			
No release restrictions Aucune restriction relative à la diffusion <input type="checkbox"/>		All NATO countries Tous les pays de l'OTAN <input type="checkbox"/>	No release restrictions Aucune restriction relative à la diffusion <input type="checkbox"/>
Not releasable À ne pas diffuser <input type="checkbox"/>			
Restricted to: / Limité à: <input type="checkbox"/>		Restricted to: / Limité à: <input type="checkbox"/>	Restricted to: / Limité à: <input type="checkbox"/>
Specify country(ies): / Préciser le(s) pays:		Specify country(ies): / Préciser le(s) pays:	Specify country(ies): / Préciser le(s) pays:
7. c) Level of information / Niveau d'information			
PROTECTED A PROTÉGÉ A <input type="checkbox"/>		NATO UNCLASSIFIED NATO NON CLASSIFIÉ <input type="checkbox"/>	PROTECTED A PROTÉGÉ A <input type="checkbox"/>
PROTECTED B PROTÉGÉ B <input type="checkbox"/>		NATO RESTRICTED NATO DIFFUSION RESTREINTE <input type="checkbox"/>	PROTECTED B PROTÉGÉ B <input type="checkbox"/>
PROTECTED C PROTÉGÉ C <input type="checkbox"/>		NATO CONFIDENTIAL NATO CONFIDENTIEL <input type="checkbox"/>	PROTECTED C PROTÉGÉ C <input type="checkbox"/>
CONFIDENTIAL CONFIDENTIEL <input type="checkbox"/>		NATO SECRET NATO SECRET <input type="checkbox"/>	CONFIDENTIAL CONFIDENTIEL <input type="checkbox"/>
SECRET SECRET <input type="checkbox"/>		COSMIC TOP SECRET COSMIC TRÈS SECRET <input type="checkbox"/>	SECRET SECRET <input type="checkbox"/>
TOP SECRET TRÈS SECRET <input type="checkbox"/>			TOP SECRET TRÈS SECRET <input type="checkbox"/>
TOP SECRET (SIGINT) TRÈS SECRET (SIGINT) <input type="checkbox"/>			TOP SECRET (SIGINT) TRÈS SECRET (SIGINT) <input type="checkbox"/>

TBS/SCT 350-103(2004/12)

Security Classification / Classification de sécurité
UNCLASSIFIED

Canada



Government of Canada
Gouvernement du Canada

Contract Number / Numéro du contrat

EP076 20 0248

Security Classification / Classification de sécurité
UNCLASSIFIED

PART A (continued) / PARTIE A (suite)

8. Will the supplier require access to PROTECTED and/or CLASSIFIED COMSEC information or assets?
Le fournisseur aura-t-il accès à des renseignements ou à des biens COMSEC désignés PROTÉGÉS et/ou CLASSIFIÉS? ☒ No ☐ Yes
Non Oui

If Yes, indicate the level of sensitivity:

Dans l'affirmative, indiquer le niveau de sensibilité :

9. Will the supplier require access to extremely sensitive INFOSEC information or assets?
Le fournisseur aura-t-il accès à des renseignements ou à des biens INFOSEC de nature extrêmement délicate? ☒ No ☐ Yes
Non Oui

Short Title(s) of material / Titre(s) abrégé(s) du matériel :

Document Number / Numéro du document :

PART B - PERSONNEL (SUPPLIER) / PARTIE B - PERSONNEL (FOURNISSEUR)

10. a) Personnel security screening level required / Niveau de contrôle de la sécurité du personnel requis

- | | | | |
|---|---|---|--|
| <input checked="" type="checkbox"/> RELIABILITY STATUS
COTE DE FIABILITÉ | <input type="checkbox"/> CONFIDENTIAL
CONFIDENTIEL | <input type="checkbox"/> SECRET
SECRET | <input type="checkbox"/> TOP SECRET
TRÈS SECRET |
| <input type="checkbox"/> TOP SECRET- SIGINT
TRÈS SECRET - SIGINT | <input type="checkbox"/> NATO CONFIDENTIAL
NATO CONFIDENTIEL | <input type="checkbox"/> NATO SECRET
NATO SECRET | <input type="checkbox"/> COSMIC TOP SECRET
COSMIC TRÈS SECRET |
| <input type="checkbox"/> SITE ACCESS
ACCÈS AUX EMPLACEMENTS | | | |

Special comments:

Commentaires spéciaux :

NOTE: If multiple levels of screening are identified, a Security Classification Guide must be provided.

REMARQUE : Si plusieurs niveaux de contrôle de sécurité sont requis, un guide de classification de la sécurité doit être fourni.

10. b) May unscreened personnel be used for portions of the work?
Du personnel sans autorisation sécuritaire peut-il se voir confier des parties du travail? ☒ No ☐ Yes
Non Oui
If Yes, will unscreened personnel be escorted?
Dans l'affirmative, le personnel en question sera-t-il escorté? ☒ No ☐ Yes
Non Oui

PART C - SAFEGUARDS (SUPPLIER) / PARTIE C - MESURES DE PROTECTION (FOURNISSEUR)

INFORMATION / ASSETS / RENSEIGNEMENTS / BIENS

11. a) Will the supplier be required to receive and store PROTECTED and/or CLASSIFIED information or assets on its site or premises?
Le fournisseur sera-t-il tenu de recevoir et d'entreposer sur place des renseignements ou des biens PROTÉGÉS et/ou CLASSIFIÉS? ☒ No ☐ Yes
Non Oui

11. b) Will the supplier be required to safeguard COMSEC information or assets?
Le fournisseur sera-t-il tenu de protéger des renseignements ou des biens COMSEC? ☒ No ☐ Yes
Non Oui

PRODUCTION

11. c) Will the production (manufacture, and/or repair and/or modification) of PROTECTED and/or CLASSIFIED material or equipment occur at the supplier's site or premises?
Les installations du fournisseur serviront-elles à la production (fabrication et/ou réparation et/ou modification) de matériel PROTÉGÉ et/ou CLASSIFIÉ? ☒ No ☐ Yes
Non Oui

INFORMATION TECHNOLOGY (IT) MEDIA / SUPPORT RELATIF À LA TECHNOLOGIE DE L'INFORMATION (TI)

11. d) Will the supplier be required to use its IT systems to electronically process, produce or store PROTECTED and/or CLASSIFIED information or data?
Le fournisseur sera-t-il tenu d'utiliser ses propres systèmes informatiques pour traiter, produire ou stocker électroniquement des renseignements ou des données PROTÉGÉS et/ou CLASSIFIÉS? ☒ No ☐ Yes
Non Oui

11. e) Will there be an electronic link between the supplier's IT systems and the government department or agency?
Disposera-t-on d'un lien électronique entre le système informatique du fournisseur et celui du ministère ou de l'agence gouvernementale? ☒ No ☐ Yes
Non Oui

Solicitation No. - N° de l'invitation
EP076-200248/A
Client Ref. No. - N° de réf. du client
EP076-200248

Amd. No. - N° de la modif.
File No. - N° du dossier
pq999 EP076-200248

Buyer ID - Id de l'acheteur
pq999
CCC No./N° CCC - FMS No./N° VME



Government
of Canada

Gouvernement
du Canada

Contract Number / Numéro du contrat

EP076 20 0248

Security Classification / Classification de sécurité
UNCLASSIFIED

PART C - (continued) / PARTIE C - (suite)

For users completing the form **manually** use the summary chart below to indicate the category(ies) and level(s) of safeguarding required at the supplier's site(s) or premises.

Les utilisateurs qui remplissent le formulaire **manuellement** doivent utiliser le tableau récapitulatif ci-dessous pour indiquer, pour chaque catégorie, les niveaux de sauvegarde requis aux installations du fournisseur.

For users completing the form **online** (via the Internet), the summary chart is automatically populated by your responses to previous questions.

Dans le cas des utilisateurs qui remplissent le formulaire **en ligne** (par Internet), les réponses aux questions précédentes sont automatiquement saisies dans le tableau récapitulatif.

SUMMARY CHART / TABLEAU RÉCAPITULATIF

Category Catégorie	PROTECTED PROTÉGÉ			CLASSIFIED CLASSIFIÉ			NATO				COMSEC					
	A	B	C	CONFIDENTIAL CONFIDENTIEL	SECRET	TOP SECRET TRÈS SECRET	NATO RESTRICTED NATO DIFFUSION RESTREINTE	NATO CONFIDENTIAL NATO CONFIDENTIEL	NATO SECRET	COSMIC TOP SECRET COSMIC TRÈS SECRET	PROTECTED PROTÉGÉ			CONFIDENTIAL	SECRET	TOP SECRET TRÈS SECRET
											A	B	C			
Information / Assets Renseignements / Biens Production																
IT Media / Support TI																
IT Link / Lien électronique																

12. a) Is the description of the work contained within this SRCL PROTECTED and/or CLASSIFIED?

La description du travail visé par la présente LVERS est-elle de nature PROTÉGÉE et/ou CLASSIFIÉE?

☒ No ☐ Yes
Non Oui

If Yes, classify this form by annotating the top and bottom in the area entitled "Security Classification".

Dans l'affirmative, classifiez le présent formulaire en indiquant le niveau de sécurité dans la case intitulée « Classification de sécurité » au haut et au bas du formulaire.

12. b) Will the documentation attached to this SRCL be PROTECTED and/or CLASSIFIED?

La documentation associée à la présente LVERS sera-t-elle PROTÉGÉE et/ou CLASSIFIÉE?

☒ No ☐ Yes
Non Oui

If Yes, classify this form by annotating the top and bottom in the area entitled "Security Classification" and indicate with attachments (e.g. SECRET with Attachments).

Dans l'affirmative, classifiez le présent formulaire en indiquant le niveau de sécurité dans la case intitulée « Classification de sécurité » au haut et au bas du formulaire et indiquer qu'il y a des pièces jointes (p. ex. SECRET avec des pièces jointes).

Solicitation No. - N° de l'invitation
EP076-200248/A
Client Ref. No. - N° de réf. du client
EP076-200248

Amd. No. - N° de la modif.
File No. - N° du dossier
pq999 EP076-200248

Buyer ID - Id de l'acheteur
pq999
CCC No./N° CCC - FMS No./N° VME



Government of Canada
Gouvernement du Canada

Contract Number / Numéro du contrat

EP076 20 0248

Security Classification / Classification de sécurité
UNCLASSIFIED

PART D - AUTHORIZATION / PARTIE D - AUTORISATION

13. Organization Project Authority / Chargé de projet de l'organisme

Name (print) - Nom (en lettres moulées) Frolov, Kostyantyn	Title - Titre Assistant Project Manager	Signature 	Date 2019-05-13
Telephone No. - N° de téléphone 819-775-4549	Facsimile No. - N° de télécopieur 819-775-4549	E-mail address - Adresse courriel kostyantyn.frolov@tpsgc-pwgsc.gc.ca	

14. Organization Security Authority / Responsable de la sécurité de l'organisme

Name (print) - Nom (en lettres moulées) Lamontagne, Stephen	Title - Titre Security Officer	Signature Lamontagne, Stephen	Digitally signed by Lamontagne, Stephen Date: 2019.06.03 13:36:09 -04'00'
Telephone No. - N° de téléphone	Facsimile No. - N° de télécopieur	E-mail address - Adresse courriel	Date

15. Are there additional instructions (e.g. Security Guide, Security Classification Guide) attached?
Des instructions supplémentaires (p. ex. Guide de sécurité, Guide de classification de la sécurité) sont-elles jointes?

☐ No / Non ☐ Yes / Oui

16. Procurement Officer / Agent d'approvisionnement

Name (print) - Nom (en lettres moulées) Shannon MacCraig	Title - Titre Supply Specialist	Signature 	Date 2019-07-29
Telephone No. - N° de téléphone 613 697 0956	Facsimile No. - N° de télécopieur Shannon.maccraig@pwgsc.gc.ca	E-mail address - Adresse courriel	

17. Contracting Security Authority / Autorité contractante en matière de sécurité

Jennifer Ball Contract Security Officer, Contract Security Division Jennifer.Ball@tpsgc-pwgsc.gc.ca Tel/Tél 613-957-1291	Title - Titre	Signature Ball, Jennifer	Digitally signed by Ball, Jennifer Date: 2019.06.05 09:44:29 -04'00'
	- N° de télécopieur	E-mail address - Adresse courriel	Date

ANNEX C
FLOOR PLAN(S)

INSTRUCTIONS TO BIDDERS:

For Category 1a products, the Bidders must provide:

- a) Completed floor plan(s) with proposed SA approved products;
- b) A product listing of proposed SA approved products offered at floor plan(s).
 - As a minimum the product listing must include the following information:
 - Supplier part numbers including NSA products forming part of this category;
 - brief product descriptions;
 - quantities;
 - firm unit prices.

***** Products from categories other than Category 1a shown on floor plan are for information purposes only*****

By submitting a bid, the Bidder certifies that their submission includes all components and quantities for Category 1a, in accordance with the floor plans, panel details, panel matrices and/or workstation layouts stipulated in Annex C.

***At contract award, "By submitting a bid, the Bidder" becomes "The Contractor".**

Category 1A:

1) Floor Plan(s)

See attached pdf and AutoCAD floor plan

Solicitation No. - N° de l'invitation
EP076-200248/A
Client Ref. No. - N° de réf. du client
EP076-200248

Amd. No. - N° de la modif.
File No. - N° du dossier
pq999 EP076-200248

Buyer ID - Id de l'acheteur
pq999
CCC No./N° CCC - FMS No./N° VME

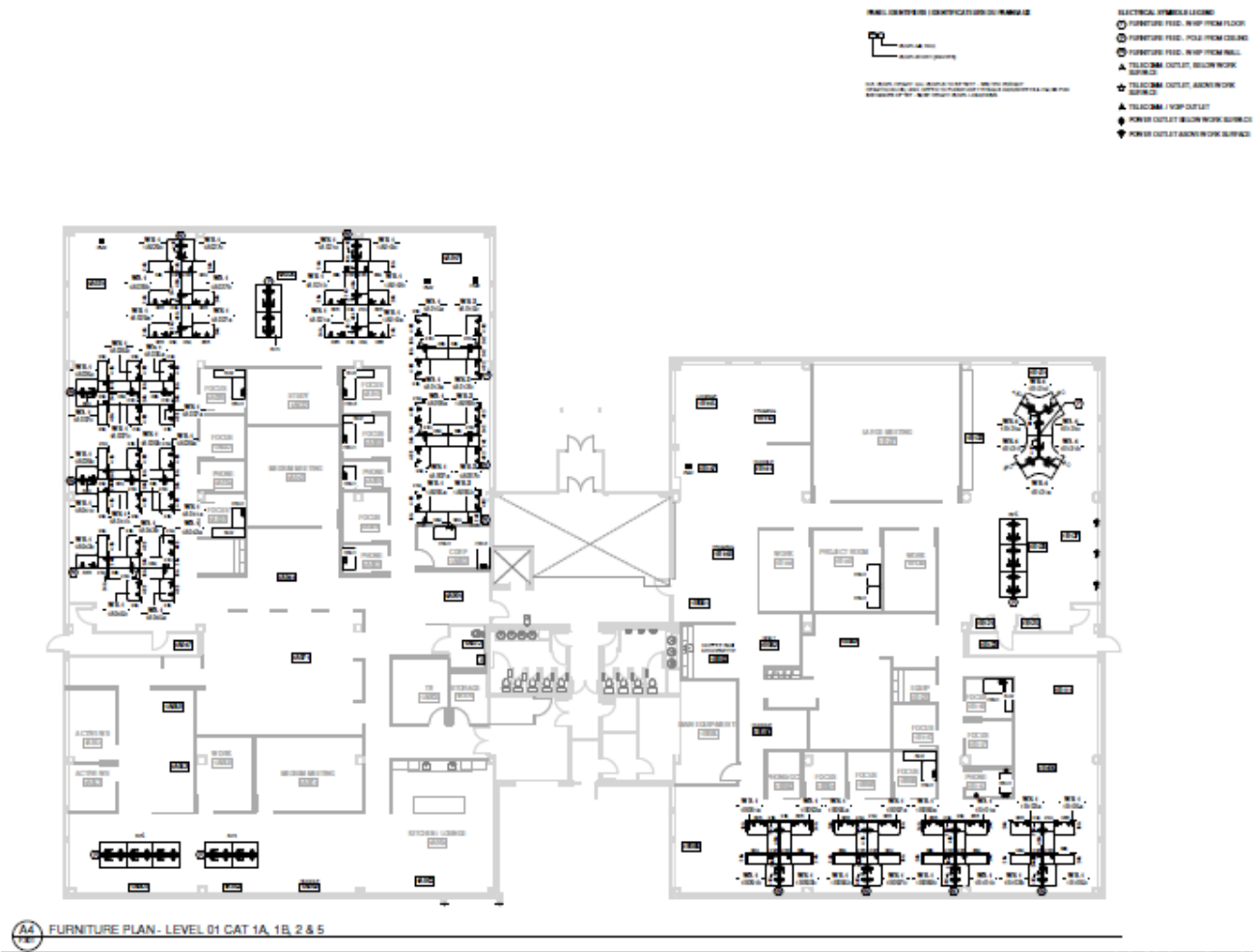

Buyer ID - Id de l'acheteur
pq999
CCC No./N° CCC - FMS No./N° VME

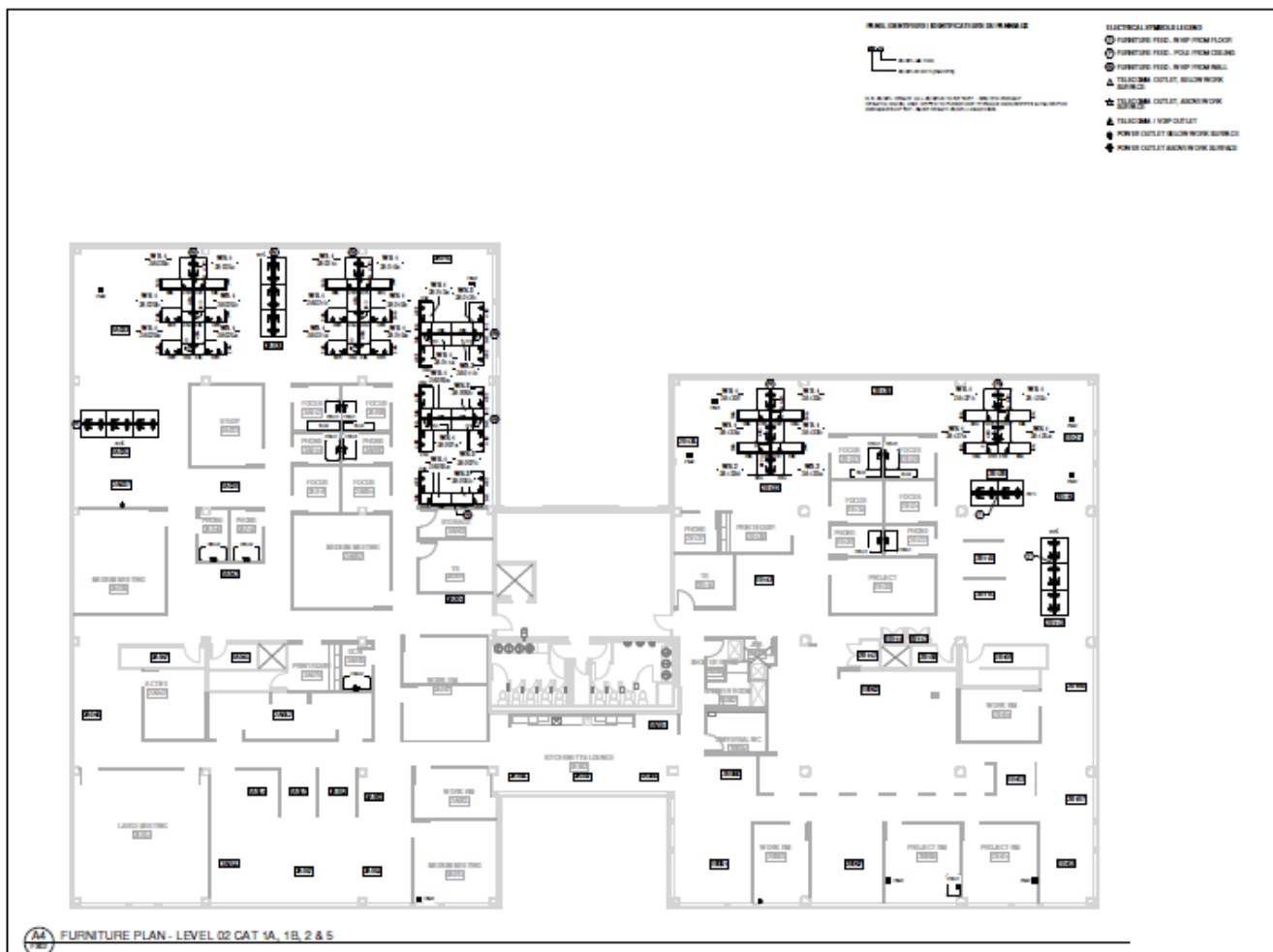

Buyer ID - Id de l'acheteur
pq999
CCC No./N° CCC - FMS No./N° VME

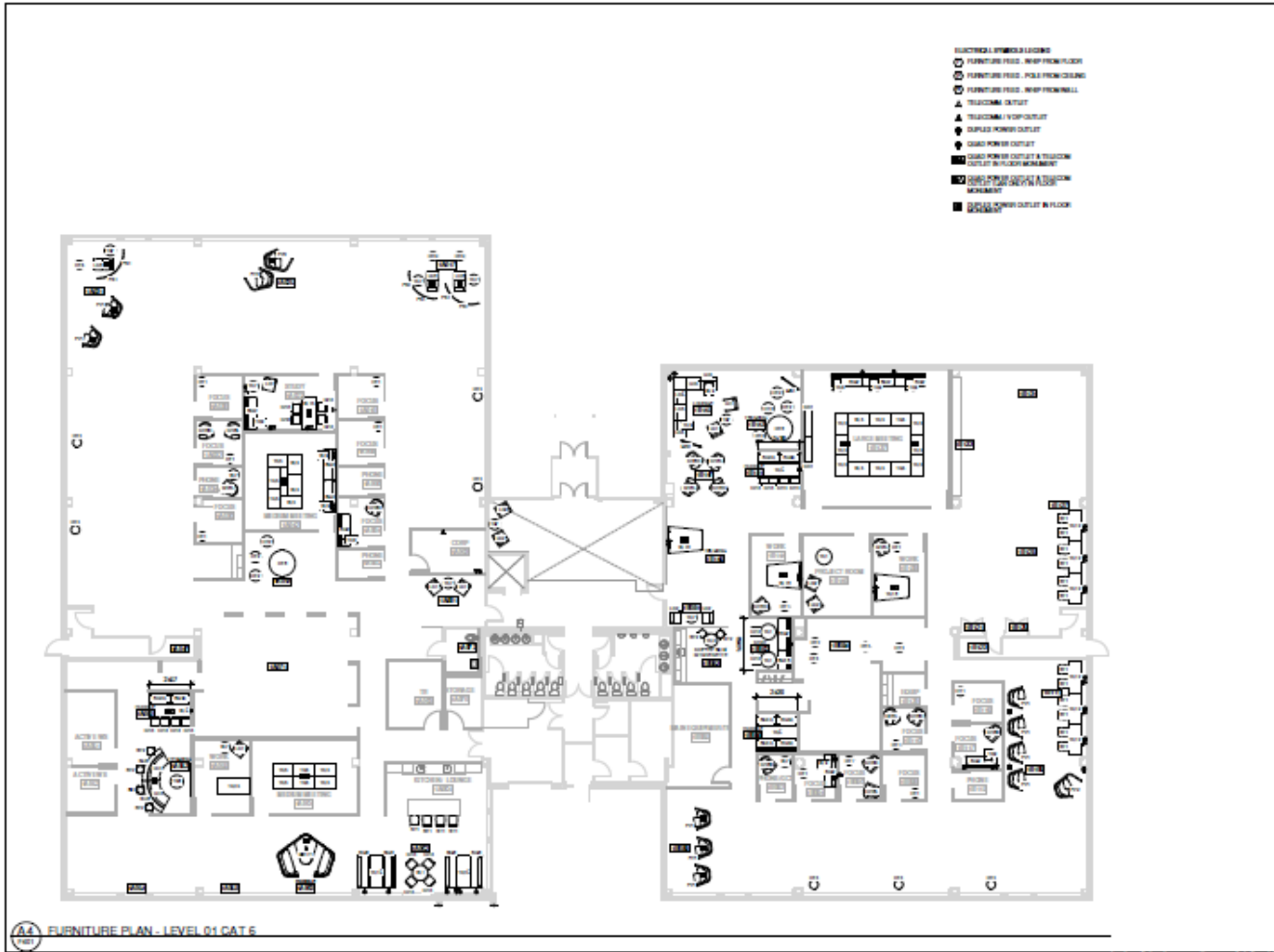

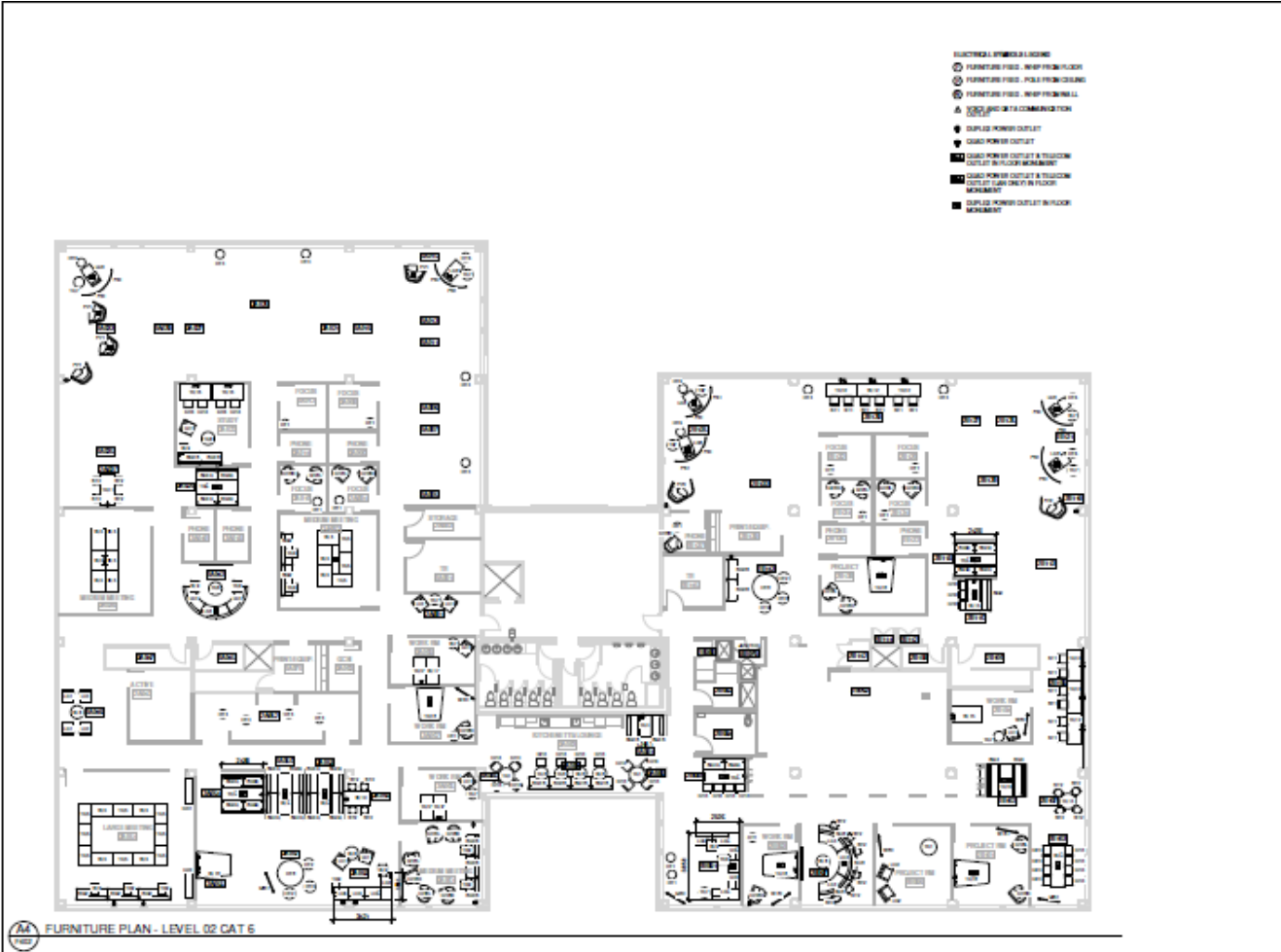

2) Panel Details

- All required panel heights: Base Height, Seated Privacy Add-on Height;
- When power is required, the power is located below work surface height; should a grouping of workstation types include shared panels and one side is identified as powered and the other side is non-powered, those panels affected must be powered.
- Type of power feed: refer to floor plan where power feeds are located by symbols.

3) Panel Matrix or Workstation Layout

See attached Panel Matrix and Workstation Layout

a. Panel Matrix

A		B	
Seated Privacy Add-on Panneau additionnel pour intimité en position assise		Seated Privacy Add-on Panneau additionnel pour intimité en position assise	
Upper Element élément supérieur 1: Frosted Glazed Cloisons vitré givré	Upper Element élément supérieur 2: Frosted Glazed Cloisons vitré givré	Upper Element élément supérieur 1: Frosted Glazed Cloisons vitré givré	Upper Element élément supérieur 2: Frosted Glazed Cloisons vitré givré
Lower Element élément inférieur 1: Fabric tissu	Lower Element élément inférieur 2: Fabric tissu	Lower Element élément inférieur 1: Fabric tissu Cut-outs for Power below the worksurface sortie(s) de courant, au-dessous de la surface de travail	Lower Element élément inférieur 2: Fabric tissu

C
Seated Privacy Add-on | Panneau
additionnel pour intimité en position assise

Upper Element élément supérieur 1: Frosted Glazed Cloisons vitré givré	Upper Element élément supérieur 2: Frosted Glazed Cloisons vitré givré
Lower Element élément inférieur 1: Fabric tissu Cut-outs for Power below the worksurface sortie(s) de courant, au-dessous de la surface de travail	Lower Element élément inférieur 2: Fabric tissu Cut-outs for Power below the worksurface sortie(s) de courant, au-dessous de la surface de travail

D
Base Height | Hauteur de base

<p>Lower Element élément inférieur 1: Fabric tissu</p> <p>Cut-outs for Power below the worksurface sortie(s) de courant, au-dessous de la surface de travail</p>	<p>Lower Element élément inférieur 2: Fabric tissu</p>

E
Base Height | Hauteur de base

<p>Lower Element élément inférieur 1: Fabric tissu</p>	<p>Lower Element élément inférieur 2: Fabric tissu</p>

b. Workstation Layout(s)

- The floor plan takes precedent over any discrepancies with the workstation layouts.
- When two or more typical workstation types share a common panel spine, the finishes of the interior side of the workstation panel as outlined in the Typical Data Sheets must be followed and **NO PANELS SHALL BE DOUBLED. Where no workstation exists adjacent to typical workstation, refer to Data Sheet for finish.**
- Should one typical workstation identify power and the other does not – power will be required for both. Include Workstation Layouts (in the form of Typical Data Sheets or 3 Dimensional drawings) here or as a separate attachment to this RFB.

WORKSTATION

WS-1

POSTE DE TRAVAIL

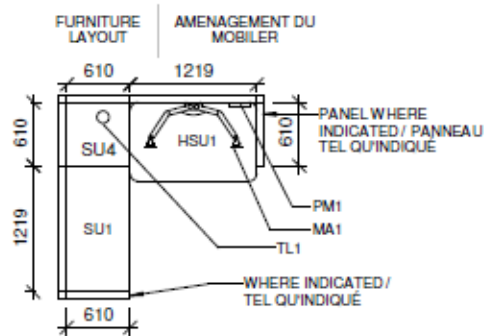

Code No. No. de code	Description
Category Catégorie 1A	
Refer to Floor Plans.	
Category Catégorie 1B	
SU1	1219 (48") x 610 (24") Worksurface, Panel Mounted, High Pressure Laminate, Rectangular Surface de travail, Monté sur cloison, Stratifiés haute pression, Rectangulaire
Category Catégorie 1B - NSA	
SU4	610 (24") x 610 (24") Worksurface, Panel Mounted, High Pressure Laminate, Rectangular Surface de travail, Monté sur cloison, Stratifiés haute pression, Rectangulaire
Category Catégorie 2	
HSU1	1219 (48") x 762 (30") Sit/Stand Range Height Adjustable Work Surface, electrically assisted Surface de travail rectangulaire avec hauteur ajustable, position assise à debout, commande électrique
Category Catégorie 5	
MA1	Monitor arm, dual monitor, grommet mount Bras de moniteur, deux moniteurs, à l'intérieur d'un passe-câble
PM1	Desk Top Power Module with 2 power duplex and 2 USB ports Module d'alimentation de Bureau avec 2 prises de courant et 2 ports USB
TL1	Task light, desk base, AC and USB power Appareils d'éclairage localisé, monté sur le plateau, prise de courant AC et USB.

WORKSTATION

WS-2

POSTE DE TRAVAIL

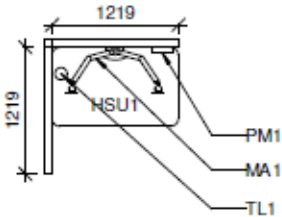
FURNITURE LAYOUT	AMÉNAGEMENT DU MOBILIER
	
Code No. No. de code	Description
Category Catégorie 1A	
Refer to Floor Plans	
Category Catégorie 2	
HSU1	1219 (48") x 762 (30") Sit/Stand Range Height Adjustable Work Surface, electrically assisted Surface de travail rectangulaire avec hauteur ajustable, position assise à debout, commande électrique
Category Catégorie 5	
MA1	Monitor arm, dual monitor, grommet mount Bras de moniteur, deux moniteurs, à l'intérieur d'un passe-câble
PM1	Desk Top Power Module with 2 power duplex and 2 USB ports Module D'alimentation de Bureau avec 2 prises de courant et 2 ports USB
TL1	Task light, desk base, AC and USB power Appareils d'éclairage localisé, monté sur le plateau, prise de courant AC et USB.

WORKSTATION

WS-3

POSTE DE TRAVAIL

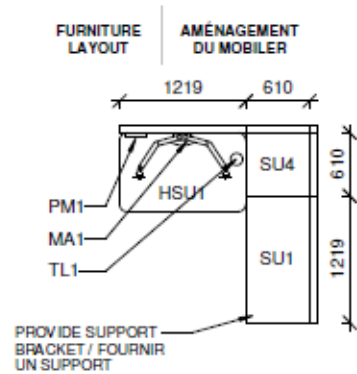

Code No. No. de code	Description
Category Catégorie 1A	
Refer to Floor Plans	
Category Catégorie 1B	
SU1	1219 (48") x 610 (24") Worksurface, Panel Mounted, High Pressure Laminate, Rectangular Surface de travail, monté sur cloison, Stratifiés haute pression, Rectangulaire
Category Catégorie 1B - NSA	
SU4	610 (24") x 610 (24") Worksurface, Panel Mounted, High Pressure Laminate, Rectangular Surface de travail, Monté sur cloison, Stratifiés haute pression, Rectangulaire
Category Catégorie 2	
HSU1	1219 (48") x 762 (30") Sit/Stand Range Height Adjustable Work Surface, electrically assisted Surface de travail rectangulaire avec hauteur ajustable, position assise à debout, commande électrique
Category Catégorie 5	
MA1	Monitor arm, dual monitor, grommet mount Bras de moniteur, deux moniteurs, à l'intérieur d'un passe-câble
PM1	Desk Top Power Module with 2 power duplex and 2 USB ports Module D'alimentation de Bureau avec 2 prises de courant et 2 ports USB
TL1	Task light, desk base, AC and USB power Appareils d'éclairage localisé, monté sur le plateau, prise de courant AC et USB

WORKSTATION

WS-4

POSTE DE TRAVAIL

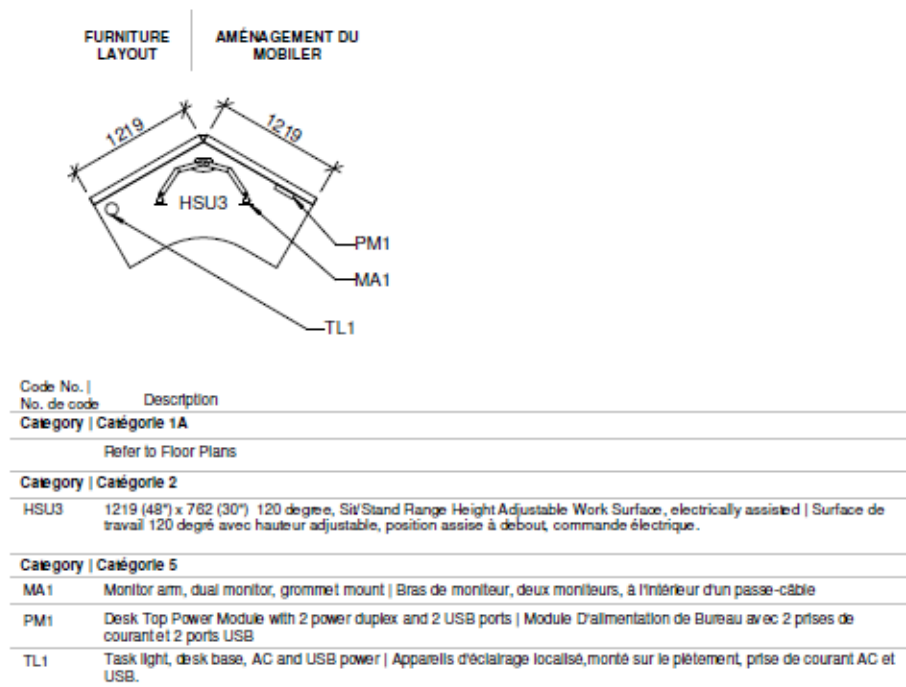

WORKSTATION BP4 & BP6 POSTE DE TRAVAIL

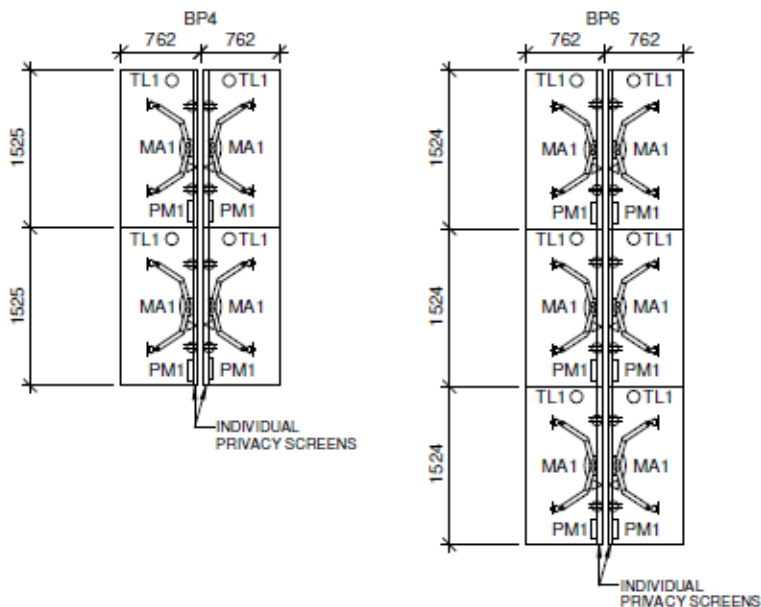

Code No. No. de code	Description
Category Catégorie 2	
BP4	4-person benching workstation, sit/stand range height adjustable work surfaces, wire management trough below work surfaces, individual fabric privacy screens Regroupement de quatre surfaces de travail, surfaces de travail à hauteur ajustable en hauteur, panneaux individuels d'intimité de tissu Electrically assisted / commande électrique
BP6	6-person benching workstation, sit/stand range height adjustable work surfaces, wire management trough below work surfaces, individual fabric privacy screens Regroupement de six surfaces de travail, surfaces de travail à hauteur ajustable en hauteur, panneaux individuels d'intimité de tissu Electrically assisted / commande électrique
Category Catégorie 5	
MA1	Monitor arm, dual monitor, grommet mount Bras de moniteur, deux moniteurs, à l'intérieur d'un passe-câble
PM1	Desk Top Power Module with 2 power duplex and 2 USB ports Module D'alimentation de Bureau avec 2 prises de courant et 2 ports USB
TL1	Task light, desk base, AC and USB power Appareils d'éclairage localisé, monté sur le piedement, prise de courant AC et USB.

PHONE BOOTH

CABINE TÉLÉPHONIQUE

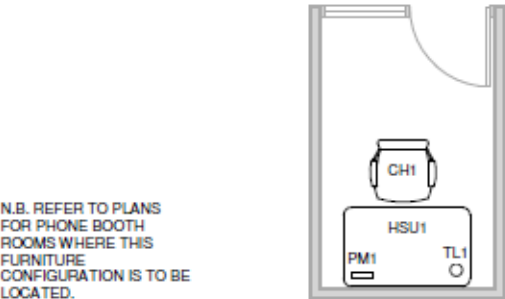

Code No. No. de code	Description
Category Catégorie 2	
HSU1	1219 (48") x 762 (30") Sit/Stand Range Height Adjustable Work Surface, electrically assisted Surface de travail rectangulaire avec hauteur ajustable, position assise à debout, commande électrique
Category Catégorie 5	
PM1	Desk Top Power Module with 2 power duplex and 2 USB ports Module d'alimentation de Bureau avec 2 prises de courant et 2 ports USB
TL1	Task light, desk base, AC and USB power Appareils d'éclairage localisé, monté sur le piètement, prise de courant AC et USB.

CORP ROOM

SALLE DE CORP

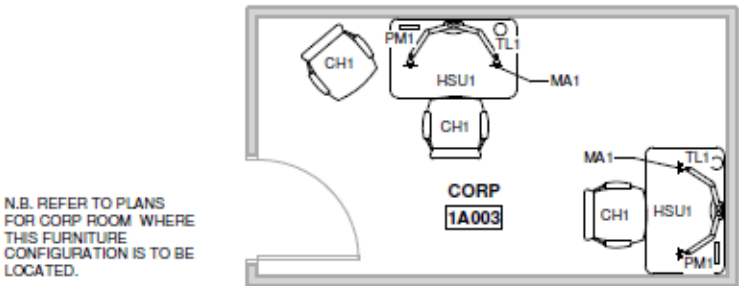

Code No. No. de code	Description
Category Catégorie 2	
HSU1	1219 (48") x 762 (30") Sit/Stand Range Height Adjustable Work Surface, electrically assisted Surface de travail rectangulaire avec hauteur ajustable, position assise à debout, commande électrique
Category Catégorie 5	
PM1	Desk Top Power Module with 2 power duplex and 2 USB ports Module d'alimentation de Bureau avec 2 prises de courant et 2 ports USB
TL1	Task light, desk base, AC and USB power Appareils d'éclairage localisé, monté sur le piètement, prise de courant AC et USB.

FOCUS ROOM

SALLE DE CONCENTRATION

N.B. REFER TO PLANS
FOR FOCUS ROOMS
WHERE THIS FURNITURE
CONFIGURATION IS TO BE
LOCATED.

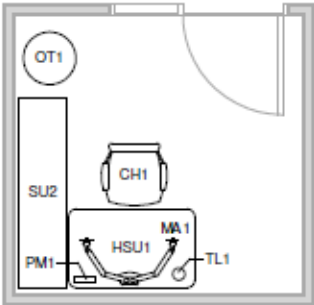

Code No. No. de code	Description
Category Catégorie Non-SA	
SU2	1829 (72") x 460 (18") Free-standing Worksurface, High Pressure Laminate, Rectangular, T-legs, No Modesty Panel Surface de travail rectangulaire autonome, pattes en T, sans panneau de modestie.
Category Catégorie 2	
HSU1	1219 (48") x 762 (30") Sit/Stand Range Height Adjustable Work Surface, electrically assisted Surface de travail rectangulaire avec hauteur ajustable, position assise à debout, commande électrique
Category Catégorie 5	
MA1	Monitor arm, dual monitor, grommet mount Bras de moniteur, deux moniteurs, à l'intérieur d'un passe-câble
PM1	Desk Top Power Module with 2 power duplex and 2 USB ports Module d'alimentation de Bureau avec 2 prises de courant et 2 ports USB
TL1	Task light, desk base, AC and USB power Appareils d'éclairage localisé, monté sur le plateau, prise de courant AC et USB.
Category Catégorie 6	
OT1	508 dia. Upholstered stool, solid round seat Surface round tabouret rembourré, base pleine.

GCSI ROOM

SALLE DE GCSI

N.B. REFER TO PLANS FOR GCSI ROOM WHERE THIS FURNITURE CONFIGURATION IS TO BE LOCATED.

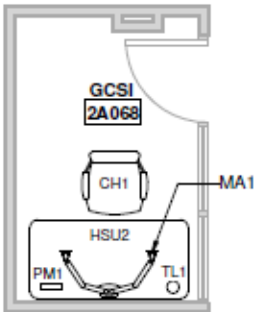

Code No. No. de code	Description
Category Catégorie 2	
HSU2	1525 (60") x 762 (30") Sit/Stand Range Height Adjustable Work Surface, electrically assisted Surface de travail rectangulaire avec hauteur ajustable, position assise à debout, commande électrique
Category Catégorie 5	
PM1	Desk Top Power Module with 2 power duplex and 2 USB ports Module D'alimentation de Bureau avec 2 prises de courant et 2 ports USB
TL1	Task light, desk base, AC and USB power Appareils d'éclairage localisé, monté sur le plateau, prise de courant AC et USB.

Solicitation No. - N° de l'invitation
EP076-200248/A
Client Ref. No. - N° de réf. du client
EP076-200248

Amd. No. - N° de la modif.
File No. - N° du dossier
pq999 EP076-200248

Buyer ID - Id de l'acheteur
pq999
CCC No./N° CCC - FMS No./N° VME

ANNEX D
Additional Specifications, Certifications

Must meet the additional Specifications, Certifications associated with NSA product forming part of the requirement.

1. Specifications

Refer to Category 1, 2, 5 and Category 6B and 6C for NSA specifications

2. Certifications

.1 NSA Product Conformance

2.1 NSA Product Conformance *(Required precedent to Issuance of a contract)*

The Supplier certifies that all the NSA products offered will conform to all specifications indicated in Annex A and D of the RFB, and meet the testing and performance requirements found at ANNEX A-1 and A-2 of the Supply Arrangement, as applicable.

Supplier's Signature

Date

NSA Product Conformance Certification *(applies after contract award)*

The Supplier warrants that the NSA Product Conformance Certification submitted by the Supplier with its bid is accurate and complete. The Supplier must keep proper records and documentation relating to the NSA product conformance and the testing requirements in this Annex, as applicable. The Supplier must not, without obtaining the prior written consent of the SAA, dispose of any such records or documentation until the expiration of the Contract or the expiry date of the Warranty, whichever is later. All such records and documentation must at all times during the retention period be open to audit, inspection and examination by the representatives of Canada, who may make copies and take extracts.

In addition, the Supplier must provide representatives of the SAA access to all locations where any part of the Work is being performed at any time during working hours. Representatives of the SAA may examine and test the Work as they see fit. The Supplier must provide all assistance and access to facilities, test pieces, samples and documentation that the representatives of the SAA may reasonably require for the carrying out of the inspection, which may also include the submission of test reporting documentation as listed in Annex A and D. The Supplier must forward such test pieces, samples and/or documentation that may also include letters of certification from the laboratories to such person or location as the representatives of the SAA specifies.