



ADDENDUM N° 002

Date: August 27th, 2019

Project: Re-roofing of metal cladding of buildings #11 and 12

Bidders must make sure that their bids are based on the latest version of the tender documents published and take into consideration the following amendments and information, including any information provided on amendments or Q&A previously published for this project.

Bidders that do not comply with this requirement will be discarded.

1- On the cover Page

DELETE

Solicitation Closes :

Thursday, August 29, 2019, at 02:00 PM, EST.

INSERT

Solicitation Closes :

Wednesday, September 4, 2019, at 02:00 PM, EST.

2- For the plans and specifications, please refer to the Addendum # A01 attached prepared by Jubinville et Associés Architectes

All other terms and conditions remain the same.

This addendum is part of the original plans and specifications and to be recognized as an integral part of the contract documents. The work affected by this addendum will comply with the original plans and specifications to the terms and conditions, the additional terms and conditions and any addenda issued prior to any. Bidders shall ensure that all addenda issued are properly registered on the tender form and the cost of the works affected by the addendum is included in the amount of the bid.

1. **MASTER CONSTRUCTION SPECIFICATION**

The master construction specifications is modified by the following notes:

1. Section 01 52 00 – CONSTRUCTION FACILITIES

1. Add item 1.15.4 as follows: access to buildings must be free at all times for users and vehicles, as the building remains operational during the works.

2. **ARCHITECTURAL DRAWINGS**

The following architectural drawings are modified by the following notes:

1. A2 – BUILDING #12 ROOF PLAN AND ELEVATIONS

1. Building #12 / front elevation – replace the vent pipe that has been ripped off by ice with a new one.

2. A3 – BUILDINGS #11 AND 12 DETAILS

1. Replace detail 1 of A3 with the one shown on sketch #1 at the end of this addendum.

3. A4 – BUILDINGS #11 AND 12 DETAILS

1. Add detail 5 of A4 shown on sketch #2 at the end of this addendum.

END OF THE ADDENDUM #A01, *architecture including : 1 page and 2 sketches.*

Par : Mathieu Choinière, architecte M.O.A.Q.

Agriculture et Agroalimentaire Canada / Agriculture and Agri-Food Canada

REVÊTEMENT DE TOITURE MÉTALLIQUE NOUVEAU /
NEW METAL ROOF SHEATING

MEMBRANE HAUTE TEMPÉRATURE BLUESKIN PE 200 HT DE
BARKOR (TEMPÉRATURE AMBIANTE ET DE SURFACE POUR LA
POSE SUPÉRIEURE À 5° C) OU MEMBRANE THERMOFUSIBLE /
HIGH-TEMPERATURE BAKOR BLUESKIN MEMBRANE PE 200 HT
(AMBIANT AND PLYWOOD TEMPERATURE FOR THE INSTALLATION
MUST BE SUPERIOR TO 5° C) OR THERMOFUSIBLE MEMBRANE.

CHEVRON 50mm X 150mm EXISTANT À ±600mm c/c /
EXISTING RAFTER 50mm X 50mm AT ±600mm O.C.

NOUVEAU CONTREPLAQUÉ 16mm VISSÉ-COLLÉ /
SCREWED AND GLUED 10mm NEW PLYWOOD

CLOSOIRE DE MOUSSE
AVEC RUBAN BUTYL /
FOAM CLOSURE
WITH BUTYL TAPE

NOUVEAU SOLIN DE FASCIA VERT /
NEW FASCIA FLASHING GREEN

NOUVELLE MOULURE TOUT LE TOUR
DU BÂTIMENT / NEW MOLDING ALL
AROUND BUILDING

NOUVEAU FASCIA DE BOIS TOUT LE TOUR
DU BÂTIMENT / NEW WOOD FASCIA ALL
AROUND BUILDING

NOUVEAU SOLIN DE FASCIA VERT
AVEC REJET D'EAU /
NEW FASCIA FLASHING GREEN
WITH WATER DRIP

ENLEVER UNE LISIÈRE DE BOIS EXISTANTE,
LARGEUR À COORDONNER AVEC LES
SPÉCIFICATIONS DU SOFFITE EN ACIER
PERFORÉ BLANC /
REMOVE A STRIPE OF WOOD PLANK, WIDTH
TO COORDONATE WITH SPECIFICATION OF
WHITE PERFORATED SOFFIT

SOFFITE DE BOIS EXISTANT /
EXISTING WOOD SOFFIT

PANNEAU DE MUR EN BOIS EXISTANT /
EXISTING WOOD WALL PANEL

CE DÉTAIL FUT CONÇU SELON CE QUI ÉTAIT POSSIBLE DE VOIR
SANS RIEN DÉMOLIR. CERTAINS ITEMS PEUVENT VARIER. SI
L'ESPACEMENT ENTRE LES CHEVRON DE 50mm X 150mm EST
PLUS DE 600mm C/C AVERTIR L'ARCHITECTE POUR DES
INSTRUCTIONS SUPPLÉMENTAIRES. /
THIS DETAIL WAS DESIGNED AS WATH WAS POSSIBLE TO SEE
WITHOUT ANY DEMOLITION. SOME ITEMS MAY VARY. IF
SPACING BETWEEN 50mm X 150mm RAFTER IS OVER 600mm O.C.
ALERT THE ARCHITEC FOR ADDITIONNAL INTRUCTIONS.

SI LES MOULURES ET LES FASCIAS SONT ENDOMAGÉS,
AVERTIR L'ARCHITECTE POUR DES INSTRUCTIONS
SUPPLÉMENTAIRES. /
SI LES MOULURES ET LES FASCIAS SONT ENDOMAGÉS,
AVERTIR L'ARCHITECTE POUR DES INSTRUCTIONS
SUPPLÉMENTAIRES..

BÂTIMENTS / BUILDINGS 11 & 12 COUPE TYPE CORNICHE / EAVE TYP SECTION

échelle 1 : 5

1
A3

POUR SOUMISSION
NE DOIT PAS SERVIR À LA CONSTRUCTION

**JUBINVILLE
ET ASSOCIÉS
ARCHITECTES**

101, rue Court
Sherbrooke, Qc J1H 1G5
819.566.2232
info@jubinvilleassociés.com

CHARGÉ DE PROJET : MATHIEU CHOINIÈRE, arch.

**Réfection des toitures en
revêtement métallique des
bâtiments #11 & 12 /**

**Re-roofing metal cladding of
building #11 & 12**

DÉTAILS BÂTIMENTS 11 & 12 /
BUILDINGS 11 & 12 DETAILS
ADDENDA #1

dossier | tech

190701-E-PLAN-11-12.dwg

CR1
de 2

22/08/2019 ADDENDA #1
DATE REVISIONS

**Agriculture et Agroalimentaire Canada /
Agriculture and Agri-Food Canada**

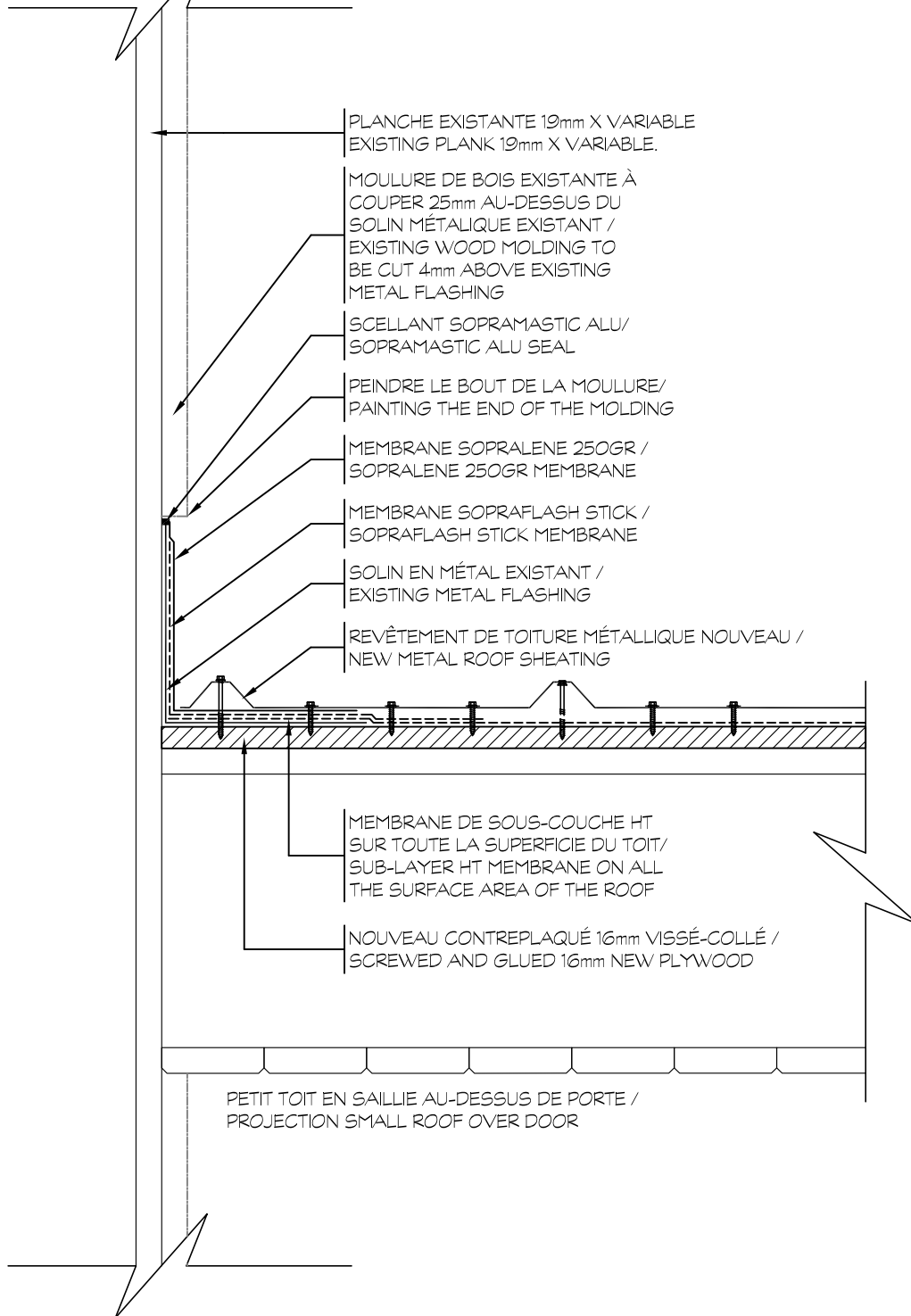

**BÂTIMENTS / BUILDINGS 11 & 12
COUPE TYPE TOIT EN SAILLIE / PROJECTION ROOF TYP SECTION**

échelle 1:5

5
A4

POUR SOUMISSION
NE DOIT PAS SERVIR À LA CONSTRUCTION

**JUBINVILLE
ET ASSOCIÉS
ARCHITECTES**

101, rue Court
Sherbrooke, Qc J1H 1G5
819.566.2232
info@jubinvilleassocies.com

CHARGÉ DE PROJET : MATHIEU CHOINIÈRE, arch.

**Réfection des toitures en
revêtement métallique des
bâtiments #11 & 12 /
Re-roofing metal cladding of
building #11 & 12**

DÉTAILS BÂTIMENTS 11 & 12 /
BUILDINGS 11 & 12 DETAILS
ADDENDA #1

22/08/2019 ADDENDA #1
DATE REVISIONS

dossier tech
190701-E-PLAN-11-12.dwg

CR2
de 2