

| BUILDING INDEX | | |
|----------------|--------------------------|---------------------|
| # | Name | Area m ² |
| A | Works/Corcan Building | 628.9 |
| B | Welcome Building | 1068.4 |
| C | Generator Building | 64.1 |
| D | Salmon House | 210.6 |
| E | Eagle House | 160.1 |
| F | Frog House | 241.5 |
| G | Bear House | 210.6 |
| I | Private Family Visit | 71.7 |
| 2 | PFV Storage | 6.0 |
| 5 | Dormitory 2 | 114.3 |
| 7 | Activities Building | 236.9 |
| 9 | Kitchen | 303.5 |
| 13 | ISS | 172.8 |
| 14 | Sewage Lift Station | 2.5 |
| 15 | Visiting Centre | 169.4 |
| 16 | Green House 1 | 17.8 |
| 18 | Aboriginal Arts & Crafts | 136.3 |
| 21 | Multi-Purpose Building | 90.4 |
| 33 | Comm. House Kitchen | 79.6 |
| 35 | Community House | 258.3 |
| 36 | Barbeque Pit | |
| 39 | Park Washroom | 5.0 |
| 40 | Recreation Storage | 3.2 |
| 42 | Programs Storage | 9.7 |
| 43 | Carving Shelter | 55.8 |
| 44 | Fuelling Station | |
| 45 | Garden Shed 1 | 7.4 |
| 45a | Garden Shed 2 | 7.4 |
| 46 | Storage Building | 62.9 |
| 46a | Recycling Centre | |
| 47 | Chlorination Building 1 | 15.9 |
| 47a | Chlorination Building 2 | 5.0 |
| 52 | Aboriginal Change Bldg | 27.1 |
| 53 | Green House 2 | 17.8 |
| | Total Area | 4461 |

- DRAWING LIST:
- A01 - SITE PLAN
 - A02 - FLOOR PLAN, GENERAL NOTES
 - A03 - PHOTOS OF EXISTING CONDITION
 - A04 - PHOTOS OF EXISTING CONDITION
 - A05 - PHOTOS OF EXISTING CONDITION
 - A06 - PHOTOS OF EXISTING CONDITION
 - A07 - PHOTOS OF EXISTING CONDITION
 - A08 - PHOTOS OF EXISTING CONDITION

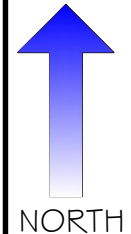

NORTH

1 SITE PLAN
Scale: 1:1500

| | | | | | |
|---|---|---|--|---|---|
| Client/client CORRECTIONAL SERVICE CANADA | Project title/Titre du projet KWIKWEXWELHP HEALING VILLAGE HARRISON MILLS, BC | Drawing title/Titre du dessin SITE PLAN | Consultant Signature & Date Only PAUL RITHALER | PWGSC Project Manager/Administrateur de Projets TPSGC PAUL RITHALER | Project No./No. du projet R.089650.001 |
| | BUILDING 9 KITCHEN DEMOLITION | | Designed by/Concept par MAX CHENG | PWGSC, Regional Manager, Architectural and Engineering Services/ Gestionnaire régionale, Services d'architecture et de génie, TPSGC PREETIPAL PAUL | Sheet/Feuille A01 |
| | | | Drawn by/Dessiné par MAX CHENG | Date/Date 2017-07-31 | Revision/ Révision 0 |



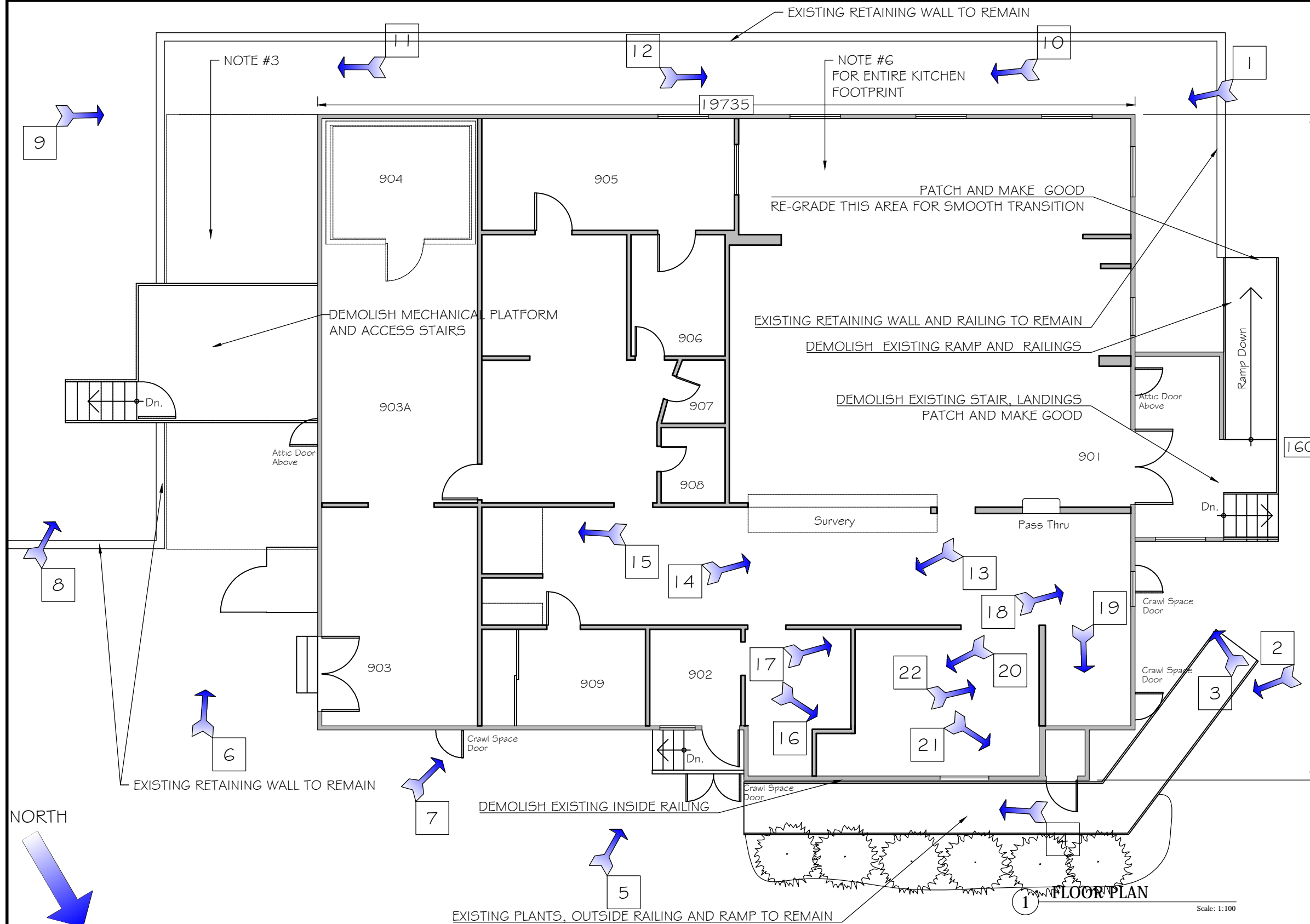

Unit 9

| Kitchen - First Floor | | |
|-----------------------|---------------------------|---------------------|
| Rm. # | Name | Area m ² |
| 901 | Main Entrance/Dining Room | 199.20 |
| 902 | Side Entrance | 5.72 |
| 903 | Delivery Entrance | 21.25 |
| 903a | Storage Room | 24.66 |
| 904 | Walk In Freezer | 12.24 |
| 905 | Food Services | 17.69 |
| 906 | Cleaning Supplies | 7.20 |
| 907 | Women's Washroom | 2.29 |
| 908 | Men's Washroom | 3.16 |
| 909 | Walk In Fridge | 10.06 |

LEGEND

- PHOTO VIEWING DIRECTION
- PHOTO NUMBER LISTED ON A3 TO A8

GENERAL NOTES

- DEMOLISH ENTIRE BUILDING #9 AND SALVAGE / DISPOSE THE DEMOLITION DEBRIS ACCORDING TO SPECIFICATION.
- DISCONNECT EXISTING EQUIPMENT LISTED IN SPECIFICATION APPENDIX B AND RETURN THEM TO OWNER AT A DESIGNATED LOCATION IN KWI HEALING VILLAGE.
- EXISTING FOOTING AND SLAB ON GRADE TO REMAIN.
- EXCAVATE THE EXISTING KITCHEN OIL INTERCEPTORS OUT AND DISPOSE ACCORDING TO GOVERNMENT REGULATIONS PER SPECIFICATION.
- ALL OTHER UNDERGROUND SERVICE SHALL REMAIN AND BE CAPPED ON THE BOTH ENDS.
- INFILL THE EXISTING CRAWL SPACE AND INSTALL 150MM GRAVEL COVER TO BE SAME LEVEL OF THE TOP OF EXISTING FOOTING.
- SEE ELECTRICAL DRAWINGS AND SPECIFICATION FOR ADDITIONAL REQUIREMENTS.
- REMOVE AND RETURN ALL COMMERCIAL GRADE KITCHEN EQUIPMENT AND ACCESSORIES TO OWNER.
- REFER TO HAZMAT REPORT FOR HAZARDOUS MATERIALS DISPOSAL

| | | | | | | |
|---|---|--|---|---|--|-----------------------------------|
| Client/client CORRECTIONAL SERVICE CANADA | Project title/Titre du projet KWIKWEXWELHP HEALING VILLAGE HARRISON MILLS, BC BUILDING 9 KITCHEN DEMOLITION | Drawing title/Titre du dessin FLOOR PLAN WITH PHOTO ORIENTATIONS | Consultant Signature & Date Only | PWGSC Project Manager/Administrateur de Projets TPSG PAUL RITHALER | Project No./No. du projet R.089650.001 | |
| | | | Designed by/Concept par MAX CHENG | PWGSC, Regional Manager, Architectural and Engineering Services/ Gestionnaire régionale, Services d'architectural et de génie, TPSG PREETIPAL PAUL | Sheet/Feuille A02 | Revision/ Revision 0 |
| | | | Drawn by/Dessine par MAX CHENG | Date/Date 2017-07-31 | OF | |





1 PHOTO OF EXISTING CONDITION

Scale: N.T.S.



2 PHOTO OF EXISTING CONDITION

Scale: N.T.S.



3 PHOTO OF EXISTING CONDITION

Scale: N.T.S.

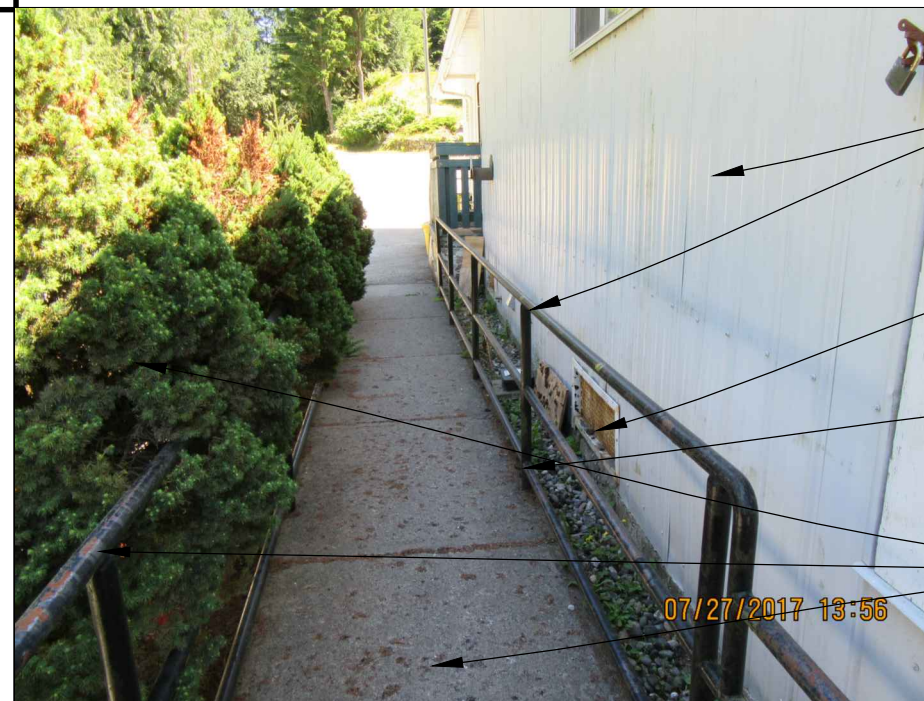

4 PHOTO OF EXISTING CONDITION

Scale: N.T.S.

- LEGEND
- 1 DEMOLISH AND DISPOSE
 - 2 REMAIN
 - 3 PATCH AND MAKE GOOD
 - 4 DISCONNECT SERVICE AND RETURN IT TO OWNER
 - 5 HAZARDOUS MATERIAL HANDLE IT PER SPEC
 - 6 BACKFILL CRAWL SPACE AND ADD 150MM GRAVEL COVER
 - 7 150MM TOP SOIL WITH HYDROSEEDING
 - 8 CAP UNDERGROUND SERVICE LINES
 - 9 REMOVE AND DISPOSE UNDERGROUND OIL INTERCEPTOR

Client/client
CORRECTIONAL SERVICE CANADA

Project title/Titre du projet
**KWIKWEXWELHP HEALING VILLAGE
HARRISON MILLS, BC**
BUILDING 9 KITCHEN DEMOLITION

Drawing title/Titre du dessin
**PHOTOS OF EXISTING CONDITION
EXTERIOR**

Consultant Signature & Date Only
Designed by/Concept par
MAX CHENG
Drawn by/Dessine par
MAX CHENG

PWGSC Project Manager/Administrateur
de Projets TPSG
PAUL RITHALER
PWGSC, Regional Manager, Architectural and Engineering Services/
Gestionnaire régionale, Services d'architectural et de génie, TPSGC
PREETIPAL PAUL
Date/Date
2017-07-31

Project No./No. du projet
R.089650.001
Sheet/Feuille
A03
OF
Revision/
Révision
0





5 PHOTO OF EXISTING CONDITION

Scale: N.T.S.



6 PHOTO OF EXISTING CONDITION

Scale: N.T.S.

LEGEND

- 1 DEMOLISH AND DISPOSE
- 2 REMAIN
- 3 PATCH AND MAKE GOOD
- 4 DISCONNECT SERVICE AND RETURN IT TO OWNER
- 5 HAZARDOUS MATERIAL HANDLE IT PER SPEC
- 6 BACKFILL CRAWL SPACE AND ADD 150MM GRAVEL COVER
- 7 150MM TOP SOIL WITH HYDROSEEDING
- 8 CAP UNDERGROUND SERVICE LINES
- 9 REMOVE AND DISPOSE UNDERGROUND OIL INTERCEPTOR

ALL EQUIPMENT IN STORAGE SHED SHALL BE RETURNED TO OWNER



7 PHOTO OF EXISTING CONDITION

Scale: N.T.S.



8 PHOTO OF EXISTING CONDITION

Scale: N.T.S.

| | |
|------------------------------------|--|
| Client/client | Project title/Titre du projet |
| CORRECTIONAL SERVICE CANADA | KWIKWEXWELHP HEALING VILLAGE HARRISON MILLS, BC |
| | BUILDING 9 KITCHEN DEMOLITION |

| |
|--|
| Drawing title/Titre du dessin |
| PHOTOS OF EXISTING CONDITION EXTERIOR |

| | |
|---|---|
| Consultant Signature & Date Only | PWGSC Project Manager/Administrateur de Projets TPSG |
| Designed by/Concept par MAX CHENG | PAUL RITHALER |
| Drawn by/Dessine par MAX CHENG | PWGSC, Regional Manager, Architectural and Engineering Services/ Gestionnaire régionale, Services d'architectural et de génie, TPSG PREETIPAL PAUL |
| Date/Date | 2017-07-31 |

| | |
|---------------------------|---------------------|
| Project No./No. du projet | R.089650.001 |
| Sheet/Feuille | A04 |
| Revision/Revision | 0 |
| OF | |





9 PHOTO OF EXISTING CONDITION

Scale: N.T.S.



10 PHOTO OF EXISTING CONDITION

Scale: N.T.S.



11 PHOTO OF EXISTING CONDITION

Scale: N.T.S.



12 PHOTO OF EXISTING CONDITION

Scale: N.T.S.

- LEGEND
- 1 DEMOLISH AND DISPOSE
 - 2 REMAIN
 - 3 PATCH AND MAKE GOOD
 - 4 DISCONNECT SERVICE AND RETURN IT TO OWNER
 - 5 HAZARDOUS MATERIAL HANDLE IT PER SPEC
 - 6 BACKFILL CRAWL SPACE AND ADD 150MM GRAVEL COVER
 - 7 150MM TOP SOIL WITH HYDROSEEDING
 - 8 CAP UNDERGROUND SERVICE LINES
 - 9 REMOVE AND DISPOSE UNDERGROUND OIL INTERCEPTOR
 - 10 SEE ELECTRICAL DWG FOR ADDITIONAL NOTES

Client/client
CORRECTIONAL SERVICE CANADA

Project title/Titre du projet
**KWIKWEXWELHP HEALING VILLAGE
HARRISON MILLS, BC**
BUILDING 9 KITCHEN DEMOLITION

Drawing title/Titre du dessin
**PHOTOS OF EXISTING CONDITION
EXTERIOR**

Consultant Signature & Date Only
Designed by/Concept par
MAX CHENG
Drawn by/Dessine par
MAX CHENG

PWGSC Project Manager/Administrateur
de Projets TPSGC
PAUL RITHALER
PWGSC, Regional Manager, Architectural and Engineering Services/
Gestionnaire régionale, Services d'architecture et de génie, TPSGC
PREETIPAL PAUL
Date/Date
2017-07-31

Project No./No. du projet
R.089650.001
Sheet/Feuille
A05
OF
Revision/
Révision
0





- LEGEND
- ① DEMOLISH AND DISPOSE
 - ② REMAIN
 - ③ PATCH AND MAKE GOOD
 - ④ DISCONNECT SERVICE AND RETURN IT TO OWNER
 - ⑤ HAZARDOUS MATERIAL HANDLE IT PER SPEC
 - ⑥ BACKFILL CRAWL SPACE AND ADD 150MM GRAVEL COVER
 - ⑦ 150MM TOP SOIL WITH HYDROSEEDING
 - ⑧ CAP UNDERGROUND SERVICE LINES
 - ⑨ REMOVE AND DISPOSE UNDERGROUND OIL INTERCEPTOR

⑬ PHOTO OF EXISTING CONDITION

Scale: N.T.S.

⑭ PHOTO OF EXISTING CONDITION

Scale: N.T.S.

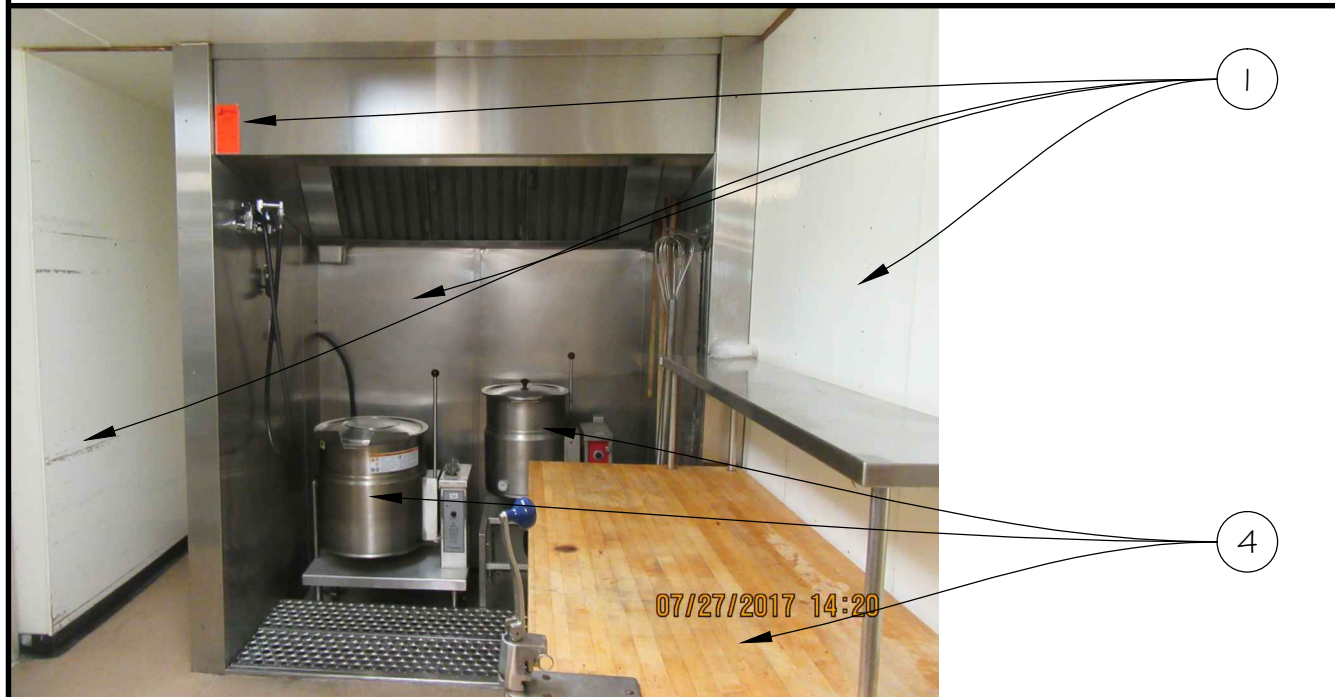

- ⑩ SEE ELECTRICAL DWG FOR ADDITIONAL NOTES

⑮ PHOTO OF EXISTING CONDITION

Scale: N.T.S.

⑯ PHOTO OF EXISTING CONDITION

Scale: N.T.S.

Client/client
CORRECTIONAL SERVICE CANADA

Project title/Titre du projet
**KWIKWEXWELHP HEALING VILLAGE
HARRISON MILLS, BC**
BUILDING 9 KITCHEN DEMOLITION

Drawing title/Titre du dessin
**PHOTOS OF EXISTING CONDITION
INTERIOR**

Consultant Signature & Date Only
Designed by/Concept par
MAX CHENG
Drawn by/Dessine par
MAX CHENG

PWGSC Project Manager/Administrateur
de Projets TPSGC
PAUL RITHALER
PWGSC, Regional Manager, Architectural and Engineering Services/
Gestionnaire régionale, Services d'architectural et de génie, TPSGC
PREETIPAL PAUL
Date/Date
2017-07-31

Project No./No. du projet
R.089650.001
Sheet/Feuille
A06
OF
Revision/
Révision
0





17 PHOTO OF EXISTING CONDITION

Scale: N.T.S.



18 PHOTO OF EXISTING CONDITION

Scale: N.T.S.



19 PHOTO OF EXISTING CONDITION

Scale: N.T.S.



20 PHOTO OF EXISTING CONDITION

Scale: N.T.S.

LEGEND

- 1 DEMOLISH AND DISPOSE
- 2 REMAIN
- 3 PATCH AND MAKE GOOD
- 4 DISCONNECT SERVICE AND RETURN IT TO OWNER
- 5 HAZARDOUS MATERIAL HANDLE IT PER SPEC
- 6 BACKFILL CRAWL SPACE AND ADD 150MM GRAVEL COVER
- 7 150MM TOP SOIL WITH HYDROSEEDING
- 8 CAP UNDERGROUND SERVICE LINES
- 9 REMOVE AND DISPOSE UNDERGROUND OIL INTERCEPTOR
- 10 SEE ELECTRICAL DWG FOR ADDITIONAL NOTES

Client/client
CORRECTIONAL SERVICE CANADA

Project title/Titre du projet
**KWIKWEXWELHP HEALING VILLAGE
HARRISON MILLS, BC
BUILDING 9 KITCHEN DEMOLITION**

Drawing title/Titre du dessin
**PHOTOS OF EXISTING CONDITION
INTERIOR**

Consultant Signature & Date Only
Designed by/Concept par
MAX CHENG
Drawn by/Dessine par
MAX CHENG

PWGSC Project Manager/Administrateur
de Projets TPSGC
PAUL RITHALER
PWGSC, Regional Manager, Architectural and Engineering Services/
Gestionnaire régionale, Services d'architecture et de génie, TPSGC
PREETIPAL PAUL
Date/Date
2017-07-31

Project No./No. du projet
R.089650.001
Sheet/Feuille
A07
OF
Revision/
Révision
0





21 PHOTO OF EXISTING CONDITION

Scale: N.T.S.



22 PHOTO OF EXISTING CONDITION

Scale: N.T.S.

LEGEND

- 1 DEMOLISH AND DISPOSE
- 2 REMAIN
- 3 PATCH AND MAKE GOOD
- 4 DISCONNECT SERVICE AND RETURN IT TO OWNER
- 5 HAZARDOUS MATERIAL HANDLE IT PER SPEC
- 6 BACKFILL CRAWL SPACE AND ADD 150MM GRAVEL COVER
- 7 150MM TOP SOIL WITH HYDROSEEDING
- 8 CAP UNDERGROUND SERVICE LINES
- 9 REMOVE AND DISPOSE UNDERGROUND OIL INTERCEPTOR
- 10 SEE ELECTRICAL DWG FOR ADDITIONAL NOTES

Client/client
CORRECTIONAL SERVICE CANADA

Project title/Titre du projet
**KWIKWEXWELHP HEALING VILLAGE
HARRISON MILLS, BC**
BUILDING 9 KITCHEN DEMOLITION

Drawing title/Titre du dessin
**PHOTOS OF EXISTING CONDITION
INTERIOR**

Consultant Signature & Date Only
Designed by/Concept par
MAX CHENG
Drawn by/Dessine par
MAX CHENG

PWGSC Project Manager/Administrateur
de Projets TPSGC
PAUL RITHALER
PWGSC, Regional Manager, Architectural and Engineering Services/
Gestionnaire régionale, Services d'architecture et de génie, TPSGC
PREETIPAL PAUL
Date/Date
2017-07-31

Project No./No. du projet
R.089650.001
Sheet/Feuille
A08
OF
Revision/
Révision
0

