

### KEY PLAN

#### GENERAL NOTES:

- DO NOT SCALE DRAWINGS
- CO-ORDINATE INFORMATION FROM ALL ARCHITECTURAL DOCUMENTS. IF DISCREPANCIES ARE FOUND REPORT THEM TO THE DEPARTMENTAL REPRESENTATIVE.
- ALL DIMENSIONS ARE APPROXIMATE AND MUST BE CONFIRMED BY CONTRACTOR ON SITE.
- ALL WORK IS TO COMPLY WITH THE REQUIREMENTS OF THE 2015 NATIONAL BUILDING CODE & LOCAL ORDINANCES.
- CO-ORDINATE DIMENSIONS REQUIRED FOR THE FITTING OF ALL COMPONENTS AS NECESSARY TO ENSURE THEIR SOUND INSTALLATION AND OPERATION UPON COMPLETION.

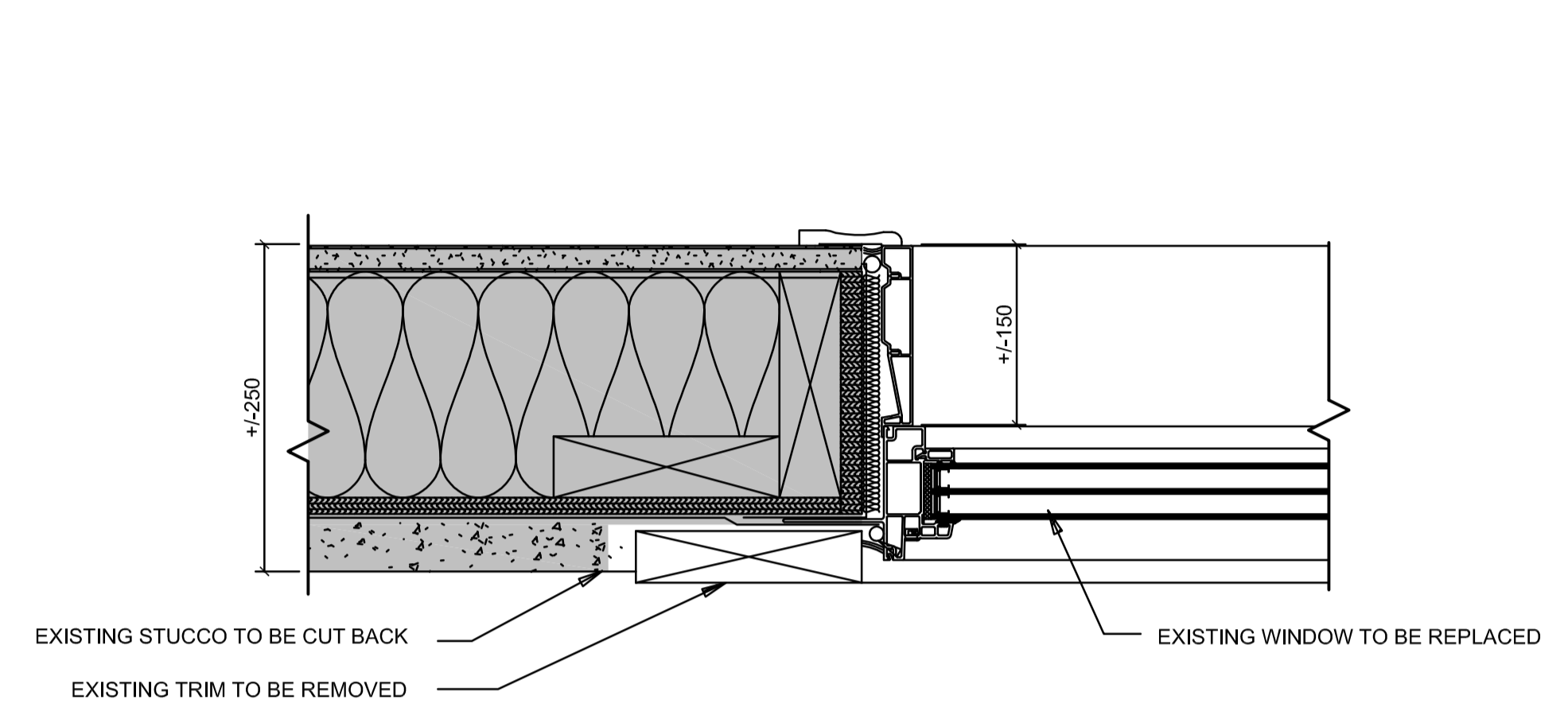

1 **EXISTING PLAN DETAIL OF WINDOW P & Q**  
A206 SCALE= 1:5

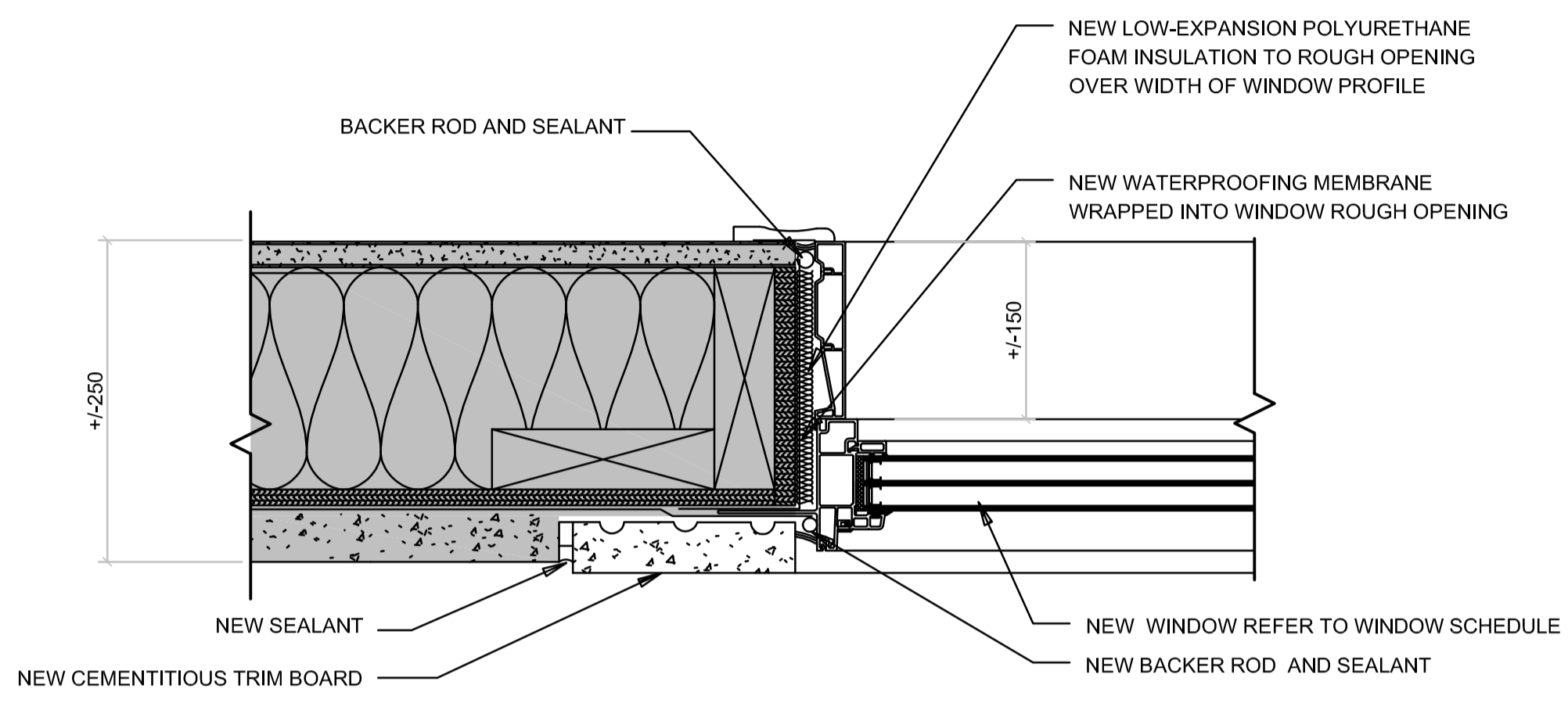

2 **NEW PLAN DETAIL OF WINDOW P & Q**  
A206 SCALE= 1:5

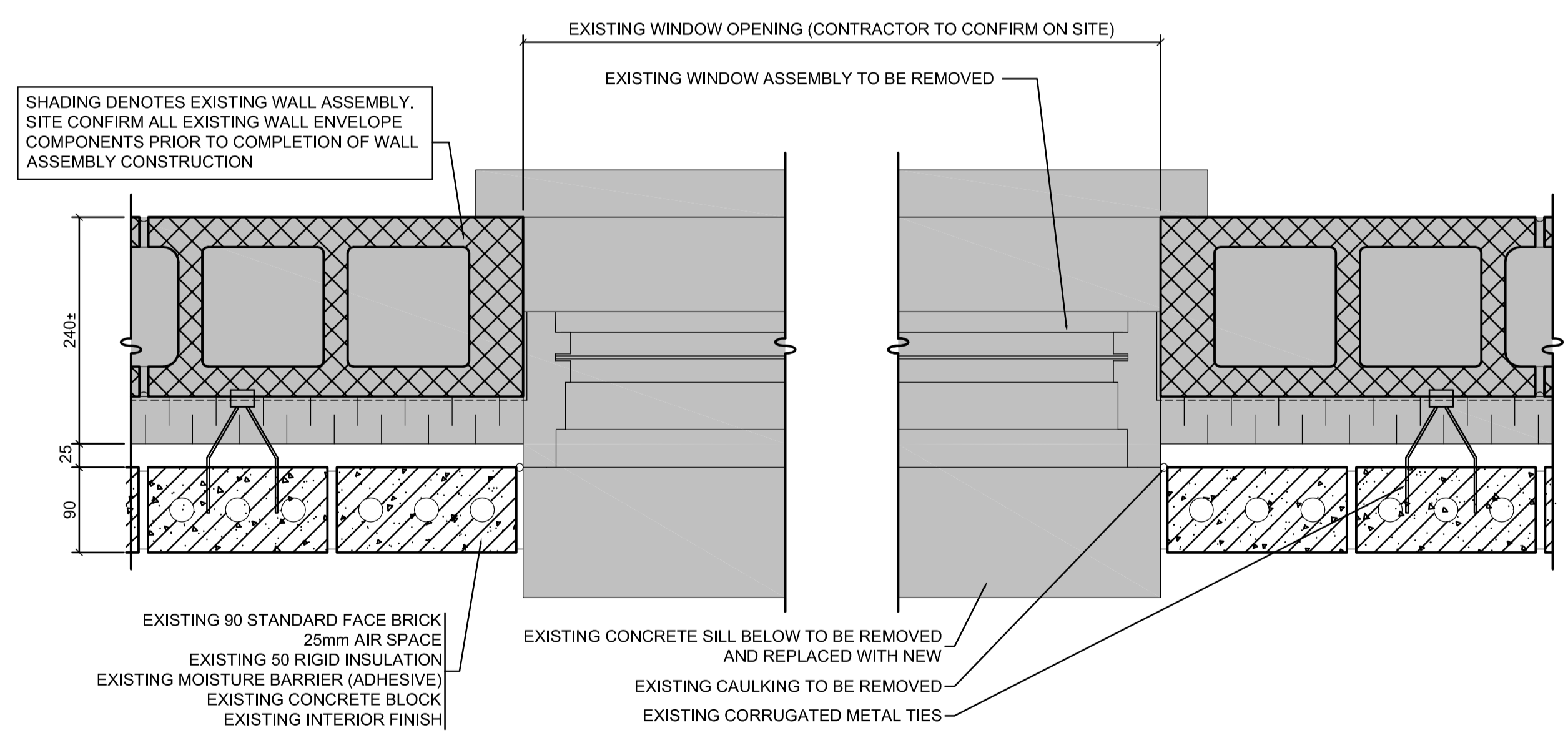

3 **TYPICAL EXISTING WINDOW PLAN DETAIL (WINDOW F, G, H, J, K, L, M, N & R)**  
A206 SCALE= 1:5

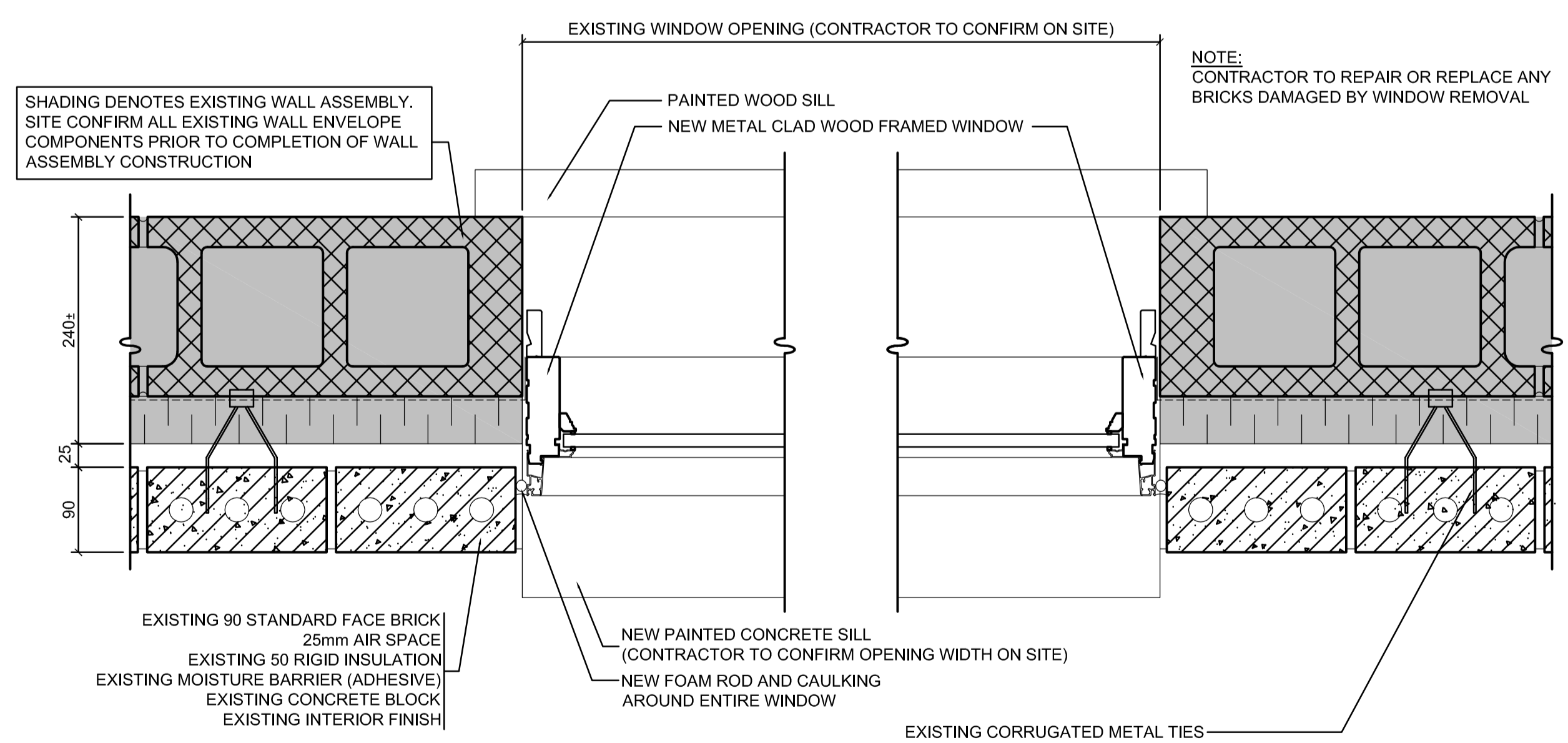

4 **TYPICAL NEW WINDOW PLAN DETAIL (WINDOW F, G, H, J, K, L, M, N & R)**  
A206 SCALE= 1:5

#### DO NOT SCALE DRAWINGS

9		
8		
7	ISSUED FOR CONSTRUCTION	17/01/26
6	ISSUED FOR 100%	16/12/15
5	REISSUED FOR 50% REVIEW	16/10/14
4	REISSUED FOR 50% REVIEW	16/08/15
Revision/	Description/Description	Date/Date

Client/client

Project title/Titre du projet  
**MASONRY RE-POINT EXTERIOR ADMINISTRATION, MULTICULTURAL AND CHAPEL, AND WINDOW REPLACEMENT AT MULTICULTURAL AND CHAPEL**

Approved by/Approuvé par  
GBB

Designed by/Concept par  
GBB

Drawn by/Dessiné par  
DB/CG

PWSC Project Manager/Administrateur de Projets TPSCG  
JAMES PATTISON

PWSC, Architectural and Engineering Resources Manager/Ressources Architectural et de Directeur d'ingénierie, TPSCG

Client/client

Drawing title/Titre du dessin

CHAPEL BUILDING SECTIONS & DETAILS

Project No./No. du projet R.032532.001	Sheet/Feuille A206	Revision no./La Révision no. 7
		OF 15