

181.18 LAKEBED ELEVATIONS (METRES)
BENCH MARK

H.W.L. ELEVATION (1985)	= 183.91m
L.W.L. ELEVATION (1926)	= 182.72m
CHART DATUM (C.D.)	= 183.20m
T.O. EXISTING TIMBER DECK ELEVATION	= 184.08m



JML
Engineering

105 Villa Street, 2nd Floor
Thunder Bay, ON P7A 7W5
Phone: 807.345.1131
Fax: 807.345.1229
Email: info@jmleng.com

- NOTE:**
1. ALL DIMENSIONS ARE IN MILLIMETRES UNLESS NOTED OTHERWISE.
 2. ALL ELEVATIONS ARE IN METERS UNLESS NOTED OTHERWISE.
 3. ELEVATIONS ARE GIVEN USING THE CANADIAN VERTICAL GEODETIC DATUM OF 1928 (CGVD28).
 4. SEE DRAWING S-13 FOR PROJECT NOTES AND SCOPE OF WORK.



JML PROJECT No. 2018074

1	ISSUED FOR ADDENDUM #1	NOV. 15, 2019
0	ISSUED FOR TENDER	OCT. 24, 2019
revision	description	date

Do not scale drawings.
Verify all dimensions and conditions on site and
immediately notify the engineer of all discrepancies.

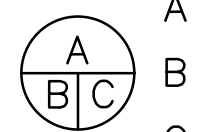

- | | |
|---|---|
| A | Detail No.
No. du détail |
| B | drawing no. — where detail required
dessin no. — où détail exigé |
| C | drawing no. — where detailed
dessin no. — où détaillé |

project title
titre du projet

SILVER ISLET ONTARIO

HARBOUR IMPROVEMENTS

drawing title	titre du dessin
---------------	-----------------

EXISTING SITE PLAN

drawn by
dessine par

designed by
conc par **MICHAEL EDMONDS, P. ENG.**

approved by
 approuvé par **JOHN LORENOWICH, P. ENG**

tender
soumission

project manager
administrateur
de projets

SMALL CRAFT HARBOURS

project date
date du projet OCTOBER 2019

project no. no. du projet	723043
------------------------------	--------

drawing no.
dessine no. S-1 OF 13

SITE PLAN - EXISTING
1:300

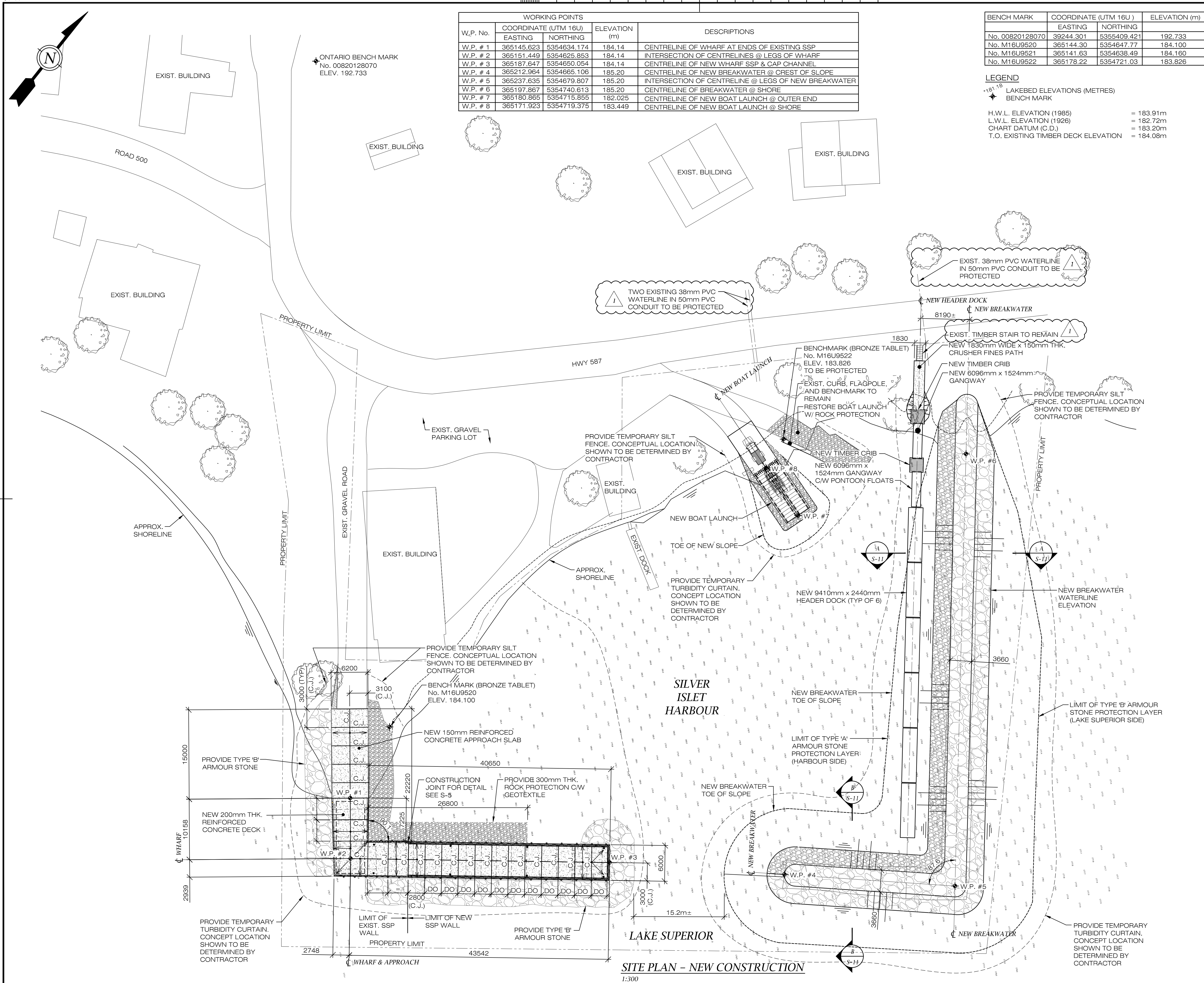

DEPARTMENT OF
FISHERIES AND OCEANS CANADA
SMALL CRAFT HARBOURS
CENTRAL AND ARCTIC REGION



JML Engineering
105 Villa Street, 2nd Floor
Thunder Bay, ON P7A 7W5
Phone: 807.345.1131
Fax: 807.345.1229
Email: info@jmleng.com

- NOTE:**
- ALL DIMENSIONS ARE IN MILLIMETRES UNLESS NOTED OTHERWISE.
 - ALL ELEVATIONS ARE IN METERS UNLESS NOTED OTHERWISE.
 - ELEVATIONS ARE GIVEN USING THE CANADIAN VERTICAL GEODETIC DATUM OF 1928 (CGVD28).
 - SEE DRAWING S-13 FOR PROJECT NOTES AND SCOPE OF WORK.

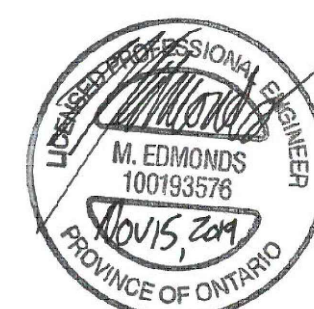
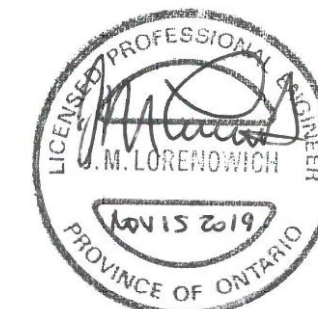

JML PROJECT No. 2018074

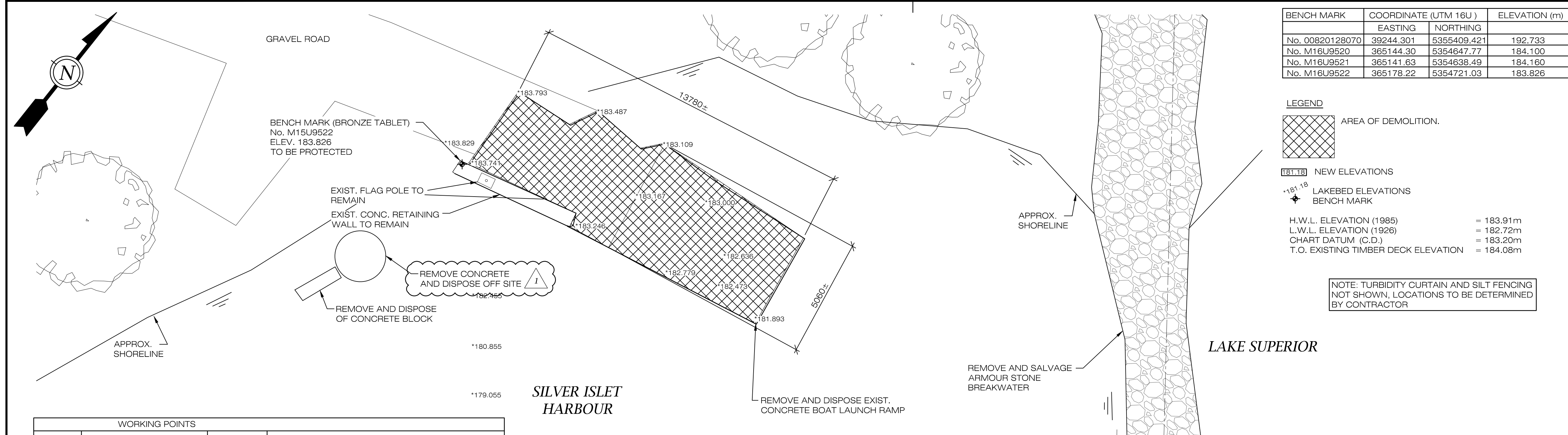

WORKING POINTS			
W.P. No.	COORDINATE (UTM 18U)		ELEVATION (m)
	EASTING	NORTHING	
W.P. # 6	365197.867	5354740.613	185.20
W.P. # 7	365180.865	5354715.855	182.025
W.P. # 8	365171.923	5354719.375	183.449

SILVER ISLET HARBOUR

SITE PLAN - DEMOLITION

1:100

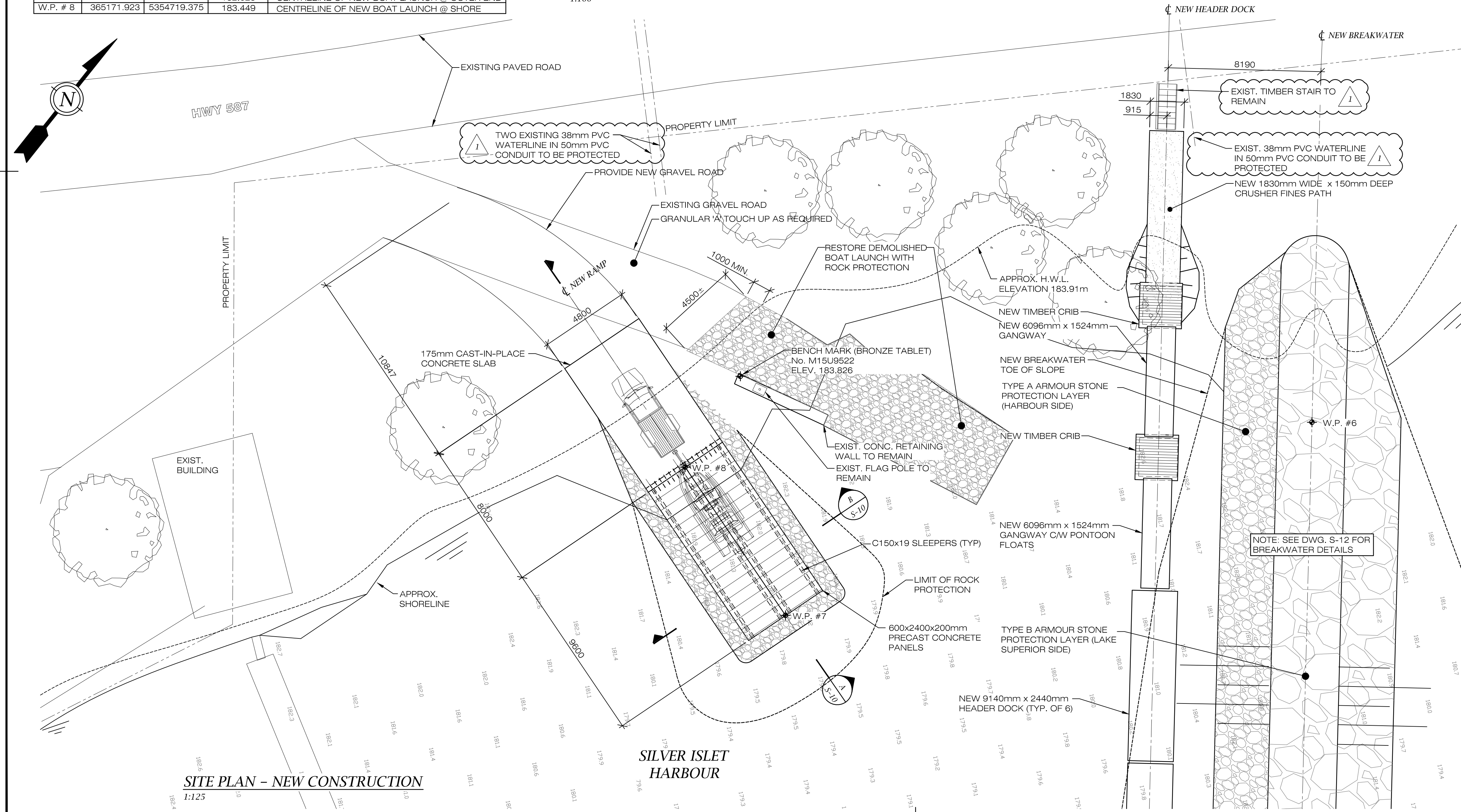

SITE PLAN - NEW CONSTRUCTION

1:125

SILVER ISLET HARBOUR



DEPARTMENT OF
FISHERIES AND OCEANS CANADA
SMALL CRAFT HARBOURS
CENTRAL AND ARCTIC REGION



JML Engineering
105 Villa Street, 2nd Floor
Thunder Bay, ON P7A 7W5
Phone: 807.345.1131
Fax: 807.345.1229
Email: info@jmleng.com

NOTE:

- ALL DIMENSIONS ARE IN MILLIMETRES UNLESS NOTED OTHERWISE.
- ALL ELEVATIONS ARE IN METERS UNLESS NOTED OTHERWISE.
- ELEVATIONS ARE GIVEN USING THE CANADIAN VERTICAL GEODETIC DATUM OF 1928 (CGVD28).
- SEE DRAWING S-13 FOR PROJECT NOTES AND SCOPE OF WORK.

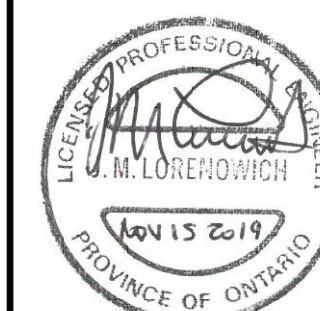

JML PROJECT No. 2018074

revision	description	date
1	ISSUED FOR ADDENDUM #1	NOV. 15, 2019
0	ISSUED FOR TENDER	OCT. 24, 2019

Do not scale drawings.
Verify all dimensions and conditions on site and immediately notify the engineer of all discrepancies.



- A Detail No.
No. du détail
- B drawing no. - where detail required
dessin no. - où détail exigé
- C drawing no. - where detail detailed
dessin no. - où détaillé

project title
titre du projet
SILVER ISLET ONTARIO
HARBOUR IMPROVEMENTS

drawing title
titre du dessin
BOAT LAUNCH - DEMOLITION AND NEW CONSTRUCTION PLANS

drawn by
dessiné par
BRYAN ANDERSON

designed by
conc par
GEORGE MCKAY, P. ENG.

approved by
approuvé par
JOHN LORENOWICH, P. ENG.

tender
soumission
SMALL CRAFT HARBOURS

project manager
administrateur de projets

project date
date du projet
OCTOBER 2019

project no.
no. du projet
723043

drawing no.
dessiné no.
S-9 OF 13

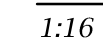
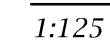

BENCH MARK	COORDINATE (UTM 16U)		ELEVATION (m)
	EASTING	NORTHING	
No. 00802128070	39244.301	5355409.421	192.733
No. M16U9520	365144.30	5354647.77	184.100
No. M16U9521	365141.63	5354638.49	184.160
No. M16U9522	365178.22	5354721.03	183.826

drawing no.
dessine no. S-12 OF 13