



Transport
Canada

Transports
Canada

January 7, 2020

Amendment 002

Subject: Request for Bid No. T5000-190002
Office Furniture – Categories 1, 2 and 3

This amendment will address the following:

- Closing Date
- Changes to ANNEX A – Category 1b, 2, 3
- Changes to ANNEX B – Panel Details
- Changes to ANNEX D – Delivery and Installation Specifications
- Questions

Closing Date:

The new Closing Date for receiving bids is hereby changed to **Monday, January 13, 2020 at 12:00pm** (Central Standard Time CST).

All other terms and conditions remain unchanged.

Tenderers are to acknowledge this Amendment by signing in the space provided below and enclosing a copy of this document with their tender submission.

Yours truly,

Cory Lajoie
 Contracting Officer
 Materiel and Contracting Services
 Telephone: (204) 228-2267
 Email: cory.lajoie@tc.gc.ca

RECEIPT ACKNOWLEDGED

Name of Company _____

Signature _____



1. **ANNEX A**

Table 1 - Category 1B

Delete – 1BFFHTNNTL72WNOLNY
Transitional

Insert – 1BFFHREN24L72WNOLNY
Rectangular
Grommets

*quantity, dimensions and finish remain the same.

Table 1 – Category 2

Delete – 2WSSREXXL24L42BELXX
Length 42”

Insert – 2WSSREXXL24L48BELXX
Length 48”

*quantity, dimensions and finish remain the same.

Table 1 – Category 3

Delete – 3PMOBBXXPM15D24XXXK
Box/Box/File

Insert – 3PMOBFXXPM15D24XXYK
Box/File

*all other details remain the same including cushion top for seating. Must fit under fixed work surface

2. **ANNEX C – Panel Details**

Delete – a. All required panel heights: Base Height

Insert – a. All required panel heights: Seated Privacy Height

3. **ANNEX D – Delivery and Installation Specifications**

Delete – Site Contact:
Curtis Urbanowich
(403) 585-4000
Curtis.banowich@tc.gc.ca

Note: Site contact information will be provided after contract award

Questions

1. Is 50"H total panel height acceptable and which option is preferred? (Monolithic vs base with stack)

Answer: 50"H total panel height is acceptable and base with stack is preferred and will be the only option considered.

2. Is a height adjustable shelf required in the wardrobe section?

Answer: no shelf is required in wardrobe section but must have bar for coat hanger(s). Also, must have door with keyed lock.

Open storage requires two height adjustable shelves.

3. Furniture plan shows Office M105, should this be quoted?

Answer: no, Office M105 should not be included in any part of the bid.

4. Could the panels be on-module instead of Qty 2-36"W non-Power panels? For example, if the Height Adjustable Table is 42"W, use correspondent panel width?

Answer: yes, only panels in Matrix A may be substituted to be on module as per the example below and to accommodate the change in the width of the height adjustable work surface from 42" to 48"

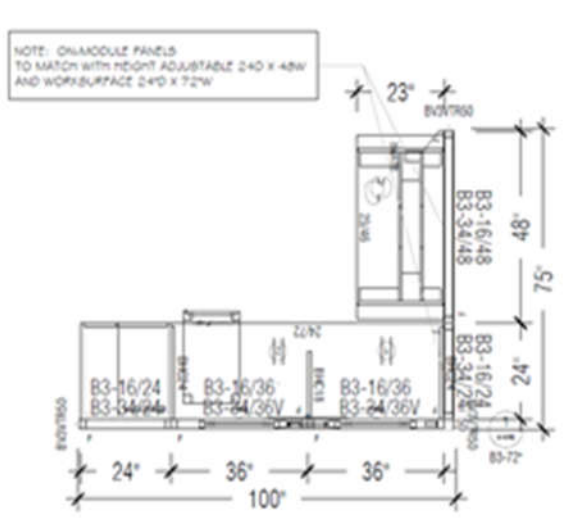

5. Can you provide a .dwg CAD file?

Answer: yes, a .dwg file will be provided upon request