

Parks Canada Parcs Canada

BRIDGE REHABILITATION
5415 SIDELINE 30
CLAREMONT (PIN#614611-2)
ROUGE NATIONAL URBAN PARK
PARKS CANADA

PROJECT NO. 45419775

DRAWING LIST	
STRUCTURAL DRAWINGS	
S-1	GENERAL NOTES
S-2	SITE PLAN LAYDOWN AREA
S-3	GENERAL ARRANGEMENT
S-4	STRUCTURAL DETAILS
S-5	GULAM TIMBER GUIDERAIL DETAILS



ISSUED FOR TENDER
JANUARY 15, 2020

DESIGN LOADING

LIVE LOAD
CL-625-ONT TRUCK AND LANE LOADING

DEAD LOAD
RAILING SYSTEM (PER SIDE): 0.87 kN/m
TRANSVERSE NAIL LAMINATED WOOD DECK: 0.87 kPa

BARRIER LOAD
BARRIER ANCHORAGE DESIGNED FOR TL-1 LOADS
PEDESTRIAN LIVE LOAD: 1.2 kN/m APPLIED VERTICALLY AND HORIZONTALLY SIMULTANEOUSLY.

GENERAL NOTES

CONSTRUCTION NOTES:

- 1.1 THE BRIDGE WAS DESIGNED USING CAN/CSA-S6-14, CANADIAN HIGHWAY BRIDGE DESIGN CODE.
- 1.2 ALL SITE WORK SHALL BE COMPLETED AS INDICATED ON DRAWINGS AND IN ACCORDANCE WITH THE CONTRACT DOCUMENTS.
- 1.3 THE CONTRACTOR SHALL VISIT THE SITE AND SHALL FAMILIARIZE THEMSELVES WITH ALL CONDITIONS AFFECTING THE PROPOSED WORK AND SHALL MAKE PROVISIONS ACCORDINGLY. THE CONTRACTOR SHALL BE RESPONSIBLE FOR FAMILIARIZING THEMSELVES WITH ALL CONTRACT DOCUMENTS, FIELD CONDITIONS, DIMENSIONS, AND CONFIRMING THAT THE WORK MAY BE ACCOMPLISHED AS SHOWN PRIOR TO PROCEEDING WITH CONSTRUCTION. ANY DISCREPANCIES SHALL BE BROUGHT TO THE ATTENTION OF THE ENGINEER PRIOR TO THE COMMENCEMENT OF WORK.
- 1.4 ALL MATERIALS FURNISHED AND INSTALLED SHALL BE IN STRICT ACCORDANCE WITH ALL APPLICABLE CODES, REGULATIONS, AND ORDINANCES. THE CONTRACTOR SHALL ISSUE ALL APPROPRIATE NOTICES AND COMPLY WITH ALL LAWS, ORDINANCES, RULES, REGULATIONS, AND LAWFUL ORDERS OF ANY PUBLIC AUTHORITY REGARDING THE PERFORMANCE OF WORK.
- 1.5 ALL WORK CARRIED OUT SHALL COMPLY WITH ALL APPLICABLE MUNICIPAL AND UTILITY COMPANY SPECIFICATIONS AND LOCAL JURISDICTIONAL CODES, ORDINANCES, AND APPLICABLE REGULATIONS.
- 1.6 UNLESS NOTED OTHERWISE, THE WORK SHALL INCLUDE FURNISHING MATERIALS, APPURTENANCES, AND LABOUR NECESSARY TO COMPLETE ALL INSTALLATIONS AS INDICATED ON DRAWINGS.
- 1.7 PLANS ARE NOT TO BE SCALED. THESE PLANS ARE INTENDED TO BE A DIAGRAMMATIC OUTLINE ONLY UNLESS OTHERWISE NOTED. DIMENSIONS SHOWN ARE TO FINISH SURFACES UNLESS OTHERWISE NOTED. IT IS CRITICAL TO FIELD VERIFY DIMENSIONS, SHOULD THERE BE ANY QUESTIONS REGARDING THE CONTRACT DOCUMENTS, THE CONTRACTOR SHALL BE RESPONSIBLE FOR OBTAINING A CLARIFICATION FROM THE ENGINEER PRIOR TO PROCEEDING WITH THE WORK. DETAILS ARE INTENDED TO SHOW DESIGN INTENT. MODIFICATIONS MAY BE REQUIRED TO SUIT JOB DIMENSIONS OR CONDITIONS AND SUCH MODIFICATIONS SHALL BE INCLUDED AS PART OF WORK AND APPROVED BY THE ENGINEER PRIOR TO PROCEEDING WITH WORK.
- 1.8 THE CONTRACTOR SHALL INSTALL ALL MATERIALS IN ACCORDANCE WITH MANUFACTURER'S RECOMMENDATIONS UNLESS SPECIFICALLY STATED OTHERWISE.
- 1.9 IF THE SPECIFIED MATERIALS CANNOT BE INSTALLED AS SHOWN ON THESE DRAWINGS, THE CONTRACTOR SHALL PROPOSE AN ALTERNATIVE INSTALLATION SPACE FOR APPROVAL BY THE ENGINEER PRIOR TO PROCEEDING.
- 1.10 THE CONTRACTOR SHALL BE RESPONSIBLE FOR THE SAFETY OF WORK AREA AND ADJACENT AREAS THAT ARE LIKELY TO BE AFFECTED BY THE WORK UNDER THIS CONTRACT. WORK SHALL CONFORM TO ALL LOCAL SAFETY REGULATIONS.
- 1.11 THE CONTRACTOR SHALL COORDINATE WORK AND SCHEDULE WORK ACTIVITIES WITH OTHER DISCIPLINES WHERE APPLICABLE.
- 1.12 CONSTRUCTION SHALL BE DONE IN A WORKMANLIKE MANNER BY COMPETENT EXPERIENCED WORKMAN IN ACCORDANCE WITH APPLICABLE CODES AND THE BEST ACCEPTED PRACTICE.
- 1.13 CONTRACTOR SHALL NOT COMMENCE WORK WITHOUT THE PRIOR WRITTEN CONSENT OF THE OWNER.
- 1.14 THE CONTRACTOR SHALL COORDINATE AND MAINTAIN ACCESS FOR ALL TRADES, SUBCONTRACTORS, MANUFACTURERS AND THE OWNER TO THE SITE, WHERE APPLICABLE.
- 1.15 THE CONTRACTOR SHALL MAINTAIN PEDESTRIAN ACCESS TO THE TENANT PROPERTY AT ALL TIMES.
- 1.16 THE CONTRACTOR SHALL STAGE THE WORK IN SUCH A MANNER THAT THE BRIDGE WILL BE OPEN TO VEHICULAR TRAFFIC WHEN THE CONTRACTOR IS NOT ON SITE. TRAFFIC BARRELS SHALL BE PROVIDED TO DELINEATE THE EDGE OF THE BRIDGE.
- 1.17 THE CONTRACTOR SHALL HAVE A PLAN AND HAVE SUFFICIENT MATERIAL ON SITE IN ORDER TO ALLOW EMERGENCY VEHICLES TO CROSS THE BRIDGE WITHIN 15 MINUTES OF BEING NOTIFIED OF AN EMERGENCY.
- 1.18 THE CONTRACTOR SHALL BE RESPONSIBLE FOR SECURITY OF THE SITE FOR THE DURATION OF CONSTRUCTION UNTIL JOB COMPLETION.
- 1.19 THE CONTRACTOR SHALL MAINTAIN IN GOOD CONDITION ONE COMPLETE SET OF PLANS WITH ALL REVISIONS, ADDENDA, AND CHANGE ORDERS ON THE PREMISES AT ALL TIMES.
- 1.20 THE CONTRACTOR SHALL MINIMIZE DISTURBANCE TO THE EXISTING SITE DURING CONSTRUCTION. EROSION CONTROL MEASURES, IF REQUIRED DURING CONSTRUCTION, SHALL BE IN CONFORMANCE WITH THE PROVINCIAL AND LOCAL JURISDICTION FOR EROSION AND SEDIMENT CONTROL. EROSION AND SEDIMENT CONTROL PLAN TO BE SUBMITTED TO AND APPROVED BY PCA AT LEAST 5 BUSINESS DAYS PRIOR TO MOBILIZING ON SITE.
- 1.21 ALL NECESSARY RUBBISH, STUMPS, DEBRIS, STICKS, STONES AND OTHER REFUSE SHALL BE REMOVED FROM SITE AND DISPOSED OF IN A LAWFUL MANNER.
- 1.22 ALL BROCHURES, INSTALLATION AND ASSEMBLY MANUALS, CATALOGS, SHOP DRAWINGS, AND OTHER DOCUMENTS SHALL BE TURNED OVER TO THE OWNER UPON COMPLETION OF CONSTRUCTION AND PRIOR TO PAYMENT.
- 1.23 THE CONTRACTOR SHALL SUBMIT A COMPLETE SET OF AS-BUILT REDLINES TO THE OWNER UPON COMPLETION OF PROJECT AND PRIOR TO PAYMENT.
- 1.24 THE CONTRACTOR SHALL LEAVE THE PREMISES IN A CLEAN CONDITION.
- 1.25 THE CONTRACTOR SHALL PROVIDE TEMPORARY WASHROOM FACILITIES ON SITE.
- 1.26 THE CONTRACTOR SHALL BE RESPONSIBLE FOR OBTAINING ALL PERMITS AND INSPECTIONS REQUIRED FOR CONSTRUCTION. IF THE CONTRACTOR CANNOT OBTAIN A PERMIT, THEY MUST NOTIFY THE OWNER IMMEDIATELY.
- 1.27 THE CONTRACTOR SHALL REMOVE ALL TRASH AND DEBRIS FROM THE SITE ON A DAILY BASIS.
- 1.28 INFORMATION SHOWN ON THE DRAWINGS WAS OBTAINED FROM SITE VISITS AND/OR DRAWINGS PROVIDED BY THE SITE OWNER. THE CONTRACTOR SHALL NOTIFY THE ENGINEER OF ANY DISCREPANCIES PRIOR TO ORDERING MATERIALS OR PROCEEDING WITH CONSTRUCTION.
- 1.29 ALL SIGNAGE, BARRICADES AND TRAFFIC CONTROL DEVICES SHALL BE IN ACCORDANCE WITH OTM BOOK 7.
- 1.30 ANY DAMAGE DURING CONSTRUCTION TO THE EXISTING STRUCTURE (NOT DESIGNATED FOR REPAIR), UTILITIES, AND ADJACENT PROPERTIES SHALL BE REPAIRED BY THE CONTRACTOR TO THE SATISFACTION OF THE ENGINEER AT NO COST TO THE OWNER.

1.31 LOCATIONS OF THE EXISTING UTILITIES SHOWN ON THE DRAWINGS ARE APPROXIMATE AND SHALL BE VERIFIED IN THE FIELD BY THE CONTRACTOR.

1.32 THE CONTRACTOR IS FULLY RESPONSIBLE FOR THE PROTECTION OF UTILITIES.

1.33 THE CONTRACTOR SHALL DESIGN AND IMPLEMENT CONTAINMENT MEASURES TO ENSURE THAT NO CONSTRUCTION DEBRIS FALLS IN THE WATERCOURSE.

STRUCTURAL NOTES:

- 2.1 GENERAL NOTES SHALL BE READ IN CONJUNCTION WITH SPECIFICATIONS AND CONTRACT DOCUMENTS.
- 2.2 DO NOT USE DRAWINGS FOR CONSTRUCTION UNLESS MARKED "ISSUED FOR CONSTRUCTION" AND SEALED BY ENGINEER.
- 2.3 DESIGN, DETAILING AND CONSTRUCTION, SHALL CONFORM TO CANADIAN HIGHWAY BRIDGE DESIGN CODE-CAN/CSA S6-14, PROVINCIAL BUILDING CODE, NATIONAL BUILDING CODE, OCCUPATIONAL HEALTH AND SAFETY ACT, LOCAL REGULATIONS AND BYLAWS AND OTHER CODES AND STANDARDS LISTED. LATEST AVAILABLE EDITIONS SHALL BE USED.
- 2.4 DIMENSIONS OF EXISTING CONDITIONS ARE PLUS OR MINUS REGARDLESS OF WHETHER SHOWN ON DRAWINGS OR NOT. VERIFY THAT ALL DIMENSIONS AND EXISTING CONDITIONS ARE AS SHOWN ON DRAWINGS. REPORT ANY INCONSISTENCIES AND DOUBTFUL CONDITIONS TO THE ENGINEER BEFORE PROCEEDING WITH THE WORK.
- 2.5 DRAWINGS SHALL NOT BE SCALED.
- 2.6 TYPICAL STRUCTURAL DETAILS SHALL BE USED WHERE SPECIFIC DETAILS ARE NOT SHOWN ON STRUCTURAL DRAWINGS.
- 2.7 NO PROVISION HAS BEEN MADE FOR CONDITIONS OCCURRING DURING CONSTRUCTION. THE CONTRACTOR SHALL PROVIDE ALL NECESSARY BRACING AND SHORING REQUIRED TO SAFEGUARD NEW AND EXISTING STRUCTURES, SERVICES AND UTILITIES, AND FOR THE LOADS AND INSTABILITY OCCURRING DURING CONSTRUCTION. CONTRACTOR SHALL ASSUME FULL RESPONSIBILITY FOR SAID TEMPORARY WORKS.
- 2.8 DESIGN LOADS, AS INDICATED SHALL NOT BE EXCEEDED DURING CONSTRUCTION.
- 2.9 DO NOT CUT OPENINGS THROUGH STRUCTURAL ELEMENTS UNLESS APPROVED BY THE ENGINEER.
- 2.10 ADEQUATE COLD OR HOT WEATHER PROTECTION SHALL BE PROVIDED FOR ALL WORK IN ACCORDANCE WITH STANDARDS SPECIFIED TO ENSURE ADEQUATE QUALITY, DURABILITY AND STRENGTH ARE ACHIEVED.

STEEL MATERIALS:

- 3.1 DESIGN, FABRICATION, ERECTION, AND OTHER CONSTRUCTION PRACTICES TO CONFORM TO CSA-S6 AND THE CISC CODE OF STANDARD PRACTICE FOR STRUCTURAL STEEL.
- 3.2 SUBMIT SHOP DRAWINGS SHOWING ALL STRUCTURAL STEEL MEMBERS FOR REVIEW PRIOR TO FABRICATION. WELDING TO CONFORM TO CSA-W59.
- 3.3 SHOP GALVANIZING TO CONFORM TO CAN/CSA-G164.
- 3.4 PROVIDED A MINIMUM OF 2 BOLTS IN BOLTED CONNECTIONS.
- 3.5 PLATES SHALL CONFORM TO CAN/CSA G40.21-350W OR ASTM A572, GRADE 42.
- 3.6 ANGLES SHALL CONFORM TO CAN/CSA G-40.21 GRADE 300W.
- 3.7 HSS SECTIONS SHALL CONFORM TO ASTM A500.
- 3.8 ALL STRUCTURAL STEEL SHALL BE HOT-DIP GALVANIZED UNLESS OTHERWISE NOTED.
- 3.9 ALL BOLTS TO BE MINIMUM 3/8" # A307 GRADE A HOT-DIP GALVANIZED UNLESS OTHERWISE NOTED.

WOOD MATERIAL

- 4.1 COMMON NAILS TO CSA B111-1974 (R2003). 100mm LONG (20d).
- 4.2 LAG SCREWS FOR BEARING CONNECTION TO ANSI/ASME STANDARD B18.2.1 GALVANIZED.
- 4.3 SAWN WOOD SPECIES TO CSA O141-05 (R2019), HEM-FIR No. 1/No. 2.
- 4.4 GLUE-LAMINATED MEMBERS TO CSA O122-16, D.FIR-L 16c-E, OR APPROVED EQUIVALENT.
- 4.5 LUMBER SHALL BE STORED IN A STRAIGHT HORIZONTAL FASHION TO AVOID DAMAGE FROM THE WEATHER OR OTHER ELEMENTS. POSTS, PLATES AND OTHER METAL ITEMS SHALL ALSO BE PROTECTED FROM THE WEATHER.
- 4.6 PLACE EACH LAMINATE VERTICAL OF WOOD DECK TIGHT AGAINST THE PRECEDING ONE. ENSURE LAMINATE BEARS EVENLY ON ALL SUPPORTS.
- 4.7 FASTEN EACH LAMINATION TO THE PRECEDING ONE AT INTERVALS NOT EXCEEDING 250mm. DRIVE NAILS ALTERNATELY NEAR THE TOP AND TO 125mm OF THE END OF EACH LAMINATION. THE NAILS SHALL BE LONG ENOUGH TO PASS THROUGH TWO LAMINATES AND AT LEAST HALFWAY THROUGH THE THIRD.
- 4.8 STAGGER BUTT WOOD DECK JOINTS SO THAT WITHIN ANY BAND OF 1.0m MEASURED ALONG THE LAMINATE, A BUTT JOINT SHALL NOT OCCUR IN MORE THAN ONE LAMINATE OUT OF ANY THREE ADJACENT LAMINATE.
- 4.9 DESIGN, FABRICATION, ERECTION, AND OTHER CONSTRUCTION PRACTICES TO CONFORM TO CSA S6, CSA-086 AND CSA-0122.
- 4.10 BOLTS TO CONFORM TO ASTM A307.
- 4.11 ALL WOOD MEMBERS SHALL BE INCISED BEFORE PRESERVATIVE TREATMENT IN ACCORDANCE WITH THE CSA 080 SERIES OF STANDARDS.
- 4.12 ALL WOOD COMPONENTS SHALL BE PRESSURE TREATED IN ACCORDANCE WITH CSA 080 AND THE REQUIREMENTS OF CSA S6-14, CLAUSE 9.17. WOOD IS DEEMED TO BE SUBJECT TO DIRECT PEDESTRIAN CONTACT AND SHALL BE TREATED WITH ONE OF THE FOLLOWING PRESERVATIVES: CHROMATED COPPER ARSENATE, AMMONIACAL COPPER, ZINC ARSENATE, ALKALINE COPPER QUATERNARY, COPPER AZOLE TYPE B.
- 4.13 WHERE POSSIBLE, ALL SURFACING, HOLES, NOTCHES, RING GROOVES, CHAMFERING, AND OTHER CUTS SHALL BE MADE BEFORE PRESSURE PRESERVATIVE TREATMENT.
- 4.14 ALL CUTS, BORE HOLES, AND OTHER FIELD FABRICATION EXPOSING UNTREATED WOOD SURFACES SHALL BE FIELD TREATED WITH COPPER NAPHTHENATE. CONTRACTOR SHALL FOLLOW MANUFACTURERS WRITTEN RECOMMENDATIONS. MINIMUM OF TWO COATS OF PRESERVATIVE SHALL BE APPLIED.

SHOP DRAWINGS AND SUBMITTALS:

- 5.1 REVIEW OF SHOP DRAWINGS BY ENGINEER SHALL BE FOR THE PURPOSE OF ASCERTAINING CONFORMANCE WITH THE GENERAL DESIGN CONCEPT. THIS REVIEW DOES NOT IMPLY APPROVAL OF DETAIL DESIGN OR QUANTITIES IN SHOP DRAWINGS AND DOES NOT RELIEVE THE CONTRACTOR OF RESPONSIBILITY FOR ERRORS AND OMISSIONS IN SHOP DRAWINGS OR FOR MAKING THE WORK ACCURATE AND IN COMPLIANCE WITH THE CONTRACT DOCUMENTS AND DRAWINGS.
- 5.2 SUBMIT AT LEAST ONE COPY OF SHOP DRAWINGS TO ENGINEER FOR REVIEW.
- 5.3 ALLOW 5 WORKING DAYS FOR REVIEW OF SHOP DRAWINGS.
- 5.4 REPRODUCTIONS OF STRUCTURAL DRAWINGS SHALL NOT BE ACCEPTED AS SHOP DRAWINGS.
- 5.5 DO NOT FABRICATE MATERIALS BASED ON REJECTED SHOP DRAWINGS OR PRIOR TO SHOP DRAWING REVIEW.

MITIGATION MEASURES

- 6.1 CONTRACTORS WILL CO-ORDINATE WITH THE PARKS CANADA PROJECT CO-ORDINATOR AS TO THE CONSTRUCTION ACTIVITIES AND SCHEDULING. THE PROJECT CO-ORDINATOR WILL INFORM THE PARKS CANADA ENVIRONMENTAL SURVEILLANCE OFFICER (ESO) OF SCHEDULE CHANGES SO THAT THEY CAN ADVISE OF MITIGATION MEASURES AND BE PRESENT ON-SITE AS NEEDED.
- 6.2 ALTHOUGH EXCAVATION IS NOT REQUIRED FOR THIS PROJECT, ANY POTENTIAL AREAS WHERE GROUND DISTURBANCE MAY OCCUR SHOULD BE CONTAINED BY ADEQUATE EROSION AND SEDIMENT CONTROL MEASURES.
- 6.3 IN THE EVENT THAT SOIL IS REQUIRED TO BE EXCAVATED, ADDITIONAL ARCHAEOLOGICAL WORK IS REQUIRED. CONTACT PARKS CANADA ARCHAEOLOGY TO ARRANGE ARCHAEOLOGICAL ASSESSMENT.
- 6.4 THE FINALIZED EROSION AND SEDIMENT CONTROL PLAN MUST BE REVIEWED AND APPROVED BY PARKS CANADA STAFF.
- 6.5 IF ANY AREAS ARE DAMAGED BY WORK ACTIVITIES, THESE AREAS WILL BE REINSTATED FOLLOWING THE COMPLETION OF WORK.
- 6.6 WORK AND STAGING WILL BE CONFINED TO THE EXISTING DRIVEWAY.
- 6.7 SCHEDULE WORK TO AVOID WET, WINDY AND RAINY PERIODS THAT MAY INCREASE EROSION AND SEDIMENTATION.
- 6.8 PLAN ACTIVITIES NEAR WATER SUCH THAT MATERIALS SUCH AS PAINT, PRIMERS, BLASTING ABRASIVES, RUST SOLVENTS, DEGREASERS, GROUT, POURED CONCRETE OR OTHER CHEMICALS DO NOT ENTER THE WATERCOURSE.
- 6.9 OPERATE MACHINERY ON LAND ABOVE THE HIGH WATER MARK IN A MANNER THAT MINIMIZES DISTURBANCE TO THE BANKS AND BED OF THE WATERBODY.
- 6.10 USE EXISTING BRIDGE AND STRUCTURE TO CROSS TRIBUTARY (IF NECESSARY).
- 6.11 MINIMIZE DAMAGE TO MILKWEED AND SURROUNDING VEGETATION WHERE FEASIBLE. PRIOR TO WORK BEGINNING, QUALIFIED STAFF WILL SWEEP THE WORK AREA. IF IT IS NOT POSSIBLE TO AVOID DAMAGING MILKWEED, THE INDIVIDUAL PLANTS WILL BE CHECKED FOR THE PRESENCE OF MONARCH EGGS OR CATERPILLERS WILL BE COLLECTED AND HEADSTARTED BY PARKS CANADA RESOURCE CONSERVATION STAFF.
- 6.12 THERE REMAINS THE POSSIBILITY OF ENCOUNTERING ARCHAEOLOGICAL RESOURCES OF INDIGENOUS OR EURO-CANADIAN OCCUPATION WITHIN THESE AREAS. IF CULTURAL FEATURES (E.G., STRUCTURAL REMAINS AND/OR ARTIFACT CONCENTRATIONS) ARE ENCOUNTERED, EXCAVATION WORK SHOULD STOP IN THIS AREA. PHOTOGRAPHS SHOULD BE TAKEN, AND THE PARKS CANADA PROJECT MANAGER SHOULD BE INFORMED. THE PROJECT MANAGER SHOULD THEN CONTACT PARKS CANADA'S TERRESTRIAL ARCHAEOLOGY SECTION FOR ADVICE. AN ASSESSMENT OF SIGNIFICANCE WILL DETERMINE WHAT WILL BE REQUIRED TO MITIGATE THE CHANCE FIND.
- 6.13 CONSTRUCTION ACCESS WILL OCCUR ONLY ON ACCESS ROUTES THAT HAVE BEEN NEGOTIATED WITH AND AGREED TO BY THE TENANTS. TENANTS WILL BE PROVIDED WITH AT LEAST 48 HOURS' NOTICE OF ANY ACTIVITIES TO OCCUR ON THE LANDS THAT THEY LEASE.
- 6.14 SHOULD SPECIES OF SIGNIFICANCE OR CULTURAL RESOURCES BE AFFECTED DURING THE PROJECT, PARKS CANADA WILL CONSULT WITH FIRST NATIONS TO ENSURE THAT THERE WILL NOT BE AN ADVERSE IMPACT ON THEIR RIGHTS.

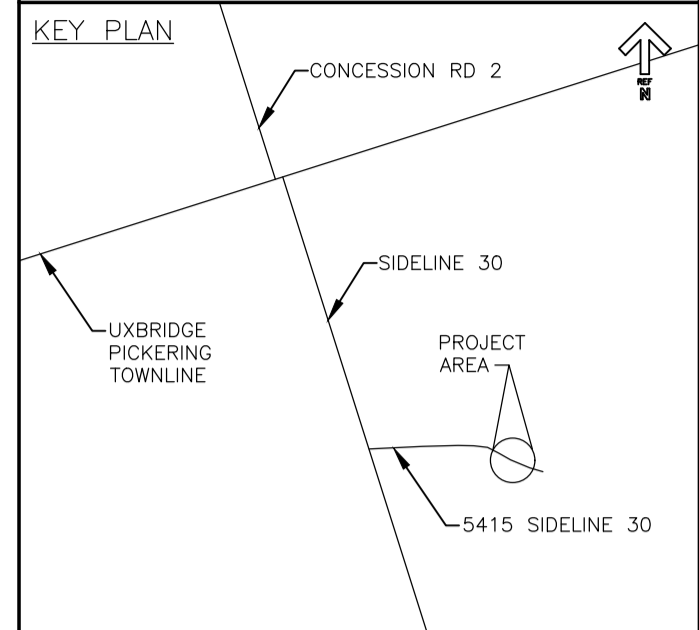

STANTEC
400-1505 Laperriere Ave
Ottawa ON
Tel. 613.722.4420
www.stantec.com

NOTES:

1. SEE DWG S-2 FOR SITE PLAN LAYDOWN AREA.
2. SEE DWG S-3 FOR EXISTING/NEW GENERAL ARRANGEMENT.
3. SEE DWG S-4 FOR TYPICAL CONSTRUCTION DETAILS.



0	ISSUED FOR TENDER	01/15 2020
revisions		date
project		project

BRIDGE REHABILITATION
5415 SIDELINE 30
CLAREMONT (PIN#614611-2)
ROUGE NATIONAL URBAN PARK,
PARKS CANADA

drawing dessin

GENERAL NOTES

designed	TM	conçu
date	2019-09-11	
drawn	CLD	dessiné
date	2019-09-11	
approved		approuvé
date		
Tender		Soumission
PWGC Project Manager	Administrateur de projets TPSCG	
project number		no. du projet
	45419775	
drawing no.		no. du dessin
	S-1	

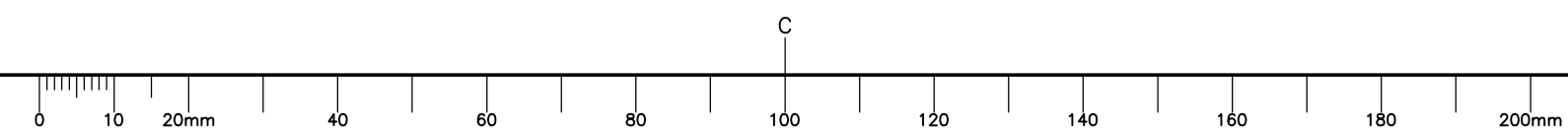

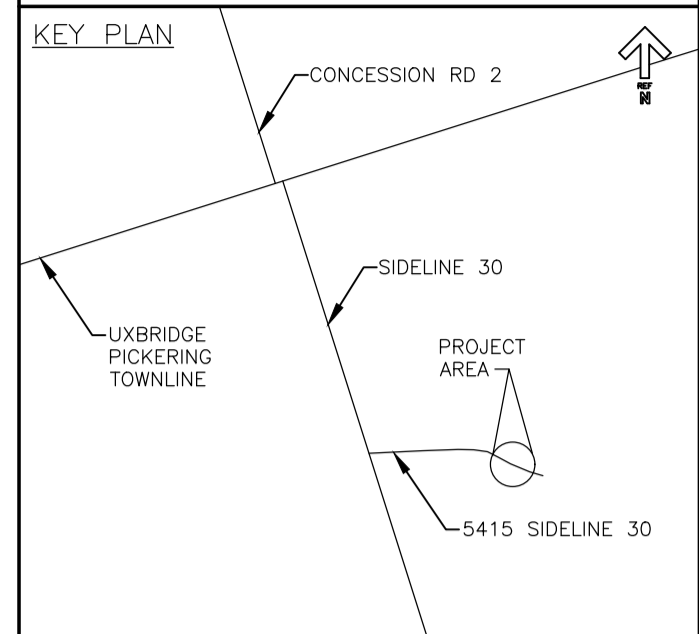

STANTEC
400-1505 Laperriere Ave
Ottawa ON
Tel. 613.722.4420
www.stantec.com

NOTES:

1. WOODEN MATTING SHALL BE PLACED ON ALL THE SURFACE OF THE STAGING AREA.
2. SEE DWG S-3 FOR EXISTING/NEW GENERAL ARRANGEMENT.



0	ISSUED FOR TENDER	01/15/2020
revisions		date
project		projct

BRIDGE REHABILITATION
5415 SIDELINE 30
CLAREMONT (PIN#614611-2)
ROUGE NATIONAL URBAN PARK,
PARKS CANADA

drawing / dessin

SITE PLAN
LAYDOWN AREA

designed TM / conçu

date 2019-09-11

drawn CLD / dessiné

date 2019-09-11

approved / approuvé

date / Soumission

PWGC Project Manager / Administrateur de projets TPSGC

project number / no. du projet

45419775

drawing no. / no. du dessin

S-2



SITE PLAN
SCALE : N.T.S.

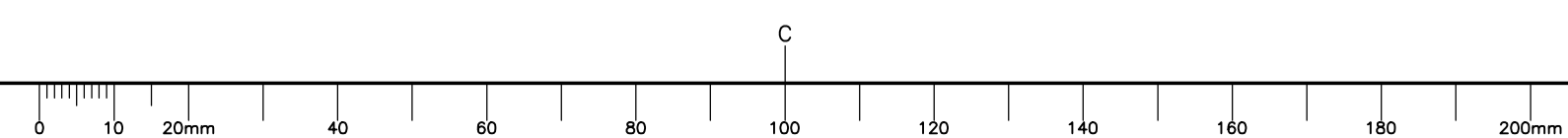

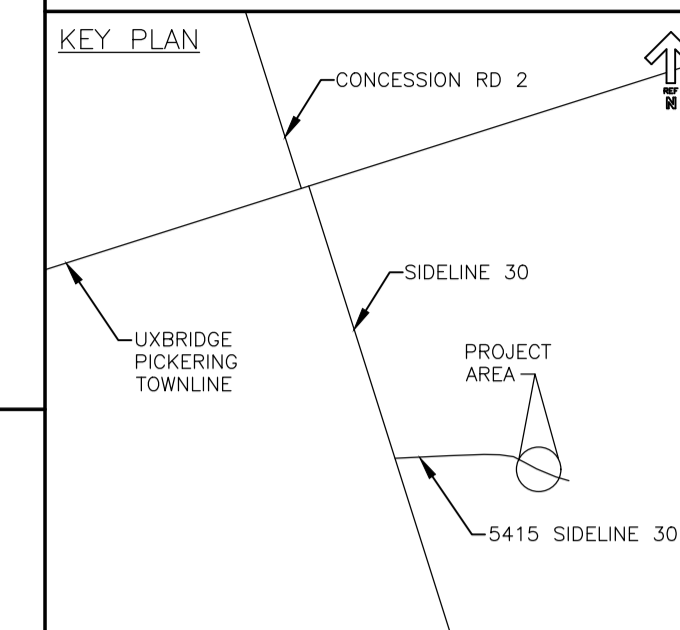

STANTEC
400-1505 Laperriere Ave
Ottawa ON
Tel. 613.722.4420
www.stantec.com

NOTES:

- SEE DWG S-1 FOR DESIGN LOADING AND GENERAL NOTES.
- SEE DWG S-2 FOR SITE PLAN LAYDOWN AREA.
- SEE DWG S-4 FOR TYPICAL CONSTRUCTION DETAILS.



0	ISSUED FOR TENDER	01/15/2020
revisions		date
project		projct

BRIDGE REHABILITATION
5415 SIDELINE 30
CLAREMONT (PIN#614611-2)
ROUGE NATIONAL URBAN PARK,
PARKS CANADA

drawing dessin

GENERAL ARRANGEMENT

designed TM conçu

date 2019-09-11

drawn CLD dessiné

date 2019-09-11

approved approuvé

date

Tender Soumission

PWGC Project Manager Administrateur de projets TPSCG

project number no. du projet

45419775

drawing no. no. du dessin

S-3

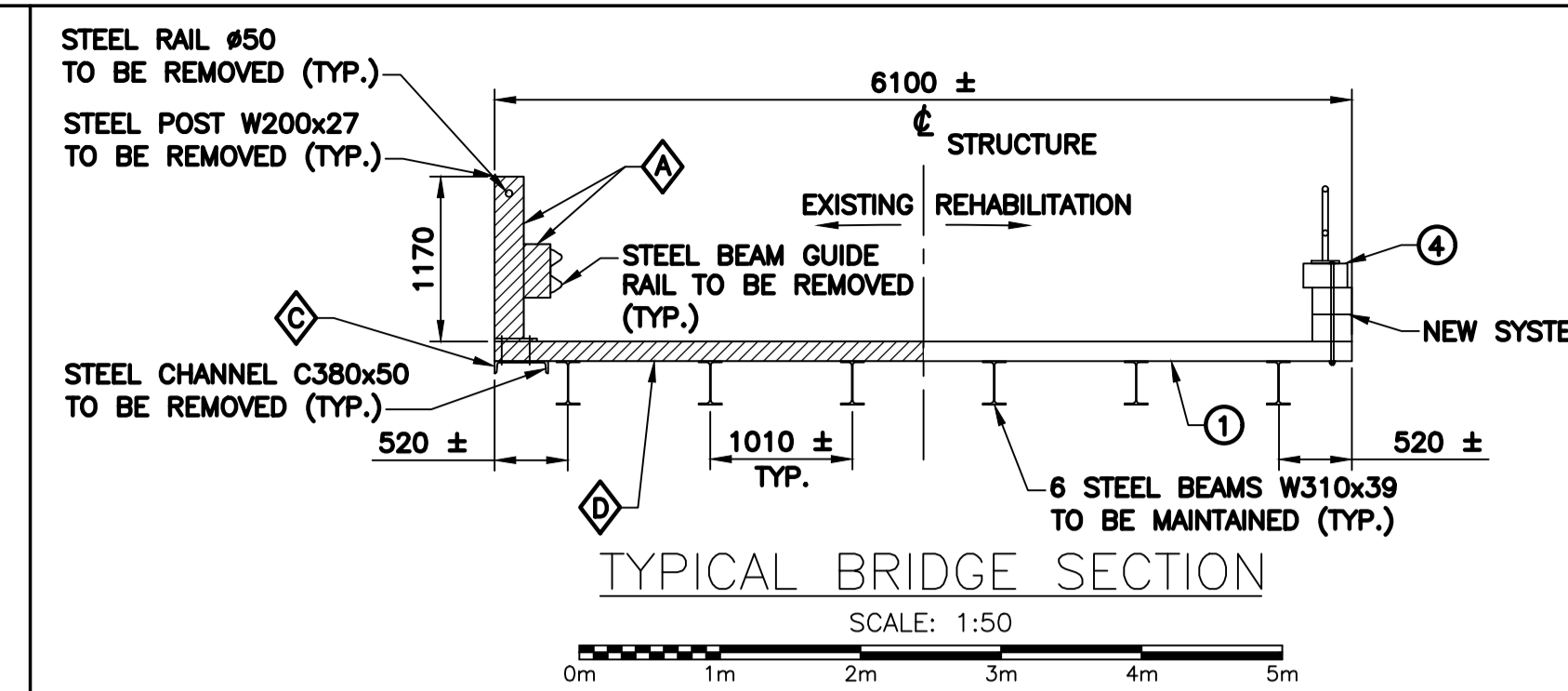

GENERAL NOTE:

- THE GENERAL SCOPE OF THE REHABILITATION WORK OUTLINED BELOW AND DESIGNATED ON THIS DRAWING SHALL BE CONSIDERED SIMILAR ON EACH SIDE OF THE CENTRELINE OF THE BRIDGE, UNLESS NOTED OTHERWISE.

REMOVALS:

- Ⓐ REMOVE STEEL BEAM GUIDE RAIL AND HAND RAIL.
- Ⓑ REMOVE DECK SIDE EXPANSION JOINT ARMORING ANGLE.
- Ⓒ REMOVE STEEL CHANNEL UNDER BRIDGE DECK.
- Ⓓ REMOVE WOOD DECK

NEW CONSTRUCTION:

- ① INSTALL 38x140 TRANSVERSE NAIL LAMINATED WOOD DECK.
- ② INSTALL ARMORING ANGLE ON WOOD DECK
- ③ INSTALL COMPRESSION SEAL AT EXPANSION JOINT.
- ④ INSTALL BRIDGE GUIDE RAIL AND STEEL PIPE HANDRAIL.

LEGEND:

- ▨ EXISTING TO BE REMOVED
- ▩ EXISTING CONDITION
- ▧ NEW CONDITION



PLAN

SCALE : 1:30

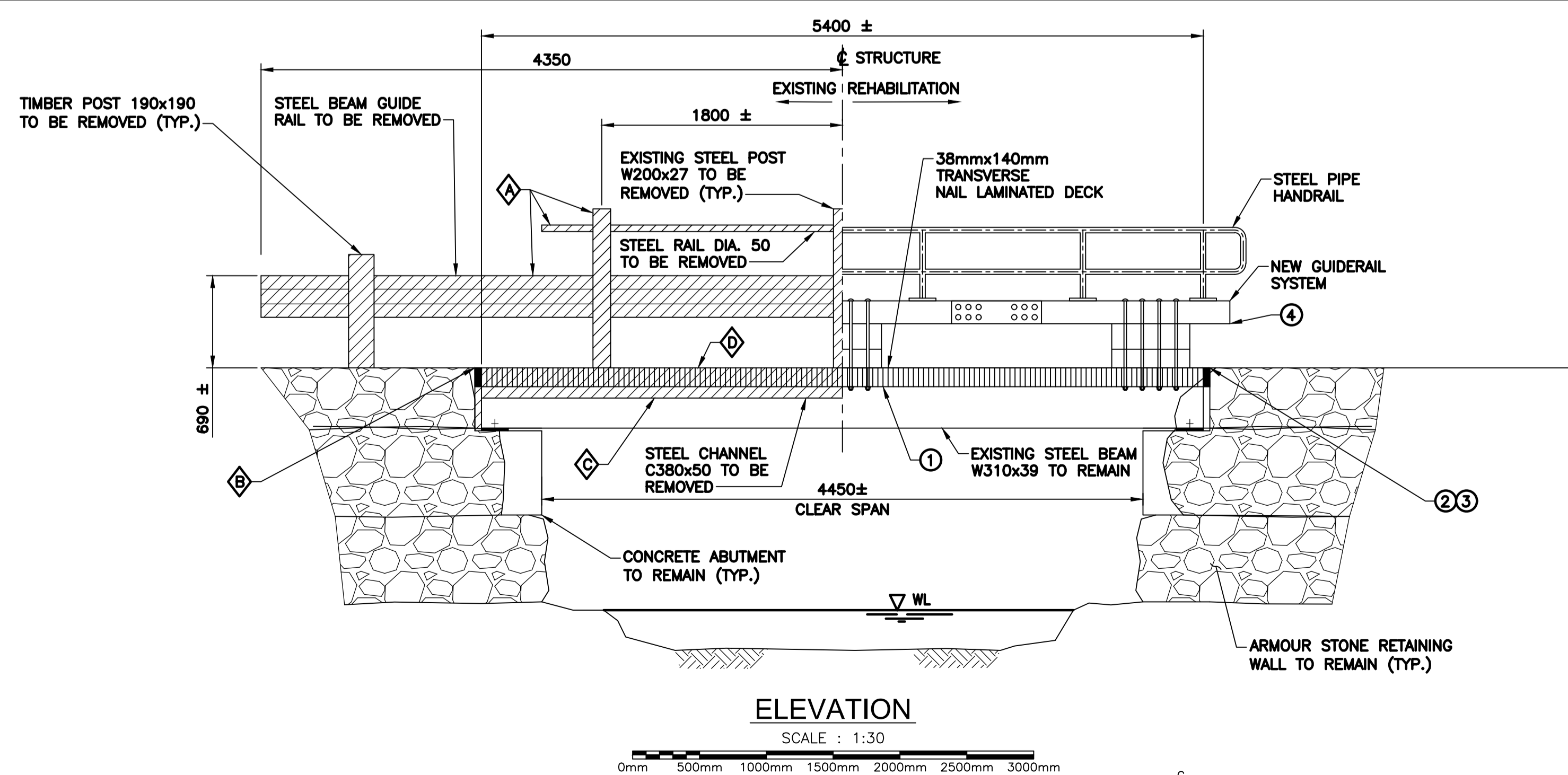

ELEVATION

SCALE : 1:30

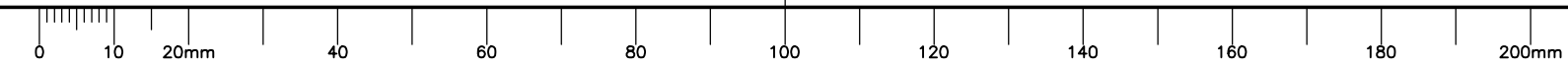
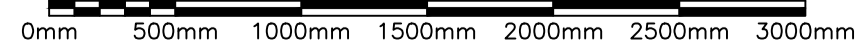

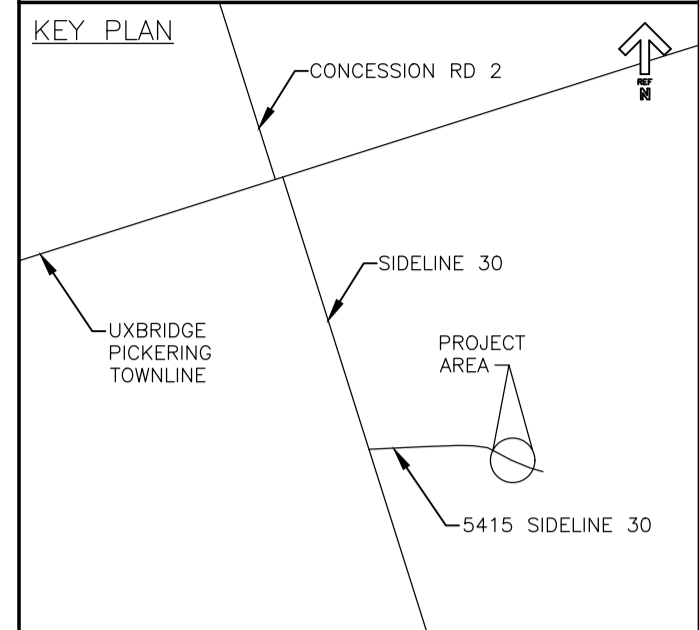

STANTEC
400-1505 Laperriere Ave
Ottawa ON
Tel. 613.722.4420
www.stantec.com

- NOTES:**
- SEE DWG S-1 FOR DESIGN LOADING AND GENERAL NOTES.
 - SEE DWG S-3 FOR EXISTING/NEW GENERAL ARRANGEMENT.



0	ISSUED FOR TENDER	01/15/2020
revisions		date

project project
BRIDGE REHABILITATION
5415 SIDELINE 30
CLAREMONT (PIN#614611-2)
ROUGE NATIONAL URBAN PARK,
PARKS CANADA

STRUCTURAL DETAILS

designed	TM	conçu
date	2019-09-11	
drawn	CLD	dessiné
date	2019-09-11	
approved		approuvé
date		
Tender		Soumission
PWGC Project Manager	Administrateur de projets TPSGC	
project number	no. du projet	
	45419775	
drawing no.	no. du dessin	
	S-4	

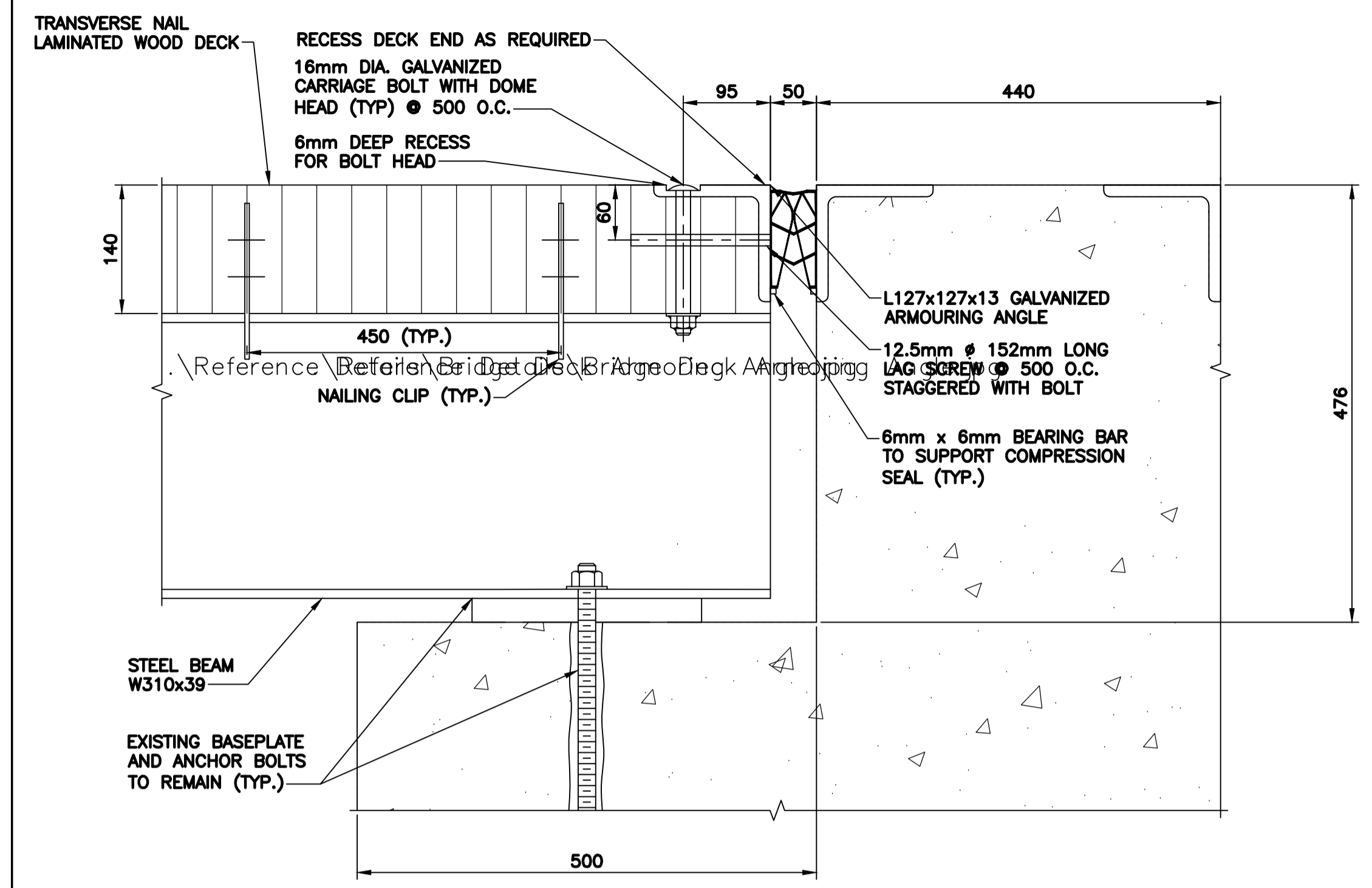

ARMORING ANGLE DETAIL

SCALE : 1:5
0mm 100mm 200mm 300mm 400mm 500mm

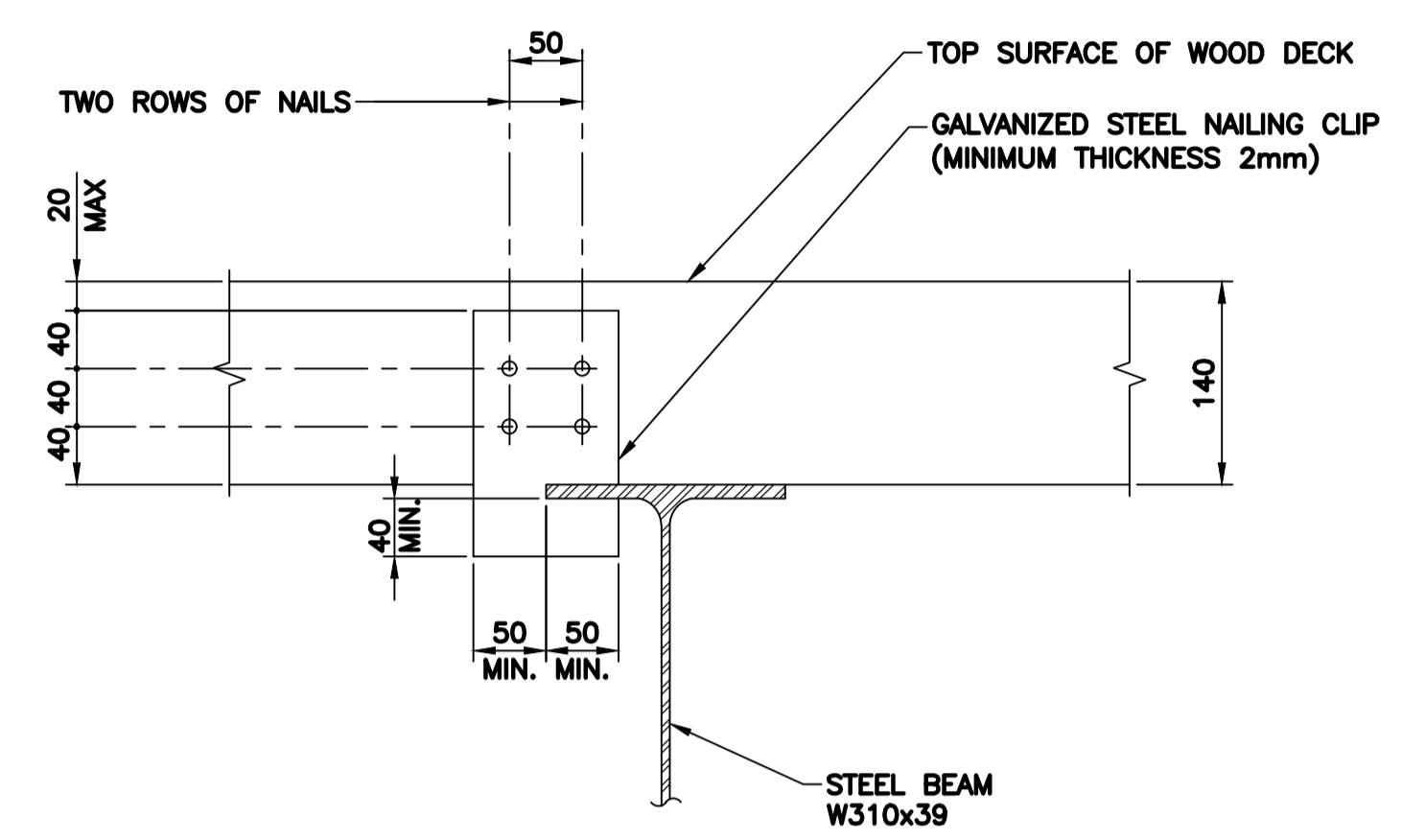

NOTE: NAILING CLIPS TO BE INSTALLED AT 450mm SPACING ALONG EACH SIDE OF BEAM AND STAGGERED BY 225mm.

CONNECTION OF NAIL-LAMINATED DECK TO STEEL BEAM

SCALE : 1:5
0mm 100mm 200mm 300mm 400mm 500mm

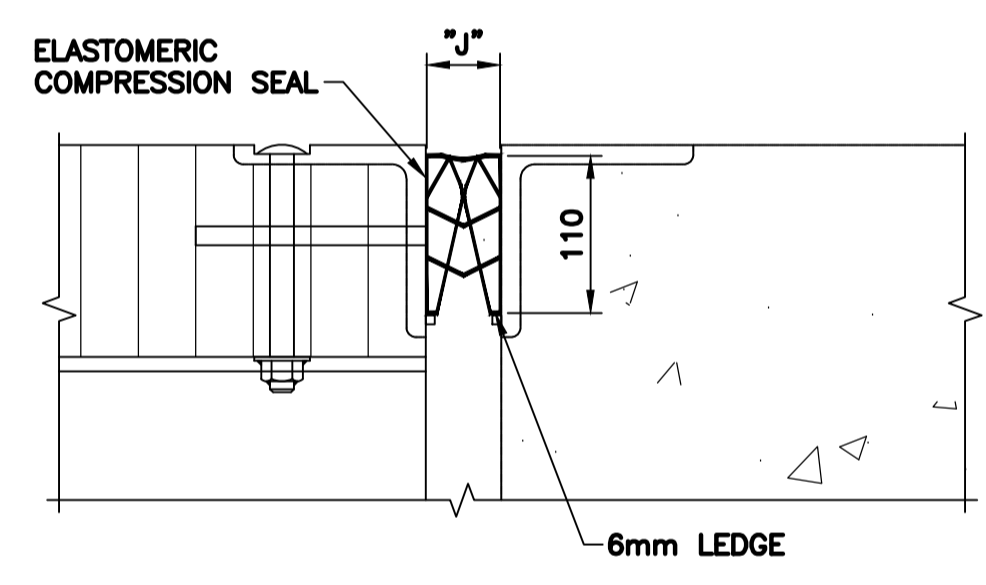

EXPANSION JOINT DETAIL

SCALE : 1:5
0mm 100mm 200mm 300mm 400mm 500mm

EXPANSION JOINT LOCATION	* "J" AT INSTALLATION TEMPERATURE (C) (mm)							
	-5°	0°	5°	10°	15°	20°	25°	30°
WEST ABUTMENT	50	50	50	50	50	50	50	50
EAST ABUTMENT	49	49	49	50	50	50	51	51

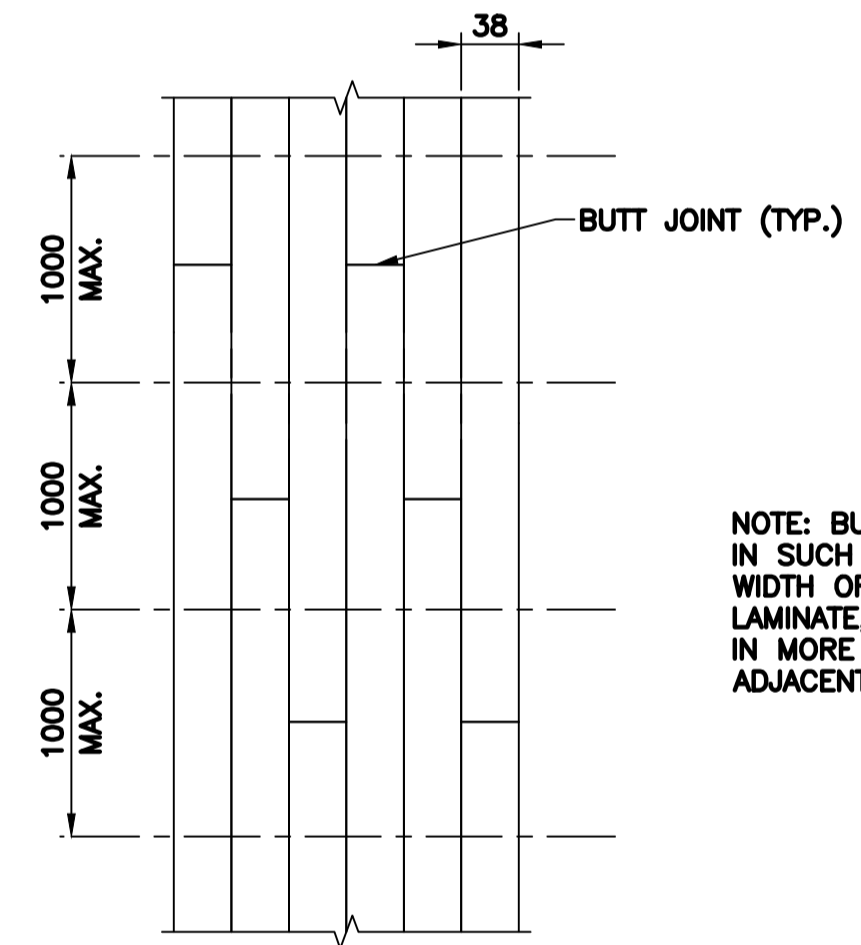

NOTE: BUTT JOINTS SHOULD BE STAGGERED IN SUCH A WAY THAT WITHIN ANY BAND WIDTH OF 1.0m MEASURED ALONG THE LAMINATE, A BUTT JOINT SHALL NOT OCCUR IN MORE THAN 1 LAMINATE OUT OF 3 ADJACENT LAMINATES.

BUTT JOINT STAGGERING DETAIL

N.T.S.

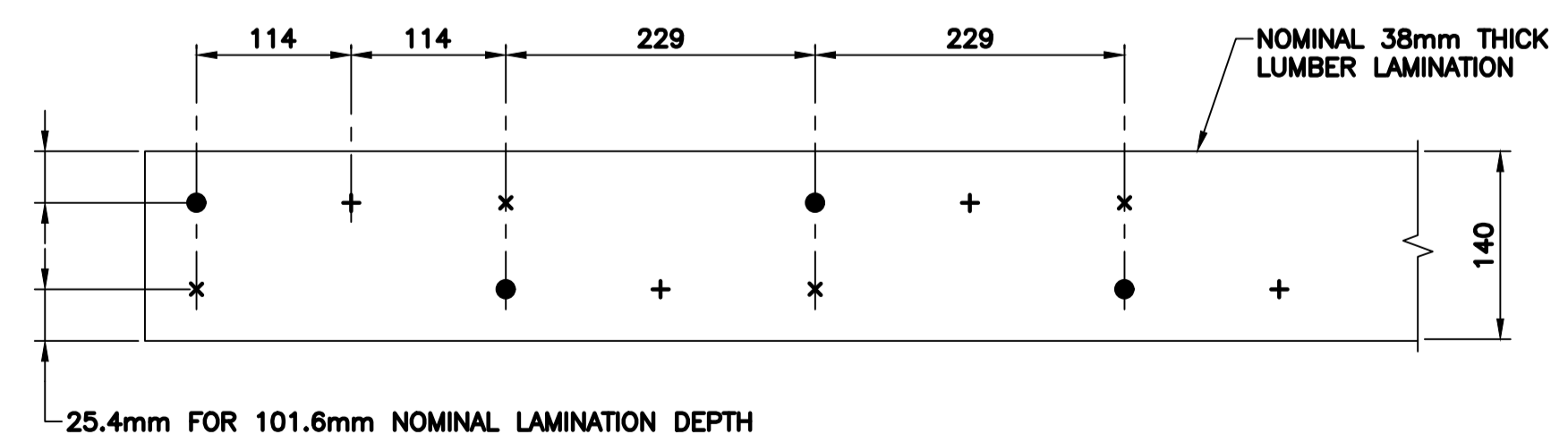

NAILING PATTERN

SCALE : 1:5
0mm 100mm 200mm 300mm 400mm 500mm

- INDICATES NAILS IN FIRST LAMINATION
- × INDICATES NAILS IN SECOND LAMINATION
- + INDICATES NAILS IN THIRD LAMINATION

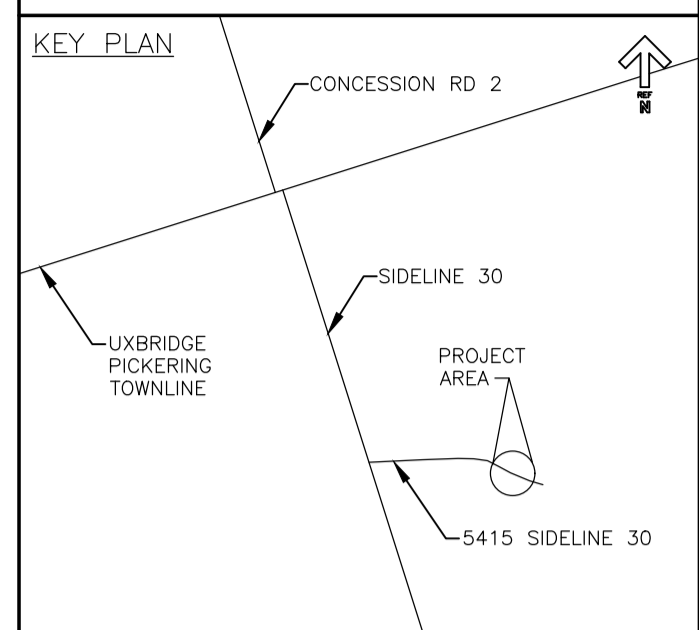
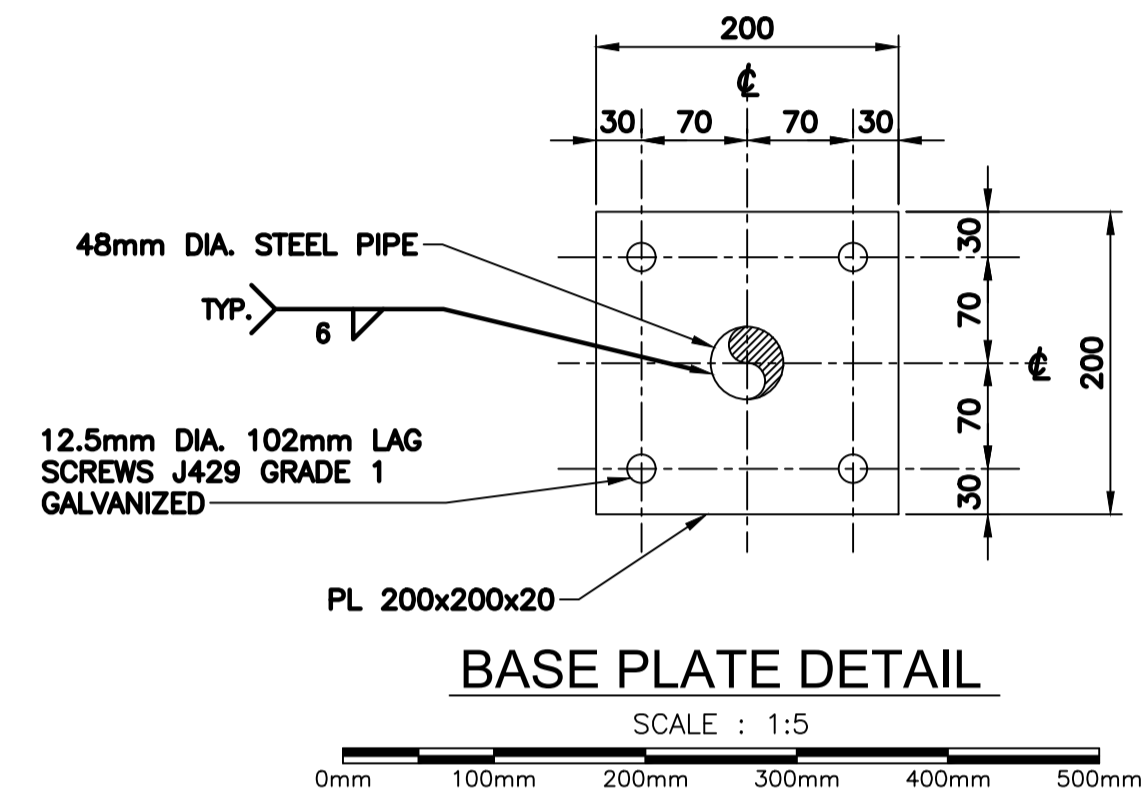
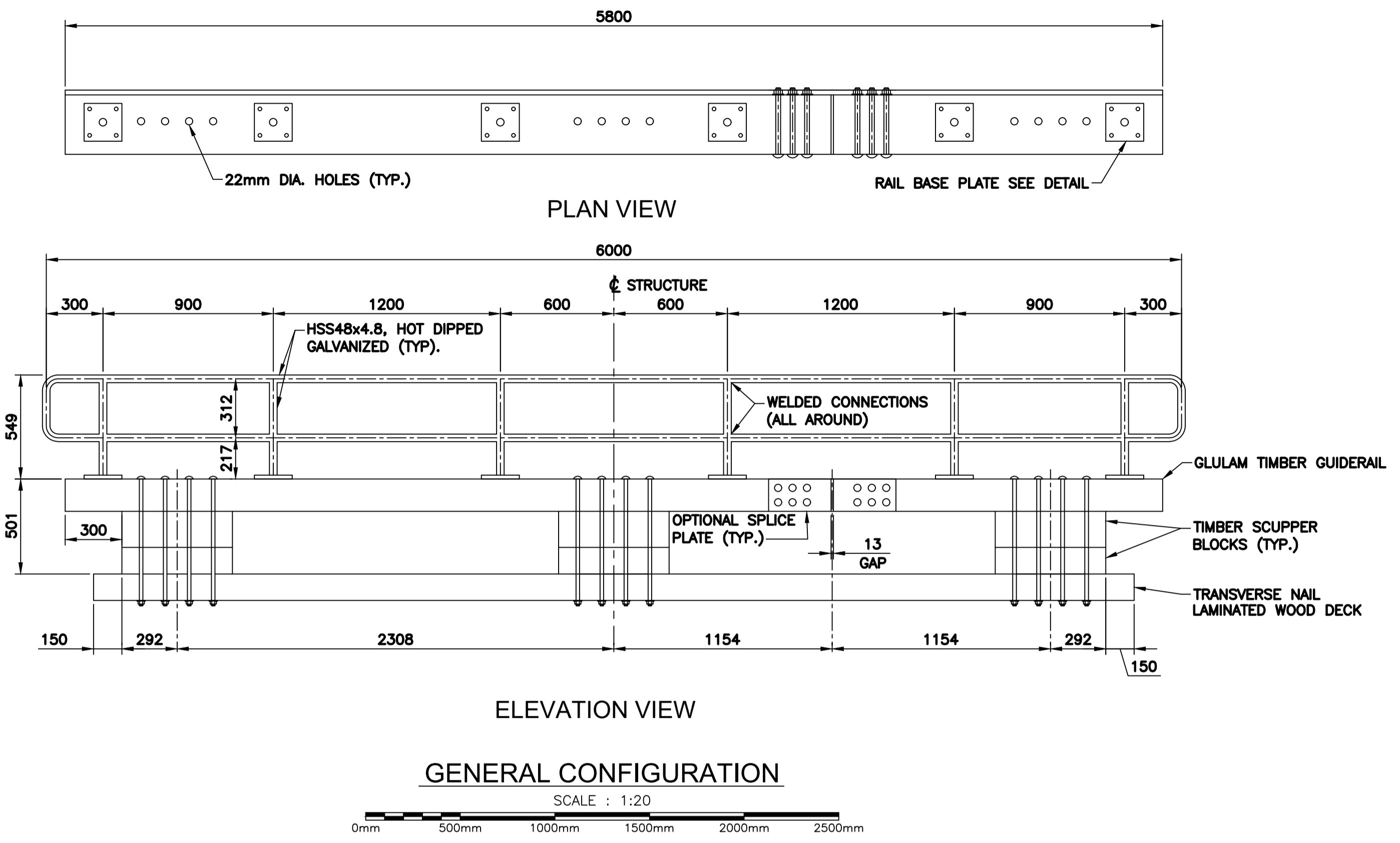

Stantec
 STANTEC
 400-1505 Laperriere Ave
 Ottawa ON
 Tel. 613.722.4420
 www.stantec.com

- NOTES:**
- SEE DWG S-1 FOR DESIGN LOADING AND GENERAL NOTES.
 - SEE DWG S-3 FOR EXISTING/NEW GENERAL ARRANGEMENT.



0	ISSUED FOR TENDER	01/15/2020
revisions		date
project		project

BRIDGE REHABILITATION
 5415 SIDELINE 30
 CLAREMONT (PIN#614611-2)
 ROUGE NATIONAL URBAN PARK,
 PARKS CANADA

GLULAM TIMBER GUIDERAIL DETAILS

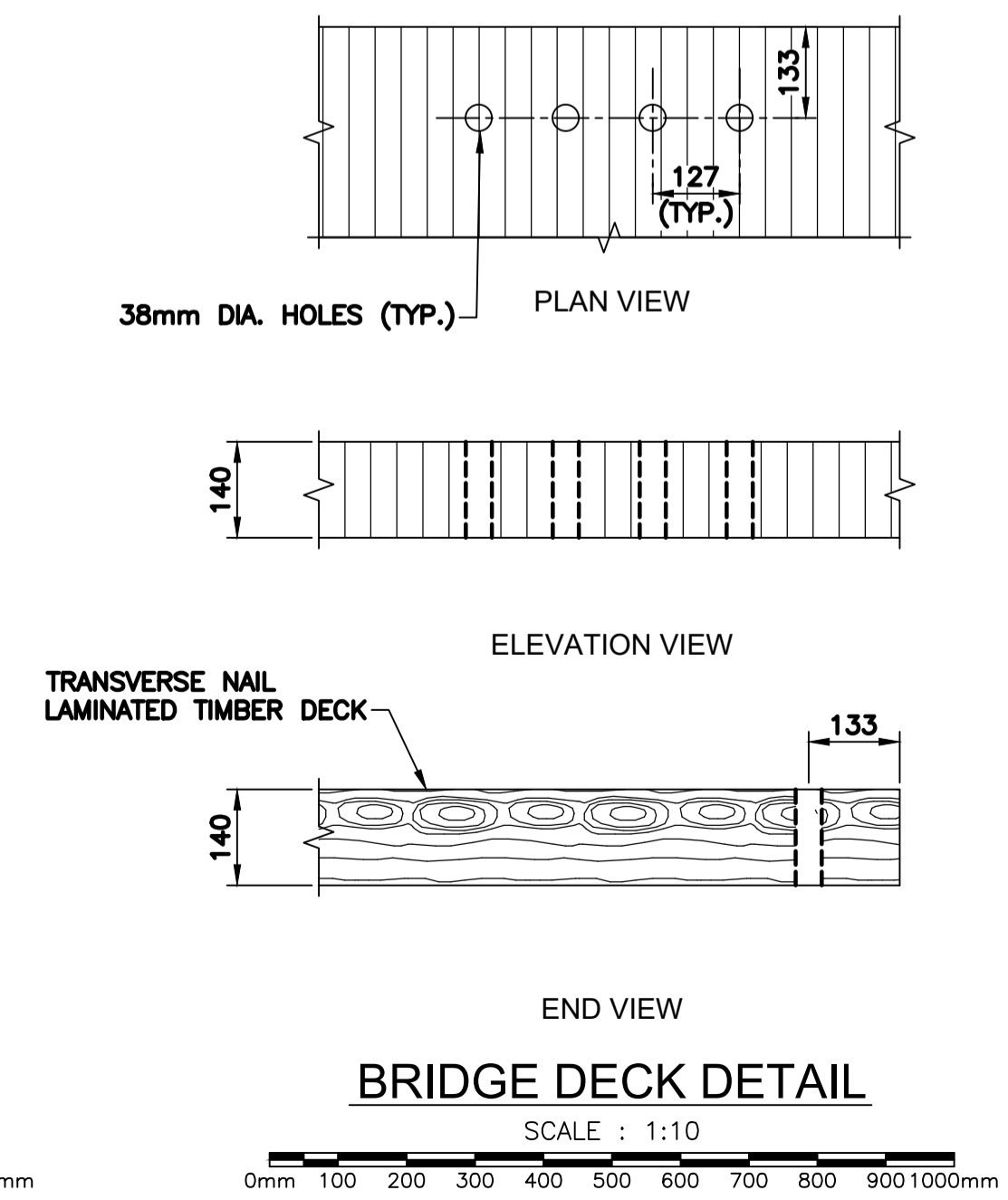
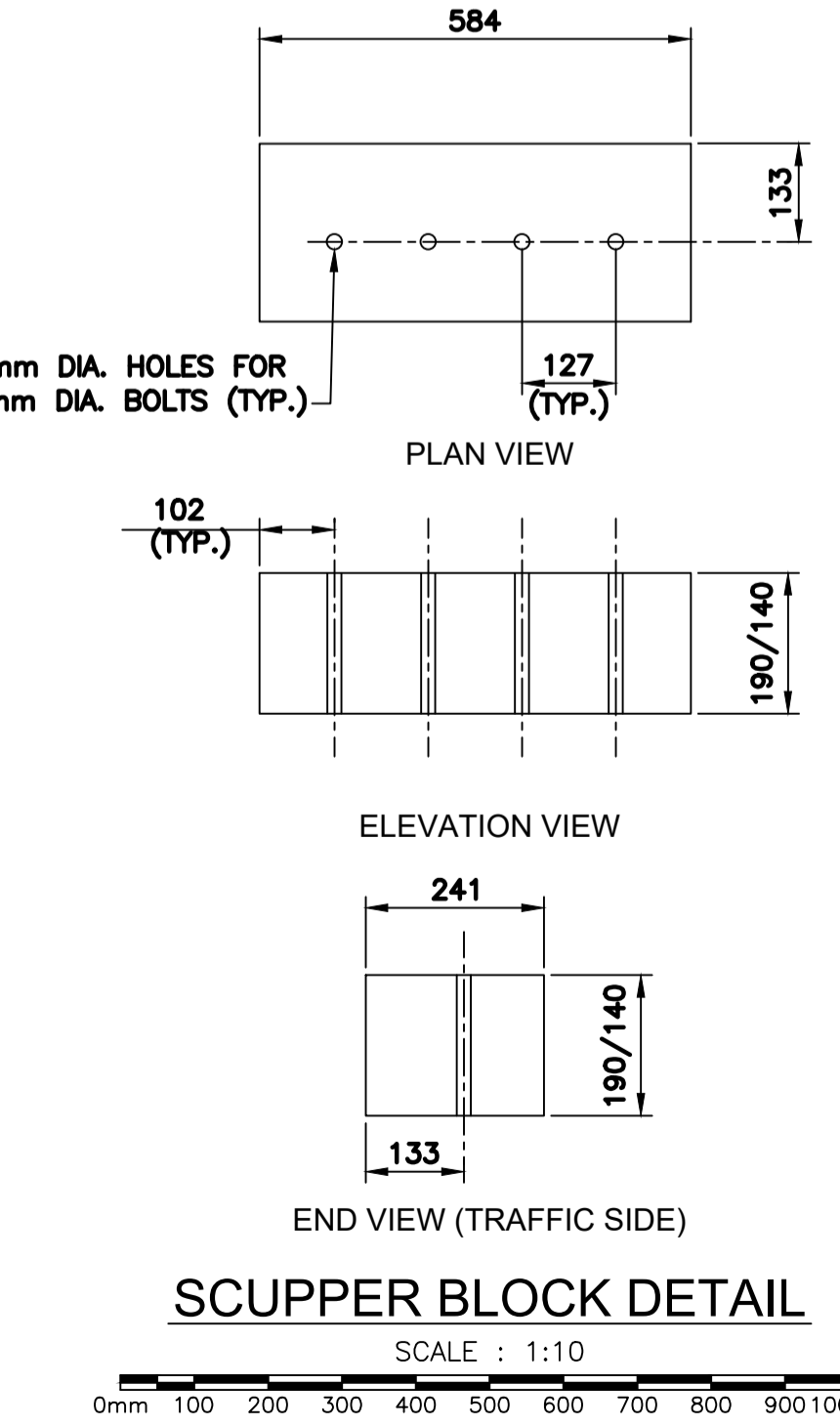
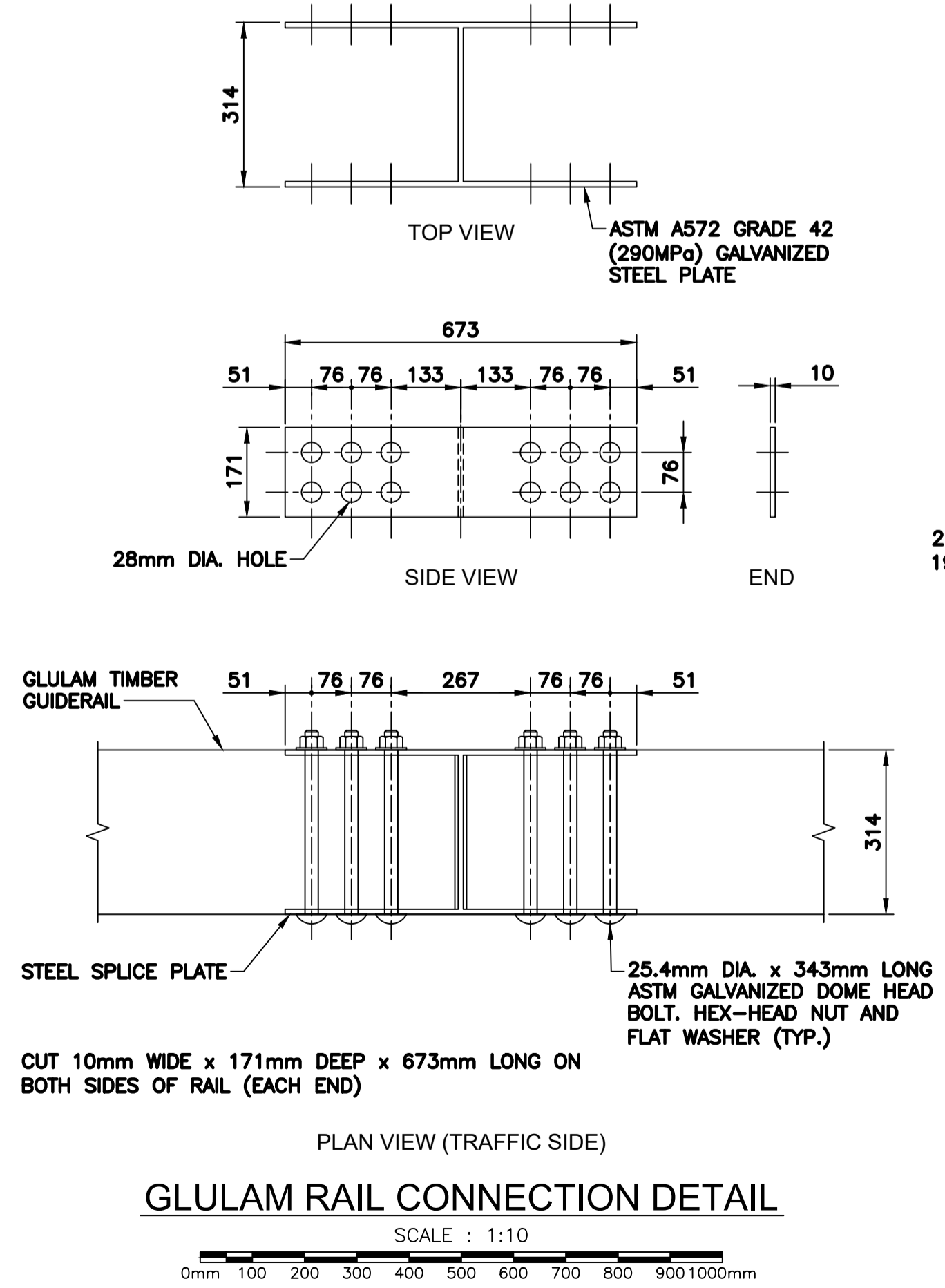
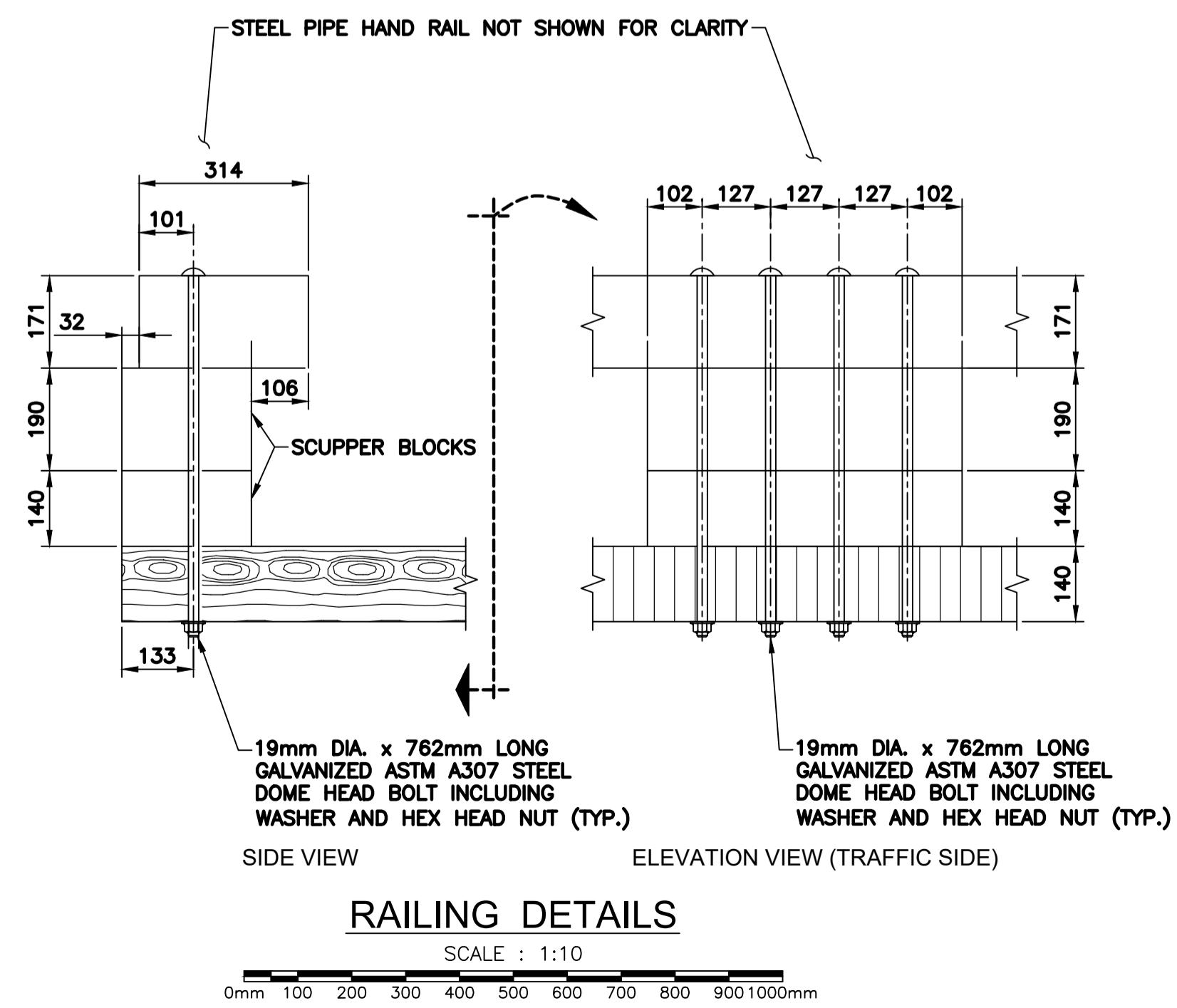

designed	TM	conçu
date	2019-09-11	
drawn	CLD	dessiné
date	2019-09-11	
approved		approuvé
date		
Tender		Soumission
PWGC Project Manager	Administrateur de projets TPSC	
project number	no. du projet	
	45419775	
drawing no.		no. du dessin
	S-5	