



**RETURN BIDS TO:  
RETOURNER LES SOUMISSIONS À:**

**Bid Receiving - PWGSC / Réception des  
soumissions - TPSGC**  
11 Laurier St. / 11, rue Laurier  
Place du Portage, Phase III  
Core 0B2 / Noyau 0B2  
Gatineau, Québec K1A 0S5  
Bid Fax: (819) 997-9776

**REQUEST FOR PROPOSAL  
DEMANDE DE PROPOSITION**

**Proposal To: Public Works and Government  
Services Canada**

We hereby offer to sell to Her Majesty the Queen in right of Canada, in accordance with the terms and conditions set out herein, referred to herein or attached hereto, the goods, services, and construction listed herein and on any attached sheets at the price(s) set out therefor.

**Proposition aux: Travaux Publics et Services  
Gouvernementaux Canada**

Nous offrons par la présente de vendre à Sa Majesté la Reine du chef du Canada, aux conditions énoncées ou incluses par référence dans la présente et aux annexes ci-jointes, les biens, services et construction énumérés ici sur toute feuille ci-annexée, au(x) prix indiqué(s).

**Comments - Commentaires**

**Vendor/Firm Name and Address**

**Raison sociale et adresse du  
fournisseur/de l'entrepreneur**

**Issuing Office - Bureau de distribution**

Electrical & Electronics Products Division  
L'Esplanade Laurier  
East Tower, 4th floor,  
Ottawa  
Ontario  
K1A 0S5

<b>Title - Sujet</b> Lighting Enclosure		
<b>Solicitation No. - N° de l'invitation</b> C1111-190732/A	<b>Date</b> 2020-04-07	
<b>Client Reference No. - N° de référence du client</b> C1111-190732		
<b>GETS Reference No. - N° de référence de SEAG</b> PW-\$\$HN-458-78642		
<b>File No. - N° de dossier</b> hn458.C1111-190732	<b>CCC No./N° CCC - FMS No./N° VME</b>	
<b>Solicitation Closes - L'invitation prend fin</b> <b>at - à 02:00 PM</b> <b>on - le 2020-05-19</b>		<b>Time Zone</b> <b>Fuseau horaire</b> Eastern Daylight Saving Time EDT
<b>F.O.B. - F.A.B.</b> <b>Plant-Usine:</b> <input type="checkbox"/> <b>Destination:</b> <input checked="" type="checkbox"/> <b>Other-Autre:</b> <input type="checkbox"/>		
<b>Address Enquiries to: - Adresser toutes questions à:</b> Lee, Carlos		<b>Buyer Id - Id de l'acheteur</b> hn458
<b>Telephone No. - N° de téléphone</b> (613) 296-6475 ( )	<b>FAX No. - N° de FAX</b> ( ) -	
<b>Destination - of Goods, Services, and Construction:</b> <b>Destination - des biens, services et construction:</b>  Specified Herein Précisé dans les présentes		

**Instructions: See Herein**

**Instructions: Voir aux présentes**

<b>Delivery Required - Livraison exigée</b> See Herein	<b>Delivery Offered - Livraison proposée</b>
<b>Vendor/Firm Name and Address</b> <b>Raison sociale et adresse du fournisseur/de l'entrepreneur</b>	
<b>Telephone No. - N° de téléphone</b> <b>Facsimile No. - N° de télécopieur</b>	
<b>Name and title of person authorized to sign on behalf of Vendor/Firm</b> <b>(type or print)</b> <b>Nom et titre de la personne autorisée à signer au nom du fournisseur/ de l'entrepreneur (taper ou écrire en caractères d'imprimerie)</b>	
<b>Signature</b>	<b>Date</b>



Destination Code - Code destinataire	Destination Address - Adresse de la destination	Invoice Code - Code bur.-comptable	Invoice Address - Adresse de facturation
D - 1	25 Eddy, 11th floor Gatineau, QC K1A 0M5	I - 1	pch.dgr-semc-rmd-smec.pch@canada.ca

Item Article	Description	Dest. Code Dest.	Inv. Code Fact.	Qty Qté	U. of I. U. de D.	Unit Price/Prix unitaire FOB/FAM Destination Plant/Usine	Delivery Req. Livraison Req.	Del. Offered Liv. offerte
1	Lighting Enclosure As detailed in Annex A - Statement of Requirement ● ● P/N Offered: _____ ● Name of Manufacturer: _____ ● Delivery Date Offered: _____	D - 1	I - 1	16	Each	\$ XXXXXXXXXXXXX	See Herein	

## **PART 1 - GENERAL INFORMATION**

1. Security Requirement
2. Requirement
3. Debriefings
4. Trade Agreements

## **PART 2 - BIDDER INSTRUCTIONS**

1. Standard Instructions, Clauses and Conditions
2. Submission of Bids
3. Enquiries - Bid Solicitation
4. Applicable Laws

## **PART 3 - BID PREPARATION INSTRUCTIONS**

1. Bid Preparation Instructions

## **PART 4 - EVALUATION PROCEDURES AND BASIS OF SELECTION**

1. Evaluation Procedures
2. Basis of Selection

## **PART 5 - CERTIFICATIONS**

- 5.1 Certifications Required with the Bid
- 5.2 Certifications Precedent to Contract Award and Additional Information

## **PART 6 - RESULTING CONTRACT CLAUSES**

1. Security Requirement
2. Requirement
3. Standard Clauses and Conditions
4. Term of Contract
5. Authorities
6. Payment
7. Invoicing Instructions
8. Certifications
9. Applicable Laws
10. Priority of Documents
11. SACC Manual Clauses (Delivery)

List of Annex's:

Annex A – Statement of Requirement  
Annex B – Replacement Parts  
Annex C – Evaluation Criteria



## **PART 1 - GENERAL INFORMATION**

### **1. Security Requirement**

There is no security requirement associated with the requirement.

### **2. Requirement**

The contractor must provide the goods in accordance with the technical requirements and in the quantities as stated herein.

#### **2.1 Delivery Requirement**

Delivery is requested to be completed by May 29, 2020.

### **3. Debriefings**

Bidders may request a debriefing on the results of the bid solicitation process. Bidders should make the request to the Contracting Authority within 15 working days of receipt of the results of the bid solicitation process. The debriefing may be in writing, by telephone or in person.

### **4. Trade Agreements**

The requirement is subject to the provisions of the North American Free Trade Agreement (NAFTA), and the Canadian Free Trade Agreement (CFTA).

## PART 2 - BIDDER INSTRUCTIONS

### 1. Standard Instructions, Clauses and Conditions

All instructions, clauses and conditions identified in the bid solicitation by number, date and title are set out in the *Standard Acquisition Clauses and Conditions Manual* (<https://buyandsell.gc.ca/policy-and-guidelines/standard-acquisition-clauses-and-conditions-manual>) issued by Public Works and Government Services Canada.

Bidders who submit a bid agree to be bound by the instructions, clauses and conditions of the bid solicitation and accept the clauses and conditions of the resulting contract.

The 2003 (2019-03-04) Standard Instructions - Goods or Services - Competitive Requirements, are incorporated by reference into and form part of the bid solicitation.

Subsection 5.4 of 2003, Standard Instructions - Goods or Services - Competitive Requirements, is amended as follows:

Delete: sixty (60) days  
Insert: ninety (90) calendar days

#### 1.1 SACC Manual Clauses

SACC Reference	Section	Date
A9033T	Financial Capability	2012-07-16
B1000T	Condition of Material	2014-06-26

### 2. Submission of Bids

Bids must be submitted ONLY TO THE BID RECEIVING UNIT by the date, time and place indicated on page 1 of the bid solicitation. Do not send proposal directly to the Contracting Officer. Email proposal are not accepted.

PWGSC Bids Receiving Unit  
11 Laurier Street  
Place du Portage, Phase 3, Core 0B2  
Gatineau, Québec, K1A 0S5  
Tel.: 819-420-7201  
Fax: 819-997-9776

### **3. Enquiries - Bid Solicitation**

All enquiries must be submitted in writing to the Contracting Authority no later than five (5) calendar days before the bid closing date. Enquiries received after that time may not be answered.

Bidders should reference as accurately as possible the numbered item of the bid solicitation to which the enquiry relates. Care should be taken by bidders to explain each question in sufficient detail in order to enable Canada to provide an accurate answer. Technical enquiries that are of a proprietary nature must be clearly marked "proprietary" at each relevant item. Items identified as "proprietary" will be treated as such except where Canada determines that the enquiry is not of a proprietary nature. Canada may edit the questions or may request that the Bidder do so, so that the proprietary nature of the question is eliminated, and the enquiry can be answered with copies to all bidders. Enquiries not submitted in a form that can be distributed to all bidders may not be answered by Canada.

### **4. Applicable Laws**

Any resulting contract must be interpreted and governed, and the relations between the parties determined, by the laws in force in Ontario.

Bidders may, at their discretion, substitute the applicable laws of a Canadian province or territory of their choice without affecting the validity of their bid, by deleting the name of the Canadian province or territory specified and inserting the name of the Canadian province or territory of their choice. If no change is made, it acknowledges that the applicable laws specified are acceptable to the bidders.



## **PART 3 - BID PREPARATION INSTRUCTIONS**

### **1. Bid Preparation Instructions**

Canada requests that bidders provide their bid in separately bound sections as follows:

Section I: Technical Bid (2 hard copies)

Section II: Financial Bid ( 1 hard copy)

Section III: Certifications ( 1 hard copy)

Section IV: Additional Information ( 1 hard copy)

Prices must appear in the financial bid only. No prices must be indicated in any other section of the bid.

Canada requests that bidders follow the format instructions described below in the preparation of their bid:

- (a) use 8.5 x 11 inch (216 mm x 279 mm) paper;
- (b) use a numbering system that corresponds to the bid solicitation.

In April 2006, Canada issued a policy directing federal departments and agencies to take the necessary steps to incorporate environmental considerations into the procurement process Policy on Green Procurement (<http://www.tpsgc-pwgsc.gc.ca/ecologisation-greening/achats-procurement/politique-policy-eng.html>). To assist Canada in reaching its objectives, bidders are encouraged to:

- 1) use paper containing fibre certified as originating from a sustainably-managed forest and/or containing minimum 30% recycled content; and
- 2) use an environmentally-preferable format including black and white printing instead of colour printing, printing double sided/duplex, using staples or clips instead of cerlox, duotangs or binders.

#### **Section I: Technical Bid**

In their technical bid, bidders should explain and demonstrate how they propose to meet the requirements and how they will carry out the Work.





## **Section II: Financial Bid**

Bidders must submit their financial bid in accordance with the Basis of Payment. The total amount of Applicable Taxes must be shown separately.

### **1.1 Exchange Rate Fluctuation Risk Mitigation**

The requirement does not offer exchange rate fluctuation risk mitigation. Requests for exchange rate fluctuation risk mitigation will not be considered. All bids including such provision will render the bid non-responsive.

## **Section III: Certifications**

### **1.2 Certifications**

Bidders must submit the certifications required under Part 5.

## **Section IV: Additional Information**

### **1.3 Additional Information**

#### **1.3.1 Delivery Offered**

While delivery is requested as indicated above, the best delivery that could be offered is \_\_\_\_\_.

#### **1.3.2 Contractor Representatives**

Name and telephone number of the person responsible for:

##### **General enquiries**

Name:

Telephone:

Facsimile:

E-mail:

##### **Delivery follow-up**

Name:

Telephone:

Facsimile:

E-mail:



## **PART 4 - EVALUATION PROCEDURES AND BASIS OF SELECTION**

### **1. Evaluation Procedures**

- (a) Bids will be assessed in accordance with the entire requirement of the bid solicitation including the technical and financial evaluation criteria.
- (b) An evaluation team composed of representatives of Canada will evaluate the bids.

### **Evaluation Criteria**

All bids must be completed in full and provide all of the information requested in the bid solicitation to enable full and complete evaluation.

#### **1.1 Technical Evaluation**

##### **1.1.1 Mandatory Technical Criteria**

The following Mandatory requirements must be submitted with the bid for evaluation

Technical compliance (description of items as stated Annex A);  
Completion of Annex B – Replacement Parts

#### **1.2 Financial Evaluation**

##### **1.2.1 Pricing Basis**

The bidder must quote firm unit prices in Canadian dollars, DDP Delivered Duty Paid (destination), Applicable Taxes extra, as applicable. Freight charges to destination and all applicable Custom duties and Excise taxes must be included.

### **2. Basis of Selection**

A bid must comply with the requirements of the bid solicitation and meet all mandatory technical evaluation criteria to be declared responsive. The responsive bid with the lowest Evaluated Price on an item by item basis will be recommended for award of a contract.



## PART 5 – CERTIFICATIONS AND ADDITIONAL INFORMATION

Bidders must provide the required certifications and additional information to be awarded a contract.

The certifications provided by Bidders to Canada are subject to verification by Canada at all times. Canada will declare a bid non-responsive, or will declare a contractor in default if any certification made by the Bidder is found to be untrue whether made knowingly or unknowingly, during the bid evaluation period or during the contract period.

The Contracting Authority will have the right to ask for additional information to verify the Bidder's certifications. Failure to comply and to cooperate with any request or requirement imposed by the Contracting Authority will render the bid non-responsive or constitute a default under the Contract.

### 5.1 Certifications Required with the Bid

Bidders must submit the following duly completed certifications as part of their bid.

#### 5.1.1 Declaration of Convicted Offences

In accordance with the Integrity Provisions of the Standard Instructions, all bidders must provide with their bid, **if applicable**, the declaration form available on the Forms for the Integrity Regime website (<http://www.tpsgc-pwgsc.gc.ca/ci-if/declaration-eng.html>), to be given further consideration in the procurement process.

### 5.2 Certifications Precedent to Contract Award and Additional Information

The certifications and additional information listed below should be submitted with the bid, but may be submitted afterwards. If any of these required certifications or additional information is not completed and submitted as requested, the Contracting Authority will inform the Bidder of a time frame within which to provide the information. Failure to provide the certifications or the additional information listed below within the time frame provided will render the bid non-responsive.

#### 5.2.1 Integrity Provisions – Required Documentation

In accordance with the section titled Information to be provided when bidding, contracting or entering into a real procurement agreement of the Ineligibility and Suspension Policy (<http://www.tpsgc-pwgsc.gc.ca/ci-if/politique-policy-eng.html>), the Bidder must provide the required documentation, as applicable, to be given further consideration in the procurement process.

### 5.2.2 General Environmental Criteria Certification

The Bidder must select and complete one of the following two certification statements.

A) The Bidder certifies that the Bidder is registered or meets ISO 14001.

\_\_\_\_\_  
Bidders' Authorized Representative Signature

\_\_\_\_\_  
Date

**or**

B) The Bidder certifies that the Bidder meets and will continue to meet throughout the duration of the contract, a minimum of four (4) out of six (6) criteria identified in the table below.

The Bidder must indicate which four (4) criteria, as a minimum, are met.

<b>Green Practices within the Bidders' organization</b>	<b>Insert a checkmark for each criterion that is met</b>
Promotes a paperless environment through directives, procedures and/or programs	
All documents are printed double sided and in black and white for day to day business activity unless otherwise specified by your client	
Paper used for day to day business activity has a minimum of 30% recycled content and has a sustainable forestry management certification	
Utilizes environmentally preferable inks and purchase remanufactured ink cartridges or ink cartridges that can be returned to the manufacturer for reuse and recycling for day to day business activity.	
Recycling bins for paper, newsprint, plastic and aluminum containers available and emptied regularly in accordance with local recycling program.	
A minimum of 50% of office equipment has an energy efficient certification.	

\_\_\_\_\_  
Bidders' Authorized Representative Signature

\_\_\_\_\_  
Date



### 5.2.3 Federal Contractors Program for Employment Equity - Bid Certification

By submitting a bid, the Bidder certifies that the Bidder, and any of the Bidder's members if the Bidder is a Joint Venture, is not named on the Federal Contractors Program (FCP) for employment equity "FCP Limited Eligibility to Bid" list available at the bottom of the page of the Employment and Social Development Canada (ESDC) - Labour's website ([http://www.esdc.gc.ca/en/jobs/workplace/human\\_rights/employment\\_equity/federal\\_contractor\\_program.page?&\\_ga=1.229006812.1158694905.1413548969](http://www.esdc.gc.ca/en/jobs/workplace/human_rights/employment_equity/federal_contractor_program.page?&_ga=1.229006812.1158694905.1413548969)).

Canada will have the right to declare a bid non-responsive if the Bidder, or any member of the Bidder if the Bidder is a Joint Venture, appears on the "FCP Limited Eligibility to Bid" list at the time of contract award.

## PART 6 - RESULTING CONTRACT CLAUSES

### 1. Security Requirement

There is no security requirement associated with the requirement.

### 2. Requirement

The contractor must provide the goods in accordance with the technical requirements and in the quantities as stated herein.

#### 2.1 Option to Purchase Contractor Recommended Replacement Parts

- a) The Contractor hereby grants to Canada and Canada shall retain an irrevocable option exercisable at any time during the Contract to procure any or all of the replacement parts described in the supplier's proposal.
- b) The Contractor shall be given a minimum of "30" working days' notice in writing by the Contracting Authority indicating that Canada intends to exercise the option.
- c) The option may only be exercised by the Contracting Authority, and the exercise of the option will be evidenced through a formal Contract Amendment.
- d) Price support may be requested.

#### 2.2 SACC Manual Clauses

SACC Reference	Section	Date
B1501C	Electrical Equipment	2018-06-21
B7500C	Excess Goods	2006-06-16

### 3. Standard Clauses and Conditions

All clauses and conditions identified in the Contract by number, date and title are set out in the *Standard Acquisition Clauses and Conditions Manual*(<https://buyandsell.gc.ca/policy-and-guidelines/standard-acquisition-clauses-and-conditions-manual>) issued by Public Works and Government Services Canada.

#### 3.1 General Conditions

2010A (2018-06-21), General Conditions - Goods (Medium Complexity), apply to and form part of the Contract.



#### 4. Term of Contract

##### 4.1 Delivery Date

All the deliverables must be received on or before \_\_\_\_\_ (Delivery as offered and as accepted will be inserted at contract award).

#### 5. Authorities

##### 5.1 Contracting Authority

The Contracting Authority for the Contract is:

**Carlos Lee**

Public Service and Procurement Canada

Acquisitions Branch

Logistics, Electrical, Fuel and Transportation Directorate

"HN" Division

L'Esplanade Laurier (LEL)

140 O'Connor street, East Tower, 4<sup>th</sup> floor

Ottawa, ON, K1A 0S5

Telephone: (613) 296-6475

E-mail address: Carlos.lee@pwgsc-tpsgc.gc.ca

The Contracting Authority is responsible for the management of the Contract and any changes to the Contract must be authorized in writing by the Contracting Authority. The Contractor must not perform work in excess of or outside the scope of the Contract based on verbal or written requests or instructions from anybody other than the Contracting Authority.

##### 5.2 Contractor's Representative

Name and telephone number of the person responsible for:

##### General Enquiries

Name: will be inserted at contract

Telephone: will be inserted at contract

Facsimile: will be inserted at contract

E-mail: will be inserted at contract

##### Delivery Follow-up

Name: will be inserted at contract

Telephone: will be inserted at contract

Facsimile: will be inserted at contract

E-mail: will be inserted at contract



## **6. Payment**

### **6.1 Basis of Payment**

In consideration of the Contractor satisfactorily completing all of its obligations under the Contract, the Contractor will be paid a firm unit prices, as specified in the contract. Customs duties are included and Applicable Taxes are extra.

Canada will not pay the Contractor for any design changes, modifications or interpretations of the Work, unless they have been approved, in writing, by the Contracting Authority before their incorporation into the Work.

### **6.2 Limitation of Price**

SACC Manual clause C6000C (2017-08-17) Limitation of Price

### **6.3 Multiple Payments**

SACC Manual clause H1001C (2008-05-12) Multiple Payments

### **6.4 SACC Manual Clauses**

<b>SACC Reference</b>	<b>Section</b>	<b>Date</b>
G1005C	Insurance	2016-01-28

## **7. Invoicing Instructions**

- (a) One (1) copy must be forwarded to the consignee.
- (b) The original and one (1) copy must be forwarded to the following address for certification and payment.  
  
Canadian Heritage  
Email: [pch.dgr-semc-rmd-smec.pch@canada.ca](mailto:pch.dgr-semc-rmd-smec.pch@canada.ca)
- (c) One (1) copy must be forwarded to the Contracting Authority identified under the section entitled "Authorities" of the Contract.  
Department of Public Works and Government Services  
"HN" Division  
L'Esplanade Laurier (LEL)  
140 O'Connor street, East Tower, 4<sup>th</sup> Floor  
Ottawa, ON, K1A 0S5  
  
Telephone: (613) 296-6475  
E-mail address: [Carlos.lee@pwgsc-tpsgc.gc.ca](mailto:Carlos.lee@pwgsc-tpsgc.gc.ca)



## 8. Certifications

### 8.1 Compliance

Compliance with the certifications and related documentation provided by the Contractor in its bid is a condition of the Contract and subject to verification by Canada during the term of the Contract. If the Contractor does not comply with any certification, provide the related documentation or if it is determined that any certification made by the Contractor in its bid is untrue, whether made knowingly or unknowingly, Canada has the right, pursuant to the default provision of the Contract, to terminate the Contract for default.

## 9. Applicable Laws

The Contract must be interpreted and governed, and the relations between the parties determined, by the laws in force in Ontario.

## 10. Priority of Documents

If there is a discrepancy between the wording of any documents that appear on the list, the wording of the document that first appears on the list has priority over the wording of any document that subsequently appears on the list.

- (a) the Articles of Agreement;
- (b) 2010A (2018-06-21) General Conditions – Goods (Medium Complexity);
- (c) Requirement;
- (d) Annex A – Statement of Requirement
- (e) Annex B – Replacement Parts
- (f) the Contractor's bid dated \_\_\_\_\_

## 11. SACC Manual Clauses (Delivery)

SACC Reference	Section	Date
D2000C	Marking	2007-11-30
D2001C	Labelling	2007-11-30
D6010C	Palletization	2007-11-30
D9002C	Incomplete Assemblies	2007-11-30

### 11.1 Shipping Instructions - Delivery at Destination

Goods must be consigned to the destination specified in the Contract and delivered:

Delivered Duty Paid (DDP) (Gatineau, QC) Incoterms 2000 for shipments from a commercial contractor.



# Annex A - Statement of Requirements

## Purchase of Enclosures for CLAY PAKY Lighting fixtures

---

### 1. Title

Purchase of Lighting Enclosures for Clay Paky Lighting Fixtures

### 2. Background

#### 2.1. Objective

To Purchase 16 Lighting Enclosures that will provide at minimum IP54 protection from the elements for the entire Clay Paky lighting fixture model inventory owned by Canadian Heritage, (PCH) Capital Celebrations and Program Operations Directorate (CCPOD)

#### 2.2. Context

CCPOD participate in and produce events within the National Capital Region (NCR). These events range from a 3 weekend Winter festival, Sound and Light shows that run in the summer and Winter, Canada Day celebrations within the NCR and other timely events, productions and other happenings as directed by the Government of Canada.

These lighting enclosures are being purchased by PCH for use with our entire Clay Paky Inventory.

PCH owns the following models of Clay Paky fixtures:

Aleda B-Eye K20  
SuperSharpy  
Sharpy Wash  
Alpha 800 QWO

The lighting enclosure must be able to accommodate all these models. PCH will make use of the enclosures at different times of the year and for different events and as such, it must be able to accommodate all models within the PCH roster.

These Clay Paky Fixtures have a remaining 10-year life expectancy and the enclosure must contribute to keeping that life expectancy by providing the necessary airflow, humidity control and protection from the elements.

The enclosures are deployed in a variety of terrain, exterior conditions and temperatures. They will also be used in a variety of orientations, be they hung from a truss upside down, hung sideways or used on the ground. The enclosures are deployed for months at a time and must be able to withstand the elements.

---

## 2.3. Terminology

PCH:	Canadian Heritage
NCR:	National Capital Region
CCPOD:	Capital Celebrations and Program Operations Directorate
PSPC:	Public Services and Procurement Canada
ESA:	Electrical Safety Authority (Ontario)

## 2.4. Reference Documents

See Annex A for fixture size specifications to ensure the enclosure proposed can fit all PCH Clay Paky fixtures.

## 3. Requirements, Scope, Task, Activities and Deliveries

### 3.1 Requirements:

- I. Enclosure for Clay Paky Lighting fixtures, with 200-240v 50/60Hz Power input,
    - a. Plug to be NEMA L6-15P, cable must be of an adequate gauge for the voltage.
    - b. Mounting points and connections must be able to accept all fixtures in 2.2 either through a plate, bracket or other mechanical connection means. These plates and brackets cannot impede in any way the functions of the fixtures or of the enclosure.
    - c. Mounting height within the enclosure must ensure that the beam of light can get through unimpeded through the entire range of motion of the fixture.
    - d. Must come with a safety cable attachment point capable of supporting the weight of the enclosure and the fixture
    - e. Must come with industry standard attachment hole sizes to attach industry standard clamps for rigging to trusses or pipes. The frame and structure of the enclosure must be made of metal.
  - II. Temperature regulated to maintain optimum operating temperatures for all Clay Paky fixtures outlined in 2.2
  - III. Humidity regulated to maintain optimum operating humidity for all Clay Paky fixtures outlined in 2.2
    - a. Must have an anti-condensation system to protect the electronics from condensation.
  - IV. Minimum of IP 54 ingress protection
  - V. Entire chassis must be grounded
  - VI. Enclosure must abide by all legislated and mandated regulations for use in Ontario. Delivered with the proper tags and certifications for use in Ontario.
  - VII. Replacement parts must be available from the winning proponent or agent specified by the winning proponent. Please indicate in Annex B
  - VIII. A minimum of two (2) year warranty service must be available from the winning proponent or agent specified by the winning proponent.
  - IX. The electrical feed to the enclosure heater (s) must be protected with a fuse(s)
  - X. Must have a 5 PIN XLR DMX input.
    - a. All cables and DMX connector must abide by USITT standards for DMX512
  - XI. Must have a 5 PIN XLR DMX output.
    - a. All cables and DMX connector must abide by USITT standards for DMX512
  - XII. Removable dome and base must be lockable to secure the fixture inside the dome.
    - a. Dome must be UV resistant solid transparent material.
    - b. Dome must be able to withstand impacts
-

- c. Dome must sit sealed and clamped to ensure ingress protection of liquids
  - d. Fixture must be mountable by removing the dome or dome and dome support frame
- XIII. Electrical connection to the enclosure can be either by cable fitted through a weather tight gland for the input and the output or with Neutrik PowerCON True1 chassis mount connectors.
  - a. Internal power connector must be Neutrik Powercon or equivalent connector that will plug into a Clay Paky Aleda B-Eye K20. Rated for the input power. PCH will provide Powercon adaptors for all other fixtures if required.
- XIV. Must have handles for transportation, handles positioned at the base of the enclosure to ensure no interference with the light beam.
- XV. Must have adjustable feet to be level on uneven surfaces.
- XVI. Weight, below 40 KG
- XVII. Operational temperatures between -20°C and +40°C
- XVIII. Over all height below 40". This is to minimize the visible portion of the light when installed for the Sound and Light show. The approvals for equipment deployment require that the equipment be as invisible as possible during non-show hours.
- XIX. Ventilation system must work with the airflow of the fixture, offering air intake and exhaust relative to the air intake and exhaust of the Clay Paky fixture.
- XX. Dome must not cause any optically visible changes to the gobo images going through it.

Standards: The enclosure must come with approved certification mark(s) for use in Ontario. If the enclosure does not come from the factory with an approved certification mark it must be field inspected, modifications done if required, approved for use in Ontario and certified with an Ontario approved certification mark. All costs for these modifications and certifications, if required, are to be included in the offerer's price.

The contractor shall provide all post-sales support as pertains to guarantee work.  
The contractor shall be an authorized distributor for the proposed enclosure make and model.

### 3.2. Resources Required

Sales Representative: Provide liaison with PCH Contract Authority on all matter relating to this contract.

Delivery Services: for shipping, from manufacturer/dealer, to PCH Warehouse

Staff and Space for product inspection

Contractor(s) for inspection, possible modifications, and final approval with certification mark recognized in Ontario by the ESA.

Shipping and handling.

Items are to arrive at the PCH warehouse with all approvals and certifications for use in Ontario. No work to render the equipment compliant will take place at the PCH warehouse.

### 3.3. Travel Requirements

None required

---

### 3.4. Language of Work

French or English, all certification documents can be provided in English only if not available in French.

### 3.5. Interdependencies

The timely delivery of this equipment is important as the equipment is to be installed the following week. Any potential or risk to the delivery timeline must be flagged in a timely manner to ensure that PCH can abide by its schedule and to be able to action its mitigation plan for late arrival of the equipment.

## 4. Support provided by PCH

- Provide a contract authority that can answer all questions
- Provide access to a loading dock, and or forklift for unloading
- Within 2 weeks of receiving PCH will unbox and test all units. Should issues with the product be identified within these two weeks PCH will advise the contractor so that corrective action can be taken. PCH may not be in a position to test all units as they arrive.

## Annex A

### Aleda B Eye K20

Primary fixture used in the enclosure for the Sound and Light show

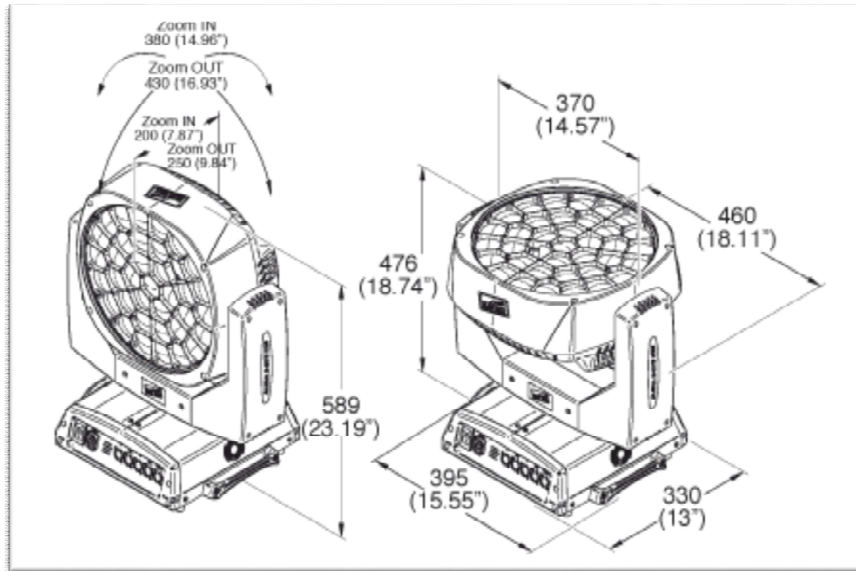

### Supersharp

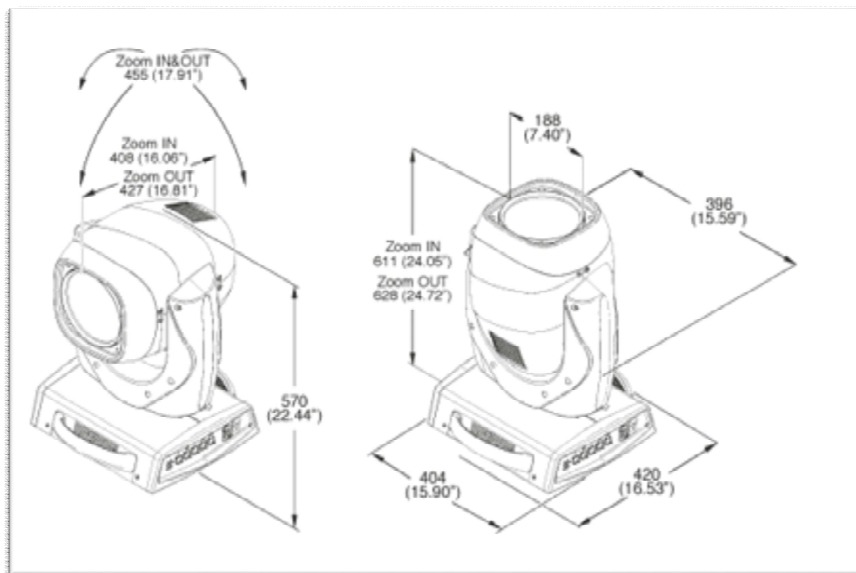

## Annex A

### Sharpay Wash 330

Note the top hat in and out dimensions

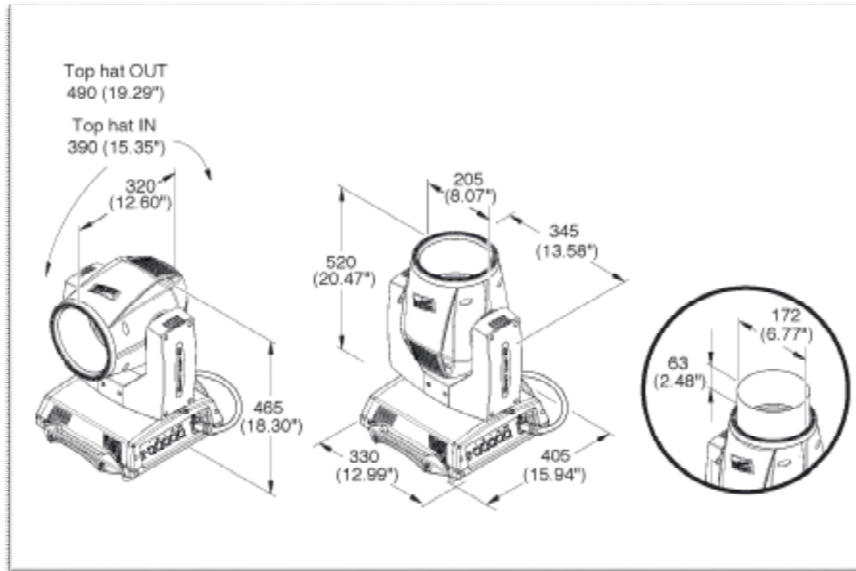

### Alpha 800 QWO

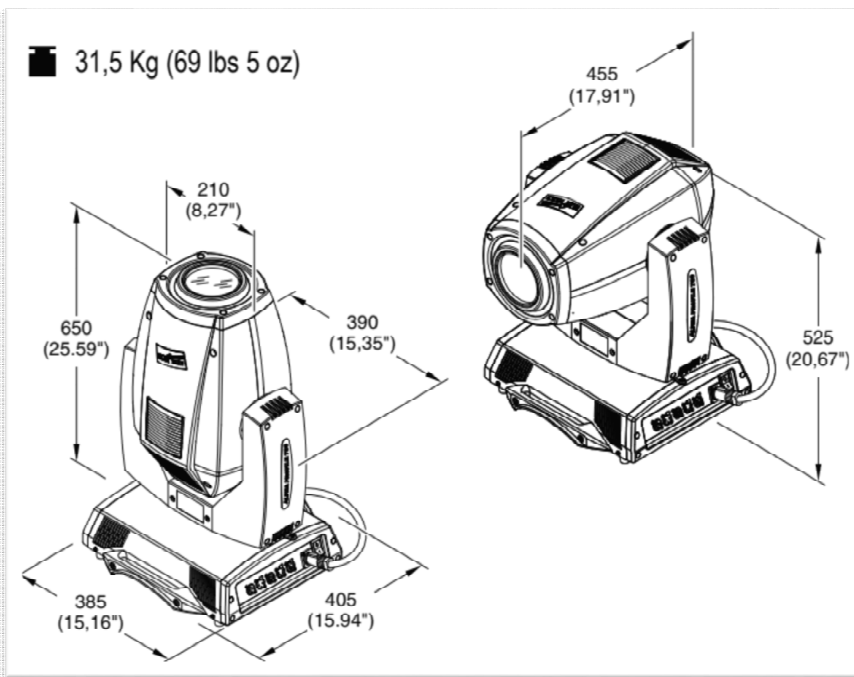

### **Annex B - REPLACEMENT PARTS**

Bidder is requested to recommend replacement parts required. The firm unit price for each recommended replacement part is to be identified below.

<b>Part Number</b>	<b>Part Description</b>	<b>Quantity</b>	<b>Unit Price</b>	<b>Total Price</b>

**\*Unit pricing for the replacement parts will not form part of the evaluation**



## Annex C- Evaluation criteria

	<b>Mandatory Technical Criteria Reference , see section 3.1 of the Statement of work for full description</b>	<b>Bid information location. Page, section</b>	<b>MET / NOT MET</b>
MT1	I a. Plug to be NEMA L6-15P, cable must be of an adequate gauge for the voltage.		
MT2	I b. Mounting points and connections must be able to accept all fixtures in 2.2 either through a plate, bracket or other mechanical connection means. These plates and brackets cannot impede in any way the functions of the fixtures or of the enclosure.		
MT3	I c. Mounting height within the enclosure must ensure that the beam of light can get through unimpeded through the entire range of motion of the fixture.		
MT4	I d. Must come with a safety cable attachment point capable of supporting the weight of the enclosure and the fixture		
MT5	I e. Must come with industry standard attachment hole sizes to attach industry standard clamps for rigging to trusses or pipes. The frame and structure of the enclosure must be made of metal.		
MT6	II. Temperature regulated to maintain optimum operating temperatures for all Clay Paky fixtures outlined in 2.2		
MT7	III. a Must have an anti-condensation system to protect the electronics from condensation.		
MT8	IV. Minimum of IP 54 ingress protection		
MT9	V. Entire chassis must be grounded		
MT10	VI. Enclosure must abide by all legislated and mandated regulations for use in Ontario. Delivered with the proper tags and certifications for use in Ontario.		
MT11	VII. Replacement parts must be available from the winning proponent or agent specified by the winning proponent.		

MT12	VIII. A minimum of two (2) year warranty service must be available from the winning proponent or agent specified by the winning proponent.		
MT13	IX. The electrical feed to the enclosure heater (s) must be protected with a fuse(s)		
MT14	X. a. All cables and 5 pin DMX input connector must abide by USITT standards for DMX512		
MT15	XI. a. All cables and DMX connector must abide by USITT standards for DMX512		
MT16	XII a. Dome must be UV resistant solid transparent material.		
MT17	XII b. Dome must be able to withstand impacts		
MT18	XII c. Dome must sit sealed and clamped to ensure ingress protection of liquids		
MT19	XII d. Fixture must be mountable by removing the dome or dome and dome support frame		
MT20	XIII. Electrical connection to the enclosure can be either by cable fitted through a weather tight gland for the input and the output or with Neutrik PowerCON True1 chassis mount connectors. a. Internal power connector must be Neutrik Powercon or equivalent connector that will plug into a Clay Paky Aleda B-Eye K20. Rated for the input power. PCH will provide Powercon adaptors for all other fixtures if required.		
MT21	XIV. Must have handles for transportation, handles positioned at the base of the enclosure to ensure no interference with the light beam.		
MT22	XV. Must have adjustable feet to be level on uneven surfaces.		
MT23	XVI. Weight, below 40 KG		
MT24	XVII. Operational temperatures between -20°C and +40°C		
MT25	XVIII. Over all height below 40". This is to minimize the visible portion of the light when installed for the Sound and Light show. The approvals for equipment deployment require that the equipment be as invisible as possible during non-show hours.		
MT26	XIX. Ventilation system must work with the airflow of the fixture, offering air intake and exhaust		

	relative to the air intake and exhaust of the Clay Paky fixture.		
MT27	XX. Dome must not cause any optically visible changes to the gobo images going through it.		