

Vendor / Sous-traitant

CCG Property and tower location
based on Deed for the property dated
May 6, 1915

Bearing to rear tower: S17°30'E

DWG NO - NO DES

C

B

A

SANDWICH STREET

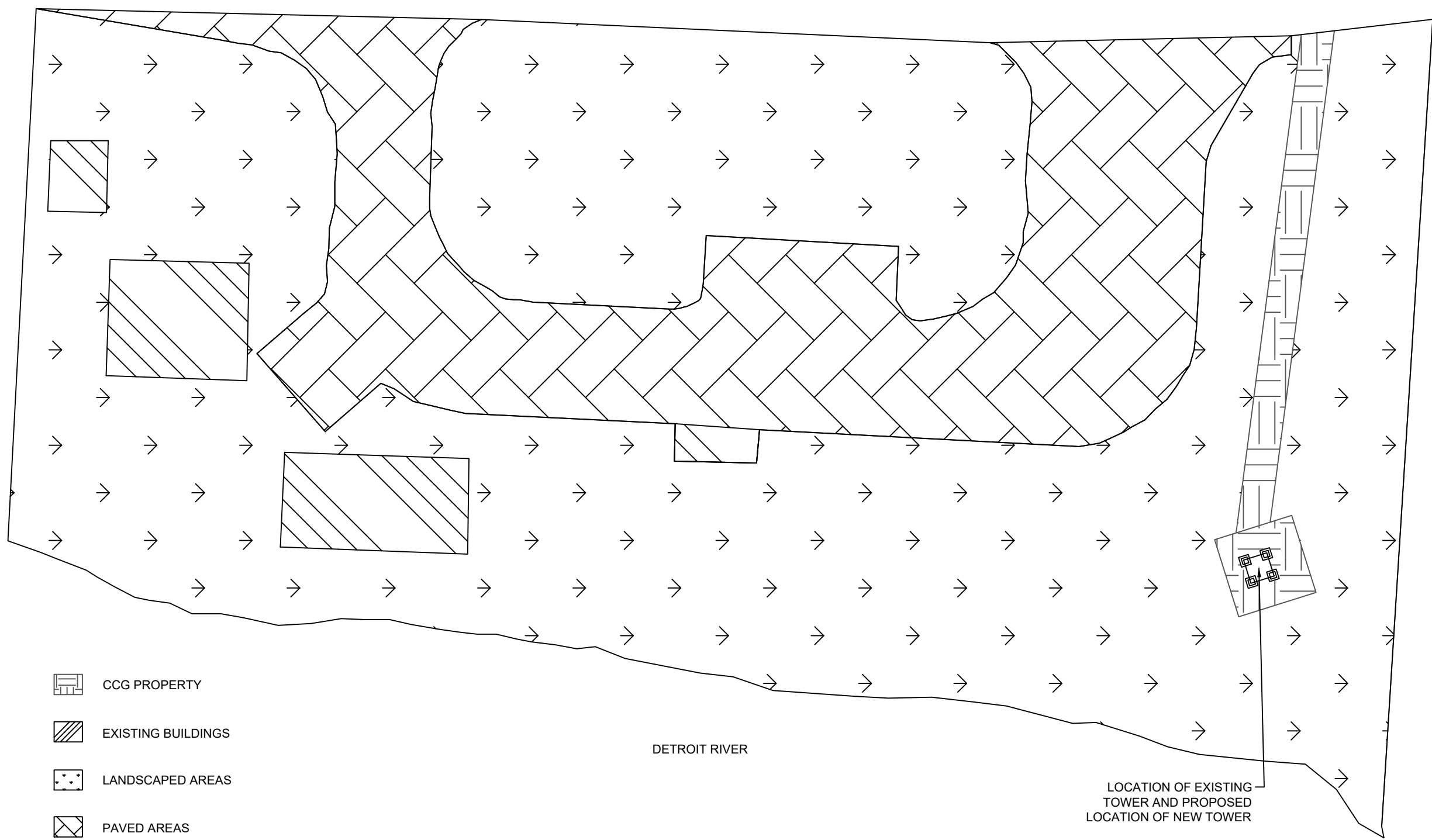

-  CCG PROPERTY
-  EXISTING BUILDINGS
-  LANDSCAPED AREAS
-  PAVED AREAS

DETROIT RIVER

LOCATION OF EXISTING
TOWER AND PROPOSED
LOCATION OF NEW TOWER

0	DESCRIPTION	BY	yyyy-mm-dd
rev	description	by	date

Asset - Actif
LL667
FORT MALDEN RANGE FRONT

Drawing - Dessin
SITE PLAN

designed - conception _____ date

drawn - dessiné
LL _____ date
2020-01-29

checked - vérifié _____ date

approved - approuvé _____ date

BY _____ date
2020-01-29

CCG ref. no. - no. réf. GCC
EWTM 8010-0667000
scale - échelle
SCALE

drawing no. - no. dessin
DWG NO - NO DES
sheet-feuille
01/01
rev
0

File / Fichier: FORT MALDEN SITE PLAN.DWG - Printed / Imprimé: 2020/02/03 9:18

ANSI B

DWG NO - NO DES

4

3

2

5

6

7

8

2

1

Vendor / Sous-traitant
CCG Property and tower location based on Deed for the property dated May 6, 1915
Bearing to front tower: N17°30'W

DWG NO - NO DES



C

B

A

DWG NO - NO DES

DETROIT RIVER

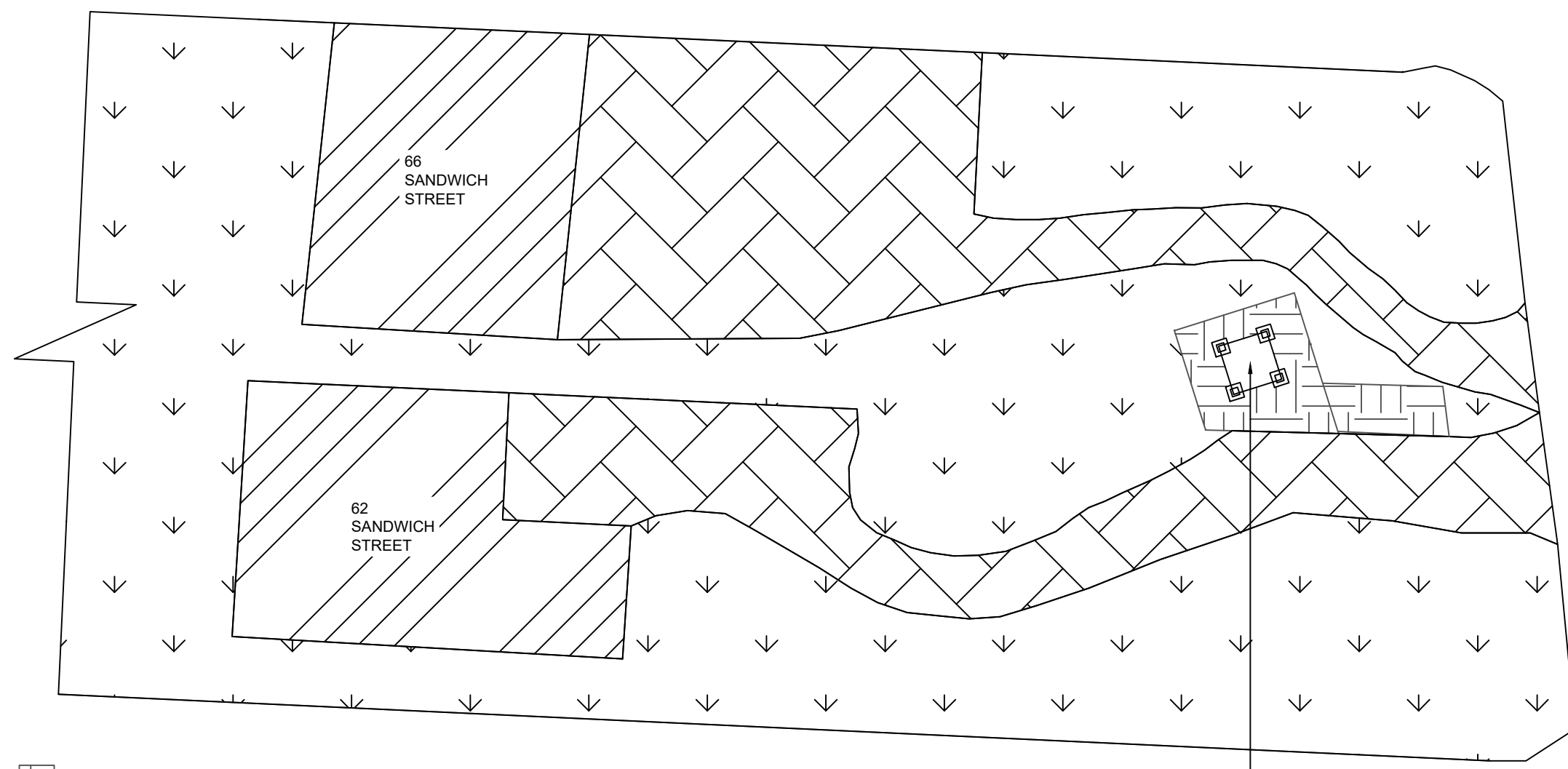

SANDWICH STREET

-  CCG PROPERTY
-  EXISTING BUILDINGS
-  LANDSCAPED AREAS
-  PAVED AREAS

EXISTING TOWER AND PROPOSED LOCATION OF NEW TOWER

0	DESCRIPTION	BY	yyyy-mm-dd
rev	description	by	date
Asset - Actif			
LL668		FORT MALDEN RANGE REAR	
Drawing - Dessin			
SITE PLAN			
designed - conception		date	
drawn - dessiné		date	
LL		2020-01-29	
checked - vérifié		date	
approved - approuvé		date	
BY		2020-01-29	
CCG ref. no. - no. réf. GCC		scale - échelle	
EWTM 8010-0668000		SCALE	
drawing no. - no. dessin		sheet-feuille	rev
DWG NO - NO DES		01/01	0

File / Fichier: FORT MALDEN SITE PLAN.DWG - Printed / Imprimé: 2020/02/03 9:19

ANSI B