



FISHERIES AND OCEANS
CANADA

SMALL CRAFT HARBOURS



ARMOUR STONE PROTECTION
ANCHOR POINT
NEWFOUNDLAND AND LABRADOR

PROJECT No. 723250
ISSUED FOR TENDER

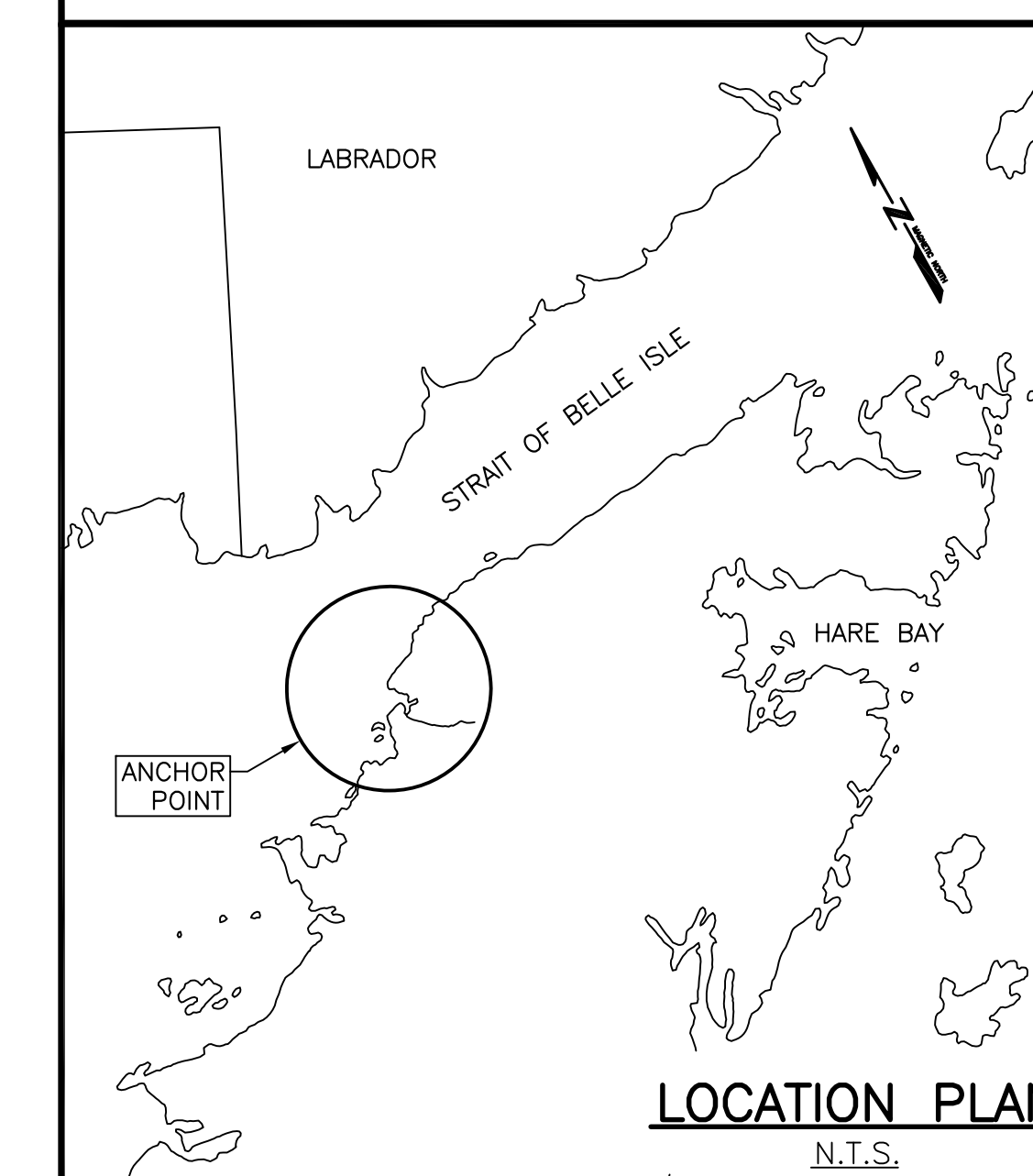
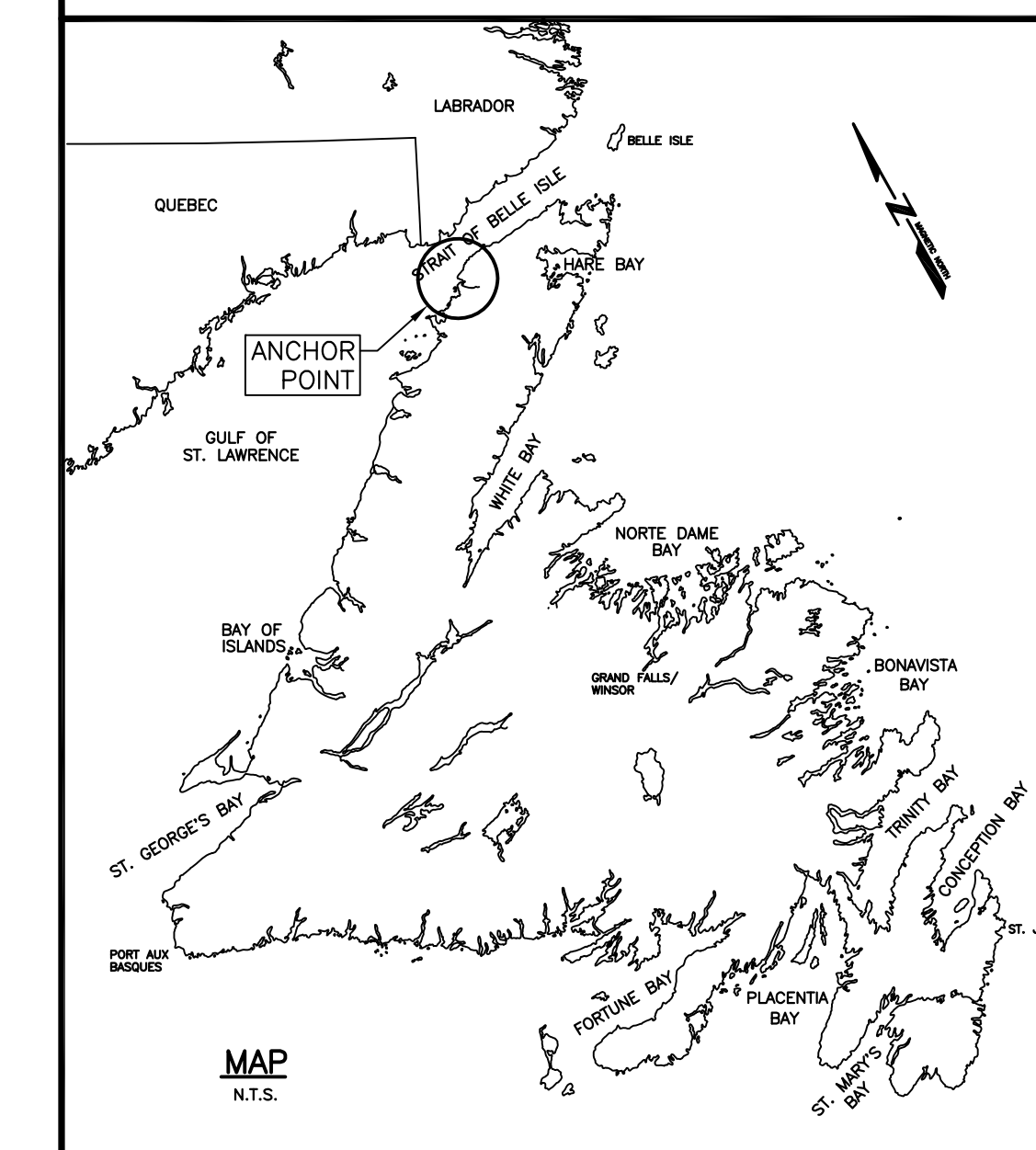

LIST OF DRAWINGS:

C1 OF 3	SOUNDING AND TOPOGRAPHIC SURVEY
C2 OF 3	NEW SITE PLAN
C3 OF 3	SECTIONS

SURVEY NOTES

SURVEY PARTY CHIEF RICHARD HEALEY
SURVEY VESSEL ALUMINUM BOAT
SURVEY DATE(S) OCTOBER 23, 2016
SOUNDER TYPE SINGLE TRANSDUCER
SOUNDER SETTING MIN/INST VEL OF SOUND 1500 m/s
DEPTH GATE USED N/A FREQ OF TRANS. 200 kHz
POSITIONING SYSTEM USED TRIMBLE R7 GNSS DGPS
LAND SURVEY POSITION BY TRIMBLE R7 GNSS DGPS
DATA TAPE/DISC(S) USED
CAD DRAWING FILE(S):

TIDAL REDUCTION SCHEME
OFFICE PROCESSOR EDDIE BEARNS
DATE OF PROCESSING NOVEMBER 2016

MODE OF PLOTTING LEAST OF MINIMUM DEPTHS
MATRIX CELL WIDTH X LENGTH
REDUCTION OF MATRIX CELLS

CONTROL POINTS:

PL NAME	EASTING	NORTHING	CD ELEV	DESCRIPTION
43009	514372.758	5676694.095		GEODETIC I.P. SET IN CONC. BLOCK
PWC 1-09	514187.502	5675873.892	+2.842 m	BOLT SET IN CONCRETE DECK
PWC 2-09	514152.453	5675845.757	+2.822 m	BOLT SET IN CONCRETE DECK
BM 2-87	514107.891	5675760.900	+2.148 m	I.P. CEMENTED IN BEDROCK
PWC 1-2007	514189.95	5675870.93	+3.40 m	BOLT SET IN CONCRETE SLAB
PWC 2-2007	514126.38	5675813.86	+3.12 m	BOLT SET IN CONCRETE WALL

ALL SOUNDINGS & ELEVATIONS IN METRES.

ALL SOUNDINGS & ELEVATIONS REFERRED TO BM 2-87 ELEV. +2.148 m (I.P. SET IN BEDROCK) ESTABLISHED BY WATER LEVEL TRANSFER CHS BM 7760033 ELEV.+4.066 m LOCATED AT ST.BARBE, Nfld. ON JULY 5-9, 1987 BY PWC SURVEY CREW.

SOUNDINGS TAKEN USING NAVISOUND 210 ECHO SOUNDER AND POSITIONED BY TRIMBLE DIFFERENTIAL GPS POSITIONING SYSTEM ON OCTOBER 23, 2016 BY PWC SURVEY CREW.

COORDINATES FOR HORIZONTAL CONTROL ARE GIVEN ON THE U.T.M. MAPPING PLANE, ZONE 21, USING THE NORTH AMERICAN DATUM OF 1983(NAD83).

SOUNDINGS WERE REDUCED BY DIGITRACE & RE-CHECKED FROM SOUNDING CHARTS BEFORE BEING CORRECTED FOR TIDE & BAR CHECK CORRECTION.

SOUNDINGS WERE REDUCED USING HYPACK MAX VER. 2013A*.

ALL FIELD NOTES ARE IN ANCHOR POINT #53.

LEGEND

- SYMBOLS**
- ANCHOR CULTURE
 - ANCHOR BLOCK
 - BOLLARD
 - BOREHOLE
 - BOUNDARY MARKER
 - CARD POSITION BUOY
 - CATCH BASIN
 - CLEAT
 - CULVERT
 - DERRICK
 - DREDGE CONTROL
 - ELECTRICAL OUTLET
 - FIRE HYDRANT
 - FIRST AID
 - FISH HANDLING EQUIP.
 - FOG HORN
 - FUEL PUMP
 - H PILE
 - HORIZONTAL CONTROL
 - ICE PLANT
 - INVERT PIPE
 - JIB CRANE
 - LADDER
 - LIFE RING
 - LIGHT STANDARD
 - MANHOLE
 - MARSH
 - MAST/TOWER
 - NAVIGATION LIGHT
 - OBSERVED BUOY
 - OBSERVED SPAR BUOY
 - PIPE PILE
 - RANGE LIGHT
 - SAFETY POST
 - SEWER OUTFLOW PIPE
 - SEW
 - TELEPHONE
 - TELEPHONE POLE
 - TIDE GAUGE/STAFF
 - TREE
 - UTILITY POLE
 - VERTICAL CONTROL
 - WATER TAP/OUTLET
 - WATER VALVE
 - WATER WELL
 - WOOD PILE
- LINE TYPE**
- ARMOUR STONE
 - CL. PAVEMENT
 - DRAIN PIPE
 - EDGE ROAD / SHOULDER
 - FENCE LINE
 - FLOATING WATERBANK
 - GUARD RAIL
 - HIGH WATER MARK
 - LOW WATER MARK
 - MARSH OUTLINE
 - PROPERTY BOUNDARY
 - RANGE LIGHT EXTENSION
 - RETAINING WALL
 - PARKING
 - TIDE OF BANK
 - TREE LINE
 - UNDERGROUND CABLE

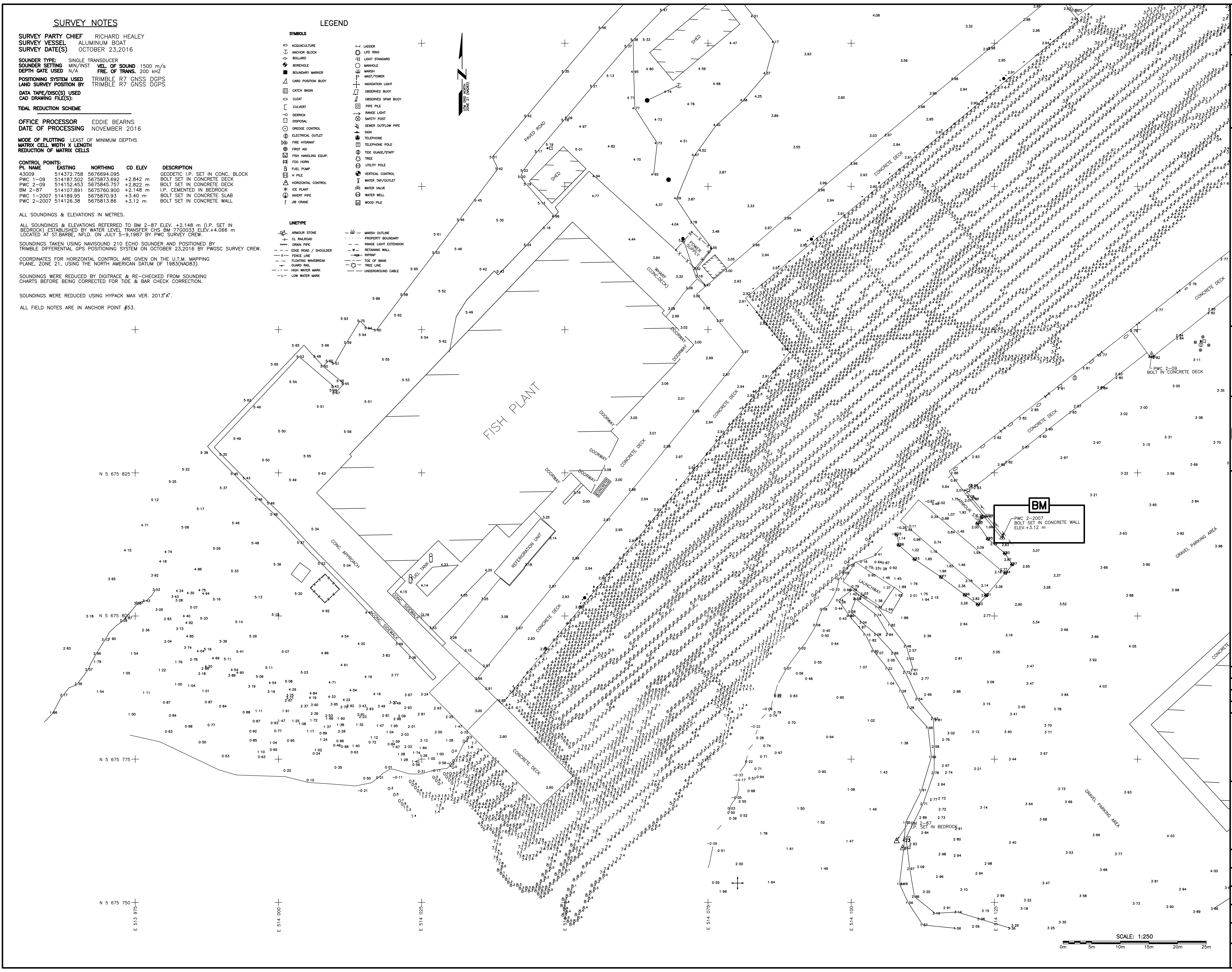
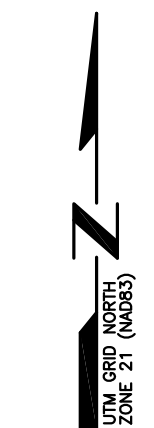

SMALL CRAFT HARBOURS



- NOTES:**
- ALL ELEVATIONS ARE IN METRES UNLESS OTHERWISE NOTED.
 - ALL DIMENSIONS ARE IN MILLIMETRES UNLESS OTHERWISE NOTED.

PROVINCE OF NEWFOUNDLAND
 PERMIT HOLDER
 This Permit Allows
 APN ENGINEERING INC.
 To practice Professional Engineering in Newfoundland and Labrador. Permit No. as issued by APENL E0282 which is valid for the year 2020.

REGISTERED PROFESSIONAL ENGINEER
 NEIL C. HUNT
 SIGNATURE 5/4/20
 DATE
 NEWFOUNDLAND & LABRADOR

C	RE-ISSUED FOR TENDER	5/4/20
B	ISSUED FOR TENDER	4/22/20
A	ISSUED FOR REVIEW	4/1/20
revisions		date

ARMOUR STONE PROTECTION
ANCHOR POINT, NL
 drawing desin
SOUNDING AND TOPOGRAPHIC SURVEY

designed N.H.	concu
date MAY 4, 2020	
drawn P.H.	desine
date MAY 4, 2020	
approved	approve

Tender Paul Curran
 DFO Project Manager
 project number 723250
 no. du projet

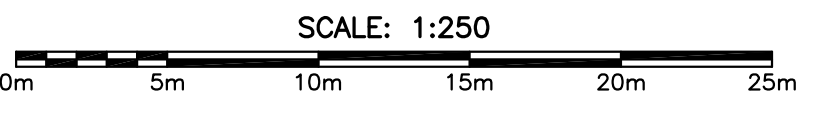

SURVEY NOTES

SURVEY PARTY CHIEF RICHARD HEALEY
SURVEY VESSEL ALUMINUM BOAT
SURVEY DATE(S) OCTOBER 23, 2016
SOUNDER TYPE SINGLE TRANSDUCER
SOUNDER SETTING MIN/INST VEL OF SOUND 1500 m/s
DEPTH GATE USED N/A FREQ OF TRANS. 200 kHz
POSITIONING SYSTEM USED TRIMBLE R7 GNSS DGPS
LAND SURVEY POSITION BY TRIMBLE R7 GNSS DGPS
DATA TAPE/DISC(S) USED
CAD DRAWING FILE(S):

TIDAL REDUCTION SCHEME
OFFICE PROCESSOR EDDIE BEARNS
DATE OF PROCESSING NOVEMBER 2016

MODE OF PLOTTING LEAST OF MINIMUM DEPTHS
MATRIX CELL WIDTH X LENGTH
REDUCTION OF MATRIX CELLS

CONTROL POINTS:	PL. NAME	EASTING	NORTHING	CD ELEV	DESCRIPTION
43009	514372.758	5676694.095			GEODETIC I.P. SET IN CONC. BLOCK
PWC 1-09	514187.502	5675873.692	+2.842 m		BOLT SET IN CONCRETE DECK
PWC 2-09	514152.453	5675845.757	+2.822 m		BOLT SET IN CONCRETE DECK
BM 2-87	514107.891	5675760.900	+2.148 m		I.P. CEMENTED IN BEDROCK
PWC 1-2007	514189.95	5675870.93	+3.40 m		BOLT SET IN CONCRETE SLAB
PWC 2-2007	514126.38	5675813.86	+3.12 m		BOLT SET IN CONCRETE WALL

ALL SOUNDINGS & ELEVATIONS IN METRES.

ALL SOUNDINGS & ELEVATIONS REFERRED TO BM 2-87 ELEV. +2.148 m (I.P. SET IN BEDROCK) ESTABLISHED BY WATER LEVEL TRANSFER CHS BM 7760033 ELEV.+4.066 m LOCATED AT ST.BARBE, Nfld. ON JULY 5-9, 1987 BY PWC SURVEY CREW.

SOUNDINGS TAKEN USING NAVISOUND 210 ECHO SOUNDER AND POSITIONED BY TRIMBLE DIFFERENTIAL GPS POSITIONING SYSTEM ON OCTOBER 23, 2016 BY PWC SURVEY CREW.

COORDINATES FOR HORIZONTAL CONTROL ARE GIVEN ON THE U.T.M. MAPPING PLANE, ZONE 21, USING THE NORTH AMERICAN DATUM OF 1983(NAD83).

SOUNDINGS WERE REDUCED BY DIGITRACE & RE-CHECKED FROM SOUNDING CHARTS BEFORE BEING CORRECTED FOR TIDE & BAR CHECK CORRECTION.

SOUNDINGS WERE REDUCED USING HYPACK MAX VER. 2013*A.

ALL FIELD NOTES ARE IN ANCHOR POINT #53.

LEGEND

- SYMBOLS**
- ANCHOR BLOCK
 - BOLLARD
 - BORHOLE
 - BOUNDARY MARKER
 - CARD POSITION BUOY
 - CATCH BASIN
 - CLEAT
 - CULVERT
 - DERRICK
 - DISPOSAL
 - DREDGE CONTROL
 - ELECTRICAL OUTLET
 - FIRE HYDRANT
 - FIRE ALARM
 - FISH HANDLING EQUIP.
 - FOG HORN
 - FUEL PUMP
 - H. PILE
 - HORIZONTAL CONTROL
 - ICE PLANT
 - INVERT PIPE
 - JIB CRANE
 - LADDER
 - LIFE RING
 - LIGHT STANDARD
 - MANHOLE
 - MARSH
 - MAST/TOWER
 - NAVIGATION LIGHT
 - OBSERVED BUOY
 - OBSERVED SPAR BUOY
 - PIPE PILE
 - RANGE LIGHT
 - SAFETY POST
 - SEWER OUTFLOW PIPE
 - SON
 - TELEPHONE
 - TELEPHONE POLE
 - TIDE GAUGE/STAFF
 - TREE
 - UTILITY POLE
 - VERTICAL CONTROL
 - WATER TAP/OUTLET
 - WATER VALVE
 - WATER WELL
 - WOOD PILE
- LINE TYPE**
- ARMOUR STONE
 - CL. PAVEMENT
 - DRAIN PIPE
 - EDGE ROAD / SHOULDER
 - FENCE LINE
 - FLOATING WAVEREAK
 - GUARD RAIL
 - HIGH WATER MARK
 - LOW WATER MARK
 - MARSH OUTLINE
 - PROPERTY BOUNDARY
 - RANGE LIGHT EXTENSION
 - RETAINING WALL
 - ROAD PARKING
 - TIDE OF BANK
 - TREE LINE
 - UNDERGROUND CABLE

- LEGEND:**
- NEW ARMOUR STONE CREST
 - NEW ARMOUR STONE SIDE SLOPE

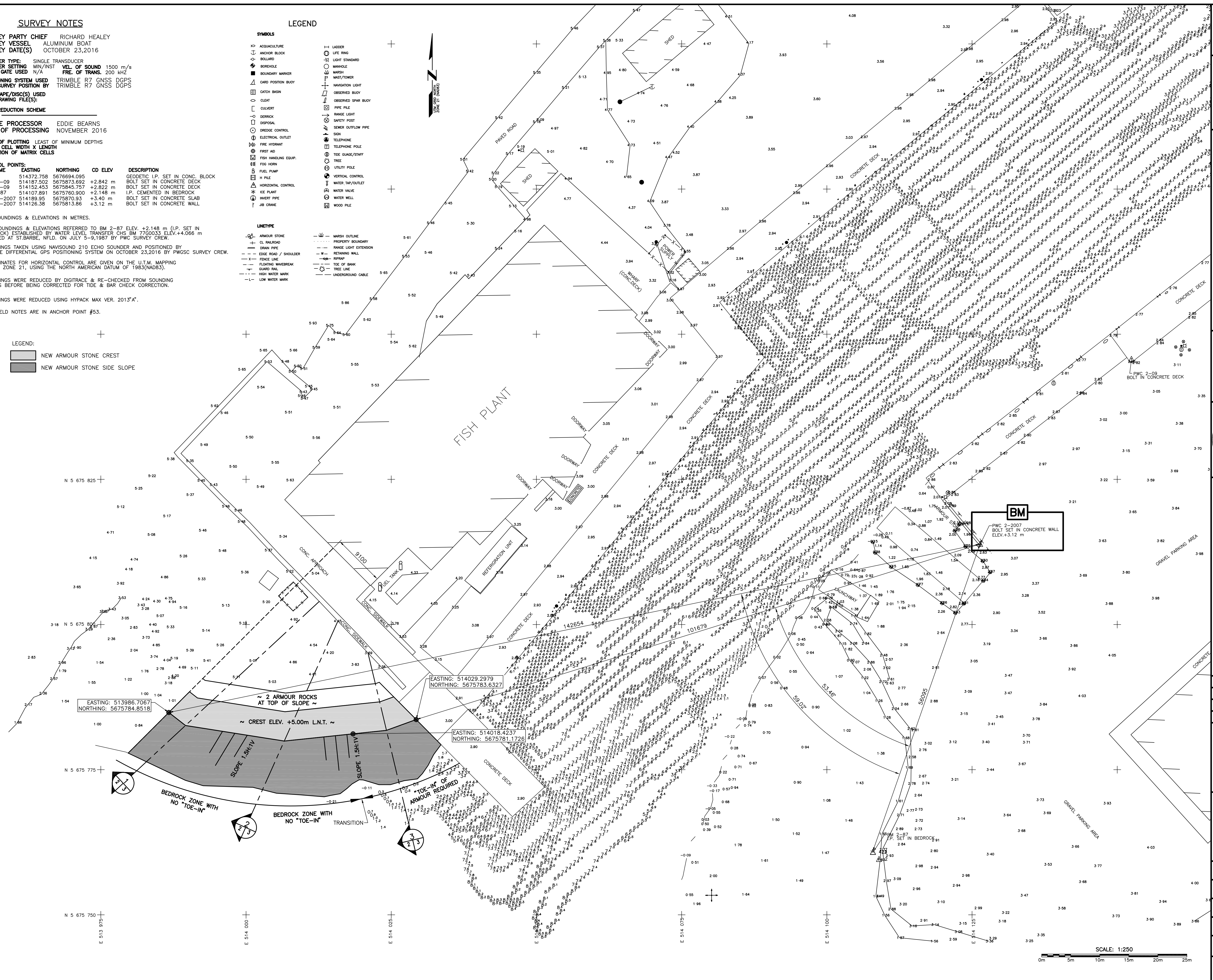

SMALL CRAFT HARBOURS



- NOTES:**
- ALL ELEVATIONS ARE IN METRES UNLESS OTHERWISE NOTED.
 - ALL DIMENSIONS ARE IN MILLIMETRES UNLESS OTHERWISE NOTED.

PROVINCE OF NEWFOUNDLAND
PERMIT HOLDER
 This Permit Allows
 APN ENGINEERING INC.
 To practice Professional Engineering in Newfoundland and Labrador. Permit No. as issued by APENL F0282 which is valid for the year 2020.

REGISTERED PROFESSIONAL ENGINEER
 NEIL C. HUNT
 SIGNATURE 5/4/20
 DATE
 NEWFOUNDLAND & LABRADOR

C	RE-ISSUED FOR TENDER	5/4/20
B	ISSUED FOR TENDER	4/22/20
A	ISSUED FOR REVIEW	4/1/20

ARMOUR STONE PROTECTION
ANCHOR POINT, NL
NEW SITE PLAN

designed	N.H.	concu
date	MAY 4, 2020	
drawn	P.H.	dessine
date	MAY 4, 2020	
approved		approve
Tender	Paul Curran	Submission
DFO Project Manager		
project number	723250	no. du projet
drawing no.	C2	no. du dessin

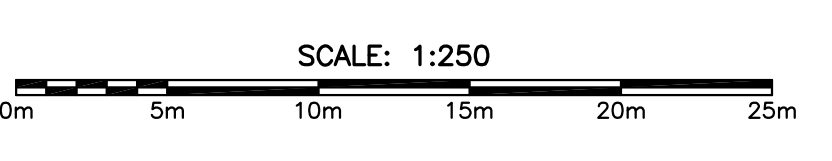

SMALL CRAFT HARBOURS



NOTES:
 1. ALL ELEVATIONS ARE IN METRES UNLESS OTHERWISE NOTED.
 2. ALL DIMENSIONS ARE IN MILLIMETRES UNLESS OTHERWISE NOTED.

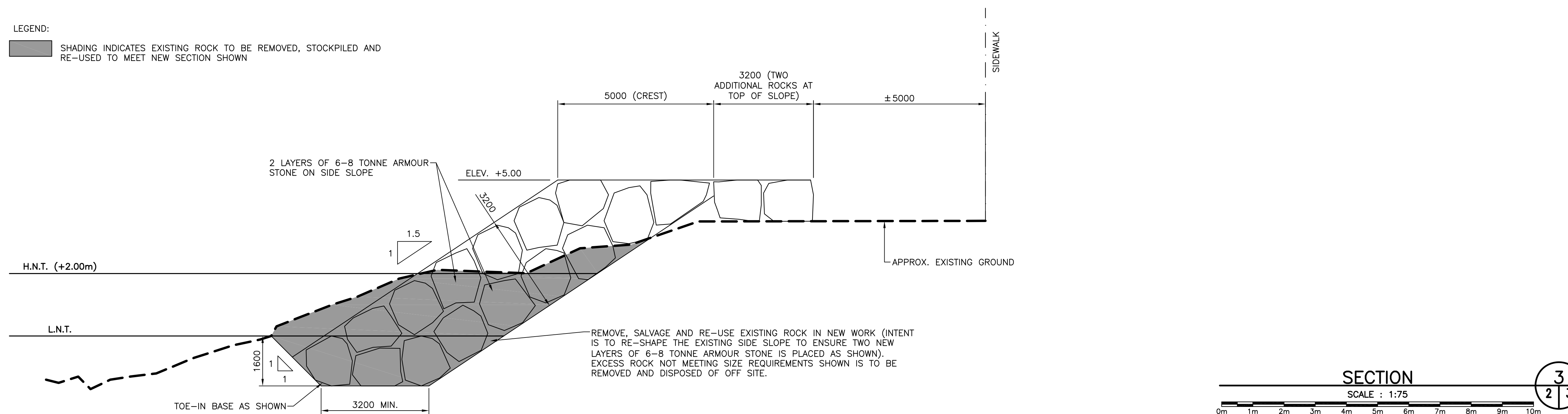
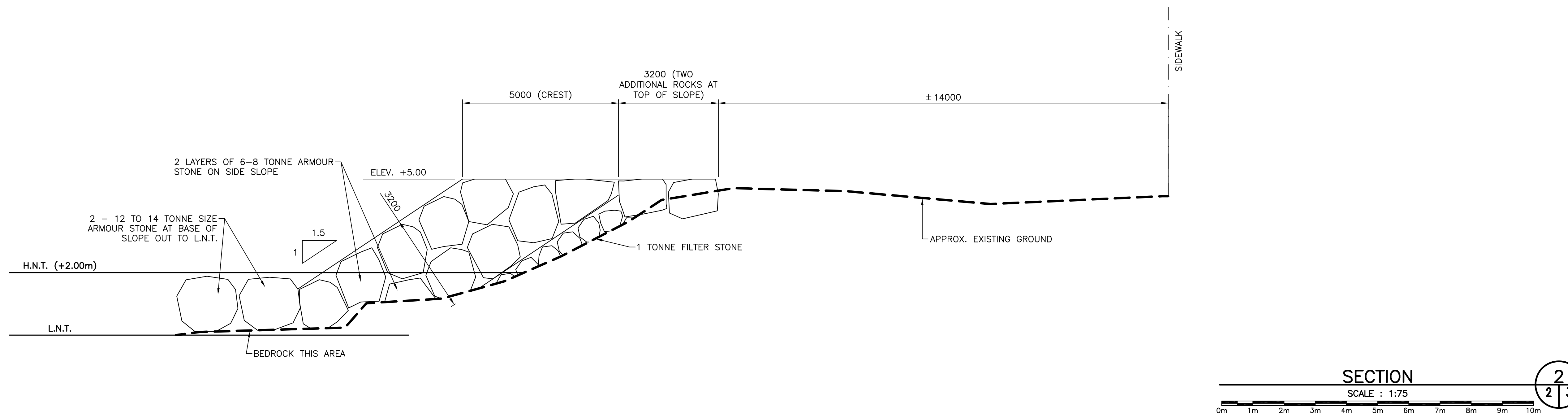
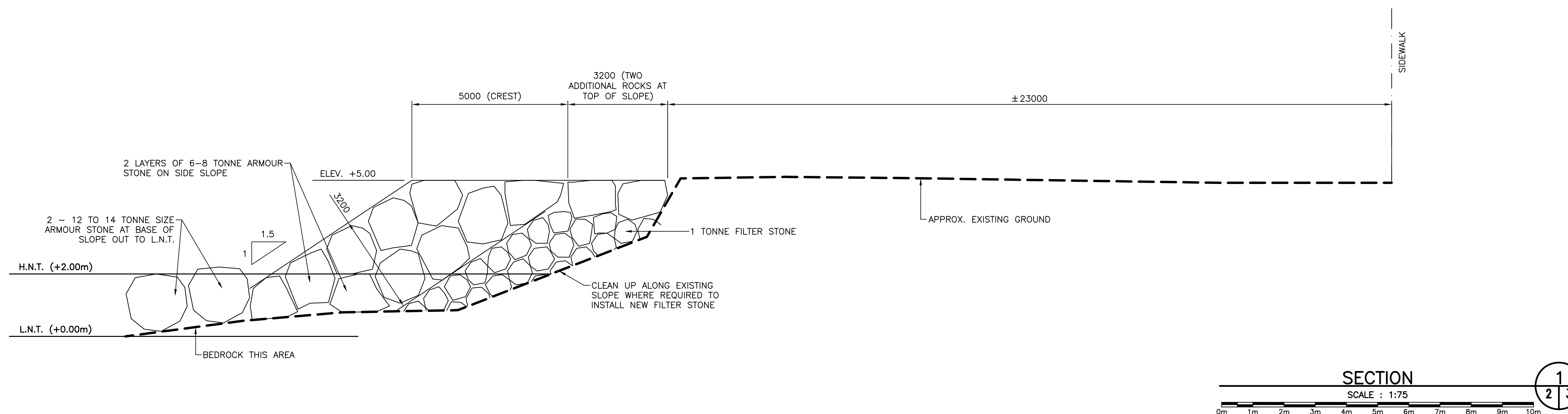

PROVINCE OF NEWFOUNDLAND
 PERMIT HOLDER
 This Permit Allows
 APN ENGINEERING INC.
 To practice Professional Engineering
 in Newfoundland and Labrador. *Neil C. Hunt*
 Permit No. as issued by APENL F0282
 which is valid for the year 2020.

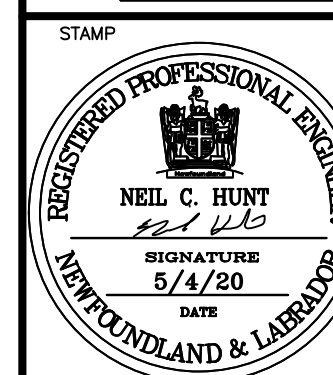

C	RE-ISSUED FOR TENDER	5/4/20
B	ISSUED FOR TENDER	4/22/20
A	ISSUED FOR REVIEW	4/1/20
revisions		date
project		project

ARMOUR STONE PROTECTION
 ANCHOR POINT, NL

drawing desin

SECTIONS

designed N.H.	concu
date MAY 4, 2020	
drawn P.H.	desine
date MAY 4, 2020	
approved	approval

Tender <i>Paul Curran</i>	Submission
DFO Project Manager	
project number 723250	no. du projet
drawing no. C3	no. du dessin