

LEGEND

- 230.0 --- EXISTING MAJOR CONTOUR
- EXISTING MINOR CONTOUR
- PROPERTY LINE
- EXISTING CANAL ACCESS ROAD
- EXISTING GABIONS
- EXISTING CONCRETE
- EXISTING CULVERT
- EXISTING HYDRO POLE
- PROPOSED EMBANKMENT ROAD
- PROPOSED WET-SIDE CREST
- PROPOSED WET-SIDE TOE
- PROPOSED VEGETATED STRIP
- RELOCATED DITCH

| | | | |
|-----|-------------------------|-------------------|----------|
| F | ISSUED FOR TENDER | DN | 19-08-20 |
| E | ISSUED FOR TENDER | DL | 01-05-20 |
| D | ISSUED FOR TENDER | DL | 01-25-18 |
| C | ISSUED FOR TENDER | DL | 12-11-17 |
| B | ISSUED FOR REVIEW - 99% | DL | 11-15-17 |
| O | ISSUED FOR REVIEW - 66% | DL | 10-23-17 |
| No. | Description | Dwn.By Des.Par | Date |

Revision / Révision

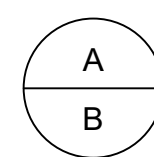

A Detail number
No. du détail
B Location dwg. no.
No. sur dessin

ISSUED FOR TENDER

Project title / Titre du projet

TSW INFRASTRUCTURE
TALBOT CANAL
REHABILITATION - NORTH
EMBANKMENT

Drawing title / Titre du dessin

PLAN & PROFILE
STATION 1+900 TO 2+280

Drawn by / Dessiné par

DAVID LEUNG

Designed by / Conçu par

DAVID LEUNG

Approved by / Approuvé par

STEVE CLARK

Drawing Date / Date du dessin

DECEMBER 1, 2019

Project manager / Administrateur de projet

STEVE CLARK

Contract No. / Numéro du contrat

TBD

Drawing No. /

Dessin No.

Project No. / Numéro du projet

161-14299-00

C106

Sheet
Feuille

8 of 26

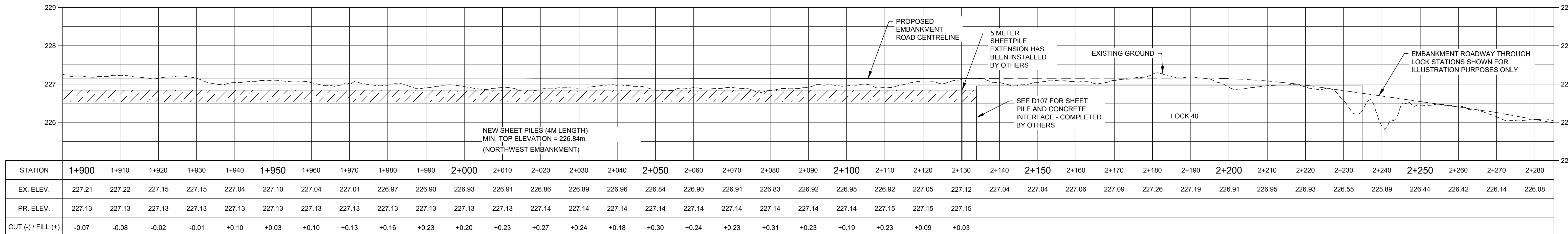

PROFILE - NORTHWEST EMBANKMENT

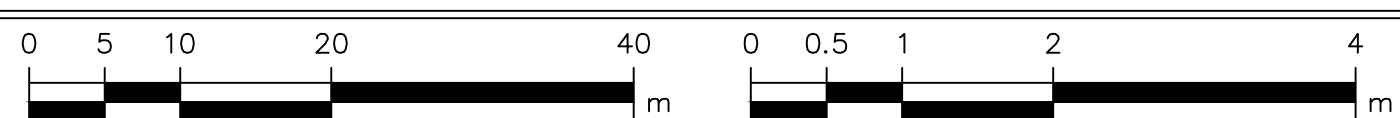

HORIZONTAL SCALE =
1:500

VERTICAL SCALE = 1:50