

# Trent-Severn Waterway

*PCA Property Boundaries  
Port Severn - Dam C & D*





PLAN OF IMPROVEMENTS WITHIN THE SURVEY OF  
PART OF ISLAND K IN THE SEVERN RIVER

(OPPOSITE LOT 28, CONCESSION 2)

PART OF ISLAND X (10)  
AND PART OF WATER LOT 2 IN FRONT OF  
ISLAND X (10) AND ISLAND K IN THE SEVERN RIVER

(FORMERLY TOWNSHIP OF BAXTER)

TOWNSHIP OF GEORGIAN BAY  
DISTRICT MUNICIPALITY OF MUSKOKA  
AND WATER LOT 1  
AND PART OF LOTS 18 AND 19  
CONCESSION 12  
TOWNSHIP OF TAY, COUNTY OF SIMCOE

SCALE 1:500  
0 2 4 6 8 10 20 METRES

ZUBER, EMO AND PATTEN LTD.  
1998

METRIC  
DISTANCES ON THIS PLAN ARE IN METRES AND CAN  
BE CONVERTED TO FEET BY DIVIDING BY 0.3048

NOTES:

BEARINGS HEREON ARE GRID BEARING AND ARE DERIVED FROM  
HORIZONTAL CONTROL MONUMENT NO. 6  
009710428 E 600077.703 N 4962285.258  
009710432 E 599351.011 N 4961876.609  
AND ARE REFERRED TO THE CENTRAL MERIDIAN 81° WEST LONGITUDE,  
UTM ZONE 17, NAD83 DATUM.

DISTANCES SHOWN HEREON ARE ADJUSTED GROUND LEVEL  
DISTANCES AND MAY BE CONVERTED TO GRID DISTANCES BY  
MULTIPLYING BY A COMBINED SCALE FACTOR OF 0.9996992

BENCH MARK

ELEVATIONS HEREON ARE GEODETIC AND ARE REFERRED TO  
GEODETIC BENCH MARK NO. 6103401 HAVING AN ELEVATION  
OF 182.050 METRES

- ◆ DENOTES SET
- ◆ DENOTES FOUND
- ◆ S.I.B. DENOTES 0.025 X 0.025 X 1.219 IRON SURVEY BAR
- ◆ I.B. DENOTES 0.016 X 0.016 X 0.610 IRON SURVEY BAR
- ◆ S.S.I.B. DENOTES 0.025 X 0.025 X 0.610 IRON SURVEY BAR
- ◆ R.B. DENOTES ROCK BAR
- ◆ C.C. DENOTES CUT CROSS
- T.C.M. DENOTES TRENT CANAL CONCRETE MONUMENT
- T.C. DENOTES TRENT CANAL
- C.B. DENOTES COPPER BOLT
- D.H. DENOTES DRILL HOLE IN ROCK
- H - DENOTES OVERHEAD HYDRO LINES
- B - DENOTES OVERHEAD BELL LINES
- U.P. DENOTES UTILITY POLE
- V.S. DENOTES SIGN POST
- C.S.P. DENOTES CORRUGATED STEEL PIPE AND DIAMETER
- P.W.F. DENOTES POST AND WIRE FENCE
- C.L.F. DENOTES CHAIN LINK FENCE
- W.F. DENOTES FLAG POLE
- G.R. - DENOTES GUARD RAIL
- T.L.S. DENOTES TRAFFIC LIGHT STANDARD
- L.S. DENOTES LIGHT STANDARD
- R - DENOTES STEEL RAIL FENCE
- A - DENOTES METAL INFORMATION ARCH
- M - DENOTES METAL POST BARRICADE
- B.F. DENOTES BOARD FENCE
- C.S.P. DENOTES CORRUGATED STEEL PIPE

O.R.O.

MISC. 1945 ONT  
DATE: JANUARY 21, 2000

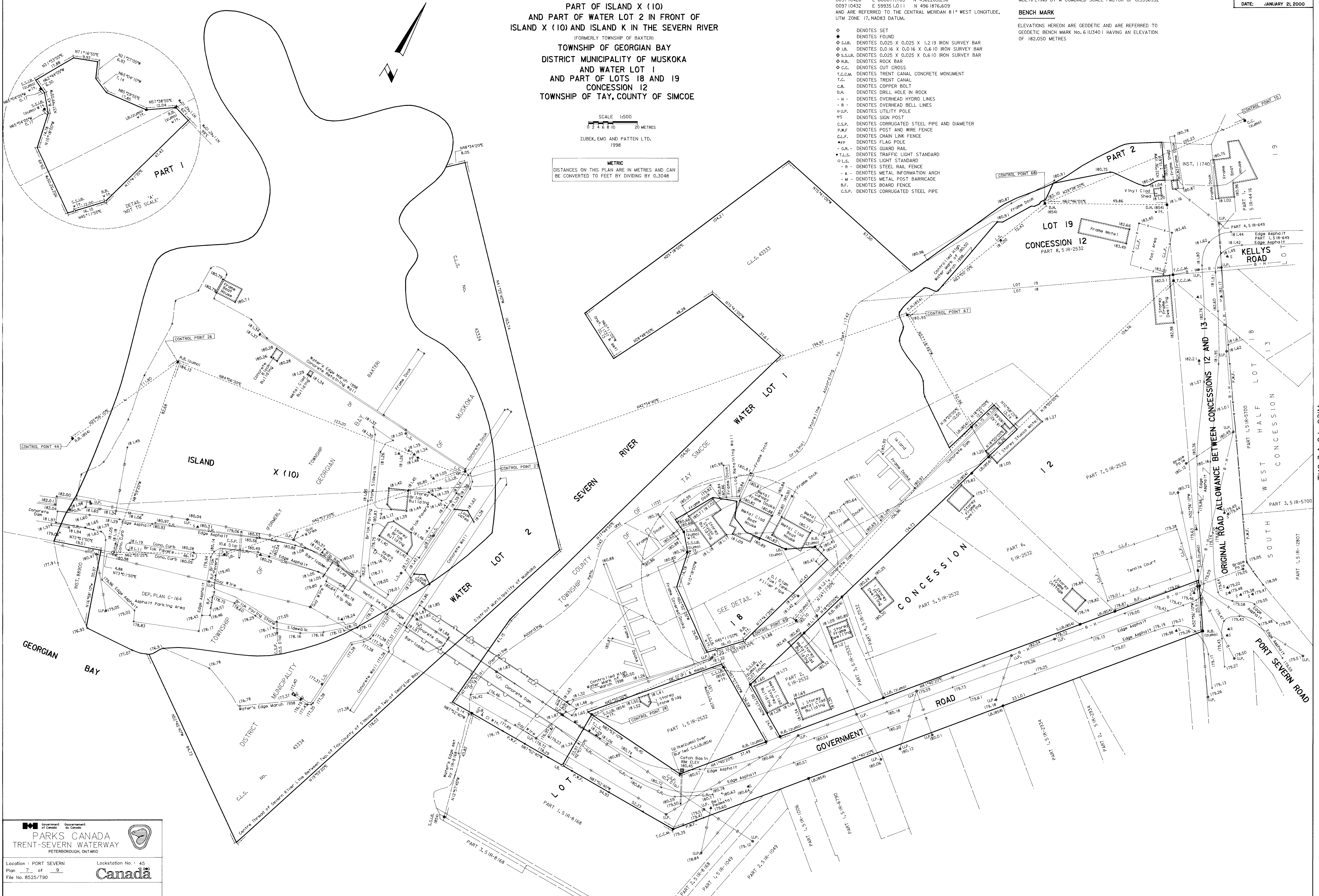

Government of Canada  
PARKS CANADA  
TRENT-SEVERN WATERWAY  
PETERBOROUGH, ONTARIO

Location: PORT SEVERN  
Plan 7 of 9  
File No. 8525/T90

Lockstation No.: 45  
Canada