



RETURN BIDS TO:

RETOURNER LES SOUMISSIONS À:

Travaux publics et Services gouvernementaux
Canada

Place Bonaventure, portail Sud-Oue

800, rue de La Gauchetière Ouest

7^e étage, suite 7300

Montréal

Québec

H5A 1L6

FAX pour soumissions: (514) 496-3822

**SOLICITATION AMENDMENT
MODIFICATION DE L'INVITATION**

The referenced document is hereby revised; unless otherwise indicated, all other terms and conditions of the Solicitation remain the same.

Ce document est par la présente révisé; sauf indication contraire, les modalités de l'invitation demeurent les mêmes.

Comments - Commentaires

Vendor/Firm Name and Address

Raison sociale et adresse du
fournisseur/de l'entrepreneur

Issuing Office - Bureau de distribution

Travaux publics et Services gouvernementaux Canada

Place Bonaventure, portail Sud-Oue

800, rue de La Gauchetière Ouest

7^e étage, suite 7300

Montréal

Québec

H5A 1L6

Title - Sujet Construction hangar et chenil	
Solicitation No. - N° de l'invitation EF937-210361/A	Amendment No. - N° modif. 009
Client Reference No. - N° de référence du client R.100341.001	Date 2020-08-26
GETS Reference No. - N° de référence de SEAG PW-\$MTC-035-15787	
File No. - N° de dossier MTC-0-43041 (035)	CCC No./N° CCC - FMS No./N° VME
Solicitation Closes - L'invitation prend fin at - à 02:00 PM on - le 2020-09-03	Time Zone Fuseau horaire Heure Avancée de l'Est HAE
F.O.B. - F.A.B. Plant-Usine: <input type="checkbox"/> Destination: <input type="checkbox"/> Other-Autre: <input type="checkbox"/>	
Address Enquiries to: - Adresser toutes questions à: Lussier, Joël	Buyer Id - Id de l'acheteur mtc035
Telephone No. - N° de téléphone (514) 708-3582 ()	FAX No. - N° de FAX (514) 496-3822
Destination - of Goods, Services, and Construction: Destination - des biens, services et construction:	

Instructions: See Herein

Instructions: Voir aux présentes

Delivery Required - Livraison exigée	Delivery Offered - Livraison proposée
Vendor/Firm Name and Address Raison sociale et adresse du fournisseur/de l'entrepreneur	
Telephone No. - N° de téléphone Facsimile No. - N° de télécopieur	
Name and title of person authorized to sign on behalf of Vendor/Firm (type or print) Nom et titre de la personne autorisée à signer au nom du fournisseur/ de l'entrepreneur (taper ou écrire en caractères d'imprimerie)	
Signature	Date

INVITATION TO TENDER
Hangar construction and Kennel extension
Rigaud, Que

This amendment 009 is raised for :

- Questions and Answers from bidders

Question 13

Regarding the project, please answer the following questions:

1) On the plans the coating re1, and re2 are polished concrete and on section 09 67 00 it is an epoxy coating, please confirm which one is correct,
In section 09 91 23 in system 13 it is a sealed floor but in point 2 it is an epoxy please tell me which option"

Response

See Addendum A-02.

For the question regarding system

Question 14

Please, is there a contradiction in the general finish rating for re1 and re2 with plinth is without plinth?
Epoxy or Polished Concrete?
Thank you"

Response

See Addendum A-02

Question 15

Below are additional questions for the above mentioned project.

Regarding masonry:

- In the estimate, the type of anchor / fasteners and mortar are not specified. Could you be more precise?
- Round corners for 90mm blocks do not exist according to our supplier.
- The installation of reinforcement such as your general details are complex to achieve for a block of 90mm. Are these details applicable for all masonry?
- In compositions M1, M4 and M5 on page A13, it is specified "Concrete block with fasteners (include sealant). What type of sealant are you referring to?

For wall and floor covering systems, here are the questions and request for approval of the products offered:

- There is no finish on the floors of the enclosures outside the switchboard so excluded, please confirm

Specification section 09 67 00

RE1 system

Can you confirm the thicknesses, recipe and products

Thickness

Page 5 point 2.1 .1 .13 mentions 4mm minimum (= 160 mils)

Page 6 point 2.2 .1 .1 .1 (8 mils) and .2 (80 mils) + page 7 2.2 .4 .6 (20mils) gives a total of +/- (100 mils) and not 4 mm = (160 mils) thickness and recipe to be confirmed

Products

- sikafloor 156 or 261 primer coat
- sikafloor 261 with addition of silica # 70 self-leveling base coat
- sikagard 7500 topcoat (epoxy novolak)

RE2 system same basic system but replaces the finish

Products

- sikafloor 156 or 261 primer coat
- sikafloor 261 with addition of silica # 70 self-leveling base coat
- sikafloor duochem 942 urethane aliphatic

RE3 wall system

Can you confirm the products, the quote does not mention primer and the products require it

Sikagard Duroplas EE sealant primer

Sikagard Duroplast 150 2 coats of water-based epoxy finish

Finally, considering that we still have not had answers to the various questions asked previously, is it possible to obtain an extension of time allowing us to submit a competitive monetary proposal to you?

Response

Masonry : See specifications.

Rounded corner is available in 90mm.

The 90mm block is secured with fasteners as shown in the drawings.

Sealant on block: See specifications in painting section.

Outdoor enclosures See addenda A-01 and A-02

09 67 00 See addendum A-01.

Question 16

Here is a question pertaining to door hardware :

To several hardware groups (such as group 09), it is specified: Card reader (s), request-to-exit detector (s), controller (s) and access management software are provided,

- installed, connected and put into operation BY OTHERS.

Can you confirm that card readers and their activation are excluded from this contract?

Response

As indicated

Question 19

Pursuant to my analysis of the tender documents, the section 08 20 00 – (Wood doors and frames) does not appear to be in the specification.

Please indicate which type of door is to be installed in the project.

Response

See Addendum A-02.

Question 20

Ceiling plans A08

see 06 / A08 cubicle sector and table of finishes

There is no cap to mention. Are the walls 3 meters high but no ceiling? can you confirm if remains as is?

Room E153 which has 2 wire mesh walls on Axis 6 from L to H and on axis H between 6 and 8, can you confirm where is the paintable gypsum ceiling portion mentioned in the finish table?

For system # 13

Can we get clarification on system # 13 floor sealer, the system described is a transparent 2 component (3 coats) water based epoxy paint what is the name of the product in question?

Is the BeS end of floor paint system # 13?

In rooms E-150, E-153, E167 and E170 where there are hatchings we limit the BeS finish or start the hatch or the hatch is applied over the BeS finish?

Plan A08 and A30

The hatched floor section note C05 floor marking is made by whom with which products and in which quotation section?

Plan A30

Are the RE1 and RE2 floor finishes mentioned as polished concrete without baseboard? but the finished slip mentions epoxy coating which corresponds to the estimate 09 67 00

Response

As per drawings

See drawings

System13:

No product name can be given.

Yes.

This is floor marking. So the sealant is done across the entire slab then comes the marking.

Question 22

I have a question about the D.E125.1 gate.

On the door panel it is written type P4 door material stained and varnished wood with aluminum frame, hardware gr 21

Can it be specified whether it is a wooden door with usually a steel frame or they want an aluminum frame with the wooden door.

In addition, the P4 type is not compatible with a footplate since it has full-size glazing.

Response

See addendum A-02.

As requested.

The dimension of the glazing will be adjusted on site to allow the installation of the footplate.

Question 24

Our flooring and ceramic subcontractors ask us to give a reference product or a purchase allowance for materials because in their specifications sections, it is indicated "at the choice of the Ministerial Representative".

However, this statement is far too vague and does not allow bidders to tender in a fair and equitable manner.

Please specify

Response

The contractor will present products that meet the requirements of the quotation. The color selection will be done on site from the samples sent.

Question 27

On plan A-05, we find note C06 which speaks of providing "... awning-type protection...".

We would need more details on the plans as the dimensions are not written down and there are no elevations either.

Will the awning be retractable (ceiling canvas only) or fixed? Removable or fixed?

Triangular roof or sloping flat?

With canvas on the sides or not?

Please specify the criteria s.v.p."

Response

See Addendum A-01

Question 28

There is a serious ambiguity with the vinyl tiles. In the plans and the list of finishes, we only find VC1. However, in the specification section 09 65 19, there are two very distinct kinds of vinyl tiles, but which are not identified as being VC1 or VC2.

The price difference is huge.

Please clarify whether Article 2.1.2 applies in this draft. If so, please identify it as VC1 or VC2.

Response

See Addendum A-02

Question 29

I have a question regarding the titled tender,

- In the architectural specifications section 04 22 00 in articles 2.1.1.3, 2.1.2.4 and 2.1.3.3, it is requested that the concrete blocks have sharp edges. However in architectural plan A23-E, several details (such as 14) show that the corners of the blocks are rounded. Considering that the subcontractor filing is tomorrow afternoon, it is possible that we will not have a response in time. If this is the case we will prioritize the quote to the details.

Response

See Addendum A-03 to come.

Question 33

My subcontractor wants to know what kind of paint to use for floor marking in the hangar?

Response

See Addendum A-02

Question 34

Following my analysis of the architectural plan, on plan A-08 Detail 05, we can read the following note. In the specifications, we do not find any section where we speak of intumescent paint. Would it be possible to issue a clarification to this effect.

Response

See Addendum A-03 to come.

Question 12

1-After today's visit I want to work on the project, but is there a possibility of postponing the closing date?

2-Is there a truck access inside the site for deliveries?

3-Can we install our site trailer inside the site or in the parking at the bottom?

4-Is it possible to have an electrical connection from the old hangar?

5-What is the construction start date?

Response

1- see modification 5.

2-No, the contractor cannot use the College's delivery dock. All construction deliveries must be made directly to the construction site.

3-The site trailer(s) must be located within the construction site limits.

4-An electrical connection is available from the location indicated in red :

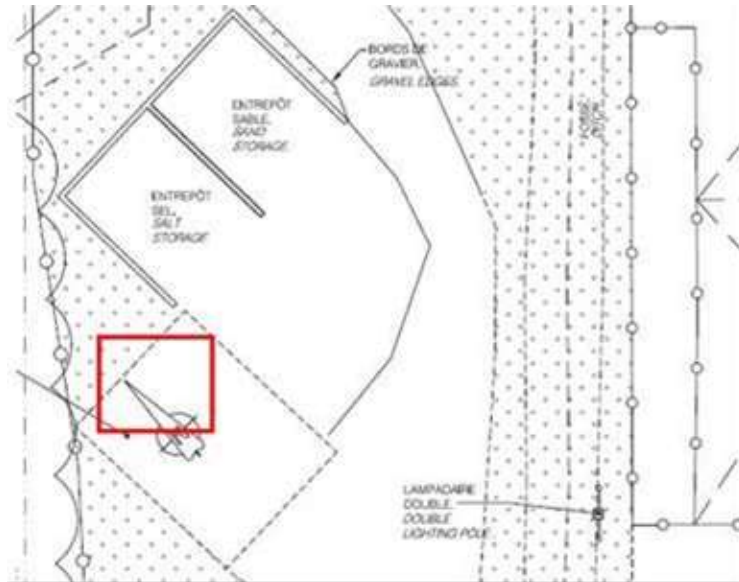

5-The construction start date will be as soon as possible after the contract is awarded in September.

Question 17

Regarding employee access, will they be allowed to drive directly to the construction site or will they have to park outside the perimeter?

Response

The site supervisor/project manager may park on the construction site. Contractor identified trucks and sub-contractors may go directly to the site and park there (parking spaces behind the College cannot be used therefore if there is no spaces left on the site, these vehicles must park in P2 located before the entrance.). Workers arriving in their personal vehicles must park at P2 and walk to the site. Workers with equipment to drop off at the site may drive there, drop off their equipment, and return to park in P2. In order to ease the site access process, a list of workers will be provided to the security located at the entrance booth. In so doing, workers may present themselves to the entrance, booth

identify themselves to security, and proceed directly to the construction site without having to go to the security post at the College's entrance.

Question 25

1. Do you require temporary partitions, if so where and is 2 meter mesh is this acceptable?
2. Does the owner provide electrical power for both phases of the job? (hangar and Kennel).
3. Should we include the costs of Covid 19? Protection, cleaning ETC.

Response

- .1 See drawings and specifications.
- .2 The contractor must arrange the connection as per BGIS instructions. There will not be a monthly charge for consumption.
- .3 If the contractor wants to be compensated for Covid related charges, they must be included in the quotation. The contractor must operate his site respecting current CNESST regulations and it is up to the contractor to determine if there are Covid related charges to include in the quotation.

All other terms and conditions to the original solicitation remains unchanged.