



Public Works and
Government Services
Canada

Travaux publics et
Services gouvernementaux
Canada

RETURN BIDS TO:

RETOURNER LES SOUMISSIONS À:

See Section 1. Voir Section 1.

STANDARD REQUEST FOR BID

INVITATION À SOUMISSIONNER - STANDARD

The Bidder offers to provide to Canada the goods, services or both listed in the bid solicitation in accordance with the conditions set out in the bid solicitation and the prices set out in the bid.

This bid solicitation is issued in accordance with the conditions of the Supply Arrangement E60PQ-140003/PQ.

Le soumissionnaire offre de fournir au Canada les biens, services ou les deux énumérés dans la demande de soumissions aux conditions prévues dans la demande de soumissions et aux prix indiqués dans la soumission.

Cette demande de soumissions est émise conformément aux conditions de l'arrangement en matière d'approvisionnement E60PQ-140003/PQ.

Solicitation No. - N° de la demande 2R008-20-0093	Amendment No. - N° de modification
--	------------------------------------

Solicitation closes – La demande prend fin : at – à See Section 1 Voir Section 1 on – le See Section 1 Voir Section 1	File No. - N° de dossier 2R008-20-0093
---	---

No of Page/

N° de page 15

Date of Solicitation – Date de la demande October 14, 2020
Address inquiries to – Adresser toute demande de renseignement à : See Section 2, Article 4.1. Voir Section 2, Article 4.1
Destination See Section 2, Annex A. Voir Section 2, Annexe A.

Instructions:

Municipal taxes are not applicable.

Unless otherwise specified in the bid solicitation, all prices quoted must be net prices in Canadian funds including Canadian customs duties, excise taxes, must be FOB, including all delivery charges to destination(s) as indicated. The amount for Applicable Taxes is to be shown as a separate item.

Instructions:

Les taxes municipales ne s'appliquent pas.

Sauf indication contraire dans la demande de soumissions, tous les prix indiqués doivent être des prix nets, en dollars canadiens, comprenant les droits de douane canadiens, la taxe d'accise et doivent être FAB, y compris tous frais de livraison à la (aux) destination(s) indiqué(s). Le montant des taxes applicables doit apparaître séparément.

Supplier Name and Address – Nom et adresse du fournisseur
Telephone No. - N° de téléphone Facsimile No. - N° de télécopieur
Name and title of person authorized to sign on behalf of supplier (type or print) Nom et titre de la personne autorisée à signer au nom du fournisseur (caractère d'impression)
Signature : _____ Date : _____

TABLE OF CONTENTS

Section 1 – Invitation and Instructions to Bidders

Section 2 – Resulting Contract including a list of required goods and services

SECTION 1 – INVITATION AND INSTRUCTIONS TO BIDDERS

Step 1. For Tier 2 and Tier 3 only (If Tier 1, skip this step and proceed with step 2)

Is this a Manufacturer Product Specific Procurement? **No.**

Step 2. Competitive or Non-Competitive

For competitive Requirements when more than one bid is received:

A bid must comply with the requirements of the bid solicitation and meet all mandatory technical evaluation criteria to be declared responsive. The responsive bid with the lowest evaluated price will be recommended for award of a contract.

For Competitive Requirements when only one bid is received:

The Bidder must provide the following information AFTER bid closing, if requested to do so by Canada:

- One or more of the following price justifications:
 1. a current published price list indicating the percentage discount available to Canada; or
 2. a copy of paid invoices for the like quality and quantity of the goods, services or both sold to other customers; or
 3. a price breakdown showing the cost of direct labour, direct materials, purchased items, engineering and plant overheads, general and administrative overhead, transportation, etc., and profit; or
 4. any other supporting documentation as requested by Canada.

For Non-Competitive Requirements:

The Bidder must provide the following information WITH the bid:

- One or more of the following price justifications:
 1. a current published price list indicating the percentage discount available to Canada; or
 2. a copy of paid invoices for the like quality and quantity of the goods, services or both sold to other customers; or
 3. a price breakdown showing the cost of direct labour, direct materials, purchased items, engineering and plant overheads, general and administrative overhead, transportation, etc., and profit; or
 4. any other supporting documentation as requested by Canada.

Step 3. General or PSAB

For PSAB procurement:

Canadian Content

The Supplier should propose conforming products(s) denoted as “Canadian Content” in the Supplier’s SA. Canada may preference all bids containing products(s) with this designation.

Terms of the RFB:

This RFB is issued pursuant to the Supplier's Furniture for Workspaces Supply Arrangement (SA) that forms part of the series of SAs issued by PWGSC with the number E60PQ-140003/PQ. The terms and conditions in the Supplier's SA apply to and form part of this RFB. Bidders who submit a bid agree to be bound by those terms and conditions as well as the terms and conditions in this RFB.

The WTCM is the Workspaces Terms and Conditions Manual that contains all terms and conditions in full text that form part of individual RFBs under this SA.

The Bidder must provide the following information WITH the bid:

- The information requested by Canada in Annex A herein.

The Bidder must also provide the information at article 4 below at the time indicated in article 3.

Security Requirement:

1. Conditions
 - a. the Bidder must hold a valid organization security (VOS) clearance as indicated in Annex B;
 - b. the Bidder's proposed individuals requiring access to classified or protected information, assets or sensitive work site(s) must meet the security requirement as indicated in Annex B.
2. For additional information on security requirements, bidders should refer to the Canadian Industrial Security Directorate (CISD), Industrial Program of Public Works and Government Services Canada (<http://ssi-iss.tpsgc-pwgsc.gc.ca/index-eng.html>) website.
3. The conditions in article 1 above must be met by the Bidder (the checked box applies):
 - a. by the closing date of the bid;
 - b. before the award of a contract. Bidders are reminded to obtain the required security clearance promptly. Any delay in the award of a contract to allow the successful bidder to obtain the required clearance will be at the entire discretion of the Contracting Authority.
4. Bidders are to supply the following information, as a minimum, to demonstrate compliance with the Security Requirement.
 - a. The Bidder's valid VOS clearance number issued by CISD;
 - b. The name of all individuals who will require access to classified or protected information, assets or sensitive work sites. It is desirable to also include their date of birth, their middle name, and their security clearance number issued by CISD.

Bid Evaluation

An evaluation team composed of representatives of Canada will evaluate the bids.

RFB Issued by:	
Identified User's (IU) Department/Agency/Crown Corporation: Contact for this RFB:	See Section 2, article 4.1 below.
RFB Closing - Submit Bid: Bids must be submitted on the date and at the time indicated below.	
By no later than date and time:	a. October 30, 2020 b. 3:00 pm EDS
To physical location (if applicable)	n/a
To e-mail address (if applicable)	Procurement.Achats@priv.gc.ca
Additional Bid Submission option epost Connect service:	n/a
RFB Enquiries	
Unless a different period is listed in the adjacent column, Bidders may submit enquires about the RFB to the Contracting Authority two business days prior to the RFB closing date. Enquiries received after the timeline indicated may not be answered.	___3___ business days

SECTION 2 - RESULTING CONTRACT CLAUSES

1.	Terms and Conditions of the Contract	
	The terms and conditions of Parts 6B and 6C of the Supplier's SA within the series E60PQ-140003/PQ apply to and form part of this Contract.	
2.	Security Requirement (the checked article applies)	
2.1	The applicable security requirement(s) is (are) set out in the Security Requirement Check List attached as Annex B of this contract. The Contractor must fulfill the security requirements by meeting the terms below.	
a.		Contractor may be escorted; possession of security clearance not required. Contractor personnel MAY NOT ENTER NOR PERFORM WORK ON sites where PROTECTED or CLASSIFIED information or assets are kept, without an escort provided by the department or agency for which the work is being performed.
b.		Possession of security clearance(s) is required. The Contractor must meet the security clearance requirements contained in the clausing in Annex B herein.
c.	<input checked="" type="checkbox"/>	There is no security requirement associated with this contract.
3.	Requirement	
3.1	The Contractor must perform the Work listed in Annex A herein.	
4.	Authorities	
4.1	Contracting Authority (IU)	
	Name:	Veronica Ross
	Title:	Procurement Officer
	Department/Agency/Crown Corporation:	Office of the Privacy Commissioner of Canada
	Address:	30 Victoria Street Gatineau, Quebec J8X 0A8
	Telephone No.:	(873)354-9618
	E-mail address:	Procurement.Achats@priv.gc.ca
4.2	Project Authority <i>[To be completed at contract award]</i>	

	<p><i>The Project Authority (PA) is the representative of the department or agency for whom the Work is being carried out under the Contract including the provision to approve the authority to proceed for delivery and installation and is responsible for all matters concerning the technical content of the Work under the Contract.</i></p> <p><i>In addition, the PA is also responsible for ensuring that the Supplier's employees and subcontractors requiring access to the site adhere to the allocated time for the Supplier to access the site to deliver and install the furniture in accordance with the master schedule held by the General Contractor (a representative of Canada or a service provider(s) under contract with the Government of Canada).</i></p>
	Name:
	Title:
	Department/Agency/Crown Corporation:
	Address:
	Telephone No.:
	E-mail address:
4.3	Contractor's Representative
	As set out in Annex A, Table 9 below.
5.	Method of Payment
	The checked box applies. If the Contractor's SA indicates acceptance for payment by credit card, that method may be used in conjunction with the following.
	<input checked="" type="checkbox"/> Single Payment
	<input type="checkbox"/> Multiple Payment
6.	Invoicing <i>(optional)</i>
	Further to the Invoicing terms of the WTCM document, the Contractor will deliver the original and one copy of the invoice to the following address for certification and payment:
	Name of the organization and contact: <i>[To be completed at contract award]</i>
	Address:
7.	Defence Contract. This clause applies if the box below is checked.
	<input type="checkbox"/> The Contract is a defence contract within the meaning of the Defence Production Act , R.S.C. 1985, c. D-1.

ANNEX A
REQUIREMENT and BASIS OF PAYMENT

1. Category Selection

Combined Categories Rule:

For reasons of compatibility, the following categories will be combined for evaluation and contract award purposes:

The rule only applies to the categories below that are checked. The unchecked categories will be evaluated separately and may be awarded to multiple suppliers;

Category 1

Category 2

Category 5

*** Exception: when using the Cat 1, 2, 5 combined categories rule, IU's may calculate the percentage of NSA product allowed (as defined in their solicitation document) against the total quantity of the combined categories.**

Design Upgrade Rule:

The IU may exercise an option to upgrade products up to 20% of each Category product total before Applicable Taxes after contract award.

The Design Upgrade amount is used at the discretion of the Project Authority (PA) **prior to the manufacturing/ordering of the products**, the PA will provide the Contractor with a written notice of Canada's Design Upgrade choices for each of the product(s) to be upgraded. The Contractor will provide the pricing of the upgraded product(s) to a maximum of 20% of each Category Contract Price of Table 8. The Contracting Authority will issue an amendment to the contract with the Design Upgrades and pricing.

The Supplier certifies that all the Design Upgraded products offered will conform to all specifications and meet the testing requirements detailed in the Specifications of the Supply Arrangement.

Design Upgrade: is the process of replacing a product with a more innovative or enhanced version of the same product.

NSA:

NSA products can be incorporated in the RFB and must not exceed 30% of the firm quantity by category. NSA items must be added to the category that is most closely related and must be generic.

The requirement includes the following category (ies) of work:

a. Category 1 – Interconnecting Panels and Freestanding Systems

Category 1a – Interconnecting Panels (Refer to Annex C)

Category 1b – Supporting components and freestanding furniture

RULE: Metal Storage

Identified Users may procure metal storage products forming part of Category 1 when the metal storage products will be part of a requirement for a workstation(s)/work point(s). If this rule does not apply, Category 3 must be used for the metal storage products forming part of this category.

b. Category 2 – Freestanding Height Adjustable Desk / Table Products

c. Category 3 – Metal Filing and Storage Cabinets

d. Category 4 – Wood Veneer – Freestanding Products

e. Category 5 – Ancillary and Lighting Products

f. Category 6 - Support Space – Collaborative Furniture

RULE: Category 6 can be further subdivided by space or like product in order to increase or allow competition. Space is defined as a location available for a particular purpose such as a meeting room space or a collaborative space. Like products are defined as products with similar design and construction. If NSA products form part of the requirement, the IU must validate the 30% NSA prior to subdividing the category. NSA products can be added to any subdivide or in its own subdivide.

The IU must identify how Category 6 will be subdivided in the Product Table for Category 6.

g. NSA Product(s) – Category(ies):

2. Product and Pricing Tables

Site Inspection Date: To be coordinated with Project Authority after contract award. (Refer to Annex A article 4 of the SA for Site Inspection and Documentation instructions.)

INSTRUCTIONS TO BIDDERS: Bidders are to complete Sections B of the tables identified by the IU in this article as well as Tables 8 and 9. **Bidders must provide a complete product offering for each category, or CAT 6 sub-divide they wish to submit a bid in order to be compliant.**

In a resulting contract, the term “Bid” means the Supplier’s commitment, the term “Bidder” means “Contractor”.

Product Category(ies): 1,2 and 3

Table 1 – Product Table

Section A - IU REQUIREMENT				Section B – SUPPLIER'S BID		
#	GoCUID	Description of Product <i>(Additional product details may be inserted, if required as per 6B. 4.1 of the SA)</i>	Qty	Supplier Part Number	Firm Unit Price** \$	Extended Total [Qty x Price] \$
Category 1A						
1	Refer to Annex C and Floor Plans.					\$
Category 2						
2	2WSSREXXL24L48BELXX	Individual Height Adjustable Work Surfaces	35		\$	\$
3	2WSSREXXL24L72BELXX	Individual Height Adjustable Work Surfaces	34			
Category 3						
4	3PMOBFXPPM15D24XXYK	Pedestals, Mobile, Box/File, Painted Metal	34		\$	\$
				Product Total		\$

Table 2 - Delivery

Section A - IU REQUIREMENT				Section B – SUPPLIER'S BID	
Product Item # from Table 1	Location	Desired Date** (Y/M/D)	Desired Time: Normal Business Hours Or Outside Normal Business Hours *	Supplier will supply and deliver as per below**	Firm Lot Price \$
1 to 4	Office of the Privacy Commissioner of Canada 30 Victoria street, Gatineau, QC J8X 0A8	2021-01-04	*Normal	_____ : weeks <i>Standard Lead time is between 6-10 weeks for furniture delivery and installation.</i>	\$
*Normal Business Hours 8:00 – 17:00, as per SA, Annex A, article 5				Delivery Total:	\$
**The Project Authority (PA) will provide the supplier the authority to proceed prior to the finalized delivery date taking into consideration the delivery time provided by the supplier. Canada will not be responsible if the supplier chooses to proceed without the PA authorization.					

Table 3 – Installation

Section A - IU REQUIREMENT				Section B – SUPPLIER'S BID	
Product Item # from Table 1	Location	Desired Date (Y/M/D)**	Desired Time: Normal Business Hours Or Outside Normal Business Hours *	Supplier will install as per below**	Firm Lot Price \$
1 to 4	Office of the Privacy Commissioner of Canada 30 Victoria street, Gatineau, QC J8X 0A8	2021-01-04	*Normal	_____ : weeks from date of supply and delivery <i>Standard Lead time is between 6-10 weeks for furniture delivery and installation.</i>	\$
*Normal Business Hours 8:00 – 17:00, as per SA, Annex A, article 5 **The Project Authority (PA) will provide the supplier the authority to proceed prior to the finalized installation date taking into consideration the installation time provided by the supplier. Canada will not be responsible if the supplier chooses to proceed without the PA authorization.				Installation Total:	\$

Table 4 – Optional Product Not Applicable

Table 5 – Optional Delivery Not Applicable

Table 6 – Optional Installation Not Applicable

Table 7 – Standard Finishes and Canada's Facilities to Accommodate the Delivery and Certifications

1.	Standard Finishes	
1.1	<p>IU is to consult the Supplier's Website identified in Part 6A of the SA to view the available finishes.</p> <p>Within ten business days of the contract award, the Project Authority will provide the Contractor with a written notice of Canada's finish choices for each of the product(s) in Annex A.</p> <p>The Contractor will deliver the products corresponding to Canada's choice of specific finishes(s). No additional charge will be applied to Canada.</p>	
2.	Canada's Facilities to Accommodate the Delivery	
	<p><i>The Supplier's employees and subcontractors requiring access to the site must adhere to the health and safety plans established for the site, in addition to any laws in effect in the jurisdiction where the work is being performed.</i></p> <p><i>During the period of the contract, a representative of Canada or a service provider(s) under contract with the Government of Canada may request the list of employees and subcontractors requiring access to the site to perform the work and their security statuses. Information must be provided in the timeframe prescribed in order to ensure that the supply, delivery and installation of the furniture aligns with the master schedule.</i></p>	
2.1	Loading Dock/Location	
A	Location	Office of the Privacy Commissioner of Canada, 30 Victoria street, Gatineau, QC, J8X 0A8
B	Dock	The loading dock is located off Maisonneuve Boulevard.
C	Lift	
D	Door	
E	Freight Elevator	Yes there is a freight elevator
F	Other (specify, if any)	
3.	Continuance of Certifications	

	The Bidder certifies that by submitting a bid in response to the RFB, the Bidder, and any of the Bidder's members if the Bidder is a Joint Venture, continues to comply with all of the following certifications listed in Parts 6A and 6B of the Bidder's SA for Work Spaces. Canada may request copies of environmental certification(s) prior to contract award within a time period specified by the Identified User.
3.1	Integrity Provisions
3.2	Federal Contractor's Program for Employment Equity
3.4	Product Conformance
3.5	Price Certification (In accordance with the SA, Part 6B)

Table 8 - Bid Evaluation and Contract Total for CATEGORY 1, 2 and 3 (Canada may complete if not completed by the Bidder)

1	Firm Product Total (Table 1)	\$
2	Firm Delivery Total (Table 2)	\$
3	Firm Installation Total (Table 3)	\$
4	Optional Product Total (Table 4) <i>(Applicable if Option is exercised)</i>	n/a
5	Optional Delivery Total (Table 5) <i>(Applicable if Option is exercised)</i>	n/a
6	Optional Installation Total (Table 6) <i>(Applicable if Option is exercised)</i>	n/a
7	Hardware Total as per article 1.5 of Annex A-1 of SA <i>(if Applicable)</i>	\$
8	Total Evaluated (Bid) Price* (1 + 2 + 3 + 4 + 5 + 6+ 7) <i>[to be removed at contract award]</i>	\$
9	Contract Price(1+2+3+7): <i>[applicable at contract award only]</i>	\$
10	Applicable Tax(es): <i>[applicable at contract award only]</i>	\$
11	Total Estimated Cost (9+10): <i>[applicable at contract award only]</i>	\$

* Applicable taxes extra.

Table 9 – Bidder's Authorized Representative

1.	Bidder's Authorized Representative for the Bid and the Contract	
	Name:	Telephone:
		E-Mail:
		Other:

ANNEX B

SECURITY REQUIREMENTS

- C. There is no security requirement associated with this contract.**

**ANNEX C
FLOOR PLAN(S)**

INSTRUCTIONS TO BIDDERS:

For Category 1a products, the Bidders must provide:

- a) Completed floor plan(s) with proposed SA approved products;
- b) A product listing of proposed SA approved products offered at floor plan(s).
 As a minimum the product listing must include the following information:
 - Supplier part numbers including NSA products forming part of this category;
 - brief product descriptions;
 - quantities;
 - firm unit prices.

***** Products from categories other than Category 1a shown on floor plan are for information purposes only*****

By submitting a bid, the Bidder certifies that their submission includes all components and quantities for Category 1a, in accordance with the floor plans, panel details, panel matrices and/or workstation layouts stipulated in Annex C.

***At contract award, "By submitting a bid, the Bidder" becomes "The Contractor".**

Category 1a Requirement:

1) Floor Plan(s) and Panel Details

See attached pdf and/or AutoCAD floor plan

2) Panel Matrix or Workstation Layout

a. Panel Matrix

Panel Matrix

A

Panel Matrix: All fabric
Seated Privacy Add-on Height

<i>upper element 1</i> Fabric / tissu	<i>upper element 2</i> Fabric / tissu
<i>lower element 1</i> Fabric / tissu	<i>lower element 2</i> Fabric / tissu

This document and all information herein is confidential and the intellectual property of Rossmann Architecture Inc. It is disclosed in confidence on terms that it will not be disclosed to any third party, used, sold, loaned, licensed, or reproduced in whole or in any part in any manner or form for manufacturing, tendering or for any other purpose without the written permission of Rossmann Architecture Inc. The copyright is retained by Rossmann Architecture Inc.

© Rossmann Architecture Inc.

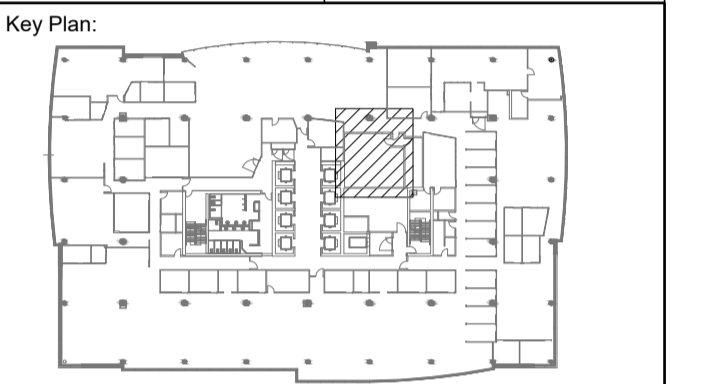
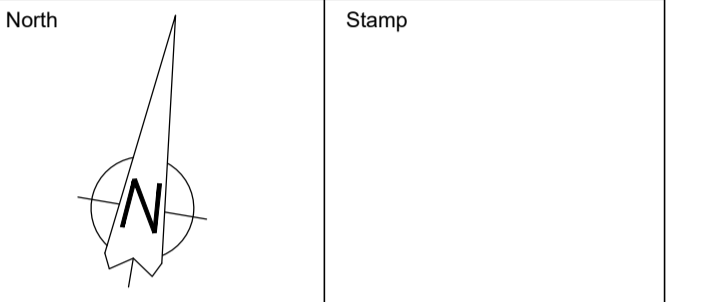

Contractor to verify all dimensions & conditions on site and immediately notify the departmental representative of all discrepancies.

revisions	description	date
revisions	ISSUED FOR CONSTRUCTION	2020-06-23
revisions	ISSUED FOR TENDER	2020-02-18
revisions	ISSUED FOR TENDER REVIEW	2020-02-07
revisions	99% DESIGN REVIEW	2020-01-22
revisions	66% DESIGN REVIEW	2019-12-10

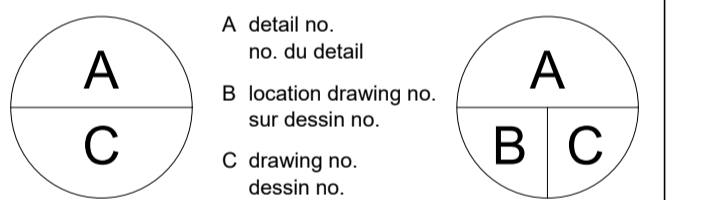

SPACE OPTIMIZATION PROJECT
FLOORS 7th AND 8th

30 Victoria, Gatineau, J8X 4H7

drawing / dessin

PLAN D'APPROVISIONNEMENT DE MOBILIER DU 7IEME ÉTAGE / FURNITURE PROCUREMENT PLAN OF 7TH FLOOR

Designed By	RAAI	Conçu par
Date		(2019/11/28)
Drawn By	ES	Dessiné par
Date		(2019/11/28)
Reviewed By	AA	Examiné par
Date		(2019/12/06)
Approved By	ER	Approuvé par
Date		(2019/12/10)
Tender		Soumission
Project Manager	Denis Patry	Administrateur de projets

Project no. / No. du projet

GOC2466261

Drawing no. / No. du dessin

F100

FURNITURE LEGEND / LÉGENDE DU MOBILIER

WXXX WORKSTATION TAG / ÉTIQUETTE DE POSTE DE TRAVAIL
THE FIGURES INDICATE THE WORKSTATION NUMBER / LES CHIFFRES INDIQUENT LE NUMÉRO DE LA POSTE DE TRAVAIL

RXX LOCKER TAG / ÉTIQUETTE DE CASIER
THE FIGURES INDICATE THE LOCKER NUMBER / LES CHIFFRES INDIQUENT LE NUMÉRO DU CASIER

JIFFY POLE

FURNITURE TAG
FIRST NUMBER INDICATES WIDTH
SECOND NUMBER INDICATES DEPTH

ÉTIQUETTE DE MOBILIER
PREMIER CHIFFRE INDIQUE LA LARGEUR
DEUXIÈME CHIFFRE INDIQUE LA PROFONDEUR

72 24 SIT/STAND INDIVIDUAL HEIGHT ADJUSTABLE WORK SURFACE / ASSIS/DEBOUT SURFACE DE TRAVAIL RÉGLABLE EN HAUTEUR
HEIGHT ADJUSTABLE AND ELECTRICALLY CONTROLLED WORK SURFACE, LAMINATED FINISH / SURFACE DE TRAVAIL RÉGLABLE EN HAUTEUR ET CONTRÔLÉE ÉLECTRIQUEMENT, FINIS LAMINÉ
MIN. 584 mm (23") - 25 mm (- 1") MAX. 1237 mm (48.7") + 25 mm (+1")

48 24 SIT/STAND INDIVIDUAL HEIGHT ADJUSTABLE WORK SURFACE / ASSIS/DEBOUT SURFACE DE TRAVAIL RÉGLABLE EN HAUTEUR
HEIGHT ADJUSTABLE AND ELECTRICALLY CONTROLLED WORK SURFACE, LAMINATED FINISH / SURFACE DE TRAVAIL RÉGLABLE EN HAUTEUR ET CONTRÔLÉE ÉLECTRIQUEMENT, FINIS LAMINÉ
MIN. 584 mm (23") - 25 mm (- 1") MAX. 1237 mm (48.7") + 25 mm (+1")

ped PERSONAL STORAGE PEDESTAL WITH SEAT / PIÉDESTAL DE RANGEMENT PERSONNEL AVEC SIÈGE
1 FILE AND 1 BOX DRAWER, PAINTED METAL FINISH, UPHOLSTERED CUSHION SEAT, KEYED LOCK / 1 TIROIR CLASSEUR ET 1 RANGEMENT PERSONNEL, FINIS MÉTAL PEINTURÉ, COUSSIN D'ASSISE, SERRURE À CLÉ
381 mm (15"W) X 610 mm (24"D)

S PERSONAL STORAGE LOCKER / CASIER DE RANGEMENT PERSONNEL
TWO HIGH PERSONAL STORAGE LOCKER, PAINTED METAL FINISH, KEYED LOCK / DEUX CASIERS DE RANGEMENT PERSONNEL SUPERPOSÉS, FINIS MÉTAL PEINTURÉ, SERRURE À CLÉ
457 mm (18"W) X 508 mm (20"D) X MIN. 1220 mm (48" H) MAX. 1372 mm (54" H)

PANEL MATRIX FOR SEATED PRIVACY HEIGHT ADD ON / MATRICE DE PANNEAU ADDITIONNEL POUR INTIMITÉ EN POSITION ASSISE

PANEL MATRIX / MATRICE DES PANNEAUX 48A (* IF PANNEL IS POWERED / SI PANNEAU EST ALIMENTÉ)	
UPPER ELEMENT / ÉLÉMENT SUPÉRIEUR 1 - FROSTED GLAZED / CLOISON VITRÉ GIVRÉ	UPPER ELEMENT / ÉLÉMENT SUPÉRIEUR 2 - FROSTED GLAZED / CLOISON VITRÉ GIVRÉ
LOWER ELEMENT / ÉLÉMENT INFÉRIEUR 1 - CUT-OUT IN FABRIC FOR TWO DOUBLE POWER OUTLETS AND TWO DATA OUTLET / OUVERTURES FINIES DANS LE TISSU POUR L'INSERTION DE DEUX DOUBLES PRISES ÉLECTRIQUES ET DEUX PRISES INFORMATIQUES	LOWER ELEMENT / ÉLÉMENT INFÉRIEUR 2 - CUT-OUT IN FABRIC FOR TWO DOUBLE POWER OUTLETS AND TWO DATA OUTLET / OUVERTURES FINIES DANS LE TISSU POUR L'INSERTION DE DEUX DOUBLES PRISES ÉLECTRIQUES ET DEUX PRISES INFORMATIQUES

SIDE / CÔTÉ 1

SIDE / CÔTÉ 2

PANEL MATRIX / MATRICE DES PANNEAUX 24B	
UPPER ELEMENT / ÉLÉMENT SUPÉRIEUR 1 - FROSTED GLAZED / CLOISON VITRÉ GIVRÉ	UPPER ELEMENT / ÉLÉMENT SUPÉRIEUR 2 - FROSTED GLAZED / CLOISON VITRÉ GIVRÉ
LOWER ELEMENT / ÉLÉMENT INFÉRIEUR 1 - FABRIC / TISSU	LOWER ELEMENT / ÉLÉMENT INFÉRIEUR 2 - FABRIC / TISSU

SIDE / CÔTÉ 1

SIDE / CÔTÉ 2

PANEL MATRIX / MATRICE DES PANNEAUX 30B	
UPPER ELEMENT / ÉLÉMENT SUPÉRIEUR 1 - FROSTED GLAZED / CLOISON VITRÉ GIVRÉ	UPPER ELEMENT / ÉLÉMENT SUPÉRIEUR 2 - FROSTED GLAZED / CLOISON VITRÉ GIVRÉ
LOWER ELEMENT / ÉLÉMENT INFÉRIEUR 1 - FABRIC / TISSU	LOWER ELEMENT / ÉLÉMENT INFÉRIEUR 2 - FABRIC / TISSU

SIDE / CÔTÉ 1

SIDE / CÔTÉ 2

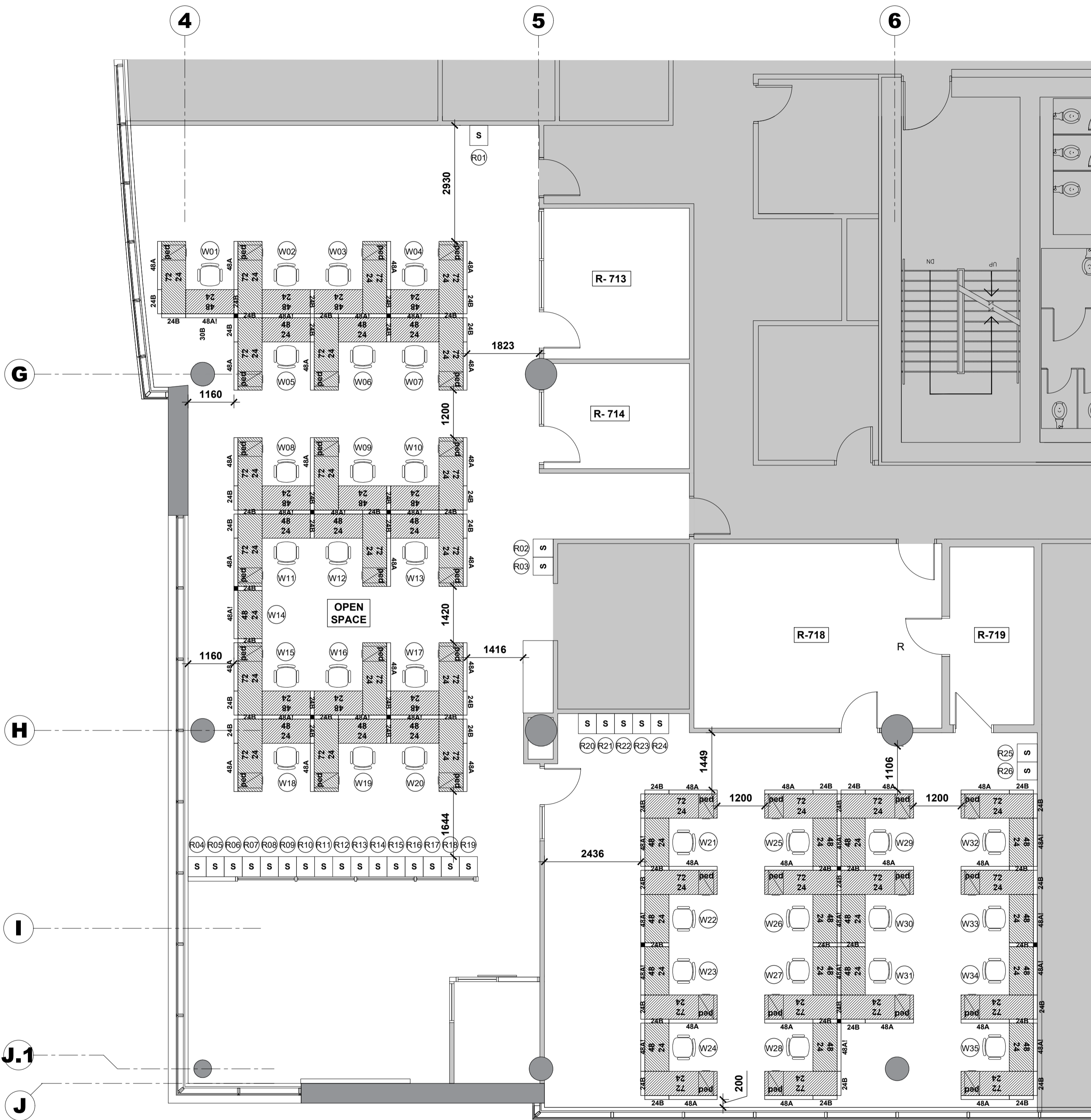

1 PLAN D'APPROVISIONNEMENT DE MOBILIER DU 7IEME ÉTAGE
FURNITURE PROCUREMENT PLAN OF THE 7TH FLOOR

F100 SCALE / ECH: 1:50

The following attributes have been removed from Category 1a: Wood Veneer, Clear Glazed, Tinted glazed.
 Les attributs suivants ont été supprimés de la catégorie 1a: Placage de bois, cloisons vitré transparente, cloisons vitré teintées.

Panel Height Hauteur des cloisons	Power Puissance	Lower Element 1 Élément inférieur 1	Lower Element 2 Élément inférieur 2	Upper Element 1 Élément supérieur 1	Upper Element 2 Élément supérieur 2	Width Largeur	Quantity Required Quantité requise	General / Général	
								Average unit price	Average extended price per product line
Seated Privacy Height Add On / Panneau additionnel pour intimité en position assise	Non-Powered / Non-électrifié	Fabric / tissu	Fabric / tissu	Frosted Glazed (Includes		610mm (24 in./po)	68	\$ 765.20	\$ 52,033.46
Seated Privacy Height Add On / Panneau additionnel pour intimité en position assise	Non-Powered / Non-électrifié	Fabric / tissu	Fabric / tissu	Frosted Glazed (Includes		1219mm (48 in./po)	34	\$ 1,071.43	\$ 36,428.52
Seated Privacy Height Add On / Panneau additionnel pour intimité en position assise	Powered outlet(s) Below Work Surface / Prise(s) électrique(s) au dessous de la surface de travail	Fabric / tissu	Fabric / tissu	Frosted Glazed (Includes		610mm (24 in./po)		\$ 904.05	\$ -
Seated Privacy Height Add On / Panneau additionnel pour intimité en position assise	Powered outlet(s) Below Work Surface / Prise(s) électrique(s) au dessous de la surface de travail	Fabric / tissu	Fabric / tissu	Frosted Glazed (Includes		1219mm (48 in./po)	23	\$ 1,210.28	\$ 27,836.42
Total								\$	116,298.40

Cat 1 ()

General Stream / Volet Général		
Tier 1: Estimated Median Value \$0.01 to \$24,999.99		\$ 116,298.40
Tier 2: Estimated Median Value \$25,000.00 to \$399,999.99 Palier 2 : valeur moyenne estimative comprise entre 25 000 \$ et 399 999,99 \$	Yes	Add 3% for Delivery charges, if applicable ajouter les frais de livraison (3 %), s'il y a lieu
Tier 3: Estimated Median Value \$400,000.00 to upper PWGSC, Acquisitions Program limits Palier 3 : valeur moyenne estimative comprise entre 400 000 \$ et la valeur maximale	No	Add 7% for Installation charges, if applicable ajouter les frais d'installation (7 %), s'il y a lieu
		\$ 3,488.95 Add 3% for Hardware ajouter le coût du matériel (3 %)
		\$ 17,444.76 Add Applicable Taxes
2020-09-03 10:24		\$ 137,232.11 Total estimated requirement value

Important: The results tab captures a total of the average prices for products that have been identified with a quantity on the product listing tab. This estimate is based on ceiling prices and clients can often obtain firm pricing with significant discounts of upto 20 to 50% during the solicitation.

Important: L'onglet Résultats contient le prix moyen des produits identifiés avec une quantité dans l'onglet Liste des produits. Cette estimation est basée sur des prix plafonds et les clients peuvent souvent obtenir des prix fermes avec des rabais significatifs allant de 20 à 50% lors d'un processus d'invitation à soumissionner

Cat 2 Ver C.05

FREE STANDING HEIGHT ADJUSTABLE WORK SURFACES

Specifications and the CST: When defining a requirement, the Identified Users (IU) MUST refer to Annex A-1 Specifications for Workspaces of the Supply Arrangement to fully understand the pre-qualified products and specifications.

The Specifications (Annex A-1): Define the minimum requirements that products meet or exceed. The Client Search Tool (CST) allows the Identified Users (IU) to generate a product GOCUID based on filter criteria (not to the full extent of the specifications) and it provides an estimated requirement value.

When completing the Annex A of the RFB, the IUs must specify the GOCUID and also include Additional Product Details when required.

- Multiple GOCUIDs may be specified when more than one product attribute is acceptable for the requirement.
- The additional product details are intended to further define the product within the scope of the Specification (can be criteria that were not included in CST and does not contradict the specification).
- Criteria defined by a range in the CST may be further defined to meet the clients specific needs. Refer to 6B. 4.1 of the SA and CST instruction tab for further details.

Cat 2 Ver C.04	Quantity Required Quantité requise	GoCUID CIUGdC	PRODUCT	TYPE OF PRODUCT	SHAPE	SUPPORT	FINISHES	DEPTH-WIDTH-DIAMETER	LENGTH	HEIGHT	CONTROLS	PRIVACY SCREEN	General Stream	
													Average unit price	Average extended price per product line
12	35	2WSSREXXL24L48BELXX	Individual Height Adjustable Work Surfaces	Sit Stand	Rectangular	NA	Laminate	24	48	23 to 48.7	Electric	NA	\$ 1,953.85	\$ 68,384.75
24	34	2WSSREXXL24L72BELXX	Individual Height Adjustable Work Surfaces	Sit Stand	Rectangular	NA	Laminate	24	72	23 to 48.7	Electric	NA	\$ 2,152.22	\$ 73,175.48
													Sum	\$ 141,560.23

Cat 2 (Freestanding Height Adjustable Desk/Table Products)

General Stream			
Tier 1: Estimated Median Value \$0.01 to \$24,999.99		\$	141,560.23
Tier 2: Estimated Median Value \$25,000.00 to \$399,999.99 Palier 2 : valeur moyenne estimative comprise entre 25 000 \$ et 399 999,99 \$	YES / OUI	\$	4,246.81
			Add 3% for Delivery charges, if applicable ajouter les frais de livraison (3 %), s'il y a lieu
Tier 3: Estimated Median Value \$400,000.00 to upper PWGSC, Acquisitions Program limits Palier 3 : valeur moyenne estimative comprise entre 400 000 \$ et la valeur	NO / NON		
			Add 7% for Installation charges, if applicable ajouter les frais d'installation (7 %), s'il y a lieu
		\$	4,246.81
			Add 3% for Hardware ajouter le coût du matériel (3 %)
		\$	21,234.03
			Add Applicable Taxes
2020-09-03 10:41		\$	171,287.88 Total estimated requirement value

Important: The results tab captures a total of the average prices for products that have been identified with a quantity on the product listing tab. This estimate is based on ceiling prices and clients can often obtain firm pricing with significant discounts of upto 20 to 50% during the solicitation.

Important: L'onglet Résultats contient le prix moyen des produits identifiés avec une quantité dans l'onglet Liste des produits. Cette estimation est basée sur des prix plafonds et les clients peuvent souvent obtenir des prix fermes avec des rabais significatifs allant de 20 à 50% lors d'un processus d'invitation à soumissionner

FILLING AND STORAGE CABINETS

Specifications and the CST: When defining a requirement, the Identified Users (IU) MUST refer to Annex A-1 Specifications for Workspaces of the Supply Arrangement to fully understand the pre-qualified products and specifications.

[The Specifications \(Annex A-1\):](#) Define the minimum requirements that products meet or exceed. The Client Search Tool (CST) allows the Identified Users (IU) to generate a product GOCUID based on filter criteria (not to the full extent of the specifications) and it provides an estimated requirement value.

When completing the Annex A of the RFB, the IUs must specify the GOCUID and also include Additional Product Details when required.

- Multiple GOCUIDs may be specified when more than one product attribute is acceptable for the requirement.
- The additional product details are intended to further define the product within the scope of the Specification (can be criteria that were not included in CST and does not contradict the specification).
- Criteria defined by a range in the CST may be further defined to meet the clients specific needs. Refer to 6B. 4.1 of the SA and CST instruction tab for further details.

												General Stream	
Item #	Quantity Required Quantité requise	GoCUID CIUGdC	PRODUCT	TYPE OF PRODUCT	FORMAT	FINISHES	WIDTH	DEPTH	HEIGHT	UPHOLSTERED CUSHION SEATS	LOCKS	Average unit price	Average extended price per product line
57	34	3PMOBFXXPM15D24XXYK	Pedestals	Mobile	Box/File	Painted Metal	15	24	NA	Yes	Keyed	\$ 690.25	\$ 23,468.50

Cat 3 ()

General Stream		
Tier 1: Estimated Median Value \$0.01 to \$24,999.99	\$	23,468.50
Tier 2: Estimated Median Value \$25,000.00 to \$399,999.99 Palier 2 : valeur moyenne estimative comprise entre 25 000 \$ et 399 999,99 \$	No	Add 3% for Delivery charges, if applicable ajouter les frais de livraison (3 %), s'il y a lieu
Tier 3: Estimated Median Value \$400,000.00 to upper PWGSC, Acquisitions Program limits Palier 3 : valeur moyenne estimative comprise entre 400 000 \$ et la valeur	No	Add 7% for Installation charges, if applicable ajouter les frais d'installation (7 %), s'il y a lieu
	\$	704.06
	\$	3,520.28
	\$	27,692.83 Total estimated requirement value
2020-09-03 10:44		

Important: The results tab captures a total of the average prices for products that have been identified with a quantity on the product listing tab. This estimate is based on ceiling prices and clients can often obtain firm pricing with significant discounts of upto 20 to 50% during the solicitation.

Important: L'onglet Résultats contient le prix moyen des produits identifiés avec une quantité dans l'onglet Liste des produits. Cette estimation est basée sur des prix plafonds et les clients peuvent souvent obtenir des prix fermes avec des rabais significatifs allant de 20 à 50% lors d'un processus d'invitation à soumissionner



Public Works and
Government Services
Canada

Travaux publics et
Services gouvernementaux
Canada

PURCHASING OFFICE - BUREAU DES ACHATS

CONTRACT – CONTRAT

Use "Canada accepts your bid" when you issued an RFB document, with Sections 1 and 2 completed, and the bidder has submitted a bid document.

Canada accepts your bid to provide to Canada the goods, services or both described in the Contract in accordance with the conditions and at the prices set out in the Contract.

Le Canada accepte votre soumission de fournir au Canada les biens, services ou les deux décrits dans le contrat conformément aux conditions et aux prix prévus au contrat.

Use "You are Requested" when you conducted a verbal solicitation, did not sent a RFB document to the bidder with Section 2 completed, and you did not review terms and conditions of Section 2 with the bidder

You are requested to sell to the Majesty the Queen in right of Canada, in accordance with the terms and conditions set out herein, referred to herein or attached hereto, the supplies and services listed herein and on any attached sheets at the price or prices set out therefor.

Nous vous demandons de vendre à Sa Majesté la Reine du chef du Canada, aux conditions énoncées ou incluses par référence dans les présentes et aux annexes ci-jointes, les articles et les services énumérés dans les présentes et sur toute feuille ci-annexée, au(x) prix indiqué(s).

Supplier to sign for a "You are Requested" contract only.

The vendor hereby accepts this contract Le fournisseur accepte le présent contrat	
Name, title of person authorized to sign (type or print) Nom et titre du signataire autorisé (caractère d'impression)	
Signature	Date

Return signed copy forthwith - Prière de retourner une copie dûment signée immédiatement

PWGSC-TPSGC 9400-4 (11/2008) modified by Furniture Division July 20

File No. – N° de dossier	
Date of Contract – Date du Contrat	
Contract No. - N° du contrat	Amendment No. - N° de modification
Client Reference No. (optional) - N° du référence du client (facultatif)	
Financial Code(s) – Code(s) financier(s)	
Duty - Droits <input checked="" type="checkbox"/> Included Inclus <input type="checkbox"/> Excluded En sus	GST - TPS/ HST – TVH <input checked="" type="checkbox"/> Included Inclus <input type="checkbox"/> Excluded En sus
FOB – FAB DESTINATION	
Destination See Section 2, Annex A. Voir Section 2, Annexe A.	
Invoices - Original and two copies must be completed and sent to: Factures – L'original et deux copies doivent être remplis et envoyés à : See Section 2, Article 6. Voir Section 2, Article 6.	
Address inquiries to : - Adresser toute demande de renseignements à : See Section 2, Article 4.1. Voir Section 2, Article 4.1.	
Area Code and Telephone No. Code régional et N° de téléphone	Facsimile No. N° de télécopieur
Total estimated cost – Coût total estimatif	
For the Minister – Pour le Ministre	

Canada