



04	ISSUED FOR TENDER - R1	2018-10-03
03	ISSUED FOR TENDER	2018-03-14
02	99% DESIGN REVIEW	2018-02-21
01	50% DESIGN REVIEW	2018-02-09
revision		date

Do not scale drawings.
Verify all dimensions and conditions on site and immediately notify the Departmental Representative of all discrepancies.

A	Detail No.
B	No. du détail
C	No. - where detail required / dessin no. - où détail exigé
	drawing no. - where detailed / dessin no. - où détaillé

project title / titre du projet
TORONTO Ontario
PUBLIC WORKS GOVERNMENT SERVICE CANADA
330-338 KEELE ST.

drawing title / titre du dessin
ELECTRICAL PLAN - DEMOLITION

drawn by / dessiné par **M.H.**

designed by / conçu par **A.M.**

approved by / approuvé par **O.B.**

bid / offre project manager / administrateur de projets

project date / date du projet **2018-03-14**

project no. / no. du projet **163-00323-01**
PWGSC#R.083503.001

drawing no. / dessin no. **E01**

DRAWING NOTES (POWER AND LIGHTING)

- 01 REMOVE THE EXISTING OVERHEAD DOOR OPERATOR WITH ALL HARDWARE, CONTROLS AND SENSORS. REMOVE ALL ASSOCIATED WIRING BACK TO SOURCE PANEL IN MAIN ELECTRICAL ROOM. DO NOT ABANDON ANY CONDUCTOR / WIRE. REMOVE ALL SURFACE MOUNTED OR EXPOSED CONDUITS ASSOCIATED WITH DOOR OPERATORS AND CAP THE CONDUITS IN DRYWALL. DO NOT REUSE ANY REMOVED CONDUIT OR CONDUCTORS FOR NEW INSTALLATION. REMOVE ISOLATING DISCONNECT SWITCH AT HIGH LEVEL.
- 02 DISCONNECT, MAKE SAFE AND LABEL AS "SPARE" THE BREAKERS FEEDING OVERHEAD DOORS IN NORTH LOADING DOCK.
- 03 REMOVE ALL ELECTRICAL EQUIPMENT AND FEEDERS ASSOCIATED WITH POWER AND CONTROL OF THE EXISTING UNIT HEATER. PULL BACK AND REMOVE ALL POWER AND CONTROL CABLES AND EXPOSED OR SURFACE MOUNTED CONDUITS UP TO THE SOURCE. REFER TO MECHANICAL DRAWINGS FOR DETAIL INFORMATION. IF THE UNIT HEATER IS FED BY A DEDICATED CIRCUIT BREAKER, ELECTRICAL CONTRACTOR TO MAKE SAFE THE BREAKER AND LABEL IT AS SPARE. IF THE BREAKER IS SHARED WITH OTHER ELECTRICAL LOADS, ELECTRICAL CONTRACTOR TO REMOVE THE FEEDER CABLE TO THE NEAREST BRANCH JUNCTION BOX AND LEAVE THE OTHER LOADS ON THE FEEDER.
- 04 EXISTING EXIT SIGNS AND EMERGENCY LIGHTS TO REMAIN.
- 05 REMOVE THE EXISTING FLUORESCENT STRIP LIGHTS. REMOVE THE WIRING AND CONDUITS IF DON'T MATCH TO THE NEW LAYOUT. VERIFY THE LOCATION AND REMOVE THE EXISTING LIGHTING SWITCH. ELECTRICAL CONTRACTOR TO PATCH AND PAINT ALL WALLS AFFECTED.
- 06 EXISTING EXTERIOR WALL SCONCES. UNINSTALL THE FIXTURE TEMPORARILY, CLEAN AND STORE PROPERLY. THESE FIXTURES WILL BE RE-INSTATED AS PART OF THIS CONTRACT PER NEW PLAN DRAWING LAYOUT AFTER MASONRY WORKS COMPLETED.
- 07 REMOVE ALL ELECTRICAL EQUIPMENT IN THE UNDERSIDE OF THE EXISTING PLATFORM AND ON THE EXTERIOR WALL IN DEMOLITION AREA INCLUDING JUNCTION BOXES, CONDUITS, WIRING AND PUSH BUTTONS.
- 08 RELOCATE EXISTING EMERGENCY REMOTE HEAD LIGHT. REFER TO NEW PLAN DRAWING. VERIFY THE EMERGENCY REMOTE HEAD LIGHT IN ITS NEW LOCATION.
- 09 REMOVE ALL LIGHTING AND POWER EQUIPMENT ON THE DEMOLITION WALLS WITH ASSOCIATED CONDUITS AND WIRING, UNLESS OTHERWISE NOTED.

DRAWING NOTES (FIRE ALARM)

- 10 RELOCATE EXISTING FIRE ALARM DETECTORS IN DEMOLITION AREA WITH THE WIRING AND EXPOSED CONDUITS. REWORK EXISTING FIRE ALARM CIRCUIT OR ZONE TO SUIT NEW LAYOUT. REFER TO NEW LAYOUT.
- 11 EXISTING FIRE ALARM PULL STATIONS TO REMAIN.
- 12 EXISTING FIRE ALARM BELLS TO REMAIN.
- 13 RE-PROGRAM THE EXISTING FIRE ALARM CONTROL PANEL (IN METER ROOM), UPDATE THE EXISTING FIRE ALARM ANNUNCIATOR PANEL (IN MAIN LOBBY) AND UPDATE THE PASSIVE GRAPHIC DISPLAYS AS REQUIRED.

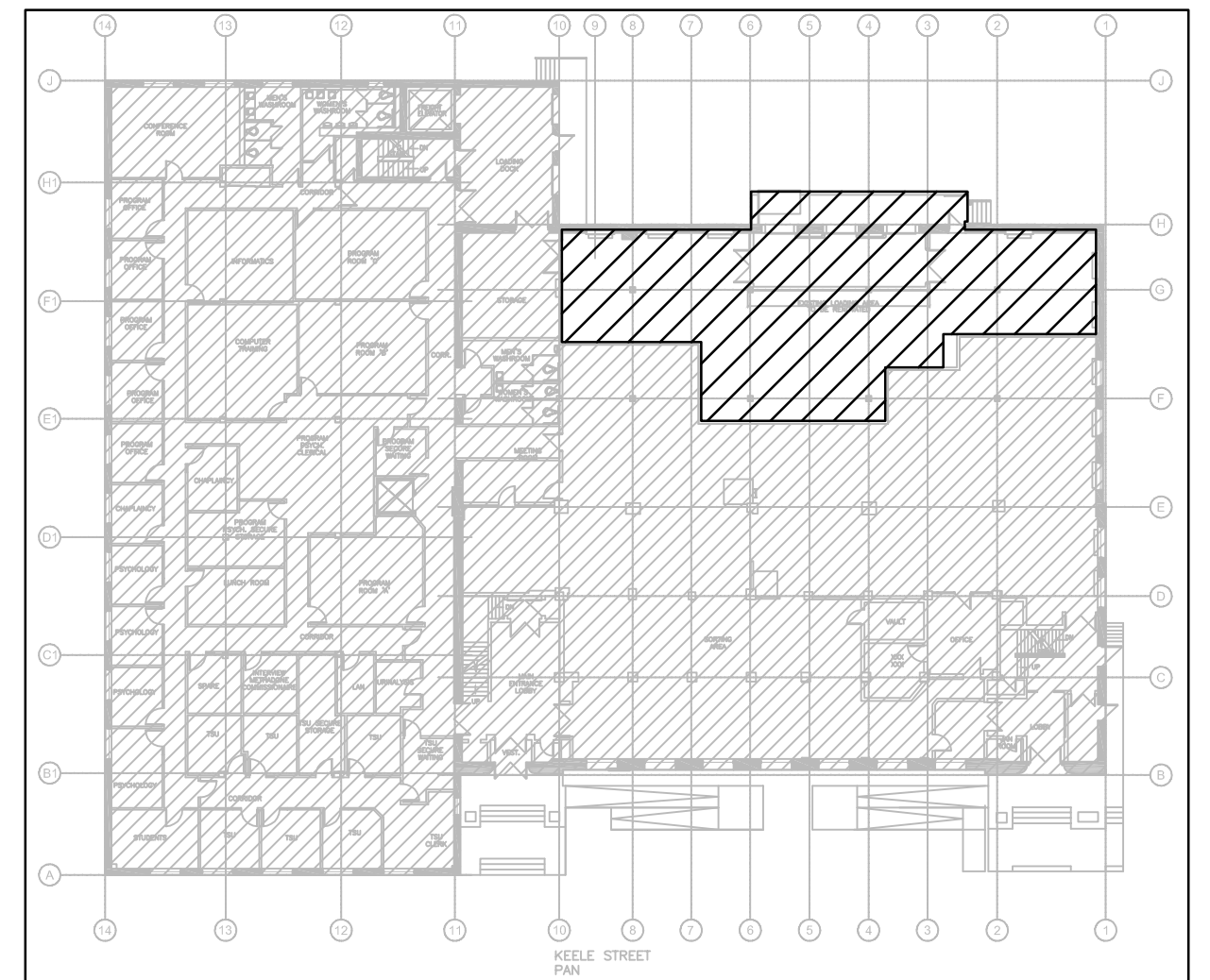

KEY PLAN

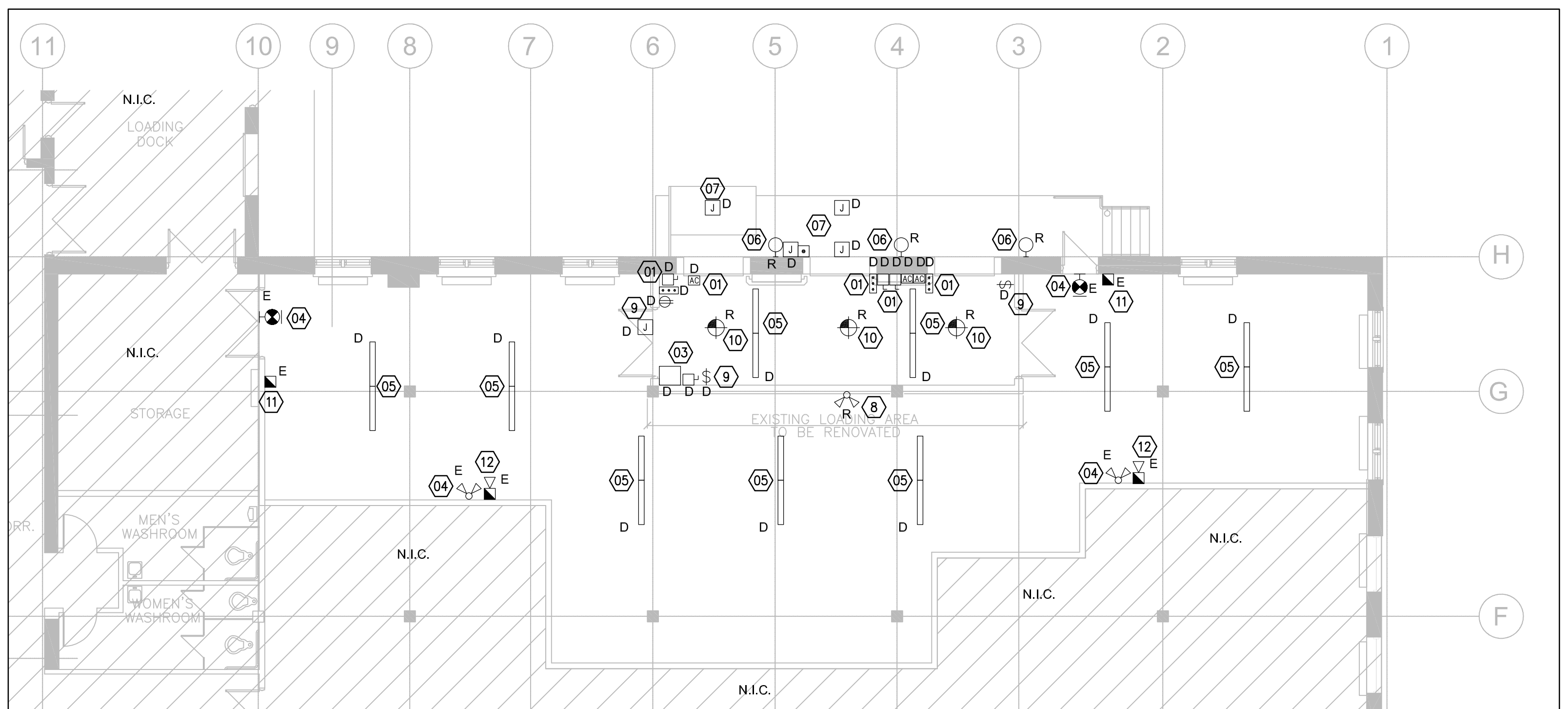

1 DEMOLITION PLAN - MAIN FLOOR
SCALE: 1:100

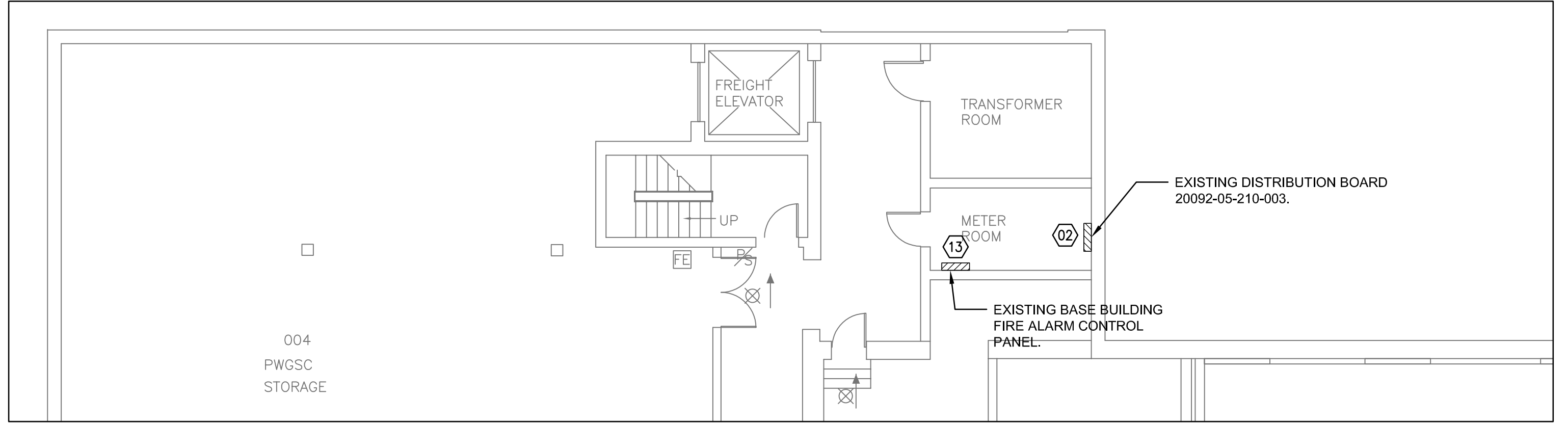

2 EXISTING ELECTRICAL METER ROOM - BASEMENT
SCALE: 1:100