



RETURN BIDS TO:

RETOURNER LES SOUMISSIONS À:

Travaux publics et Services gouvernementaux
Canada

Voir dans le document/

See herein

NA

Québec

NA

**SOLICITATION AMENDMENT
MODIFICATION DE L'INVITATION**

The referenced document is hereby revised; unless otherwise indicated, all other terms and conditions of the Solicitation remain the same.

Ce document est par la présente révisé; sauf indication contraire, les modalités de l'invitation demeurent les mêmes.

Comments - Commentaires

Vendor/Firm Name and Address

Raison sociale et adresse du
fournisseur/de l'entrepreneur

Issuing Office - Bureau de distribution

Travaux publics et Services gouvernementaux Canada
Place Bonaventure, portail Sud-Oue
800, rue de La Gauchetière Ouest
7^e étage, suite 7300
Montréal
Québec
H5A 1L6

Title - Sujet Computer laboratory workbenches-ECC Computer laboratory workbenches-ECCC	
Solicitation No. - N° de l'invitation EF944-212498/A	Amendment No. - N° modif. 002
Client Reference No. - N° de référence du client R.112994.001	Date 2021-03-10
GETS Reference No. - N° de référence de SEAG PW-SMTA-625-16090	
File No. - N° de dossier MTA-0-43291 (625)	CCC No./N° CCC - FMS No./N° VME
Solicitation Closes - L'invitation prend fin at - à 02:00 PM Eastern Daylight Saving Time EDT on - le 2021-03-22 Heure Avancée de l'Est HAE	
F.O.B. - F.A.B. Plant-Usine: <input type="checkbox"/> Destination: <input checked="" type="checkbox"/> Other-Autre: <input type="checkbox"/>	
Address Enquiries to: - Adresser toutes questions à: Lavoie, Corine	Buyer Id - Id de l'acheteur mta625
Telephone No. - N° de téléphone (514) 207-4777 ()	FAX No. - N° de FAX () -
Destination - of Goods, Services, and Construction: Destination - des biens, services et construction: Voir doc.	

Instructions: See Herein

Instructions: Voir aux présentes

Delivery Required - Livraison exigée	Delivery Offered - Livraison proposée
Vendor/Firm Name and Address Raison sociale et adresse du fournisseur/de l'entrepreneur	
Telephone No. - N° de téléphone Facsimile No. - N° de télécopieur	
Name and title of person authorized to sign on behalf of Vendor/Firm (type or print) Nom et titre de la personne autorisée à signer au nom du fournisseur/ de l'entrepreneur (taper ou écrire en caractères d'imprimerie)	
Signature	Date

AMENDMENT 002

This amendment is made in order to modify the Annex A (Requirement) of the Request for proposals and to publish a Question & Answer.

DELETE

ANNEX "A" - REQUIREMENT

Part 2 - Products

2.2 GENERAL FEATURES

- .14 Controls: Desk products offering *continuous height adjustment* capability shall be operable from the usual working position and shall not require the use of any unsupplied tools. Controls used to effect continuous adjustments shall have adequate clearance to permit the user to make the adjustment. Hand-crank-adjustable surfaces shall not require more than 50 N (12 lbf.) to operate.

QUESTION & ANSWER

Question:

To our knowledge there are no hand crank systems that gives a stroke ranging from 24 to 50''H, therefore the height adjustability has to be performed by an electrical system, built from actuators, control box and a keypad. Can you confirm this is what is expected here, and if so, can you give an approximation of the weight capacity the actuators or the surface is expected to handle?

Answer:

The intention is that the work surface (like the shelves) can be manually installed at varying heights on the vertical structure and if needed, with height adjustable legs in the front for more support. The use of tools will be required.

At a minimum, the center surface will be adjustable, per the image below:

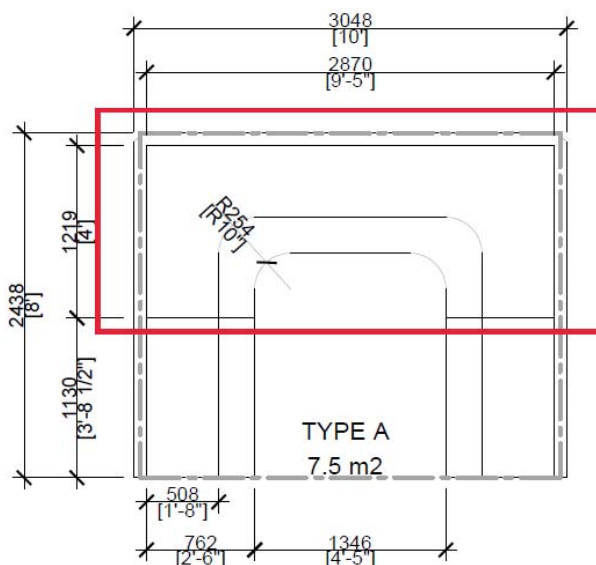

Solicitation No. - N° de l'invitation
EF944-212498/A
Client Ref. No. - N° de réf. du client
EF944-212498

Amd. No. - N° de la modif.
002
File No. - N° du dossier
MTA-0-43291

Buyer ID - Id de l'acheteur
mta625
CCC No./N° CCC - FMS No./N° VME

ALL OTHER TERMS AND CONDITIONS REMAIN UNCHANGED.