



RETURN BIDS TO:

RETOURNER LES SOUMISSIONS À:

Travaux publics et Services gouvernementaux
Canada

Voir dans le document/

See herein

NA

Québec

NA

**SOLICITATION AMENDMENT
MODIFICATION DE L'INVITATION**

The referenced document is hereby revised; unless otherwise indicated, all other terms and conditions of the Solicitation remain the same.

Ce document est par la présente révisé; sauf indication contraire, les modalités de l'invitation demeurent les mêmes.

Comments - Commentaires

Vendor/Firm Name and Address

Raison sociale et adresse du
fournisseur/de l'entrepreneur

Issuing Office - Bureau de distribution

Travaux publics et Services gouvernementaux Canada
Place Bonaventure, portail Sud-Oue
800, rue de La Gauchetière Ouest
7^e étage, suite 7300
Montréal
Québec
H5A 1L6

Title - Sujet Computer laboratory workbenches-ECC Computer laboratory workbenches-ECCC	
Solicitation No. - N° de l'invitation EF944-212498/A	Amendment No. - N° modif. 003
Client Reference No. - N° de référence du client R.112994.001	Date 2021-03-17
GETS Reference No. - N° de référence de SEAG PW-SMTA-625-16090	
File No. - N° de dossier MTA-0-43291 (625)	CCC No./N° CCC - FMS No./N° VME
Solicitation Closes - L'invitation prend fin at - à 02:00 PM Eastern Daylight Saving Time EDT on - le 2021-03-29 Heure Avancée de l'Est HAE	
F.O.B. - F.A.B. Plant-Usine: <input type="checkbox"/> Destination: <input checked="" type="checkbox"/> Other-Autre: <input type="checkbox"/>	
Address Enquiries to: - Adresser toutes questions à: Lavoie, Corine	Buyer Id - Id de l'acheteur mta625
Telephone No. - N° de téléphone (514) 207-4777 ()	FAX No. - N° de FAX () -
Destination - of Goods, Services, and Construction: Destination - des biens, services et construction: Voir doc.	

Instructions: See Herein

Instructions: Voir aux présentes

Delivery Required - Livraison exigée	Delivery Offered - Livraison proposée
Vendor/Firm Name and Address Raison sociale et adresse du fournisseur/de l'entrepreneur	
Telephone No. - N° de téléphone Facsimile No. - N° de télécopieur	
Name and title of person authorized to sign on behalf of Vendor/Firm (type or print) Nom et titre de la personne autorisée à signer au nom du fournisseur/ de l'entrepreneur (taper ou écrire en caractères d'imprimerie)	
Signature	Date

AMENDMENT 003

The purpose of this amendment is as follows:

- 1) Extend the closing date of the Tender Notice
- 2) Answer questions received
- 3) Amend the solicitation document

QUESTIONS / ANSWERS

- Q2. The intention is that the work surface (like the shelves) can be manually installed at varying heights on the vertical structure and if needed, with height adjustable legs in the front for more support. The use of tools will be required.**

Please advise if a mechanically adjustable foot assembly giving the worksurface a range of adjustability from 26"H up to 40"H is acceptable in this application? The operation to raise/ lower the surface will require basic tools and is not intended to be performed frequently.

A2. No

- Q3. With regards to part 3 – section 3.1.2.8 – Privacy Panels; the privacy panels must be open frame with the exception of two tackable upper elements to be removable. Can you advise what would be the general dimensions of these 2 tackable panels you're referring to?**

A3. This may be supplier dependent, but the width should fit within the vertical posts. The height can be approximately 12 inches (this may also be supplier dependent).

- Q4. For part 3.1.1.1.1, the full height panels, we plan on providing laminated finishing panels that are removable and installed with small brackets that attaches on the back of the rear vertical post. Can you advise if this is acceptable, and can you confirm if we must provide panels for all sides of the benches, including those where the benches are facing a wall in the room?**

A4. This is acceptable, and all sides of the panel should be closed.

Q5. Point 3.1.1.1.5 – can you advise what are the approximate expected width for the hutch, and if possible, on which section of the bench they will be installed?

A5. The width of an overhead storage unit must correspond with the width of the supporting panel. They should be placed on the panel which is against the wall.

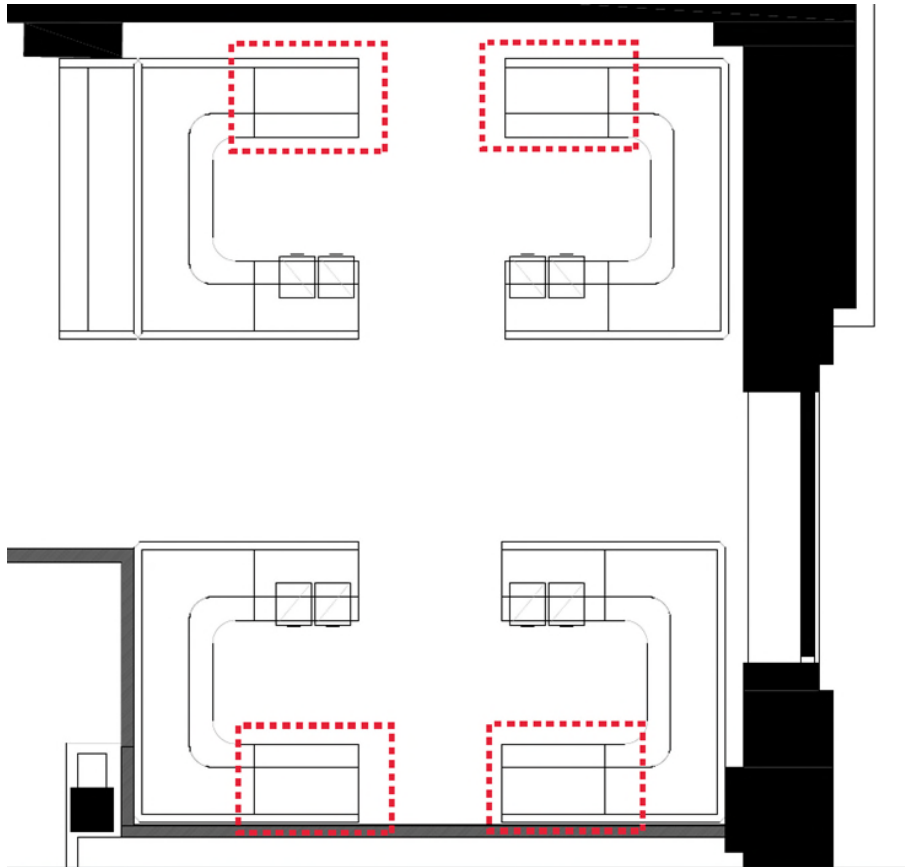

ALL OTHER TERMS AND CONDITIONS REMAIN UNCHANGED.