



Fisheries and Oceans
Canada

Pêches et Océans
Canada



Small Craft Harbours
Newfoundland Region
St. John's, NL.

Ports Pour Petits Bateaux

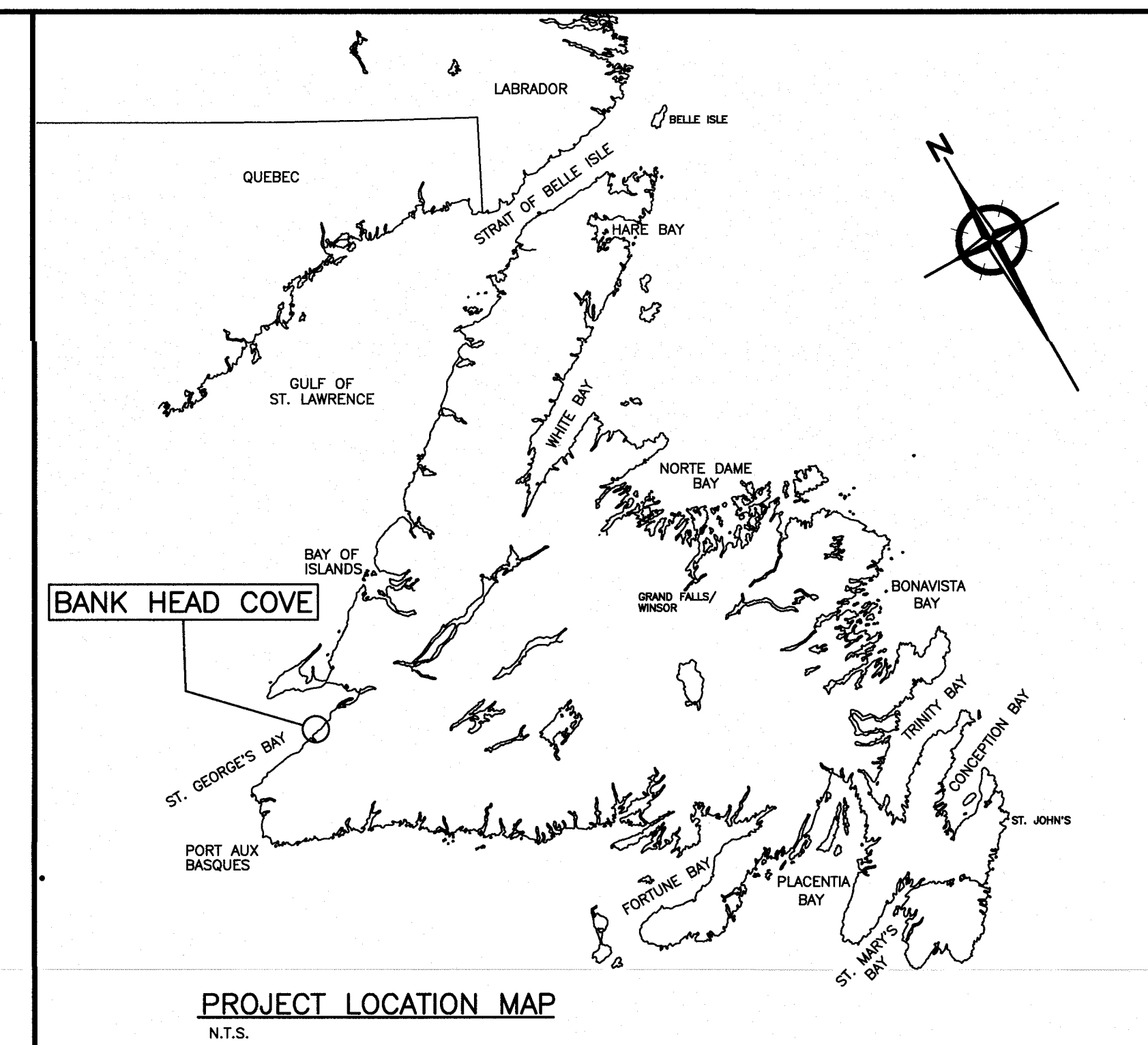

UPLAND IMPROVEMENTS BANK HEAD COVE, NL.

LONG RANGE MOUNTAINS DISTRICT, NEWFOUNDLAND AND LABRADOR

PROJECT NO. 723439

DRAWING LIST

DRAWING NO.	TITLE
1 OF 5	EXISTING SITE PLAN & TOPOGRAPHIC SURVEY
2 OF 5	NEW SITE PLAN
3 OF 5	SITE PROFILE AT CENTERLINE OF ROADWAY
4 OF 5	SITE SECTIONS
5 OF 5	SITE SECTIONS



SMALL CRAFT HARBOURS

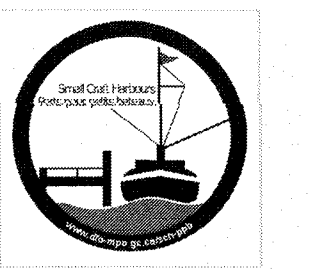

PROVINCE OF NEWFOUNDLAND
 PERMIT HOLDER
 This Permit Allows
 ANDERSON ENGINEERING CONSULTANTS LTD.
 To practice Professional Engineering
 in Newfoundland and Labrador.
 Permit No. as issued by APECSL 80092,
 which is valid for the year 2021.

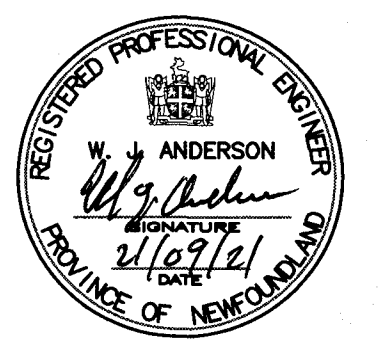

NOTES

SURVEY INFORMATION UPDATED BY AECL
 SURVEY DATE AUGUST 25, 2020

CONTROL POINTS:	PL NAME	EASTING	NORTHING	CD ELEV	DESCRIPTION
	935000	376335.203	5358780.686	+58.120 m	PROVINCIAL BRASS PLAQUE IN BOULDER
	PWC 1-2013	377065.438	5359743.240	+13.391 m	I.P. DRIVEN INTO GRAVEL
	PWC 2-2013	377091.228	5359670.932	+14.746 m	I.P. DRIVEN INTO GRAVEL

ALL ELEVATIONS IN METERS.

ALL ELEVATIONS REFERRED TO PWC 1-2013 ELEV. +13.391m (I.P. DRIVEN IN GRAVEL) AND WAS ESTABLISHED FROM DPGS TRANSFER FROM CHS BM 1-1967 ELEVATION 2.702m LOCATED AT ST. GEORGES, NL.

COORDINATES FOR HORIZONTAL CONTROL ARE GIVEN ON THE U.T.M. MAPPING PLANE, ZONE 21, USING THE NORTH AMERICAN DATUM OF 1983 (NAD83).

LEGEND

- 0.00 EXISTING GRADE ELEVATION
- INDICATES TREELINE
- TOP INDICATES EMBANKMENT SLOPE
- TOE

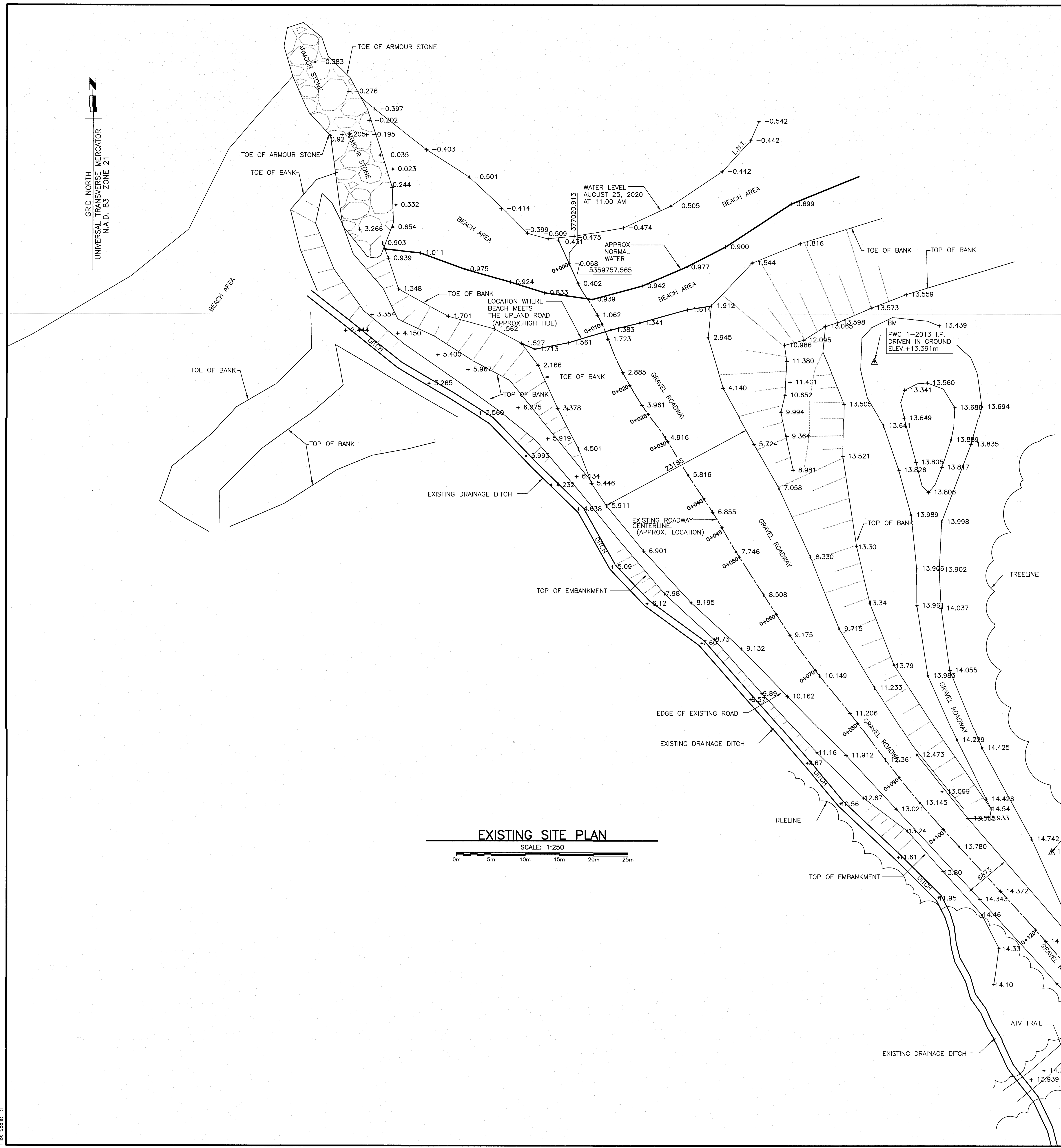

EXISTING SITE PLAN

SCALE: 1:250
 0m 5m 10m 15m 20m 25m

0	ISSUED FOR TENDER	21/01/21
revisions		date
project		project

UPLAND IMPROVEMENTS
 BANK HEAD COVE, NL

EXISTING SITE PLAN
 &
 TOPOGRAPHIC SURVEY

designed	W.J. ANDERSON	concep
date	JAN. 2021	
drawn	R.S.H	dessine
date	JAN. 2021	
approved		approuve
date		
Tender	Paul Curran	Soumission
DFD Project Manager		
project number	723439	no. du projet
drawing no.	1 OF 5	no. du dessin

SMALL CRAFT HARBOURS



PROVINCE OF NEWFOUNDLAND
PERMIT HOLDER
 This Permit Allows
 ANDERSON ENGINEERING CONSULTANTS LTD.
 To practice Professional Engineering
 in Newfoundland and Labrador.
 Permit No. as issued by APELON, R0092,
 which is valid for the year 2021.

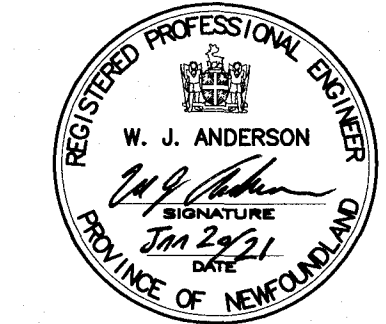

LEGEND

- 0.00 EXISTING GRADE ELEVATION
- 0.00 FINISHED GRADE ELEVATION
- INDICATES TREE LINE
- TOP INDICATES EMBANKMENT SLOPE
- TOE
- INDICATES AREA OF NEW EXCAVATION AND RE-GRADING / RESURFACING OF UPLAND AREA AND ACCESS
- INDICATES NEW PARKING AND LAY-DOWN AREA
- INDICATES NEW ROCK LINED DITCHING

- GENERAL NOTES:**
- ALL DIMENSIONS & ELEVATIONS IN MILLIMETERS.
 - ALL SOUNDINGS & ELEVATIONS IN METERS.
 - REFER TO SPEC. SECTION 31 23 33.01 EXCAVATING, TRENCHING AND BACKFILLING FOR THE EXCAVATION REMOVAL AND DISPOSAL OF THE EXISTING MATERIALS EXCAVATED FROM SITE UNDER THIS CONTRACT

HORIZONTAL CONTROL POINTS			
MARK	EASTING	NORTHING	ELEVATION
PWC 1-2013	377065.438	5359743.240	13.391
Ⓐ	377003.261	5359749.827	1.700
Ⓑ	377015.866	5359744.977	1.500
Ⓒ	377038.197	5359750.825	1.500
Ⓓ	377043.040	5359739.949	3.625
Ⓔ	377050.875	5359722.951	5.275
Ⓕ	377079.158	5359677.106	13.500
Ⓖ	377072.245	5359671.704	13.500
Ⓗ	377063.875	5359676.504	12.050
Ⓙ	377031.196	5359711.902	5.275
Ⓚ	377003.261	5359749.827	3.625

ADDITIONAL GPS CO-ORDINATES FOR ADDITIONAL SPOT LOCATIONS CAN BE PROVIDED BY DEPARTMENTAL REPRESENTATIVE UPON REQUEST FROM CONTRACTOR.

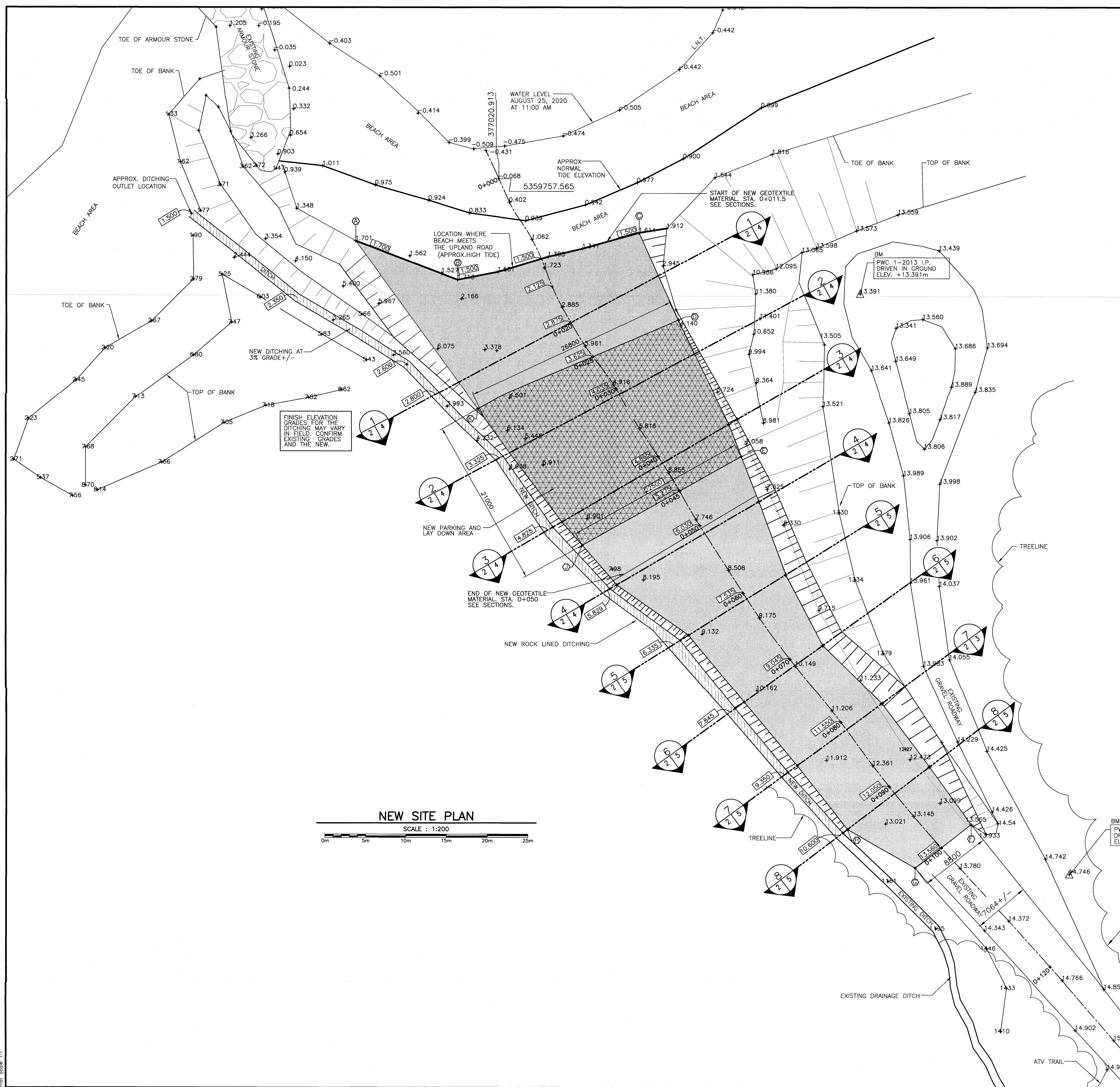

NEW SITE PLAN
 SCALE : 1:200
 0m 5m 10m 15m 20m 25m

0	ISSUED FOR TENDER	21/01/21
revisions		date
project		project

UPLAND IMPROVEMENTS BANK HEAD COVE, NL

NEW SITE PLAN

designed	W.J.ANDERSON	concu
date	JAN. 2021	
drawn	R.S.H	desine
date	JAN. 2021	
approved		approve
date		
Tender	<i>Paul Curran</i>	Submission
DFO Project Manager		
project number	723439	no. du projet
drawing no.	2 OF 5	no. du dessin

SMALL CRAFT HARBOURS



PROVINCE OF NEWFOUNDLAND
 PERMIT HOLDER
 ANDERSON ENGINEERING CONSULTANTS LTD.
 To practice Professional Engineering in Newfoundland and Labrador:
 Permit No. as issued by APECN 80092
 which is valid for the year 2021

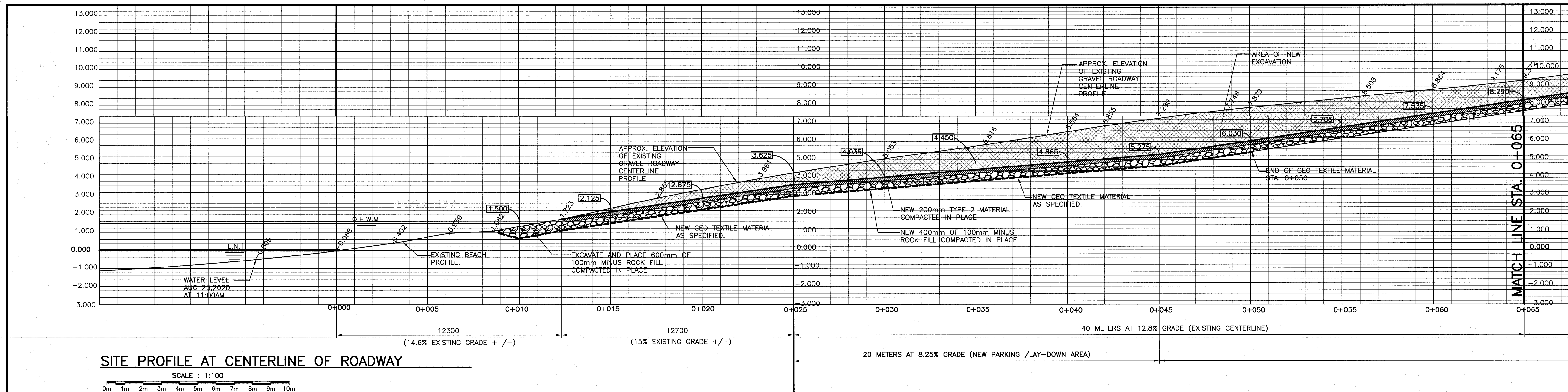
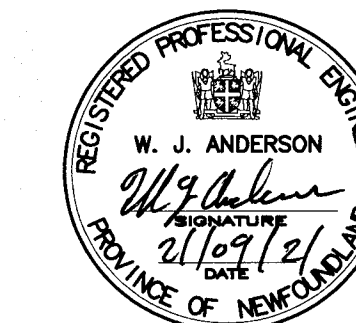

SITE PROFILE AT CENTERLINE OF ROADWAY

SCALE : 1:100
 0m 1m 2m 3m 4m 5m 6m 7m 8m 9m 10m

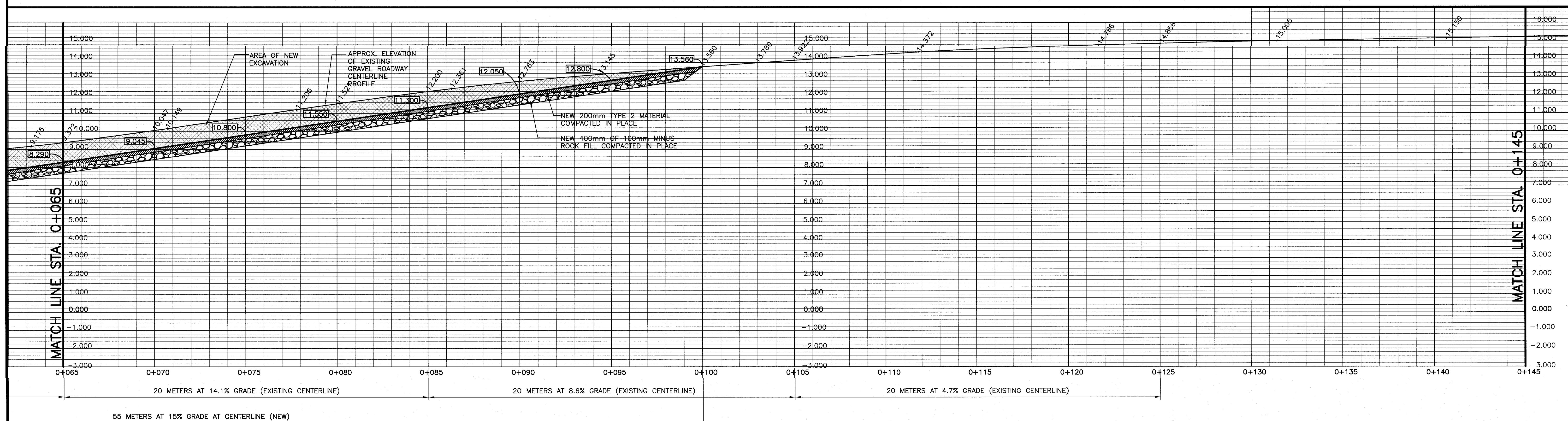

SITE PROFILE AT CENTERLINE OF ROADWAY

SCALE : 1:100
 0m 1m 2m 3m 4m 5m 6m 7m 8m 9m 10m

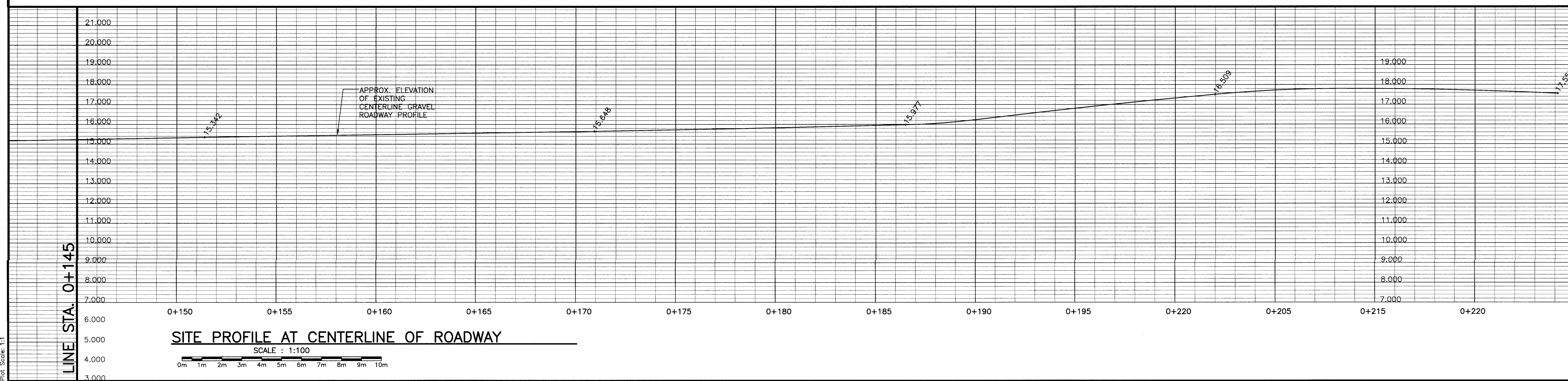

SITE PROFILE AT CENTERLINE OF ROADWAY

SCALE : 1:100
 0m 1m 2m 3m 4m 5m 6m 7m 8m 9m 10m

0	ISSUED FOR TENDER	21/01/21
revisions		date
project		project

UPLAND IMPROVEMENTS
 BANK HEAD COVE, NL

SITE PROFILE
 AT CENTERLINE
 OF ROADWAY

designed	W.J.ANDERSON	concu
date	JAN. 2021	
drown	R.S.H	dessine
date	JAN. 2021	
approved		approuve
date		
Tender	Paul Curran	Sourmission
DFD Project Manager		
project number	723439	no. du projet
drawing no.		no. du dessin

SMALL CRAFT HARBOURS



PROVINCE OF NEWFOUNDLAND
PERMIT HOLDER
 This Permit Allows
 ANDERSON ENGINEERING CONSULTANTS LTD.
 To practice Professional Engineering
 in Newfoundland and Labrador.
 Permit No. as issued by APELON 80092.
 which is valid for the year 2021.

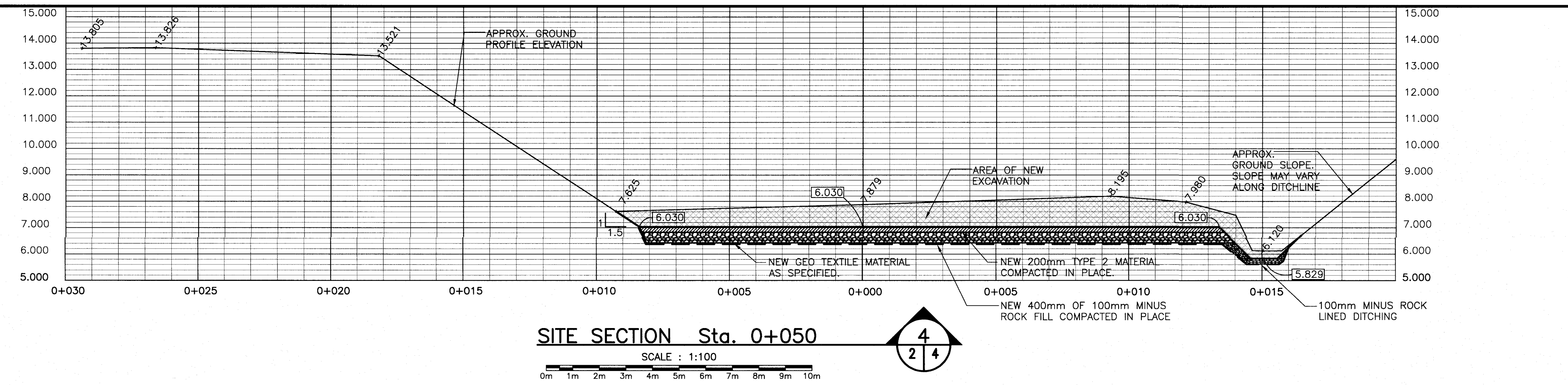
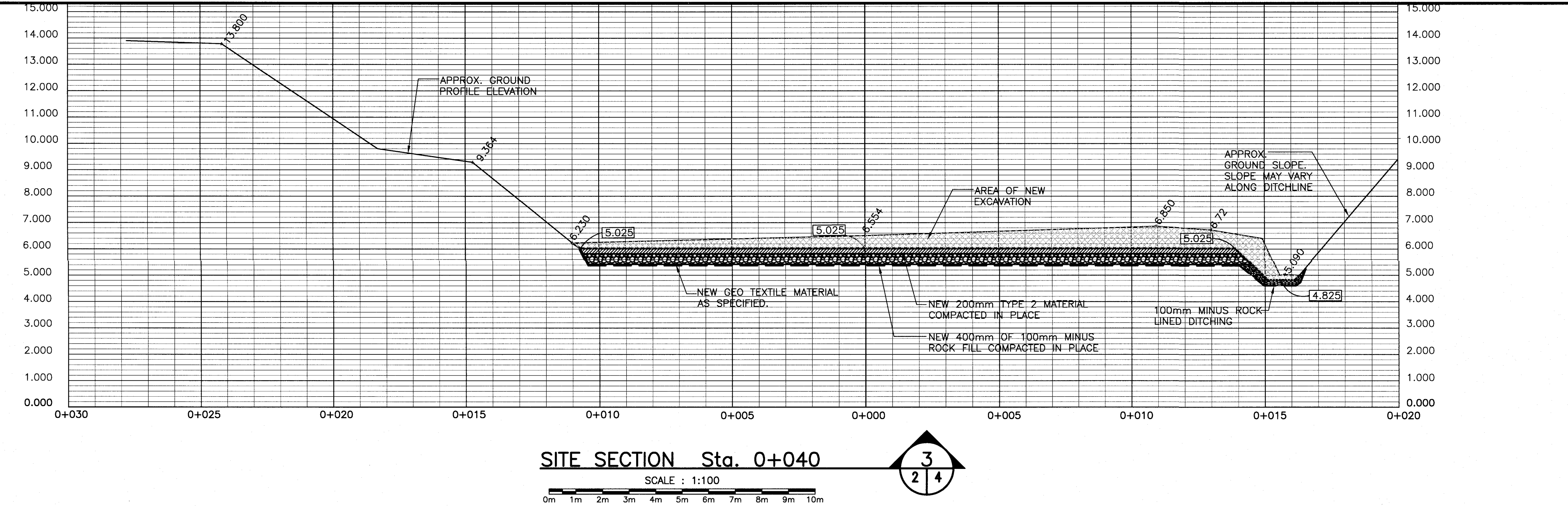
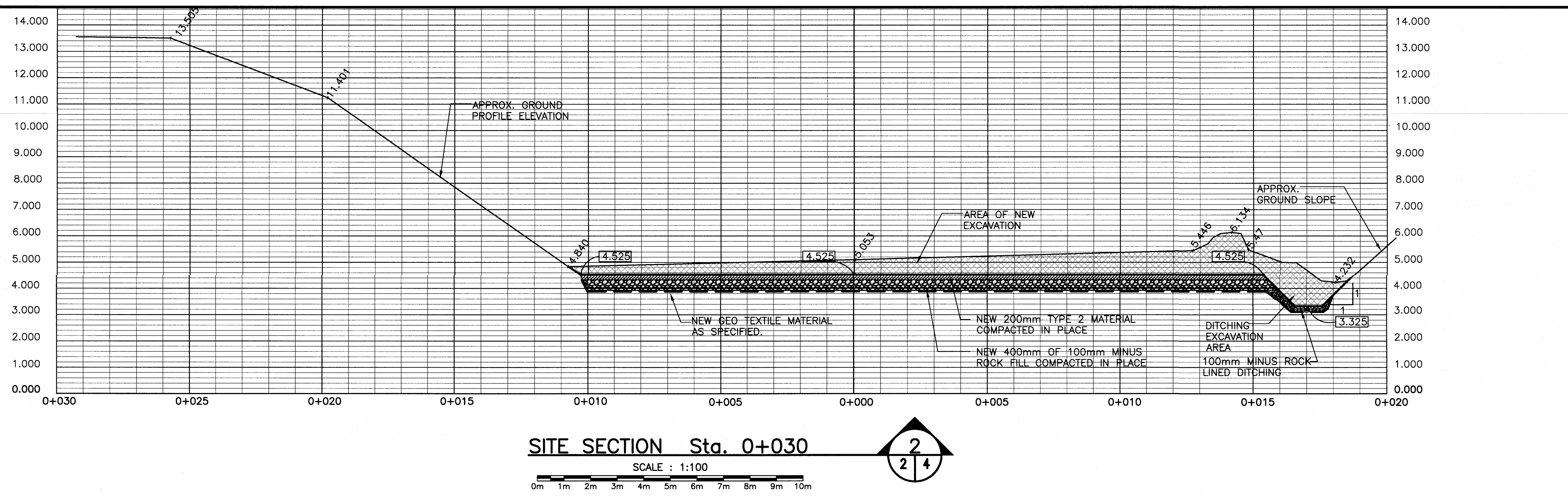
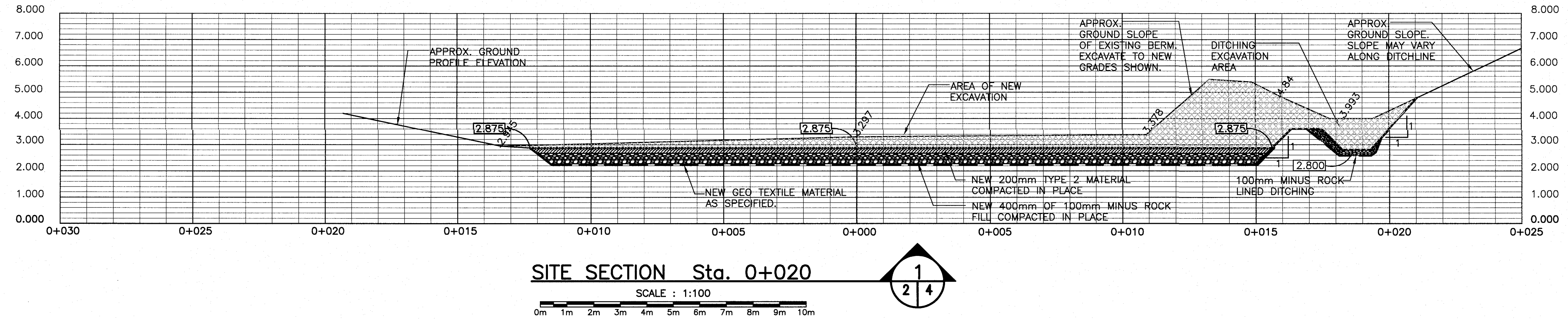
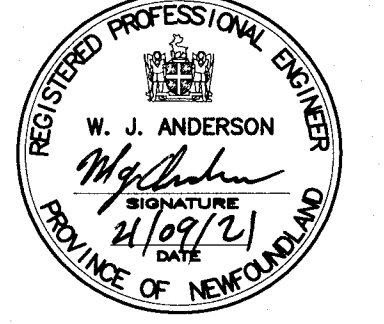

0	ISSUED FOR TENDER	21/09/21
revisions		date
project		project

UPLAND IMPROVEMENTS
 BANK HEAD COVE, NL

SITE SECTIONS

designed	W.J.ANDERSON	conçu
date	JAN. 2021	
drawn	R.S.H	dessiné
date	JAN. 2021	
approved		approuvé
date		
Tender	DFD Project Manager	Submission
project number	723439	no. du projet
drawing no.	4 OF 5	no. du dessin

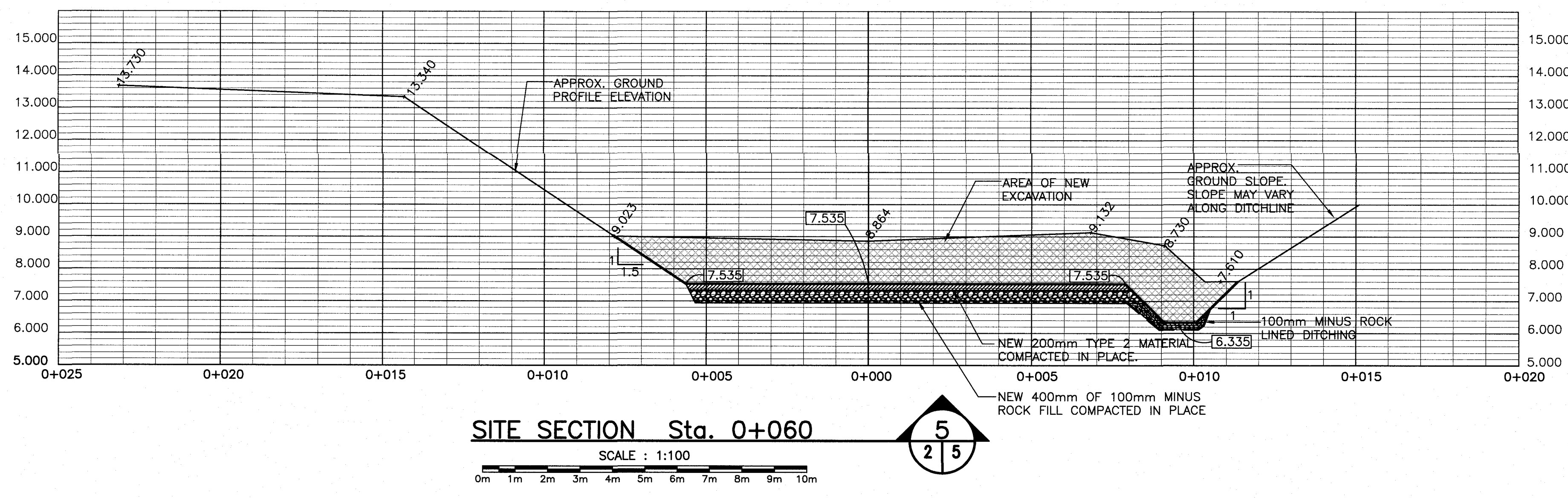

SITE SECTION Sta. 0+060

SCALE : 1:100

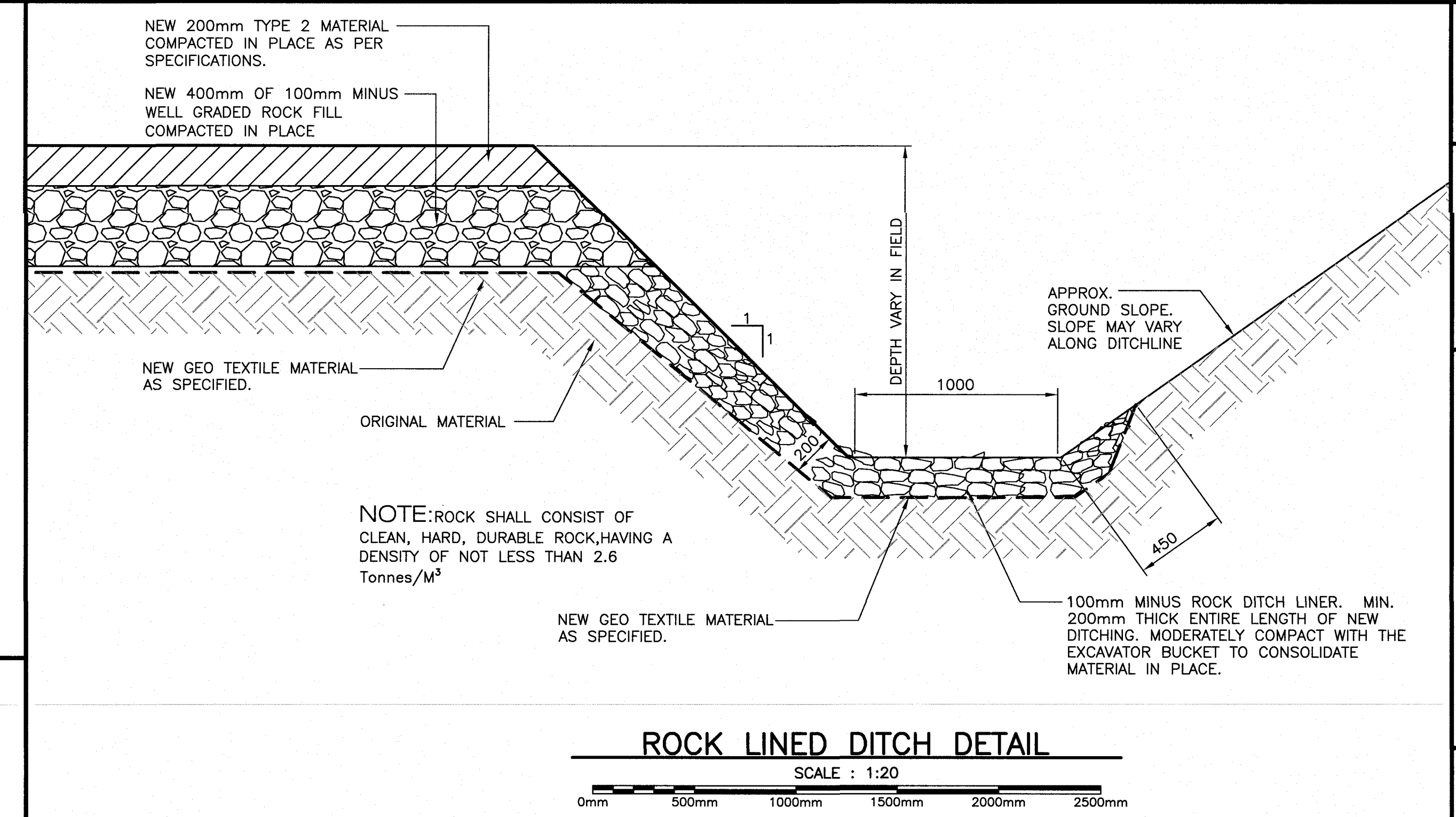
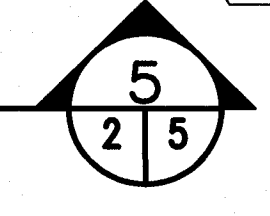

ROCK LINED DITCH DETAIL

SCALE : 1:20

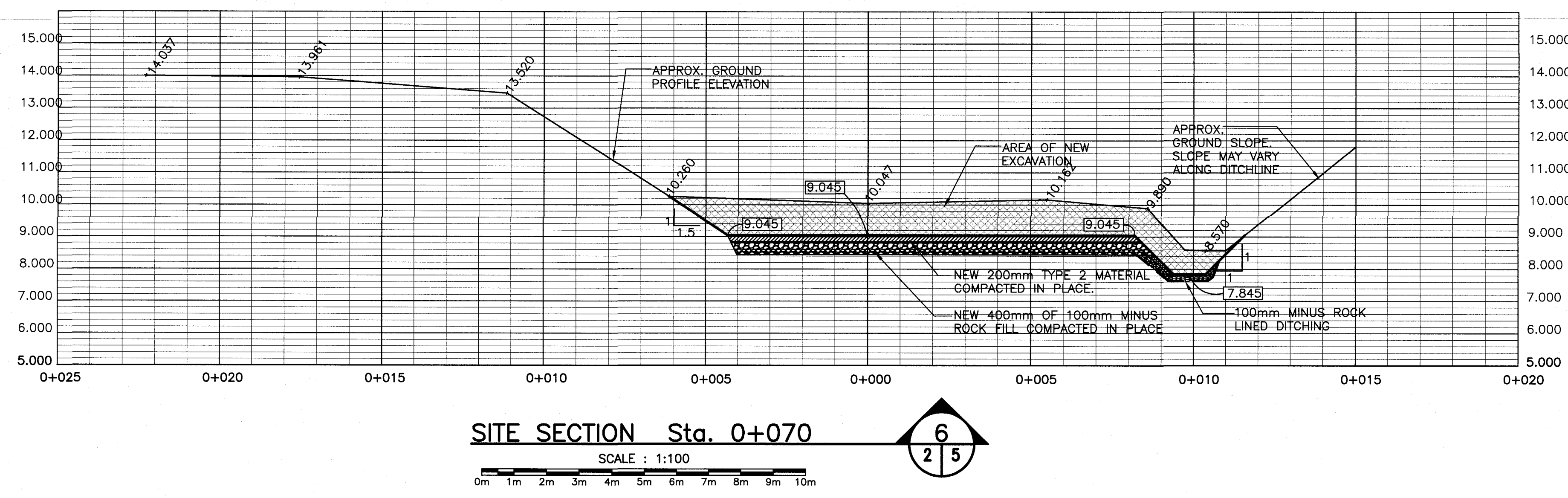

SITE SECTION Sta. 0+070

SCALE : 1:100

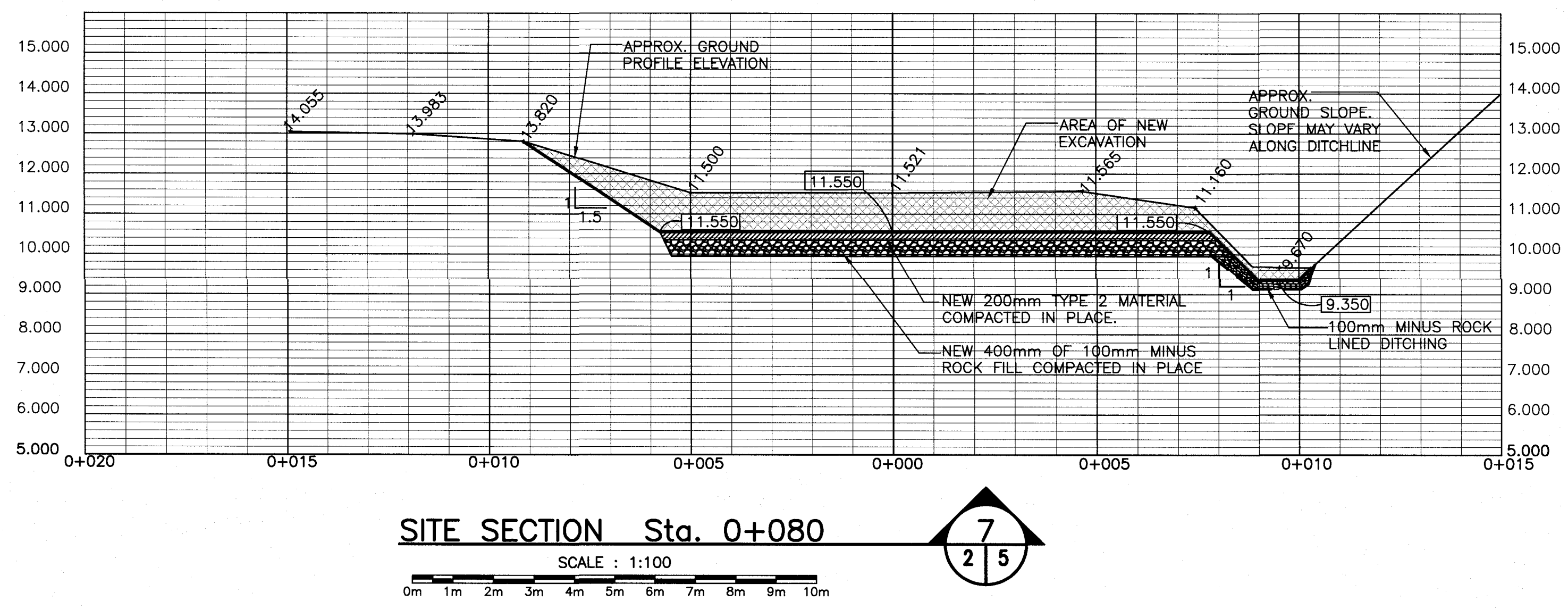
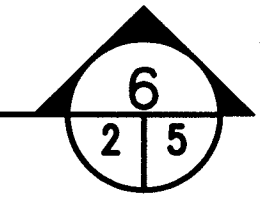

SITE SECTION Sta. 0+080

SCALE : 1:100

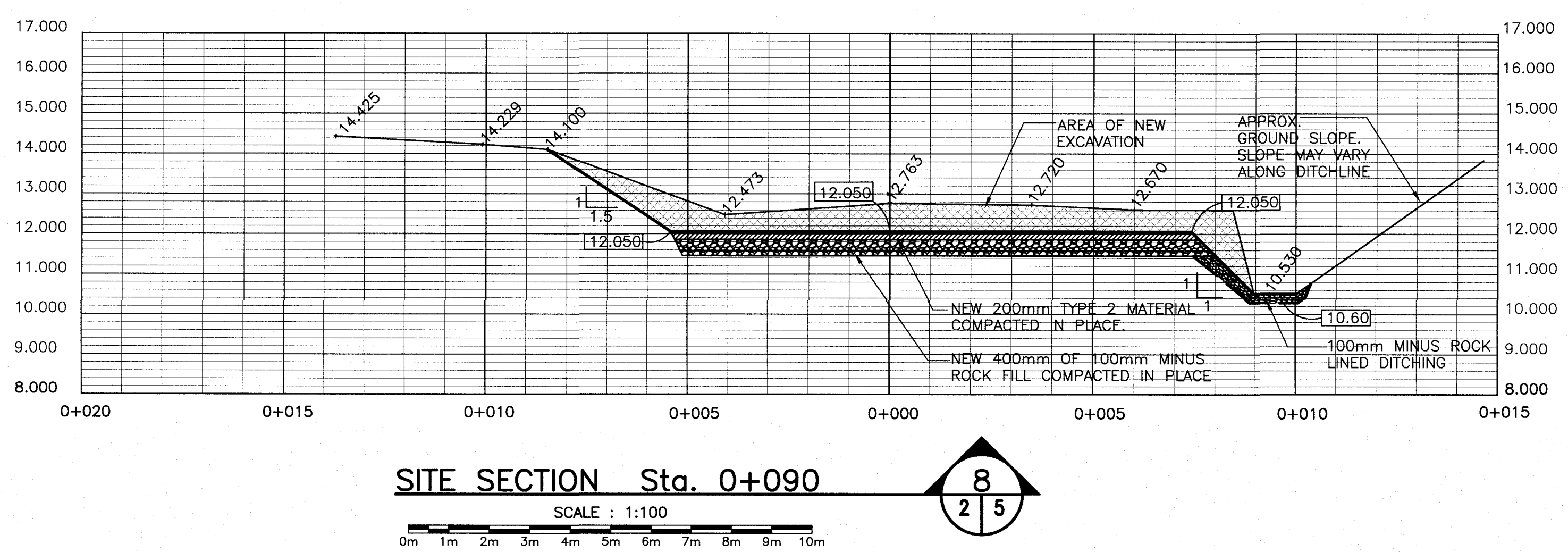
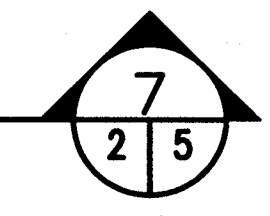

SITE SECTION Sta. 0+090

SCALE : 1:100

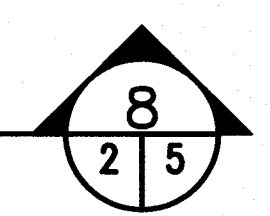

PROVINCE OF NEWFOUNDLAND
 PERMIT HOLDER
 This Permit Allows
 ANDERSON ENGINEERING CONSULTANTS LTD.
 To practice Professional Engineering
 in Newfoundland and Labrador.
 Permit No. as issued by APEGL, 80092,
 which is valid for the year 2021.

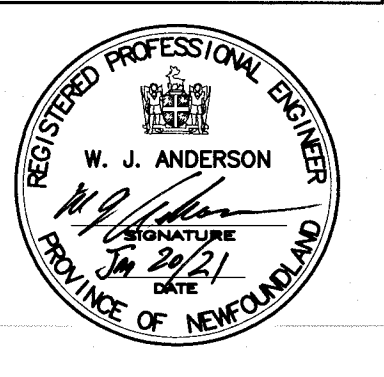

0	ISSUED FOR TENDER	21/01/21
revisions		date
project		project

UPLAND IMPROVEMENTS
 BANK HEAD COVE, NL

SITE SECTIONS

designed	W.J.ANDERSON	conçu
date	JAN. 2021	
drawn	R.S.H	dessiné
date	JAN. 2021	
approved		approuvé
date		
Tender	Paul Curran	Soumission
DFO Project Manager		
project number	723439	no. du projet
drawing no.	5 OF 5	no. du dessin