

PUBLIC SERVICES AND PROCUREMENT CANADA

Professional and Technical Services, Real Property Services Branch, Pacific Region

Alaska Hwy Km 325-355 & 520-555

Addendum 003

Paving and Miscellaneous Works

Project No. R.116050.001

2021-05-25

*Explanation of Addendum Presentation: Changes to the Specifications and Changes to the Contract Drawings sections of this Addendum have been presented as follows:*

- *New text has been underlined for ease of identification.*
- *Removed text has a “strikethrough” and is to be deleted from the text.*

**Changes to the Specifications:**

1. Section – Table of Contents

**Delete:**

List of Contract Drawings.

**Insert:**

List of Contract Drawings:

**LIST OF CONTRACT DRAWINGS**

No.	Title	Drawing Number	Revision Number
0	COVER PAGE	C0000	0
1	PROJECT LOCATION PLAN & DRAWING INDEX	C0001	2
2	KM 325 – 355: PROJECT KEY PLAN	C0002	1
3	KM 520 – 555: PROJECT KEY PLAN	C0003	1
4	LEGEND & CONTROL MONUMENT LOCATIONS	C0004	1
5	PLAN / PROFILE STA. 324+640 TO STA. 355+360	C1101 – C1147	0 / 1
6	PLAN / PROFILE STA. 519+700 TO STA. 555+160	C1201 – C1254	0 / 1 / <u>3</u>
7	TYPICAL SECTIONS – FULL DEPTH RECLAMATION	C1301	0
8	TYPICAL SECTIONS – KM 325 PAVEMENT SHOULDER WIDTH TRANSITION & STANDARD BARRIER FLARE TERMINAL	C1302	1

PUBLIC SERVICES AND PROCUREMENT CANADA

Professional and Technical Services, Real Property Services Branch, Pacific Region

Alaska Hwy Km 325-355 & 520-555  
 Paving and Miscellaneous Works  
 Project No. R.116050.001

Addendum 003  
 2021-05-25

9	ASPHALT PAVEMENT TIE-IN & TRANSITION DETAILS	C1303	0
10	PAINT MARKING DETAILS	C1304	1
11	ACCESS ROAD DETAILS	C1305	1
12	RUMBLE STRIP DETAILS	C1306	0
13	TYPICAL SECTIONS – FULL PAVEMENT RECONSTRUCTION	C1307	1
<u>14</u>	<u>TYPICAL SECTIONS – TRENCHLESS CULVERT INSTALLATION</u>	<u>C1308 – C1309</u>	<u>3</u>
15	KM 365 REST STOP PLAN / PROFILE	C1401	2
16	KM 365 REST STOP TYPICAL SECTION	C1402	2
17	KM 365 REST STOP CROSS SECTIONS	C1403-C1404	2
18	KM 375 REST STOP PLAN & TYPICAL SECTION	C1411	2
19	KM 375 REST STOP CROSS SECTIONS	C1412	2
20	KM 380 REST STOP PLAN & TYPICAL SECTION	C1421	2
21	KM 380 REST STOP CROSS SECTIONS	C1422	2
22	KM 419 REST STOP PLAN / PROFILE	C1431	2
23	KM 419 REST STOP TYPICAL SECTION	C1432	2
24	KM 419 REST STOP CROSS SECTIONS	C1433 – C1435	2
25	KM 525.4 CHAIN UP AREA PLAN / PROFILE	C1501	1
26	KM 525.4 CHAIN UP AREA TYPICAL SECTIONS	C1502	1
27	KM 525.4 CHAIN UP AREA CROSS SECTIONS	C1503 – C1505	1
28	KM 533.1 REST STOP PLAN / TYPICAL SECTION	C1511	1
29	KM 533.1 REST STOP CROSS SECTIONS	C1512 – C1513	1
30	KM 535.2 REST STOP DECOMMISSIONING PLAN	C1521	1

PUBLIC SERVICES AND PROCUREMENT CANADA

Professional and Technical Services, Real Property Services Branch, Pacific Region

Alaska Hwy Km 325-355 & 520-555  
Paving and Miscellaneous Works  
Project No. R.116050.001

Addendum 003  
2021-05-25

31	KM 536.3 STEAMBOAT INTERSECTION AND CHAIN UP AREA HIGHWAY LANING AND GEOMETRICS AND SIGNAGE PLAN	C1531	2
32	KM 536.3 STEAMBOAT INTERSECTION AND CHAIN UP AREA CHAIN UP AREA AND DITCHING GRADING PLAN	C1532	2
33	KM 536.3 STEAMBOAT INTERSECTION AND CHAIN UP AREA TYPICAL SECTIONS	C1533 – C1535	2
34	KM 536.3 STEAMBOAT INTERSECTION AND CHAIN UP AREA CROSS SECTIONS	C1536 – C1548	2
35	KM 545 EMBANKMENT BORROW AREA PLAN	C1551	1
36	KM 545 EMBANKMENT BORROW AREA TYPICAL SECTION AND DETAIL	C1552	1
37	KM 545 EMBANKMENT BORROW AREA CROSS SECTIONS	C1553-C1555	1
38	KM 546.8 CHAIN UP AREA PLAN / PROFILE	C1561	1
39	KM 546.8 CHAIN UP AREA TYPICAL SECTION AND DETAIL	C1562	1
40	KM 546.8 CHAIN UP AREA TYPICAL SECTIONS	C1563	1
41	KM 546.8 CHAIN UP AREA CROSS SECTIONS	C1564 – C1566	1
42	KM 326.86 – KM 327.11 DITCH AND SLOPE RECONSTRUCTION PLAN / TYPICAL SECTION	C1601	1
43	KM 326.86 – KM 327.11 DITCH AND SLOPE RECONSTRUCTION CROSS SECTIONS	C1602 – C1604	1
44	KM 346 – KM 348 TREE CLEARING, DITCH, AND SLOPE RE-ESTABLISHMENT PLAN STA. 346+415 TO 348+190	C1611 – C1613	1
45	KM 346 – KM 348 TREE CLEARING, DITCH, AND SLOPE RE-ESTABLISHMENT TYPICAL SECTIONS	C1614	1
46	KM 346 – KM 348 TREE CLEARING, DITCH, AND SLOPE RE-ESTABLISHMENT CROSS SECTIONS	C1615 – C1618	1

PUBLIC SERVICES AND PROCUREMENT CANADA

Professional and Technical Services, Real Property Services Branch, Pacific Region

Alaska Hwy Km 325-355 & 520-555  
Paving and Miscellaneous Works  
Project No. R.116050.001

Addendum 003  
2021-05-25

47	KM 353.66 EMBANKMENT RECONSTRUCTION PLAN / TYPICAL SECTION	C1621	1
48	KM 354.0 – KM 354.6 DITCH RE-ESTABLISHMENT PLAN / TYPICAL SECTION	C1631	1
49	KM 354.0 – KM 354.6 DITCH RE-ESTABLISHMENT CROSS SECTIONS	C1632 – C1633	1
50	KM 528.2 SAG CURVE RECONSTRUCTION PLAN / PROFILE	C1701	1
51	KM 528.2 SAG CURVE RECONSTRUCTION TYPICAL SECTION	C1702	1
52	KM 528.2 SAG CURVE RECONSTRUCTION CROSS SECTIONS	C1703 – C1706	1
53	KM 545.3 SLOPE RECONSTRUCTION PLAN	C1711	1
54	KM 545.3 SLOPE RECONSTRUCTION TYPICAL SECTIONS AND DETAILS	C1712	1
55	KM 545.3 SLOPE RECONSTRUCTION CROSS SECTIONS	C1713 – C1716	1
56	KM 534.43 CULVERT PLAN / PROFILE / TYPICAL	C1801	1
57	KM 534.43 CULVERT CROSS SECTIONS	C1802	1
58	KM 546.7 CULVERT PLAN / PROFILE	C1811	1
59	KM 546.7 CULVERT TYPICAL SECTIONS	C1812	1
60	KM 546.7 CULVERT CROSS SECTIONS	C1813 – C1814	1

2. Section 10 14 53 – Signage

**Insert:**

2.2 – Km 536.3 Chain Up Area Signs:

2.2.1 The signposts shall be 6” × 4” pressure treated Douglas Fir / Larch, No. 1 Grade. Posts shall be straight, free of cracks and supplied in complete lengths without any

PUBLIC SERVICES AND PROCUREMENT CANADA

Professional and Technical Services, Real Property Services Branch, Pacific Region

Alaska Hwy Km 325-355 & 520-555

Addendum 003

Paving and Miscellaneous Works

Project No. R.116050.001

2021-05-25

splices.

3. Section 33 42 13 – Pipe Culverts

**Delete:**

1.1 – General:

- .1 The installation of the 800 mm diameter culvert replacements at the accesses of the Km 525.4 Chain Up Area and the Km 546.8 Chain Up Area, the 600 mm diameter culvert extensions at Km 534.43, the 600 mm diameter culvert at the Km 545.3 Slope Reconstruction, the 600 mm / 800 mm diameter culvert extension at the Km 546.8 Chain Up Area shall be installed by the Contractor using the open cut method. The Steel Pipe Culvert shall be installed by excavation, partial removal/disposal of existing culvert to facilitate new culvert install, placement of new culvert, followed by backfill and compaction as per Part 1, Part 2a or Part 2b (refer to the Contract Drawings for the type of culvert to be installed at the proposed location), and Part 3a of this specifications.

**Insert:**

1.1 – General:

- .1 The installation of the 800 mm diameter culvert replacements at the accesses of the Km 525.4 Chain Up Area and the Km 546.8 Chain Up Area, the 600 mm diameter culvert extensions at Km 534.43, the 600 mm diameter culvert at the Km 545.3 Slope Reconstruction, the 600 mm / 800 mm diameter culvert extension at the Km 546.8 Chain Up Area, the 600 mm diameter culvert at the Km 536.3 Steamboat Intersection and Chain Up Area and the 900 mm diameter culvert at Km 419 Rest Stop shall be installed by the Contractor using the open cut method. The Steel Pipe Culvert shall be installed by excavation, partial removal/disposal of existing culvert to facilitate new culvert install, placement of new culvert, followed by backfill and compaction as per Part 1, Part 2a or Part 2b (refer to the Contract Drawings for the type of culvert to be installed at the proposed location), and Part 3a of this specifications.

**Changes to the Contract Drawings**

**Replace:**

Sheet C1217 – Plan / Profile Sta. 530+280 to Sta. 530+920 – Rev 3 – Issued for Amendment 003 – Dated: 21/05/25

PUBLIC SERVICES AND PROCUREMENT CANADA

Professional and Technical Services, Real Property Services Branch, Pacific Region

Alaska Hwy Km 325-355 & 520-555

Addendum 003

Paving and Miscellaneous Works

Project No. R.116050.001

2021-05-25

---

**Insert:**

Sheet C1308 – Typical Sections – Trenchless Culvert Installation – Rev 3 – Issued for Amendment 003 – Dated: 21/05/25

Sheet C1309 – Typical Sections – Trenchless Culvert Installation – Rev 3 – Issued for Amendment 003 – Dated: 21/05/25

**All other terms and conditions remain unchanged.**

**ISSUED FOR AMENDMENT 003**

**GENERAL NOTES:**  
 1. DIMENSIONS, COORDINATES, ELEVATIONS ARE IN METRES UNLESS NOTED OTHERWISE  
 2. THE CONTRACTOR IS RESPONSIBLE FOR VERIFYING THE LOCATION OF ALL UTILITIES PRIOR TO CONSTRUCTION

**LEGEND**  
 (PROFILE / SUPERELEVATION)  
 NC = NORMAL CROWN  
 LC = LEVEL CROWN  
 RC = REVERSE CROWN  
 FS = FULL SUPERELEVATION

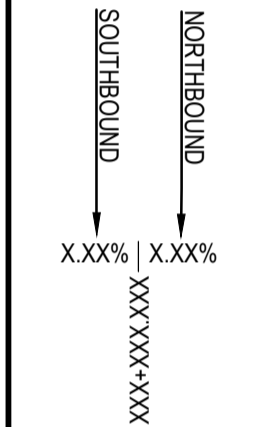

0 50  
 Horiz. Scale: 1: 1000 (metres)  
 0 5  
 Vert. Scale: 1: 100 (metres)

3	ISSUED FOR AMENDMENT 003	21/05/25
1	ISSUED FOR AMENDMENT 001	21/05/11
0	ISSUED FOR TENDER	21/02/12

Client/client  
**Public Services and Procurement Canada**

**TETRA TECH**  
 Project title/Titre du projet  
**KM 325 - 355 & KM 520 - 555  
 PAVEMENT REPLACEMENT &  
 MISCELLANEOUS WORKS  
 ALASKA HIGHWAY, BC**

Approved by/Approve par  
**S.LI**  
 Designed by/Concept par  
**A.DEEPWELL / C.ERIKS / H.ONG**  
 Drawn by/Dessine par  
**A.DEEPWELL / H.ONG**

PSPC Project Manager/Administrateur de Projets TPSGC  
**A.TAHERI**  
 PSPC, Architectural and Engineering Resources Manager/  
 Ressources Architectural et de Directeur d'ingénierie, TPSGC

Client/client  
**PUBLIC SERVICES AND PROCUREMENT CANADA**

Drawing title/Titre du dessin  
**PLAN / PROFILE  
 STA. 530+260 TO STA. 530+920**

Project No./No. du projet <b>R.116050.001</b>	Sheet/Feuille <b>C1217</b> OF	Revision no./ La Révision no. <b>3</b>
--	-------------------------------------	--

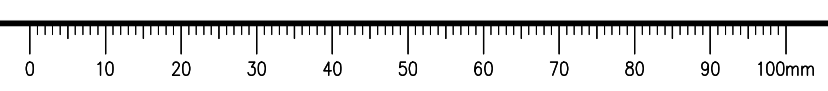
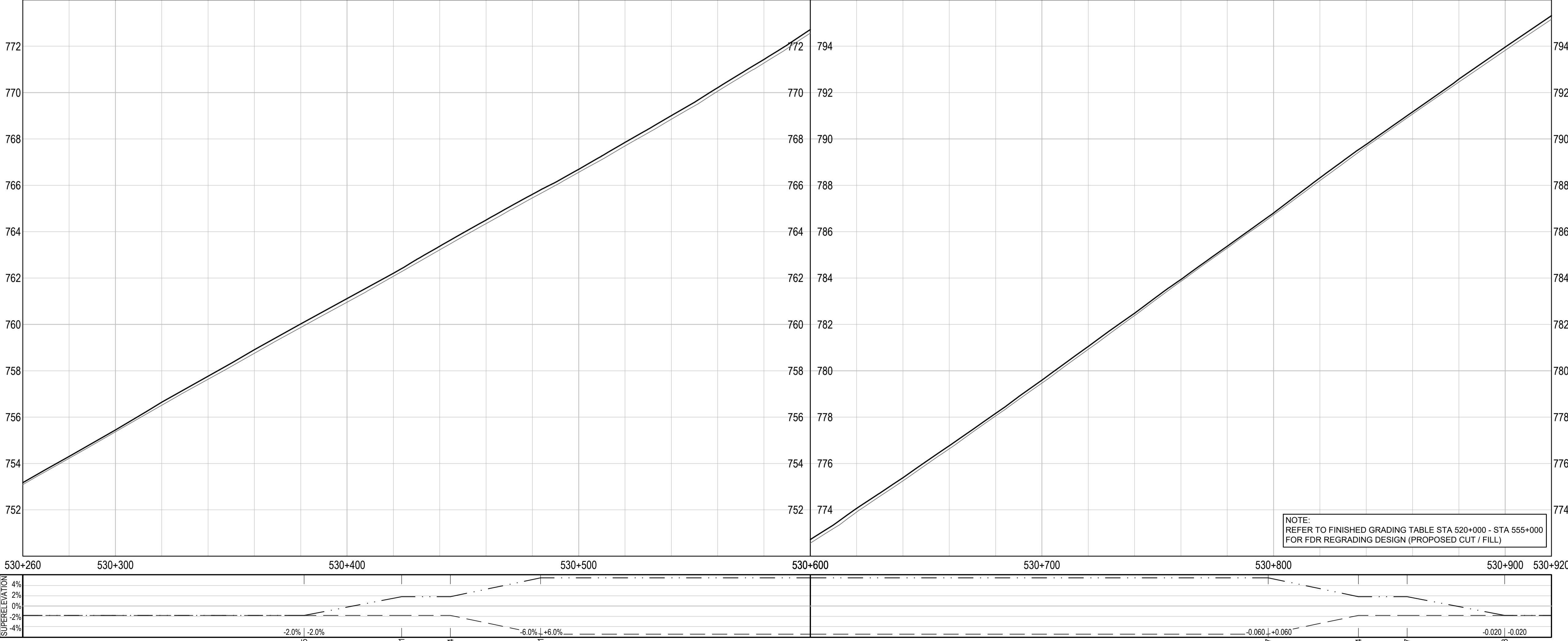
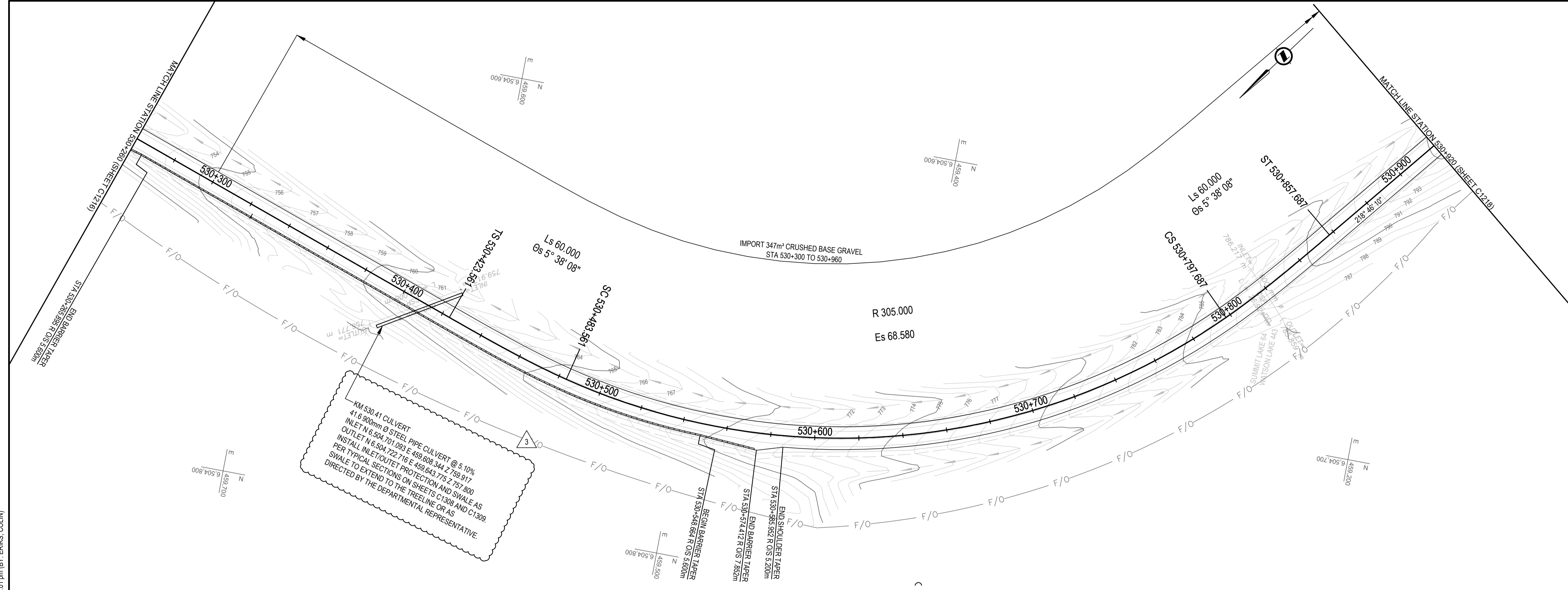

Q:\Vancouver\Transportation\TRN\HWY03164 Alaska Highway Paving Km 325 - 355 & Km 520 - 555\CAD\Sheets KM 325-355 & Km 520 - 555\CAD\Sheets KM 325-355 & Km 520 - 555\CAD\Profiles.dwg [C1217] May 25, 2021 - 5:04:01 pm [BY: ERIKS, COULIN]



**ISSUED FOR AMENDMENT 003**

- GENERAL NOTES:  
 1. DIMENSIONS, COORDINATES, ELEVATIONS ARE IN METRES UNLESS NOTED OTHERWISE  
 2. THE CONTRACTOR IS RESPONSIBLE FOR VERIFYING THE LOCATION OF ALL UTILITIES PRIOR TO CONSTRUCTION

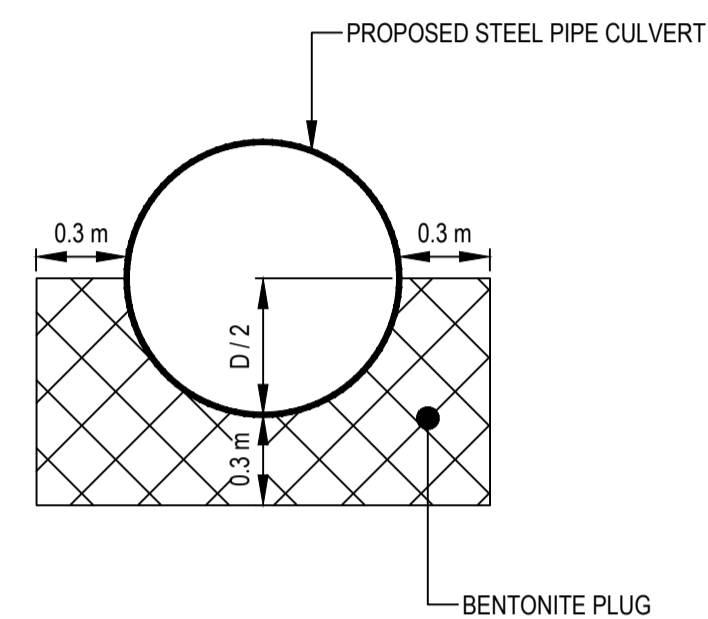

**TYPICAL BENTONITE PLACEMENT (INLET ONLY)**  
**TRENCHLESS CULVERTS**  
 SCALE 1:25

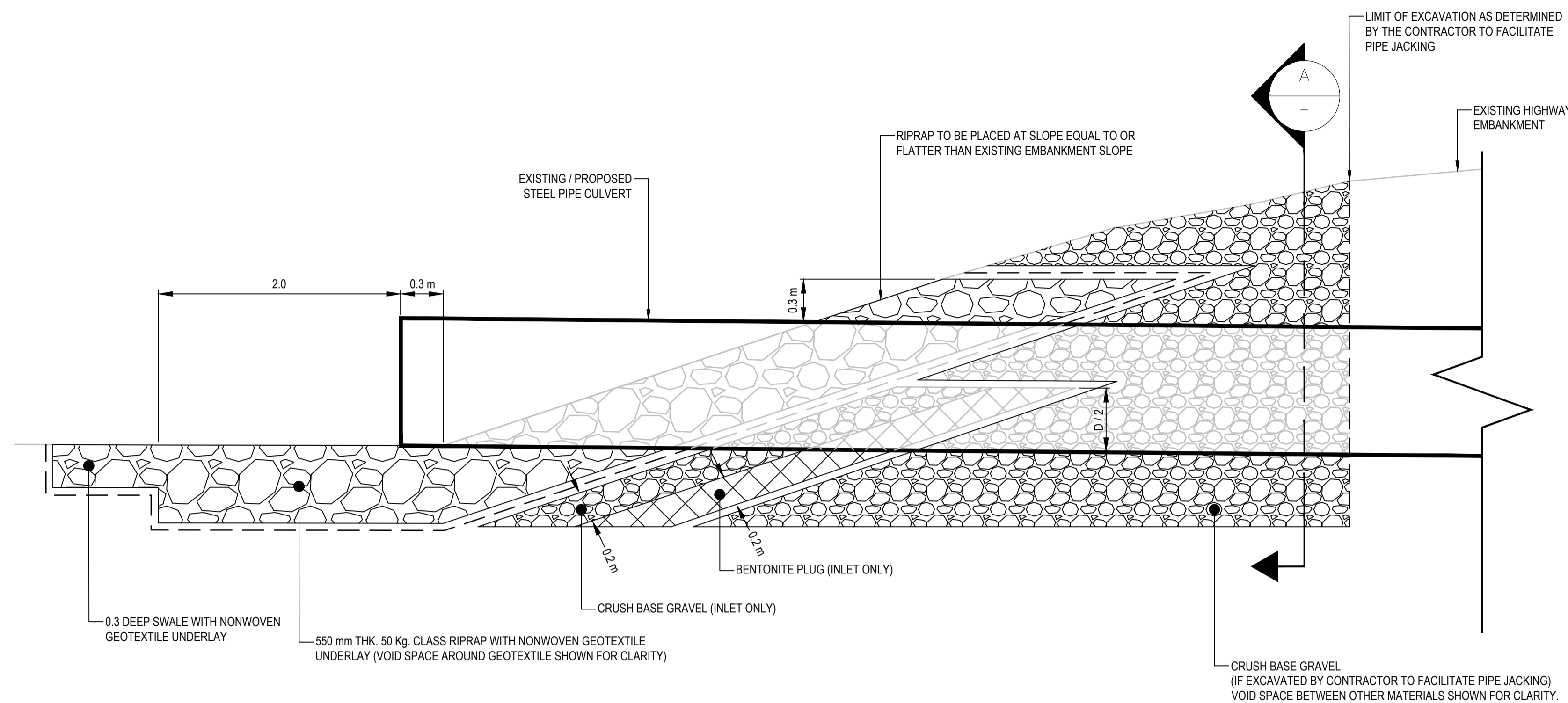

**TYPICAL CULVERT INLET / OUTLET DETAIL FOR**  
**TRENCHLESS INSTALLATION**  
 SCALE 1:25

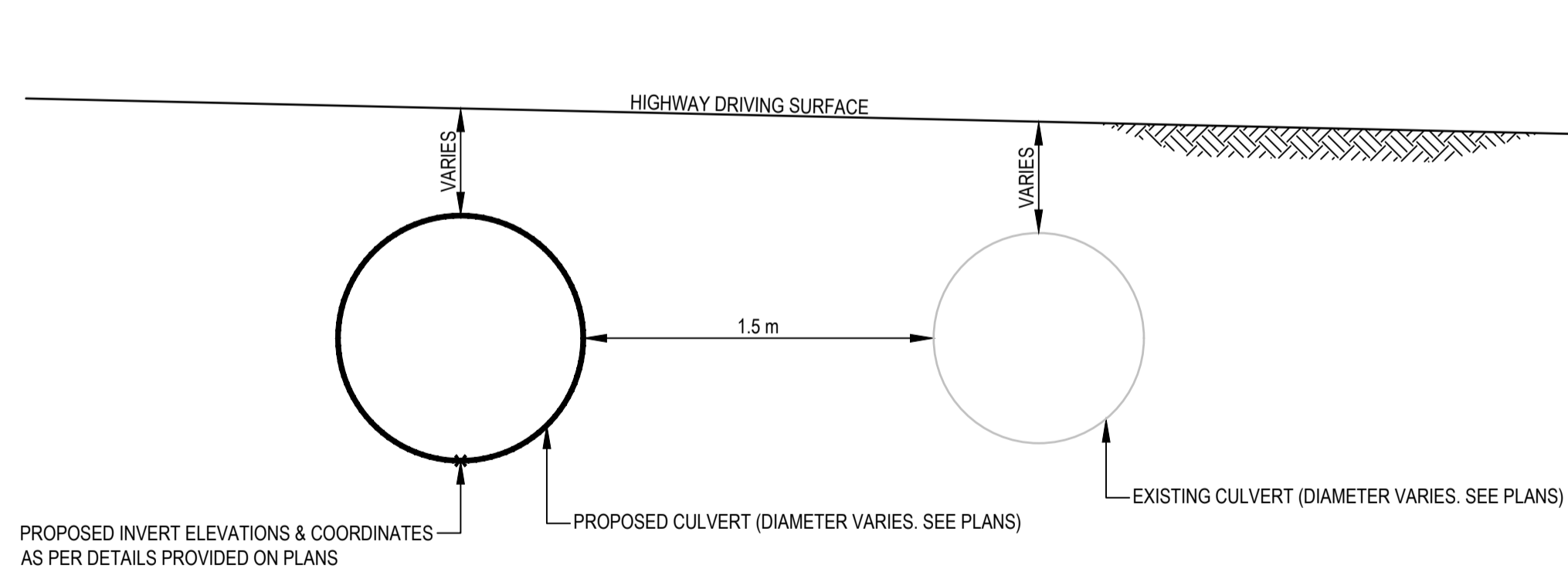

**TYPICAL PROPOSED CULVERT LOCATION SECTION**  
**TRENCHLESS CULVERTS**  
 SCALE 1:25

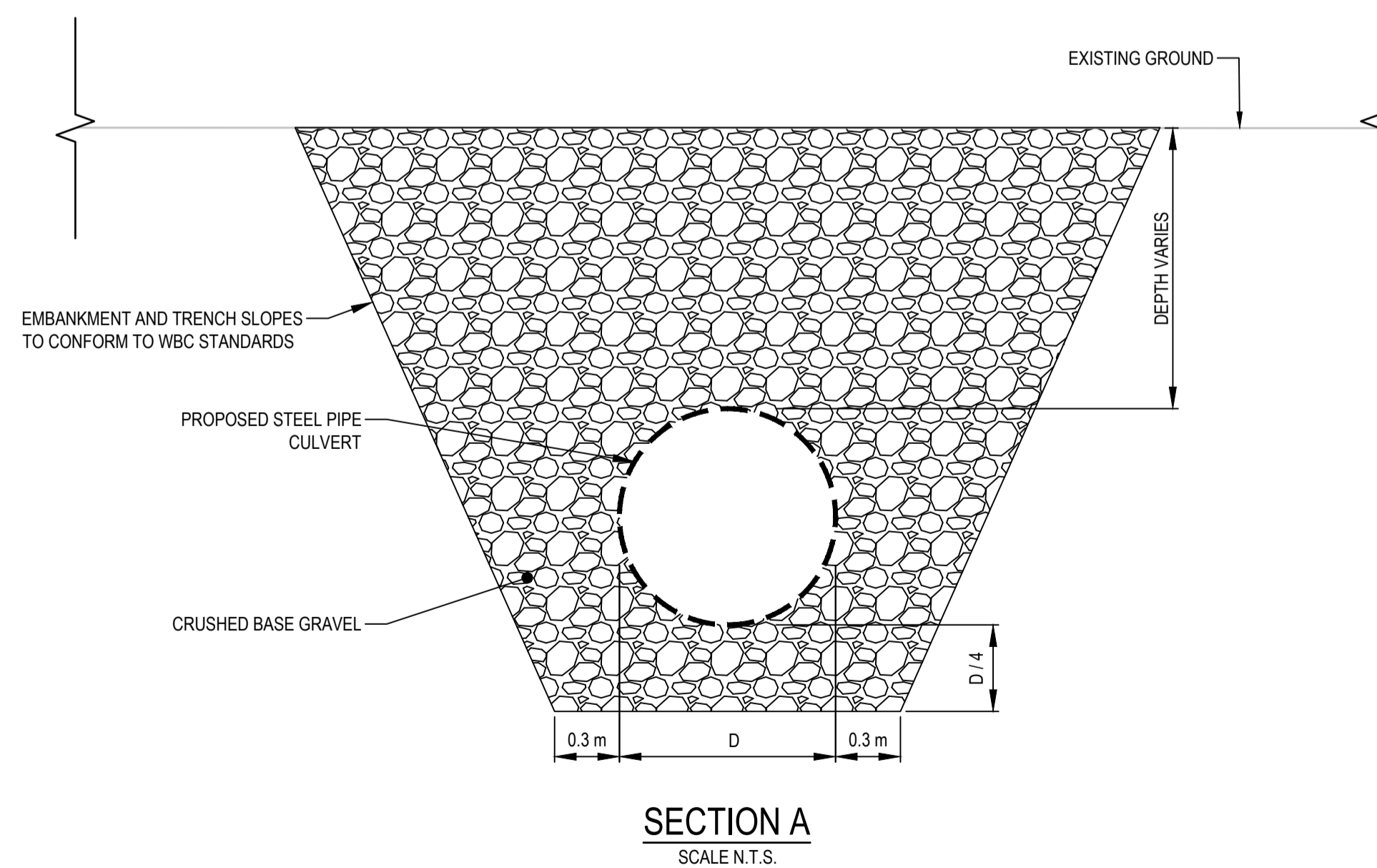

**SECTION A**  
 SCALE N.T.S.

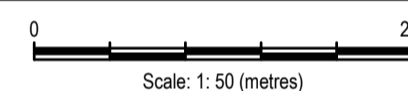

Revision/Description	Date/Date
3 ISSUED FOR AMENDMENT 003	21/05/25

Client/client: **Public Services and Procurement Canada**



Project title/Titre du projet:  
**KM 325 - 355 & KM 520 - 555 PAVEMENT REPLACEMENT & MISCELLANEOUS WORKS ALASKA HIGHWAY, BC**

Approved by/Approuvé par:  
**S.L.I.**  
 Designed by/Concepté par:  
**A.DEEPWELL / C.ERIKS / H.ONG**  
 Drawn by/Dessiné par:  
**A.DEEPWELL / H.ONG**  
 PSPC Project Manager/Administrateur de Projets TPSGC:  
**A.TAHERI**  
 PSPC Architectural and Engineering Resources Manager/Ressources Architectural et de Directeur d'Ingénierie, TPSGC:  
 Client/client:  
**PUBLIC SERVICES AND PROCUREMENT CANADA**

**TYPICAL SECTIONS - TRENCHLESS CULVERT INSTALLATION**

Project No./No. du projet	Sheet/Feuille	Revision no./La Révision no.
R.116050.001	C1308	3

Q:\Vancouver\Transportation\TRN\VHWY\Projects\TRN\VHWY\Projects\CAD\Drawings\C1308\C1307 TYPICAL ROADWAY SECTIONS & DETAILS.dwg [C:1308] May 25, 2021 - 4:38:13 pm (BY: ERIKS, COLIN)

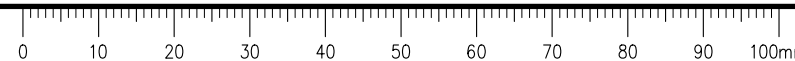



**ISSUED FOR AMENDMENT 003**

- GENERAL NOTES:  
 1. DIMENSIONS, COORDINATES, ELEVATIONS ARE IN METRES UNLESS NOTED OTHERWISE  
 2. THE CONTRACTOR IS RESPONSIBLE FOR VERIFYING THE LOCATION OF ALL UTILITIES PRIOR TO CONSTRUCTION

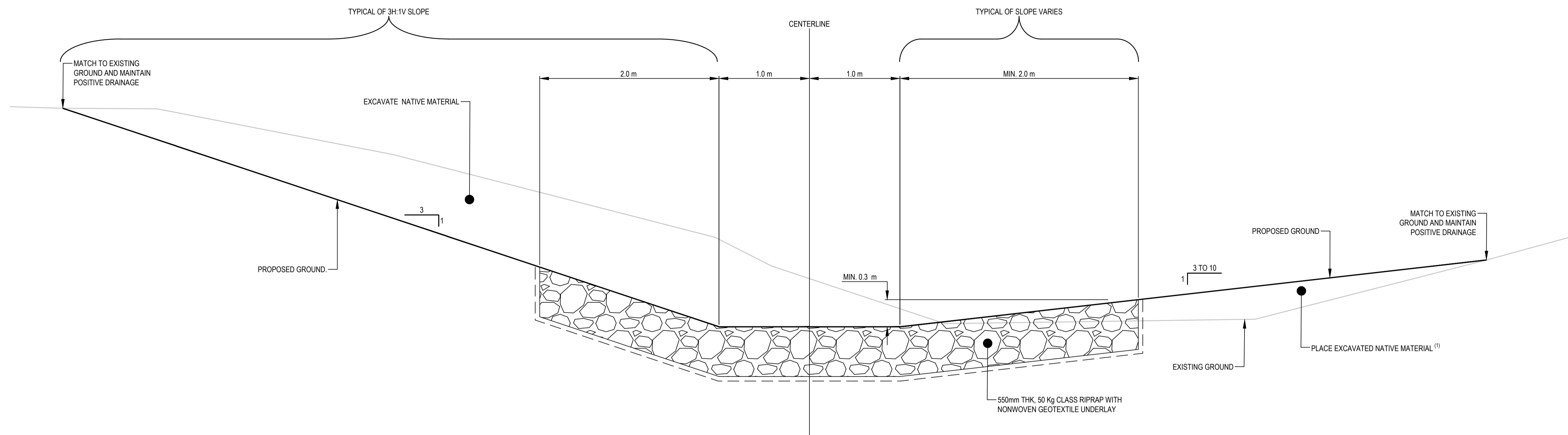

**TYPICAL SECTION - CHANNEL WITH RIPRAP**  
SCALE 1:25

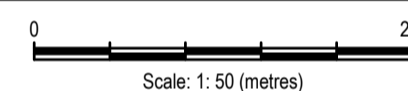

Revision/Revisión	Description/Description	Date/Date
3	ISSUED FOR AMENDMENT 003	21/05/25

Public Services and Procurement Canada



Project title/Titre du projet  
**KM 325 - 355 & KM 520 - 555 PAVEMENT REPLACEMENT & MISCELLANEOUS WORKS ALASKA HIGHWAY, BC**

Approved by/Approuvé par  
**S.LI**

Designed by/Concept par  
**A.DEEPWELL / C.ERIKS / H.ONG**

Drawn by/Dessiné par  
**A.DEEPWELL / H.ONG**

PSPC Project Manager/Administrateur de Projets TPSGC  
**A.TAHERI**

PSPC Architectural and Engineering Resources Manager/Ressources Architectural et de Directeur d'Ingénierie, TPSGC

Client/client  
**PUBLIC SERVICES AND PROCUREMENT CANADA**

Drawing title/Titre du dessin

**TYPICAL SECTIONS - TRENCHLESS CULVERT INSTALLATION**

Project No./No. du projet	Sheet/Feuille	Revision no./La Révision no.
<b>R.116050.001</b>	<b>C1309</b>	<b>3</b>

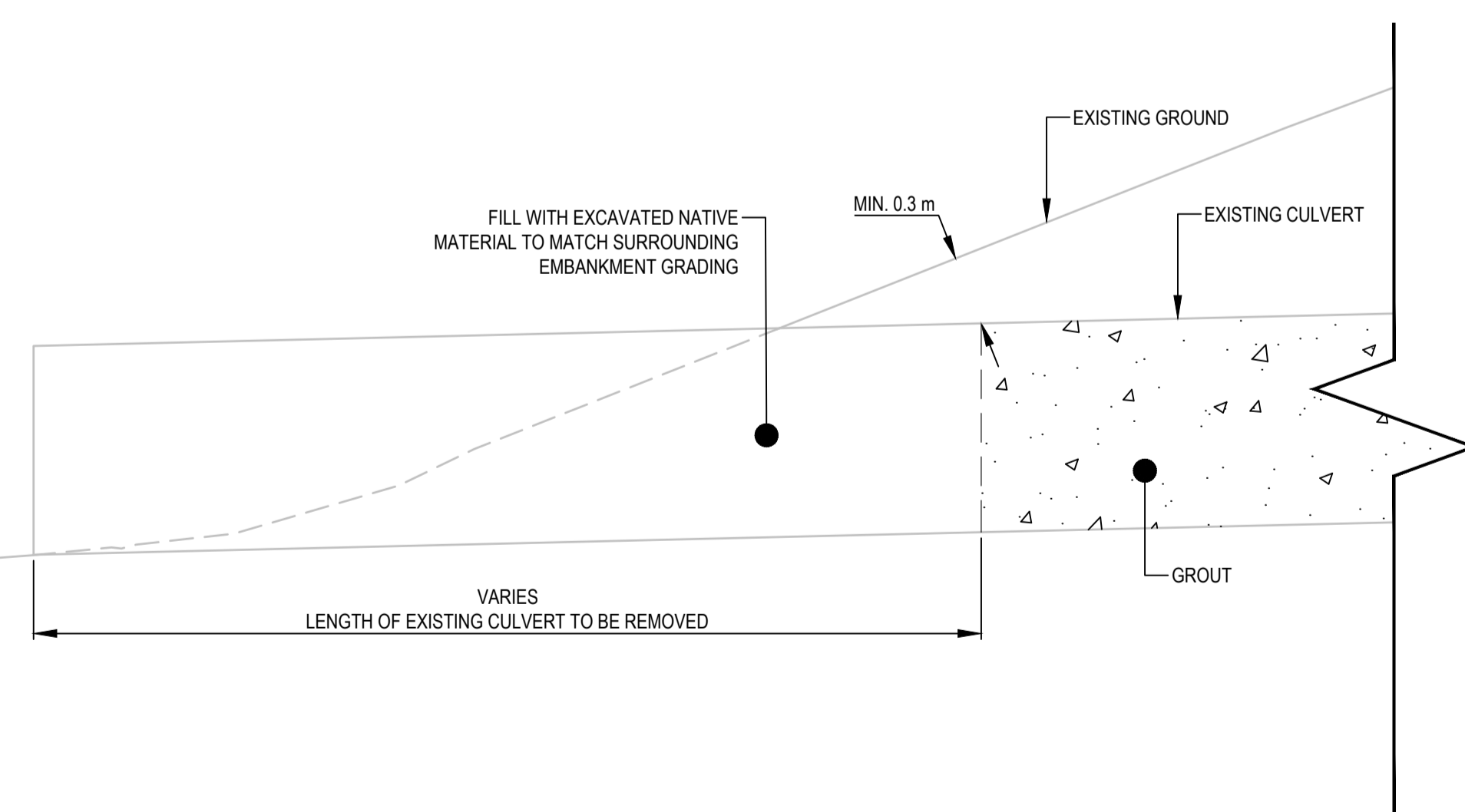

**TYPICAL DETAIL - DECOMMISSIONING OF EXISTING CULVERT TRENCHLESS CULVERTS**  
SCALE 1:25

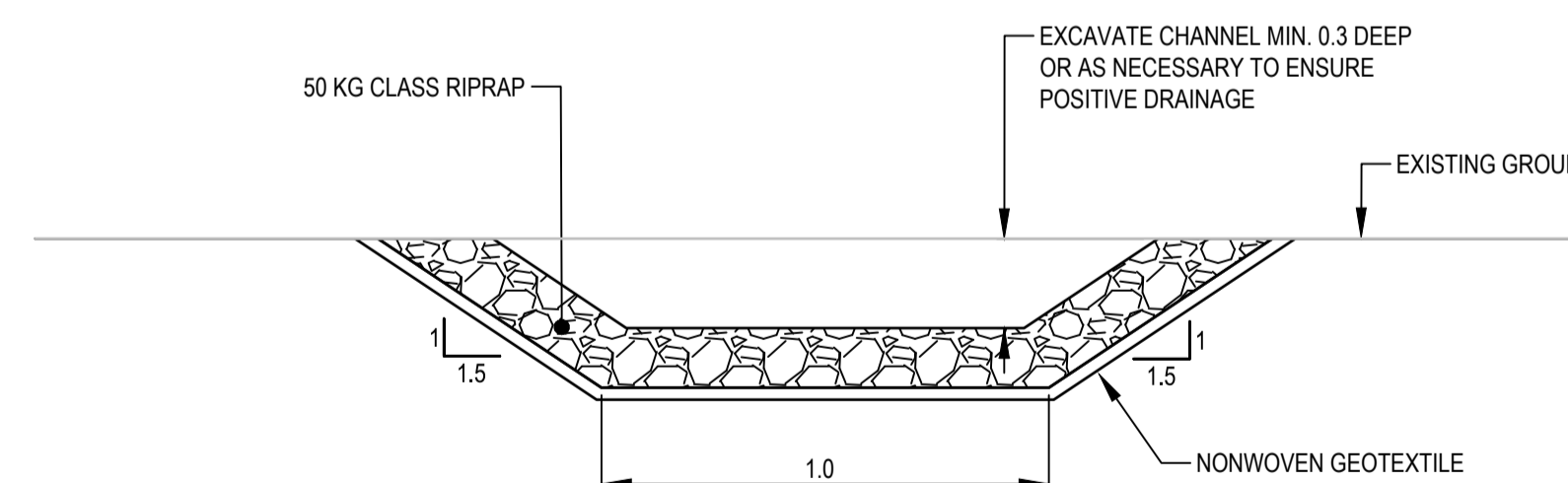

**TYPICAL SECTION - SWALE CONSTRUCTION**  
1:25

Q:\Vancouver\Transportation\TRN\VHWY03\64 Alaska Highway Paving Km 325 - 355 & Km 520 - 555\CAD\Sheets KM 325-355 & Km 520 - 555\PAVING\C1307-TYPICAL ROADWAY SECTIONS & DETAILS.dwg [C:1309] May 25, 2021 - 4:38:17 pm (BY: ERIKS, COLIN)

