

Fisheries and Oceans
Canada

Pêches et Océans
Canada



Small Craft Harbours
Newfoundland Region
St. John's, NL.

Ports Pour Petits Bateaux

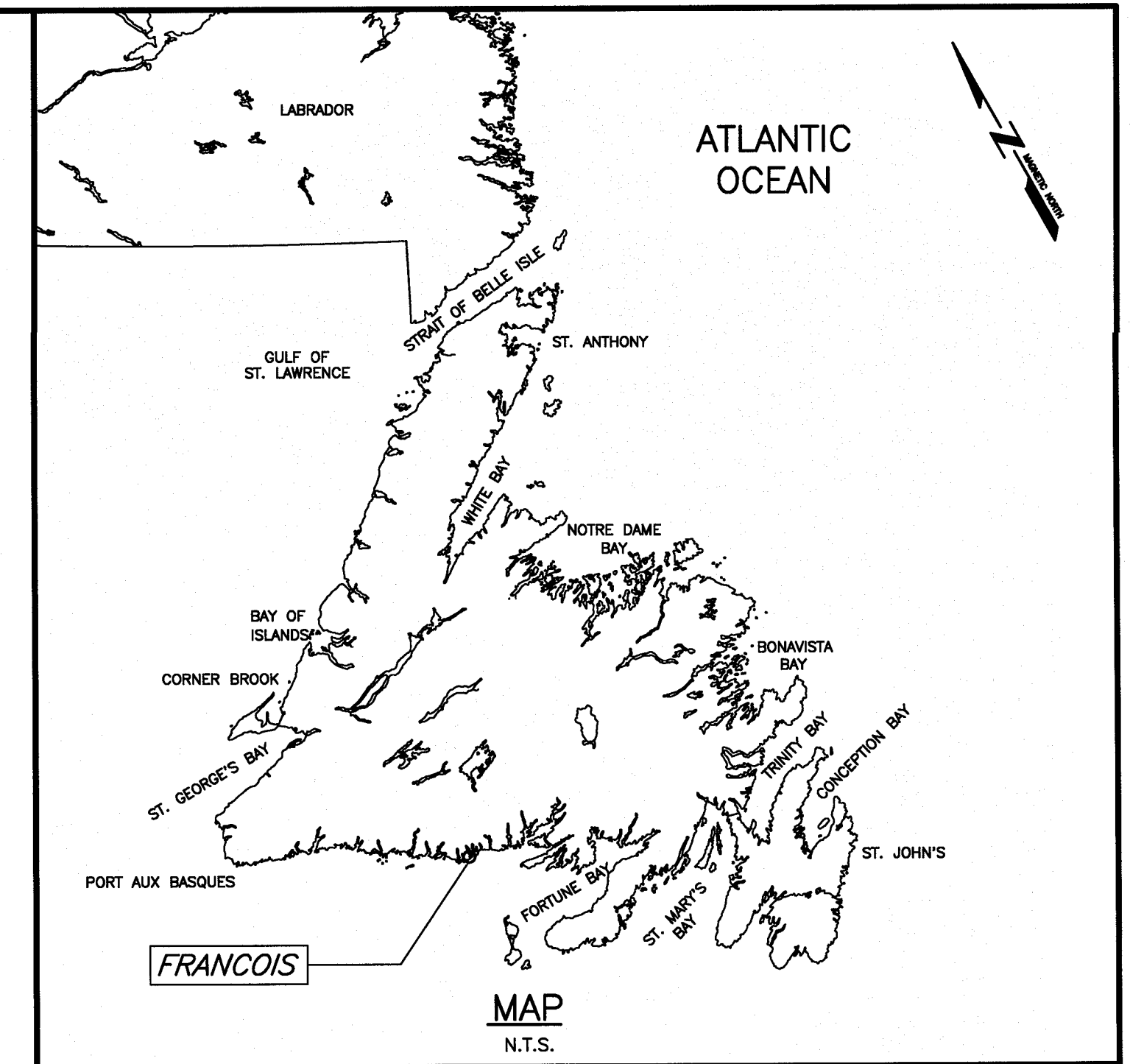

SLIPWAY RECONSTRUCTION

DRAWING LIST

FRANCOIS

NEWFOUNDLAND AND LABRADOR

CIVIL

- C1 OF 6 EXISTING/DEMOLITION SITE PLAN
- C2 OF 6 EXISTING/DEMOLITION PROFILE & SECTION
- C3 OF 6 NEW SITE PLAN
- C4 OF 6 NEW PROFILE & SECTION
- C5 OF 6 NEW COMPONENT PLAN
- C6 OF 6 DETAILS

PROJECT NO. 722318

Canada

SMALL CRAFT HARBOURS

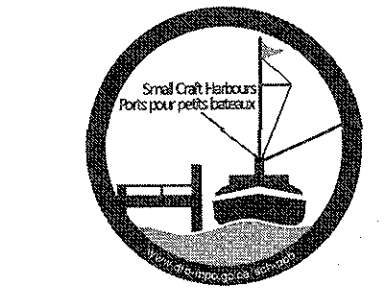

- GENERAL NOTES:
- ALL DIMENSIONS IN MILLIMETERS UNLESS SPECIFIED OTHERWISE.
 - ALL ELEVATIONS IN METERS.
 - DO NOT SCALE FROM DRAWINGS, USE DIMENSIONS AS SHOWN.
 - RELIABLE AS-BUILT INFORMATION IS LIMITED, EXISTING SLIPWAY DETAILS SHOWN FOR INFORMATION PURPOSES ONLY. CONTRACTOR SHALL CONFIRM ALL CRITICAL DIMENSIONS IN THE FIELD. CONTRACTOR TO BASE COSTS FOR DEMOLITION AND ASSOCIATED RISK ACCORDINGLY.
 - THE CONTRACTOR SHALL DETERMINE WHAT SAFETY MEASURES NEED TO BE TAKEN DURING DEMOLITION/CONSTRUCTION ACTIVITIES.
 - REFER TO SPECIFICATION SECTION 02.41.16-SITWORK, DEMOLITION AND REMOVAL. ALL DEMOLITION MATERIAL, INCLUDING CREOSOTE MATERIAL, TO BE DISPOSED AT A PROVINCIALLY APPROVED WASTE DISPOSAL FACILITY, UNLESS NOTED OTHERWISE.
 - CRIBWORK MAY HAVE SETTLED INTO THE SEA BOTTOM, CONTRACTOR TO ENSURE THAT ALL EXISTING CRIBWORK, INCLUDING ANY SETTLED IN TO THE SEA BOTTOM, IS REMOVED ENTIRELY.
 - IT IS RECOMMENDED THAT THE SLIPWAY BE RECONSTRUCTED IN SECTIONS/AREAS, TO AVOID REMOVING ALL ITEMS AT ONCE. THE CONTRACTOR SHALL MAKE ADEQUATE PROVISIONS FOR ALL DEMOLITION/CONSTRUCTION STRESSES, ENVIRONMENTAL PROTECTION AND FOR SUFFICIENT TEMPORARY BRACING AND SHORING TO KEEP THE STRUCTURE PLUMB AND STABLE DURING ALL PHASES OF WORK.

- GENERAL LEGEND
- [Hatched Box] DEMOLITION AND REMOVAL OF EXISTING DECKING & RUNNERS
 - [Cross-hatched Box] DEMOLITION AND REMOVAL OF EXISTING BEAMS, DECKING & RUNNERS
 - [Diagonal Hatched Box] DEMOLITION AND REMOVAL OF EXISTING BEAMS, DECKING, RUNNERS & CRIBWORK

D	ISSUED FOR TENDER	21/01/20
C	ISSUED FOR 99% REVIEW	21/01/07
B	ISSUED FOR 66% REVIEW	20/12/09
A	ISSUED FOR 33% REVIEW	20/11/20
revisions		date

SLIPWAY RECONSTRUCTION

FRANCOIS, NL

EXISTING/DEMOLITION SITE PLAN

designed	C. FISHER	concu
date	NOVEMBER 2020	
drawn	P. MARSH	desine
date	NOVEMBER 2020	
approved		approve
date		
Tender	<i>Paul Curran</i>	Submission
DFP Project Manager	Administrateur de projets MPD	
project number		no. du projet
	722318	
drawing no.		no. du dessin
	C1 OF 6	

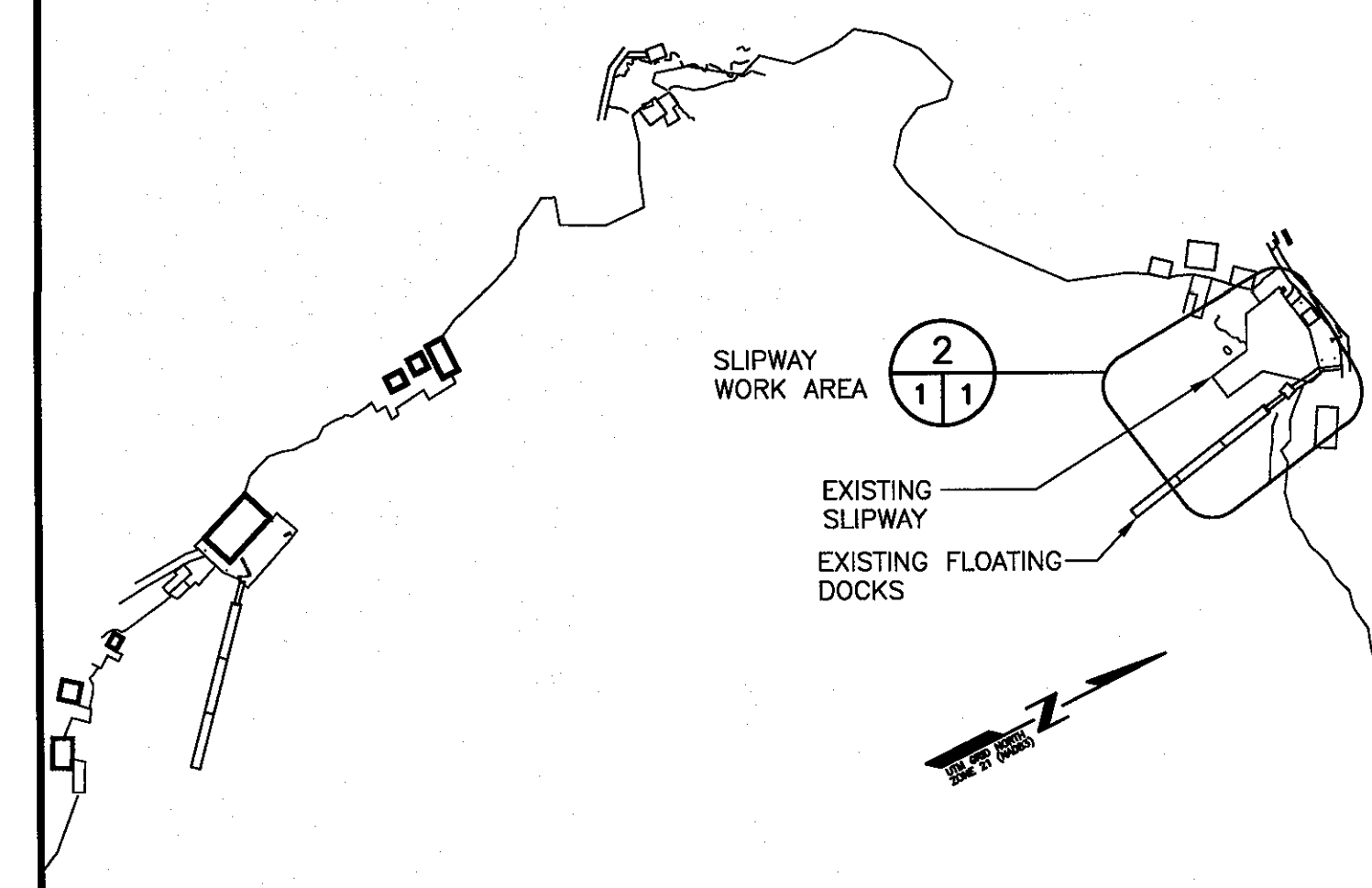

1 LOCATION SITE PLAN
SCALE: 1:2000

SURVEY NOTES

SURVEY PARTY CHIEF RICHARD HEALEY
 SURVEY VESSEL
 SURVEY DATE(S) JULY 22-23,2003
 SOUNDING TYPE: SINGLE TRANSDUCER
 SOUNDING SETTING MIN/INST VEL. OF SOUND 1492 m/s
 DEPTH GATE USED N/A FREQ. OF TRANS. 210 kHz
 POSITIONING SYSTEM USED DPGS (WITH OTF)
 LAND SURVEY POSITION BY WILD T1600 & DGPS
 DATA TAPE/DISC(S) USED
 CAD DRAWING FILE(S):
 TIDAL REDUCTION SCHEME

OFFICE PROCESSOR RICHARD HEALEY
 DATE OF PROCESSING AUGUST 2003
 MODE OF PLOTTING LEAST OF MINIMUM DEPTHS
 MATRIX CELL WIDTH X LENGTH
 REDUCTION OF MATRIX CELLS

CONTROL POINTS:

PL NAME	EASTING	NORTHING	CD ELEV	DESCRIPTION
PWC 1-2003	519178.6	5269494.1	+3.21 m	BOLT DRIVEN IN WOODEN DECK
PWC 3-2003	519230.88	5269603.88	+7.17 m	BOLT CEMENTED IN CONC. WALKWAY(NORTH OF SUPWAY).
PWC 4-2003	519261.67	5269607.84	+7.50m	ANCHOR BOLT IN LARGE BOULDER AT THE NORTH END OF SUPWAY.
PWC 5-2003	519103.95	5269677.10	+2.20m	BOLT CEMENTED IN BEDROCK NEXT TO THE BROOK AND @ THE SITE FOR A PROPOSED SUPWAY.
BM 95F9098	519277.36	5268330.35	+3.165 m	CHS BRONZE TABLE SET IN CONCRETE PAD ANCHORING A DOLPHIN SOUTH OF GOVERNMENT WHARF.

ALL SOUNDINGS & ELEVATIONS IN METRES.
 ALL SOUNDINGS & ELEVATIONS REFERRED TO CHS BM 95F9098 ELEV.+3.165 m.

SOUNDINGS TAKEN USING KNUDSEN SOUNDING AND POSITIONED BY DPGS POSITIONING SYSTEM (WITH OTF) ON JULY 22-23,2003.

NOTE: THERE WAS NO HORIZONTAL CONTROL AVAILABLE AT THE TIME OF SURVEY. COORDINATES FOR POINTS ARE RELATIVE TO PWC 1-2003 WHICH ARE ASSUMED VALUES.

COORDINATES FOR HORIZONTAL CONTROL ARE GIVEN ON THE U.T.M. MAPPING PLANE, ZONE 21, USING THE NORTH AMERICAN DATUM OF 1983(NAD83).

A DIGIBAR-PRO SOUND VELOCIMETER WAS USED TO ACQUIRE THE SPEED OF SOUND.
 ALL FIELD NOTES ARE IN FRANCOIS FIELD BOOK #327.

SURVEY LEGEND

- SYMBOLS**
- ACQUACULTURE
 - ANCHOR BLOCK
 - BOLLARD
 - BOREHOLE
 - BOUNDARY MARKER
 - CARD POSITION BUOY
 - CATCH BASIN
 - CLEAT
 - CULVERT
 - DERRICK
 - DISPOSAL
 - DREDGE CONTROL
 - ELECTRICAL OUTLET
 - FIRE HYDRANT
 - FIRST AID
 - FISH HANDLING EQUIP.
 - FOG HORN
 - FUEL PUMP
 - H PILE
 - HORIZONTAL CONTROL
 - ICE PLANT
 - INVERT PIPE
 - JIB CRANE
 - LADDER
 - LIFE RING
 - LIGHT STANDARD
 - MANHOLE
 - MARSH
 - MAST/TOWER
 - NAVIGATION LIGHT
 - OBSERVED BUOY
 - OBSERVED SPAR BUOY
 - PIPE PILE
 - RANGE LIGHT
 - SAFETY POST
 - SEWER OUTFLOW PIPE
 - SIGN
 - TELEPHONE
 - TELEPHONE POLE
 - TIDE GAUGE/STAFF
 - TREE
 - UTILITY POLE
 - VERTICAL CONTROL
 - WATER TAP/OUTLET
 - WATER VALVE
 - WATER WELL
 - WOOD PILE
- LINE TYPE**
- ARMOUR STONE
 - CL. RAILROAD
 - DRAIN PIPE
 - EDGE ROAD / SHOULDER
 - FENCE LINE
 - FLOATING WAVEBREAK
 - GUARD RAIL
 - HIGH WATER MARK
 - LOW WATER MARK
 - MARSH OUTLINE
 - PROPOSED BOUNDARY
 - RANGE LIGHT EXTENSION
 - RETAINING WALL
 - RIPRAP
 - TOE OF BANK
 - TREE LINE
 - UNDERGROUND CABLE

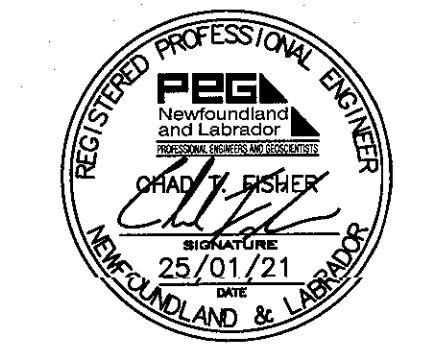

PROVINCE OF NEWFOUNDLAND AND LABRADOR
PERMIT HOLDER
 Meridian Engineering Inc.
 Member No. 04378
 To practice Professional Engineering in Newfoundland and Labrador.
 Permit No. as issued by PEG - N0468
 which is valid for the year 2021.

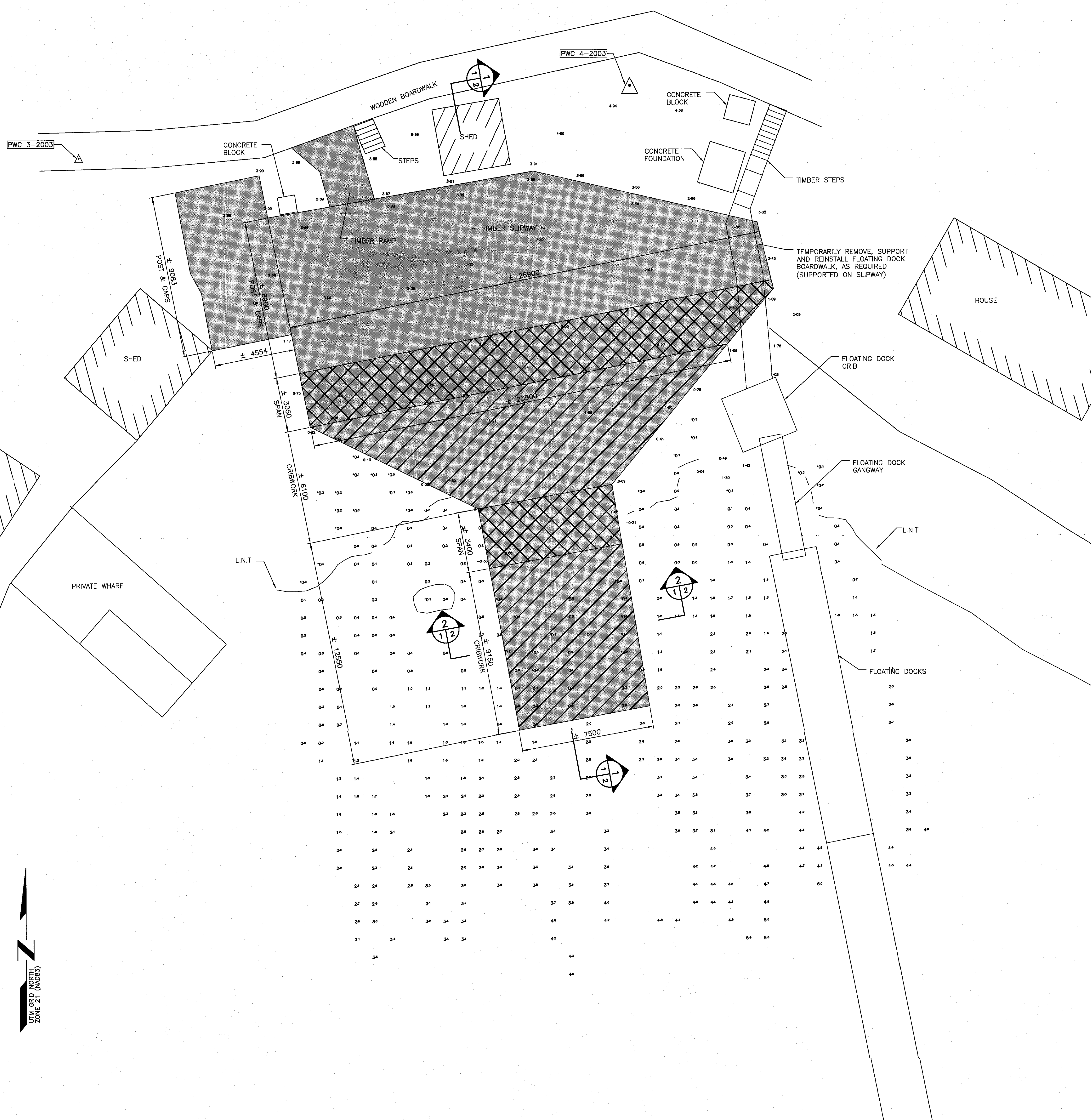

2 EXISTING/DEMOLITION SITE PLAN - SLIPWAY
SCALE: 1:100

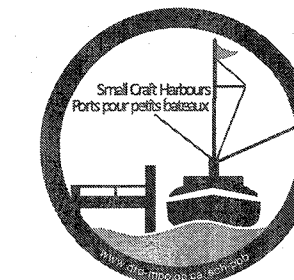

GENERAL NOTES:

1. ALL DIMENSIONS IN MILLIMETERS UNLESS SPECIFIED OTHERWISE.
2. ALL ELEVATIONS IN METERS.
3. DO NOT SCALE FROM DRAWINGS, USE DIMENSIONS AS SHOWN.
4. RELIABLE AS-BUILT INFORMATION IS LIMITED, EXISTING SLIPWAY DETAILS SHOWN FOR INFORMATION PURPOSES ONLY. CONTRACTOR SHALL CONFIRM ALL CRITICAL DIMENSIONS IN THE FIELD. CONTRACTOR TO BARE COSTS FOR DEMOLITION AND ASSOCIATED RISK ACCORDINGLY.
5. THE CONTRACTOR SHALL DETERMINE WHAT SAFETY MEASURES NEED TO BE TAKEN DURING DEMOLITION/CONSTRUCTION ACTIVITIES.
6. REFER TO SPECIFICATION SECTION 02 41 16-SITWORK, DEMOLITION AND REMOVAL. ALL DEMOLITION MATERIAL, INCLUDING CREOSOTE MATERIAL, TO BE DISPOSED AT A PROVINCIALY APPROVED WASTE DISPOSAL FACILITY, UNLESS NOTED OTHERWISE.
7. CRIBWORK MAY HAVE SETTLED INTO THE SEA BOTTOM. CONTRACTOR TO ENSURE THAT ALL EXISTING CRIBWORK, INCLUDING ANY SETTLED IN TO THE SEA BOTTOM, IS REMOVED ENTIRELY.
8. IT IS RECOMMENDED THAT THE SLIPWAY BE RECONSTRUCTED IN SECTIONS/AREAS, TO AVOID REMOVING ALL ITEMS AT ONCE. THE CONTRACTOR SHALL MAKE ADEQUATE PROVISIONS FOR ALL DEMOLITION/CONSTRUCTION STRESSES, ENVIRONMENTAL PROTECTION AND FOR SUFFICIENT TEMPORARY BRACING AND SHORING TO KEEP THE STRUCTURE PLUMB AND STABLE DURING ALL PHASES OF WORK.

GENERAL LEGEND

■ DENOTES ITEMS TO BE COMPLETELY DEMOLISHED AND REMOVED

D	ISSUED FOR TENDER	21/01/20
C	ISSUED FOR 99% REVIEW	21/01/20
B	ISSUED FOR 66% REVIEW	20/12/19
A	ISSUED FOR 33% REVIEW	20/11/19

revisions	date
project	project

SLIPWAY RECONSTRUCTION

FRANCOIS, NL

drawing dessin

EXISTING/DEMOLITION PROFILE & SECTION

designed C. FISHER	conçu
date NOVEMBER 2020	
drawn P. MARSH	dessiné
date NOVEMBER 2020	
approved	approuvé
date	
Tender Paul Curran	Submission
DFD Project Manager Administrateur de projets MPD	
project number	no. du projet

722318

drawing no. no. du dessin

C2 OF 6

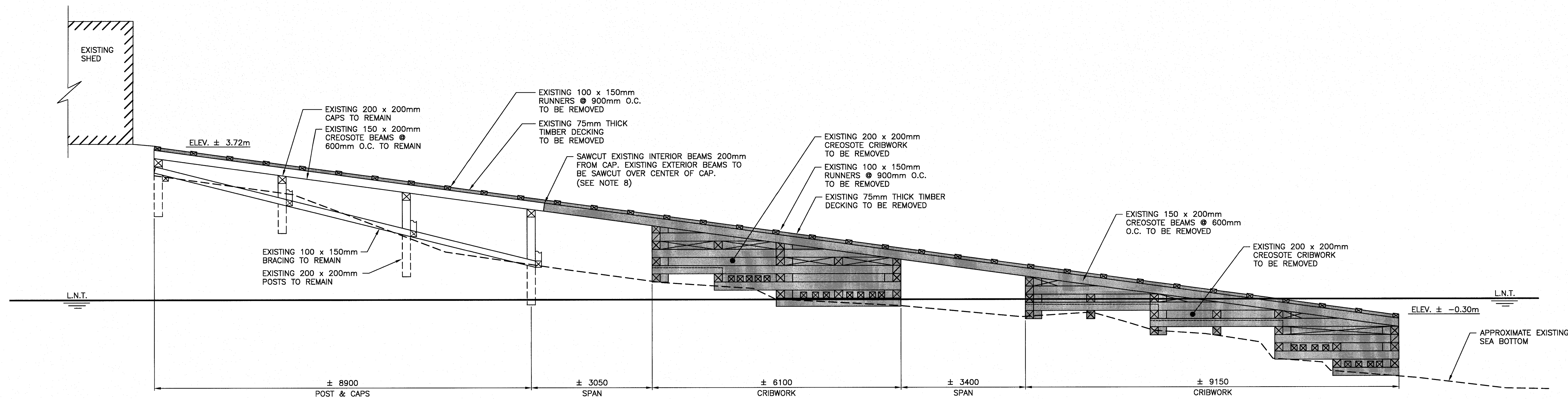

1 EXISTING SLIPWAY DEMOLITION PROFILE - TYPICAL

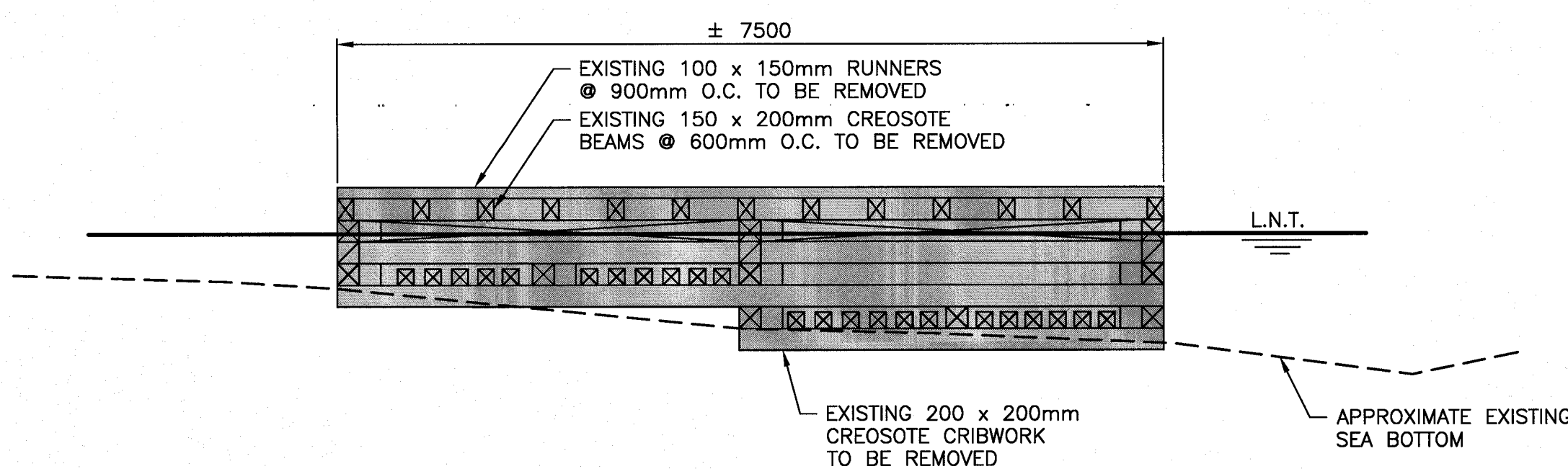
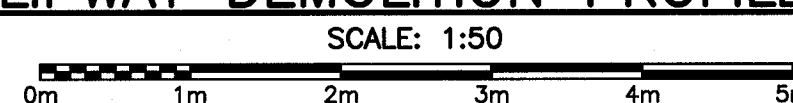

2 EXISTING CRIBWORK DEMOLITION SECTION - TYPICAL

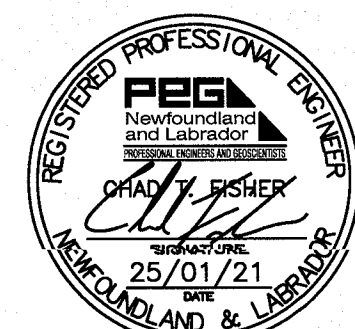
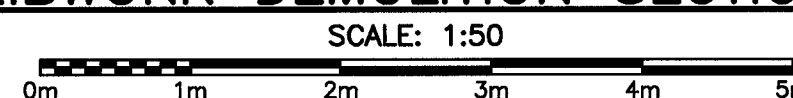

PROVINCE OF NEWFOUNDLAND AND LABRADOR
 PERMIT HOLDER
 This Permit Allows
 Member No. 04378
Meridian Engineering Inc.
 To practice Professional Engineering
 in Newfoundland and Labrador.
 Permit No. as issued by PEO - N0453
 which is valid for the year 2021.

SMALL CRAFT HARBOURS

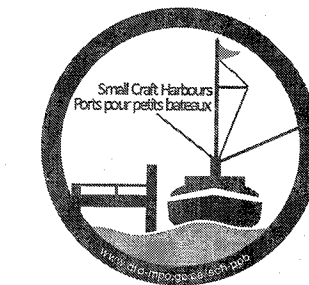

GENERAL NOTES:

1. ALL DIMENSIONS IN MILLIMETERS UNLESS SPECIFIED OTHERWISE.
2. ALL ELEVATIONS IN METERS.
3. DO NOT SCALE FROM DRAWINGS, USE DIMENSIONS AS SHOWN.
4. CONTRACTOR SHALL EXCAVATE IN SUCH A MANNER TO ENSURE STABILITY OF SIDE SLOPES.
5. NEW CRIBWORK TO BE INSTALLED AND SCRIBED TO HARD BOTTOM TO ELEVATIONS INDICATED. IF NECESSARY, EXCAVATE AND REMOVE ANY SOFT OVERBURDEN MATERIAL AND REPLACE WITH SUITABLE ROCK FILL MATERIAL IF REQUIRED. CONTRACTOR SHALL SUBMIT A CRIB CONSTRUCTION/SCRIBE PLAN TO THE DEPARTMENTAL REPRESENTATIVE FOR APPROVAL.
6. ALL MACHINE BOLTS TO BE 19mm Ø (GALVANIZED), UNLESS OTHERWISE NOTED.
7. ALL DRIFT BOLTS TO BE 19mm Ø (GALVANIZED), UNLESS OTHERWISE NOTED.
8. ALL TIMBER TO BE TREATED TO CSA O80, LATEST EDITION, UNLESS OTHERWISE NOTED.
9. GALVANIZING WILL CONFORM TO ASTM A123/123M, LATEST EDITION.

GENERAL LEGEND

■ DENOTES NEW ITEMS TO BE INSTALLED

revision	date
D	ISSUED FOR TENDER 21/01/20
C	ISSUED FOR 99% REVIEW 21/01/20
B	ISSUED FOR 66% REVIEW 20/12/19
A	ISSUED FOR 33% REVIEW 20/11/20

SLIPWAY RECONSTRUCTION

FRANCOIS, NL

NEW PROFILE & SECTION

designed	C. FISHER	conçu
date	NOVEMBER 2020	
drawn	P. MARSH	dessiné
date	NOVEMBER 2020	
approved		approuvé
date		
Tender	Paul Curran	Submission
DFO Project Manager	Administrateur de projets MPO	
project number	722318	no. du projet
drawing no.	C4 OF 6	no. du dessin

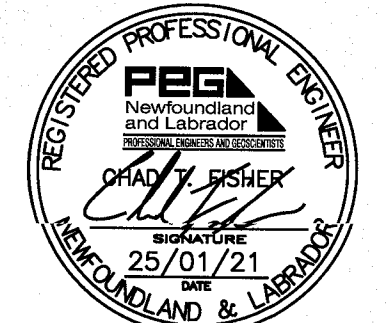

PROVINCE OF NEWFOUNDLAND AND LABRADOR
 PERMIT HOLDER
 Meridian Engineering Inc.
 Member No. 04378
 To practice Professional Engineering in Newfoundland and Labrador, Permit No. as issued by PEG No. 1563 which is valid for the year 2021.

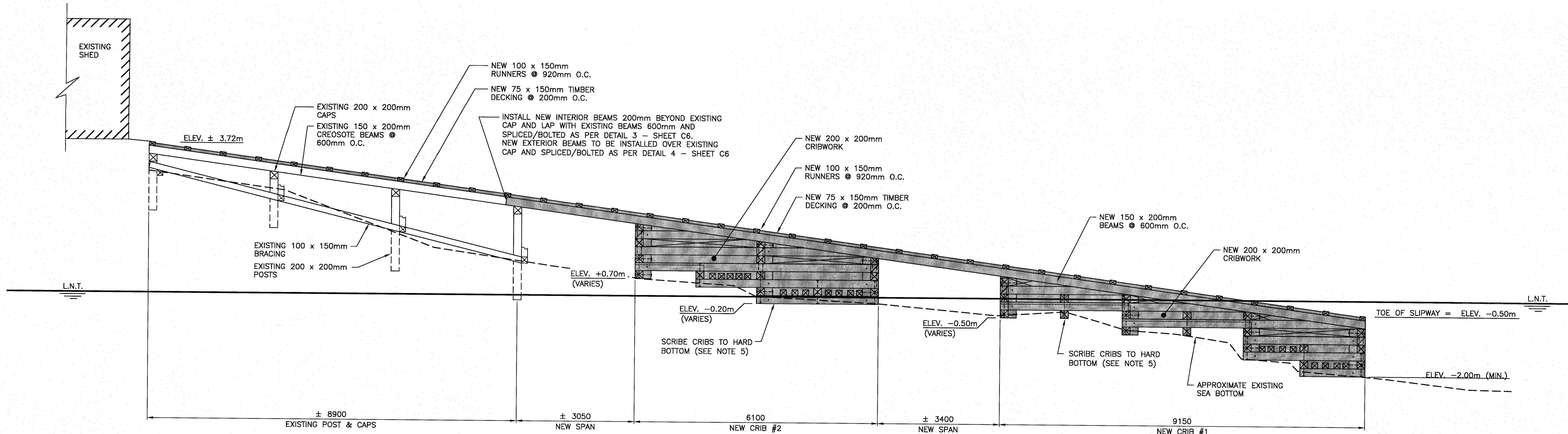

1 NEW SLIPWAY PROFILE - TYPICAL
 SCALE: 1:50

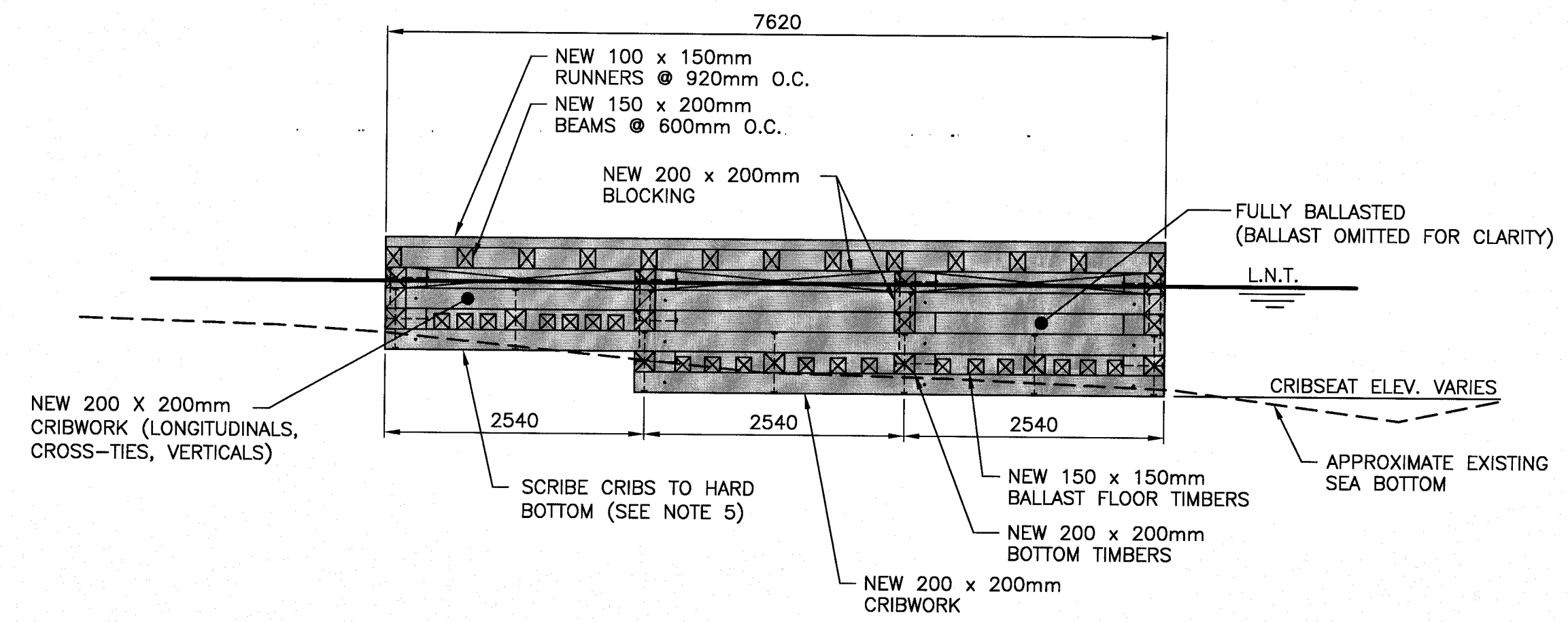

2 NEW CRIBWORK SECTION - TYPICAL
 SCALE: 1:50

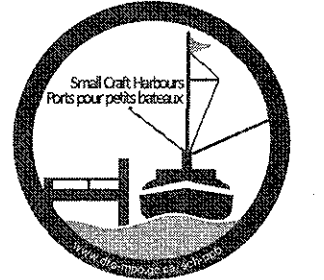

GENERAL NOTES:

1. ALL DIMENSIONS IN MILLIMETERS UNLESS SPECIFIED OTHERWISE.
2. ALL ELEVATIONS IN METERS.
3. DO NOT SCALE FROM DRAWINGS, USE DIMENSIONS AS SHOWN.
4. CONTRACTOR SHALL EXCAVATE IN SUCH A MANNER TO ENSURE STABILITY OF SIDE SLOPES.
5. NEW CRIBWORK TO BE INSTALLED AND SCRIBED TO HARD BOTTOM TO ELEVATIONS INDICATED. IF NECESSARY, EXCAVATE AND REMOVE ANY SOFT OVERBURDEN MATERIAL AND REPLACE WITH SUITABLE ROCK FILL MATERIAL IF REQUIRED. CONTRACTOR SHALL SUBMIT A CRIB CONSTRUCTION/SCRIBE PLAN TO THE DEPARTMENTAL REPRESENTATIVE FOR APPROVAL.
6. THE CONFIGURATION FOR THE IRREGULAR/ANGLE SHAPED CRIBS MAY VARY IN THE FIELD DURING CONSTRUCTION, DUE TO ACTUAL DIMENSIONS, HARD BOTTOM LOCATION, SCRIBING, ETC. FOR THE IRREGULAR/ANGLE SHAPE CRIB BAYS, THE LARGEST DIMENSION WITHIN THE BAY SHALL NOT EXCEED THE DIMENSION SHOWN. IF NECESSARY, PROVIDE AND INSTALL ADDITIONAL CRIB TIMBERS TO MEET THE DIMENSIONS SHOWN. IN ADDITION, PROVIDE AND INSTALL ADDITIONAL CRIB TIMBERS REQUIRED TO ENSURE TIMBERS IN THE SAME PLANE, ALONG THE ANGLE SECTION OF THE CRIB, ARE FULLY SUPPORTED.
7. ALL MACHINE BOLTS TO BE 19mm Ø (GALVANIZED), UNLESS OTHERWISE NOTED.
8. ALL DRIFT BOLTS TO BE 19mm Ø (GALVANIZED), UNLESS OTHERWISE NOTED.
9. ALL TIMBER TO BE TREATED TO CSA 080, LATEST EDITION, UNLESS OTHERWISE NOTED.
10. GALVANIZING WILL CONFORM TO ASTM A123/123M, LATEST EDITION.

GENERAL LEGEND

■ DENOTES NEW ITEMS TO BE INSTALLED

D	ISSUED FOR TENDER	21/07/20
C	ISSUED FOR 99% REVIEW	21/01/07
B	ISSUED FOR 66% REVIEW	20/12/09
A	ISSUED FOR 33% REVIEW	20/11/20

revisions	date
project	project

SLIPWAY RECONSTRUCTION

FRANCOIS, NL

drawing design

NEW COMPONENT PLAN

designed C. FISHER concu

date NOVEMBER 2020

drawn P. MARSH desine

date NOVEMBER 2020

approved approve

date

Tender Paul Curran Sourmission

DFO Project Manager Administrateur de projets MPO

project number 722318 no. du projet

drawing no. C5 OF 6 no. du dessin

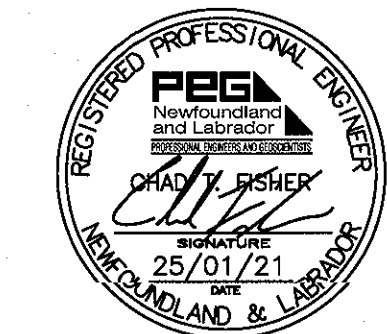

PROVINCE OF NEWFOUNDLAND AND LABRADOR
 PERMIT HOLDER
 This Permit Allows
Meridian Engineering Inc.
 Member No. 04378
 To practice Professional Engineering
 in Newfoundland and Labrador.
 Permit No. as issued by PRG_201453
 which is valid for the year 2021.

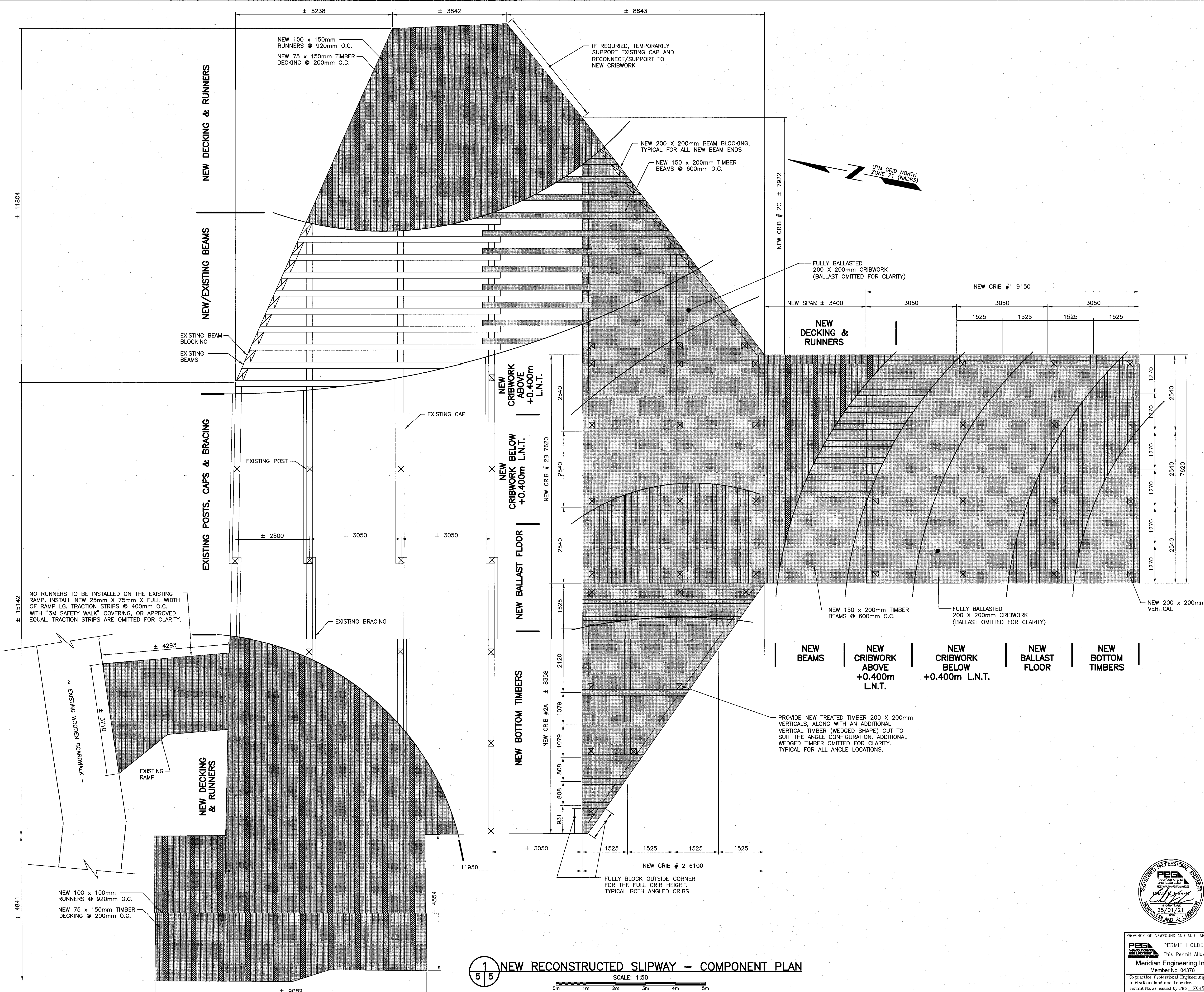

1 5 NEW RECONSTRUCTED SLIPWAY - COMPONENT PLAN

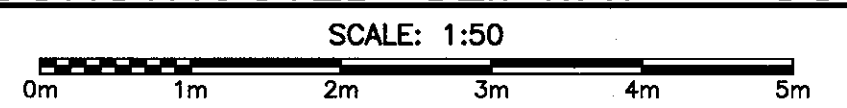

SMALL CRAFT HARBOURS



GENERAL NOTES:

1. ALL DIMENSIONS ARE IN MILLIMETERS UNLESS SPECIFIED OTHERWISE.
2. ALL ELEVATIONS ARE IN METERS.
3. DO NOT SCALE FROM DRAWINGS, USE DIMENSIONS SHOWN.
4. CONTRACTOR MUST VERIFY ALL DIMENSIONS AND CONDITIONS ON SITE PRIOR TO PROCEEDING WITH ANY PORTION OF THIS WORK.
5. ALL MACHINE BOLTS TO BE 19mm Ø (GALVANIZED), UNLESS OTHERWISE NOTED.
6. ALL DRIFT BOLTS TO BE 19mm Ø (GALVANIZED), UNLESS OTHERWISE NOTED.
7. ALL TIMBER TO BE TREATED TO CSA O80, LATEST EDITION, UNLESS OTHERWISE NOTED.
8. GALVANIZING WILL CONFORM TO ASTM A123/123M, LATEST EDITION.

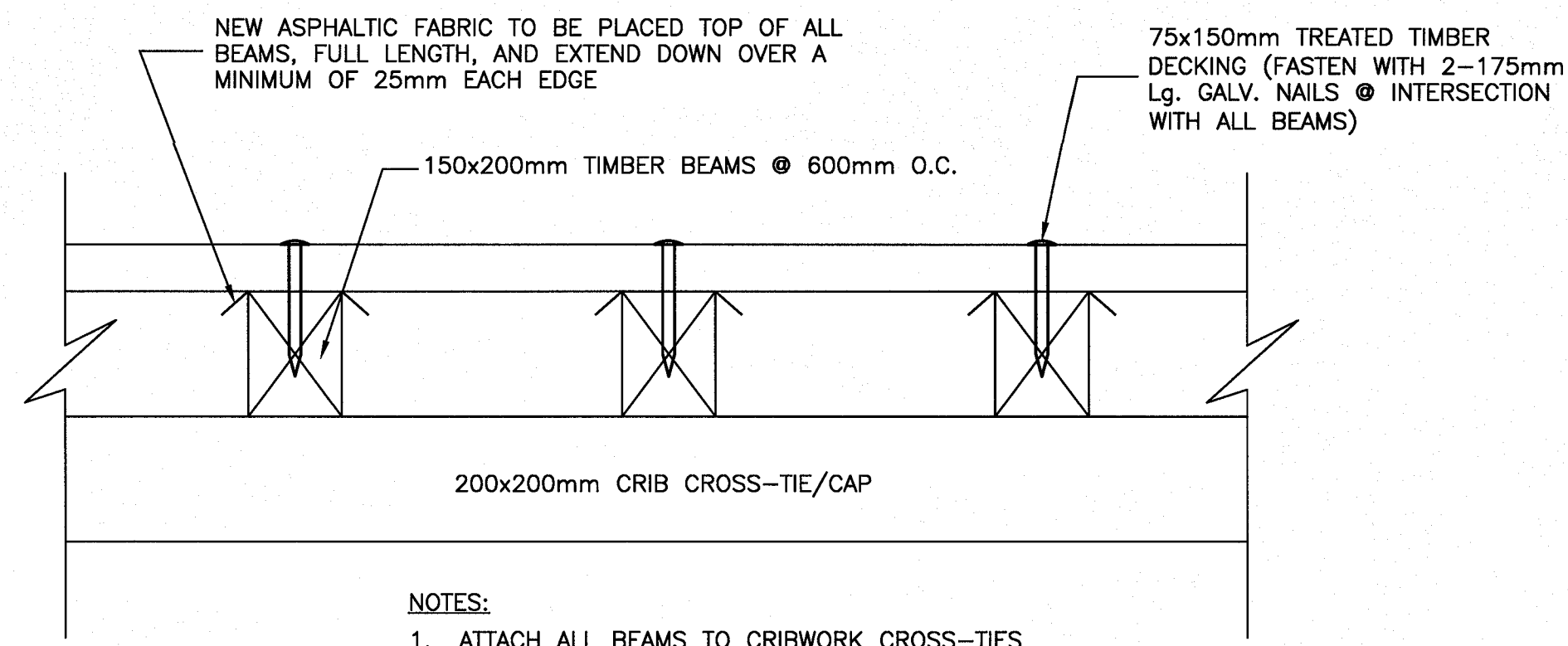

- NOTES:
1. ATTACH ALL BEAMS TO CRIBWORK CROSS-TIES WITH 19mm Ø x 700mm LONG DRIFT BOLTS, COUNTERSUNK.
 2. ATTACH ALL BEAMS TO EXISTING CAPS WITH 16mm Ø x 350mm LONG LAG SCREWS

1
6 6 DECK DETAIL 1
SCALE : 1:10
0mm 100 200 300 400 500 600 700 800 900 1000mm

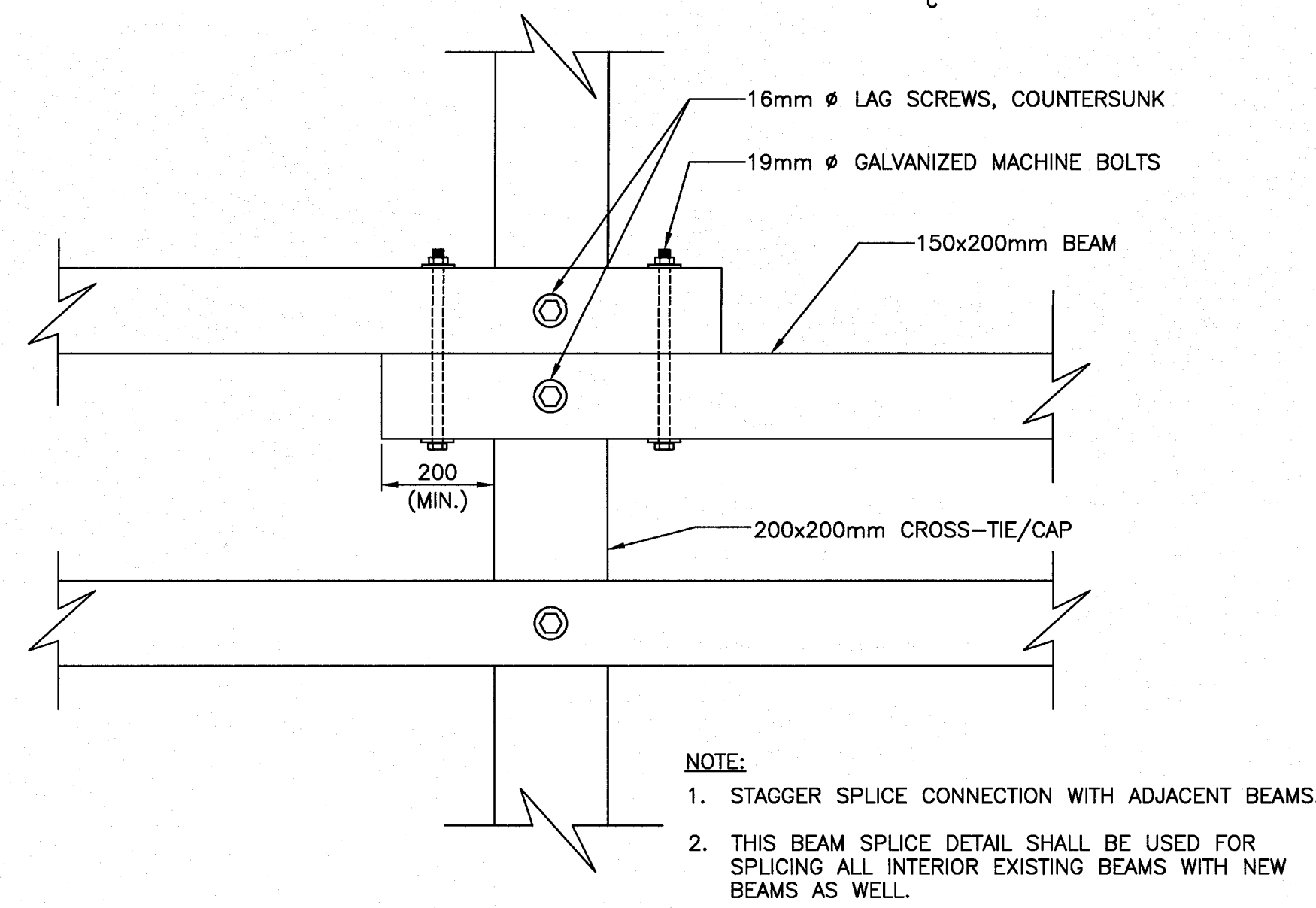

- NOTE:
1. STAGGER SPLICE CONNECTION WITH ADJACENT BEAMS.
 2. THIS BEAM SPLICE DETAIL SHALL BE USED FOR SPLICING ALL INTERIOR EXISTING BEAMS WITH NEW BEAMS AS WELL.

3
6 6 INTERIOR BEAM SPLICE DETAIL
SCALE : 1:10
0mm 100 200 300 400 500 600 700 800 900 1000mm

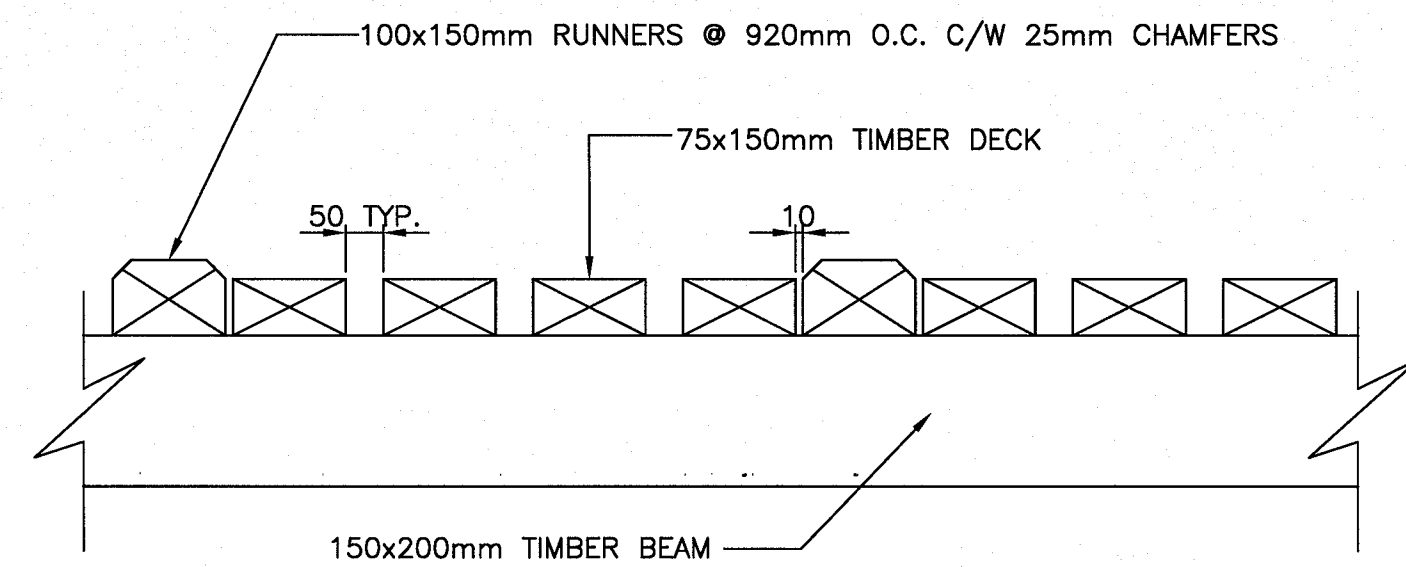

- NOTE:
1. ATTACH ALL RUNNERS AT INTERSECTION WITH BEAMS USING 16mm Ø x 250mm Lg. LAG SCREWS COUNTERSUNK.
 2. NO RUNNERS TO BE INSTALLED ON THE EXISTING RAMP. INSTALL NEW 25mm X 75mm X FULL WIDTH OF RAMP Lg. TRACTION STRIPS @ 400mm O.C. WITH "3M SAFETY WALK" COVERING, OR APPROVED EQUAL.

2
6 6 DECKING DETAIL 2
SCALE : 1:10
0mm 100 200 300 400 500 600 700 800 900 1000mm

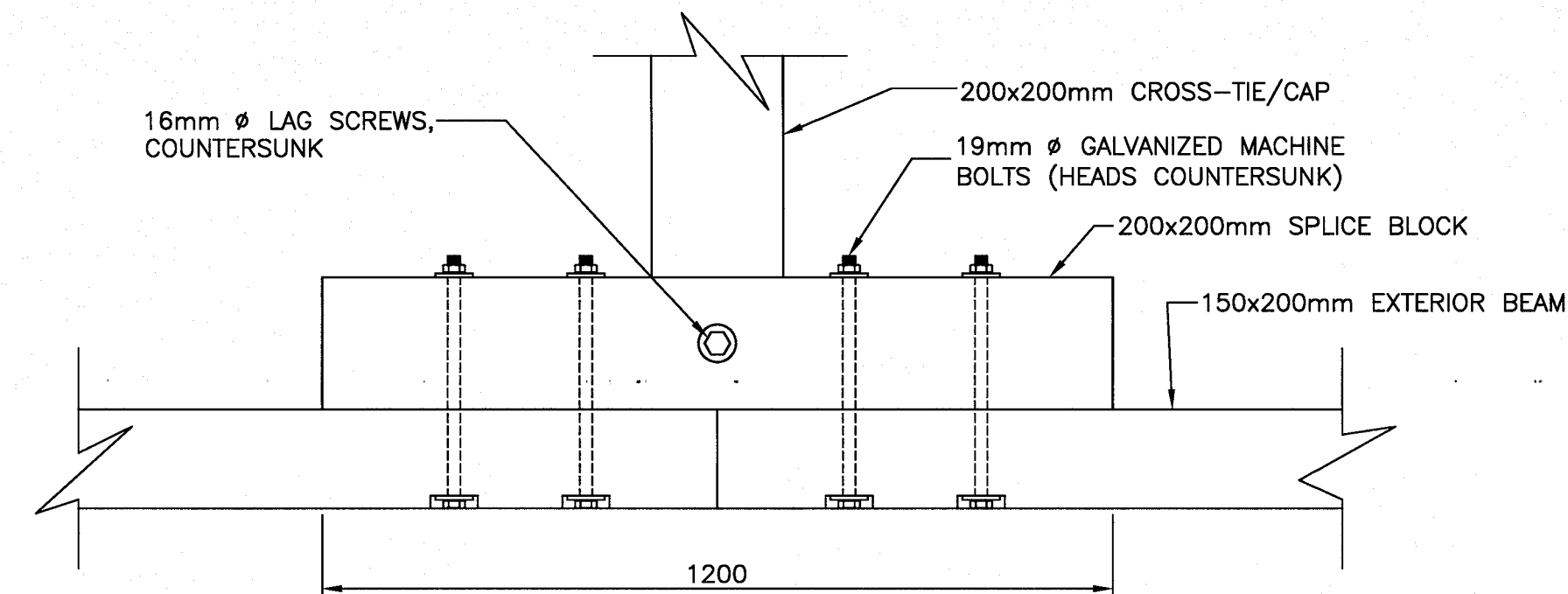

PLAN

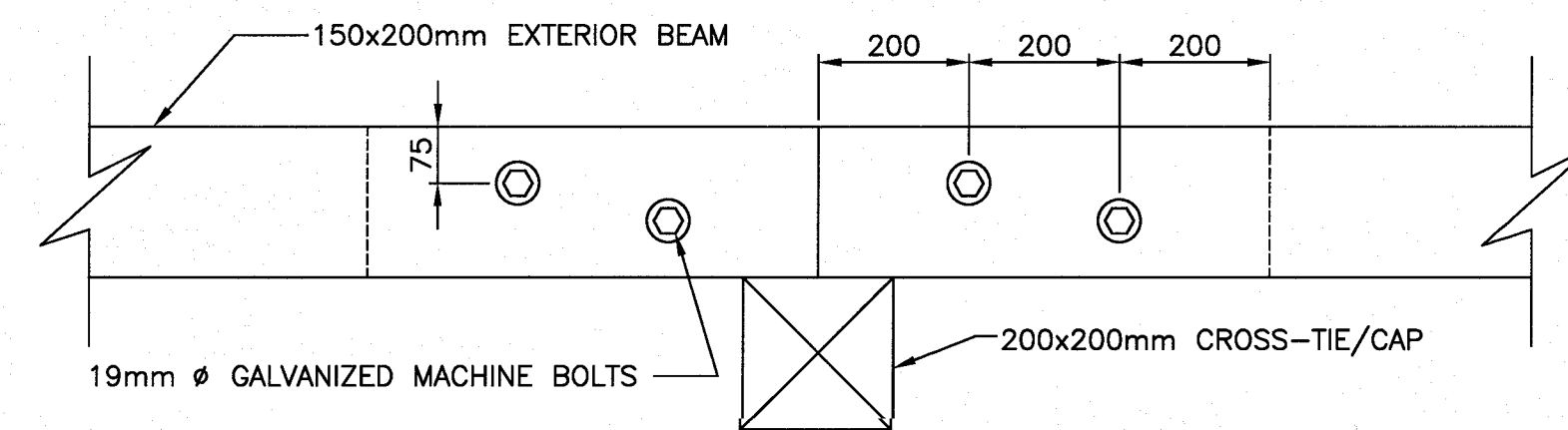

ELEVATION

- NOTE:
1. THIS BEAM SPLICE DETAIL SHALL BE USED FOR SPLICING ALL EXTERIOR EXISTING BEAMS WITH NEW BEAMS AS WELL.

4
6 6 EXTERIOR BEAM SPLICE DETAIL
SCALE : 1:10
0mm 100 200 300 400 500 600 700 800 900 1000mm

D	ISSUED FOR TENDER	21/01/25
C	ISSUED FOR 99% REVIEW	21/01/07
B	ISSUED FOR 66% REVIEW	20/12/09
A	ISSUED FOR 33% REVIEW	20/11/20
revisions		date
project		project

SLIPWAY RECONSTRUCTION

FRANCOIS, NL

drawing design

DETAILS

designed C. FISHER concd

date NOVEMBER 2020

drawn R. SNOW desine

date NOVEMBER 2020

approved approve

date

Tender Sourmission

DFO Project Manager Administrateur de projets MPO

project number no. du projet

722318

drawing no. no. du dessin

C6 OF 6

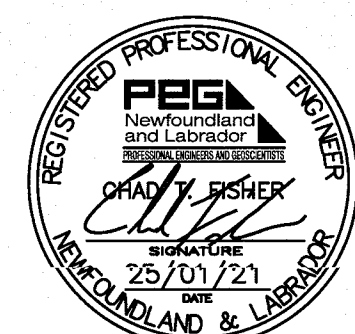

PROVINCE OF NEWFOUNDLAND AND LABRADOR
PERMIT HOLDER
This Permit Allows
Meridian Engineering Inc.
Member No. 04378
To practice Professional Engineering in Newfoundland and Labrador.
Permit No. as issued by REG. 200453
which is valid for the year 2021.

