

**BRIDGE SECTION**

SCALE 1:50

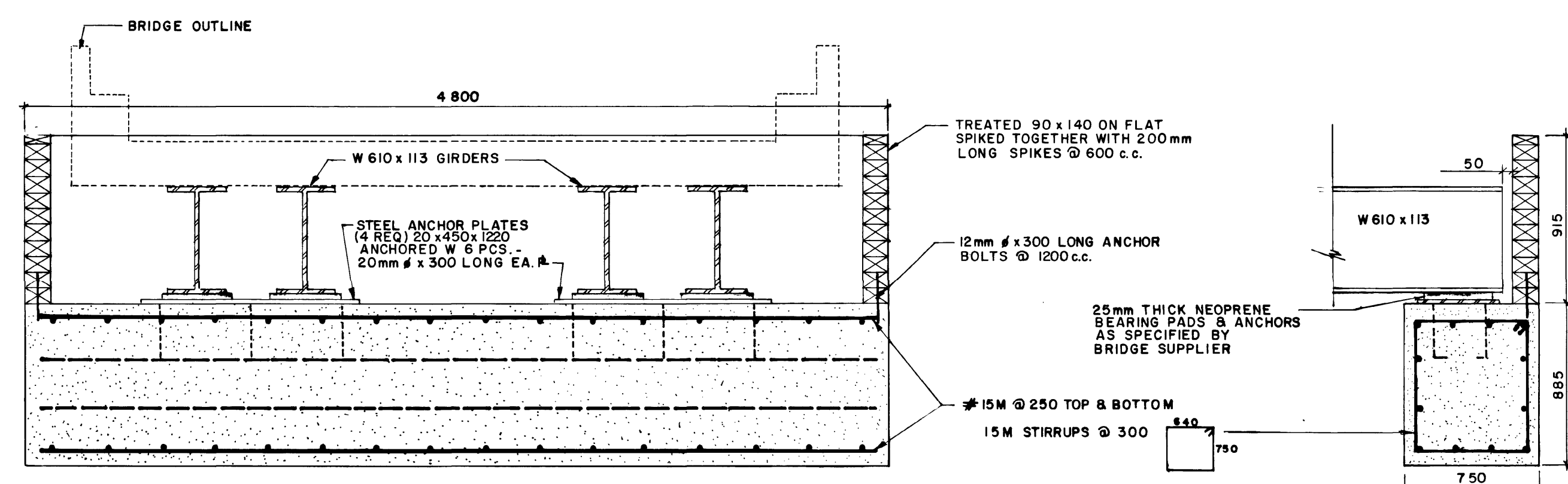

**VIEW AT ABUTMENT BEARING & FNDN. SECTION**

SCALE 1:25

**ABUTMENT SECTION**

SCALE 1:25

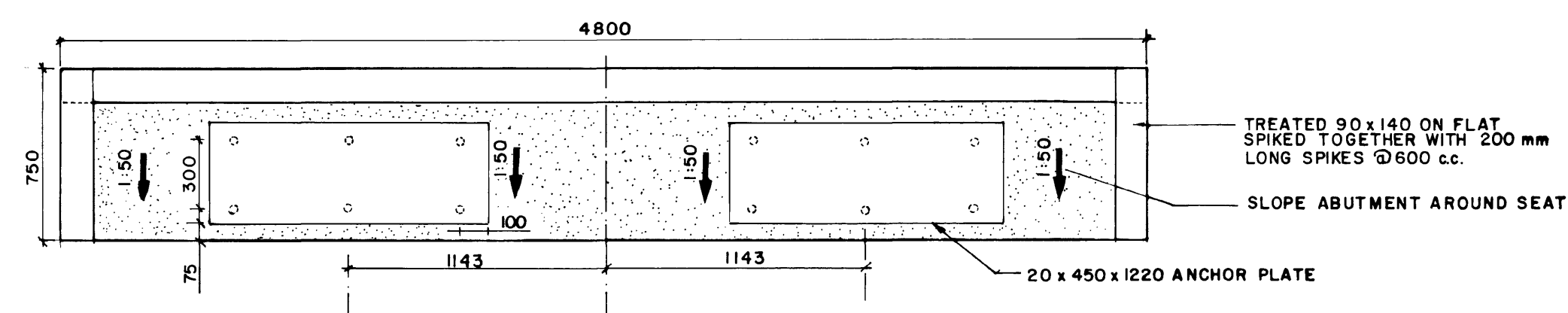

**ABUTMENT PLAN VIEW**

SCALE 1:25

**NOTES**

1. CONCRETE COMPRESSIVE STRENGTH TO BE 25 MPa AT 28 DAYS; 40 mm AGGREGATE, 3 TO 6 % ENTRAINED AIR.
2. CEMENT TO BE TYPE 50 SULPHATE RESISTANT.
3. CONCRETE WORK TO BE CARRIED OUT TO CSA CAN 3-A23.1
4. USE GALVANIZED SPIKES IN TIMBER BELOW GROUND.
5. REINFORCING STEEL TO BE GRADE 400 DEFORMED BARS FOR 15 M AND LARGER, GRADE 300 FOR 10 M BARS.
6. STEEL OF BRIDGE TO BE PAINTED WITH PRIMER COAT; 3 mils ZINC RICH PRIMER, CARBONZINC 12 OR APPROVED EQUAL. FINISH COAT: 4 mils OF CARBOLINE 890 (GRAY) OR APPROVED EQUAL. CONTRACTOR TO TOUCH-UP SCRATCHES AFTER INSTALLATION.

approved by / approuvé par \_\_\_\_\_ date/date \_\_\_\_\_

Park Superintendent / Directeur du parc \_\_\_\_\_

no.	date	description	drawn by tracé par	app'd by appr. par

revision / révision

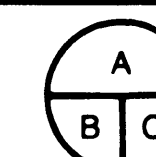

A detail number  
B location drawing number  
C drawing number



**Parks  
Canada**

**Engineering  
and Architecture**

**Parcs  
Canada**

**Génie et  
architecture**

project title / titre du projet

**RESERVOIR BRIDGE SITE  
STEPHEN CREEK**  
Field Townsite B.C.

**Yoho National Park**

drawing title / titre du dessin

**SECTIONS & DETAILS**

designed by / conception par <b>A. Sippola</b>	approved by / approuvé par _____
drawn by / tracé par <b>P.M. Rasko</b>	date / date <b>JUNE 1991</b>
checked by / vérifié par <b>E. Rindt</b>	scale / échelle <b>As noted</b>

project asset number / numéro du projet d'immobilisation

**NWY 91/R6**

sheet no. / feuille no.

**2 of 2**