



RETURN BIDS TO:

RETOURNER LES SOUMISSIONS À:

Bid Receiving Public Works and Government
Services Canada/Réception des soumissions/Travaux
publics et Services gouvernementaux Canada
See herein for bid submission
instructions/

Voir la présente pour les
instructions sur la présentation
d'une soumission

NA
Ontario

**SOLICITATION AMENDMENT
MODIFICATION DE L'INVITATION**

The referenced document is hereby revised; unless otherwise
indicated, all other terms and conditions of the Solicitation
remain the same.

Ce document est par la présente révisé; sauf indication contraire,
les modalités de l'invitation demeurent les mêmes.

Comments - Commentaires

Address enquires to the Contracting Authority at
cynthia.lamorie@tpsgc-pwgsc.gc.ca

Vendor/Firm Name and Address

Raison sociale et adresse du
fournisseur/de l'entrepreneur

Issuing Office - Bureau de distribution

Public Works and Government Services Canada Supply
and Services Operation
Petawawa Procurement
Building S-111, Rm C-114
101 Menin Rd. Garrison Petawawa
Petawawa
Ontario
K8H 2X3

Title - Sujet Warehouse Racking Rayonnage d'entrepôt	
Solicitation No. - N° de l'invitation W0107-22MB03/A	Amendment No. - N° modif. 002
Client Reference No. - N° de référence du client W0107-22-MB03	Date 2021-08-25
GETS Reference No. - N° de référence de SEAG PW-\$PET-907-1687	
File No. - N° de dossier PET-1-55006 (907)	CCC No./N° CCC - FMS No./N° VME
Solicitation Closes - L'invitation prend fin at - à 02:00 PM Eastern Daylight Saving Time EDT on - le 2021-08-30 Heure Avancée de l'Est HAE	
F.O.B. - F.A.B. Plant-Usine: <input type="checkbox"/> Destination: <input checked="" type="checkbox"/> Other-Autre: <input type="checkbox"/>	
Address Enquiries to: - Adresser toutes questions à: Lamorie, Cindy	Buyer Id - Id de l'acheteur pet907
Telephone No. - N° de téléphone (613) 401-3643 ()	FAX No. - N° de FAX () -
Destination - of Goods, Services, and Construction: Destination - des biens, services et construction: Repair Parts Stores Section (RPSS) 257 Montgomery Rd, Bldg H-112 Garrison Petawawa, ON	

Instructions: See Herein

Instructions: Voir aux présentes

Delivery Required - Livraison exigée	Delivery Offered - Livraison proposée
Vendor/Firm Name and Address Raison sociale et adresse du fournisseur/de l'entrepreneur	
Telephone No. - N° de téléphone Facsimile No. - N° de télécopieur	
Name and title of person authorized to sign on behalf of Vendor/Firm (type or print) Nom et titre de la personne autorisée à signer au nom du fournisseur/ de l'entrepreneur (taper ou écrire en caractères d'imprimerie)	
Signature	Date

Solicitation No. - N° de l'invitation
W0107-22MB03/A
Client Ref. No. - N° de réf. du client
W0107-22MB03

Amd. No. - N° de la modif.
002
File No. - N° du dossier
PET-1-55006

Buyer ID - Id de l'acheteur
PET907
CCC No./N° CCC - FMS No./N° VME

AMENDMENT 002

WAREHOUSE RACKING

This amendment to this Request for Proposal is raised to answer questions:

QUESTION 1:

What is the width of the blue columns?

ANSWER 1:

8 inches

QUESTION 2:

Is the Contractor required to dispose of the old racking? If so, can the racking be disposed of while being dismantled?

ANSWER 2:

Yes, the Contractor is responsible to dispose of the old racking. The old racking can be moved to Bldg H-110 Base Supply for storage until the Contractor is ready to dispose of it.

QUESTION 3:

Can the Contractor use a portion of the aisle to accommodate the spacers that are required?

ANSWER 3:

Yes, the spacers can be placed to the outer edge of the yellow line.

QUESTION 4:

What is the accumulative weight capacity of the shelving?

ANSWER 4:

Each shelf must hold a minimum of 2000 lbs for a total minimum racking bay weight of 10,000 lbs.

QUESTION 5:

Is the labourer used to install the warehouse racking required to be unionized?

ANSWER 5:

The Contractor is responsible to decide whether they choose to employ union or non-unionized staff.

QUESTION 6:

Can building drawings be provided?

ANSWER 6 :

See Annex A below

QUESTION 7:

The current racking is ready rack. Is this the type of racking DND is looking for?

Solicitation No. - N° de l'invitation
W0107-22MB03/A
Client Ref. No. - N° de réf. du client
W0107-22MB03

Amd. No. - N° de la modif.
002
File No. - N° du dossier
PET-1-55006

Buyer ID - Id de l'acheteur
PET907
CCC No./N° CCC - FMS No./N° VME

ANSWER 7 :

Yes.

QUESTION 8:

Is there a colour preference?

ANSWER 8 :

No.

QUESTION 9:

What is the aisle width?

ANSWER 9 :

It is 8 ft now, but will be required to be 9 ft after the new installation.

QUESTION 10:

What is the length of each aisle? Can schematics be provided?

ANSWER 10 :

The racking is currently 5 bays deep and each aisle is 40 ft long. Schematics are provided at Annex B below.

QUESTION 11:

How much room is in the back to move racking?

ANSWER 11 :

Approximately 3 ft.

QUESTION 12:

When will this contract be awarded?

ANSWER 12 :

As soon as possible after the evaluation is complete.

QUESTION 13:

Are wire mesh shelves required?

ANSWER 13 :

Yes, for safety reasons.

QUESTION 14:

Are the wire mesh shelving required to be RMI certified?

ANSWER 14 :

Yes, the wire mesh shelving must be RMI R-Mark certified or equivalent industry standard.

QUESTION 15:

What is the width from the inside of the post connector per bay?

ANSWER 15 :

108 inches or 9 feet.

QUESTION 16:

What is the required height for the post protectors?

ANSWER 16 :

24 inches for each post, which are installed on the outside of the post and bolted to the ground.

QUESTION 17:

Page 17 point 7.b – dimensions mentioned are : 2.5 x 5 x 272 cms - is it 5inch or cm? Beam, 108" x 5" x 2.5", Step or Box beam?

ANSWER 17 :

Dimensions are in centimetres. Step beams are preferred.

QUESTION 18:

What is the clear height of the building?

ANSWER 18 :

We do not have exact clear height but the current shelving units are approximately 18 feet (+/- 5%).

QUESTION 19:

In technical criteria, you have mentioned lateral support beam dimensions. What is the beam profile height you are looking for, 4"?

ANSWER 19 :

Current beam profile is 4"

QUESTION 20:

In technical criteria, you have mentioned bay capacity. If we break it down to per level, what is the minimum beam capacity you are looking for?

ANSWER 20 :

Each shelf must hold a minimum of 2000 lbs for a total minimum racking bay weight of 10,000 lbs.

QUESTION 21:

Are you looking to use reach truck or counter balance to determine aisle width?

ANSWER 20 :

There is currently a 9.5 foot clearance for current counter balance forklift.

Solicitation No. - N° de l'invitation
W0107-22MB03/A
Client Ref. No. - N° de réf. du client
W0107-22MB03

Amd. No. - N° de la modif.
002
File No. - N° du dossier
PET-1-55006

Buyer ID - Id de l'acheteur
PET907
CCC No./N° CCC - FMS No./N° VME

ANNEX A

Building floor plan H-112

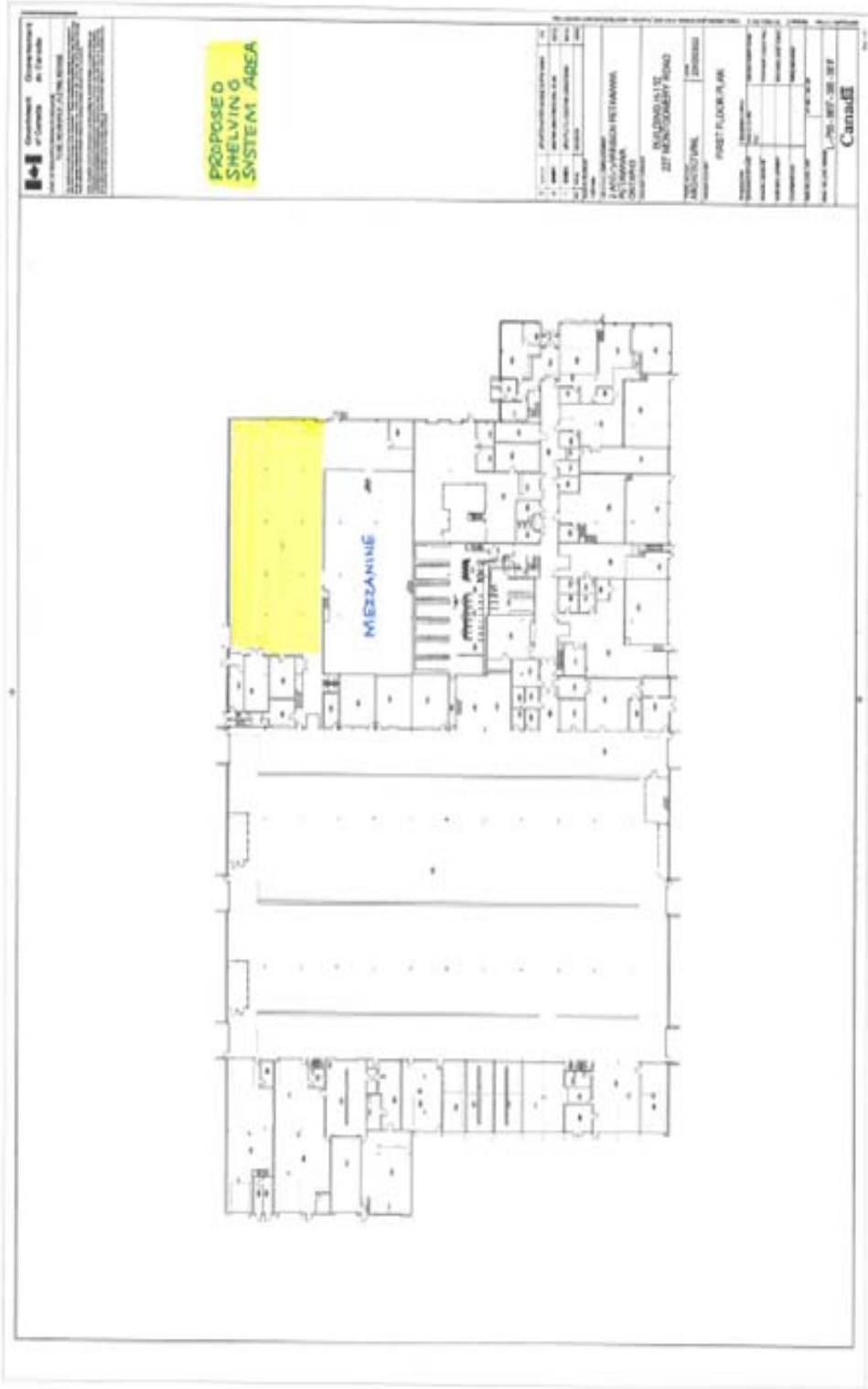

Solicitation No. - N° de l'invitation
W0107-22MB03/A
Client Ref. No. - N° de réf. du client
W0107-22MB03

Amd. No. - N° de la modif.
002
File No. - N° du dossier
PET-1-55006

Buyer ID - Id de l'acheteur
PET907
CCC No./N° CCC - FMS No./N° VME

