

- GENERAL NOTES:**
- CONTRACTOR TO VERIFY LOCATION OF ALL BURIED SERVICES PRIOR TO START OF CONSTRUCTION.
  - TOPOGRAPHIC INFORMATION PROVIDED BY RONALD H. SMITH LTD. (JULY 2012). REFER TO CONTROL POINT (00819730538) LOCATION SHOWN ON KEY PLAN, NORTHING=4899107.479, EASTING=375921.245, ELEVATION = 84.229m.
  - GEOTECHNICAL INFORMATION PROVIDED BY DBA ENGINEERING LTD. (NOVEMBER 2012).
  - EXISTING BUILDINGS AND TREES TO BE PROTECTED DURING CONSTRUCTION UNLESS INDICATED OTHERWISE.
  - REINSTATE DISTURBED AREAS TO ORIGINAL CONDITION OR BETTER AND GRADE SURROUNDING AREAS AT 4H:1V FOR TIE-IN. COORDINATE WITH DEPARTMENT REPRESENTATIVE PRIOR TO COMMENCING RESTORATION.
  - HEAVY DUTY SILT FENCE AS PER OPSD 219.130 TO BE INSTALLED DOWN STREAM OF CONSTRUCTION.
  - (S) - SWALE GRADE; (TOC) - TOP OF CURB GRADE; (BOC) - BOTTOM OF CURB GRADE
  - TEST EXCAVATIONS ARE TO BE COMPLETED AT ALL UTILITY TIE-INS AND UTILITY CROSSINGS. EXCAVATION IS TO BE COMPLETED AND ANY DISCREPANCIES OR CONFLICTS WITH THE INFORMATION PROVIDED IS TO BE SUBMITTED TO THE DEPARTMENTAL REPRESENTATIVE SEVEN (7) DAYS IN ADVANCE OF THE WORK.
  - THE CONTRACTOR IS TO COORDINATE ALL TRENCHING ACTIVITIES WITH THE DEPARTMENTAL REPRESENTATIVE. THE LENGTH OF OPEN UTILITY TRENCHES SHALL BE LIMITED TO 5.0m OR OTHERWISE DIRECTED BY THE DEPARTMENTAL REPRESENTATIVE. TRENCHING SHALL START AT THE TIE IN OR THE NEW BUILDING.
  - 1.8m HIGH RIGID FENCING TO BE PLACED AROUND THE ENTIRE PERIMETER OF ALL OPEN EXCAVATIONS.

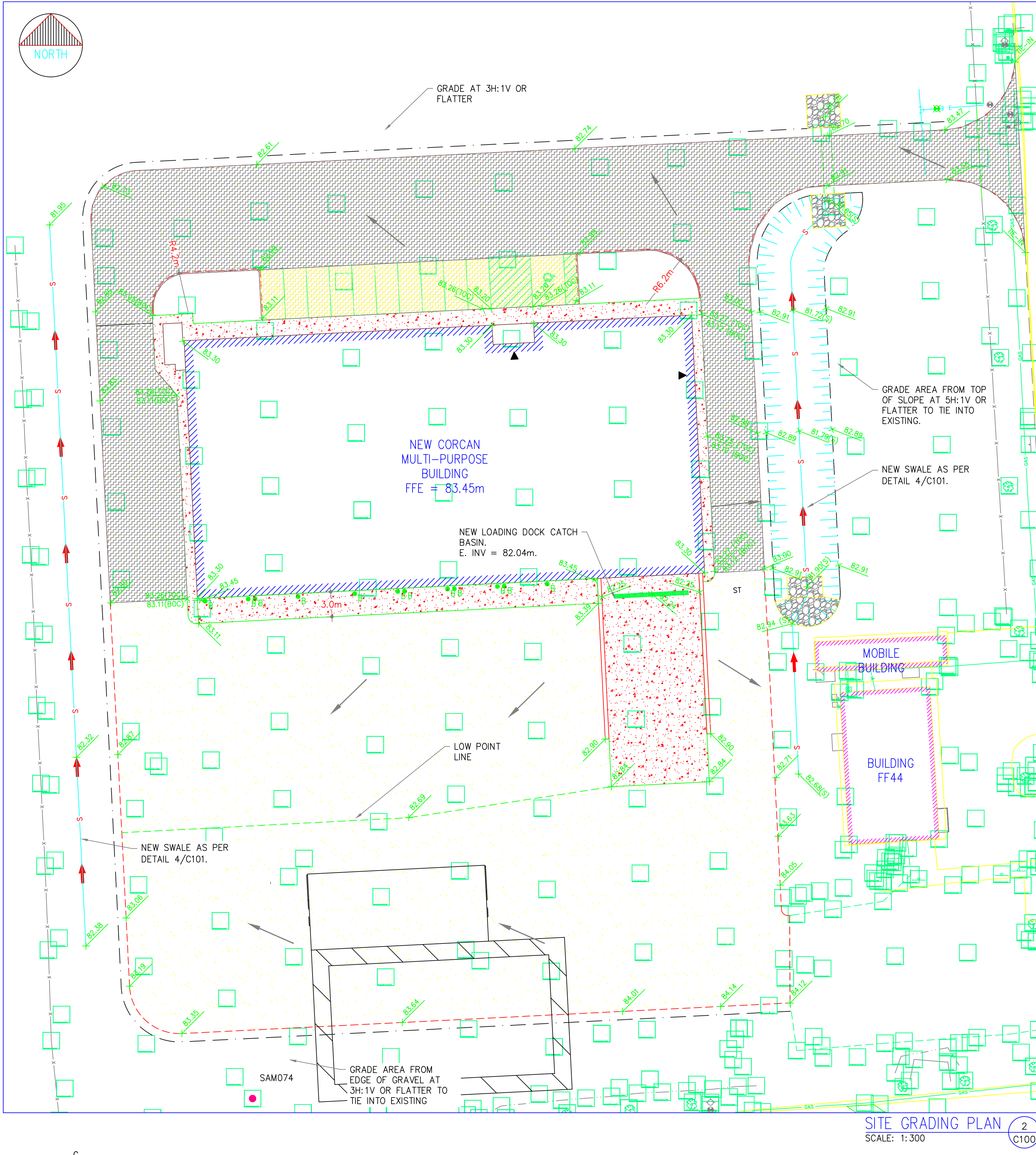
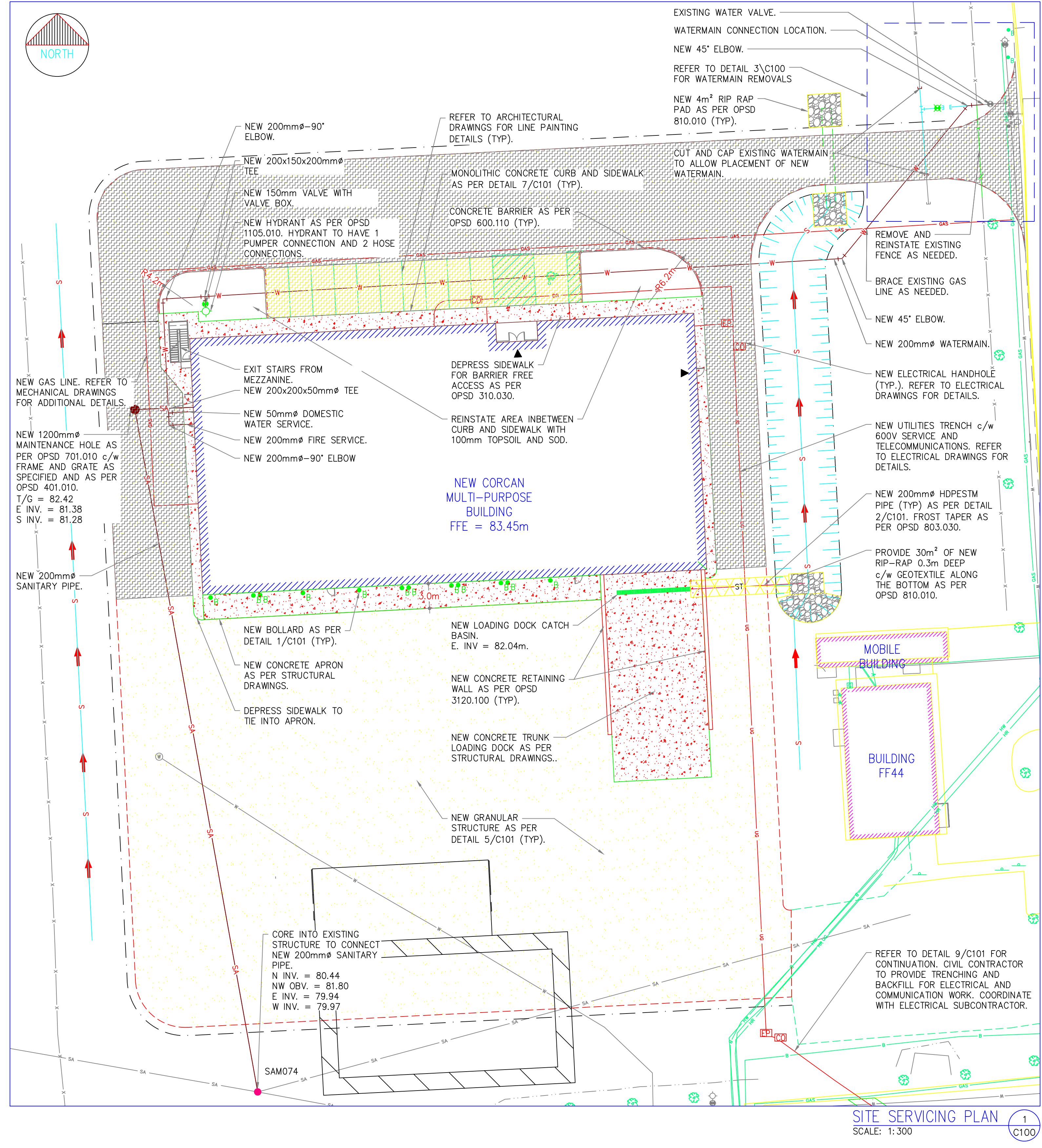
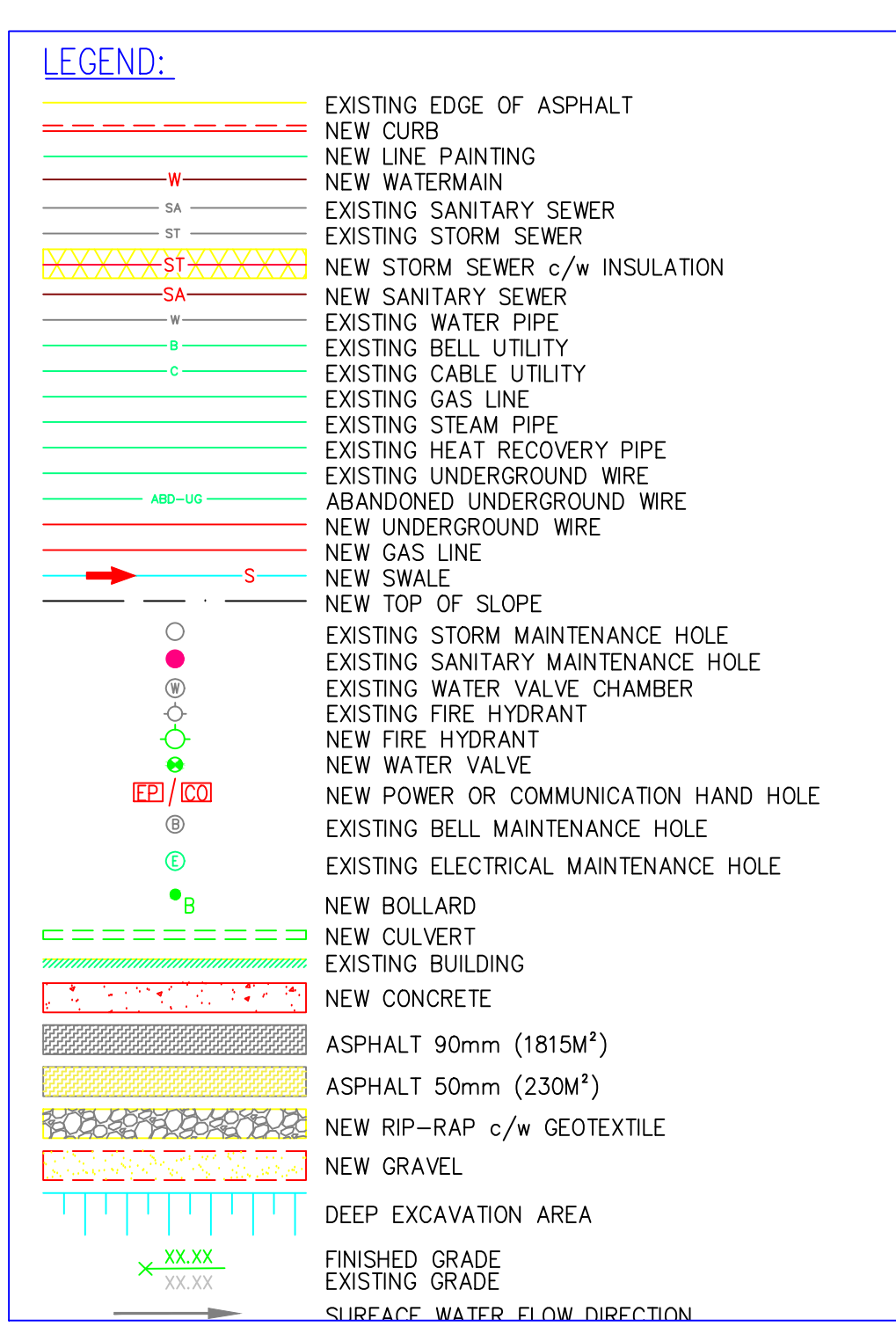

key plan	plan-dé	
01	ISSUED FOR TENDER	15/03/16
revision	description	date
A	A detail no. m <sup>2</sup> du détail	A
B	B location drawing no. sur dessin m <sup>2</sup>	B
C	C drawing no. dessin m <sup>2</sup>	C
project	<p style="text-align: center;"><b>CSC MULTI-PURPOSE BUILDING</b>  <b>CBI MINIMUM INSTITUTION (FRONTENAC)</b>          KINGSTON, ONTARIO</p>	
drawing	<p style="text-align: center;"><b>CIVIL</b>  <b>SITE PLAN &amp; GRADING</b></p>	
designed	conqu	
date	(yyyy/mm/dd)	
drawn	dessiné	
date	(yyyy/mm/dd)	
reviewed	examiné	
date	(yyyy/mm/dd)	
approved	approuvé	
date	(yyyy/mm/dd)	
Tender	Soumission	
Project Manager	Administrateur de projets	
project no.	no. du projet	
drawing no.	no. du dessin	
<b>C100</b>		

02.02.2015  
MPB-CORCAN C100.dwg