

Fisheries and Oceans
Canada

Pêches et Océans
Canada

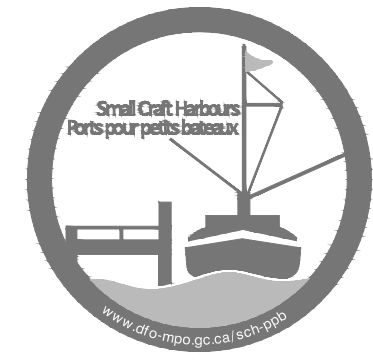

Small Craft Harbours
Newfoundland Region
St. John's, NL.

Ports Pour Petits Bateaux

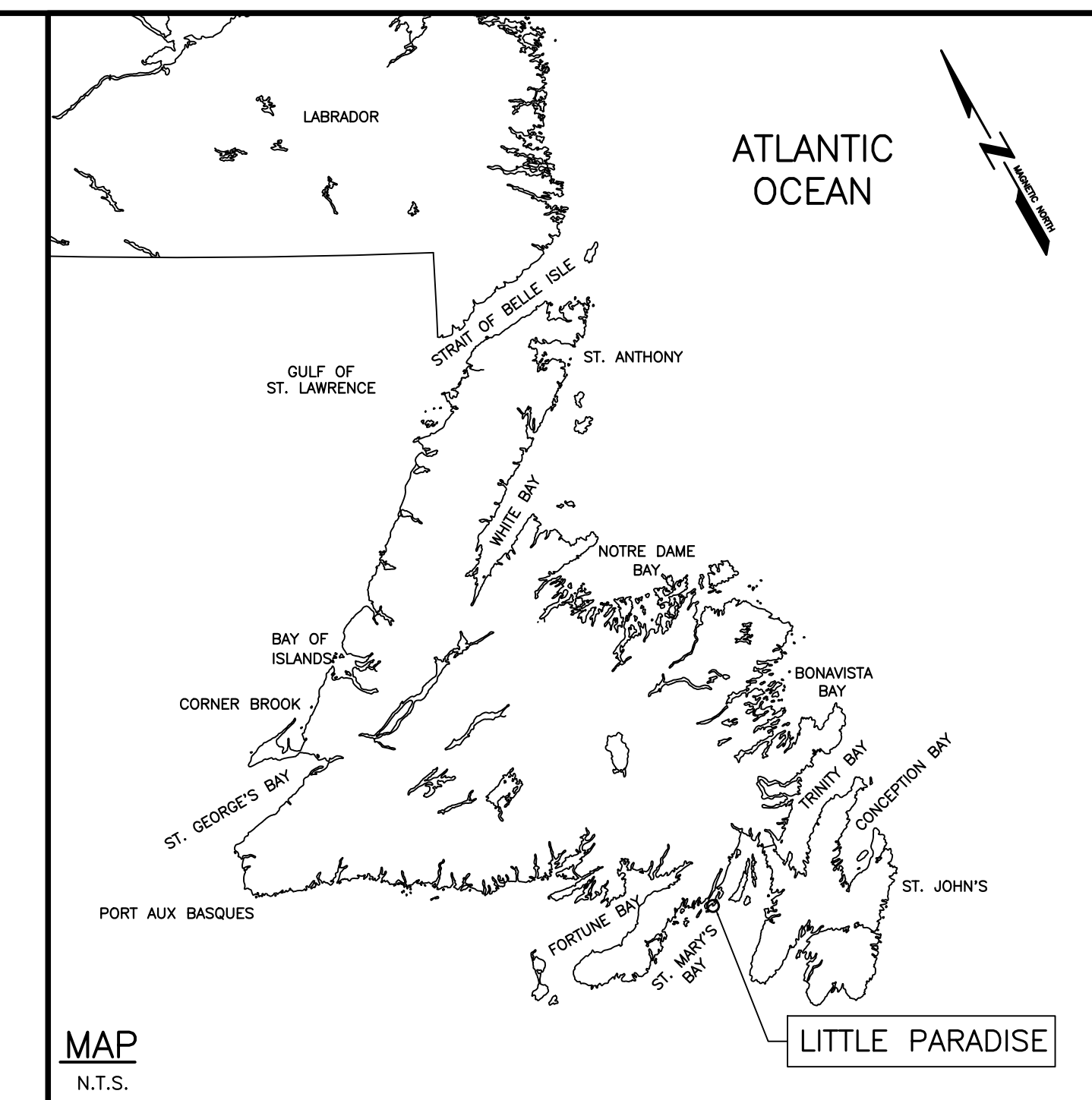

WHARF DEMOLITION

DRAWING LIST

LITTLE PARADISE

CIVIL

- C1 OF 5 EXISTING SITE PLAN (PRIOR TO STORM DAMAGE)
- C2 OF 5 EXISTING WHARF & BUILDING COMPONENT PLAN (PRIOR TO STORM DAMAGE)
- C3 OF 5 EXISTING WHARF & BUILDING SECTION (PRIOR TO STORM DAMAGE)
- C4 OF 5 EXISTING / DEMOLITION SITE PLAN (AFTER STORM DAMAGE)
- C5 OF 5 NEW SITE PLAN

NEWFOUNDLAND AND LABRADOR

PROJECT NO. C2-00113-04-02-01

SMALL CRAFT HARBOURS



NOTES:

1. ALL ELEVATIONS ARE IN METRES UNLESS OTHERWISE NOTED.
2. ALL DIMENSIONS ARE IN MILLIMETRES UNLESS OTHERWISE NOTED.
3. DO NOT SCALE FROM DRAWING, USE DIMENSIONS SHOWN.
4. SHEET C1 IS PROVIDED FOR INFORMATION PURPOSES ONLY, TO SHOW THE APPROXIMATE SITE FEATURES/CONDITIONS PRIOR TO STORM DAMAGE. THIS IS NOT THE CURRENT EXISTING SITE CONDITION. REFER TO SHEET C4.

GENERAL LEGEND:

DENOTES STRUCTURES DAMAGED DURING STORM. ALL EXISTING DAMAGED STRUCTURES TO BE COMPLETELY DEMOLISHED AND REMOVED BASED ON THEIR CURRENT CONDITION. REFER TO SHEET C4.

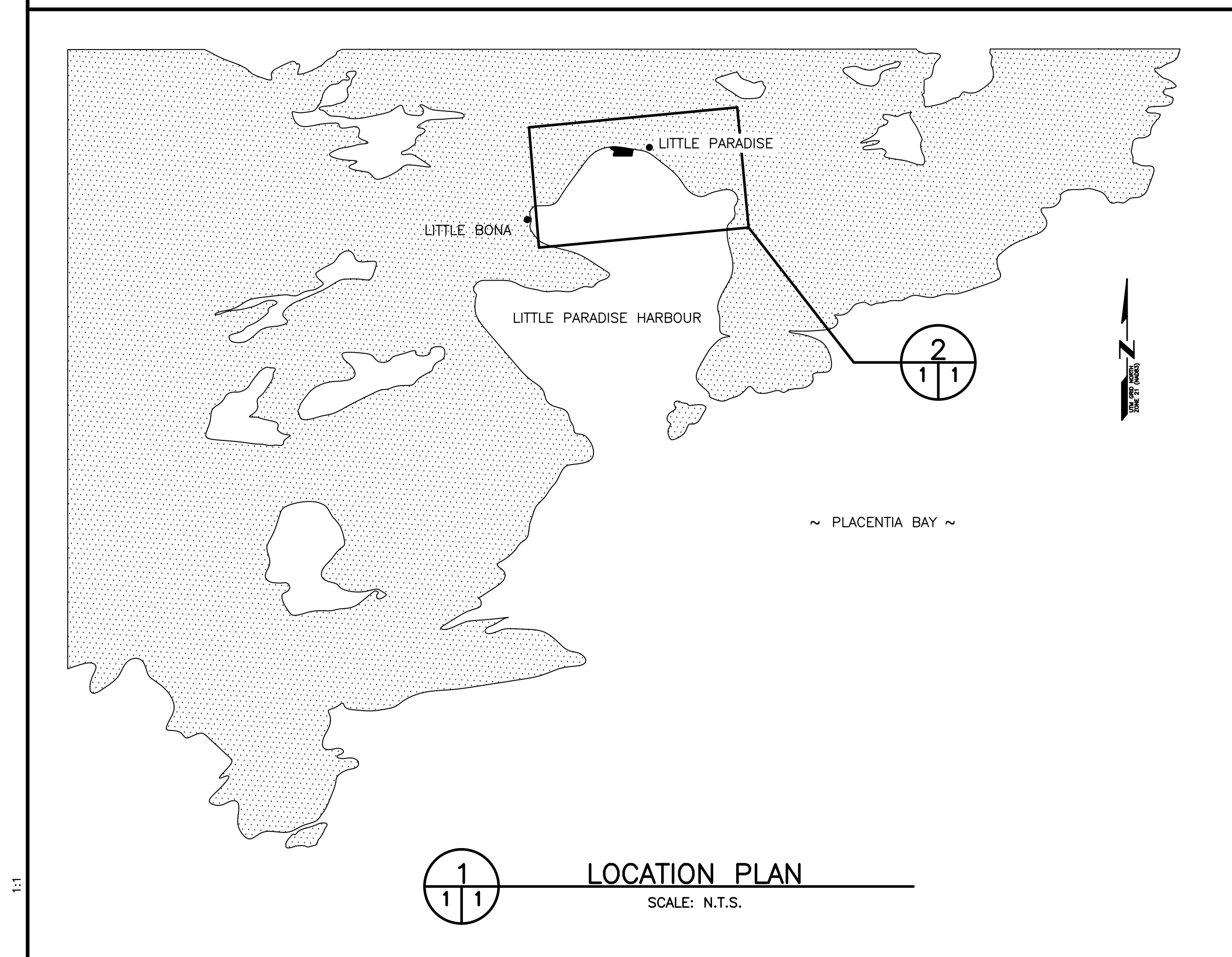
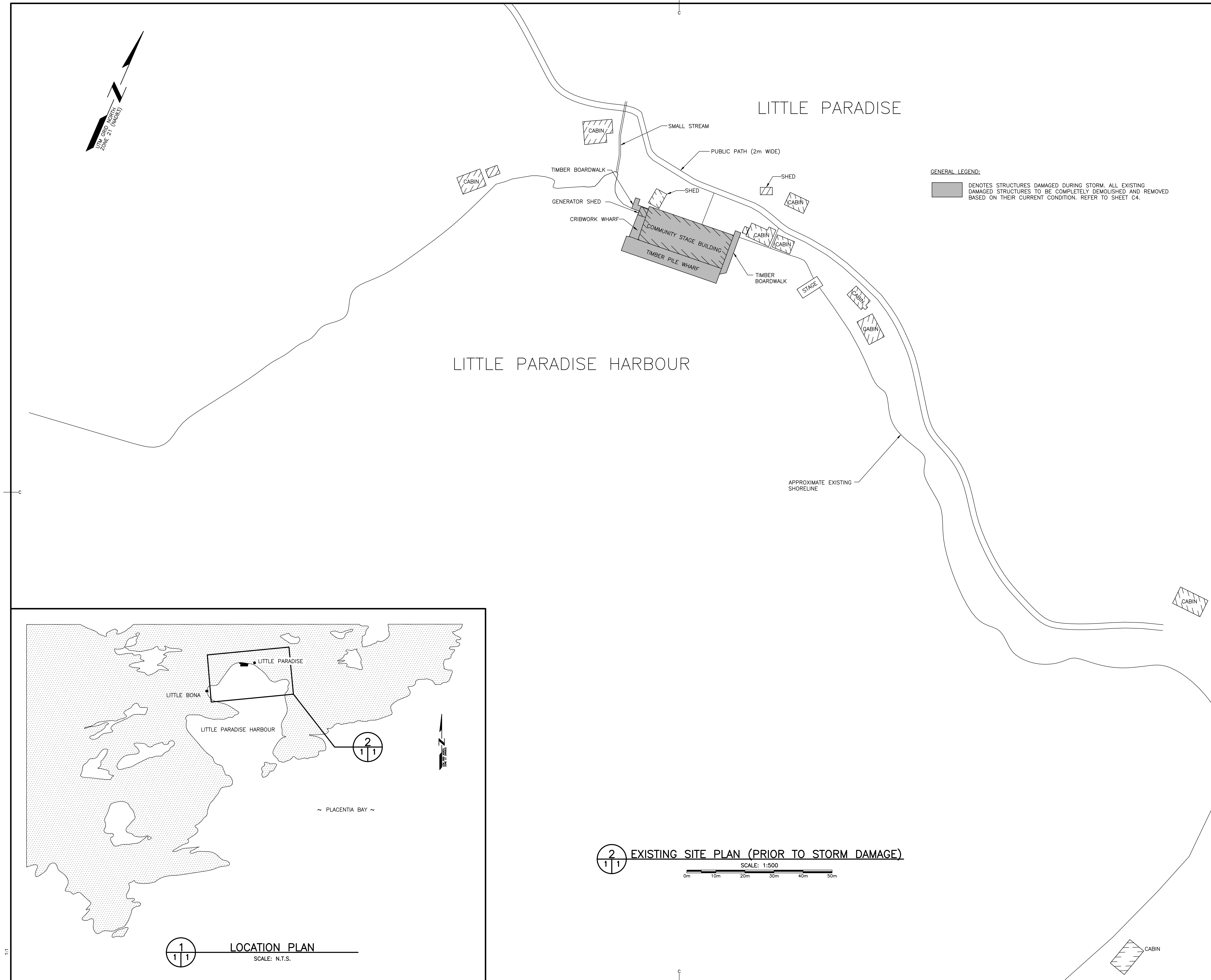

2 EXISTING SITE PLAN (PRIOR TO STORM DAMAGE)
SCALE: 1:500



PROVINCE OF NEWFOUNDLAND AND LABRADOR
P.E.G. PERMIT HOLDER
 This Permit Allows
Meridian Engineering Inc.
 Member No. 04378
 To practice Professional Engineering in Newfoundland and Labrador.
 Permit No. as issued by PEG 20153
 which is valid for the year 2021.

revisions	date
project	project
C	ISSUED FOR TENDER 21/10/07
B	ISSUED FOR 99% REVIEW 21/10/05
A	ISSUED FOR 33% REVIEW 21/09/29

**WHARF DEMOLITION
LITTLE PARADISE, NL**

**EXISTING SITE PLAN
(PRIOR TO STORM DAMAGE)**

designed C. FISHER	conçu
date SEPTEMBER, 2021	
drawn R. SNOW	dessiné
date SEPTEMBER, 2021	
approved	approuvé
date	
Tender	Soumission
DFO Project Manager	Administrateur de projets MPD
project number	no. du projet
C2-00113-04-02-01	
drawing no.	no. du dessin
C1 OF 5	

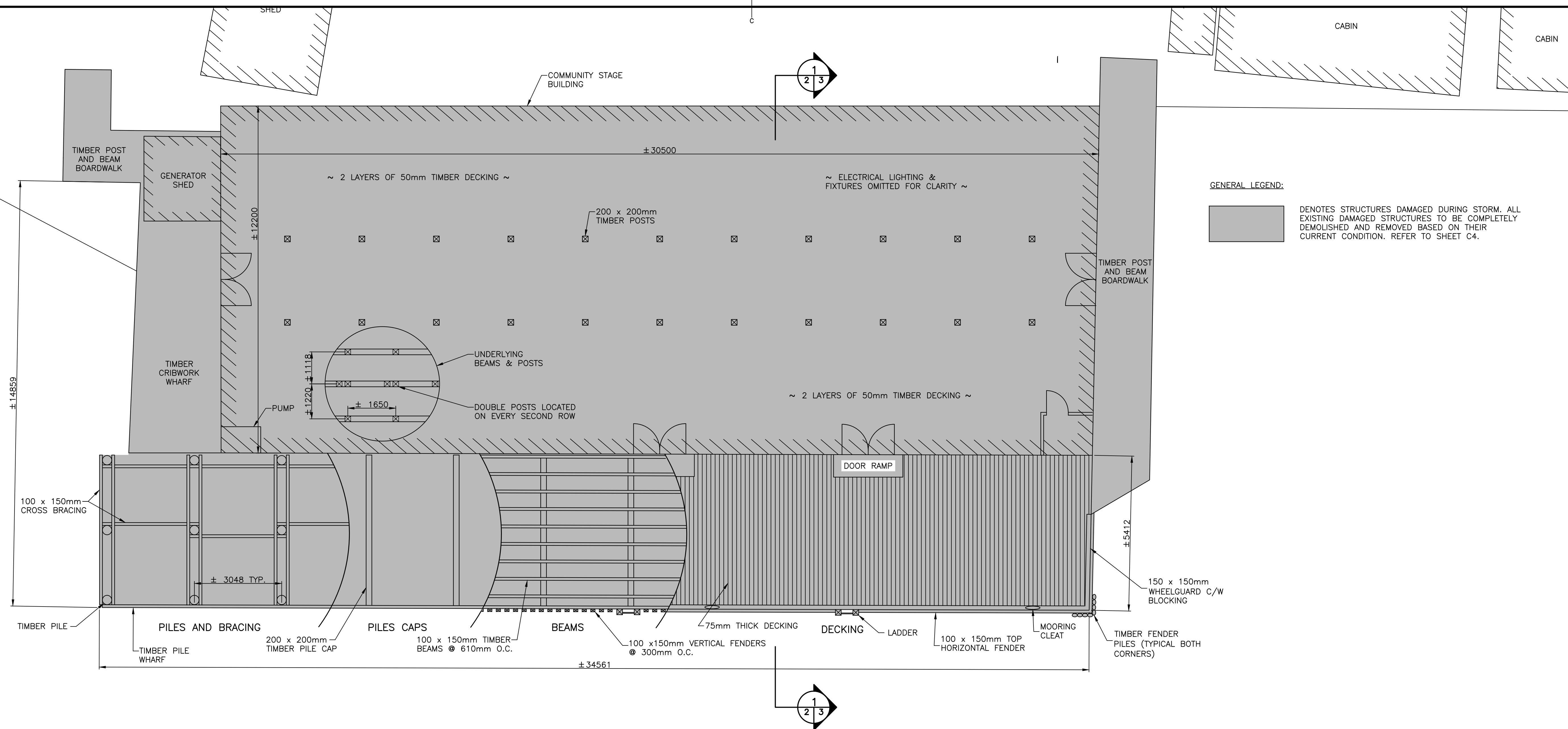

GENERAL LEGEND:

DENOTES STRUCTURES DAMAGED DURING STORM. ALL EXISTING DAMAGED STRUCTURES TO BE COMPLETELY DEMOLISHED AND REMOVED BASED ON THEIR CURRENT CONDITION. REFER TO SHEET C4.

SMALL CRAFT HARBOURS



- NOTES:**
1. ALL ELEVATIONS ARE IN METRES UNLESS OTHERWISE NOTED.
 2. ALL DIMENSIONS ARE IN MILLIMETRES UNLESS OTHERWISE NOTED.
 3. DO NOT SCALE FROM DRAWING, USE DIMENSIONS SHOWN.
 4. SHEET C2 IS PROVIDED FOR INFORMATION PURPOSES ONLY, TO SHOW THE APPROXIMATE SITE FEATURES/CONDITIONS PRIOR TO STORM DAMAGE. THIS IS NOT THE CURRENT EXISTING SITE CONDITION. REFER TO SHEET C4.
 5. RELIABLE AS-BUILT INFORMATION IS LIMITED. EXISTING WHARF, BUILDING AND BOARDWALK PLANS AND SECTIONS ARE SHOWN FOR GENERAL INFORMATION ONLY AND MAY VARY THROUGHOUT. DIMENSIONS INDICATED ARE TO BE CONSIDERED APPROXIMATE, INCLUDING MEMBER SIZES, AND THE CONTRACTOR IS RESPONSIBLE TO VERIFY IN THE FIELD. ALL MISCELLANEOUS BLOCKING, FASTENERS, ETC. ARE OMITTED FOR CLARITY. CONTRACTOR TO BASE COST FOR DEMOLITION AND ASSOCIATED RISKS ACCORDINGLY.

1 EXISTING WHARF & BUILDING COMPONENT PLAN (PRIOR TO STORM DAMAGE)

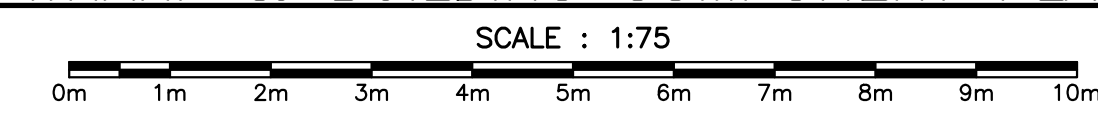

PROVINCE OF NEWFOUNDLAND AND LABRADOR
P.E.G. PERMIT HOLDER
 This Permit Allows
Meridian Engineering Inc.
 Member No. 04378
 To provide Professional Engineering
 in Newfoundland and Labrador.
 Permit No. as issued by PEG: 20153
 which is valid for the year 2021.

revisions	date
project	project
C	ISSUED FOR TENDER 21/10/07
B	ISSUED FOR 99% REVIEW 21/10/05
A	ISSUED FOR 33% REVIEW 21/09/29

WHARF DEMOLITION
LITTLE PARADISE, NL

EXISTING WHARF & BUILDING COMPONENT PLAN (PRIOR TO STORM DAMAGE)

designed	C. FISHER	conçu
date	SEPTEMBER, 2021	
drawn	R. SNOW	dessiné
date	SEPTEMBER, 2021	
approved		approuvé
date		
Tender		Soumission
DFO Project Manager	Administrateur de projets MPD	
project number	no. du projet	
C2-00113-04-02-01		
drawing no.	no. du dessin	
C2 OF 5		

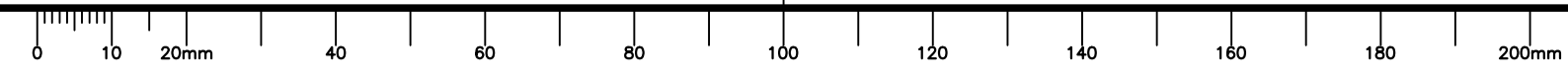

SMALL CRAFT HARBOURS



- NOTES:**
1. ALL ELEVATIONS ARE IN METRES UNLESS OTHERWISE NOTED.
 2. ALL DIMENSIONS ARE IN MILLIMETRES UNLESS OTHERWISE NOTED.
 3. DO NOT SCALE FROM DRAWING, USE DIMENSIONS SHOWN.
 4. SHEET C3 IS PROVIDED FOR INFORMATION PURPOSES ONLY, TO SHOW THE APPROXIMATE SITE FEATURES/CONDITIONS PRIOR TO STORM DAMAGE. THIS IS NOT THE CURRENT EXISTING SITE CONDITION. REFER TO SHEET C4.
 5. ALL RECOVERED ITEMS LISTED SHALL BE SALVAGED AND REMAIN ON-SITE. STORE ITEMS IN A LOCATION APPROVED BY THE DEPARTMENTAL REPRESENTATIVE.
 6. RELIABLE AS-BUILT INFORMATION IS LIMITED. EXISTING WHARF, BUILDING AND BOARDWALK PLANS AND SECTIONS ARE SHOWN FOR GENERAL INFORMATION ONLY AND MAY VARY THROUGHOUT. DIMENSIONS INDICATED ARE TO BE CONSIDERED APPROXIMATE, INCLUDING MEMBER SIZES, AND THE CONTRACTOR IS RESPONSIBLE TO VERIFY IN THE FIELD. ALL MISCELLANEOUS BLOCKING, FASTENERS, ETC. ARE OMITTED FOR CLARITY. CONTRACTOR TO BASE COST FOR DEMOLITION AND ASSOCIATED RISKS ACCORDINGLY.



PROVINCE OF NEWFOUNDLAND AND LABRADOR
 PERMIT HOLDER
 This Permit Allows
Meridian Engineering Inc.
 Member No. 04378
 To provide Professional Engineering in Newfoundland and Labrador.
 Permit No. as issued by PEG 20153
 which is valid for the year 2021.

C	ISSUED FOR TENDER	21/10/07
B	ISSUED FOR 99% REVIEW	21/10/05
A	ISSUED FOR 33% REVIEW	21/09/29

revisions	date
project	projct

**WHARF DEMOLITION
 LITTLE PARADISE, NL**

**EXISTING WHARF &
 BUILDING SECTION
 (PRIOR TO
 STORM DAMAGE)**

designed	C. FISHER	concu
date	SEPTEMBER, 2021	
drawn	R. SNOW	dessine
date	SEPTEMBER, 2021	
approved		approuve
date		
Tender		Soumission
DFO Project Manager	Administrateur de projets MPD	
project number	no. du projet	
	C2-00113-04-02-01	
drawing no.	no. du dessin	
	C3 OF 5	

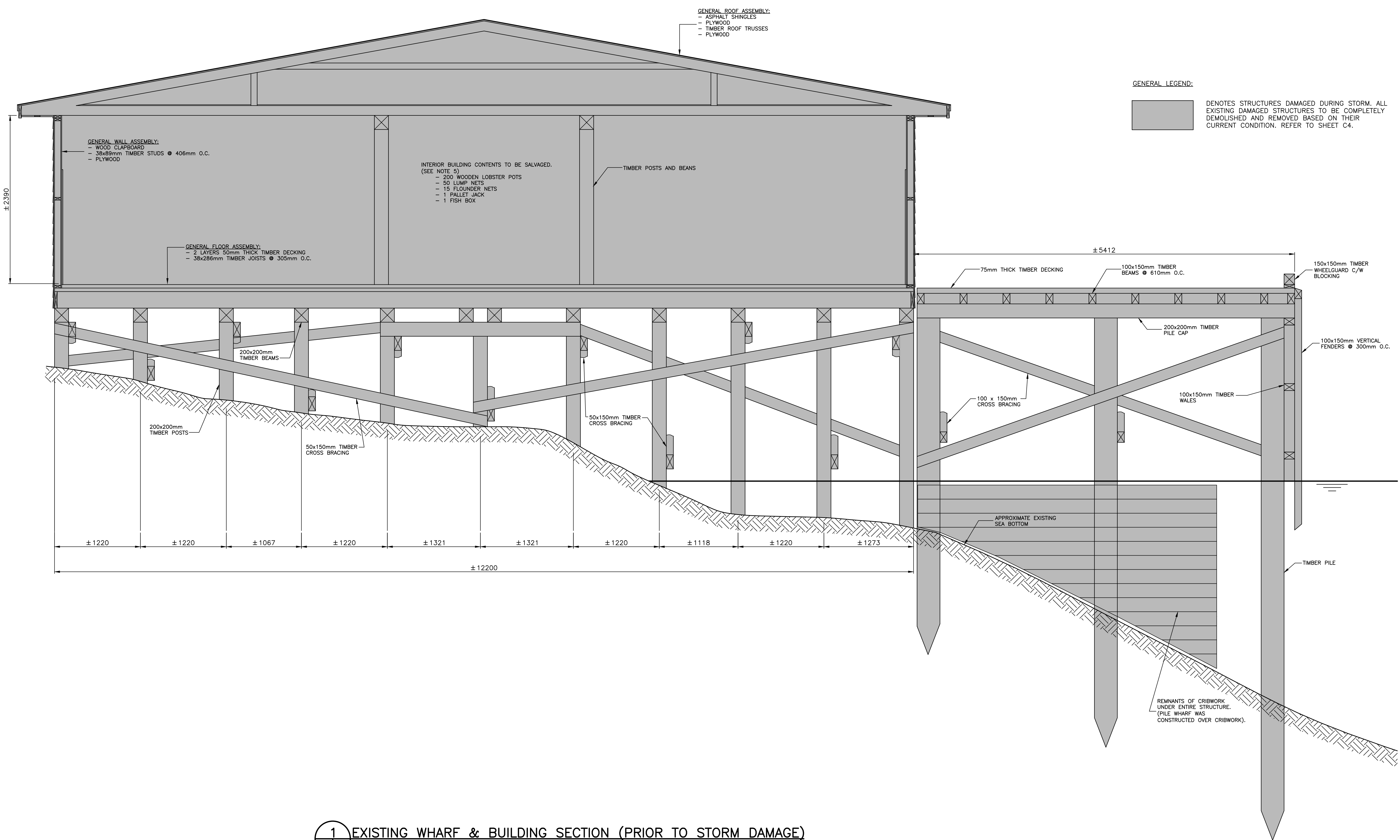

1 EXISTING WHARF & BUILDING SECTION (PRIOR TO STORM DAMAGE)
 SCALE: 1:25
 0mm 500mm 1000mm 1500mm 2000mm 2500mm

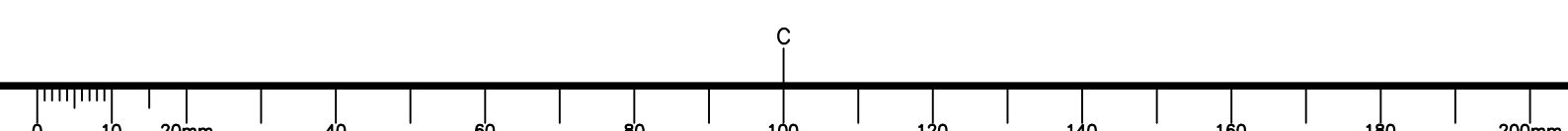

- GENERAL LEGEND:**
- EXISTING FOOTPRINT OF WHARF, COMMUNITY STAGE BUILDING AND BOARDWALKS PRIOR TO STORM DAMAGE
 - DENOTES REMNANTS OF EXISTING STRUCTURES DAMAGED DURING THE STORM TO BE COMPLETELY REMOVED. SEE NOTE 9
 - ▨ DENOTES FLOATING/ABOVE WATER MATERIAL/DEBRIS SCATTERED THROUGHOUT THE HARBOUR TO BE COMPLETELY REMOVED WITHIN LIMITS SPECIFIED. SEE NOTE 9
 - ▧ DENOTES UNDERWATER MATERIAL/DEBRIS SCATTERED THROUGHOUT THE HARBOUR TO BE COMPLETELY REMOVED WITHIN LIMITS SPECIFIED. SEE NOTE 9
 - ✂ DENOTES TIMBER MATERIAL SCATTERED THROUGHOUT THE HARBOUR TO BE COMPLETELY REMOVED WITHIN LIMITS SPECIFIED. SEE NOTE 9
 - DENOTES SHORELINE MATERIAL/DEBRIS REMOVAL LIMITS (APPROX 500m IN LENGTH). REFER TO HARBOUR CLEAN-UP PLAN AND NOTE 6.
 - DENOTES REMOVAL LIMITS AROUND EXISTING STRUCTURE LOCATION. SEE NOTE 7.

LITTLE PARADISE

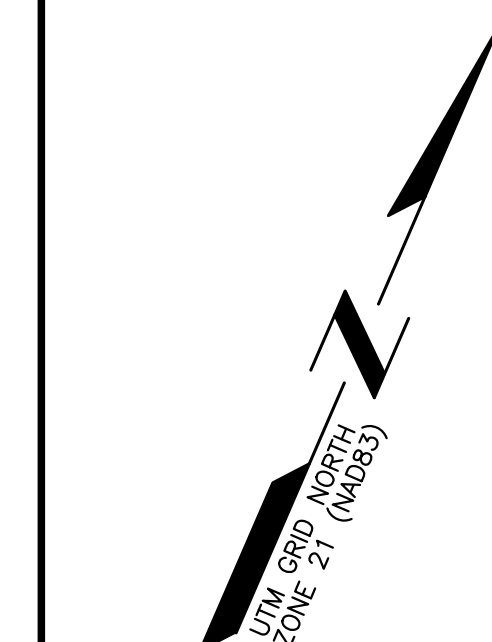

LIMITS OF SHORELINE REMOVAL
SEE NOTE 6

~ FLOATING DEBRIS CLEAN-UP ~
(REFER TO HARBOUR CLEAN-UP PLAN FOR LIMITS AND NOTE 5)

LITTLE PARADISE HARBOUR

SEE NOTE 6 FOR SHORELINE
REMOVAL LIMITS

- NOTES:**
1. ALL ELEVATIONS ARE IN METRES UNLESS OTHERWISE NOTED.
 2. ALL DIMENSIONS ARE IN MILLIMETRES UNLESS OTHERWISE NOTED.
 3. DO NOT SCALE FROM DRAWING, USE DIMENSIONS SHOWN.
 4. THE ENTIRE WHARF, BUILDING AND BOARDWALK STRUCTURES ARE TO BE FULLY DEMOLISHED AND REMOVED FROM SITE. REFER TO SHEETS C1, C2 AND C3 FOR THE TYPICAL CONSTRUCTION ARRANGEMENT OF EACH OF THE STRUCTURES PRIOR TO STORM DAMAGE. ENSURE ALL ITEMS WHICH ARE DESIGNATED FOR REMOVAL ARE FULLY EXTRACTED IN THEIR ENTIRETY, INCLUDING ALL TIMBER PILES AND POSTS (DO NOT CUT PILES/POSTS OFF), AND ANY CRIBWORK SETTLED INTO THE SEA BOTTOM.
 5. ALL FLOATING DEBRIS WITHIN THE LIMITS DEFINED ON THE HARBOUR CLEAN-UP PLAN, SHALL BE COMPLETELY REMOVED.
 6. SHORELINE REMOVAL LIMITS, (APPROX. 500m IN LENGTH), SHALL SPAN FROM 5M ABOVE NORMAL HIGH-WATER LEVEL TO 10M BELOW NORMAL LOW-WATER LEVEL, MEASURED PERPENDICULAR TO THE SHORELINE. ALL ABOVE AND BELOW WATER SHORELINE MATERIAL/DEBRIS WITHIN THESE LIMITS SHALL BE COMPLETELY REMOVED.
 7. REMOVE ALL ABOVE AND BELOW WATER MATERIAL/DEBRIS WITHIN A 20M HORIZONTAL OFFSET AROUND THE EXISTING STRUCTURE FACE.
 8. CONTRACTOR WILL BE REQUIRED TO PROVIDE AN UNDERWATER DIVING VIDEO AT PROJECT COMPLETION CONFIRMING ALL MATERIAL/DEBRIS HAS BEEN REMOVED WITHIN THE LIMITS INDICATED.
 9. THE LOCATION OF THE EXISTING STRUCTURES AND THE MATERIAL/DEBRIS SHOWN SHALL BE CONSIDERED APPROXIMATE ONLY. THESE LOCATIONS REFLECT THE GENERAL LOCATION AS VIEWED ON SEPTEMBER 20, 2021 AND DOES NOT ACCOUNT FOR ALL LOCATIONS SCATTERED THROUGHOUT THE HARBOUR. IT IS EXPECTED THAT THESE LOCATIONS WILL VARY/SHIFT, WITHIN THE HARBOUR, PRIOR TO CONSTRUCTION ACTIVITIES. CONTRACTOR TO CONFIRM EXACT LOCATIONS IN THE FIELD AND TO BASE COST FOR DEMOLITION/REMOVAL AND ASSOCIATED RISKS ACCORDINGLY.
 10. THE EXISTING STRUCTURES ARE IN A STATE OF DISREPAIR, COLLAPSED, AND ARE STRUCTURALLY UNSAFE. THE CONTRACTOR SHALL DETERMINE WHAT SAFETY MEASURES NEED TO BE TAKEN DURING DEMOLITION/CONSTRUCTION ACTIVITIES. PERFORM SURVEY OF THE CONDITION OF THE STRUCTURES TO DETERMINE IF WHETHER REMOVING ANY ELEMENT MIGHT RESULT IN FURTHER STRUCTURAL DEFICIENCY OR UNPLANNED COLLAPSE OF ANY PORTION.
 11. RELIABLE AS-BUILT INFORMATION IS LIMITED. EXISTING WHARF, BUILDING AND BOARDWALK PLANS AND SECTIONS ARE SHOWN FOR GENERAL INFORMATION ONLY AND MAY VARY THROUGHOUT. DIMENSIONS INDICATED ARE TO BE CONSIDERED APPROXIMATE, INCLUDING MEMBER SIZES, AND THE CONTRACTOR IS RESPONSIBLE TO VERIFY IN THE FIELD. ALL MISCELLANEOUS BLOCKING, FASTENERS, ETC. ARE OMITTED FOR CLARITY. CONTRACTOR TO BASE COST FOR DEMOLITION AND ASSOCIATED RISKS ACCORDINGLY. REFER TO SHEETS C1, C2 AND C3 FOR APPROXIMATE SITE FEATURES, CONDITIONS, AND CONSTRUCTION ARRANGEMENT PRIOR TO STORM DAMAGE.
 12. CONTRACTOR SHALL PROTECT ALL EXISTING ADJACENT PROPERTIES/INFRASTRUCTURE AND SHALL RESTORE ANY AREAS DISTURBED DURING CONSTRUCTION ACTIVITIES. DAMAGE TO GROUND AND PROPERTY WILL BE REPAIRED BY THE CONTRACTOR AS THEIR OWN COST.
 13. IF NECESSARY, PRIOR TO DEMOLITION OF STRUCTURES, DEACTIVATE POWER TO THE AFFECTED FIXTURES AND TERMINATE AND REMOVE ALL CABLING.
 14. REFER TO SECTION 02 41 16 - SITEWORK, DEMOLITION AND REMOVAL. ALL DEMOLITION MATERIAL TO BE DISPOSED AT A PROVINCIALLY APPROVED WASTE DISPOSAL FACILITY, UNLESS NOTED OTHERWISE. EXPECT TO ENCOUNTER CREOSOTE TIMBER THROUGHOUT THE EXISTING STRUCTURES/DEBRIS. ALL CREOSOTE MATERIAL TO BE DISPOSED OF AT THE APPROVED WASTE DISPOSAL FACILITY IN ROBIN HOOD BAY OR NORRIS ARM.
 15. ALL INTERIOR BUILDING CONTENTS LISTED ON SHEET C3 SHALL BE SALVAGED AND REMAIN ON-SITE. STORE ITEMS IN A LOCATION APPROVED BY THE DEPARTMENTAL REPRESENTATIVE.
 16. CONTRACTOR TO USE CAUTION DURING DEMOLITION/CONSTRUCTION ACTIVITIES FOR ANY UNDERGROUND UTILITIES OR SERVICES NOT IDENTIFIED ON THE DRAWINGS. ANY SERVICE ENCOUNTERED SHALL BE PROPERLY REROUTED OR TERMINATED TO APPROVAL OF DEPARTMENTAL REPRESENTATIVE AND AUTHORITIES HAVING JURISDICTION. CONTRACTOR SHALL CARRY NECESSARY COSTS IN DEMOLITION AND REMOVAL.

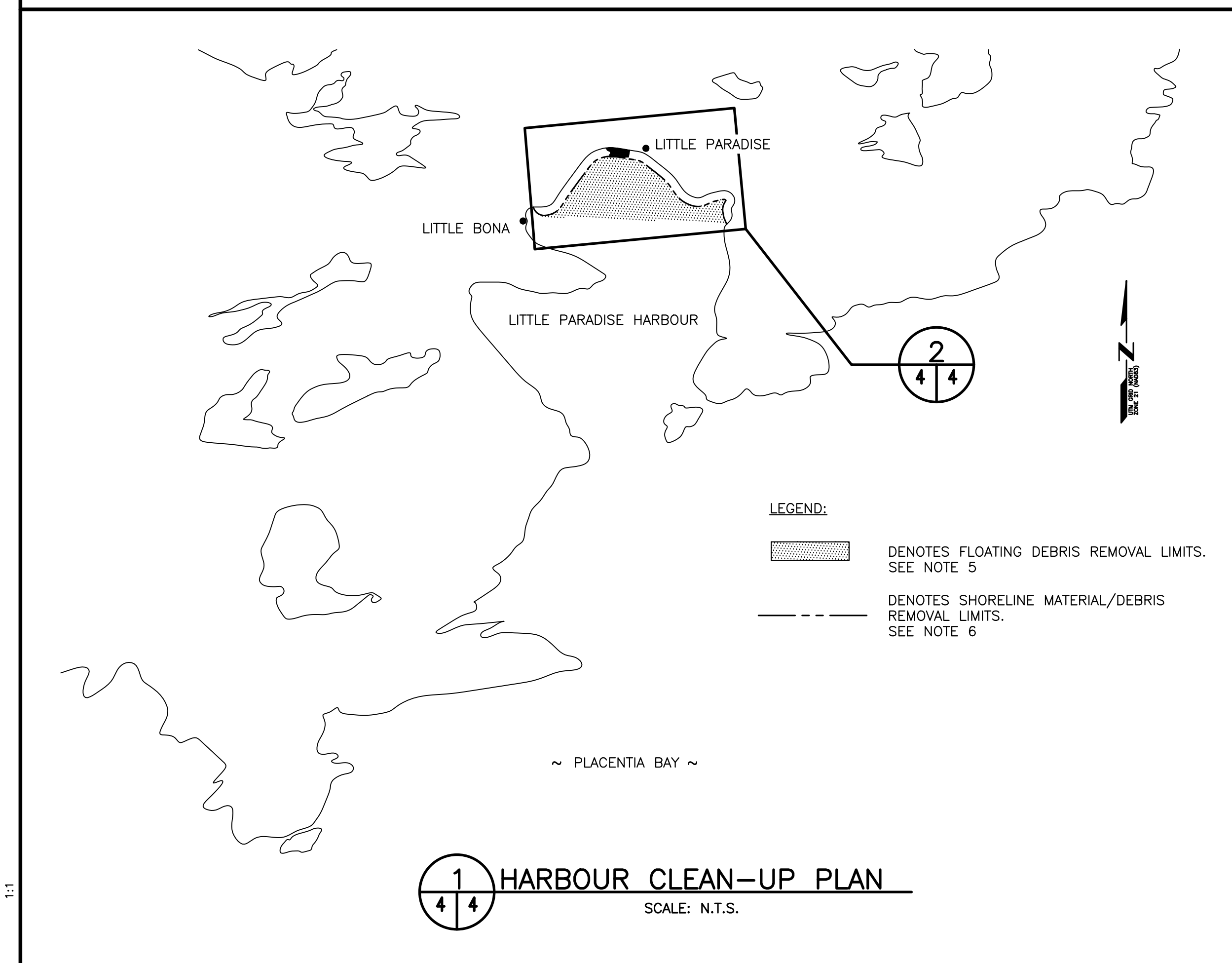

2 EXISTING / DEMOLITION SITE PLAN (AFTER TO STORM DAMAGE)

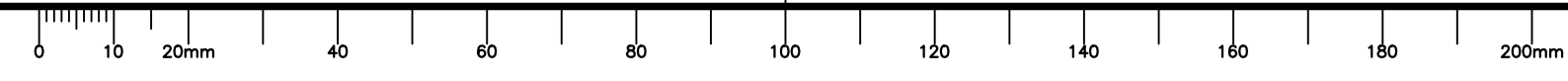
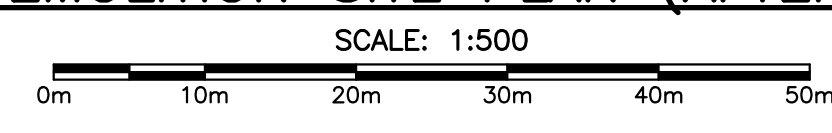

SMALL CRAFT HARBOURS



PROVINCE OF NEWFOUNDLAND AND LABRADOR
PERMIT HOLDER
 This Permit Allows
Meridian Engineering Inc.
 Member No. 04378
 To provide Professional Engineering in Newfoundland and Labrador.
 Permit No. as issued by PEG 201153
 which is valid for the year 2021.

C	ISSUED FOR TENDER	21/10/07
B	ISSUED FOR 99% REVIEW	21/10/05
A	ISSUED FOR 33% REVIEW	21/09/29

revisions	date
project	project

WHARF DEMOLITION LITTLE PARADISE, NL

EXISTING / DEMOLITION SITE PLAN (AFTER STORM DAMAGE)

designed C. FISHER	concu
date SEPTEMBER, 2021	
drawn P. MARSH	dessine
date SEPTEMBER, 2021	
approved	approuvé
date	
Tender	Submission
DFO Project Manager	Administrateur de projets MPD
project number	no. du projet
C2-00113-04-02-01	
drawing no.	no. du dessin
C4 OF 5	

SMALL CRAFT HARBOURS



NOTES:

1. ALL ELEVATIONS ARE IN METRES UNLESS OTHERWISE NOTED.
2. ALL DIMENSIONS ARE IN MILLIMETRES UNLESS OTHERWISE NOTED.
3. DO NOT SCALE FROM DRAWING, USE DIMENSIONS SHOWN.



PROVINCE OF NEWFOUNDLAND AND LABRADOR
PERMIT HOLDER
 This Permit Allows
Meridian Engineering Inc.
 Member No. 04378
 To practice Professional Engineering in Newfoundland and Labrador.
 Permit No. as issued by PEG - NL1153
 which is valid for the year 2021.

C	ISSUED FOR TENDER	21/10/07
B	ISSUED FOR 99% REVIEW	21/10/05
A	ISSUED FOR 33% REVIEW	21/09/29

revisions	date
project	projet

WHARF DEMOLITION
LITTLE PARADISE, NL

drawing dessin
NEW SITE PLAN

designed C. FISHER	conçu
date SEPTEMBER, 2021	
drawn P. MARSH	dessiné
date SEPTEMBER, 2021	
approved	approuvé
date	
Tender	Soumission
DFO Project Manager	Administrateur de projets MPD
project number	no. du projet
C2-00113-04-02-01	
drawing no.	no. du dessin
C5 OF 5	

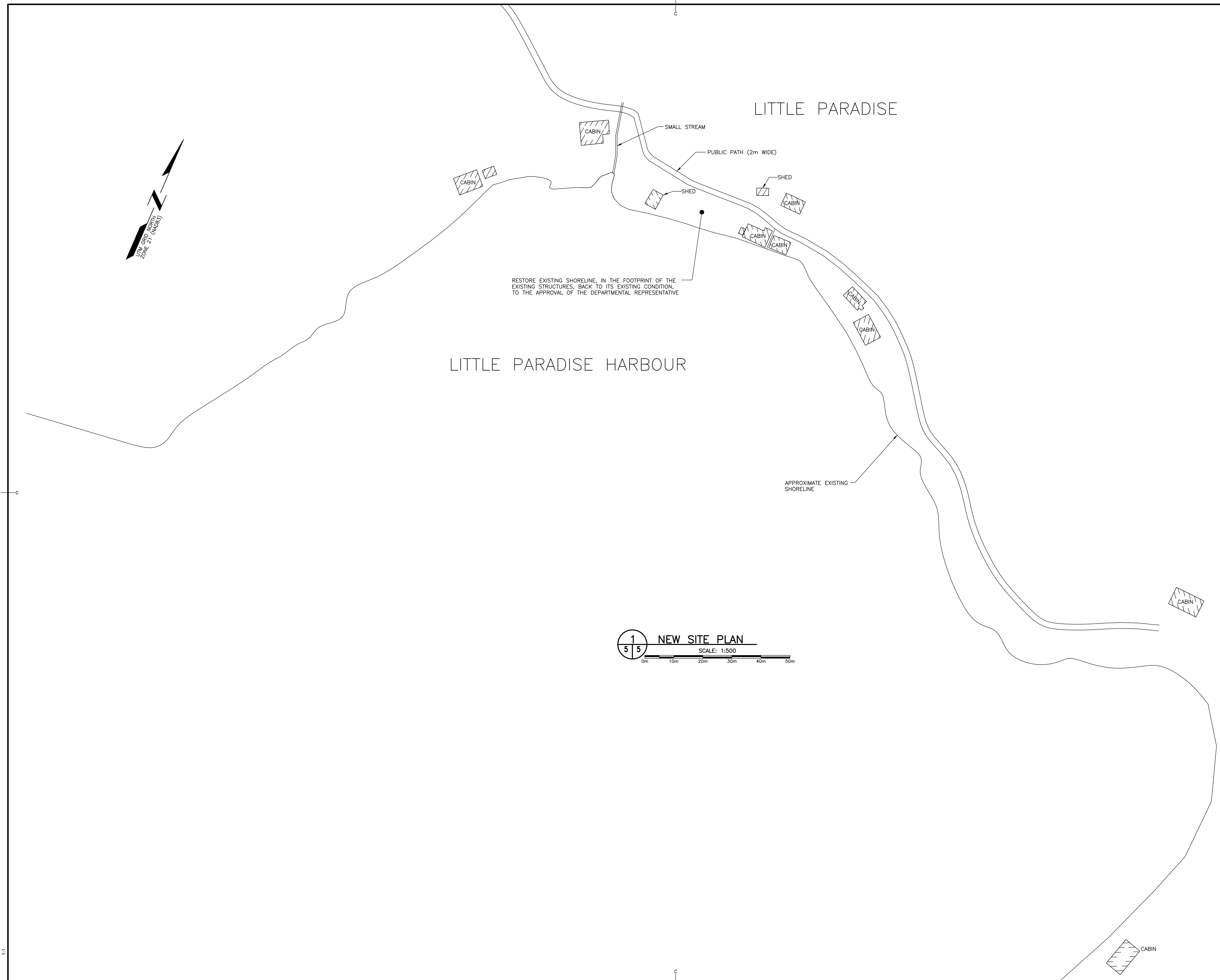

1
NEW SITE PLAN
 SCALE: 1:500
 0m 10m 20m 30m 40m 50m

