

SMALL CRAFT HARBOURS
ONTARIO AND PRAIRIE REGION

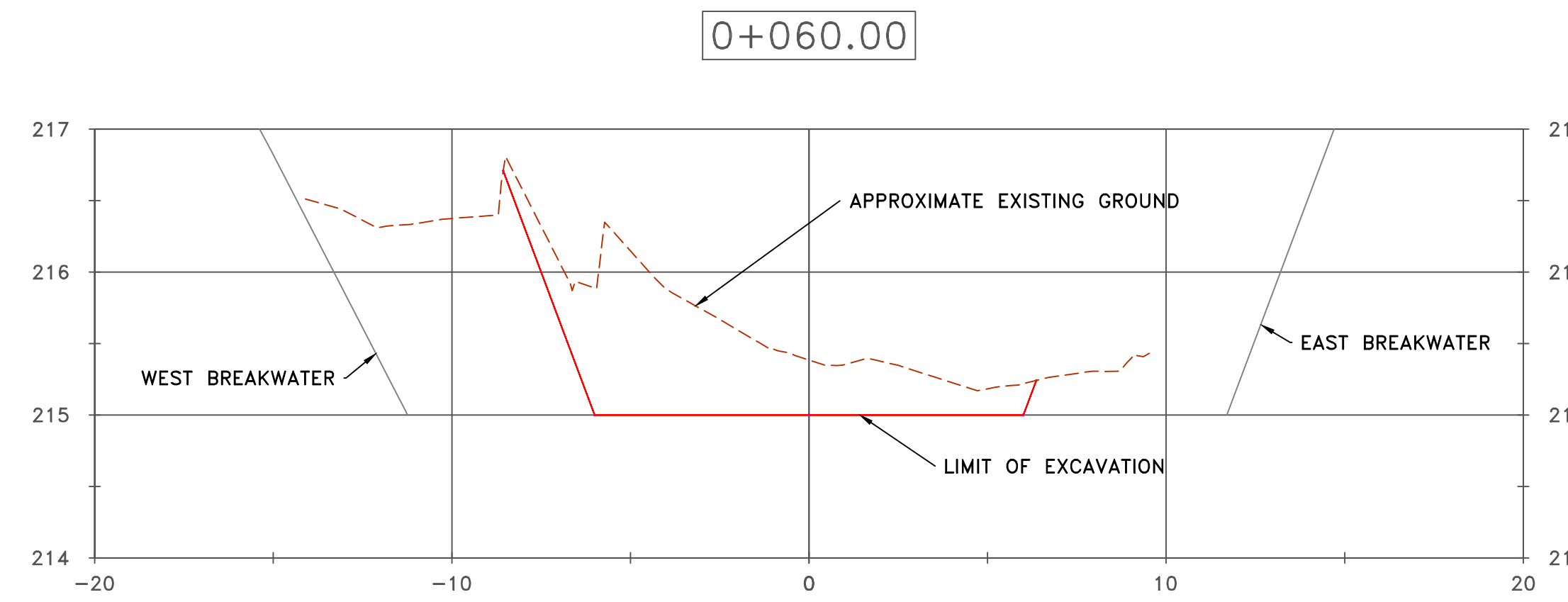

- NOTES:
- ELEVATIONS AND DIMENSIONS IN METRES UNLESS OTHERWISE STATED.
 - ELEVATIONS ARE GIVEN USING THE CANADIAN GEODETIC VERTICAL DATUM OF 1928 (CGVD28).
 - COORDINATES FOR HORIZONTAL CONTROL ARE GIVEN ON THE U.T.M. MAPPING PLANE, ZONE 14, USING THE NORTH AMERICAN DATUM OF 1983 (NAD83).
 - LAUNCH RAMP, STEEL SHEET PILE WHARF AND BREAKWATERS NOT TO BE USED FOR ACCESS TO SITE.
 - NO EXCAVATION TO SPECIFIED GRADE TO OCCUR WITHIN 2 METRES OF STEEL SHEET PILE WHARF, FLOAT WHARVES, PILES, AND TOE OF BREAKWATERS.

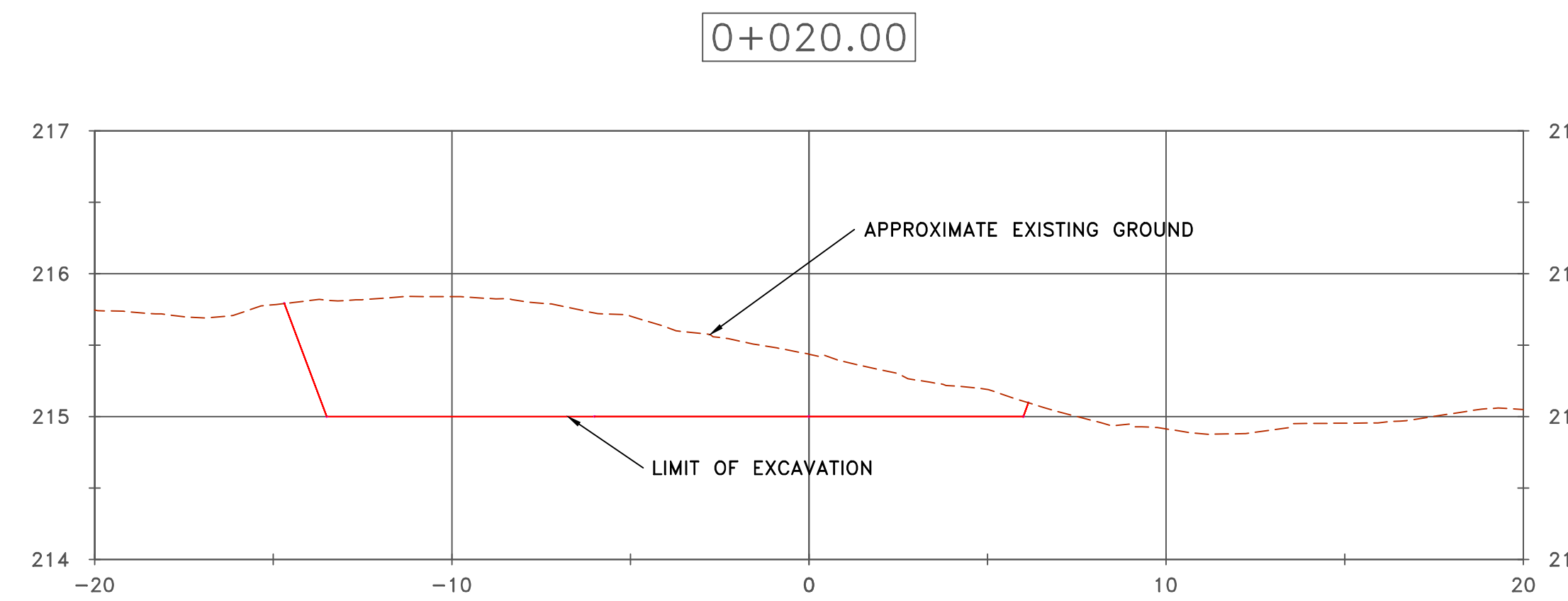
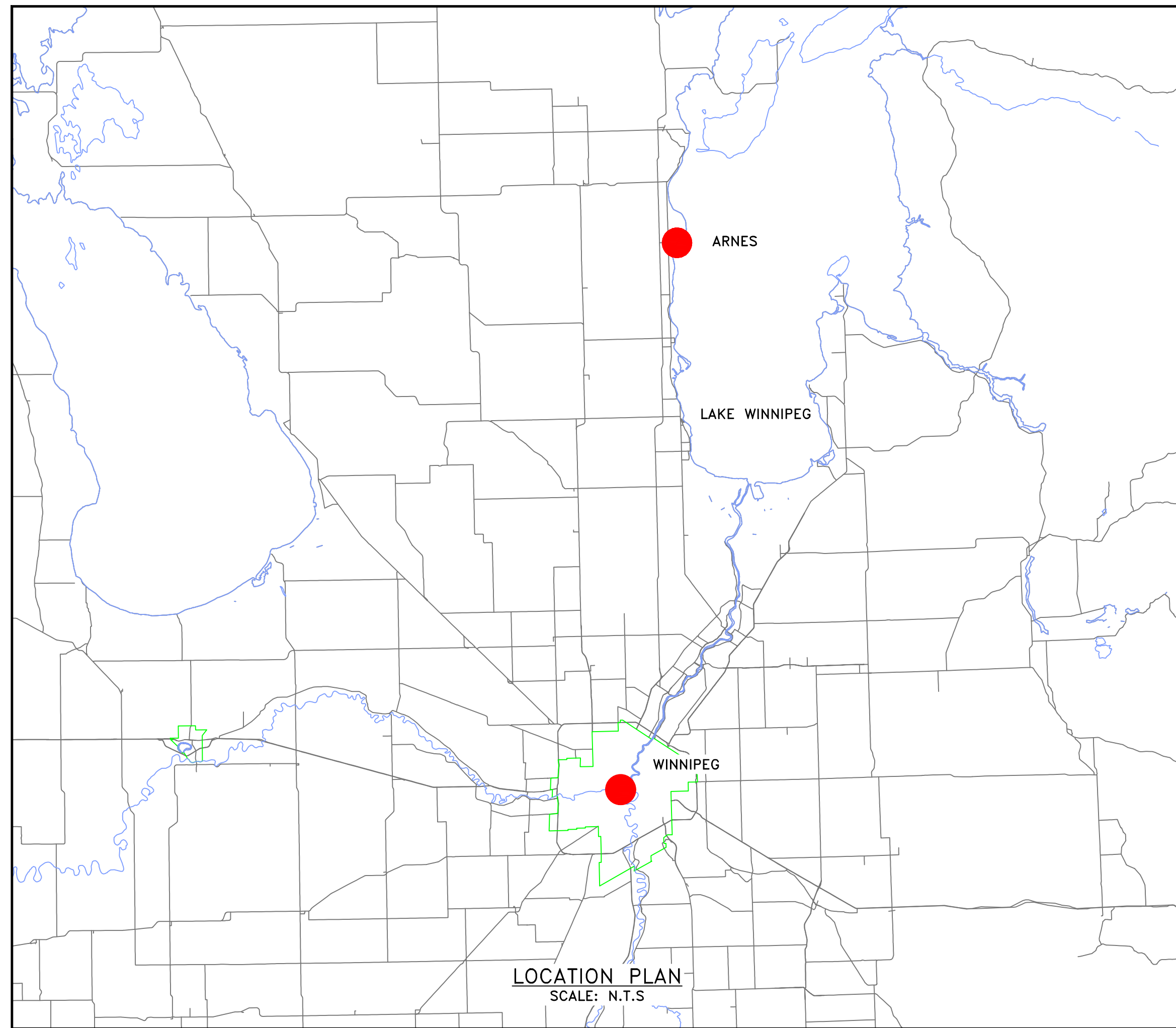

SECTION VIEWS
SCALE: 1:150

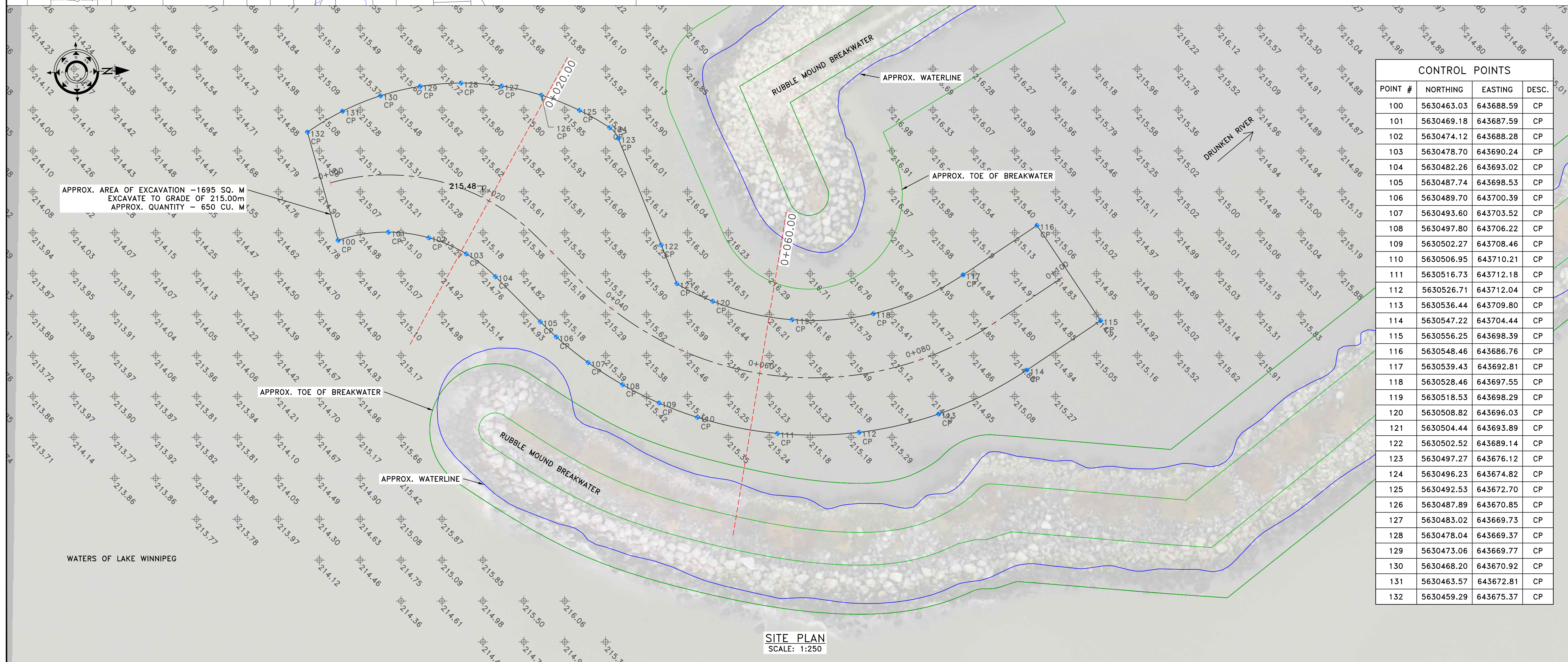

CONTROL POINTS			
POINT #	NORTHING	EASTING	DESC.
100	5630463.03	643688.59	CP
101	5630469.18	643687.59	CP
102	5630474.12	643688.28	CP
103	5630478.70	643690.24	CP
104	5630482.26	643693.02	CP
105	5630487.74	643698.53	CP
106	5630489.70	643700.39	CP
107	5630493.60	643703.52	CP
108	5630497.80	643706.22	CP
109	5630502.27	643708.46	CP
110	5630506.95	643710.21	CP
111	5630516.73	643712.18	CP
112	5630526.71	643712.04	CP
113	5630536.44	643709.80	CP
114	5630547.22	643704.44	CP
115	5630556.25	643698.39	CP
116	5630548.46	643686.76	CP
117	5630539.43	643692.81	CP
118	5630528.46	643697.55	CP
119	5630518.53	643698.29	CP
120	5630508.82	643696.03	CP
121	5630504.44	643693.89	CP
122	5630502.52	643689.14	CP
123	5630497.27	643676.12	CP
124	5630496.23	643674.82	CP
125	5630492.53	643672.70	CP
126	5630487.89	643670.85	CP
127	5630483.02	643669.73	CP
128	5630478.04	643669.37	CP
129	5630473.06	643669.77	CP
130	5630468.20	643670.92	CP
131	5630463.57	643672.81	CP
132	5630459.29	643675.37	CP

- LEGEND
- ⊕ 215.57 SOUNDINGS
 - ⊕ HORIZONTAL CONTROL POINT

REVISIONS:

0	ISSUED FOR TENDER	NOV. 15, 2021
---	-------------------	---------------

SCALE: AS SHOWN CLASS:

PROJECT:
2021 HARBOUR DREDGING

DESCRIPTION:
DREDGE PLAN AND DETAILS

DRAWN: SCH	APPROVED: SCH
DATE: DEC. 2021	DATE: DEC. 2021

LOCATION:
ARNES
MANITOBA

DRAWING NO.: A-1 of 1	LOCATOR CODE: 5501
--------------------------	-----------------------