

Addendum Addenda

No./No
2

Project Description / Description de projet		
SAS-01 Roof Replacement 000 Block/SAS-01 Replacement Du Toit 000 Bloc		
Project No./No de projet	Departmental Representative / représentant ministériel	Date
6119	Jazmin McLean	25-May-2022
Solicitation No./N° de sollicitation		
22-58003		
<p>Notice: This addendum shall form part of the tender documents and all conditions shall apply and be read in conjunction with the original plans and specifications.</p>		
<p>Nota: Cet addenda fait partie intégrale des dossiers d'appel; toutes les conditions énoncées doivent être lues et appliquées en conjonction avec les plans et les devis originaux.</p>		

Item No	Description
1	Please see attached document from Pinchin for Addendum #2.
1	Veillez consulter le document joint de Pinchin pour l'addendum #2.
2	Please see attached document for request for alternate materials.
2	Veillez consulter le document ci-joint pour la demande de matériaux alternatifs.
3	Closing date extended to June 2, 2022 at 14:00 CST
3	Date de clôture reportée au 2 Juin 2022 à 14h00 TSC



Addendum No. 1

Project Name:	National Research Council Roof Replacement	Date:	May 16, 2022
Project Address:	110 Gymnasium Place, Saskatoon, Saskatchewan	Client Name:	National Research Council of Canada
Project Location:	Roof	Client Project/P.O. No.:	6119
Client Contact:	Jazmin McLean	Pinchin File No.:	300068.000
Pinchin Project Manager:	Michael Evanyshyn	Delivery Method:	Email

Addenda are issued by the owner through the consultant only for the purpose of recording a change in the tender drawings and specifications. These addenda form a part of the contract documents and are subject to the provisions of the Contract.

1. Contractor Questions:

Q: Are the existing exhaust fans to remain in operation?

A: Yes.

Q: Are the exhaust fans and associated ductwork to be removed or remain in place?

A: They will remain in place.

Q: Are new duct supports required?

A: Duct brackets can remain but utilize new C-Port supports for the brackets. Complete with loose laid cap sheet slip sheets on underside.

Q: If the existing ductwork is to be removed, there is a high probability that damage will occur resulting in a partial or complete replacement.

A: Duct work is to remain in place.

Q: What type of plumbing vent is acceptable for use?

A: Refer to detail SK01 included in this addendum.

Q: Are new or retrofit drains to be installed? What drain is acceptable for use? Watts RD-100?

A: Refer to Section 22 05 00. New drains. Zurn Z100 or approved equivalent. A Watts RD-100 is acceptable but must incorporate a metal drain dome.

Q: Is asbestos present?

A: Refer to Section 02 41 13. It is not expected that hazardous materials will be encountered.

Q: Sloped insulation requirement. It read sloped insulation is to start at 12.7mm at the roof drains with a 1% slope to a maximum height of 63.5mm. With the specified slope our thickest insulation on the slope package would be upwards of 5"-7". Please advise.

A: Refer to Section 2 of this addendum. Insulation thickness has been revised.

Q: Section 01 11 00 Summary of Work shows that there is metal roofing to be removed and replaced. There is no mention of this on the drawings/details. Please provide drawings and details if this work is to be included.

A: Refer to Section 07 61 00 for instruction on metal roof replacement.

Q: No details provided for high low cladding walls. Can detail be provided?

A: Refer to detail SK02 included in this addendum.

Q: No details provided for mechanical roof top equipment. Only one detail for the doghouse. Can additional details be provided for remaining roof top equipment?

A: Remove existing membrane. Fasten new laminated base sheet membrane to vertical of existing curbs and tie into field base sheet. Strip with new cap sheet membrane and install new counter flashing under existing curb flashings.

Q: Can the 2 bins on site be temporarily relocated during the roof replacement? As this area would be the only ideal area for our garbage disposal.

A: Yes they can be temporarily relocated.

Q: As we are adding sloped insulation to the roof and roof height will be increasing the existing door threshold will not be sufficient. Please advise.

A: Refer to Section 2 of this addendum, insulation thicknesses have been revised.

Q: No detail provided for parapet detail with guard rails. Can detail be provided?

A: Temporarily remove and store guard rail for re-use. Construct parapet as noted in the parapet detail. Parapet cap to be constructed level to accommodate re-installation of guard rail. Once parapet cap flashing is installed. Re-secure existing guard rail and detail guard rail penetrations through horizontal of parapet with fluid applied waterproofing.

Q: No detail provided at high low walls brick locations. Can detail be provided?

A: Refer to detail SK02 included in this addendum.

Q: Would a peel and stick vapour barrier be acceptable in lieu of torch applied membrane?

A: No.



2. Specification Changes:

1. Section 01 11 00 Summary of Work – 3.3.1 – Delete and substitute with the following:

The new roof assembly is to include but is not limited to:

Concrete Deck

New thermally fused modified bituminous vapour retarder

New 50.8mm polyisocyanurate insulation

New tapered polyisocyanurate insulation

New 50.8mm polyisocyanurate insulation

New 2-ply SBS modified bitumen roof membrane with factory laminated coverboard (adhere base sheet, thermally fuse cap sheet)

2. Section 07 21 13 Board Insulation – 2.1.1.3 Delete and substitute with the following:

.3 Thickness: Two layers of 50.8mm

3. Section 07 21 13 Board Insulation – 2.1.2.3 Delete and substitute with the following:

.3 Thickness: 12.7mm at the drain to a maximum of 50.8mm.

Pinchin Ltd.

Prepared by:

Michael Evanyshyn, C.E.T.
Project Manager
403.358.6753
mevanyshyn@pinchin.com

Reviewed by:

Adam Hernberg
Senior Project Manager
780.818.3697
ahernberg@pinchin.com

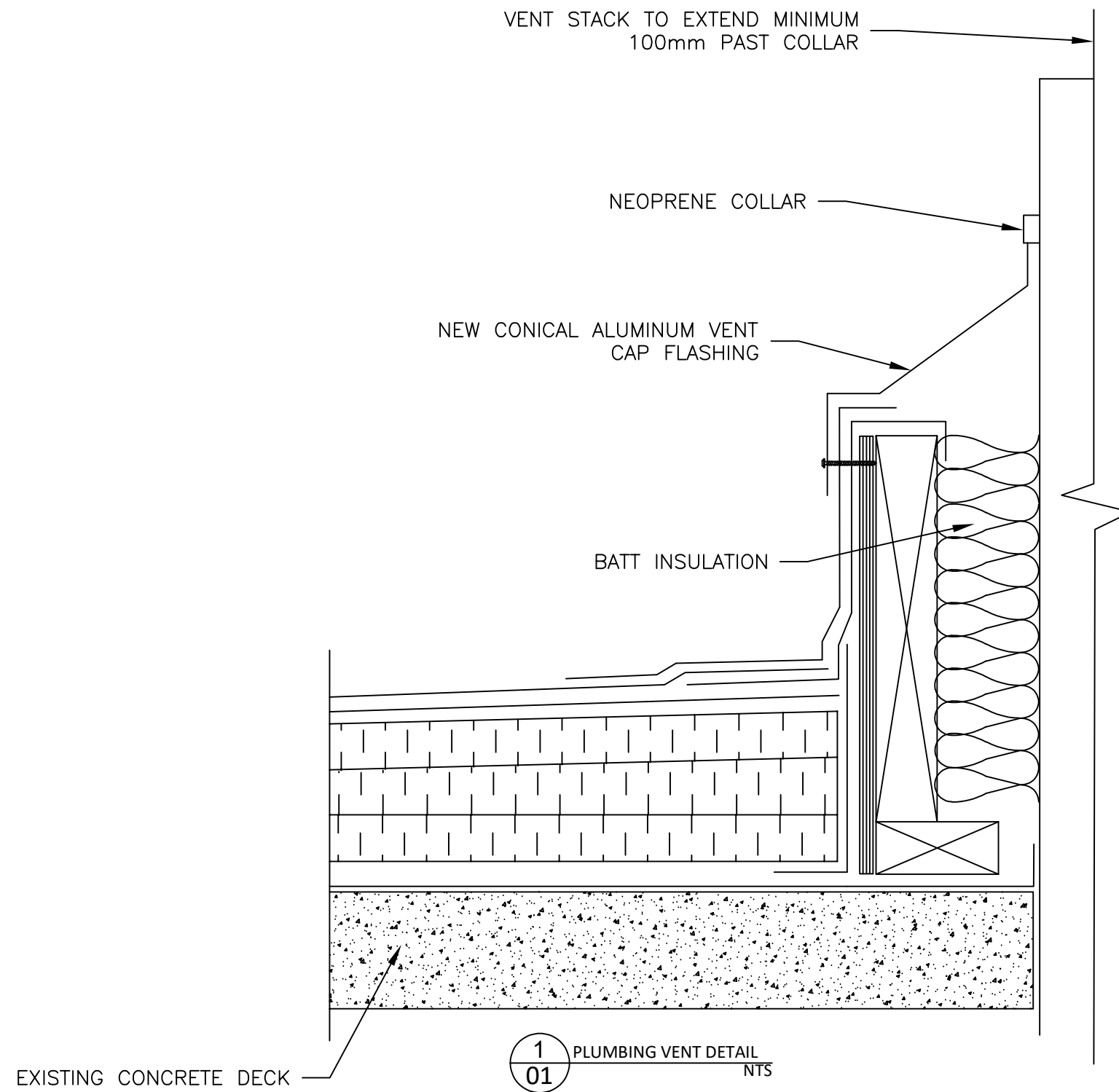

RPPM 11x17

NRC - CNRC
 National Research Council Canada
 Conseil national de recherches Canada
 Real Property Planning and Management
 Planification et gestion des biens immobiliers

NRC - CNRC

project
NATIONAL RESEARCH COUNCIL OF CANADA ROOF REPLACEMENT
 project

110 GYMNASIUM PLACE, SASKATOON, SASKATCHEWAN

drawing
PLUMBING VENT DETAIL
 dessin

date 12/21 date scale NTS échelle ACAD file: 6119 fichier CDAO: 6119

designed PINCHIN LTD.	conçu	checked A.H.	vérifié
drawn MVE	dessiné	approved A.H.	approuvé
W.O.no. 1	D.T.no.	sheet of/de 3	feuille
dwg.no. 6119-SK01		dessin no.	

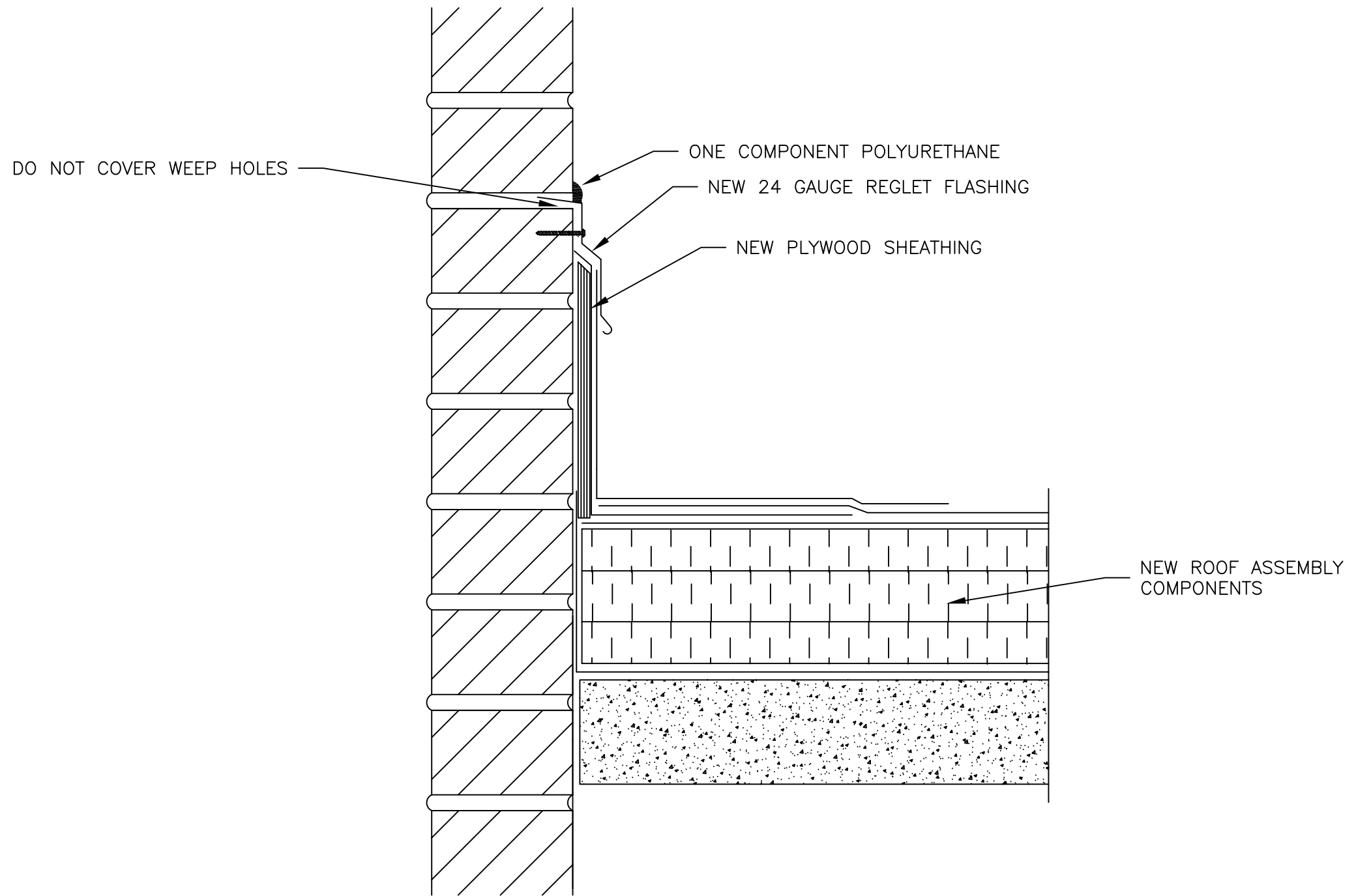

1 ROOF TO MASONRY WALL DETAIL
02 NTS

RPPM 11x17

NRC - CNRC
National Research Council Canada
Conseil national de recherches Canada
Real Property Planning and Management
Planification et gestion des biens immobiliers

NRC - CNRC

project
NATIONAL RESEARCH COUNCIL OF CANADA
ROOF REPLACEMENT

110 GYMNASIUM PLACE, SASKATOON, SASKATCHEWAN

drawing
ROOF TO MASONRY WALL DETAIL

date 12/21 scale NTS échelle ACAD file: 6119 fichier CDAO: 6119

designed	conçu	checked	vérifié
PINCHIN LTD.		A.H.	
drawn	dessiné	approved	approuvé
MVE		A.H.	
W.O.no.	D.T.no.	sheet	feuille
2		of/de 3	
dwg.no.	dessin no.		
6119-SK02			

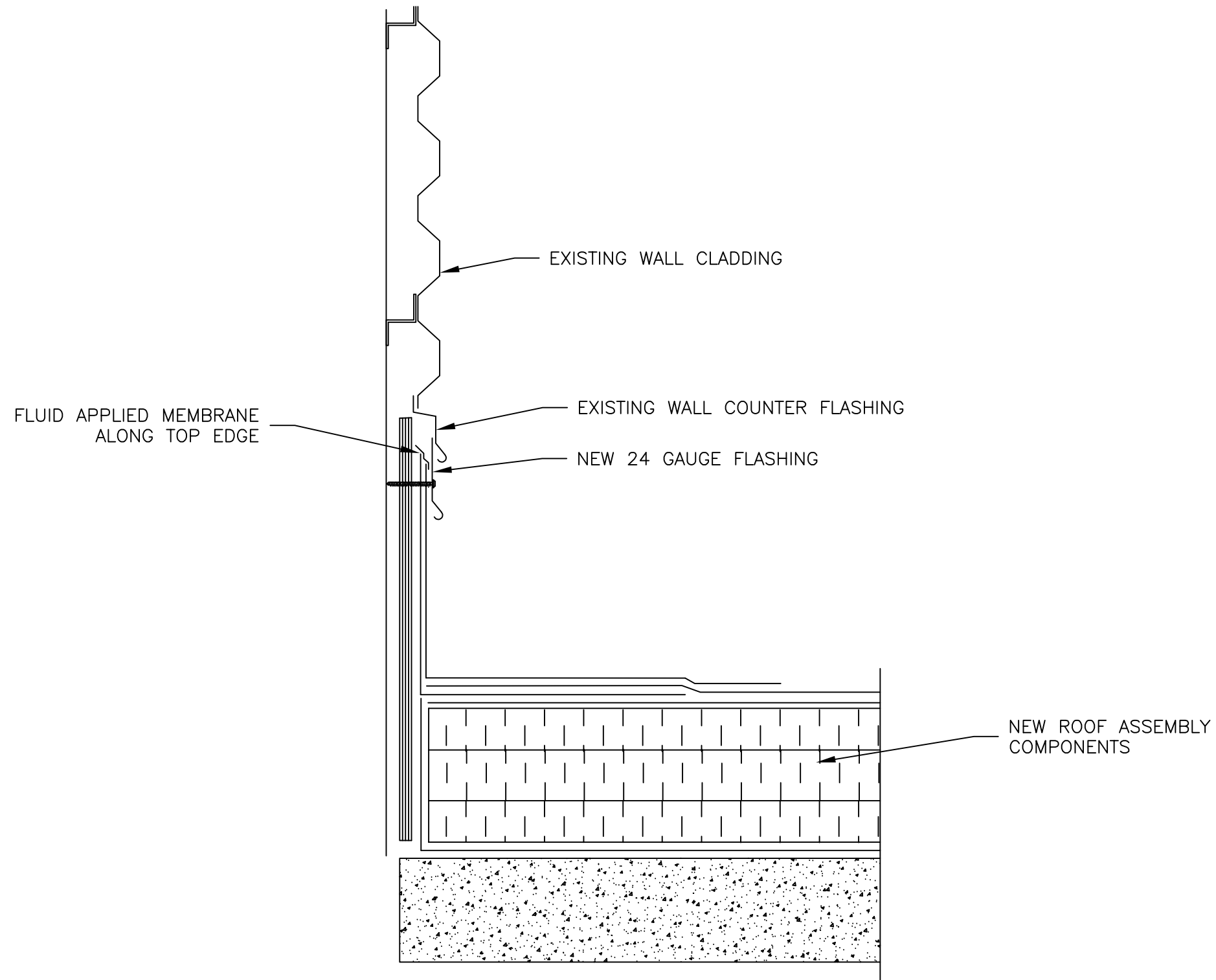

1 ROOF TO HIGH WALL DETAIL
03 NTS

RPPM 11x17

 National Research Council Canada
 Real Property Planning and Management
 Conseil national de recherches Canada
 Planification et gestion des biens immobiliers

NRC · CNRC

project drawing
 NATIONAL RESEARCH COUNCIL OF CANADA
 ROOF REPLACEMENT

110 GYMNASIUM PLACE, SASKATOON, SASKATCHEWAN

dessin
 ROOF TO HIGH WALL DETAIL

date 12/21 scale NTS échelle ACAD file: 6119 fichier CDAO:

designed PINCHIN LTD.	conçu	checked A.H.	vérifié
drawn MVE	dessiné	approved A.H.	approuvé
W.O.no. 3	D.T.no.	sheet of/de 3	feuille
dwg.no. 6119-SK03		dessin no.	

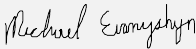

Date:	May 10, 2022	<h2 style="text-align: center;">Request for Equivalent Materials</h2>	
Project Name:	110 Gymnasium place		
Client:	NRC Canada		
Attention:	NRC Canada		
Email Address:	Jazmin.McLean@nrc-cnrc.gc.ca	From:	Brandon Grunow
Tender Closing Date:	May 24, 2022	Email Address:	Brandon.grunow@flynncompanies.com
Specification Section:	07 52 00		
Material Specified	Soprema- Soprasmart board, Sopralene flam 180, Sopralene flam 250 GR		
Additional Note to Material Request	Proposed materials attached.		
Review Comment/Acceptance	The flameless equivalents submitted are acceptable. Michael Evanyshyn – May 13, 2022 		

Please feel free to call with any questions or concerns. Attachments:

- Flameless MB Corporate Letter c/w detail drawings