

**SMQ**  
SERVICES MÉTALLURGIQUES DU QUÉBEC LTÉE  
765 RUE DE SAINT-ROMUALD  
LÉVIS (Qc) CANADA G6W 5M6  
TEL: 418 210-3600

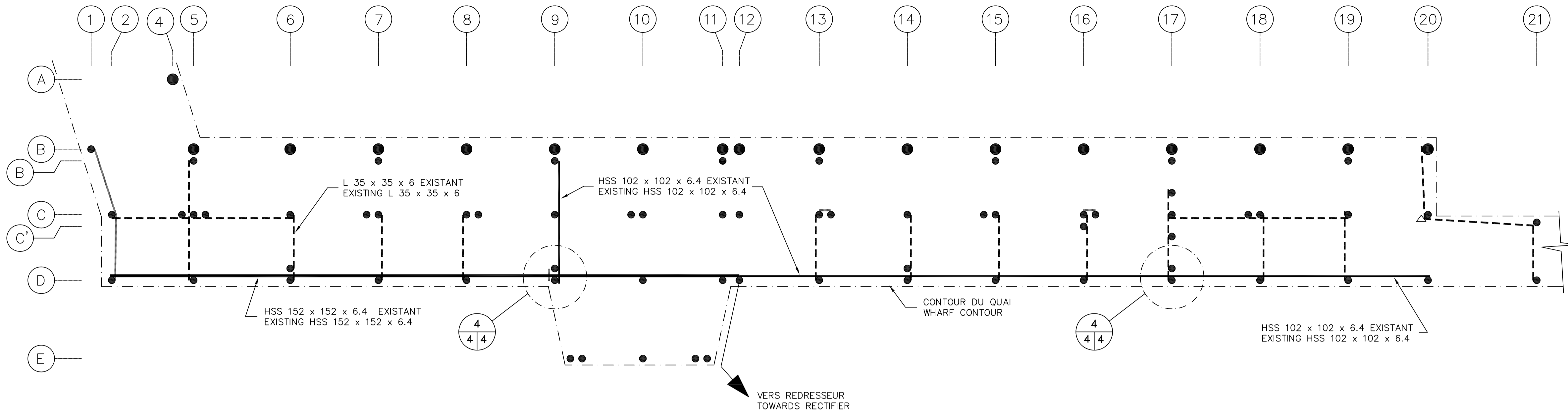

**SCHEMA EN PLAN DE LA POSITION DES HSS ET DES CONTINUITES ELECTRIQUES**  
**PLAN DIAGRAM OF THE POSITION OF THE EXISTING HSS AND ELECTRICAL CONTINUITIES**



LEGENDE	LEGEND
--- CONTOUR DU QUAI	WHARF CONTOUR
- - - CONTINUITE ELECTRIQUE	ELECTRICAL CONTINUITY
— HSS POUR CABLES DE LA PROTECTION CATHODIQUE	HSS FOR CATHODIC PROTECTION CABLES
● PIEU	PILE

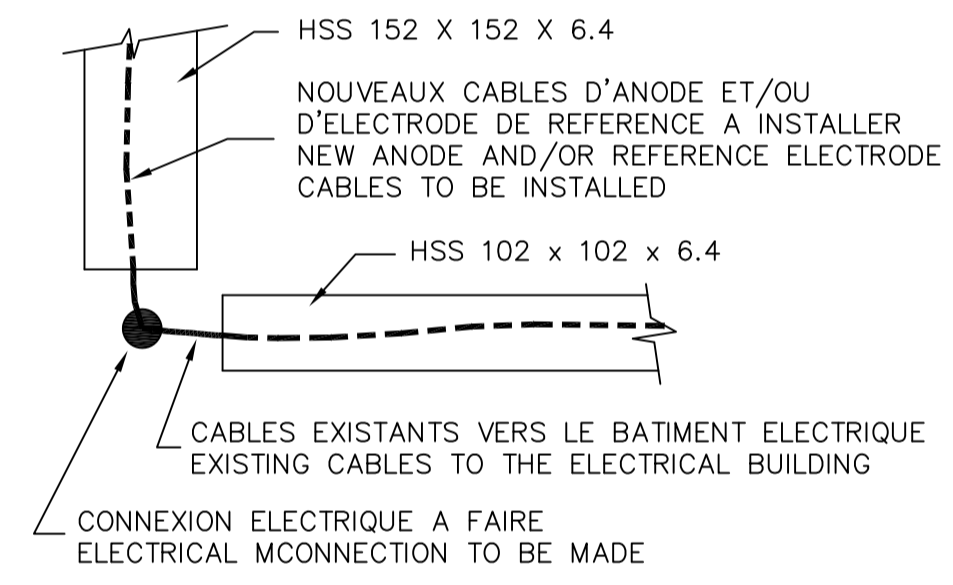

NOTE: SOUMETTRE POUR APPROBATION  
NOTE: SUBMIT FOR APPROVAL

**DETAIL TYPE – VUE ENN PLAN**  
**TYPICAL DETAIL – PLAN VIEW**

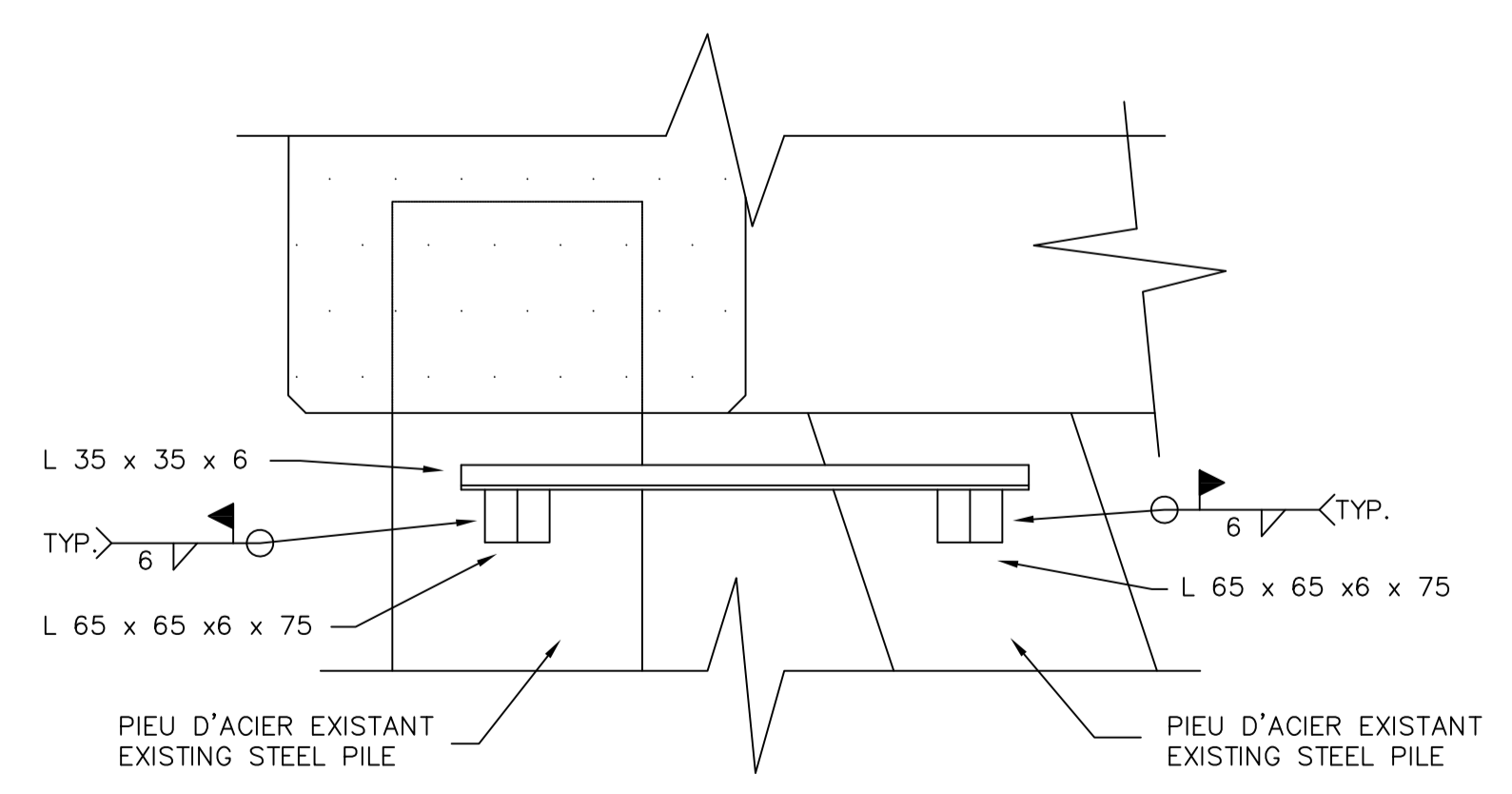

**CONTINUITE ELECTRIQUE TYPE**  
**TYPICAL ELECTRICAL CONTINUITY**

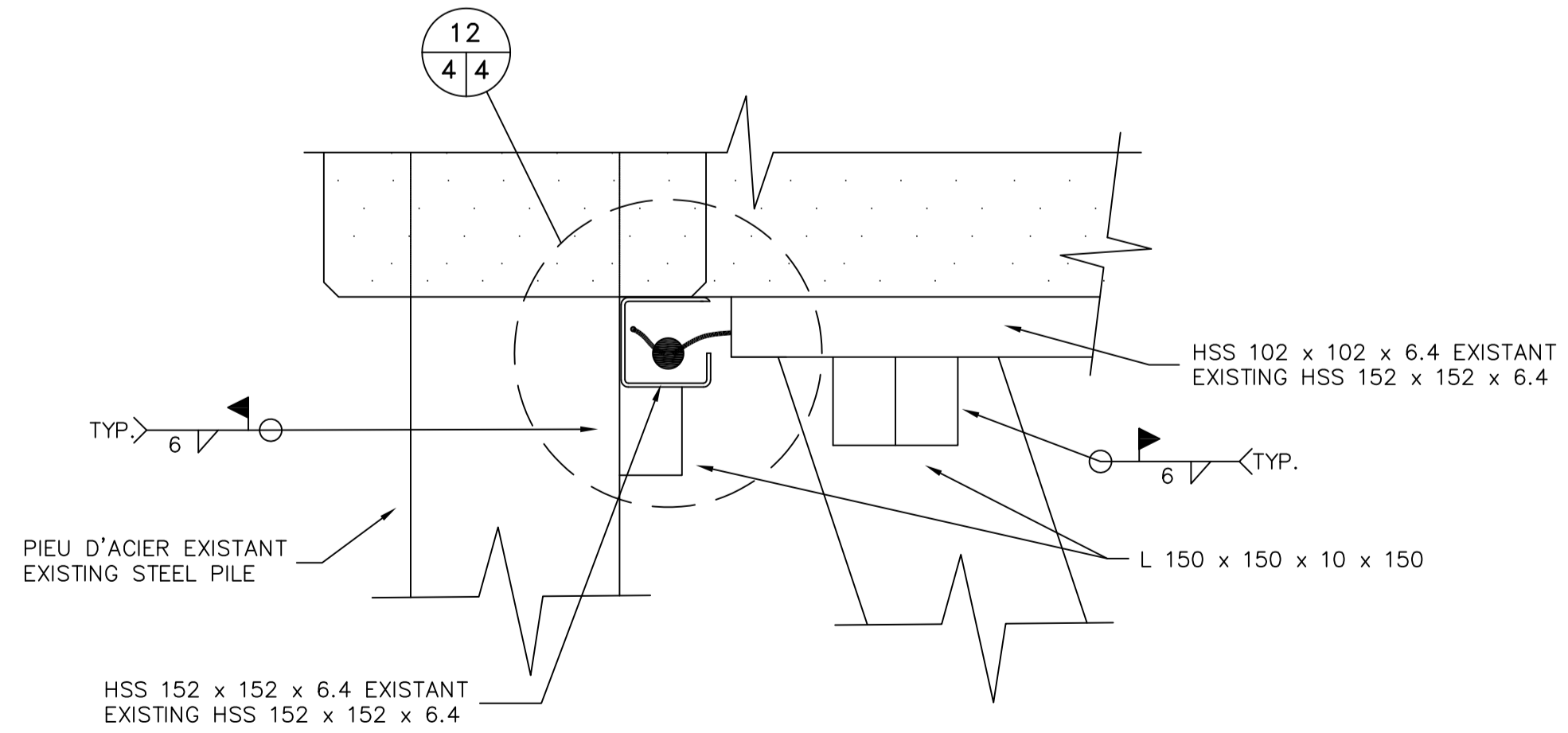

**DETAIL TYPE – VUE VERTICALE**  
**TYPICAL DETAIL – VERTICAL VIEW**

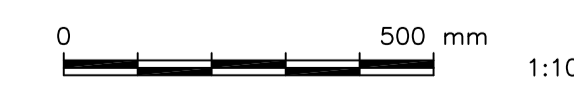

LES MESURES SUR LES PLANS SONT APPROXIMATIVES ET ELLES DOIVENT ETRE VERIFIEES SUR PLACE PAR L'ENTREPRENEUR.  
AVANT DE COMMENCER LES TRAVAUX, VERIFIER EN CONSEQUENCE, MESURER AVANT DE COUPER TOUTE PIECE.  
THE MEASUREMENTS INDICATED ON THE PLANS ARE APPROXIMATE AND SHOULD BE CHECKED ON THE SITE BY THE CONTRACTOR.  
BEFORE STARTING THE WORKS, CHECK ACCORDINGLY, AND MEASURE ADEQUATELY BEFORE CUTTING ANY COMPONENT.



Révision	Description	Par/By	Date
03	POUR SOUMISSION	G.C	2022/02/09
02	POUR APPROBATION	G.C	2022/02/07
01	POUR DISCUSSION	G.C	2022/02/03

A: Numéro du détail Detail no.	A
B: Feuille sur laquelle le détail est référencé Location drawing no.	B   C
C: Feuille sur laquelle le détail est dessiné Drawing no.	C

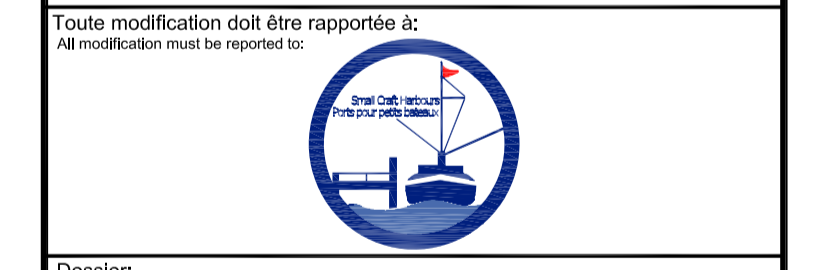

Dossier: RIVIERE-AU-TONNERRE  
REMPLACEMENT DES ANODES  
REPLACEMENT OF ANODES

DETAILS CONTINUITE ELECTRIQUE  
DETAILS ELECTRICAL CONTINUITY

Conçu par: / Designed by: GEORGE CALAVRE ing.	Date: 2021/01/24
Dessiné par: / Drawn by: RENALD BILODEAU tech.	Date: 20-21/01/27
Vérifié par: / Verified by: GERORGE CALAVRE ing.	Date: 2021/02/01
Approuvé par: / Approved by: MARIO NICOL tech.	Date:
No. dossier: / File no: 22-102	Echelle: / Scale:
No. dessin: / Drawing no: PPB22-3760-PC01-01	No. feuille: / Sheet no: 4