



Public Works and  
Government Services  
Canada

Travaux publics et  
Services gouvernementaux  
Canada

No of Page/

N° de page 18 pages

**RETURN BIDS TO:**

**RETOURNER LES SOUMISSIONS À:**

See Section 1.  
Voir Section 1.

**STANDARD REQUEST FOR BID**

**INVITATION À SOUMISSIONNER - STANDARD**

The Bidder offers to provide to Canada the goods, services or both listed in the bid solicitation in accordance with the conditions set out in the bid solicitation and the prices set out in the bid.

This bid solicitation is issued in accordance with the conditions of the Supply Arrangement E60PQ-140003/PQ.

Le soumissionnaire offre de fournir au Canada les biens, services ou les deux énumérés dans la demande de soumissions aux conditions prévues dans la demande de soumissions et aux prix indiqués dans la soumission.

Cette demande de soumissions est émise conformément aux conditions de l'arrangement en matière d'approvisionnement E60PQ-140003/PQ.

Solicitation No. - N° de la demande 202206404/A	Amendment No. 004 - N° 004 de modification
Supplier SA No. - N° de l'AMA de fournisseur : E60PQ-140003/___	

Solicitation closes – La demande prend fin :  on June 24, 2022 at 14:00 EDT Le 24 juin 2022 a 14:00 HAE	File No. - N° de dossier 202206404
---	---------------------------------------

<b>Date of Solicitation – Date de la demande</b> June 1, 2022 1 juin 2022
<b>Address inquiries to – Adresser toute demande de renseignement à :</b>  <b>See Section 2, Article 4.1.</b> <b>Voir Section 2, Article 4.1</b>
<b>Destination</b>  <b>See Section 2, Annex A.</b> <b>Voir Section 2, Annexe A.</b>

**Instructions:**

Municipal taxes are not applicable.

Unless otherwise specified in the bid solicitation, all prices quoted must be net prices in Canadian funds including Canadian customs duties, excise taxes, must be FOB, including all delivery charges to destination(s) as indicated. The amount for Applicable Taxes is to be shown as a separate item.

**Instructions:**

Les taxes municipales ne s'appliquent pas.

Sauf indication contraire dans la demande de soumissions, tous les prix indiqués doivent être des prix nets, en dollars canadiens, comprenant les droits de douane canadiens, la taxe d'accise et doivent être FAB, y compris tous frais de livraison à la (aux) destination(s) indiqué(s). Le montant des taxes applicables doit apparaître séparément.

<b>Supplier Name and Address – Nom et adresse du fournisseur</b>
<b>Telephone No. - N° de téléphone</b> <b>Facsimile No. - N° de télécopieur</b>
<b>Name and title of person authorized to sign on behalf of supplier (type or print)</b> <b>Nom et titre de la personne autorisée à signer au nom du fournisseur (caractère d'impression)</b>
<b>Signature : _____ Date : _____</b>

This amendment is raised to address the following:

- To respond to questions received during the solicitation period; and
- To revise the solicitation accordingly, as applicable.

The **bid closing date has been extended to June 24, 2022 at 14:00 EDT (Eastern Daylight Time)**. The first page of this solicitation has been revised to reflect the new closing date.

Revise solicitation to remove the following clauses:

SACC Manual clause [A3080T: COVID-19 vaccination requirement](#);  
SACC Manual clause [A3081T: COVID-19 Vaccination Requirement Certification](#); and  
Remove Annex E - COVID-19 VACCINATION REQUIREMENT CERTIFICATION

### **QUESTIONS ET RÉPONSES**

**Q1:** CAT-1B qty 5 24x66 panel mounted worksurfaces. Drawing shows only qty 4. Where's the 1 extra?

**A1:** There are 4 in 114 and 1 in 113. See below.

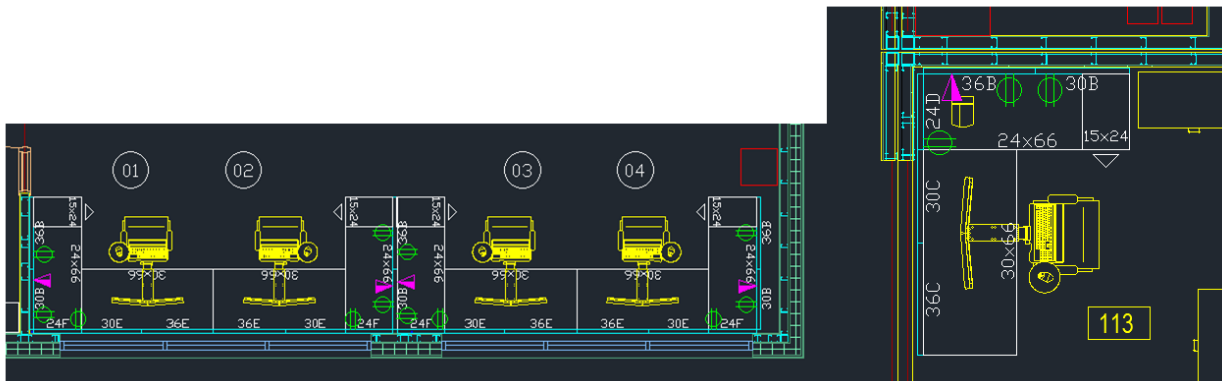

**Q2:** CAT-1B qty 1 24x30 C legs w/ modesty panel. Please provide a room tag. Can't find this in the drawing?

**A2:** Room 119

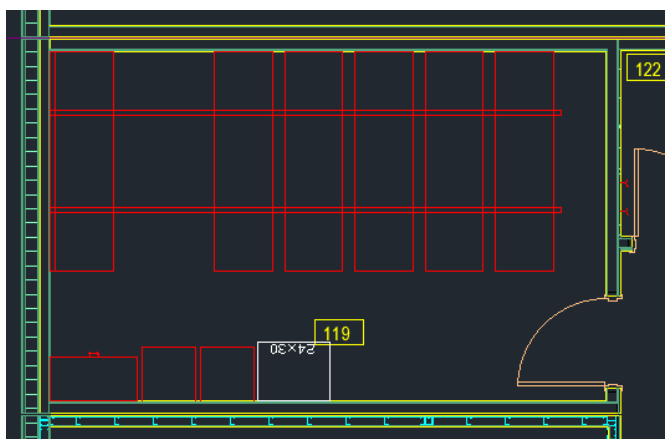

**Q3:** CAT-1B qty 24x66 C legs w/ modesty panel. Please provide a room tag. Drawing shows more than qty 1 Room 113 & 115

**A3:** Room 115. 113 is panel mounted, as indicated in question 1

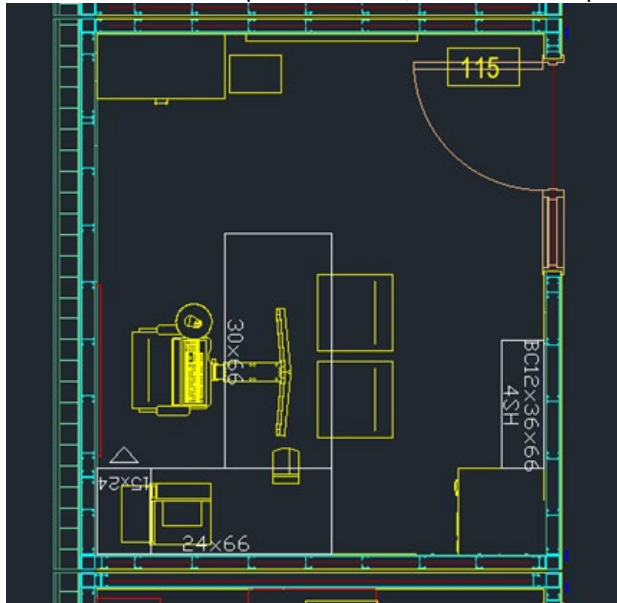

**Q4:** Room 118 - Are those 4 tables 24x60 to be included in the scope of work? Not in Table 1

**A4:** No

**Q5:** 48x144 table. Is this to be included in the scope of work? Shows in drawing, but not in Table 1

**A5:** No

**Q6:** CAT-1B qty 30x60 C legs w/ modesty panel. Drawing shows Qty 3 in total - Tag: 132 (2) and 105. Please confirm tags and quantities required.

**A6:** 30 x 60 C-legs with modesty panel is in 132. 105 is NIC.

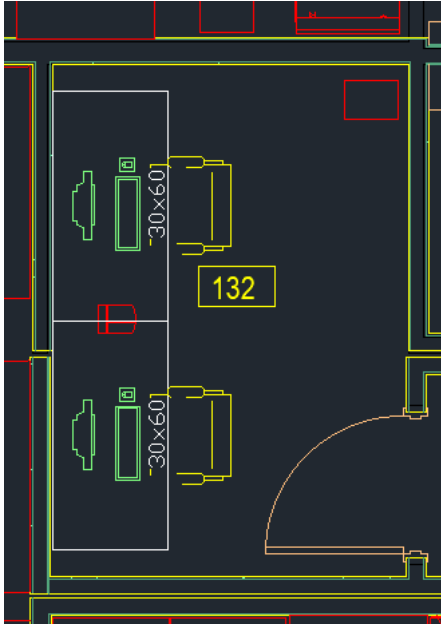

**Q7:** CAT-1B 30dx72W Qty 1 panel mounted worksurface. This is missing from Table 1. Is this to quote or not?

**A7:** Yes, please include

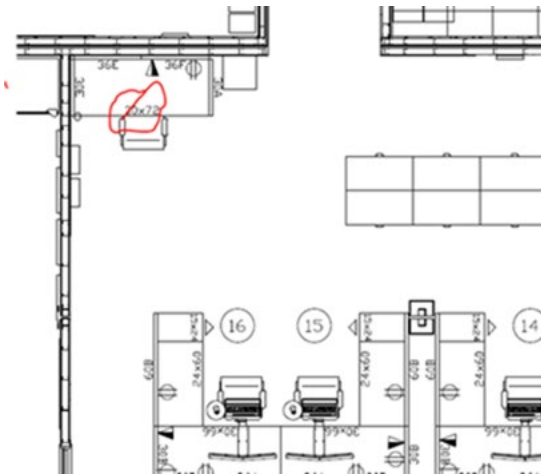

**Q8:** We need an electrical plan that shows where you want the power pole locations as well. The furniture plan doesn't show details.

**A8:** We would like the vendor to recommend the optimal locations for the power poles.