

WHEN FITTING PROPELLER HUB TO SHAFT, PREHEAT TO APPROX 80°C AND PUSH HUB HARD ON TO THE SHAFT. PREHEATING ALLOWS THE HUB TO BE LOCATED 1,5 - 1,7mm FURTHER ON THE SHAFT.

TANK MUST BE PLACED MIN. 3m. ABOVE WATERLINE AT MAX. DRAFT OF THE SHIP.

TIGHTEN UP THE BOLTS IN THE FLANGE— FIRST ON THE SIDE WHERE THERE SHALL BE NO CLEARANCE BETWEEN THE COUPLING HALVES. MOMENT TORQUE 850 Nm

SECTION D-D

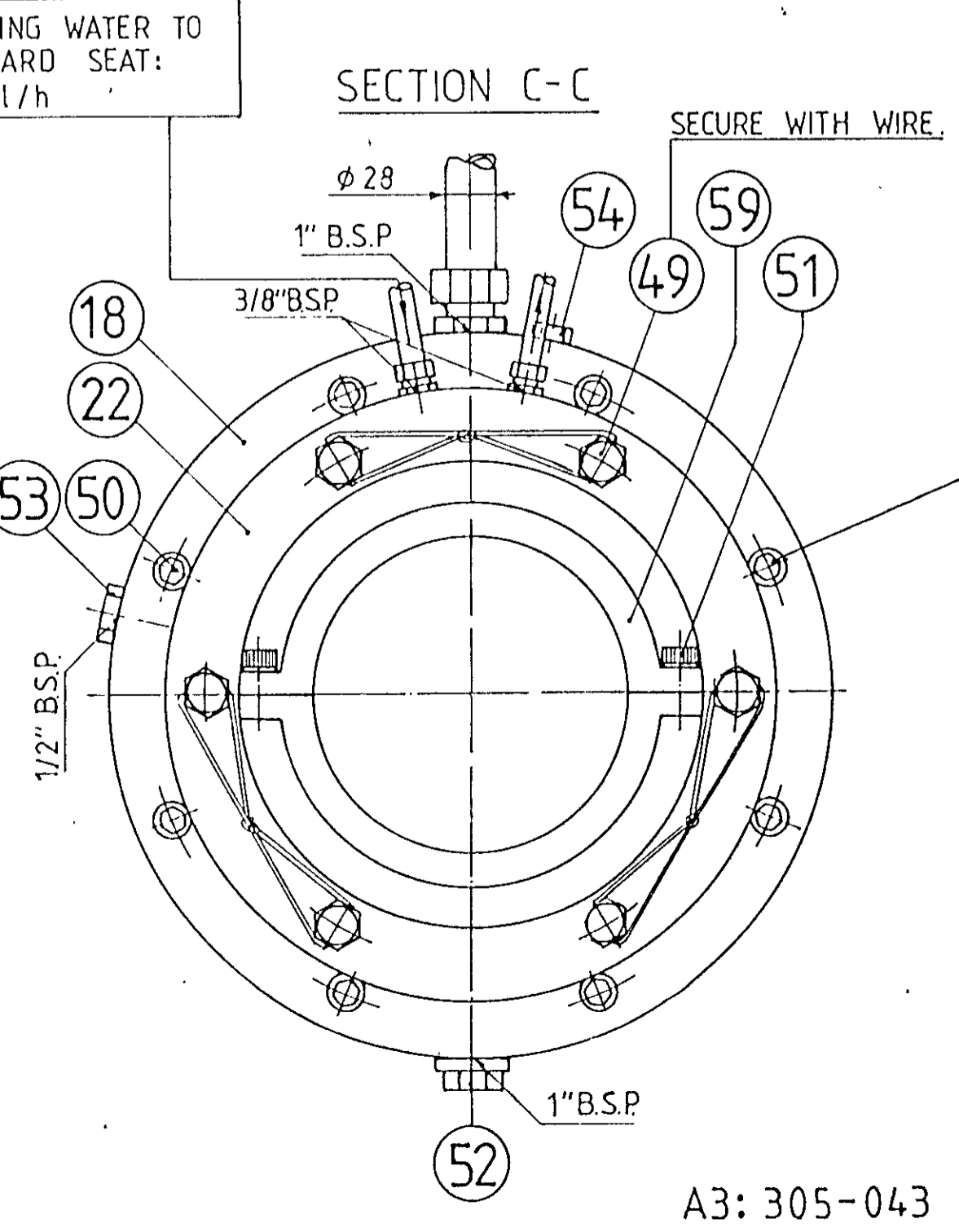
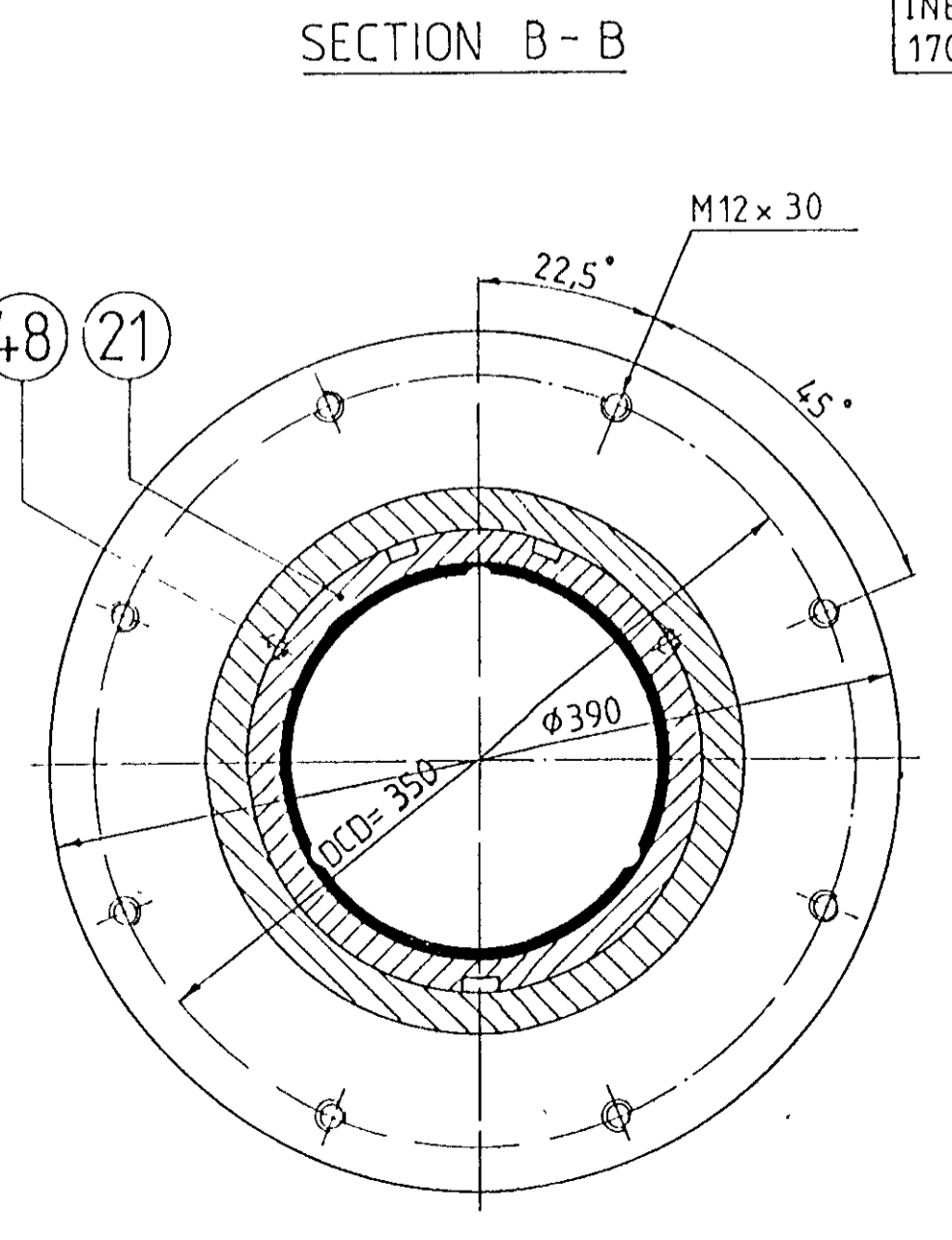
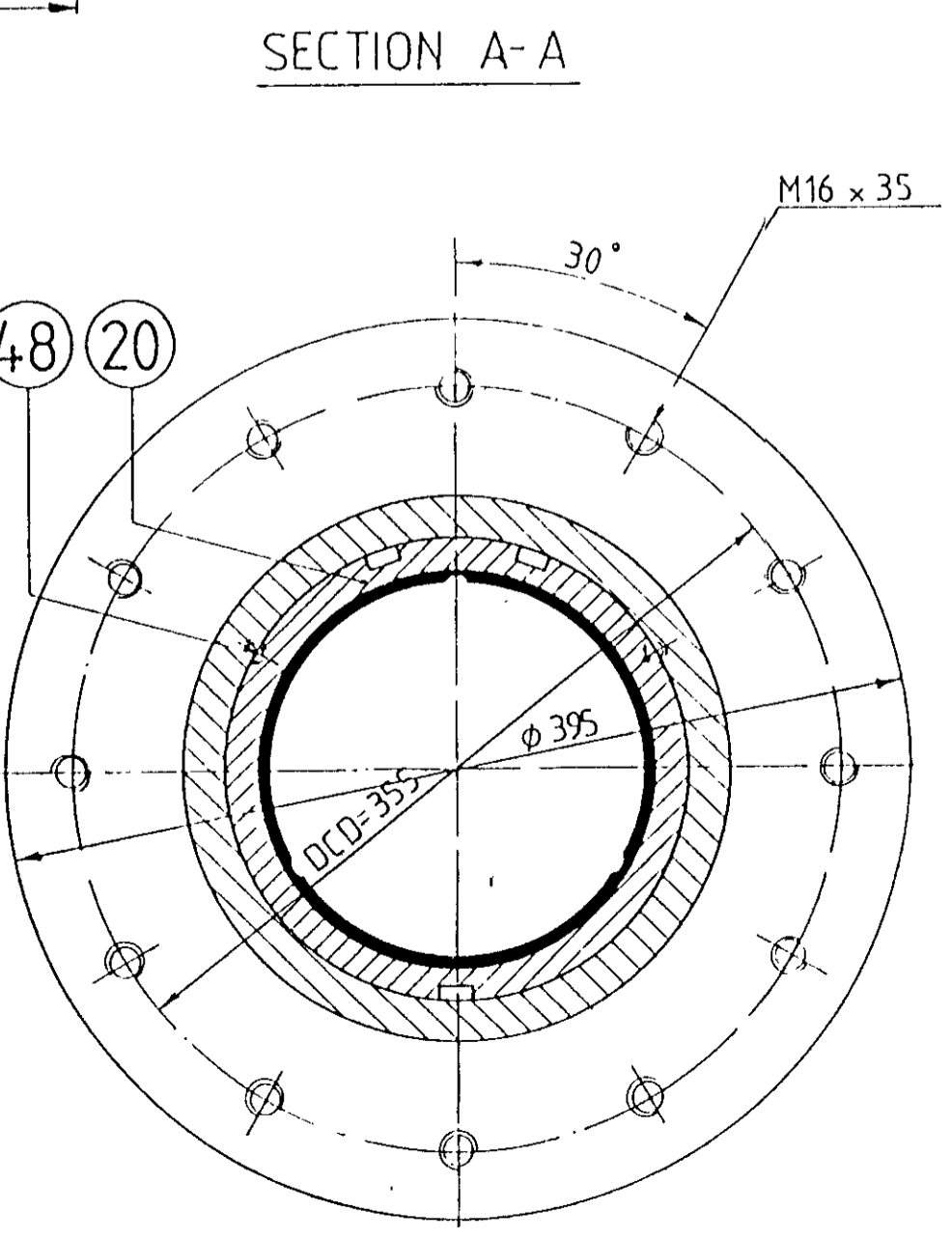
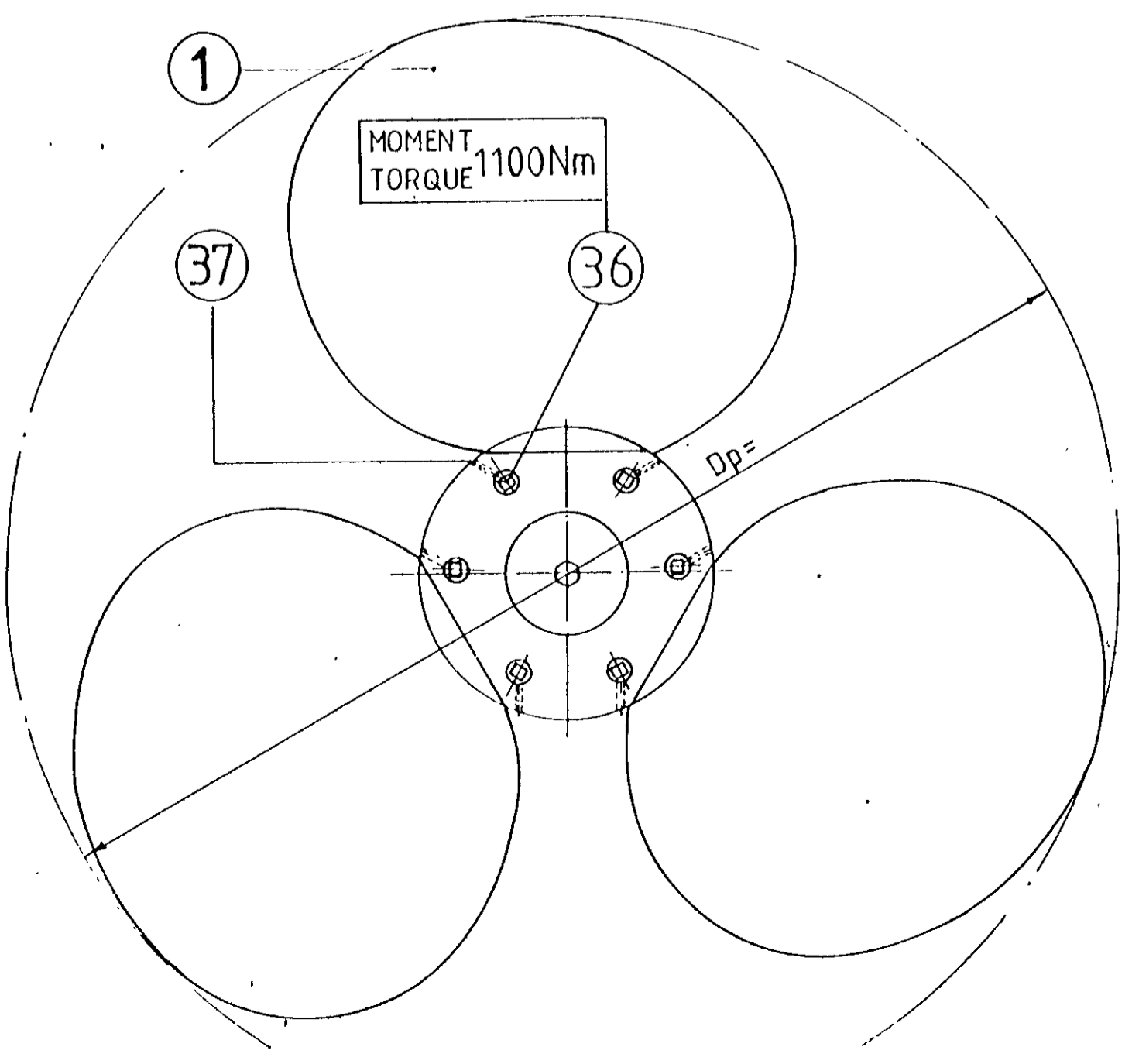
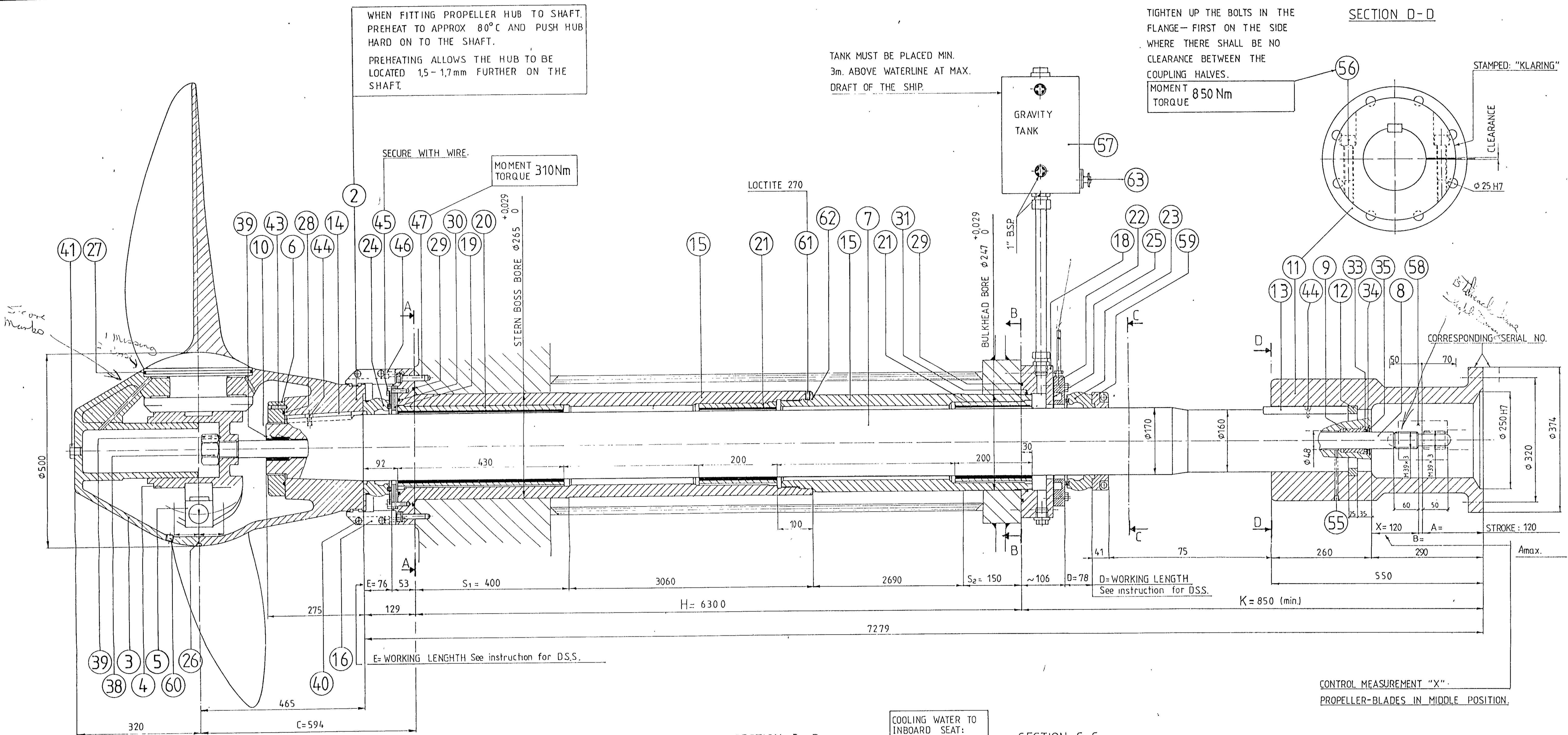

REF. 91006/CAN. DFO 29 MTR.

DO NOT SCALE!

Ant.	Gjenstand	Pos.	Materiale	Tegning nr	Mod nr	Anmerking
	PROPELLER ARRANGEMENT			Tegn 4/4.91.KE		Prod. 407-087
	K500/170/160		/DSS - HG3 S	Trac		108-096
	HEIMDAL PROPULSION A/S <small>Post Boks 2051, Maringhaug - 4401 Maritime, Norway</small>				Målestokk	Erst av

A3: 305-043

90-95