

1.1 MAIN FLOOR PLAN

BARRIER FREE DRAWING NOTES

ISSUED FOR DATE
DRAWING FOR REPORT 03/28/22

1 DOOR MAY REQUIRE AUTO OPERATOR FOR BARRIER FREE ACCESS TO ROOM

2 DOOR CLEARANCE NOT MET FOR BARRIER FREE

1200mm IS PREFERRED FOR CLEARANCE AROUND ALL MEETING FURNITURE. 1100mm MINIMUM.

1100mm AISLES REQUIRED EXCEPT FOR AUXILIARY AISLES NOT EXCEEDING 7.5m, PER THE AFC.

1700mm TURNING RADIUS REQUIRED BY CSSA B651-18.

DOOR CLEARANCES SHOWN PER THE CSA B651-18

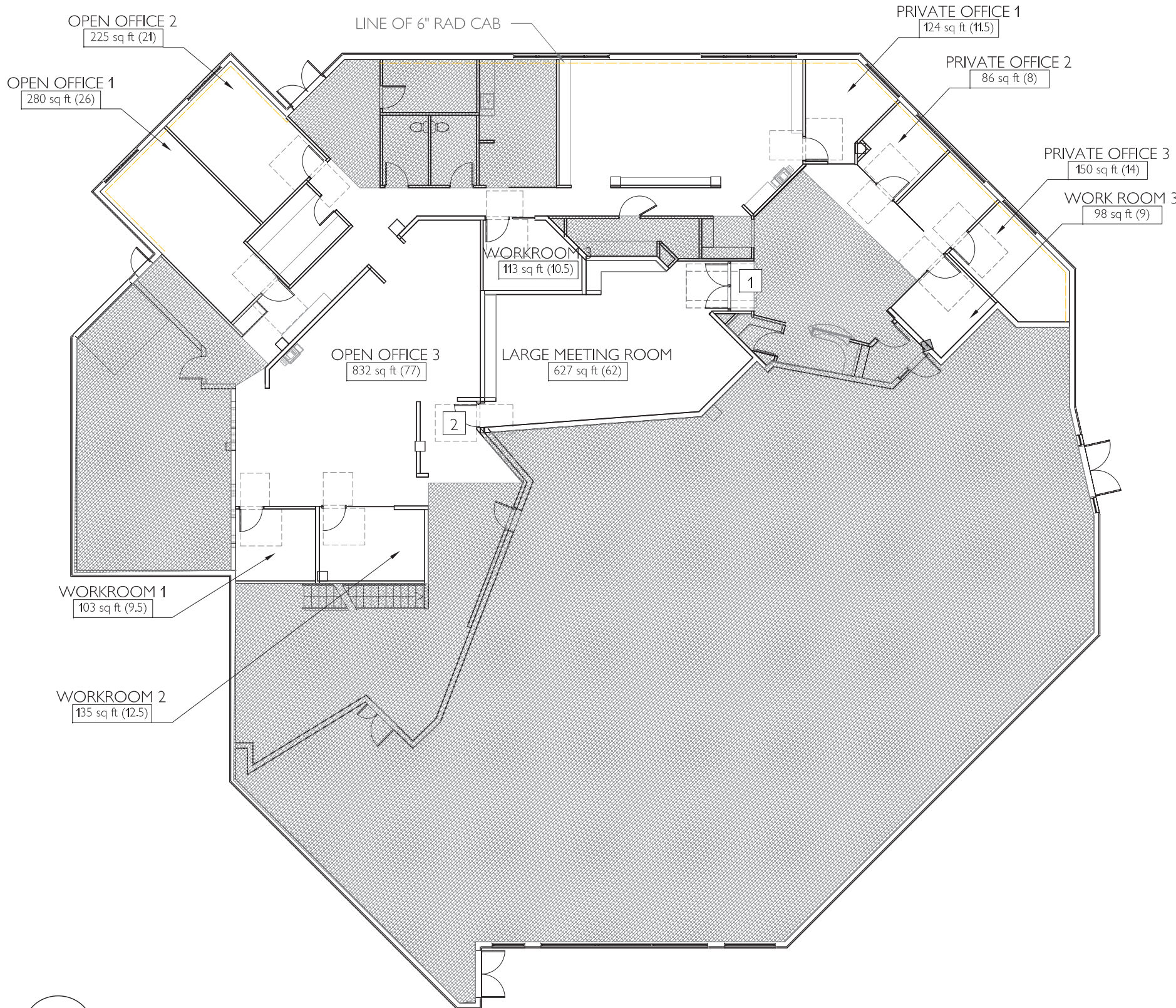

DRAWING #

ID2.0

FURN

PROJECT ADDRESS
LAKE LOUISE
ALBERTA

LEGAL ADDRESS

PROJECT NUMBER
Y21-0293

PROJECT TITLE
FLOOR PLAN

IDEALAB
LICENSED INTERIOR DESIGN
#300, 4838 RICHARD ROAD SW
CALGARY, AB

IDEALAB

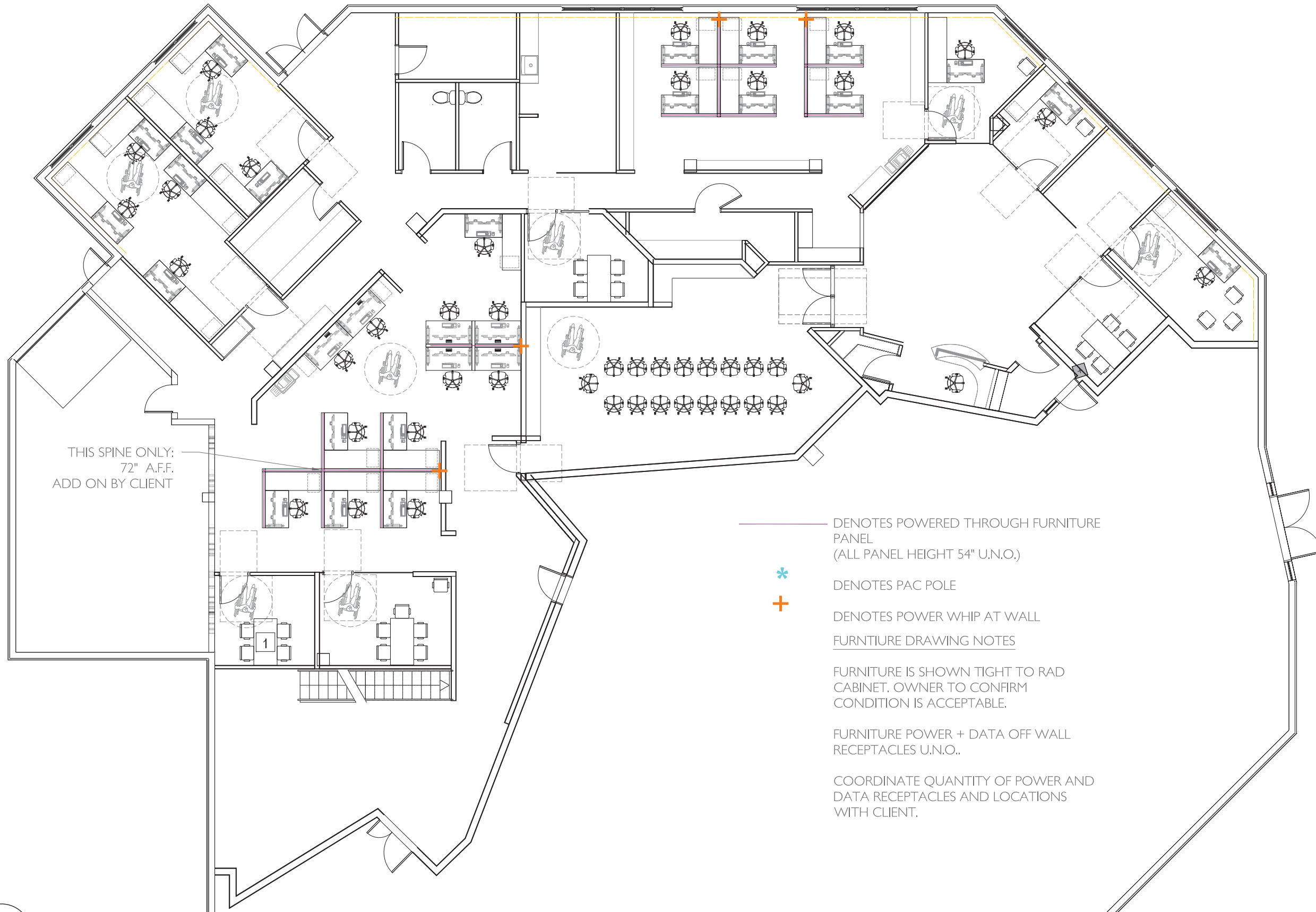

DRAWING #

ID2.1

FURN

PROJECT ADDRESS
LAKE LOUISE
ALBERTA

LEGAL ADDRESS

PROJECT NUMBER
Y21-0293

PROJECT TITLE
FURNITURE PLAN

IDEALAB
LICENSED INTERIOR DESIGN
#300, 4838 RICHARD ROAD SW
CALGARY, AB

IDEALAB

1

1.3 FURNITURE REFERENCE

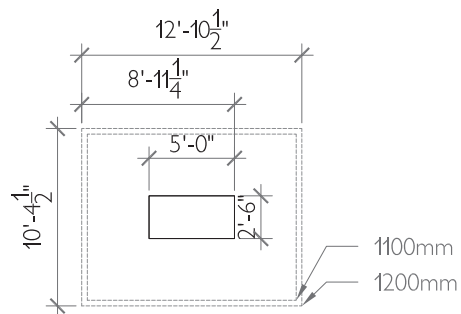
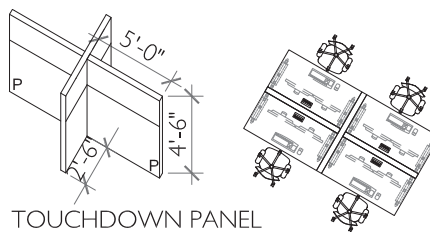
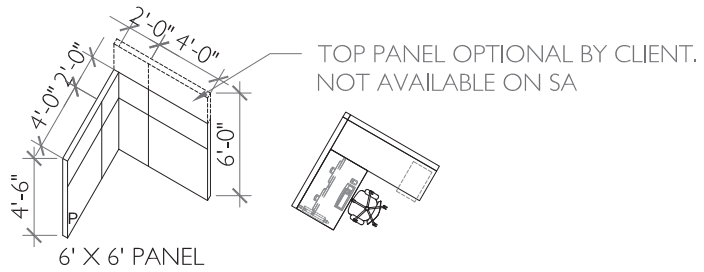
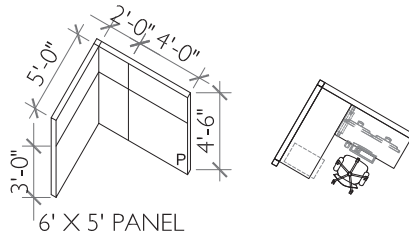
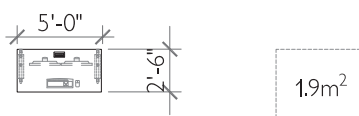
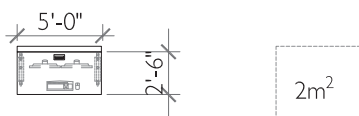
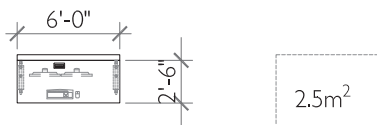
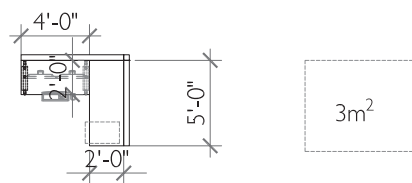
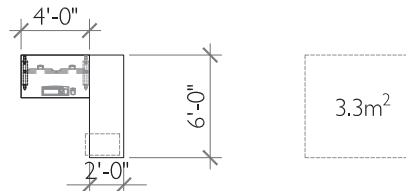
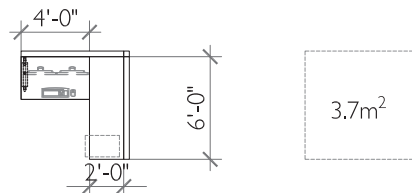
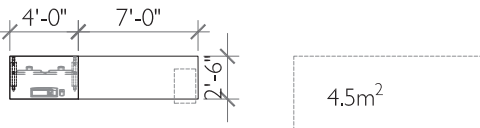
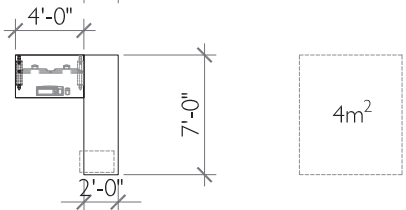
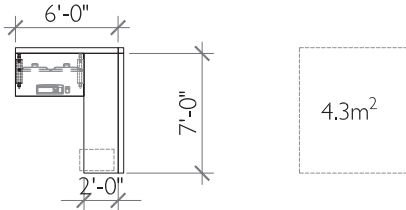
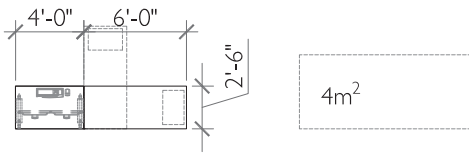

 SIDE CHAIR

 TASK CHAIR

1.1) PLAN DU REZ-DE-CHAUSSÉE

NOTES DE DESSIN SANS BARRIÈRE

Dessin pour le rapport

DATE
03/28/22

1 LA PORTE PEUT NÉCESSITER UNE AUTOMATION POUR UN ACCÈS SANS BARRIÈRE À LA PIÈCE.

2 LE DÉGAGEMENT DE LA PORTE N'EST PAS ADÉQUAT POUR UN ACCÈS SANS BARRIÈRE.

UN DÉGAGEMENT DE 1200 mm AUTOUR DE TOUS LES MEUBLES DE RÉUNION EST PRIVILÉGIÉ, JUSQU'À UN MINIMUM DE 1100 mm.

DES ALLÉES DE 1100 mm REQUISES, SAUF LES ALLÉES AUXILIAIRES, 7,5 m TOUT AU PLUS, EN VERTU DE L' AFC.

RAYON DE ROTATION DE 1700 mm REQUIS EN VERTU DE LA NORME CSA B651-18.

DÉGAGEMENTS DES PORTES INDIQUÉS EN VERTU DE LA NORME CSA B651-18

Numéro du dessin



Adresse du projet
Lake Louise, Alberta

Adresse légale

Numéro de projet

Y21-0293

Titre du projet
PLAN D'AMEUBLEMENT

IDEALAB
LICENSED INTERIOR DESIGN
#300, 4838 RICHARD ROAD SW
CALGARY, AB

IDEALAB

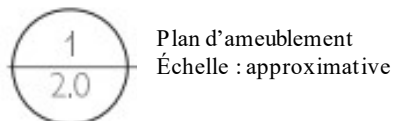
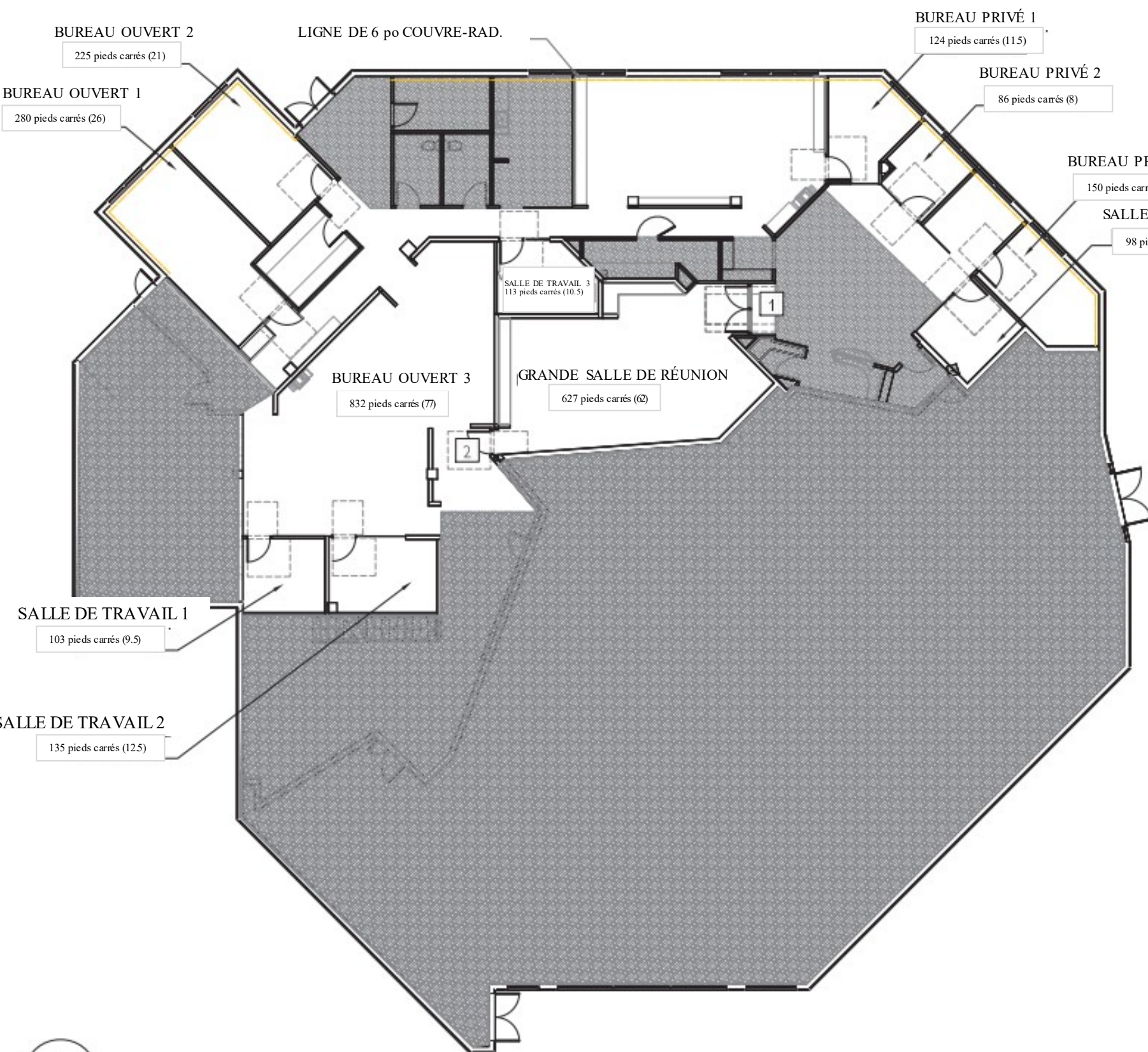

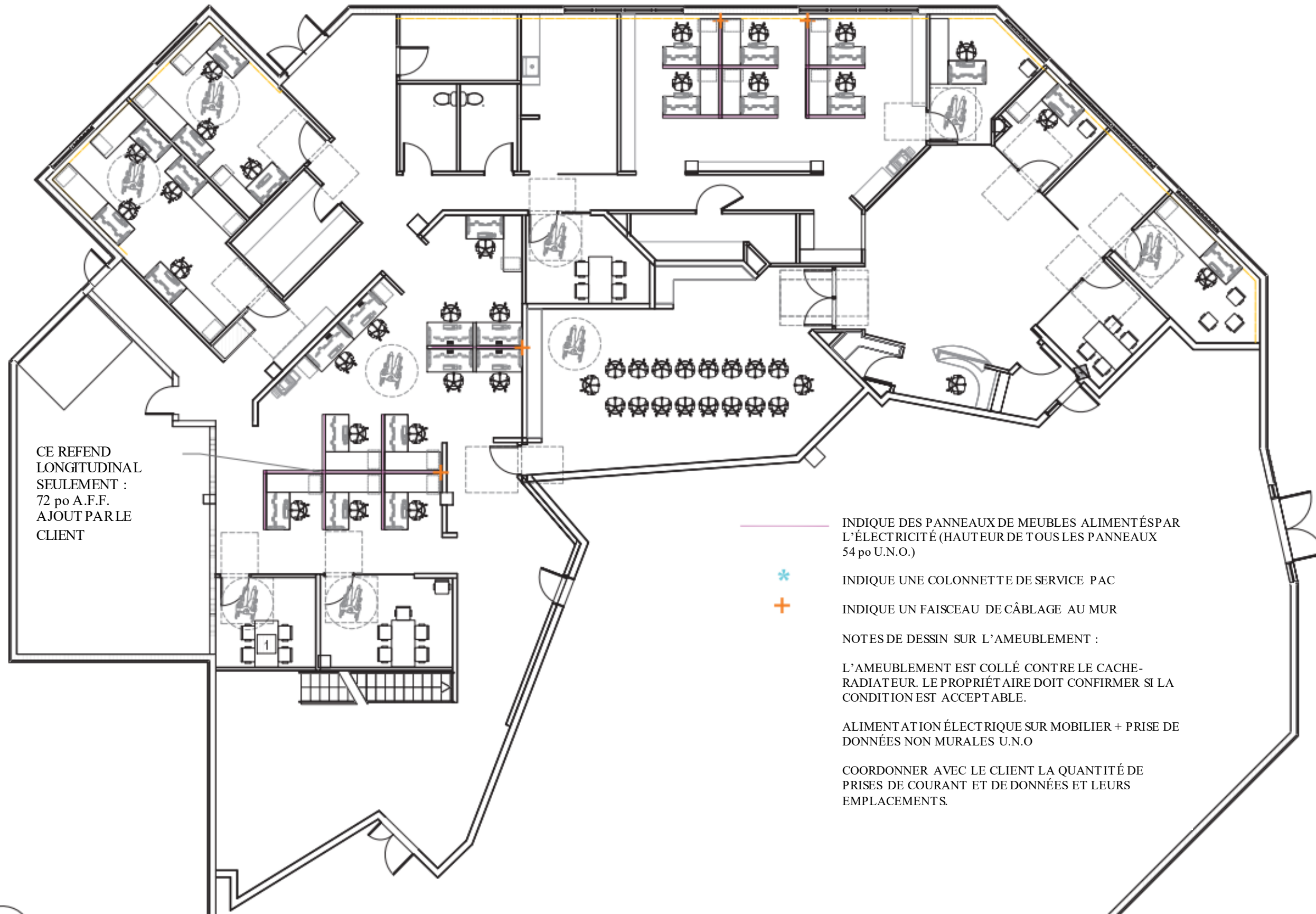

CE REFEND LONGITUDINAL SEULEMENT : 72 po A.F.F. AJOUT PAR LE CLIENT

— INDIQUE DES PANNEAUX DE MEUBLES ALIMENTÉS PAR L'ÉLECTRICITÉ (HAUTEUR DE TOUS LES PANNEAUX 54 po U.N.O.)

* INDIQUE UNE COLONNETTE DE SERVICE PAC

+ INDIQUE UN FAISCEAU DE CÂBLAGE AU MUR

NOTES DE DESSIN SUR L'AMEUBLEMENT :

L'AMEUBLEMENT EST COLLÉ CONTRE LE CACHE-RADIATEUR. LE PROPRIÉTAIRE DOIT CONFIRMER SI LA CONDITION EST ACCEPTABLE.

ALIMENTATION ÉLECTRIQUE SUR MOBILIER + PRISE DE DONNÉES NON MURALES U.N.O

COORDONNER AVEC LE CLIENT LA QUANTITÉ DE PRISES DE COURANT ET DE DONNÉES ET LEURS EMPLACEMENTS.

Numéro du dessin

ID2,1

FURN

Adresse du projet
Lake Louise, Alberta

Adresse légale

Numéro de projet

Y21-0293

Titre du projet
PLAN D'AMEUBLEMENT



IDEALAB
LICENSED INTERIOR DESIGN
#300, 4838 RICHARD ROAD SW
CALGARY, AB

IDEALAB

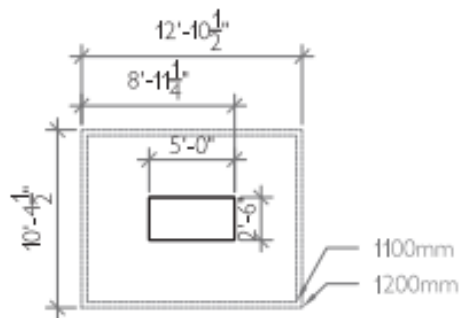
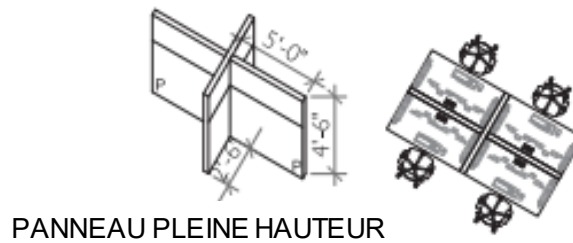
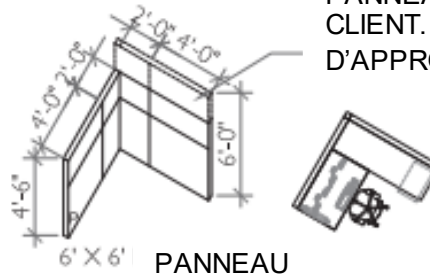
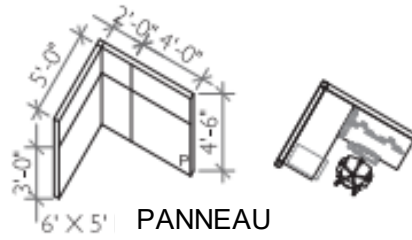
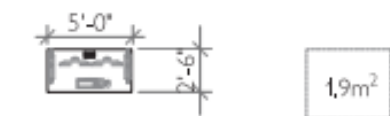
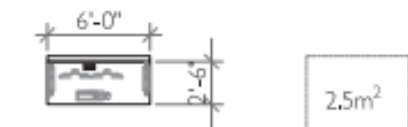
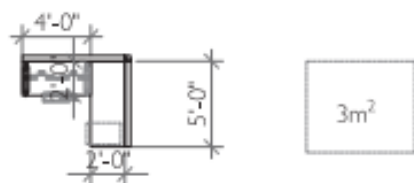
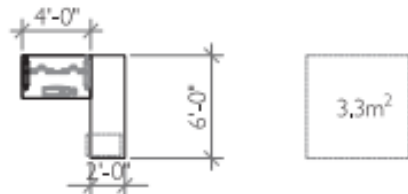
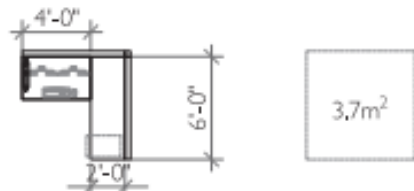
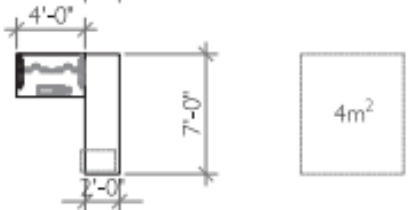
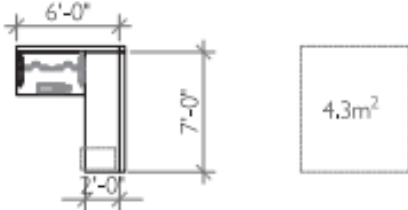
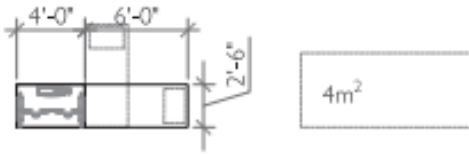
1.3 | RÉFÉRENCE D'AMEUBLEMENT



PANNEAU SUPÉRIEUR FACULTATIF POUR LE CLIENT. NON COMPRIS DANS L'ENTENTE D'APPROVISIONNEMENT.

-  FAUTEUIL D'APPOINT
-  FAUTEUIL DE BUREAU