



Date: October 26, 2023

Title: Design and Installation of a Microgrid at the High Commission of Canada in South Africa, in Pretoria

Solicitation Number: 24-250214

The following Questions & Answers is in link with the solicitation document mentioned above.

Questions & Answers # 3

Q16. “RFP Section 6 Electrical Requirements (page 53 of 65 of 24-250214---rfp.pdf) states “System must be supplied with lockable DC and AC disconnect switched.”
Query: Please confirm if these must be separate from the AC and DC combiner panels that would be installed.”

A16. *Yes, they must be separate.*

Q17. “RFP Section 6.4 Energy Storage Systems (page 55 of 65 of 24-250214---rfp.pdf)- In this section the following conditions need to be met, amongst others:
• “Energy storage systems (ESS) are to be located in a dedicated storage room, utility closet, service room, or similar area, or similar area that does not open into sleeping areas;”
Query:
Does this mean that the ESS should be located inside the main building or does the bidder have to provide this room outside the main building together with the inverters as it is stated in Section 6.2 Inverter(s): “Inverters must be located outside, in a NEMA 4 enclosure or equivalent.”

A17. *Please refer to addendum #3
Design/Builder can propose appropriate enclosure for the proposed ESS solution. (For Ex. new Utility room or self enclosure rated for outdoor application would be acceptable)*

Q18. “RFP Section 6.4 Energy Storage Systems (page 55 of 65 of 24-250214---rfp.pdf)- In this section the following conditions need to be met, amongst others:
• “Energy storage systems (ESS) are to be located in a dedicated storage room, utility closet, service room, or similar area, or similar area that does not open into sleeping areas;”
Query:
If the battery is located inside the building and the inverters outside the building this would double cable runs, would it not be more efficient if all the major equipment is in one location?”

A18. *Refer to answer A17. Efficient proposed locations are expected as part of the design phase.*

Q19. “RFP Section 6.4 Energy Storage Systems (page 55 of 65 of 24-250214---rfp.pdf)- In this section the following conditions need to be met, amongst others:
• “Individual ESS capacity does not exceed 20kWh;”
• “Multiple aggregate capacity does not exceed 40kWh;”
Query: Does the above mean that the Bidder is not required to size the ESS larger than the 40kWh as stated in the above, as the SOW requires 72hour backup at full load capacity, which means the existing diesel generator would still be the dominant source of energy if this is the case, could you please confirm if our understanding is correct or can the bidder size the ESS accordingly?”



A19. Refer to answer A17.

Q20. “Please confirm the building height.”

A20. *The height of the building varies. Height from the main entrance is 10.548m.*

Q21. “The on-site manholes, what services are they currently being used for (water, sewerage, electrical, telecoms)?”

A21. *Design Builder to confirm site conditions as part of the design phase first deliverable is a “Electrical and Structural Site Survey, and Assessment of Current Installations”.*

Q22. “Please confirm whether tree-cutting or trimming will be allowed.”

A22. *Tree cutting/trimming within the compound of the High Commission would be allowed to some extent if the benefits outweighs the drawbacks and as long as it is approved by Municipality.*

Q23. “Can the plans submitted to the Municipality for the existing carport structures please be shared?”

A23. *We do not have access to the plans for the carport installation.*

Q24. “Please confirm the dimensions of the existing car bays used for parking.”

A24. *Parking stalls are 2600mm width. Carport shading varies in size.*

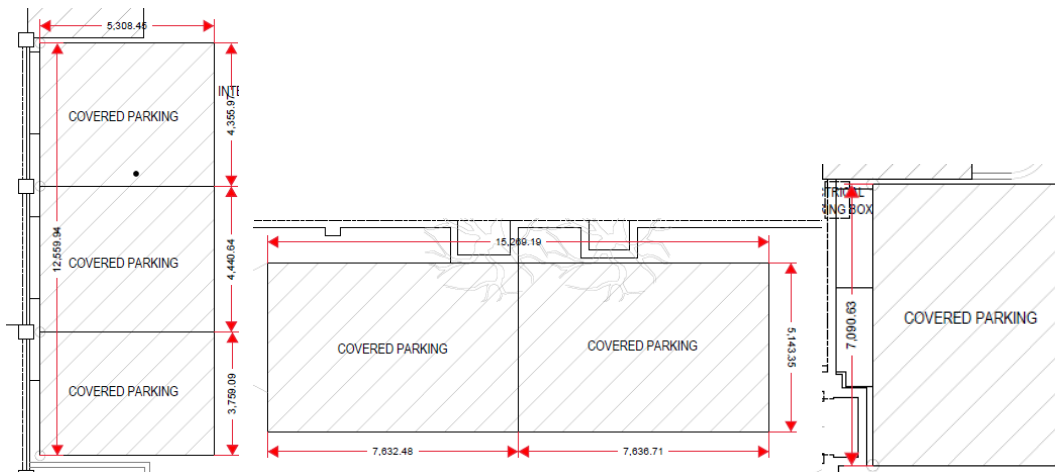

Q25. “Please confirm what type of roof the guard houses are and whether modules can be installed on them.”

A25. *The Guard house roof is made out of concrete. Modules could possibly be installed on the roof, pending validation by the bidders structural consultant and Global Affairs Canada’s Security team.*



Q26. “Please confirm what type of roof the generator room is and if modules can be installed on it.”

A26. *The Generator room roof is made out of concrete. Modules could possibly be installed on the roof, pending validation by the bidders structural consultant.*

Q27. “Please share measurements of the generator room.”

A27. *Exterior measurements of the Generator room are 2810.93mm by 6113.99mm.*

Q28. “Are there any water services drawings available indicating where these services are located underground?”

A28. *We do not have civil drawings available on site.*

Q29. “Please confirm whether the tie-in for the new system can occur after hours or on weekends.”

A29. *Yes, the tie-in for the new system can occur off-hours.*

Q30. “RFP section 1.7on submission requirements (Pg 2 of 65 of 24-250214---rfp.pdf): One of the points mentioned in this criteria states that ‘The e-mail was rejected or put in quarantine because it contains files that are not accepted by DFATD server, such as, but not limited to, .rar, encrypted .zip, encrypted .pdf, .exe., etc.’
Query: Kindly confirm that .zip, .exe and .pdf files will be acceptable as Point 1.4 of this clause states that the Bidders must provide their electronic proposals in Portable Document Format (.pdf) software.”

A31. *.zip and .pdf files can be accepted by the server, as long as they are not encrypted. .exe files cannot be accepted. It is requested that bidders provide their electronic proposals in Portable Document Format (.pdf) software application files or Microsoft office version 2003 or greater files, if possible, but it is not mandatory.*

Q31. “RFP TP8- Payment in Event of Termination (Pg 22 of 65 of 24-250214---rfp.pdf): This clause states that “if the Contract is terminated pursuant to GC41, His Majesty shall pay the Contractor any amount that is lawfully due and payable to the Contractor as soon as is practicable under the circumstances”.
Query: Ideally a contract should have timelines attached to such terms, request if the same can be taken into consideration when awarding the contract to the successful bidder.”

A31. *Section “II” Terms of Payment will provide this information. Payments under the contract will follow clause TP4 Time of Payment, which is 30 days. Please also review the GC41 clause as it does contain additional information.*

Q32. “RFP Formats for Broker and Insurer’s Insurance (Pg 46 & 47 of 65 of 24-250214---rfp.pdf):
Query: Will the local formats, deemed acceptable in South Africa, be permitted under the Broker and Insurer’s Certificate of Insurance (ensuring all the aspects of “all risks” are covered by the bidder)? Further, since the contract value will be ZAR (South African Rands),



please confirm the amount in ZAR that will now be specified for Insurance and for its deductibles.”

A32. *Yes, local formats which are deemed acceptable in South Africa will be accepted for the Broker and Insurer's Certificate of Insurance, as long as all the risk coverages are equivalent. The insurance and deductible values will be changed to ZAR, please refer to addendum #3.*

Q33. “Also, is it possible for us to get at least one electricity invoice from the municipality for the facility to aid with our battery selection?”

A33. *Yes. Invoice to follow.*
