



Public Works and
Government Services
Canada

Travaux publics et
Services gouvernementaux
Canada

RETURN BIDS TO:

RETOURNER LES SOUMISSIONS À:

See Section 1.
Voir Section 1.

STANDARD REQUEST FOR BID

INVITATION À SOUMISSIONNER - STANDARD

The Bidder offers to provide to Canada the goods, services or both listed in the bid solicitation in accordance with the conditions set out in the bid solicitation and the prices set out in the bid.

This bid solicitation is issued in accordance with the conditions of the Supply Arrangement E60PQ-140003/PQ.

Le soumissionnaire offre de fournir au Canada les biens, services ou les deux énumérés dans la demande de soumissions aux conditions prévues dans la demande de soumissions et aux prix indiqués dans la soumission.

Cette demande de soumissions est émise conformément aux conditions de l'arrangement en matière d'approvisionnement E60PQ-140003/PQ.

Solicitation No. - N° de la demande : 5000075713	Amendment No. - N° de modification 002
Supplier SA No. - N° de l'AMA de fournisseur : E60PQ-140003/___	

Solicitation closes – La demande prend fin :	File No. - N° de dossier 5000075713-02
at – à See Section 1	
 Voir Section 1	
on – le See Section 1	
 Voir Section 1	

Date of Solicitation – Date de la demande September 28, 2023
Address inquiries to – Adresser toute demande de renseignement à : See Section 2, Article 4.1. Voir Section 2, Article 4.1
Destination See Section 2, Annex A. Voir Section 2, Annexe A.

Instructions:

Municipal taxes are not applicable.

Unless otherwise specified in the bid solicitation, all prices quoted must be net prices in Canadian funds including Canadian customs duties, excise taxes, must be FOB, including all delivery charges to destination(s) as indicated. The amount for Applicable Taxes is to be shown as a separate item.

Instructions:

Les taxes municipales ne s'appliquent pas.

Sauf indication contraire dans la demande de soumissions, tous les prix indiqués doivent être des prix nets, en dollars canadiens, comprenant les droits de douane canadiens, la taxe d'accise et doivent être FAB, y compris tous frais de livraison à la (aux) destination(s) indiqué(s). Le montant des taxes applicables doit apparaître séparément.

Supplier Name and Address – Nom et adresse du fournisseur
Telephone No. - N° de téléphone
Facsimile No. - N° de télécopieur
Name and title of person authorized to sign on behalf of supplier (type or print) Nom et titre de la personne autorisée à signer au nom du fournisseur (caractère d'impression)
Signature : _____ Date : _____

The amendment to the bid solicitation is to address the enquiries received:

Response(s) (R) to Question(s) (Q):

Q1: Re. CAT 1B item A, Will the CA also accept a PET-Felt privacy screen?

R1: No the privacy screen needs to meet the SOW description.

Q2: Re. CAT 1B item A, Is this screen to be exactly 48"W or match the nominal height adjustable table CAT2 Item D width of 46"?

R2: 46" wide is acceptable.

Q3: Re. CAT 2 items D-G, Additional notes have the height adjustable surfaces as exact sizes, please advise if this is correct as they will not have any pinch point allowances, or will the CA accept nominal sizes per the SA i.e. 2" on width and 1" on depth to allow for pinch points and wire drops

R3: Nominal sizes are acceptable.

Q4: Re. CAT 1B item C, Network outlet connectors and hinged cable management systems that run along the base of the table do not form part of the SA and these specifications may be manufacture-specific. These components also will not work with the required minimum height of modesty on these desks that must sit above the floor. Please respectfully remove these requirements and utilize supplier-standard cable management that meets the SA requirements.

R4: Work surfaces must have at least one gutter below the surface to allow electrical and network cables to pass through. For fixed surfaces, it is not mandatory to have the cable management system articulated and flexible along the base, but the cable management gutter under the surface is mandatory.

Q5: Re. CAT 1B item C, A six-power outlet bar does not form part of the SA requirements for this GoCUID, if the CA requires this please respectfully add it as a non-SA item or procure it separately.

R5: We'll change it to non-SA. Power bar must be included in the quote.

Q6: Re. CAT 2 items D-G., The requirement for a cable management system that shall allow for the electrification of all workstations is not a requirement of the SA for freestanding height adjustable tables. Under these GoCUID each table per the SA will have its own cable management and dedicated power cord. What is being described is a shared hardwired feed in a benching application. Further, the required network outlet connectors and hinged cable management systems that run along the base of the table do not form part of the SA and these specifications may be manufacture-specific. Please respectfully remove these requirements.

R6: According to SA, all height-adjustable tables are equipped with a vertical cable routing system. We maintain the same requirements so that every workstation can be electrified and wired.

Q7: Re. CAT 2 items D-G., A six-power outlet bar does not form part of the SA requirements for this GoCUID, if the CA requires this please respectfully add it as a non-SA item or procure it separately.

R7: We'll change it to non-SA. Power bar must be included in the quote.

Q8: Category 1b, Item C, 1bFFHRED24L72WNOLNY, The cable management requirements as noted on page 11 fall outside the SA requirements for these worksurfaces (3.2.1. Category 1b, Freestanding worksurfaces, fixed height worksurfaces). Can you please move this item to NSA.

R8: Work surfaces must have at least one gutter below the surface to allow the passage of electrical and network cables. For fixed surfaces, a flexible, articulated cable management system along the base is not mandatory, but the cable management gutter under the surface is.

Q9: Category 1b, Item C, 1bFFHRED24L72WNOLNY, Can you please clarify what is meant by Network outlet connector? Is this a box/opening to house a data faceplate (provided by others)?

R9: It is a box/opening to house a data faceplate (provided by others).

Q10: Category 1b, Item C, 1bFFHRED24L72WNOLNY, Can you please clarify what is meant by Hinged and flexible cable management along the base? Is this located under the surface, or is the requirement for vertical wire management?

R10: The cable gutter must be below the surfaces.

Q11: Does the client require power outlets to be accessible from the top of the worksurface by way of a recessed power module? Or will grommets suffice for wires to pass thru to below?

R11: Power sockets (power bar of 6 sockets) must be below the surface and not accessible. A CAT 5 socket module is required for sockets on work surfaces. Grommets are used to pass cables for workstation equipment.

Q12: Will the power supply be hardwired for these worksurfaces? Or will the power be supplied from a plug from the wall?

R12: From a plug from the wall.

Q13: Category 2, Items D-G, can you please clarify what is meant by Network outlet connector? Is this a box/opening to house a data faceplate (provided by others)?

R13: It is a box/opening to house a data faceplate (provided by others).

Q14: Category 2, Items D-G, can you please clarify what is meant by Hinged and flexible cable management along the base? Is this located under the surface, or is the requirement for vertical wire management?

R14: The cable gutter must be below the surfaces.

Q15: Category 2, Items D-G, Will the power supply for these tables be supplied from the wall?

R15: Yes

The bid solicitation is amended as follows:

SECTION 1 – INVITATION AND INSTRUCTIONS TO BIDDERS

Delete:

RFB Issued by:	
Identified User's (IU) Department/Agency/Crown Corporation: Contact for this RFB:	See Section 2, article 4.1 below.
RFB Closing - Submit Bid: Bids must be submitted on the date and at the time indicated below.	
By no later than date and time:	October 12, 2023 2:00 pm EDT
To e-mail address:	soumissionsbids@ec.gc.ca
RFB Enquiries:	
Unless a different period is listed in the adjacent column, Bidders may submit enquires about the RFB to the Contracting Authority two business days prior to the RFB closing date. Enquiries received after the timeline indicated may not be answered.	3 business days

Insert:

RFB Issued by:	
Identified User's (IU) Department/Agency/Crown Corporation: Contact for this RFB:	See Section 2, article 4.1 below.
RFB Closing - Submit Bid: Bids must be submitted on the date and at the time indicated below.	
By no later than date and time:	October 17, 2023 2:00 pm EDT
To e-mail address:	soumissionsbids@ec.gc.ca
RFB Enquiries:	
Unless a different period is listed in the adjacent column, Bidders may submit enquires about the RFB to the Contracting Authority two business days prior to the RFB closing date. Enquiries received after the timeline indicated may not be answered.	3 business days

ANNEX A REQUIREMENT and BASIS OF PAYMENT is deleted in its entirety and replaced with the following:

**ANNEX A
REQUIREMENT and BASIS OF PAYMENT**

1. Category Selection

Combined Categories Rule:

For reasons of compatibility, the following categories will be combined for evaluation and contract award purposes:

The rule only applies to the categories below that are checked. The unchecked categories will be evaluated separately and may be awarded to multiple suppliers;

Category 1

Category 2

Category 5

*** Exception: when using the Cat 1, 2, 5 combined categories rule, IU's may calculate the percentage of NSA product allowed (as defined in their solicitation document) against the total quantity of the combined categories.**

Design Upgrade Rule:

The IU may exercise an option to upgrade products up to 20% of each Category product total before Applicable Taxes after contract award.

The Design Upgrade amount is used at the discretion of the Project Authority (PA) **prior to the manufacturing/ordering of the products**, the PA will provide the Contractor with a written notice of Canada's Design Upgrade choices for each of the product(s) to be upgraded. The Contractor will provide the pricing of the upgraded product(s) to a maximum of 20% of each Category Contract Price of Table 8. The Contracting Authority will issue an amendment to the contract with the Design Upgrades and pricing.

The Supplier certifies that all the Design Upgraded products offered will conform to all specifications and meet the testing requirements detailed in the Specifications of the Supply Arrangement.

Design Upgrade: is the process of replacing a product with a more innovative or enhanced version of the same product.

NSA:

NSA products can be incorporated in the RFB and must not exceed 30% of the firm quantity by category. NSA items must be added to the category that is most closely related and must be generic.

The requirement includes the following category (ies) of work:

a. Category 1 – Interconnecting Panels and Freestanding Systems

Category 1a – Interconnecting Panels (Refer to Annex C)

Category 1b – Supporting components and freestanding furniture

RULE: Metal Storage

Identified Users may procure metal storage products forming part of Category 1 when the metal storage products will be part of a requirement for a workstation(s)/work point(s). If this rule does not apply, Category 3 must be used for the metal storage products forming part of this category.

b. Category 2 – Freestanding Height Adjustable Desk / Table Products

c. Category 3 – Metal Filing and Storage Cabinets

Identifying the maximum height of the Personal Storage Towers, Wardrobes and Storage Cabinets is acceptable as per 6B. 4.1 of the SA (table 1 Additional product details)

d. Category 4 – Wood Veneer – Freestanding Products

e. Category 5 – Ancillary and Lighting Products

f. Category 6 - Support Space – Collaborative Furniture

RULE: Category 6 can be further subdivided by space or like product in order to increase or allow competition. Space is defined as a location available for a particular purpose such as a meeting room space or a collaborative space. Like products are defined as products with similar design and construction. If NSA products form part of the requirement, the IU must validate the 30% NSA prior to subdividing the category. NSA products can be added to any subdivide or in its own subdivide.

The IU must identify how Category 6 will be subdivided in the Product Table for Category 6.

g. NSA Product(s) – Category(ies): 5

2. Product and Pricing Tables

Site Inspection Date: To be coordinated with Project Authority after contract award. (Refer to Annex A article 4 of the SA for Site Inspection and Documentation instructions.)

INSTRUCTIONS TO BIDDERS: Bidders are to complete Sections B of the tables identified by the IU in this article as well as Tables 8 and 9. **Bidders must provide a complete product offering for each category, or CAT 6 sub-divide they wish to submit a bid in order to be compliant.**

****Refer to article 6A.7 for instructions on how to submit products that are not approved in product listing.****

In a resulting contract, the term “Bid” means the Supplier’s commitment, the term “Bidder” means “Contractor”.

Product Category(ies): 1B/2/5

Table 1 – Product Table

Section A - IU REQUIREMENT					Section B – SUPPLIER’S BID		
#	GoCUID	Description of Product <i>(Additional product details may be inserted, if required as per 6B. 4.1 of the SA)</i>	QTY	** Provide additional Information Yes/No	Supplier Part Number	Firm Unit Price \$	Extended Total [Qty x Price] \$
Category 1B							
A	1bCPSXXXSXXL4 8XFANNN	Privacy Screens	4	Yes			
B	1bSPBMCAA151 8XXYKXX	Pedestals Box/File	6	Yes			
C	1bFFHREG24L7 2WNOLNY	Fixed Height Work Surfaces	4	Yes		\$	\$
Category 2							
D	2WSSREXXL24L 72BELXX	Individual Height Adjustable Work Surfaces	2	Yes			
E	2WSSREXXL30L 48BELXX	Individual Height Adjustable Work Surfaces	6	Yes			
F	2WSSREXXL30L 54BELXX	Individual Height Adjustable Work Surfaces	2	Yes			
G	2WSSREXXL30L 60BELXX	Individual Height Adjustable Work Surfaces	1	Yes		\$	\$
Category 5							
K	5MOADUARMGRM MTXXXXX	Monitor Arms	9	Yes			
L	5PMOWKSMTACU SBXXXXX	Power Module	9	Yes		\$	\$
**Provide additional information:							
Canada is requesting bidders: to provide drawings and/or pictures including descriptive literature for these products with your bid submission.							
NSA products							
The Supplier signs, and certifies that all the NSA products offered will conform to all specifications and meet the testing requirements detailed at Annex D.							
Section A - IU REQUIREMENT					Section B – SUPPLIER’S BID		
#	NSA Product(s) Description		QTY	** Provide additional Information Yes/No	Supplier Part Number	Firm Unit Price \$	Extended Total [Qty x Price] \$
N	6-outlet power bar mounted under each table. The power cord must be at least 72 inches long.		15	Yes		\$	\$
					Product Total		\$

Description des items

Image: example of a workstation

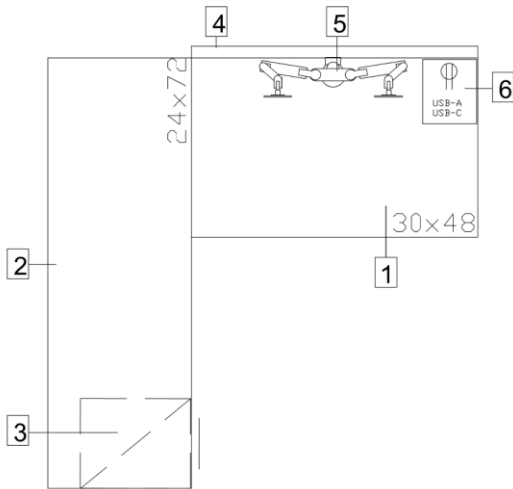

1	Individual height-adjustable work surfaces, 30 inches deep (Item E)
2	Individual height-adjustable work surface OR Fixed Height Work Surfaces, 24 inches depth (Items C et D)
3	Pedestal (Item B)
4	Privacy screen fixed on 30 inches depth work surface (Item A)
5	Dual monitor arm (Item K)
6	Power module (Item L)

A – Privacy Panels

Privacy panels must be attached to tables. Panels must be 48 inches long and a minimum of 28 inches high. The portion of the panels above the table must be at least 20 inches high.

Panels must be made of fabric. Fabric must have moisture, stain and odor resistant properties.

Upholstery seams must be straight and aligned with the frame. Upholstery or mesh fabric must have no wrinkling or stretching.

They must be constructed with a rigid wood, metal or plywood frame and finished according to the requirements detailed in the SA.

B - Pedestals

The pedestals must be lockable with keys. Two (2) keys per pedestal must be provided. Locks shall be unique and a master key must be provided to the departmental representative upon installation.

Pedestals shall have a padded fabric cushion on top.

Pedestals must have casters.

Pedestals must have two (2) drawers. Both drawers shall be locked simultaneously with the same key. The height of the pedestals, including casters and cushion, must not exceed 27 inches.

C - Fixed Height Work Surfaces

The surfaces must be in laminate. The base of the surface shall be 2 sides full height.

The shape of the tables is rectangular

The tables size is 24x72, 29 inches high.

Cables management

A cable management system shall be included. Cables must be concealed and shall allow for the electrification of all workstations.

For all tables, the supplier shall provide and install a cable management system that most include the following items:

- 6 outlet power bar attached under each table
- Network outlet connectors (2 network outlets for each 30" deep table)
- Cable management gutter under the surface
- Hinged and flexible cable management system along the base

Work surfaces and tables should have cable management accessories such as grommets. The grommets should be at the bottom of the surface.

D, E, F and G - Individual Height Adjustable Work Surfaces

Tables must be electrically adjustable and made of laminate. They must allow height adjustment between 23 and 48.7 inches.

Surfaces item D : Length 72 inches, depth 24 inches

Surfaces item E : Length 48 inches, depth 30 inches

Surfaces item F : Length 54 inches, depth 30 inches

Surfaces item G : Length 60 inches, depth 30 inches

The control mechanism shall have the ability to store at least two (2) adjustments. The control mechanism shall be installed and positioned to allow the user to easily adjust the tables. The mechanism must be installed on the front of the table on the right or left side, depending on the workstation layout.

Cables management

A cable management system shall be included. Cables must be concealed and shall allow for the electrification of all workstations.

For all tables, the supplier shall provide and install a cable management system that most include the following items:

- 6 outlet power bar attached under each table. The power cord must be at least 72 inches long.
- Network outlet connectors (2 network outlets for each 30" deep table)
- Cable management gutter under the surface
- Hinged and flexible cable management system along the base

Work surfaces and tables should have cable management accessories such as grommets. The grommets should be at the bottom of the surface.

K – Dual Monitors arms

Double articulated stand for computer screens from 23 to 28 inches. Stand shall allow adjustment of monitor position without tools. Stand shall allow for stacked and/or aligned monitor configuration.

L – External power supply module

Must be above the surface, on tables 30 inches deep (1 per table). Must have the following features:

- 2 electrical outlets
- 1 USB A type plug
- 1 USB C type plug

Table 2 - Delivery

Section A - IU REQUIREMENT				Section B – SUPPLIER’S BID	
Product Item # from Table 1	Location	Desired Date** (YYYY-MM-DD)	Desired Time: Normal Business Hours Or Outside Normal Business Hours *	Supplier will supply and deliver as per below**	Firm Lot Price \$
A-L & N	CMC Dorval 2121 Trans-Canada Highway, Dorval, QC H9P 1J3	ASAP Before 2023-12-17	Outside Normal Business Hours	_____ : weeks <i>Standard Lead time is between 6-10 weeks for furniture delivery and installation.</i>	\$
*Normal Business Hours 8:00 – 17:00, as per SA, Annex A, article 5 **The Project Authority (PA) will provide the supplier the authority to proceed prior to the finalized delivery date taking into consideration the delivery time provided by the supplier. Canada will not be responsible if the supplier chooses to proceed without the PA authorization.				Delivery Total:	\$

Table 3 – Installation

Section A - IU REQUIREMENT				Section B – SUPPLIER’S BID	
Product Item # from Table 1	Location	Desired Date** (YYYY-MM-DD)	Desired Time: Normal Business Hours Or Outside Normal Business Hours *	Supplier will install as per below**	Firm Lot Price \$
A-L & N	CMC Dorval 2121 Trans-Canada Highway, Dorval, QC H9P 1J3	ASAP Before 2023-12-17	Outside Normal Business Hours	_____ : weeks from date of supply and delivery <i>Standard Lead time is between 6-10 weeks for furniture delivery and installation.</i>	\$

<p>*Normal Business Hours 8:00 – 17:00, as per SA, Annex A, article 5</p> <p>**The Project Authority (PA) will provide the supplier the authority to proceed prior to the finalized installation date taking into consideration the installation time provided by the supplier. Canada will not be responsible if the supplier chooses to proceed without the PA authorization.</p>	Installation Total:	\$
---	---------------------	----

Table 4 – Optional Product Not Applicable

Table 5 – Optional Delivery Not Applicable

Table 6 – Optional Installation Not Applicable

Table 7 – Standard Finishes and Canada’s Facilities to Accommodate the Delivery and Certifications

1.	Standard Finishes	
1.1	<p>IU is to consult the Supplier’s Website identified in Part 6A of the SA to view the available finishes.</p> <p>Within ten business days of the contract award, the Project Authority will provide the Contractor with a written notice of Canada’s finish choices for each of the product(s) in Annex A.</p> <p>The Contractor will deliver the products corresponding to Canada’s choice of specific finishes(s). No additional charge will be applied to Canada.</p>	
2.	Canada’s Facilities to Accommodate the Delivery	
	<p><i>The Supplier’s employees and subcontractors requiring access to the site must adhere to the health and safety plans established for the site, in addition to any laws in effect in the jurisdiction where the work is being performed.</i></p> <p><i>During the period of the contract, a representative of Canada or a service provider(s) under contract with the Government of Canada may request the list of employees and subcontractors requiring access to the site to perform the work and their security statuses. Information must be provided in the timeframe prescribed in order to ensure that the supply, delivery and installation of the furniture aligns with the master schedule.</i></p>	
2.1	Loading Dock/Location	
A	Location	2121 Trans-Canada Highway, Dorval, QC H9P 1J3
B	Dock	N/A
C	Lift	does not exist
D	Door	Elevator doors: 3½ by 7 feet
E	Freight Elevator	Access is via the main entrance on the first floor (double door)
F	Other (specify, if any)	2 conventional elevators with a maximum capacity of 1135kg/elevator
3.	Continuance of Certifications	
	<p>The Bidder certifies that by submitting a bid in response to the RFB, the Bidder, and any of the Bidder’s members if the Bidder is a Joint Venture, continues to comply with all of the following certifications listed in Parts 6A and 6B of the Bidder’s SA for Work Spaces.</p> <p>Canada may request copies of environmental certification(s) prior to contract award within a time period specified by the Identified User.</p>	
3.1	Integrity Provisions	
3.2	Federal Contractor’s Program for Employment Equity	
3.4	Product Conformance	
3.5	Price Certification (In accordance with the SA, Part 6B)	

Table 8 - Bid Evaluation and Contract Total

(Canada may complete if not completed by the Bidder)

1	Firm Product Total (Table 1)	\$
2	Firm Delivery Total (Table 2)	\$
3	Firm Installation Total (Table 3)	\$
4	Total Evaluated (Bid) Price* (1 + 2 + 3) [to be removed at contract award]	\$
5	Applicable Tax(es): [applicable at contract award only]	\$
6	Total Estimated Cost (4 + 5): [applicable at contract award only]	\$

* Applicable taxes extra.

Table 9 – Bidder’s Authorized Representative

1.	Bidder’s Authorized Representative for the Bid and the Contract		
	Name:	Telephone:	
		E-Mail:	
		PBN:	

Product Category: 3

Table 1 – Product Table

Section A - IU REQUIREMENT				Section B – SUPPLIER’S BID			
#	GoCUID	Description of Product (Additional product details may be inserted, if required as per 6B. 4.1 of the SA)	QTY	** Provide additional Information Yes/No	Supplier Part Number	Firm Unit Price \$	Extended Total [Qty x Price] \$
H	3FLT3DXXPM36D 18XXXS	Filing Cabinet	4	Yes		\$	\$
I	3FLT4DXXPM36D 18XXXS	Filing Cabinet	1	Yes		\$	\$
J	3WSDHHXXLM48D 24HIXK	Wardrobes	1	Yes		\$	\$
**Provide additional information:							
Canada is requesting bidders: to provide drawings and/or pictures including descriptive literature for these products with your bid submission.							
					Product Total	\$	

H - Filing cabinets, 3 drawers

Lateral filing cabinet 36 x18, with one digital combination lock per drawer.

Filing cabinets shall be painted metal.

Procedures for use of lock modules shall be provided to the departmental representative at the time of installation. 2 master keys to open all file cabinets shall be provided to the Departmental Representative at the time of installation.

If the lock module is battery operated, batteries must be included. If the lock module does not have batteries, at least one charger must be provided to the departmental representative.

I - Filing cabinets, 4 drawers

Lateral filing cabinet 36 x18, with one digital combination lock per drawer.

Filing cabinets shall be painted metal.

Procedures for use of lock modules shall be provided to the departmental representative at the time of installation. 2 master keys to open all file cabinets shall be provided to the Departmental Representative.

If the lock module is battery operated, batteries must be included. If the lock module does not have batteries, at least one charger must be provided to the departmental representative.

J – Wardrobes

Dimensions: 48 inches long and 24 inches deep. Cabinet height must be at least 54 inches, maximum 78 inches.

Cabinet must have 2 sliding doors.

The cabinet must have a shelf at the bottom (about 15 inches from the bottom) and a pole at the top.

No lock required.

Table 2 - Delivery

Section A - IU REQUIREMENT				Section B – SUPPLIER’S BID	
Product Item # from Table 1	Location	Desired Date** (YYYY-MM-DD)	Desired Time: Normal Business Hours Or Outside Normal Business Hours *	Supplier will supply and deliver as per below**	Firm Lot Price \$
H-J	CMC Dorval 2121 Trans-Canada Highway, Dorval, QC H9P 1J3	ASAP Before 2023-12-17	Outside Normal Business Hours	_____ : weeks <i>Standard Lead time is between 6-10 weeks for furniture delivery and installation.</i>	\$
*Normal Business Hours 8:00 – 17:00, as per SA, Annex A, article 5				Delivery Total:	\$
**The Project Authority (PA) will provide the supplier the authority to proceed prior to the finalized delivery date taking into consideration the delivery time provided by the supplier. Canada will not be responsible if the supplier chooses to proceed without the PA authorization.					

Table 3 – Installation

Section A - IU REQUIREMENT				Section B – SUPPLIER'S BID	
Product Item # from Table 1	Location	Desired Date** (YYYY-MM-DD)	Desired Time: Normal Business Hours Or Outside Normal Business Hours *	Supplier will install as per below**	Firm Lot Price \$
H-J	CMC Dorval 2121 Trans-Canada Highway, Dorval, QC H9P 1J3	ASAP Before 2023-12-17	Outside Normal Business Hours	_____ : weeks from date of supply and delivery <i>Standard Lead time is between 6-10 weeks for furniture delivery and installation.</i>	\$
*Normal Business Hours 8:00 – 17:00, as per SA, Annex A, article 5 **The Project Authority (PA) will provide the supplier the authority to proceed prior to the finalized installation date taking into consideration the installation time provided by the supplier. Canada will not be responsible if the supplier chooses to proceed without the PA authorization.				Installation Total:	\$

Table 4 – Optional Product Not Applicable

Table 5 – Optional Delivery Not Applicable

Table 6 – Optional Installation Not Applicable

Table 7 – Standard Finishes and Canada’s Facilities to Accommodate the Delivery and Certifications

1.	Standard Finishes	
1.1	<p>IU is to consult the Supplier’s Website identified in Part 6A of the SA to view the available finishes.</p> <p>Within ten business days of the contract award, the Project Authority will provide the Contractor with a written notice of Canada’s finish choices for each of the product(s) in Annex A.</p> <p>The Contractor will deliver the products corresponding to Canada’s choice of specific finishes(s). No additional charge will be applied to Canada.</p>	
2.	Canada’s Facilities to Accommodate the Delivery	
	<p><i>The Supplier’s employees and subcontractors requiring access to the site must adhere to the health and safety plans established for the site, in addition to any laws in effect in the jurisdiction where the work is being performed.</i></p> <p><i>During the period of the contract, a representative of Canada or a service provider(s) under contract with the Government of Canada may request the list of employees and subcontractors requiring access to the site to perform the work and their security statuses. Information must be provided in the timeframe prescribed in order to ensure that the supply, delivery and installation of the furniture aligns with the master schedule.</i></p>	
2.1	Loading Dock/Location	
A	Location	2121 Trans-Canada Highway, Dorval, QC H9P 1J3
B	Dock	N/A
C	Lift	does not exist
D	Door	Elevator doors: 3½ by 7 feet
E	Freight Elevator	Access is via the main entrance on the first floor (double door)

F	Other (specify, if any)	2 conventional elevators with a maximum capacity of 1135kg/elevator
3. Continuance of Certifications		
The Bidder certifies that by submitting a bid in response to the RFB, the Bidder, and any of the Bidder's members if the Bidder is a Joint Venture, continues to comply with all of the following certifications listed in Parts 6A and 6B of the Bidder's SA for Work Spaces.		
Canada may request copies of environmental certification(s) prior to contract award within a time period specified by the Identified User.		
3.1	Integrity Provisions	
3.2	Federal Contractor's Program for Employment Equity	
3.4	Product Conformance	
3.5	Price Certification (In accordance with the SA, Part 6B)	

Table 8 - Bid Evaluation and Contract Total

(Canada may complete if not completed by the Bidder)

1	Firm Product Total (Table 1)	\$
2	Firm Delivery Total (Table 2)	\$
3	Firm Installation Total (Table 3)	\$
4	Total Evaluated (Bid) Price* (1 + 2 + 3) [to be removed at contract award]	\$
5	Applicable Tax(es): [applicable at contract award only]	\$
6	Total Estimated Cost (4 + 5): [applicable at contract award only]	\$

* Applicable taxes extra.

Table 9 – Bidder's Authorized Representative

1.	Bidder's Authorized Representative for the Bid and the Contract		
	Name:	Telephone:	
		E-Mail:	
		PBN:	

Product Category: 6

Table 1 – Product Table

Section A - IU REQUIREMENT				Section B – SUPPLIER'S BID			
#	GoCUID	Description of Product (Additional product details may be inserted, if required as per 6B. 4.1 of the SA)	QTY	** Provide additional Information Yes/No	Supplier Part Number	Firm Unit Price \$	Extended Total [Qty x Price] \$
M	6LFSUPXXXXW8X XXTXXX	Free standing screen	2	Yes		\$	\$
**Provide additional information:							
Canada is requesting bidders: to provide drawings and/or pictures including descriptive literature for these products with your bid submission.							
					Product Total	\$	

M – Free standing screen

Dimensions: Length 48 inches, height 54 inches, maximum depth 4 inches.

The screen must be made of padded fabric.

Fabric must have moisture, stain and odor resistant properties.

Upholstery seams must be straight and aligned with the frame. Upholstery or mesh fabric must be wrinkle-free and stretch-free.

Table 2 - Delivery

Section A - IU REQUIREMENT				Section B – SUPPLIER’S BID	
Product Item # from Table 1	Location	Desired Date** (YYYY-MM-DD)	Desired Time: Normal Business Hours Or Outside Normal Business Hours *	Supplier will supply and deliver as per below**	Firm Lot Price \$
M	CMC Dorval 2121 Trans-Canada Highway, Dorval, QC H9P 1J3	ASAP Before 2023-12-17	Outside Normal Business Hours	_____ : weeks <i>Standard Lead time is between 6-10 weeks for furniture delivery and installation.</i>	\$
*Normal Business Hours 8:00 – 17:00, as per SA, Annex A, article 5				Delivery Total:	\$
**The Project Authority (PA) will provide the supplier the authority to proceed prior to the finalized delivery date taking into consideration the delivery time provided by the supplier. Canada will not be responsible if the supplier chooses to proceed without the PA authorization.					

Table 3 – Installation

Section A - IU REQUIREMENT				Section B – SUPPLIER’S BID	
Product Item # from Table 1	Location	Desired Date** (YYYY-MM-DD)	Desired Time: Normal Business Hours Or Outside Normal Business Hours *	Supplier will install as per below**	Firm Lot Price \$
M	CMC Dorval 2121 Trans-Canada Highway, Dorval, QC H9P 1J3	ASAP Before 2023-12-17	Outside Normal Business Hours	_____ : weeks from date of supply and delivery <i>Standard Lead time is between 6-10 weeks for furniture delivery and installation.</i>	\$
*Normal Business Hours 8:00 – 17:00, as per SA, Annex A, article 5				Installation Total:	\$
**The Project Authority (PA) will provide the supplier the authority to proceed prior to the finalized installation date taking into consideration the installation time provided by the supplier. Canada will not be responsible if the supplier chooses to proceed without the PA authorization.					

Table 4 – Optional Product

Not Applicable

Table 5 – Optional Delivery Not Applicable

Table 6 – Optional Installation Not Applicable

Table 7 – Standard Finishes and Canada’s Facilities to Accommodate the Delivery and Certifications

1.	Standard Finishes	
1.1	<p>IU is to consult the Supplier’s Website identified in Part 6A of the SA to view the available finishes.</p> <p>Within ten business days of the contract award, the Project Authority will provide the Contractor with a written notice of Canada’s finish choices for each of the product(s) in Annex A.</p> <p>The Contractor will deliver the products corresponding to Canada’s choice of specific finishes(s). No additional charge will be applied to Canada.</p>	
2.	Canada’s Facilities to Accommodate the Delivery	
	<p><i>The Supplier’s employees and subcontractors requiring access to the site must adhere to the health and safety plans established for the site, in addition to any laws in effect in the jurisdiction where the work is being performed.</i></p> <p><i>During the period of the contract, a representative of Canada or a service provider(s) under contract with the Government of Canada may request the list of employees and subcontractors requiring access to the site to perform the work and their security statuses. Information must be provided in the timeframe prescribed in order to ensure that the supply, delivery and installation of the furniture aligns with the master schedule.</i></p>	
2.1	Loading Dock/Location	
A	Location	2121 Trans-Canada Highway, Dorval, QC H9P 1J3
B	Dock	N/A
C	Lift	does not exist
D	Door	Elevator doors: 3½ by 7 feet
E	Freight Elevator	Access is via the main entrance on the first floor (double door)
F	Other (specify, if any)	2 conventional elevators with a maximum capacity of 1135kg/elevator
3.	Continuance of Certifications	
	<p>The Bidder certifies that by submitting a bid in response to the RFB, the Bidder, and any of the Bidder’s members if the Bidder is a Joint Venture, continues to comply with all of the following certifications listed in Parts 6A and 6B of the Bidder’s SA for Work Spaces.</p> <p>Canada may request copies of environmental certification(s) prior to contract award within a time period specified by the Identified User.</p>	
3.1	Integrity Provisions	
3.2	Federal Contractor’s Program for Employment Equity	
3.4	Product Conformance	
3.5	Price Certification (In accordance with the SA, Part 6B)	

Table 8 - Bid Evaluation and Contract Total

(Canada may complete if not completed by the Bidder)

1	Firm Product Total (Table 1)	\$
2	Firm Delivery Total (Table 2)	\$
3	Firm Installation Total (Table 3)	\$
4	Total Evaluated (Bid) Price* (1 + 2 + 3) [to be removed at contract award]	\$
5	Applicable Tax(es): [applicable at contract award only]	\$
6	Total Estimated Cost (4 + 5): [applicable at contract award only]	\$

* Applicable taxes extra.

Table 9 – Bidder’s Authorized Representative

1.	Bidder’s Authorized Representative for the Bid and the Contract	
	Name:	Telephone:
		E-Mail:
		PBN:

All other terms and conditions of the Bid Solicitation remain the same.