

Plot Date: 2023-05-19  
 Grandeur de papier: B1707x1000mm  
 File Path: Y:\2023\03823\_Botsford Shore Protection - BC1036-23-002\_Sheets\Phase 1 Containment Cell  
 Numero du Plan: 036-23-1-C2 (REV)  
 Drawing Number: 036-23-1-C2 (REV)

TANGENT TABLE: BOTSFORD WHARF CONTAINMENT CELL CONSTRUCTION					
TANGENT #	LENGTH	DIRECTION	START POINT	END POINT	FINISH GRADE
L1	27.98	S16° 07' 01"W	(2698092.091,7466324.327)	(2698084.322,7466297.443)	5.50m
L2	20.52	S89° 34' 49"E	(2698093.856,7466284.668)	(2698114.380,7466284.517)	5.50m
L3	28.39	N16° 20' 22"E	(2698118.248,7466287.392)	(2698126.236,7466314.639)	5.50m
L4	19.53	N87° 17' 36"W	(2698116.296,7466328.585)	(2698096.785,7466329.508)	5.50m
L5	2.35	S16° 02' 25"W	(2698092.751,7466326.617)	(2698092.103,7466324.360)	5.50m
T9	56.82	S16° 07' 01"W	(2698115.793,7466333.619)	(2698100.020,7466279.034)	5.50m

Curve Table: Alignments										
Curve #	Radius	Delta Angle (I)	Length (Lc)	Tc	T.C.	C.T.	PI	Center Coordinates	Back Azimuth (+180°)	Ahead Azimuth
C1	10.000	105° 41' 50.21"	18.448	13.198	2+027.983, 7466297.443, 2698084.322	2+046.431, 7466284.668, 2698093.856	2+041.181, 7466284.764, 2698080.659	7466294.667, 2698093.929	196° 07' 00.99"	090° 25' 10.79"
C2	4.000	074° 04' 49.17"	5.172	3.019	2+066.955, 7466284.517, 2698114.380	2+072.127, 7466287.392, 2698118.248	2+069.974, 7466284.495, 2698117.398	7466288.517, 2698114.409	090° 25' 10.79"	016° 20' 21.61"
C3	10.894	103° 37' 58.09"	19.704	13.851	2+100.521, 7466314.639, 2698126.236	2+120.224, 7466328.585, 2698116.296	2+114.372, 7466327.931, 2698130.132	7466317.704, 2698115.782	016° 20' 21.61"	272° 42' 23.52"
C4	4.000	076° 39' 58.71"	5.352	3.163	2+139.758, 7466329.508, 2698096.785	2+145.110, 7466326.617, 2698092.751	2+142.921, 7466329.657, 2698093.625	7466325.512, 2698096.596	272° 42' 23.52"	196° 02' 24.81"

NOTES

Fisheries and Oceans Pêches et Océans  
Canada  
Small Craft Harbours Ports pour Petits Bateaux  
Maritimes/Gulf Region Région des Maritimes/Gafo

NOTE: ALL ELEVATIONS ARE CHART DATUM

CONTROL	EASTING	NORTHING	CO ELEV	DESCRIPTION
8884	2697833.25	7466151.75	10.016 (GEODETIC)	URIS
			11.465 (CORRECTED CHART)	

TBM 2.725 (CHART) PWC CONTROL

DATE OF SURVEY: APRIL 27 2023

CONTOUR GEODETIC ELEVATIONS ARE CORRECTED BASED ON TBM ELEVATION PROVIDED BY CLIENT

HML: HIGHER HIGH WATER LEVEL LARGE TIDE 2.67m  
LML: LOWER LOW WATER LEVEL LARGE TIDE 0.35m

LEGEND

- PROPERTY LINE
- WORK AREA LIMITS
- STATIONS
- ALIGNMENT
- R-50 RIP-RAP
- R-5 RIP-RAP

NO.	DATE	REVISIONS	Prep By
O	23/09/26	ISSUED FOR TENDER	A.K.
B	23/07/07	ISSUED FOR APPROVAL	A.K.
A	23/05/31	PRELIMINARY	A.K.

Client: Client

FISHERIES AND OCEANS

Project: Project

CONSTRUCTION OF A CONTAINMENT CELL

MURRAY CORNER NB

ROY CONSULTANTS

543, av. King Ave  
Bathurst (NB) E2A 1P7  
T. / 508.546.4484  
F. / 508.548.2207

Drawing Title: Titre du Plan

SITE PLAN

Design by: Design par: Drawn by: Dessiné par:  
S.C. R.H.

Checked by: Vérifié par: Date: MAY 2023  
S.C.

Scale: Echelle: Sheet: Feuille:  
1:250 2 of/de 3

Drawing Number: Numero du Plan: Rev.  
036-23-1-C2 0

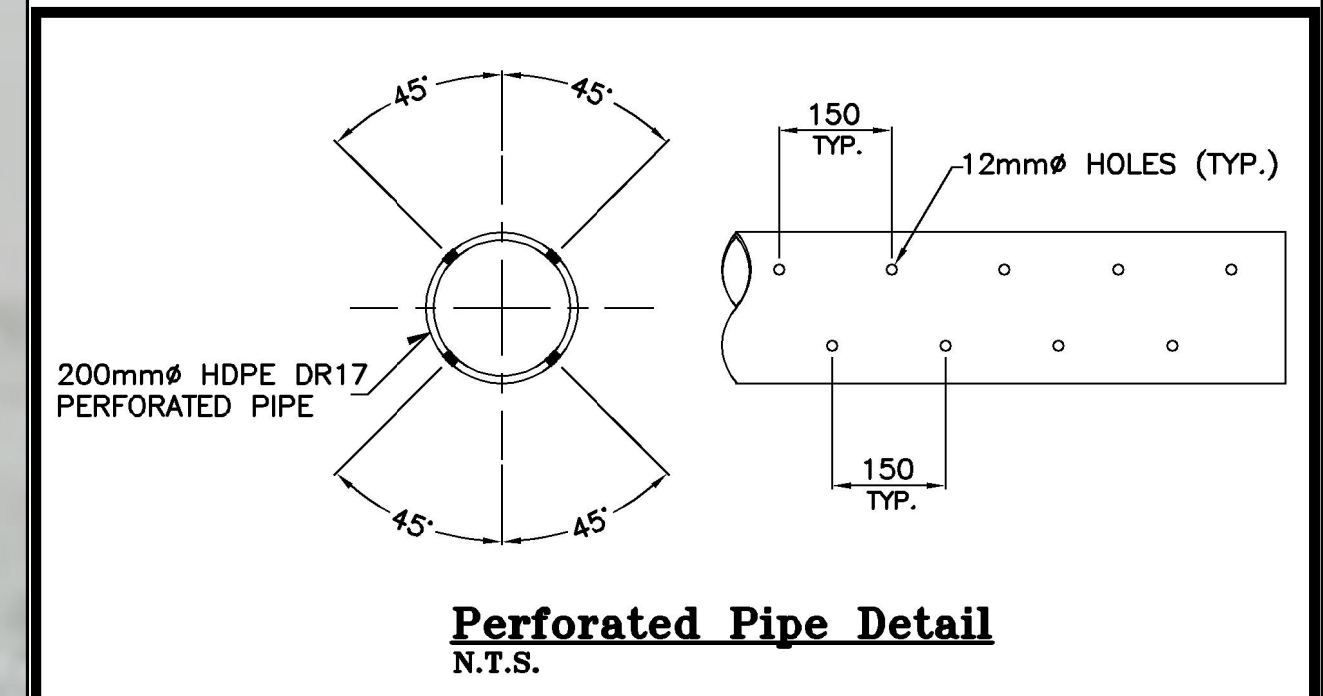
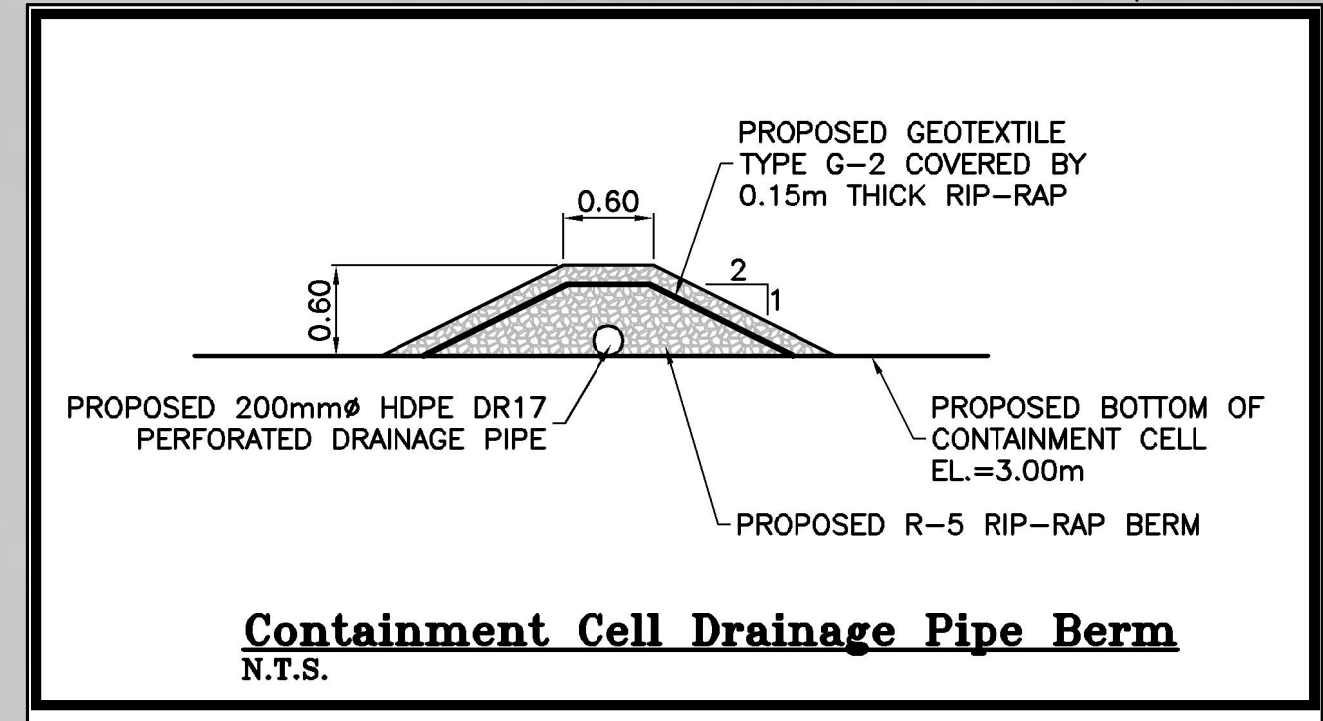
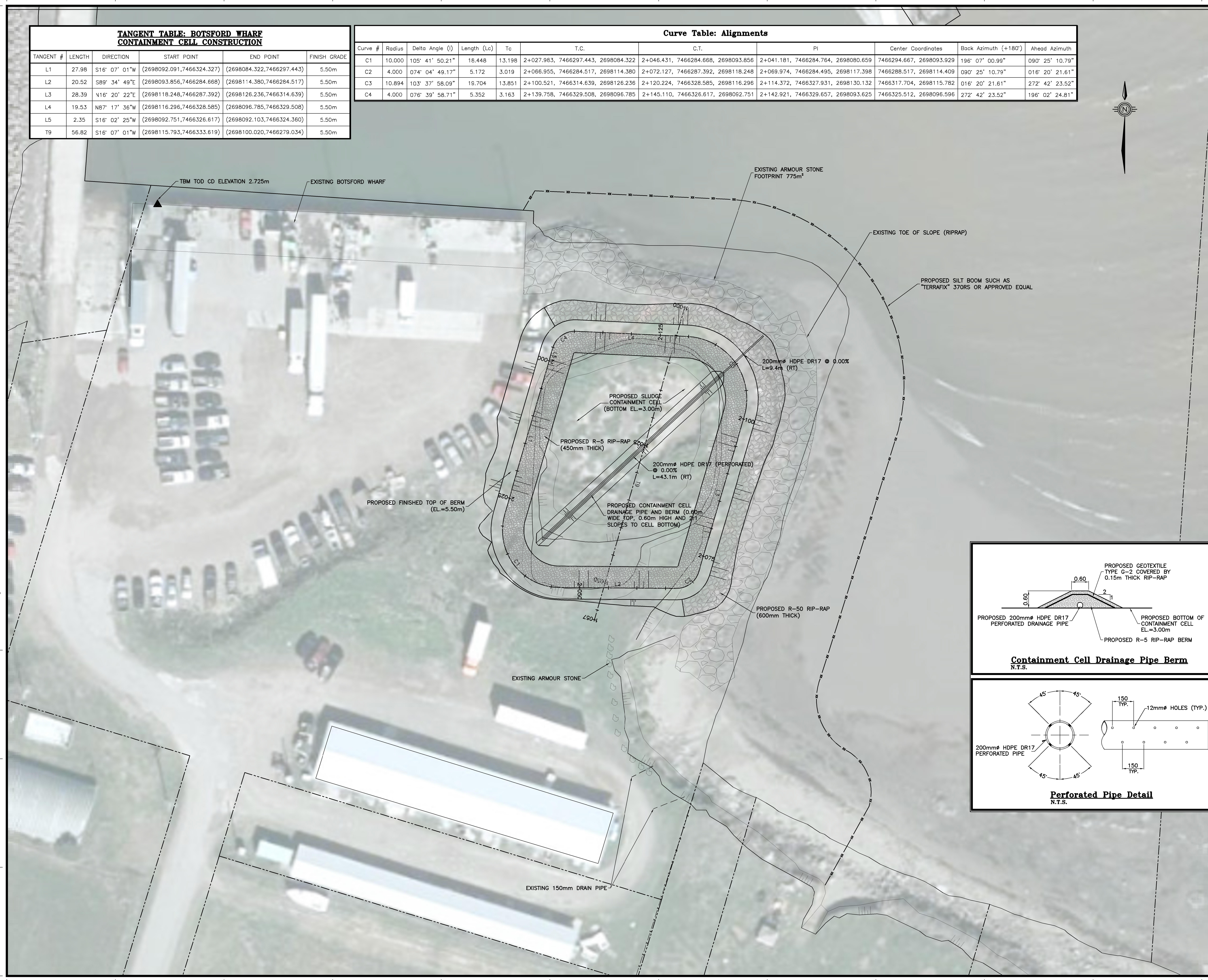

ON LE SITE APPROUVÉ, ENGAGEZ-VOUS À ÉVALUER L'ÉTAT ACTUEL DU PRÉSENT DOCUMENT, SANS OBLIGER NI GARANTIR QUE LE DONT. SANS AVOIR OBTENU AU PRÉALABLE L'APPROBATION ÉCRITE DE L'AUTORITÉ.