

Key Plan:

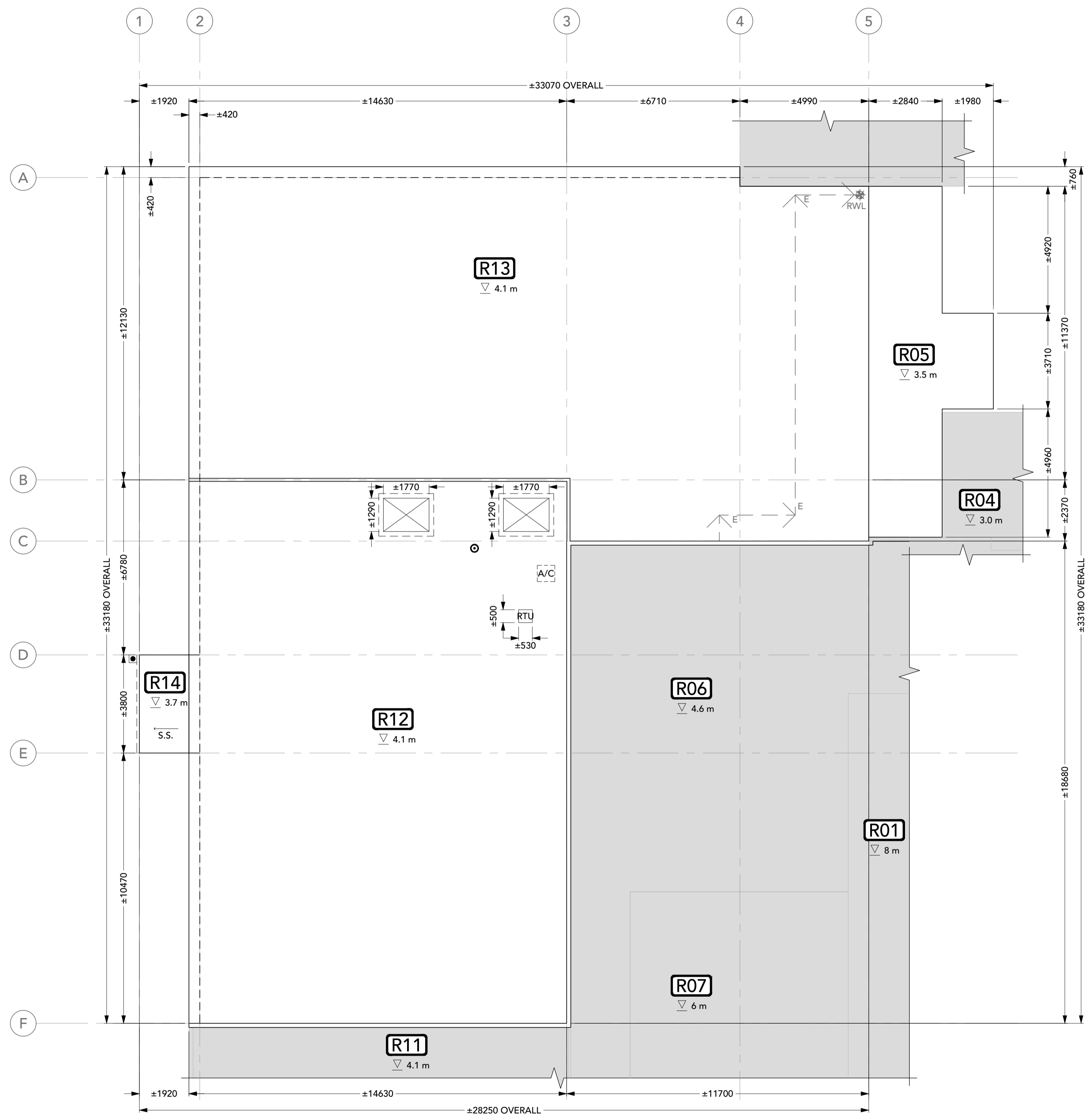

Notes:

1. CONTRACTOR IS RESPONSIBLE TO VERIFY ALL DIMENSIONS AND CONFIRM EXISTING CONDITIONS.
2. NOTIFY CONSULTANT IMMEDIATELY OF ANY DEVIATIONS FROM ASSUMED EXISTING CONDITIONS AS THEY ARE ENCOUNTERED ON SITE.
3. TEMPORARILY REMOVE AND SUPPORT ELECTRICAL BOXES AND CONDUIT RUNNING ALONG PARAPETS AND ON ROOF SURFACES. REINSTATE UPON COMPLETION AND RE-SECURE AS REQUIRED.
4. DRAWINGS ARE NOT TO BE SCALED.
5. THE PROJECT CONSTRUCTOR IS RESPONSIBLE FOR RETAINING/COORDINATING SUB-TRADES, AND SUPPLY AND INSTALLATION OF ALL EQUIPMENT AND MATERIALS AS REQUIRED TO COMPLETE THE WORK AS OUTLINED IN THE RE-ROOFING TENDER DOCUMENTS.



EXISTING ROOF PLAN
1:100

LEGEND	
SYMBOL	DESCRIPTION
\boxed{X} ▽ XX	ROOF NUMBER AND ELEVATION
\square	ROOF AREA NOT IN CONTRACT
\square with X	EXISTING LOUVERED PENTHOUSE TO BE REMOVED AND RETAINED FOR REINSTALLATION
A/C	EXISTING AIR CONDITIONING CONDENSER TO BE REMOVED AND RETAINED FOR REINSTALLATION
RTU	EXISTING ROOF TOP UNIT TO BE REMOVED AND RETAINED FOR REINSTALLATION
⊙	EXISTING PLUMBING VENT TO REMAIN
== \square ==	EXISTING EAVESTROUGH AND DOWNSPOUTS TO BE REMOVED AND DISPOSED OF
- E ->	APPROXIMATE LOCATION OF EXISTING RAIN WATER LEADER LOCATED ON THE INTERIOR TO REMAIN - PROVIDED FOR REFERENCE
* RWL	APPROXIMATE LOCATION OF EXISTING RAIN WATER LEADER RISER LOCATED ON THE INTERIOR TO REMAIN - PROVIDED FOR REFERENCE



Correctional Service Canada / Service correctionnel Canada



105-1020 Bayridge Drive, Kingston, Ontario, K7P 2S2
T: 613-767-8930 | F: 613-831-3812 | www.fsaeng.com

REV #	DATE	DESCRIPTION
3	2023-12-08	ISSUED FOR TENDER
2	2023-11-03	PRETENDER APPROVAL
1	2023-09-07	FOR 99% REVIEW

Client: CORRECTIONAL SERVICES CANADA

Project: JOYCEVILLE INSTITUTION ROOF AND STRUCTURAL WORK

Project #: FSA Project #: 23172DK

EXISTING ROOF PLAN

Address of Project: 3766 Highway 15 Kingston, ON K7L 4X9	Scale: 1:100 Drw.: RRC Dgn.: DJA Chk.: DJA	Page Number: 1
---	---	--------------------------

Date: 2023-08-14 | 23172DK-1.dwg

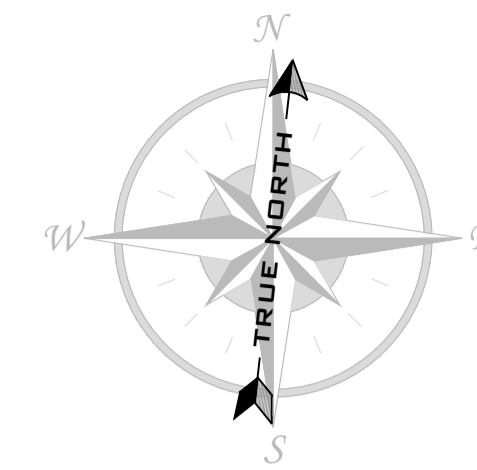

Key Plan:

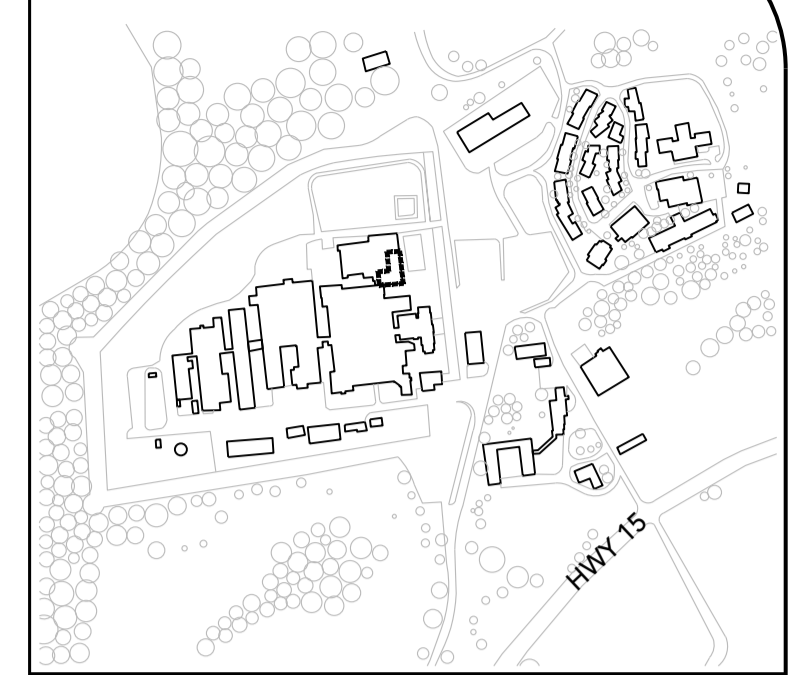

Notes:

1. CONTRACTOR IS RESPONSIBLE TO VERIFY ALL DIMENSIONS AND CONFIRM EXISTING CONDITIONS.
2. NOTIFY CONSULTANT IMMEDIATELY OF ANY DEVIATIONS FROM ASSUMED EXISTING CONDITIONS AS THEY ARE ENCOUNTERED ON SITE.
3. TEMPORARILY REMOVE AND SUPPORT ELECTRICAL BOXES AND CONDUIT RUNNING ALONG PARAPETS AND ON ROOF SURFACES. REINSTATE UPON COMPLETION AND RE-SECURE AS REQUIRED.
4. DRAWINGS ARE NOT TO BE SCALED.
5. THE PROJECT CONSTRUCTOR IS RESPONSIBLE FOR RETAINING/COORDINATING SUB-TRADES, AND SUPPLY AND INSTALLATION OF ALL EQUIPMENT AND MATERIALS AS REQUIRED TO COMPLETE THE WORK AS OUTLINED IN THE RE-ROOFING TENDER DOCUMENTS.

LEGEND	
SYMBOL	DESCRIPTION
	AREA NOT IN CONTRACT
	ROOF OVERHANG TO BE REMOVED
	EXISTING OPEN WEB STEEL JOIST TO REMAIN
	HATCHED AREA DENOTES LOCATIONS OF CORRUGATED METAL DECK REPAIRS

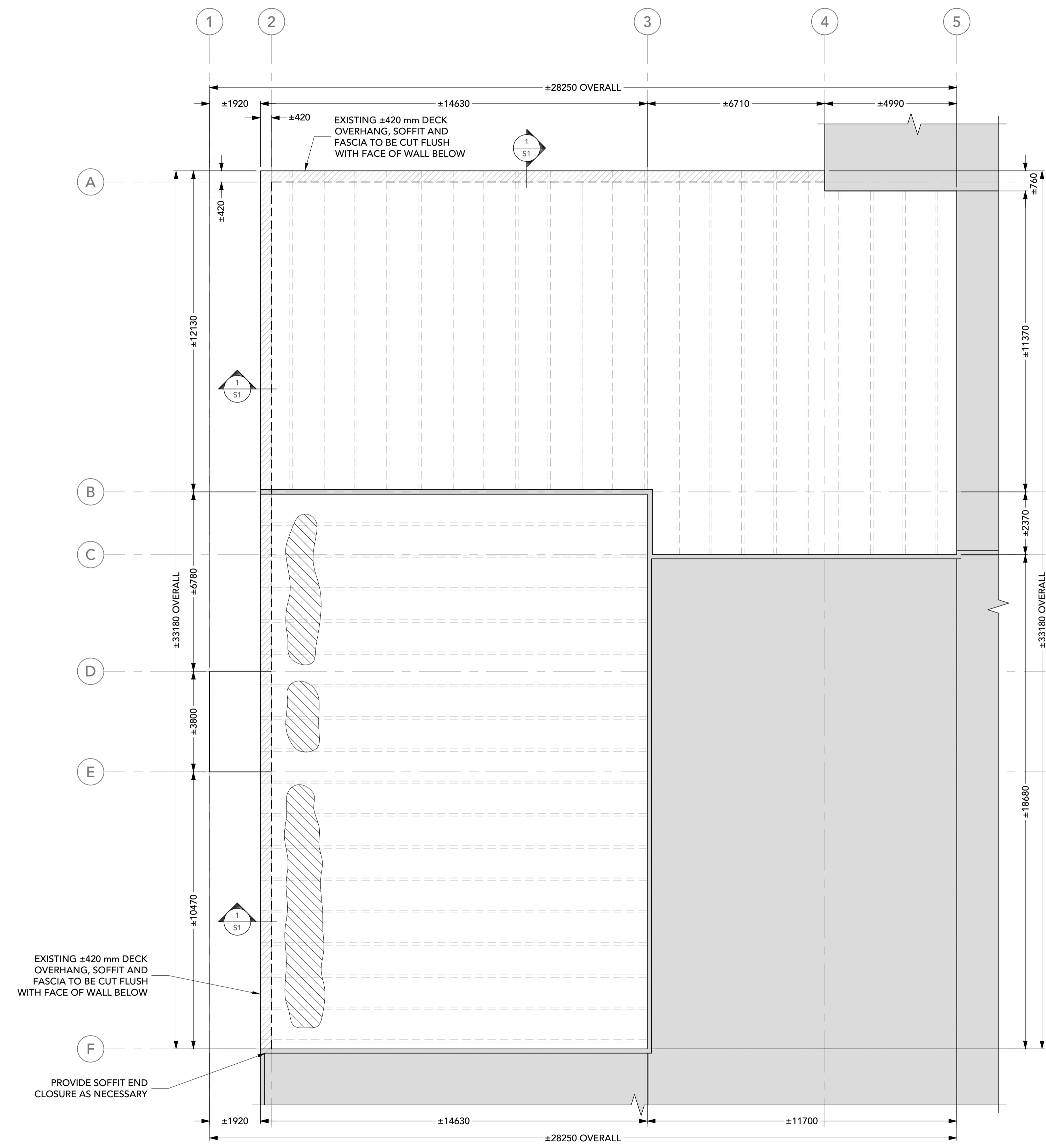

EXISTING STRUCTURAL PLAN
1:100

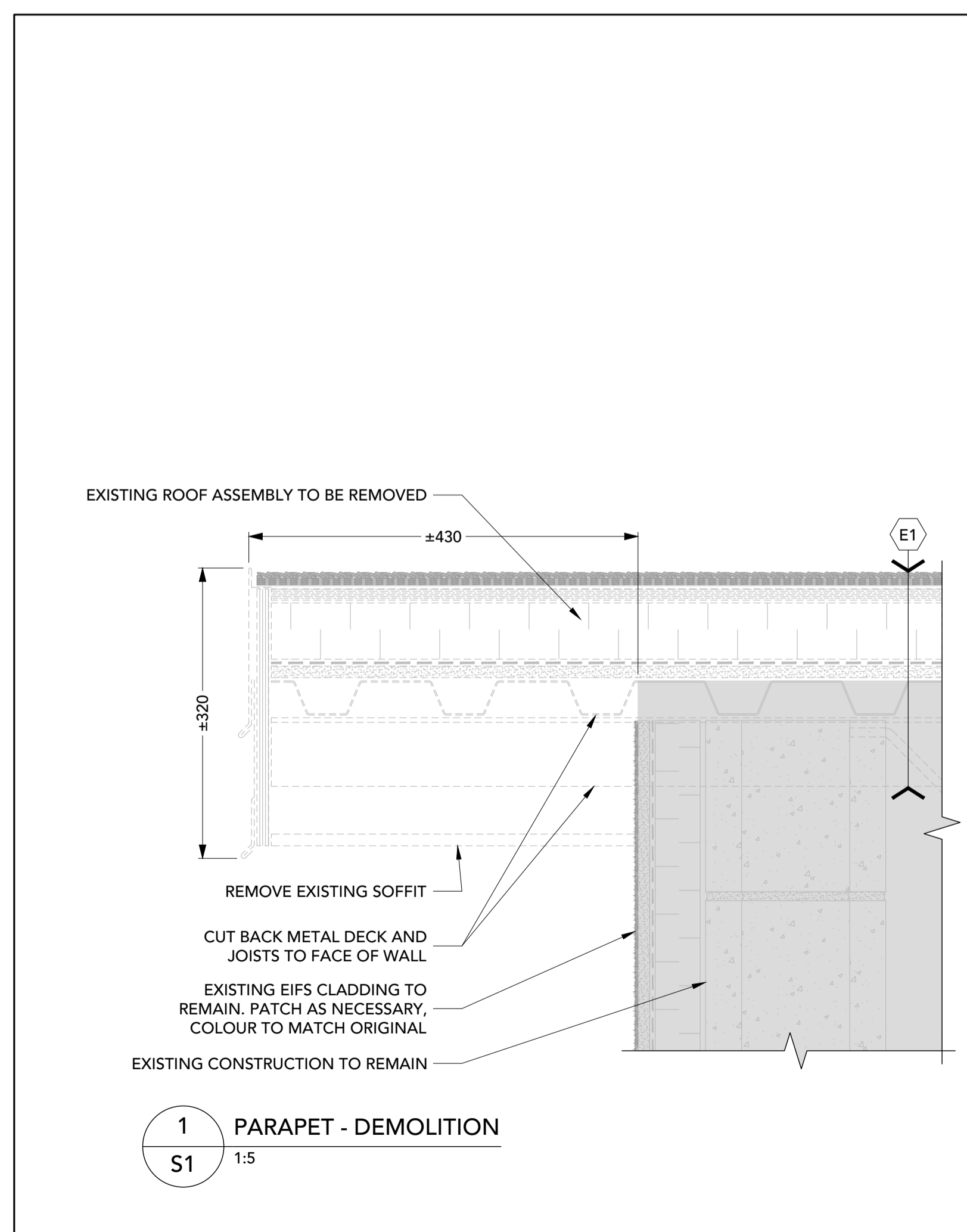

1 PARAPET - DEMOLITION
S1 1:5



Correctional Service Canada / Service correctionnel Canada



105-1020 Bayridge Drive, Kingston, Ontario, K7P 2S2
T: 613-767-8930 | F: 613-831-3812 | www.fsaeng.com

REV #	DATE	DESCRIPTION
3	2023-12-08	ISSUED FOR TENDER
2	2023-11-03	PRETENDER APPROVAL
1	2023-09-07	FOR 99% REVIEW

Client: CORRECTIONAL SERVICES CANADA

Project: JOYCEVILLE INSTITUTION ROOF AND STRUCTURAL WORK

Project #: FSA Project #: 23172DK

EXISTING STRUCTURAL PLAN

Address of Project: 3766 Highway 15 Kingston, ON K7L 4X9	Scale: 1:100 Dgn.: RRC Dgn.: DJA Chk.: DJA	Page Number: S1
---	---	---------------------------

Date: 2023-08-14 | 23172DK-1.dwg

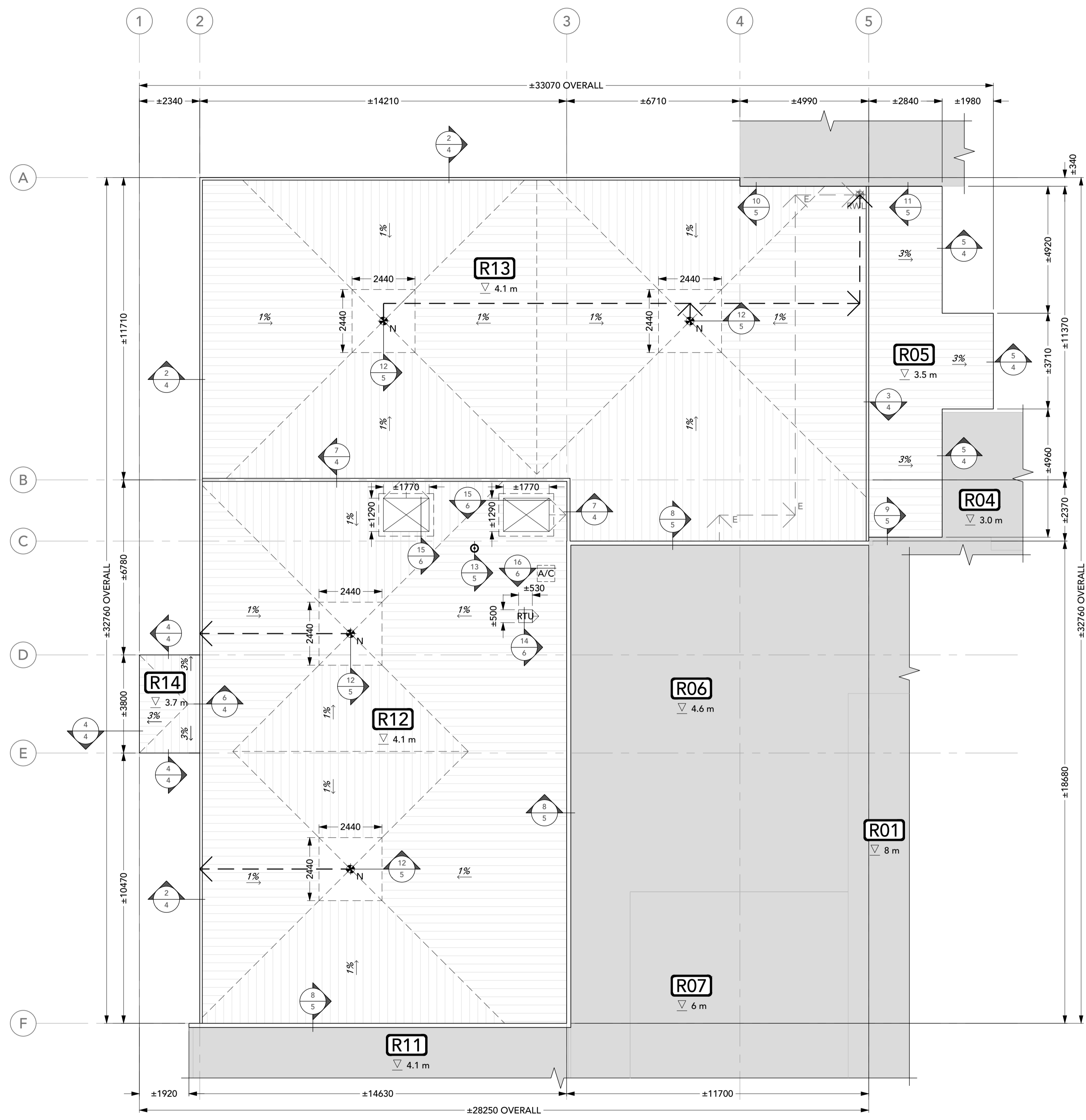

ROOF PLAN
1:100

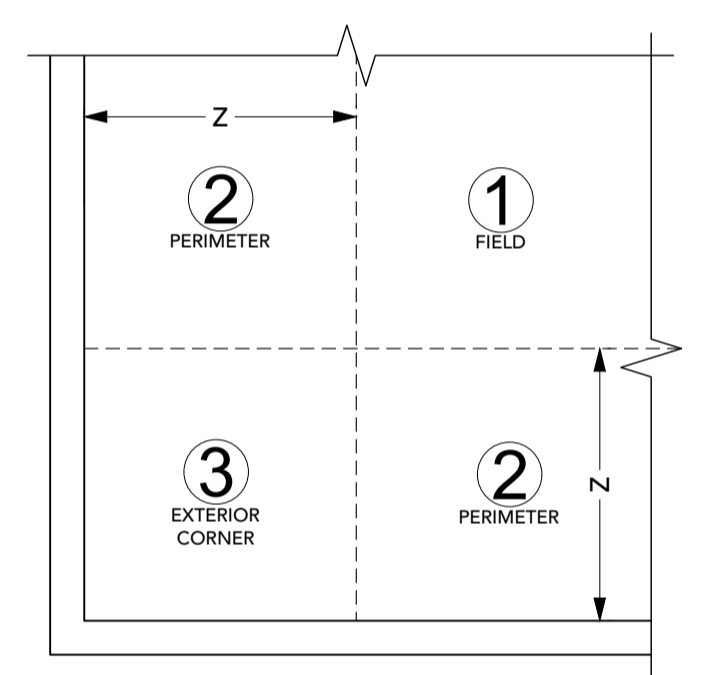
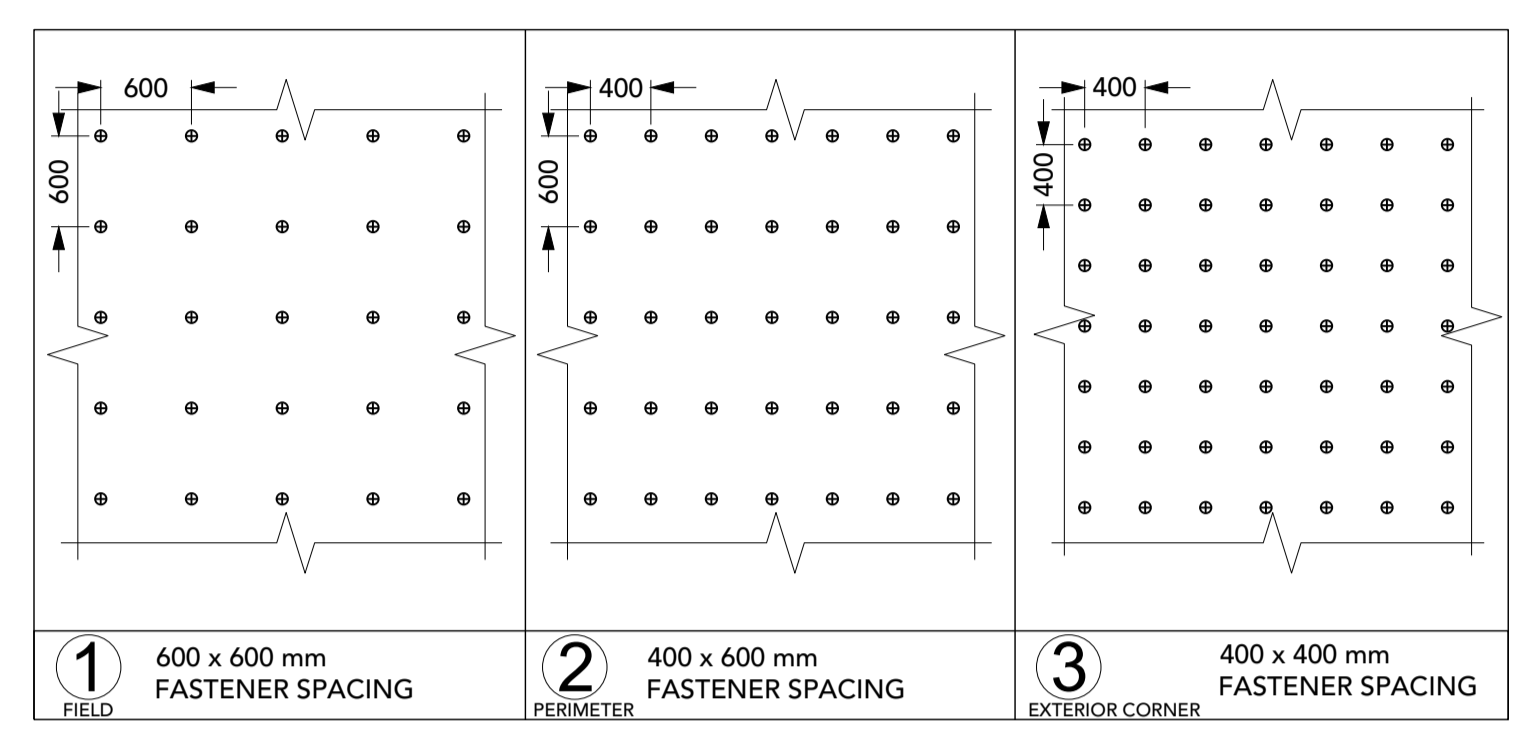

WIND LOAD FACTORS	ROOF AREA			
	R05	R12	R13	R14
L	13.6 m	21.0 m	25.9 m	3.8 m
W	4.8 m	14.2 m	14.1 m	2.3 m
h	3.5 m	4.1 m	4.1 m	3.7 m
z	1.0 m	1.4 m	1.4 m	1.0 m
C _e	0.9	0.9	0.9	0.9
C _p C _g (P1)	-1.76	-1.76	-1.76	-1.76
C _p C _g (P2)	-2.5	-2.5	-2.5	-2.5
C _p C _g (P3)	-5.12	-5.12	-5.12	-5.12
C _e C _g	-0.9	-0.9	-0.9	-0.9
I _w	1.15	1.15	1.15	1.15
q	0.47 kPa	0.47 kPa	0.47 kPa	0.47 kPa
P ₁	-1.81 kPa	-1.81 kPa	-1.81 kPa	-1.81 kPa
P ₂	-2.32 kPa	-2.32 kPa	-2.32 kPa	-2.32 kPa
P ₃	-4.10 kPa	-4.10 kPa	-4.10 kPa	-4.10 kPa

LEGEND	
SYMBOL	DESCRIPTION
X ▽ XX	ROOF NUMBER AND ELEVATION
■	ROOF AREA NOT IN CONTRACT
⊠	EXISTING LOUVERED PENTHOUSE TO BE REINSTALLED ON PREMANUFACTURED CURB WITH INSULATED CRICKET
A/C	EXISTING AIR CONDENSER TO BE REINSTALLED ON CONCRETE PAVER
RTU	EXISTING AIR CONDITIONER CONDENSER TO BE REINSTALLED ON WOOD SLEEPERS
⊙	EXISTING PLUMBING VENT TO REMAIN
N	ROOF DRAIN TO BE INSTALLED IN NEW LOCATION WITH 2440 x 2440 mm SUMP
1%	EXTENT AND DIRECTION OF TAPERED INSULATION
---	RAINWATER LEADER TO BE INSTALLED IN THE CONFIGURATION INDICATED
E	APPROXIMATE LOCATION OF EXISTING RAIN WATER LEADER LOCATED ON THE INTERIOR TO REMAIN - PROVIDED FOR REFERENCE
RWL	APPROXIMATE LOCATION OF EXISTING RAIN WATER LEADER RISER LOCATED ON THE INTERIOR TO REMAIN - PROVIDED FOR REFERENCE

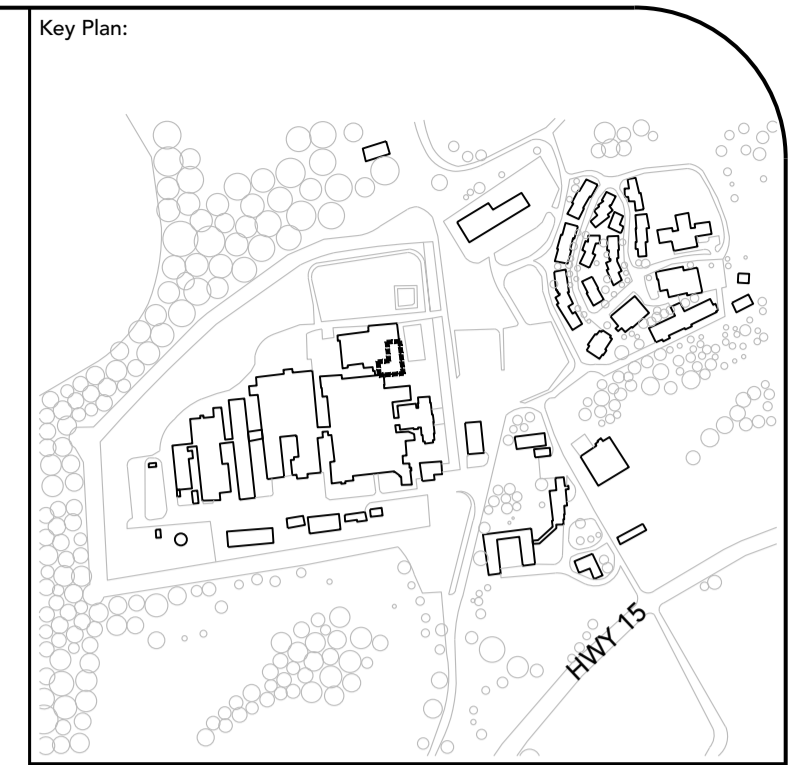

- Notes:
- CONTRACTOR IS RESPONSIBLE TO VERIFY ALL DIMENSIONS AND CONFIRM EXISTING CONDITIONS.
 - NOTIFY CONSULTANT IMMEDIATELY OF ANY DEVIATIONS FROM ASSUMED EXISTING CONDITIONS AS THEY ARE ENCOUNTERED ON SITE.
 - TEMPORARILY REMOVE AND SUPPORT ELECTRICAL BOXES AND CONDUIT RUNNING ALONG PARAPETS AND ON ROOF SURFACES. REINSTATE UPON COMPLETION AND RE-SECURE AS REQUIRED.
 - DRAWINGS ARE NOT TO BE SCALED.
 - THE PROJECT CONSTRUCTOR IS RESPONSIBLE FOR RETAINING/COORDINATING SUB-TRADES, AND SUPPLY AND INSTALLATION OF ALL EQUIPMENT AND MATERIALS AS REQUIRED TO COMPLETE THE WORK AS OUTLINED IN THE RE-ROOFING TENDER DOCUMENTS.



Correctional Service Canada / Service correctionnel Canada



105-1020 Bayridge Drive, Kingston, Ontario, K7P 2S2
T: 613-767-8930 | F: 613-831-3812 | www.fsaeng.com

REV #	DATE	DESCRIPTION
3	2023-12-08	ISSUED FOR TENDER
2	2023-11-03	PRETENDER APPROVAL
1	2023-09-07	FOR 99% REVIEW

Client: CORRECTIONAL SERVICES CANADA

Project: JOYCEVILLE INSTITUTION ROOF AND STRUCTURAL WORK

Project #: FSA Project #: 23172DK

ROOF PLAN

Address of Project: 3766 Highway 15, Kingston, ON K7L 4X9
Scale: 1:100
Page Number: 2
Date: 2023-08-14 | 23172DK-1.dwg

Key Plan:

Notes:

1. CONTRACTOR IS RESPONSIBLE TO VERIFY ALL DIMENSIONS AND CONFIRM EXISTING CONDITIONS.
2. NOTIFY CONSULTANT IMMEDIATELY OF ANY DEVIATIONS FROM ASSUMED EXISTING CONDITIONS AS THEY ARE ENCOUNTERED ON SITE.
3. TEMPORARILY REMOVE AND SUPPORT ELECTRICAL BOXES AND CONDUIT RUNNING ALONG PARAPETS AND ON ROOF SURFACES. REINSTATE UPON COMPLETION AND RE-SECURE AS REQUIRED.
4. DRAWINGS ARE NOT TO BE SCALED.
5. THE PROJECT CONSTRUCTOR IS RESPONSIBLE FOR RETAINING/COORDINATING SUB-TRADES, AND SUPPLY AND INSTALLATION OF ALL EQUIPMENT AND MATERIALS AS REQUIRED TO COMPLETE THE WORK AS OUTLINED IN THE RE-ROOFING TENDER DOCUMENTS.

- EXISTING ROOF ASSEMBLY E1:
- EXISTING 4-PLY BUR MEMBRANE WITH GRAVEL TO BE REMOVED
 - EXISTING 13 mm FIBREBOARD TO BE REMOVED
 - EXISTING 63 mm RIGID INSULATION TO BE REMOVED
 - EXISTING VAPOUR BARRIER TO BE REMOVED
 - EXISTING GYPSUM UNDERLAYMENT TO BE REMOVED
 - EXISTING METAL DECK TO REMAIN

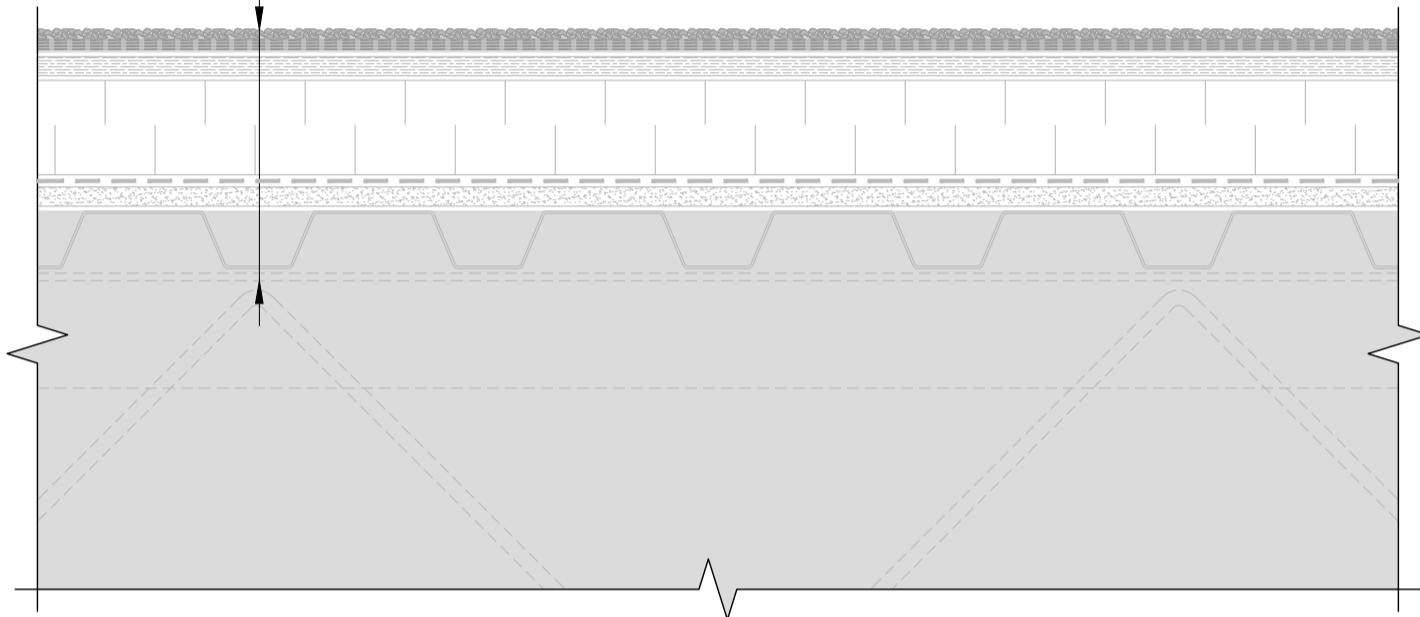

E1 EXISTING ROOF ASSEMBLY E1
3 1:5 ROOF AREA R12

- EXISTING ROOF ASSEMBLY E2:
- EXISTING 4-PLY BUR MEMBRANE WITH GRAVEL TO BE REMOVED
 - EXISTING 13 mm FIBREBOARD TO BE REMOVED
 - EXISTING 50 mm RIGID INSULATION TO BE REMOVED
 - EXISTING KRAFT MEMBRANE TO BE REMOVED
 - EXISTING METAL DECK TO REMAIN

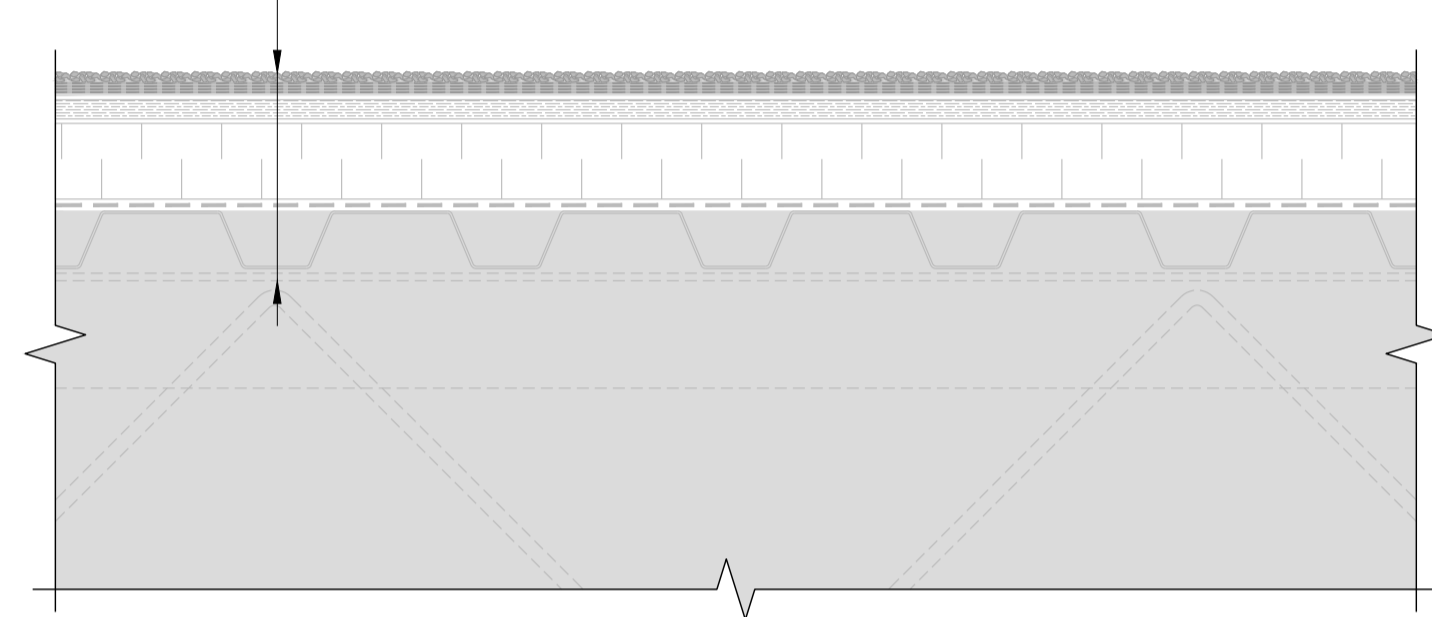

E2 EXISTING ROOF ASSEMBLY E2
3 1:5 ROOF AREA R13

- EXISTING ROOF ASSEMBLY E3:
- EXISTING 4-PLY BUR MEMBRANE WITH GRAVEL TO BE REMOVED
 - EXISTING DECK TO REMAIN



E3 EXISTING ROOF ASSEMBLY E3
3 1:5 ROOF AREA R14

- EXISTING ROOF ASSEMBLY E4:
- EXISTING 4-PLY BUR MEMBRANE WITH GRAVEL TO BE REMOVED
 - EXISTING TAPERED FIBREBOARD TO BE REMOVED
 - EXISTING 75 mm RIGID INSULATION TO BE REMOVED
 - EXISTING VAPOUR BARRIER TO BE REMOVED
 - EXISTING WOOD DECK TO REMAIN

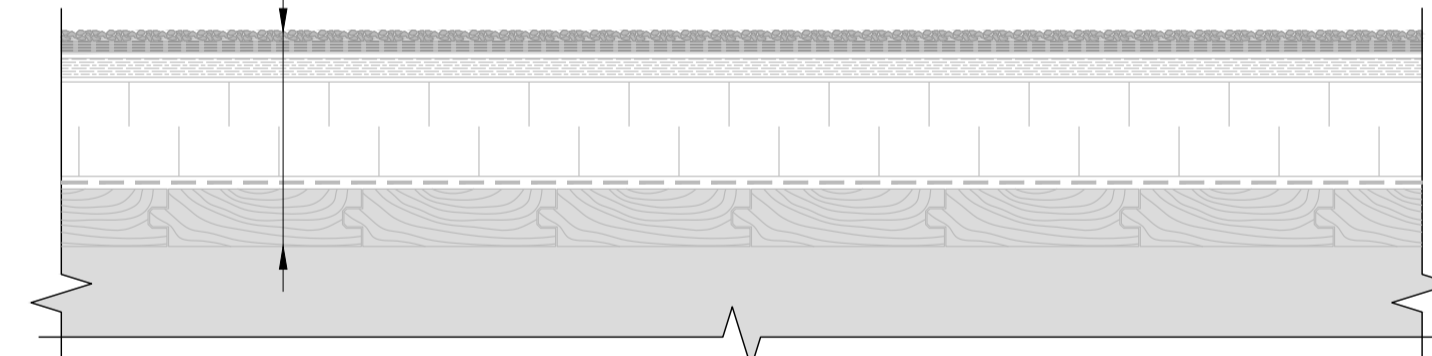

E4 EXISTING ROOF ASSEMBLY E4
3 1:5 ROOF AREA R05

- TYPICAL ROOF ASSEMBLY R1:
- 2-PLY MOD. BIT. MEMBRANE
 - 6 mm OVERLAY BOARD
 - TAPERED POLYISO INSULATION
 - 50 mm POLYISO INSULATION
 - 50 mm POLYISO INSULATION
 - 1-PLY MOD. BIT. AIR/VAPOUR BARRIER MEMBRANE
 - 13 mm GYPSUM BOARD
 - EXISTING STEEL DECK TO REMAIN

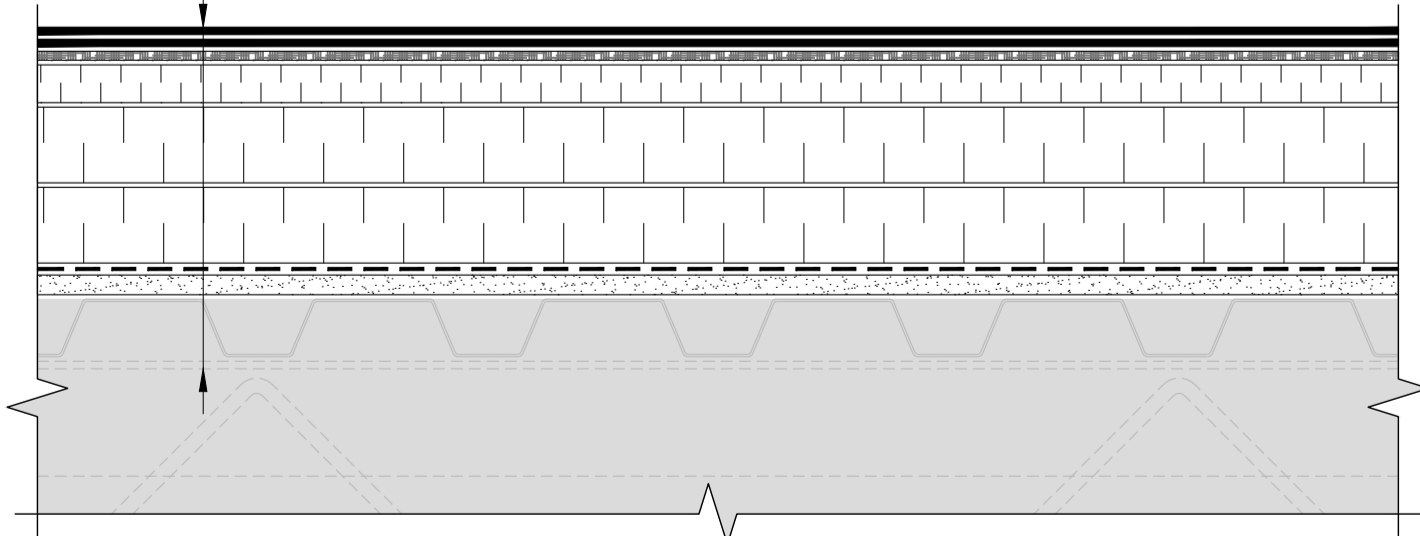

R1 TYPICAL ROOF ASSEMBLY R1
3 1:5 ROOF AREAS R12 & R13

- TYPICAL ROOF ASSEMBLY R2:
- 2-PLY MOD. BIT. MEMBRANE
 - 6 mm OVERLAY BOARD
 - TAPERED POLYISO INSULATION
 - 1-PLY MOD. BIT. AIR/VAPOUR BARRIER MEMBRANE
 - 13 mm GYPSUM BOARD
 - EXISTING DECK TO REMAIN

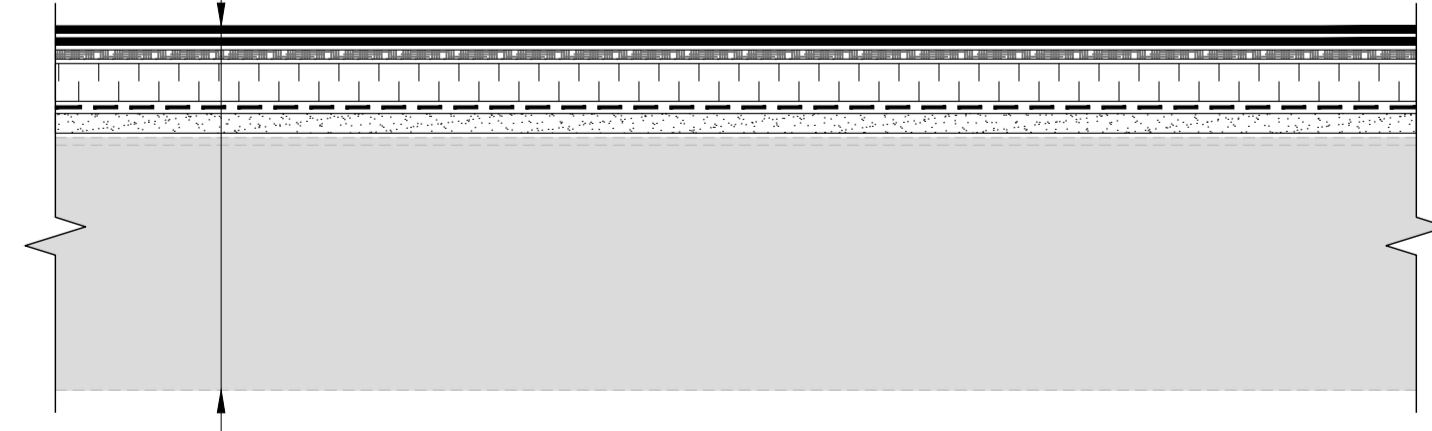

R2 TYPICAL ROOF ASSEMBLY R2
3 1:5 ROOF AREA R14

- TYPICAL ROOF ASSEMBLY R3:
- 2-PLY MOD. BIT. MEMBRANE
 - 6 mm OVERLAY BOARD
 - TAPERED POLYISO INSULATION
 - 50 mm POLYISO INSULATION
 - 50 mm POLYISO INSULATION
 - 1-PLY MOD. BIT. AIR/VAPOUR BARRIER MEMBRANE
 - EXISTING WOOD DECK TO REMAIN

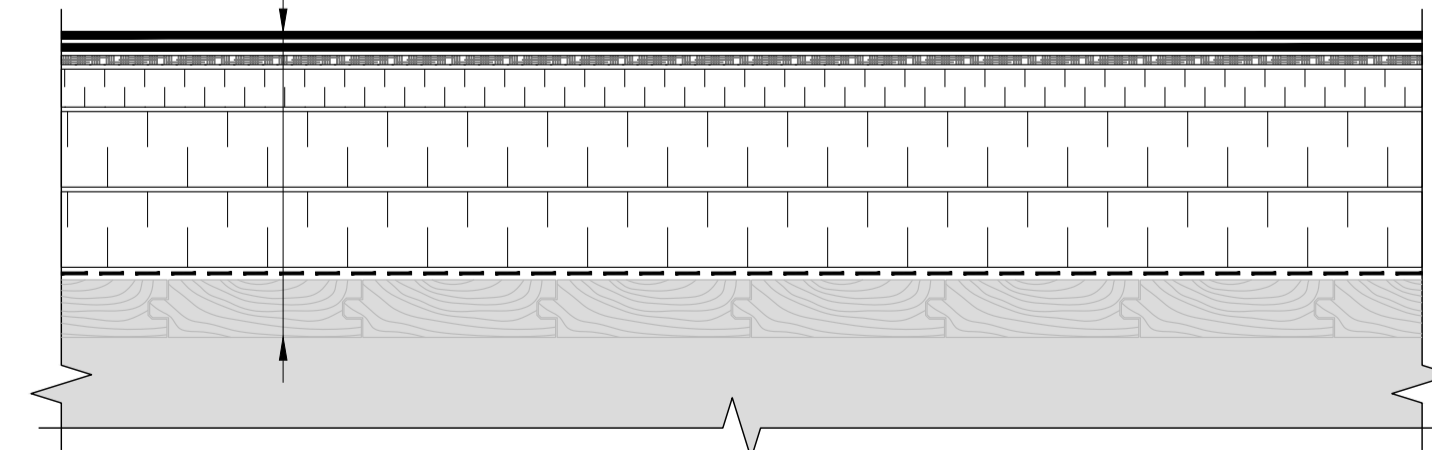

R3 TYPICAL ROOF ASSEMBLY R3
3 1:5 ROOF AREA R05



Correctional Service Canada / Service correctionnel Canada



105-1020 Bayridge Drive, Kingston, Ontario, K7P 2S2
T: 613-767-8930 | F: 613-831-3812 | www.fsaeng.com

REV #	DATE	DESCRIPTION
3	2023-12-08	ISSUED FOR TENDER
2	2023-11-03	PRETENDER APPROVAL
1	2023-09-07	FOR 99% REVIEW

Client: CORRECTIONAL SERVICES CANADA

Project: JOYCEVILLE INSTITUTION ROOF AND STRUCTURAL WORK

Project #: FSA Project #: 23172DK

Title: ROOF ASSEMBLIES

Address of Project: 3766 Highway 15 Kingston, ON K7L 4X9	Scale: 1:5 Drawn: RRC Designed: DJA Checked: DJA	Page Number: 3
---	---	--------------------------

Date: 2023-08-14 | 23172DK-1.dwg

0 50 100 150 200 250 300 mm

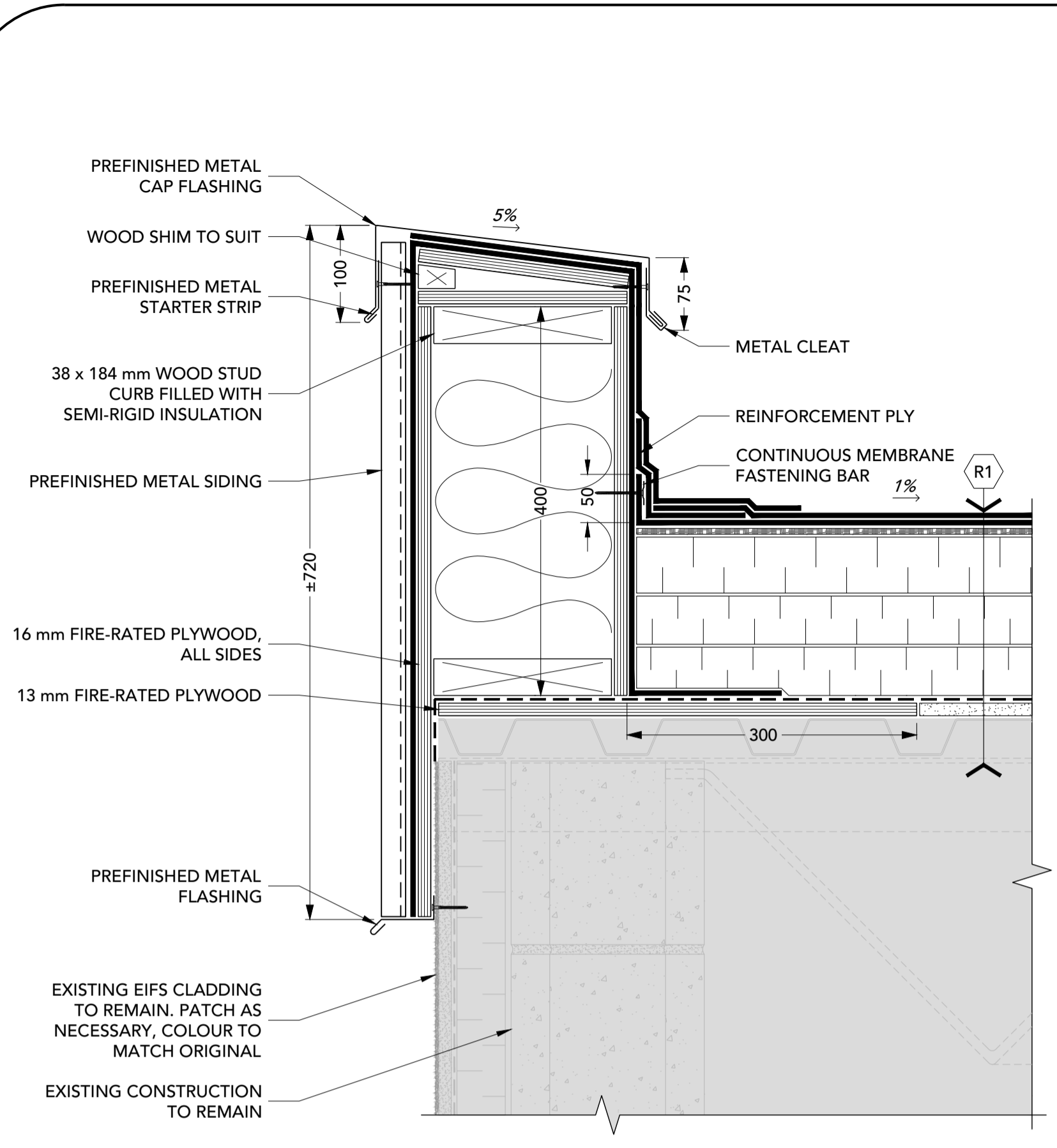

2 PARAPET
4 1:5

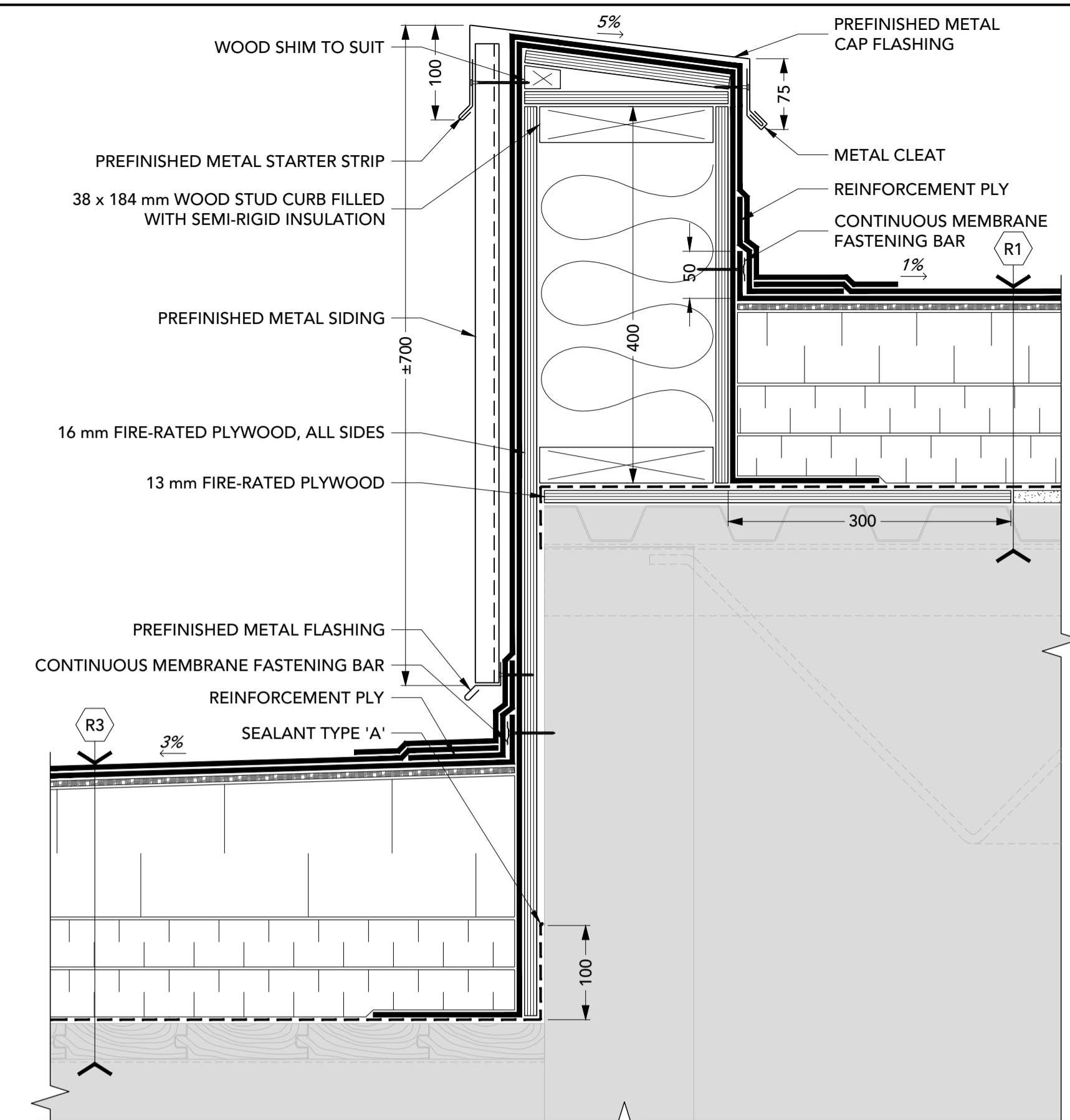

3 PARAPET
4 1:5

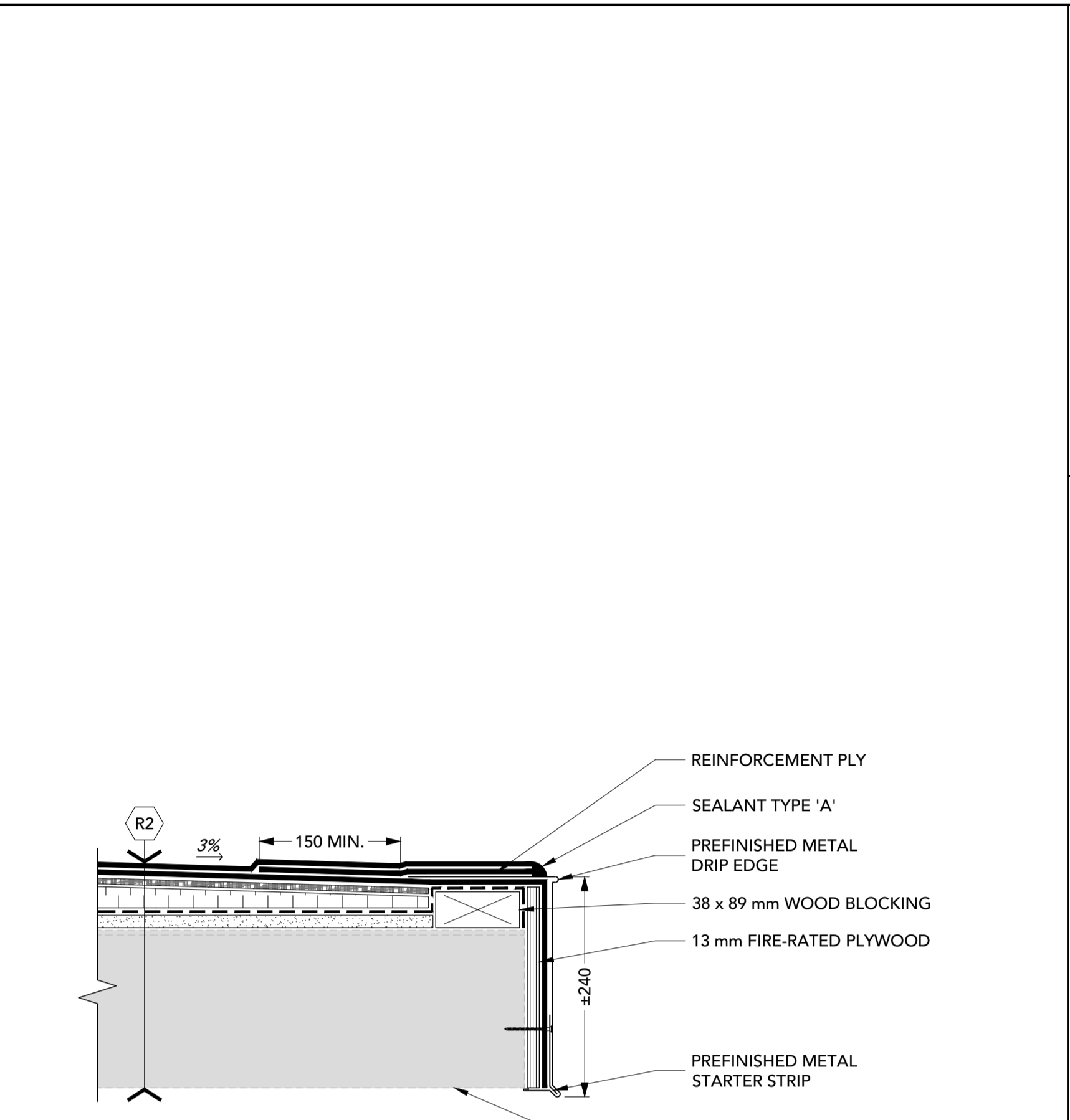

4 DRIP EDGE
4 1:5

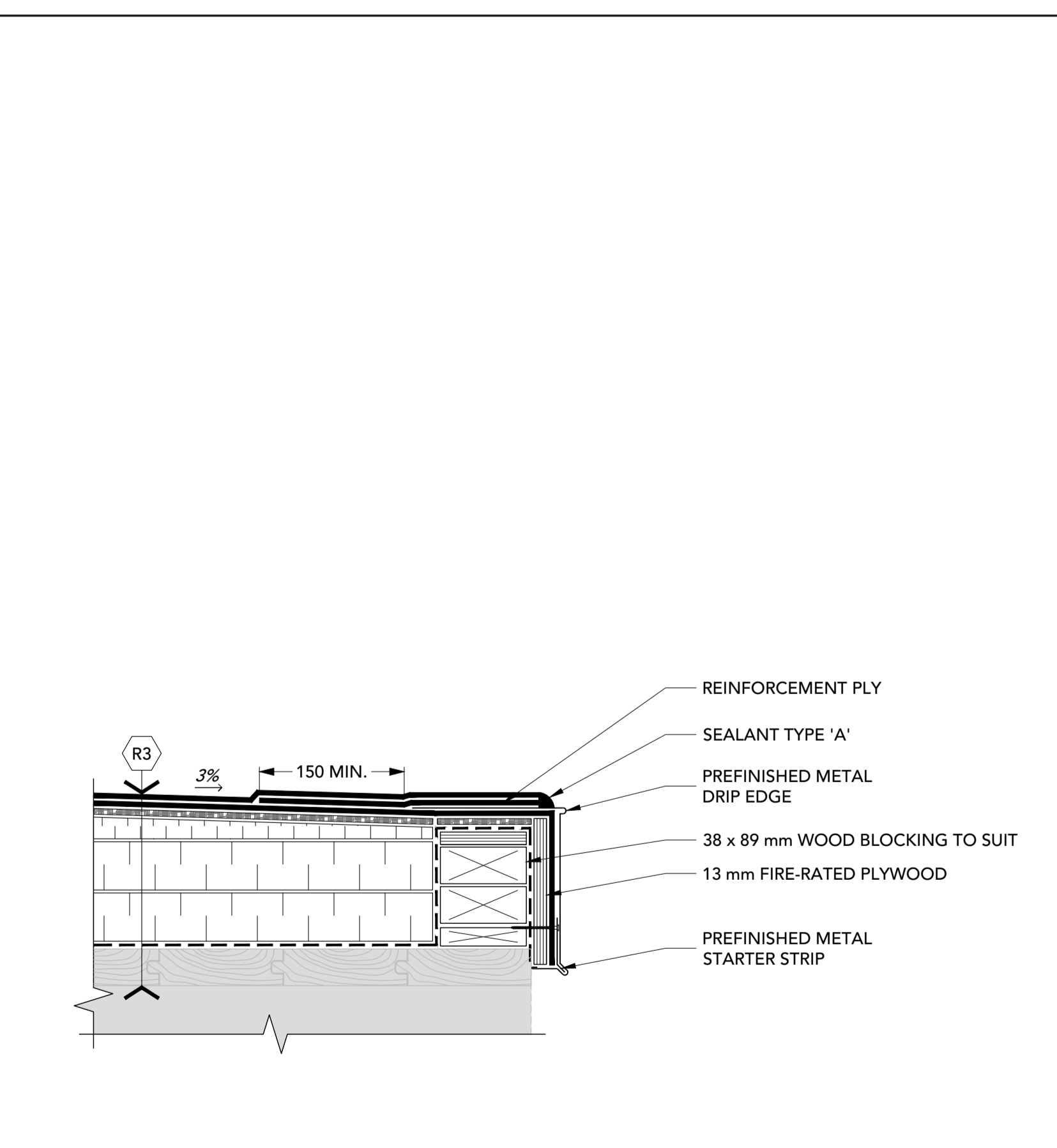

5 DRIP EDGE
4 1:5

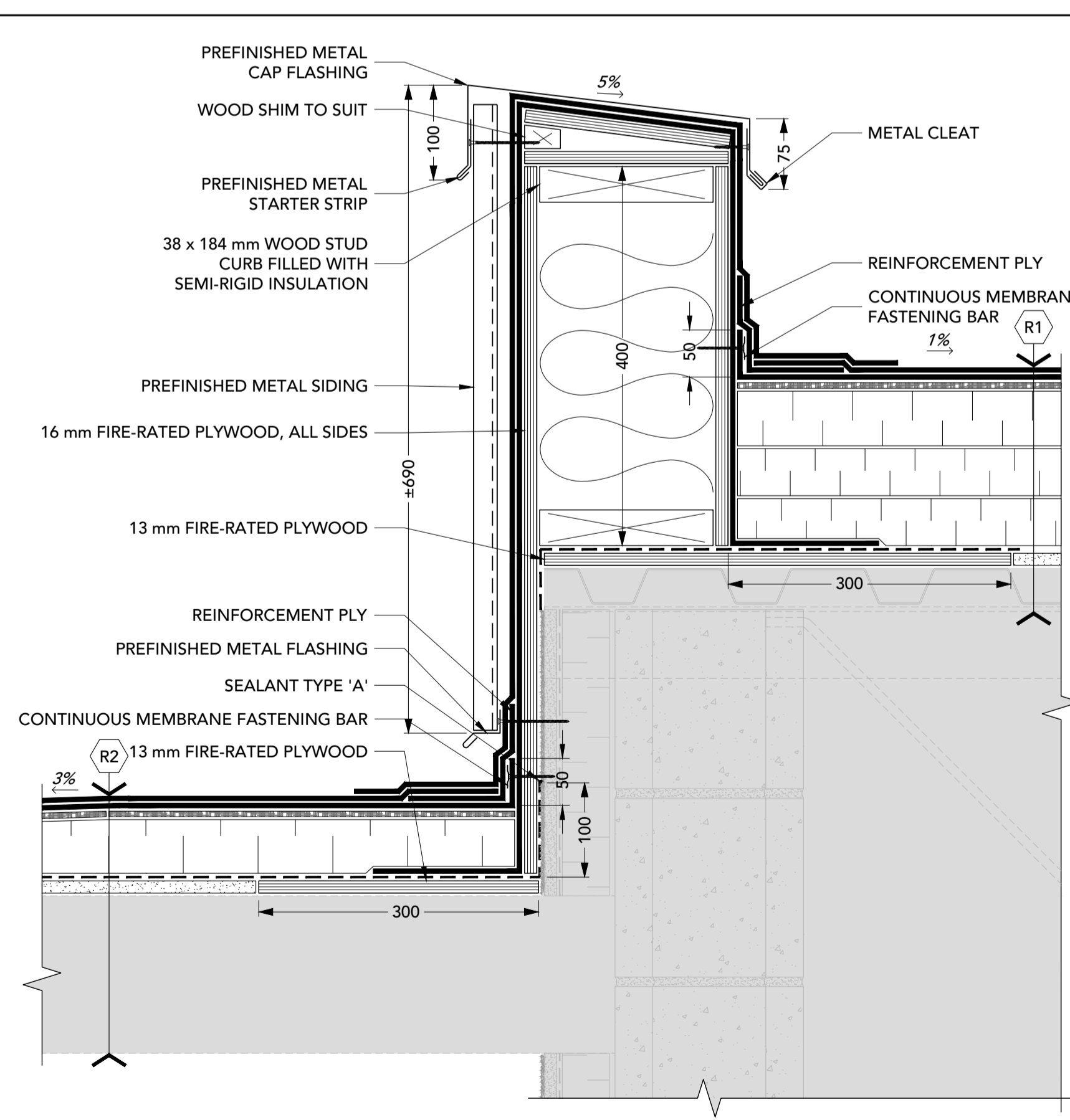

6 ROOF TRANSITION
4 1:5

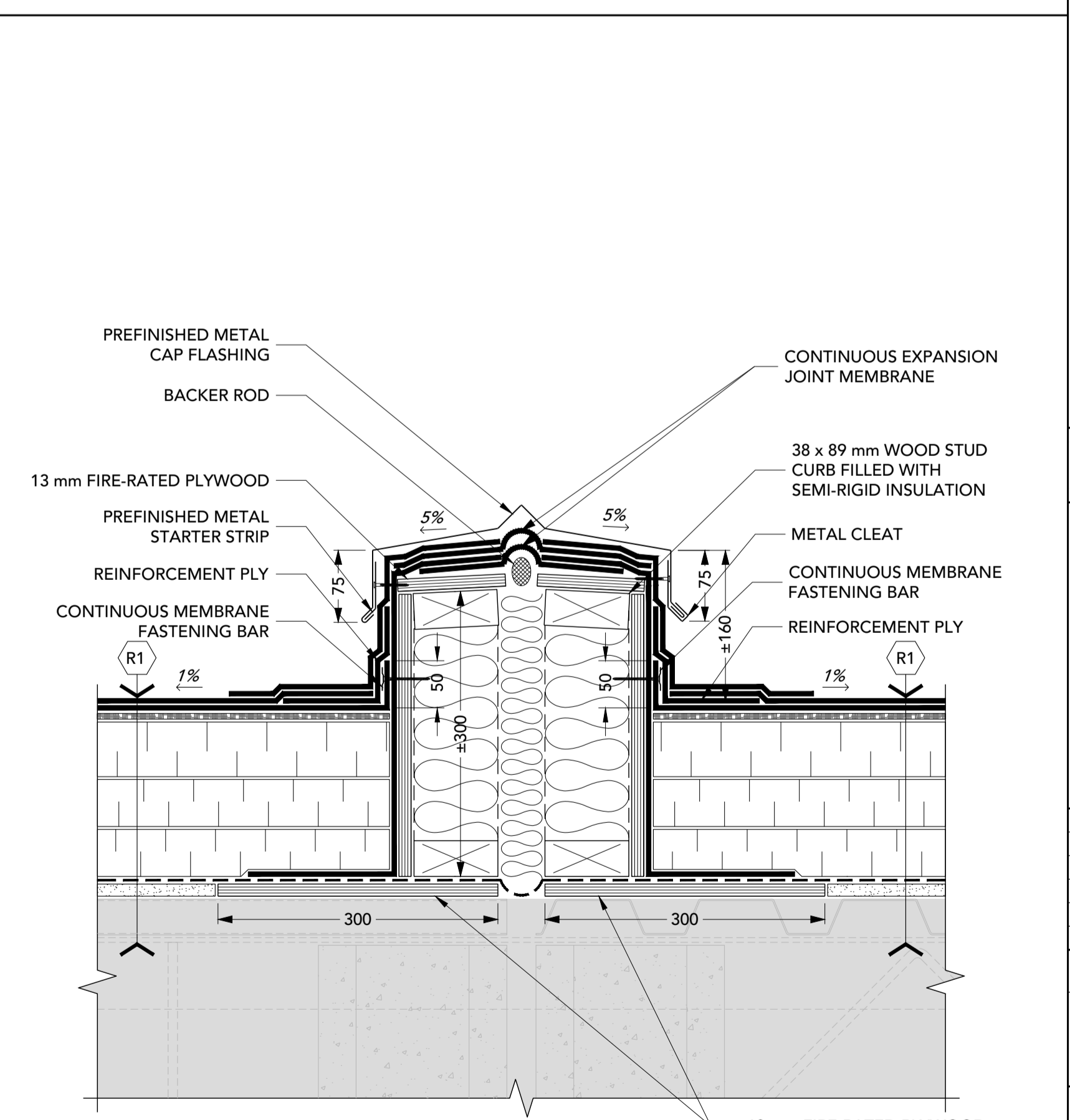

7 EXPANSION JOINT
4 1:5

Key Plan:

- Notes:
1. CONTRACTOR IS RESPONSIBLE TO VERIFY ALL DIMENSIONS AND CONFIRM EXISTING CONDITIONS.
 2. NOTIFY CONSULTANT IMMEDIATELY OF ANY DEVIATIONS FROM ASSUMED EXISTING CONDITIONS AS THEY ARE ENCOUNTERED ON SITE.
 3. TEMPORARILY REMOVE AND SUPPORT ELECTRICAL BOXES AND CONDUIT RUNNING ALONG PARAPETS AND ON ROOF SURFACES. REINSTATE UPON COMPLETION AND RE-SECURE AS REQUIRED.
 4. DRAWINGS ARE NOT TO BE SCALED.
 5. THE PROJECT CONSTRUCTOR IS RESPONSIBLE FOR SUPPLY AND INSTALLATION OF ALL EQUIPMENT AND MATERIALS AS REQUIRED TO COMPLETE THE WORK AS OUTLINED IN THE RE-ROOFING TENDER DOCUMENTS.



Correctional Service Canada / Service correctionnel Canada



105-1020 Bayridge Drive, Kingston, Ontario, K7P 2S2
T: 613-767-8930 | F: 613-831-3812 | www.fsaeng.com

REV #	DATE	DESCRIPTION
3	2023-12-08	ISSUED FOR TENDER
2	2023-11-03	PRETENDER APPROVAL
1	2023-09-07	FOR 99% REVIEW

Client: CORRECTIONAL SERVICES CANADA

Project: JOYCEVILLE INSTITUTION ROOF AND STRUCTURAL WORK

Project #: FSA Project #: 23172DK

DETAILS

Address of Project: 3766 Highway 15 Kingston, ON K7L 4X9	Scale: 1:5 Draw.: RRC Dgn.: DJA Chk.: DJA	Page Number: 4
---	--	--------------------------

Date: 2023-08-14 | 23172DK-1.dwg

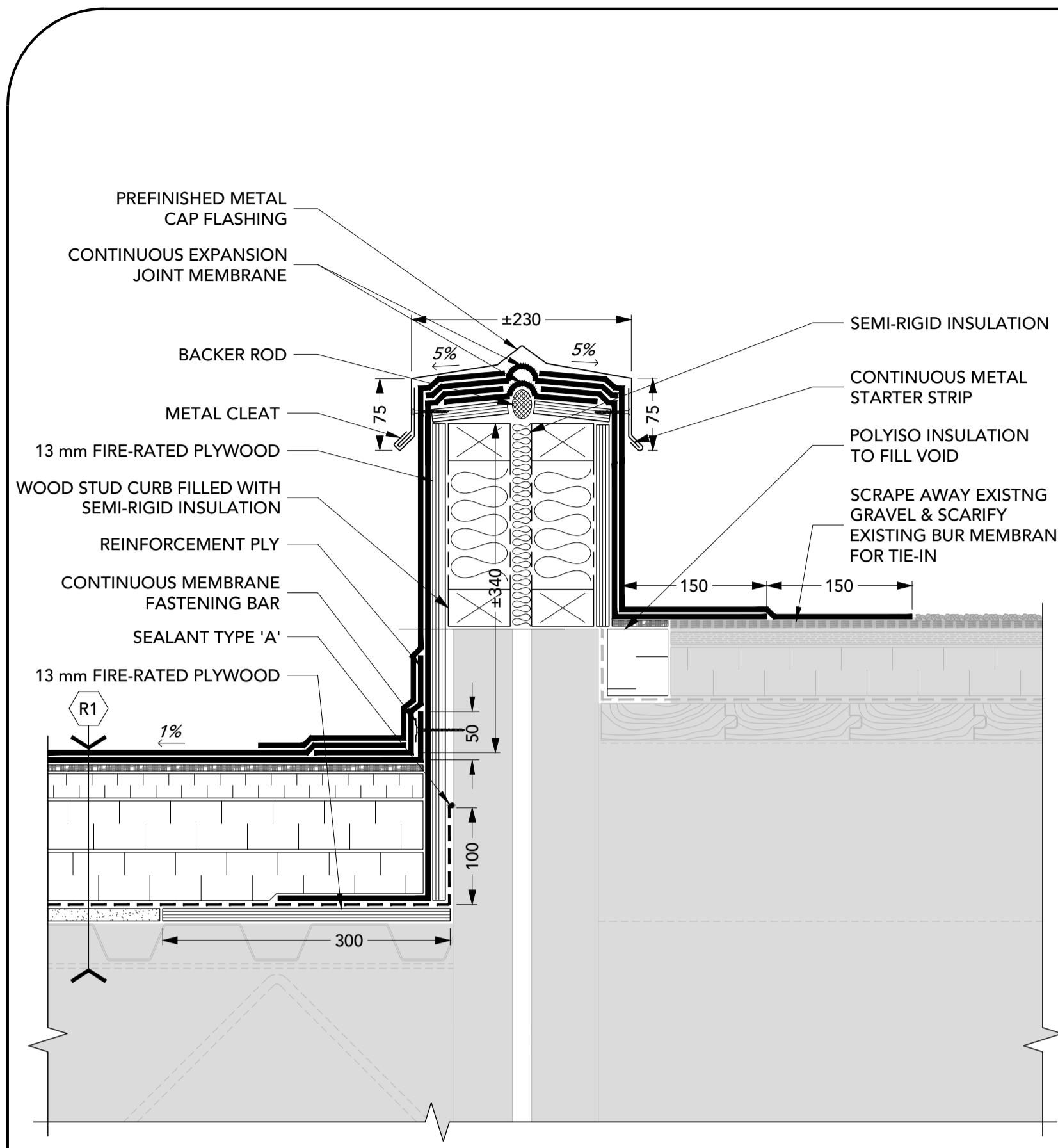

8 ROOF TRANSITION
5 1:5

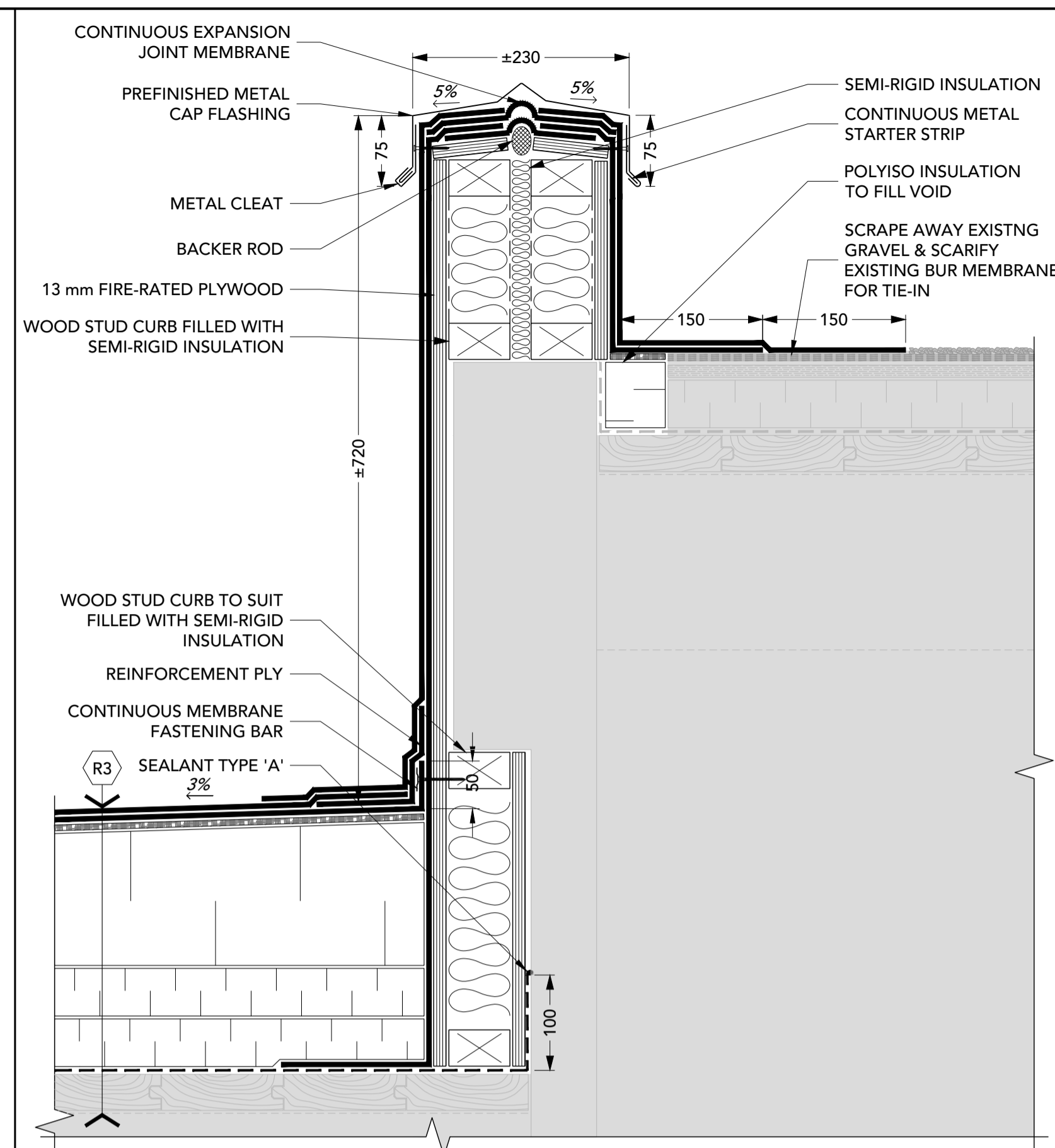

9 ROOF TRANSITION
5 1:5

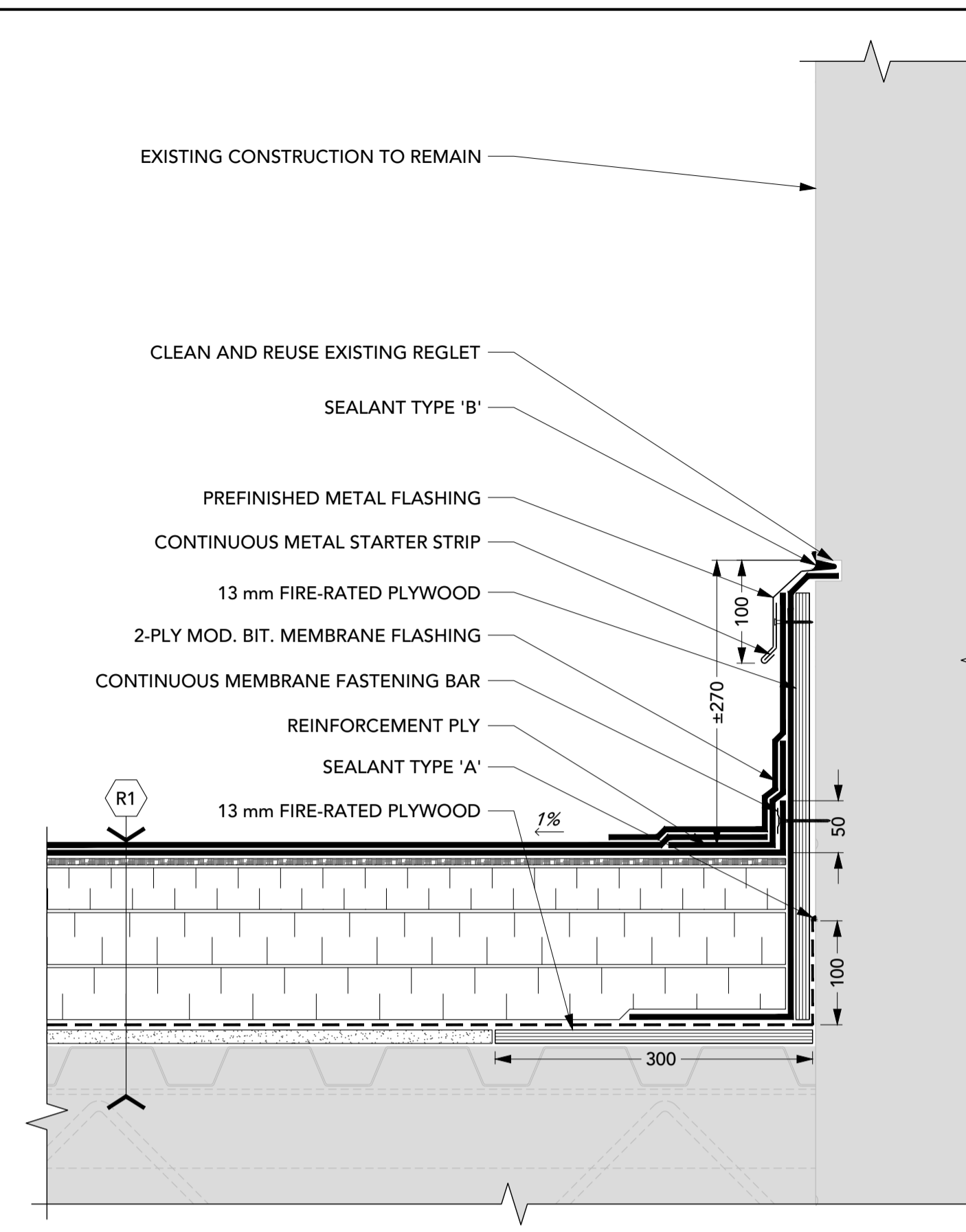

10 WALL UPTURN
5 1:5

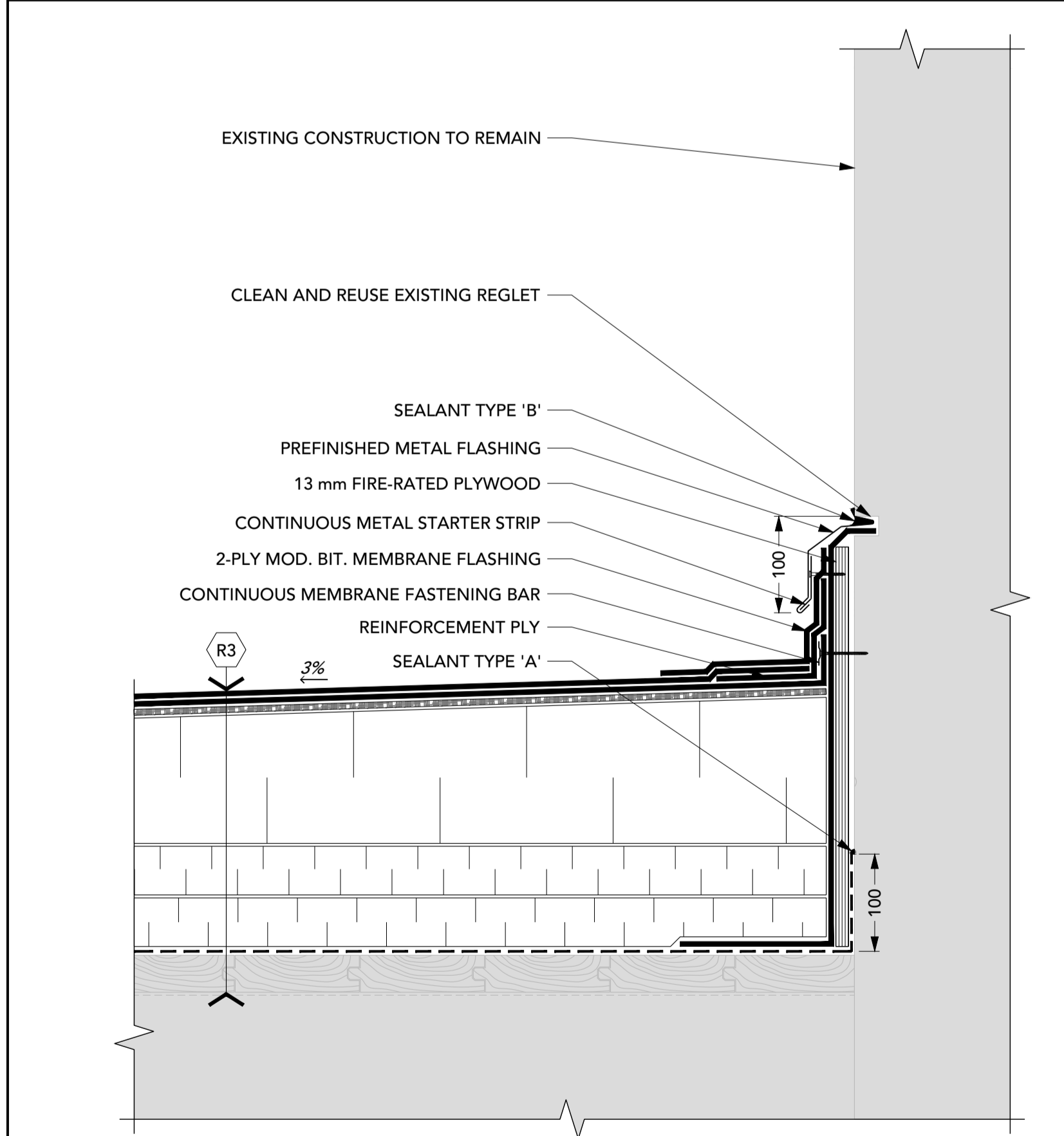

11 WALL UPTURN
5 1:5

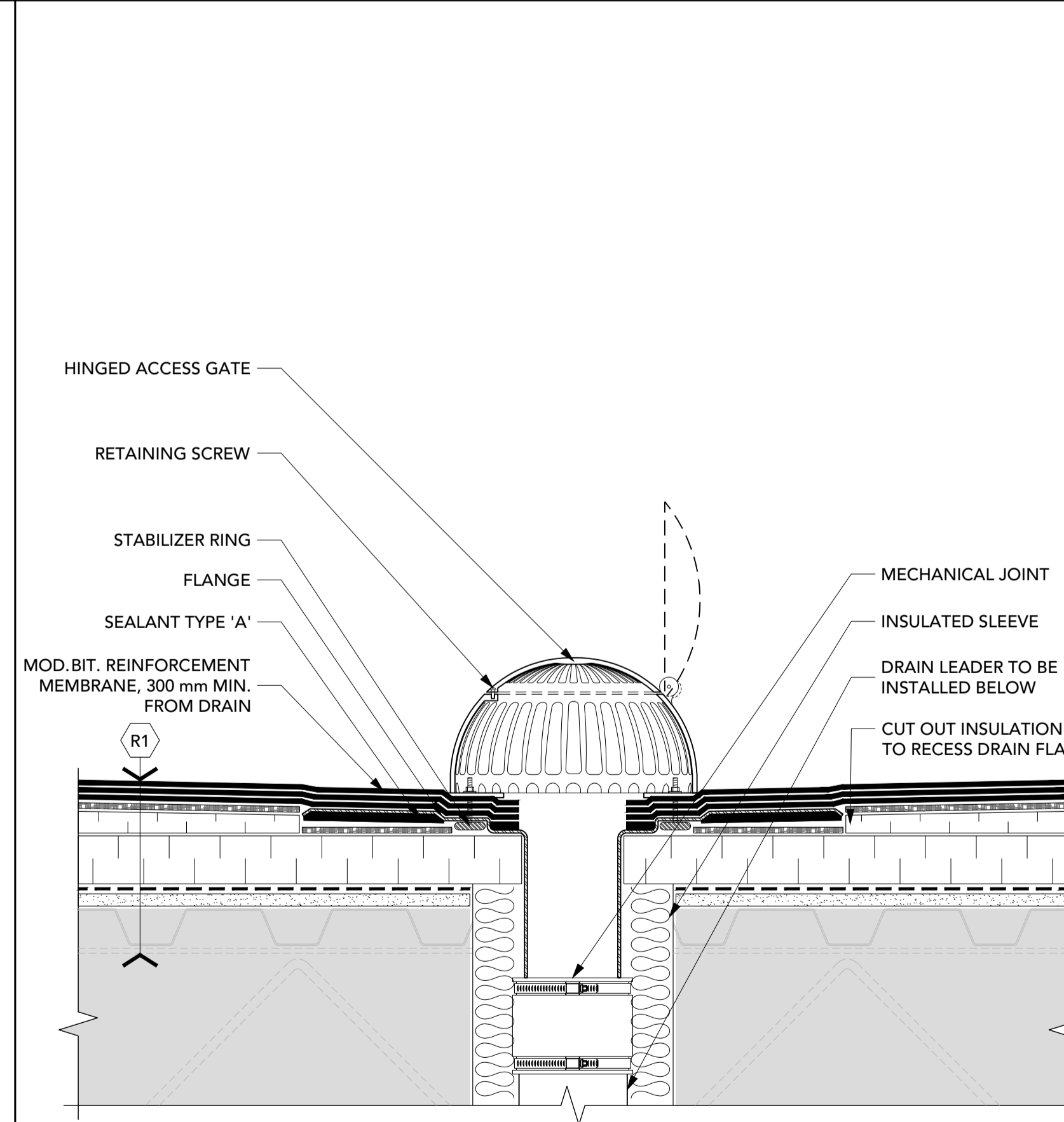

12 ROOF DRAIN IN EXISTING LOCATION
5 1:5

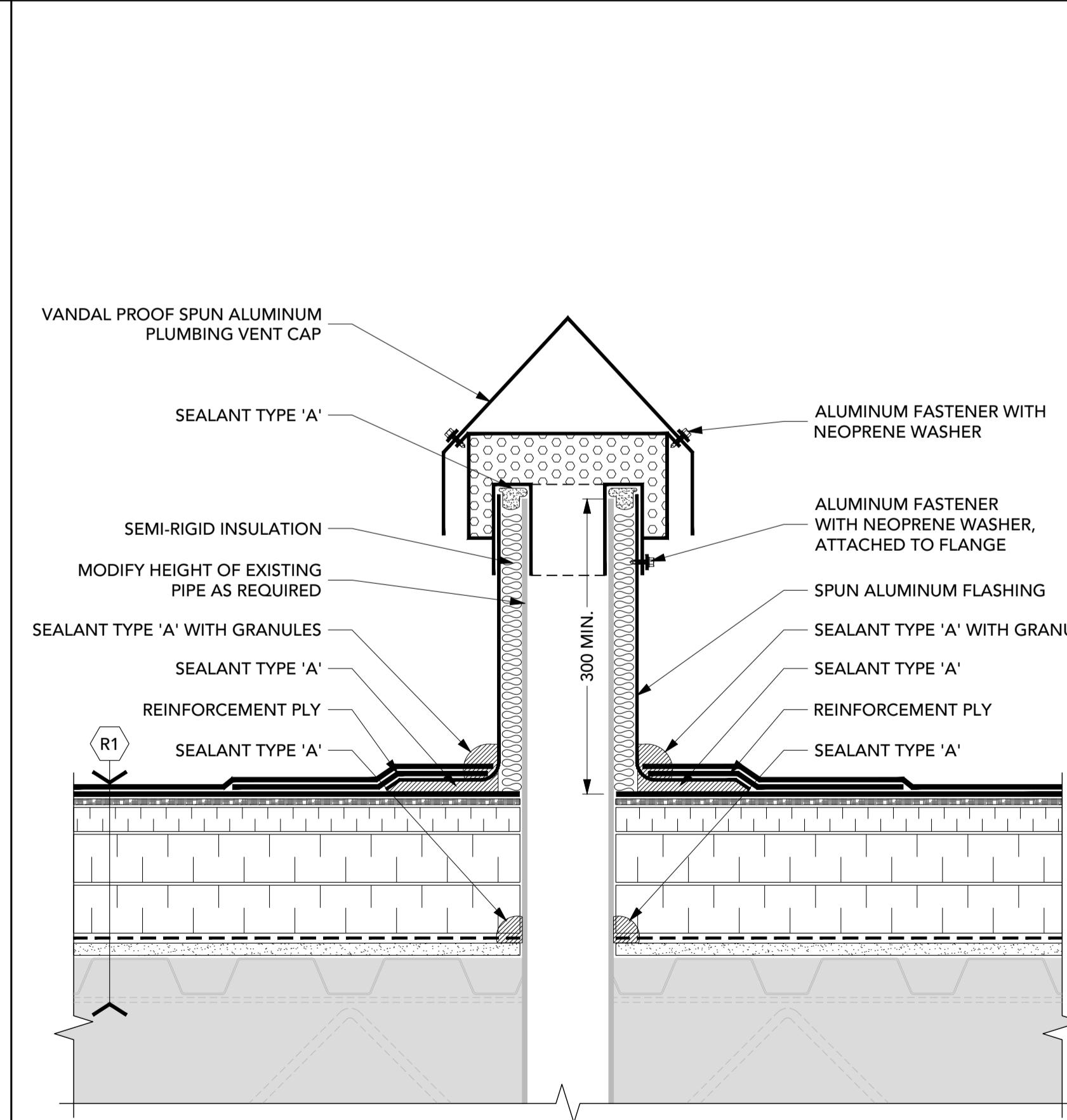

13 PLUMBING VENT
5 1:5

Key Plan:

Notes:

1. CONTRACTOR IS RESPONSIBLE TO VERIFY ALL DIMENSIONS AND CONFIRM EXISTING CONDITIONS.
2. NOTIFY CONSULTANT IMMEDIATELY OF ANY DEVIATIONS FROM ASSUMED EXISTING CONDITIONS AS THEY ARE ENCOUNTERED ON SITE.
3. TEMPORARILY REMOVE AND SUPPORT ELECTRICAL BOXES AND CONDUIT RUNNING ALONG PARAPETS AND ON ROOF SURFACES. REINSTATE UPON COMPLETION AND RE-SECURE AS REQUIRED.
4. DRAWINGS ARE NOT TO BE SCALED.
5. THE PROJECT CONSTRUCTOR IS RESPONSIBLE FOR RETAINING/COORDINATING SUB-TRADES, AND SUPPLY AND INSTALLATION OF ALL EQUIPMENT AND MATERIALS AS REQUIRED TO COMPLETE THE WORK AS OUTLINED IN THE RE-ROOFING TENDER DOCUMENTS.



Correctional Service Canada Service correctionnel Canada



105-1020 Bayridge Drive, Kingston, Ontario, K7P 2S2
T: 613-767-8930 | F: 613-831-3812 | www.fsaeng.com

3	2023-12-08	ISSUED FOR TENDER
2	2023-11-03	PRETENDER APPROVAL
1	2023-09-07	FOR 99% REVIEW

REV #	DATE	DESCRIPTION
-------	------	-------------

Client: CORRECTIONAL SERVICES CANADA

Project: JOYCEVILLE INSTITUTION ROOF AND STRUCTURAL WORK

Project #: FSA Project #: 23172DK

Title: DETAILS

Address of Project: 3766 Highway 15 Kingston, ON K7L 4X9	Scale: 1:5 Drw.: RRC Dgn.: DJA Chk.: DJA	Page Number: 5
---	---	--------------------------

Date: 2023-08-14 | 23172DK-1.dwg

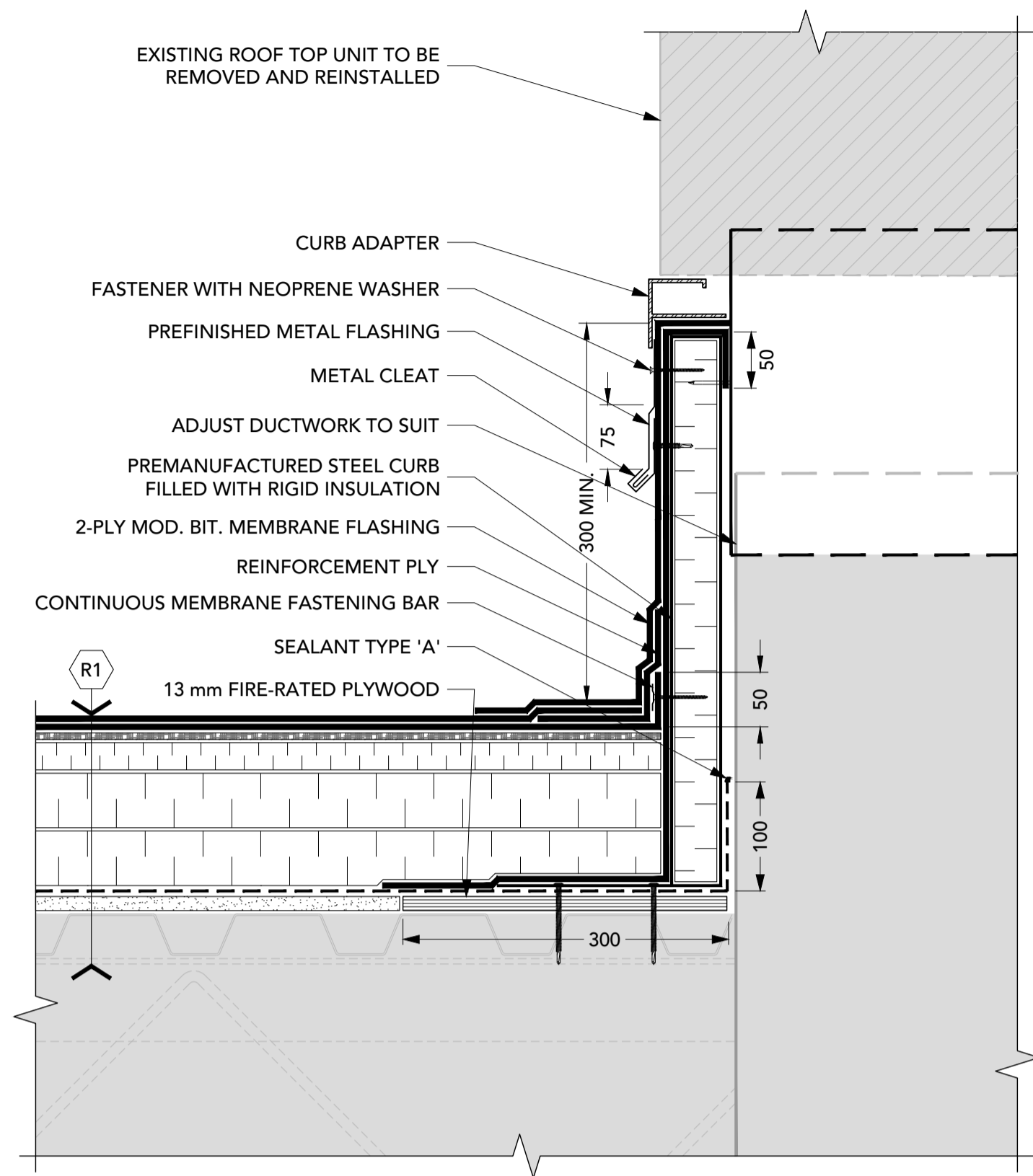

14 ROOF TOP UNIT
6 1:5

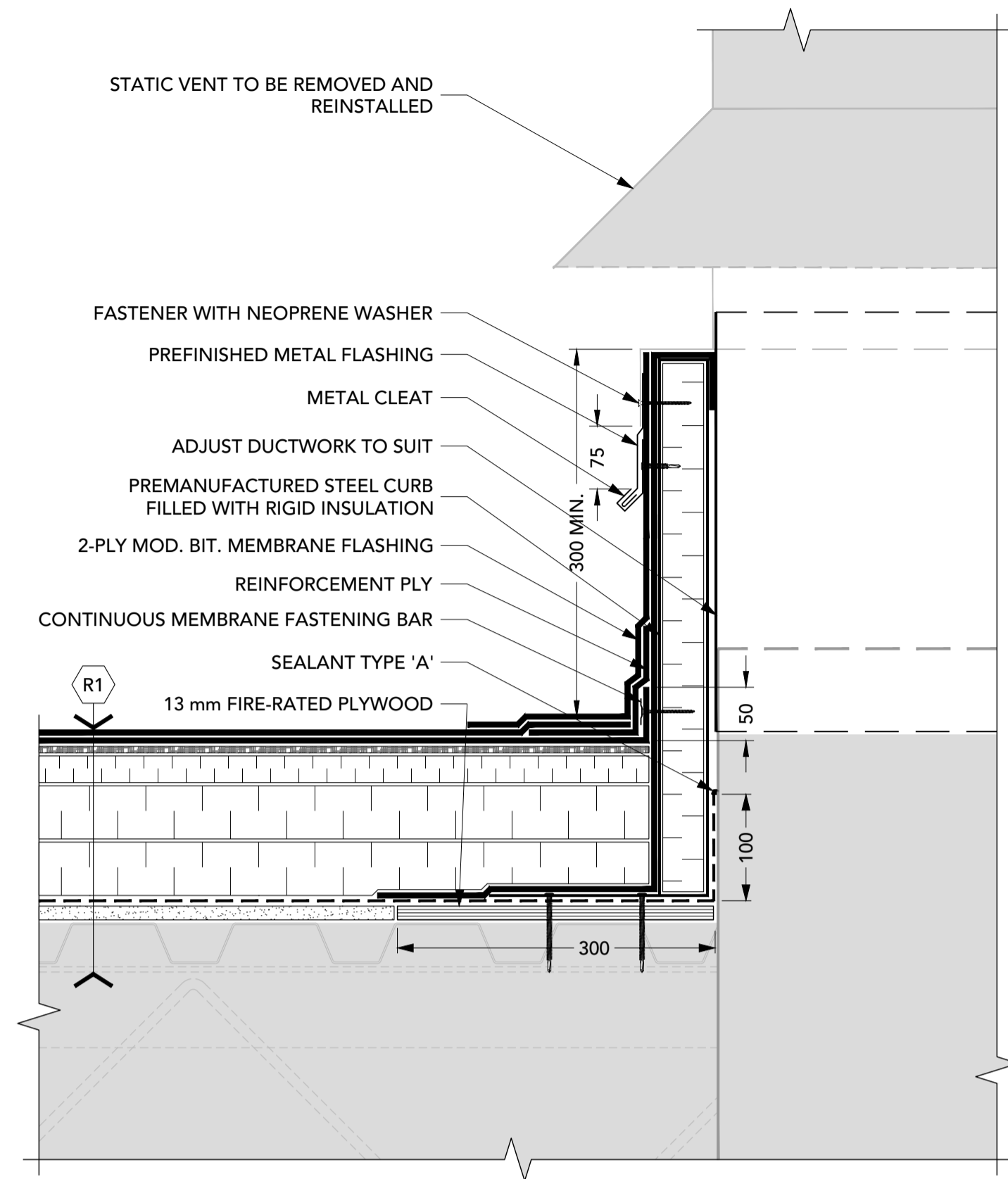

15 STATIC VENT
6 1:5

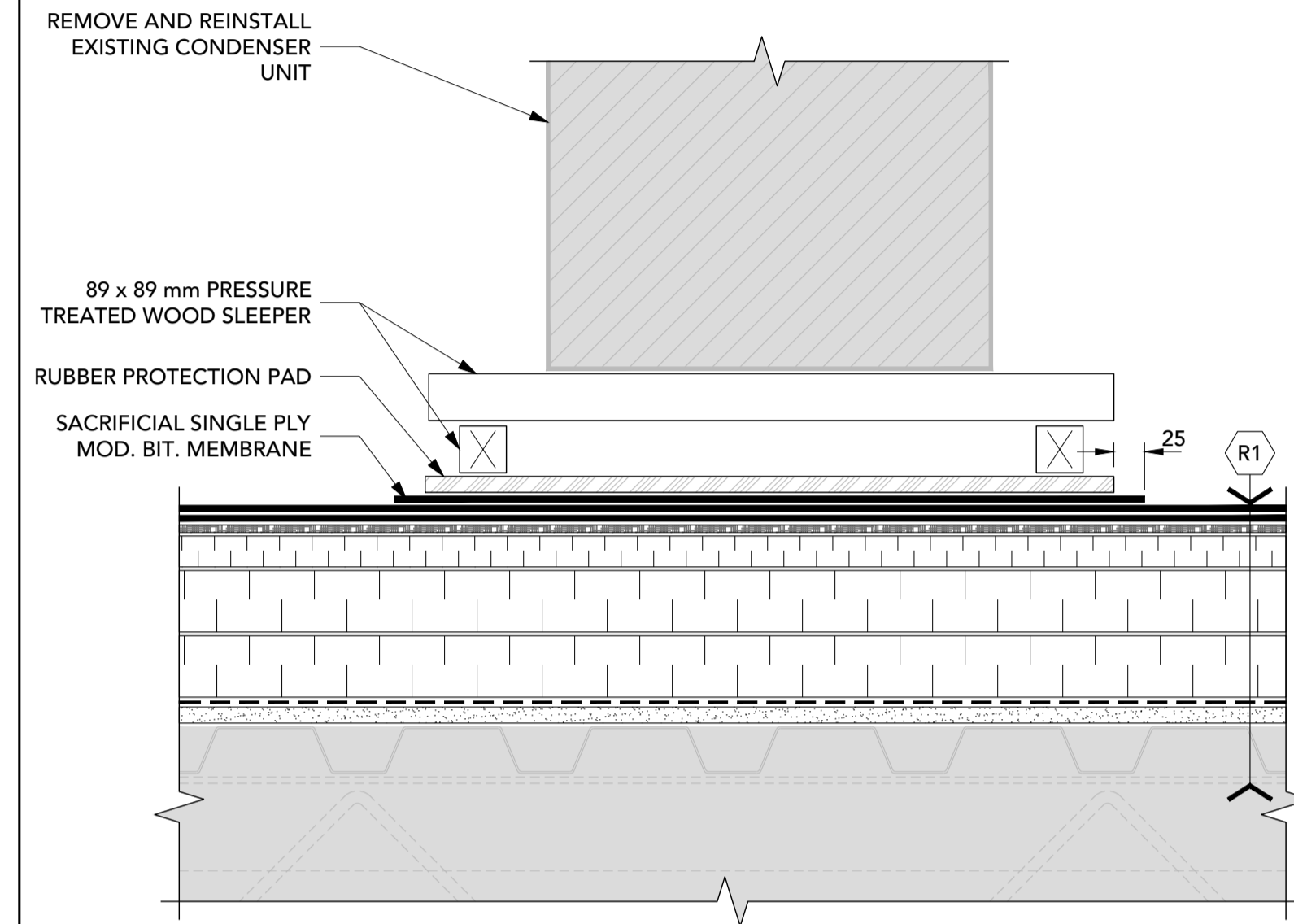

16 SUSPENDED AIR CONDENSER UNIT
6 1:5

NOTE: DECK PROFILE TO BE VERIFIED BY CONTRACTOR PRIOR TO REMOVAL OF ROOF SYSTEMS TO ENSURE MATERIALS ARE ON SITE PRIOR TO COMMENCING WORK.

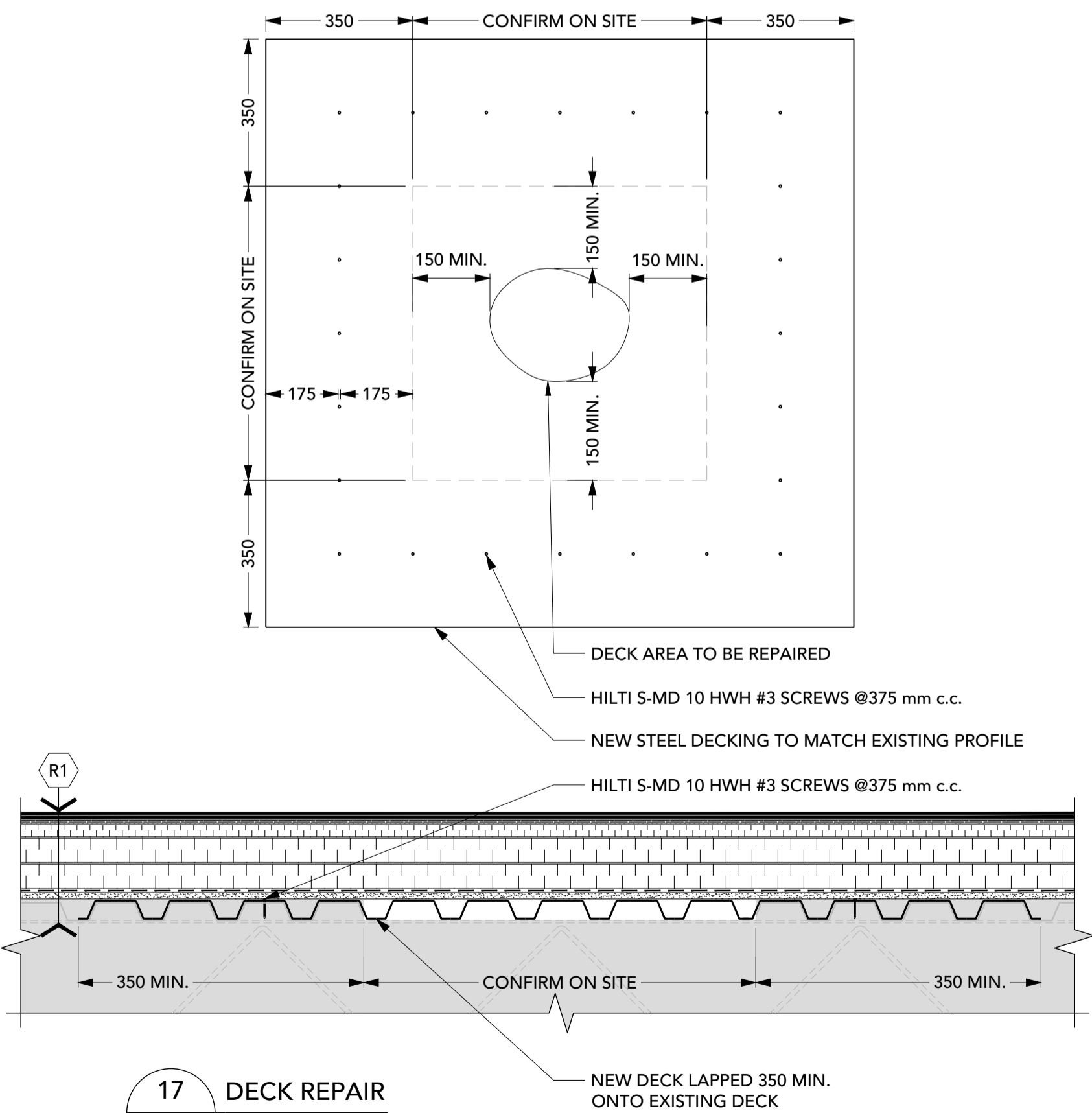

17 DECK REPAIR
6 1:10

Key Plan:

Notes:

- CONTRACTOR IS RESPONSIBLE TO VERIFY ALL DIMENSIONS AND CONFIRM EXISTING CONDITIONS.
- NOTIFY CONSULTANT IMMEDIATELY OF ANY DEVIATIONS FROM ASSUMED EXISTING CONDITIONS AS THEY ARE ENCOUNTERED ON SITE.
- TEMPORARILY REMOVE AND SUPPORT ELECTRICAL BOXES AND CONDUIT RUNNING ALONG PARAPETS AND ON ROOF SURFACES. REINSTATE UPON COMPLETION AND RE-SECURE AS REQUIRED.
- DRAWINGS ARE NOT TO BE SCALED.
- THE PROJECT CONSTRUCTOR IS RESPONSIBLE FOR RETAINING/COORDINATING SUB-TRADES, AND SUPPLY AND INSTALLATION OF ALL EQUIPMENT AND MATERIALS AS REQUIRED TO COMPLETE THE WORK AS OUTLINED IN THE RE-ROOFING TENDER DOCUMENTS.



Correctional Service Canada / Service correctionnel Canada



105-1020 Bayridge Drive, Kingston, Ontario, K7P 2S2
T: 613-767-8930 | F: 613-831-3812 | www.fsaeng.com

REV #	DATE	DESCRIPTION
3	2023-12-08	ISSUED FOR TENDER
2	2023-11-03	PRETENDER APPROVAL
1	2023-09-07	FOR 99% REVIEW

Client: CORRECTIONAL SERVICES CANADA

Project: JOYCEVILLE INSTITUTION ROOF AND STRUCTURAL WORK

Project #: FSA Project #: 23172DK

Title: DETAILS

Address of Project: 3766 Highway 15 Kingston, ON K7L 4X9	Scale: VARIES Drw.: RRC Dgn.: DJA Chk.: DJA	Page Number: 6
---	--	--------------------------

Date: 2023-08-14 | 23172DK-1.dwg

RESERVED

RESERVED