

LEGEND

- EXISTING CONCRETE PAVEMENT TO REMAIN
- EXISTING VEGETATION
- EXISTING TREES/SHRUBS
- EXISTING ELEVATION (GEODETIC)
- EXISTING CONCRETE PAVEMENT - CLEAR VEGETATION
- EXISTING CHAIN LINK FENCE
- BOUNDARY OF NEW WORK (SEE DWG C02 DETAIL 01)
- TH 1 TEST HOLE

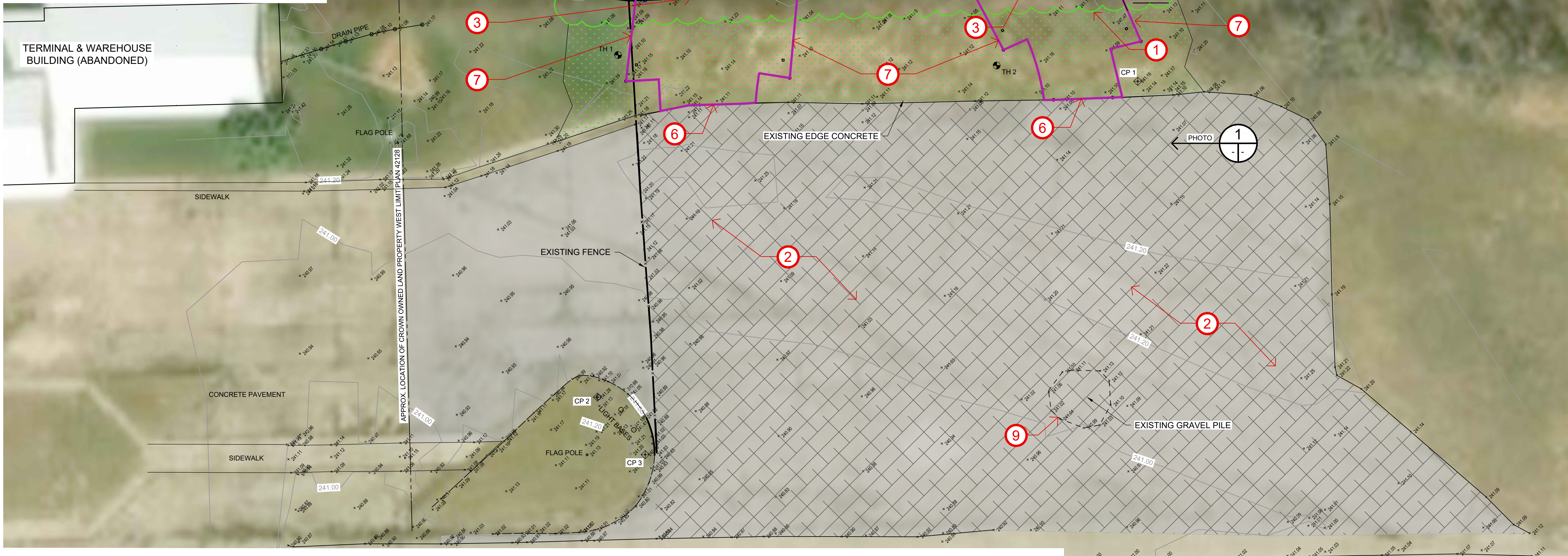

- GENERAL NOTES**
- A. THESE DRAWINGS ARE COLOR CODED. MUST BE VIEWED AND PRINTED IN COLOR.
 - B. READ IN CONJUNCTION WITH SPECIFICATIONS AND RELATED ANNEXES.
 - C. UNLESS OTHERWISE INDICATED AS EXISTING, ALL MATERIALS TO BE PROVIDED ARE NEW AND TO BE SUPPLIED AND INSTALLED AS PART OF THIS CONTRACT.
 - D. DO NOT SCALE DRAWINGS. ALL DIMENSIONS AND QUANTITIES OF EXISTING MATERIALS MUST BE SITE VERIFIED BEFORE COMMENCING ANY WORK. ANY CLAIMS FOR ADDITIONAL COMPENSATION MUST BE RESOLVED BEFORE ANY WORK COMMENCES.
 - E. UNLESS OTHERWISE INDICATED, ALL REMOVED MATERIALS NOT INDICATED TO BE RE-INSTALLED MUST BE DISPOSED OFF-SITE IN ACCORDANCE WITH MUNICIPAL AND PROVINCIAL REGULATIONS. REFER TO SPECIFICATIONS SP.0 FOR WASTE MANAGEMENT PLAN. THERE IS A REQUIREMENT TO DIVERT, SEPARATE AND RECYCLE ALL WASTE WHERE POSSIBLE.
 - F. CONTRACTORS ARE RESPONSIBLE FOR REQUESTING CLARIFICATIONS DURING TENDERING AND CONSTRUCTION.
 - G. ENVIRONMENTAL MITIGATIONS MUST BE IMPLEMENTED AT ALL TIMES. REFER TO SPECIFICATIONS SP.0 ENVIRONMENTAL MANAGEMENT FOR THE ENVIRONMENTAL MITIGATIONS THAT THE CONTRACTOR IS REQUIRED TO IMPLEMENT FOR THIS PROJECT.
 - H. REFER TO SUBMITTALS LIST IN APPENDIX B OF SPECIFICATIONS. REFER TO SPECIFICATIONS SP.0 FOR SUBMITTAL PROCESS AND TIMELINES. SUBMITTALS MUST BE APPROVED BEFORE WORK COMMENCES.
 - I. MAINTAIN, PROTECT AND MAKE GOOD ON ALL SPACES ADJACENT TO THE WORK AREA, ON THE PROPERTY AND ON ANY NEIGHBORING PROPERTIES INCLUDING MUNICIPAL ROADS.
 - J. DO NOT TRAVEL UPON OR USE ANY SPACE ON THE ADJACENT PRIVATELY OWNED PROPERTY TO THE WEST.
 - K. PROVIDE UTILITY LOCATES BEFORE COMMENCING WORK. CONTACTOR IS RESPONSIBLE FOR COORDINATING AND COSTS.
 - L. PROVIDE 3RD PARTY INDEPENDENT INSPECTION AND TESTING AS OUTLINED IN SP.0. CONTACTOR IS RESPONSIBLE FOR COORDINATING AND COSTS.
 - M. PLAN AND DO OTHER DEMOLITION AND REMOVAL AS NEEDED TO FACILITATE NEW CONSTRUCTION.
 - N. PROVIDE BARRICADES AROUND THE ACCESS POINTS TO THE AREA OF CONSTRUCTION, AS NEEDED, FOR SAFETY.
 - O. REFER TO SPECIFICATIONS SP.0 SECTION 1.3 FOR WORK RESTRICTIONS THAT APPLY TO THIS PROJECT.
 - P. PROVIDE TEMPORARY FENCE PANELS AT LEAST 2.0 METERS HIGH FOR AREAS OF THE DEMOLISHED EXISTING FENCE INTERIM TO COMPLETION NEW GATE AND FENCE WORKS. THE TEMPORARY FENCE PANELS MUST BE SECURED TOP AND BOTTOM AND TO THE EXISTING FENCE TO REMAIN.

- DEMOLITION NOTES**
1. REMOVE ALL SHRUBS AND TREES WITHIN THE NEW WORK AREA AND TWO (2) METERS BEYOND. REMOVE ANY STUMPS WITHIN THE FOOTPRINT OF THE NEW WORK AREA TAKING CARE TO MINIMIZE DISTURBANCE TO THE NATIVE SUBGRADE. **REMOVAL AREA ESTIMATED AT 220 m2.**
 2. REMOVE VEGETATION THAT HAS GROWN THROUGH THE JOINTS IN THE EXISTING CONCRETE AREA. JOINTS DO NOT REQUIRE CLEANING. RESIDUAL VEGETATION IN THE JOINT TO BE APPROXIMATELY FLUSH WITH THE PAVEMENT SURFACE. **TOTAL AREA APPROXIMATELY 3500 m2.** SEE DWG C01 DETAIL 2
 3. REMOVE EXISTING FENCE SEGMENT AS NEEDED TO PROVIDE NECESSARY OPENING FOR THE NEW WORK AND GATES. REMOVE (PULL) ANY LINE AND END POSTS WITHIN THE FENCE SEGMENT BEING DEMOLISHED. RETAIN EXISTING FENCE FABRIC TO TIE INTO THE NEW GATE POST. REFER TO DWG C02 NOTES 3, 5 AND 6 FOR EXACT SCOPE OF EXISTING FENCE DEMOLITION.
 4. REMOVE EXISTING CORRAL FENCE CONNECTION LOCATED ON THE EAST SIDE. THIS FENCE IS PERPENDICULAR TO EXISTING MAIN EAST-WEST COMPOUND EXISTING FENCE ON THE EAST SITE. REMOVE (PULL) ANY LINE AND END POSTS WITHIN THE FENCE SEGMENT BEING DEMOLISHED. RETAIN EXISTING FENCE FABRIC TO TIE INTO THE NEW GATE POST. SEE DWG C03 DETAIL 05
 5. EXCAVATE EXISTING NATIVE MATERIALS TO THE SUBGRADE DEPTH FOR NEW PAVEMENT STRUCTURE, INCLUDING THE SHOULDER. ENSURE THE SUBGRADE IS MINIMALLY DISTURBED DURING THE EXCAVATION. EXISTING CONCRETE PAVEMENT TO BE RETAINED.
 6. TAKE PRECAUTIONS TO NOT UNDERMINE THE BASE AND SUB-BASE OF EXISTING CONCRETE PAVEMENT RETAINED THAT IS ADJACENT TO THE NEW PAVEMENT. PREPARE AND CLEAN EXISTING CONCRETE FOR NEW TRANSITION. SEE DWG C02 DETAIL 01 AND DETAIL 03
 7. EXCAVATE EXISTING NATIVE MATERIALS TO THE SUBGRADE DEPTH FOR THE NEW SWING GATE PADS. SEE DWG C02 DETAIL 01 AND DETAIL 03
 8. REMOVE EXISTING CFIA SIGN (SHOWN IN DWG C01 DETAIL 03) INCLUDING POSTS AND RETAIN FOR REINSTALLATION AT A NEW LOCATION. EXISTING PIERS TO REMAIN.
 9. EXISTING GRAVEL PILE LOCATED ON THE SOUTH PORTION OF EXISTING PAVEMENT APRON TO BE RELOCATED TO THE FAR NORTH EAST CORNER OF THE CONCRETE APRON. MUST NOT HINDER NEW ENTRANCE. **APPROXIMATE AREA 29 m2 AND VOLUME 12-15 m3.** NEW PILE TO BE A SIMILAR COMPACT FOOTPRINT.



1 TYPICAL VEGETATION ON CONCRETE PAD



2 TYPICAL VEGETATION & CHAIN LINK FENCE AT PROPOSED NEW ACCESS



3 TYPICAL VEGETATION & CHAIN LINK FENCE AT PROPOSED NEW ACCESS

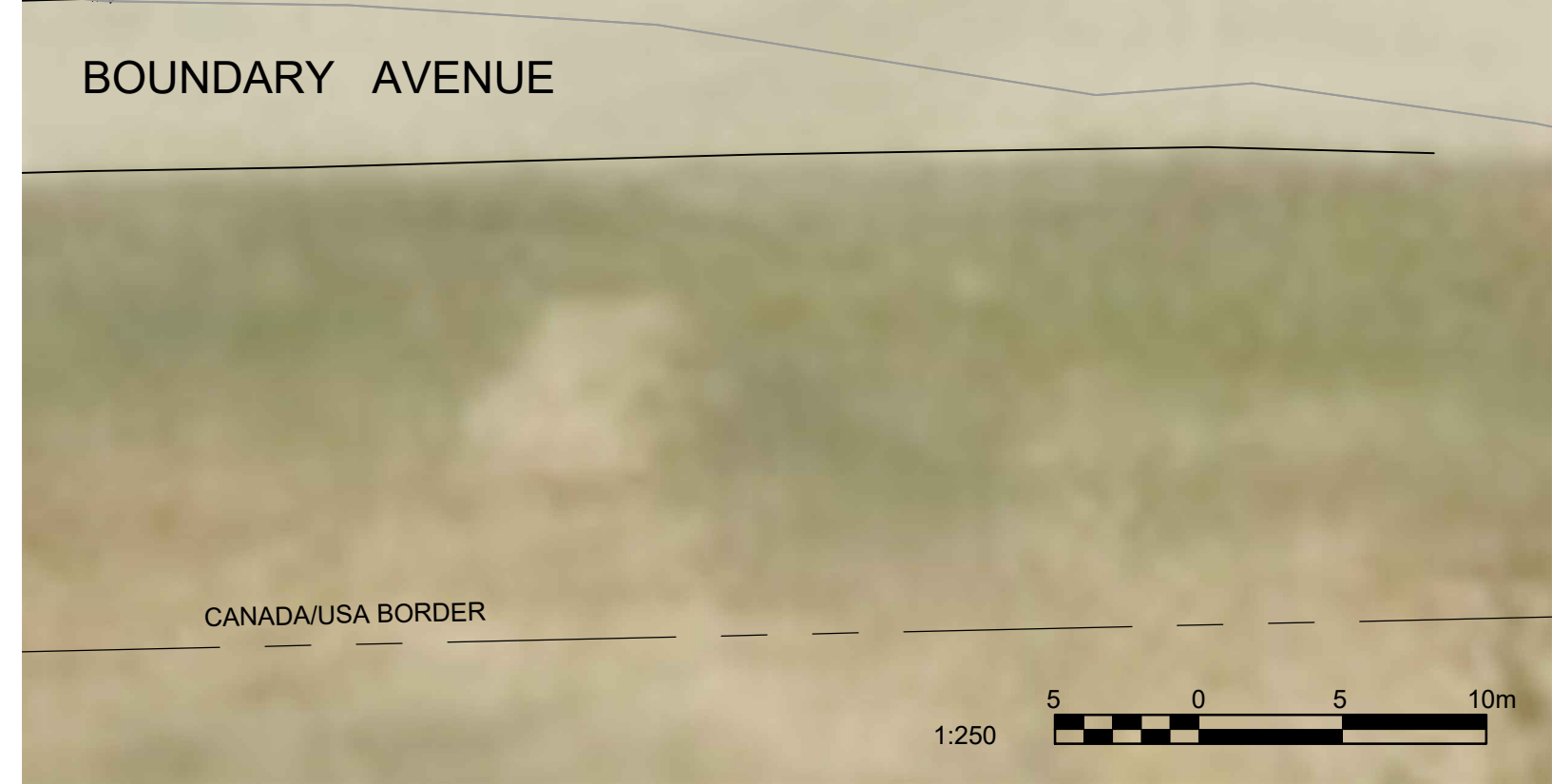

DRAWING NO.	DESCRIPTION	NO.	DATE	DESCRIPTION	DRAWN	REVIEWED	ISSUED	APPROVED
0	ISSUED FOR TENDER		2022.11.30		GMD	DAL	DAL	JW
	REVISIONS/ISSUE				DRAFTING		ENGINEERING	

PERMIT STAMP	SEAL
	ORIGINAL DRAWING REVISION "0" SEALED BY J.M. HILDEBRAND 2022.11.30

DESIGNED BY: DAL	DRAWN BY: GMD	REVIEWED BY: MH
APPROVED BY: JW	DATE: 2022-12-22	SCALE: 1 : 250

CLIENT: **Public Works and Government Services**

PROJECT NAME: CANADIAN FOOD INSPECTION AGENCY - EMERSON, MB. NEW VEHICLE ACCESS
DRAWING DESCRIPTION: DEMOLITION & OVERVIEW
PROJECT NO. SHEET NO. C01 REV. 0

D:\22\3347
3D MODEL REF No:

LEGEND

	EXISTING CONCRETE PAVEMENT
	EXISTING VEGETATION
	EXISTING TREES/SHRUBS
	NEW ASPHALT PAVEMENT LANE
	NEW GRAVEL SHOULDER
	EXISTING ELEVATION (GEODETC)
	NEW ELEVATION (GEODETC)
	NEW CONCRETE TO ASPHALT PAVEMENT TRANSITION
	NEW SWING GATE
	NEW SWING GATE PAD
	CLEAR PAVEMENT VEGETATION
	NEW PAVEMENT JOINT
	EXISTING PAVEMENT JOINT
	TEST HOLE
	DRAINAGE DIRECTION

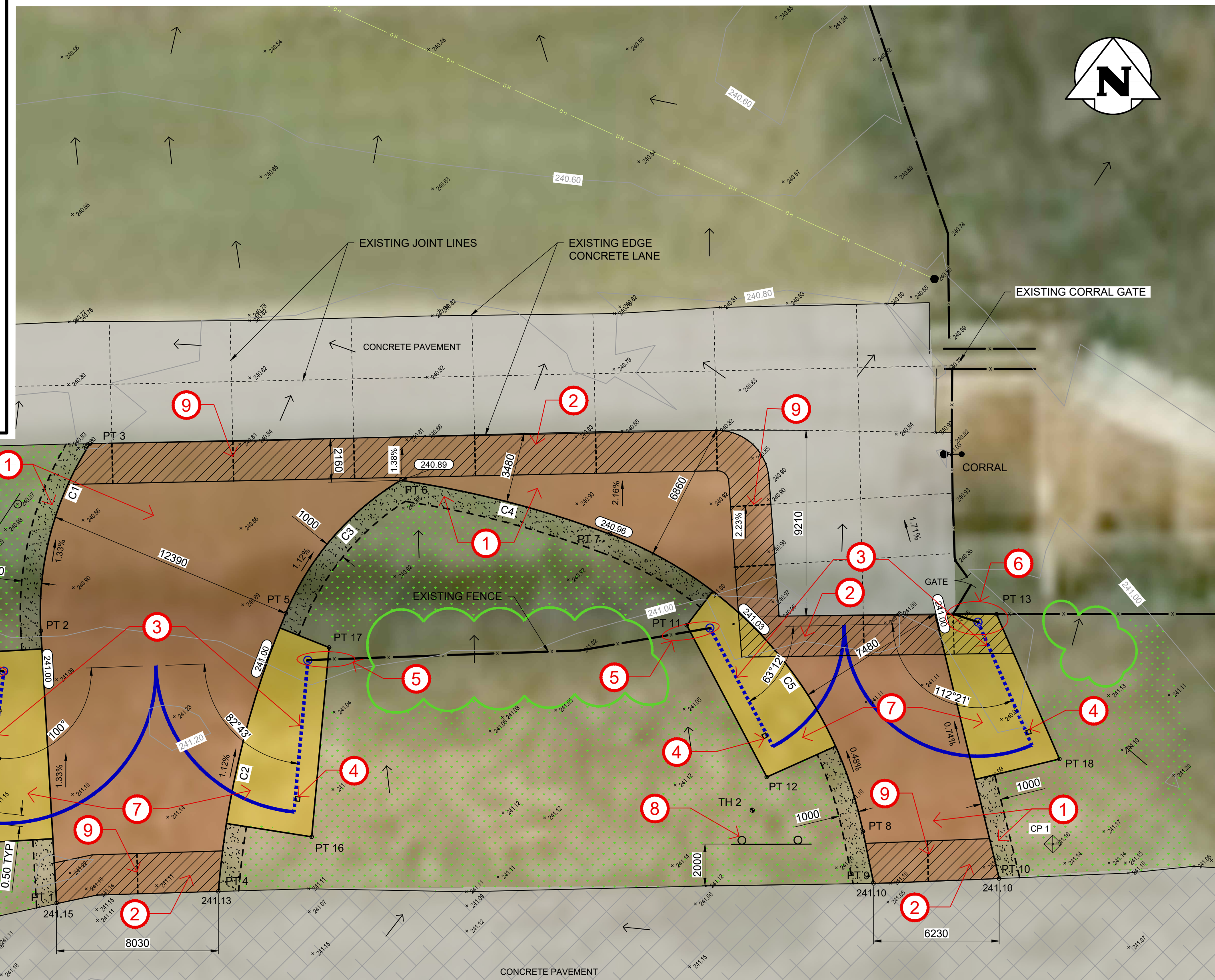

POINT TABLE (UTM NAD 83)

POINT No.	NORTHING	EASTING
1	5429121.064	630951.772
2	5429134.399	630951.005
3	5429143.685	630953.450
4	5429121.476	630959.813
5	5429135.265	630963.155
6	5429141.865	630968.863
7	5429139.196	630979.226
8	5429124.451	630991.794
9	5429121.870	630992.318
10	5429122.113	630998.547
11	5429134.678	630983.051
13	5429135.219	630998.421
14	5429133.342	630948.265
15	5429123.834	630947.142
16	5429124.179	630964.441
17	5429133.573	630965.303
18	5429128.040	631001.541

CURVE TABLE

CURVE	RADIUS	DELTA	TANGENT	LENGTH	PI COORDINATES
C1	15.500	36°05'18"	5.049	9.763	N: 5429138.848 E: 630950.334
C2	45.000	18°08'24"	7.184	14.247	N: 5429128.637 E: 630960.383
C3	14.000	36°19'04"	4.592	8.874	N: 5429139.422 E: 630964.893
C4	50.000	12°17'13"	5.382	10.722	N: 5429141.061 E: 630974.237
C5	20.000	57°56'30"	11.073	20.225	N: 5429135.303 E: 630989.582

Control Points

	Easting	Northing	Elevation	Label	Description
Control Point 1	631001.205	5429123.825	241.159	AAE-CFIA-CP1	Horizontal and Vertical (Ground Pin, flagged/staked)
Control Point 2 (Sheet C01)	630944.129	5429090.482	241.283	AAE-CFIA-CP2	Horizontal and Vertical (Ground Pin, flagged/staked)
Control Point 3 (Sheet C01)	630949.169	5429084.412	240.903	79M037	High Precision 3D (Well Pin)
Control Point 4	630354.061	5429661.245	240.959	30M864C	Vertical Only (Town Hall)
Control Point 5	630540.803	5429657.803	239.553	11M1484	Vertical Only (Post Office)

Coordinate System: UTM NAD 83, ZONE 14N
Vertical Datum: CGVD28

- GENERAL NOTES**
- THESE DRAWINGS ARE COLOR CODED. MUST BE VIEWED AND PRINTED IN COLOR.
 - READ IN CONJUNCTION WITH SPECIFICATIONS AND RELATED ANNEXES.
 - UNLESS OTHERWISE INDICATED AS EXISTING, ALL MATERIALS TO BE PROVIDED ARE NEW AND TO BE SUPPLIED AND INSTALLED AS PART OF THIS CONTRACT.
 - DO NOT SCALE DRAWINGS. ALL DIMENSIONS AND QUANTITIES OF EXISTING MATERIALS MUST BE SITE VERIFIED BEFORE COMMENCING ANY WORK. ANY CLAIMS FOR ADDITIONAL COMPENSATION MUST BE RESOLVED BEFORE ANY WORK COMMENCES.
 - UNLESS OTHERWISE INDICATED, ALL REMOVED MATERIALS NOT INDICATED TO BE RE-INSTALLED MUST BE DISPOSED OFF-SITE IN ACCORDANCE WITH MUNICIPAL AND PROVINCIAL REGULATIONS. REFER TO SPECIFICATIONS SP.0 FOR WASTE MANAGEMENT PLAN. THERE IS A REQUIREMENT TO DIVERT, SEPARATE AND RECYCLE ALL WASTE WHERE POSSIBLE.
 - CONTRACTORS ARE RESPONSIBLE FOR REQUESTING CLARIFICATIONS DURING TENDERING AND CONSTRUCTION.
 - ENVIRONMENTAL MITIGATIONS MUST BE IMPLEMENTED AT ALL TIMES. REFER TO SPECIFICATIONS SP.0 ENVIRONMENTAL MANAGEMENT FOR THE ENVIRONMENTAL MITIGATIONS THAT THE CONTRACTOR IS REQUIRED TO IMPLEMENT FOR THIS PROJECT.
 - REFER TO SUBMITTALS LIST IN APPENDIX B OF SPECIFICATIONS. REFER TO SPECIFICATIONS SP.0 FOR SUBMITTAL PROCESS AND TIMELINES. SUBMITTALS MUST BE APPROVED BEFORE WORK COMMENCES.
 - MAINTAIN, PROTECT AND MAKE GOOD ON ALL SPACES ADJACENT TO THE WORK AREA, ON THE PROPERTY AND ON ANY NEIGHBORING PROPERTIES INCLUDING MUNICIPAL ROADS.
 - DO NOT TRAVEL UPON OR USE ANY SPACE ON THE ADJACENT PRIVATELY OWNED PROPERTY TO THE WEST.
 - PROVIDE UTILITY LOCATES BEFORE COMMENCING WORK. CONTACTOR IS RESPONSIBLE FOR COORDINATING AND COSTS.
 - PROVIDE 3RD PARTY INDEPENDENT INSPECTION AND TESTING AS OUTLINED IN SP.0. CONTACTOR IS RESPONSIBLE FOR COORDINATING AND COSTS.
 - PLAN AND DO OTHER DEMOLITION AND REMOVAL AS NEEDED TO FACILITATE NEW CONSTRUCTION.
 - PROVIDE BARRICADES AROUND THE ACCESS POINTS TO THE AREA OF CONSTRUCTION, AS NEEDED, FOR SAFETY.
 - REFER TO SPECIFICATIONS SP.0 SECTION 1.3 FOR WORK RESTRICTIONS THAT APPLY TO THIS PROJECT.
 - PROVIDE TEMPORARY FENCE PANELS AT LEAST 2.0 METERS HIGH FOR AREAS OF THE DEMOLISHED EXISTING FENCE INTERIM TO COMPLETION NEW GATE AND FENCE WORKS. THE TEMPORARY FENCE PANELS MUST BE SECURED TOP AND BOTTOM AND TO THE EXISTING FENCE TO REMAIN.

- CONSTRUCTION NOTES**
- PROVIDE NEW PAVEMENT COMPLETE WITH GRAVEL SHOULDERS AS INDICATED. **NEW ASPHALT PAVEMENT AREA APPROXIMATELY 545 m². NEW GRAVEL SHOULDER AREA APPROXIMATELY 55 m².** SEE DWG C02 DETAIL 2
 - PROVIDE CONCRETE TRANSITION SLAB ALONG JOINT WHERE NEW PAVEMENT ABUTS WITH EXISTING REINFORCED CONCRETE PAVEMENT RETAINED. REMOVE ALL MATERIAL AND CLEAN THE EXISTING CONCRETE PAVEMENT FACE. PROVIDE 20M DOWELS THAT ARE 600MM LONG (300mm INTO EXISTING CONCRETE) AT 300 O/C. EPOXY THE DOWEL END INTO THE EXISTING CONCRETE USING HILTI EPOXY GROUT OR EQUIVALENT. **APPROXIMATE TOTAL AREA TRANSITION SLAB OF 136 m².** SEE DWG C02 DETAIL 4
 - PROVIDE TWO (2) NEW DOUBLE GATES 1.82m HIGH C/W ALL RELATED HARDWARE AS SHOWN DWG C03 DETAIL 01. WEST GATE 15.0m WIDE AND EAST GATE 13.5m WIDE. PROVIDE FOUR (4) NEW GATE POSTS AS INDICATED. SEE DWG C03 DETAILS 01 AND 03
 - PROVIDE FOUR (4) NEW PT 4X4 WOOD POSTS TO ALLOW THE GATES TO BE RESTRAINED IN THE OPEN POSITION C/W RELATED HARDWARE. PROVIDE A CONCRETE PIER FOR EACH NEW PT POST THAT IS AT LEAST 1.5m DEEP AND 250mm DIAMETER. THE POST MUST PENETRATE THE CONCRETE AT LEAST 1.2m. ENSURE POSTS ARE INSTALLED PLUMB. SEE DWG C03 DETAILS 02
 - PROVIDE NEW RAILS AND HARDWARE TO CONNECT EXISTING FENCE FABRIC TO NEW GATE POST. THIS INCLUDES NEW TOP RAIL, BRACE RAIL, BOTTOM RAIL, TENSION BAR AND RELATED HARDWARE. TENSION AND SECURE THE EXISTING FABRIC SUITABLY. SEE DWG C03 DETAILS 01
 - TRIM AND CONNECT EXISTING FABRIC OF THE CORRAL FENCE TO THE NEW POST. PROVIDE NEW HARDWARE TO CONNECT EXISTING FENCE TO NEW GATE POST INCLUDING NEW TOP RAIL, BRACE RAIL, BOTTOM RAIL, TENSION BAR AND RELATED HARDWARE. TENSION THE EXISTING FABRIC SUITABLY. C03 DETAILS 05
 - PROVIDE (4) SWING GATE PADS AS INDICATED. THESE PADS ARE AN EXTENSION TO THE NEW PAVEMENT TO ALLOW THE GATES TO BE ROLLED OUT BEYOND THE PAVEMENT WITH EASE. **APPROXIMATE TOTAL AREAS 130 m².** SEE DWG C02 DETAIL 03
 - PROVIDE TWO (2) NEW PIERS AND U-ANCHOR BOLTS FOR THE RELOCATED CFIA SIGN. SITE VERIFY THE EXISTING SIGN BASEPLATES OF THE SIGN POSTS TO ENSURE THE NEW ANCHORS ARE COMPATIBLE IN SIZE AND SPACING. REINSTALL THE EXISTING CFIA SIGN ENSURING THAT IT IS PLUMB AND LEVEL. SEE DWG C03 DETAILS 04 AND 06.
 - PROVIDE SAW CUT JOINTS IN THE TRANSITION SLABS IN ACCORDANCE WITH SP.8. FINAL JOINT WIDTH TO BE 10mm WIDE BY 30mm DEEP. BACKER ROD AND HOT Poured JOINT SEALANT TO BE PLACED IN ACCORDANCE TO SP.8.

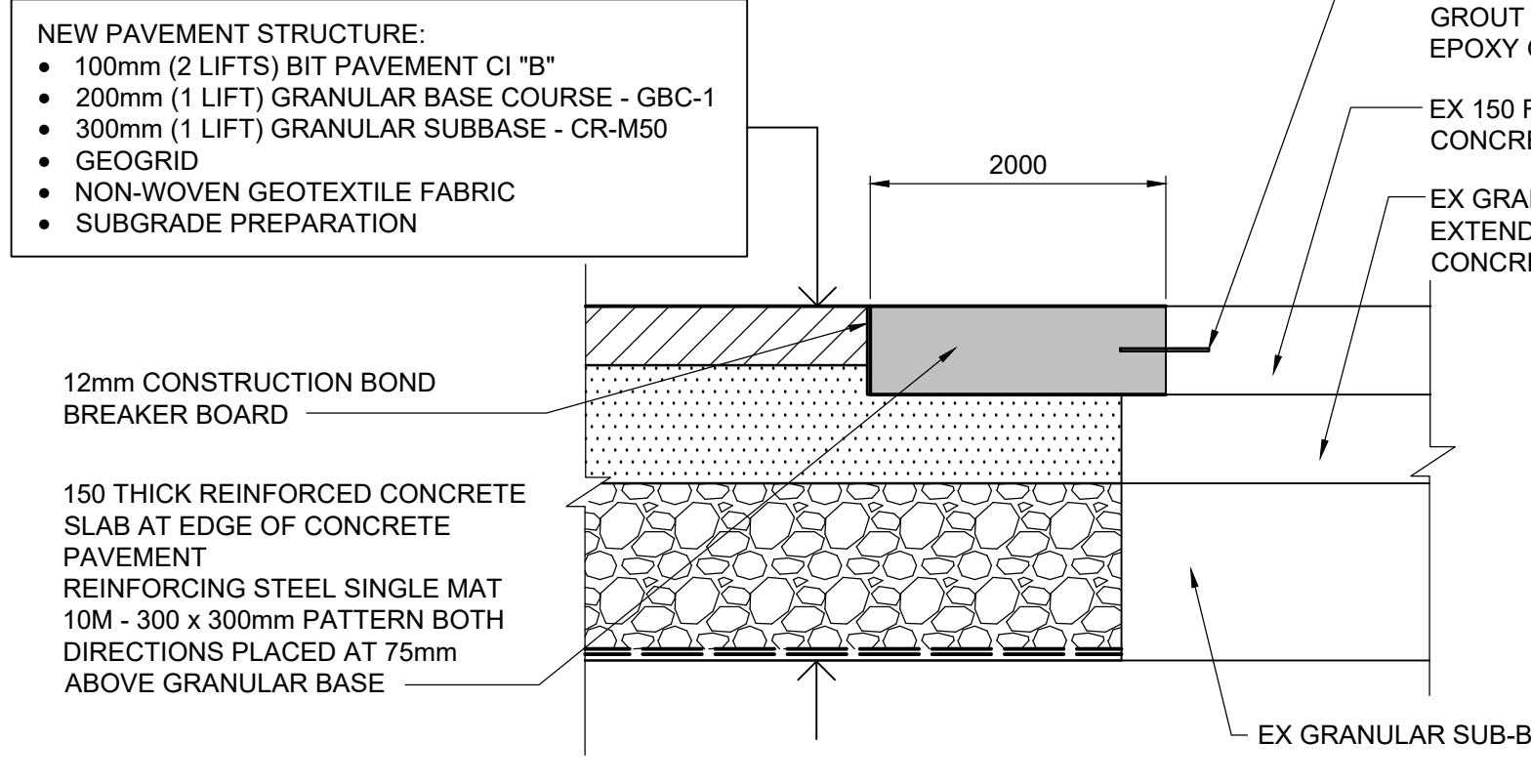
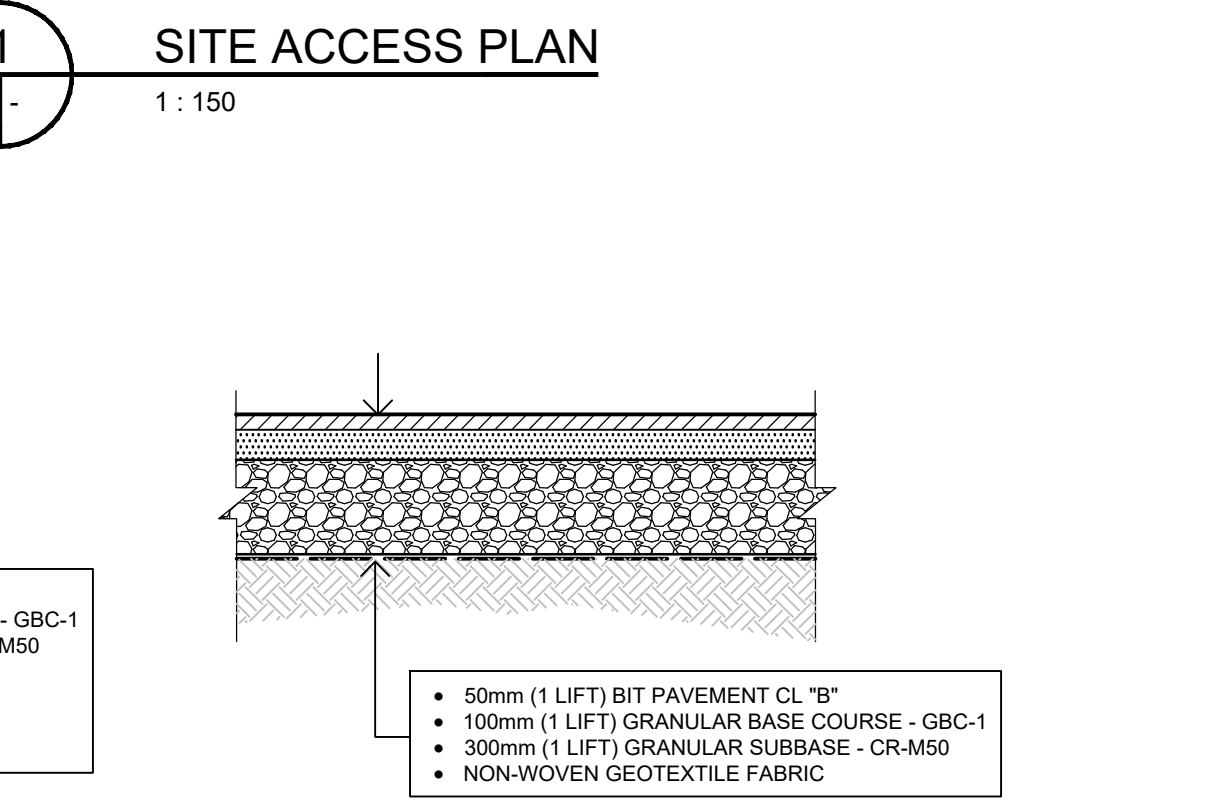
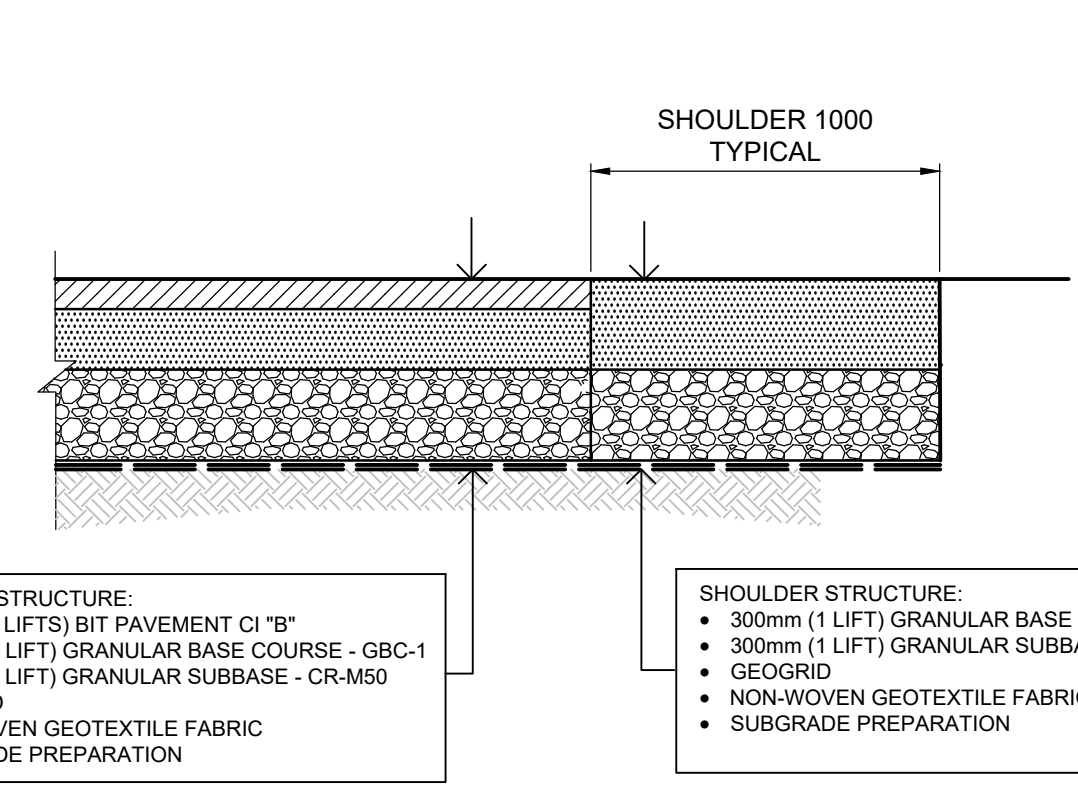

METRIC
WHOLE NUMBERS ARE IN MILLIMETRES
DECIMALIZED NUMBERS ARE IN METRES

DRAWING NO.	DESCRIPTION	NO.	DATE	DESCRIPTION	DRAWN	REVIEWED	ISSUED	APPROVED	
0	ISSUED FOR TENDER		2022.11.30		GMD	DAL	DAL	JW	
REVISIONS/ISSUE					DRAFTING	ENGINEERING			

PERMIT STAMP

SEAL

ORIGINAL DRAWING REVISION 10" SEALED BY J.M. HILDEBRAND 2022.11.30

DESIGNED BY: DAL	DRAWN BY: GMD	REVIEWED BY: MH
APPROVED BY: JW	DATE: 2022-12-22	SCALE: AS NOTED

CLIENT:
Public Works and Government Services

PROJECT NAME:
CANADIAN FOOD INSPECTION AGENCY - EMERSON, MB. NEW VEHICLE ACCESS

DRAWING DESCRIPTION:
NEW WORK - GRADING & PAVEMENT STRUCTURE

PROJECT NO.:	SHEET NO.:	REV.:
	C02	0

D:\22\3\341

3D MODEL REF No:

NOTES GÉNÉRALES SUR LA CLÔTURE ET LES PORTES
 FIL D'ATTACHE GALVANISÉ CALIBRE 9
 ESPACÉ À 400 MM SUR TOUS LES RAILS ET
 POTEAUX EXISTANTS.

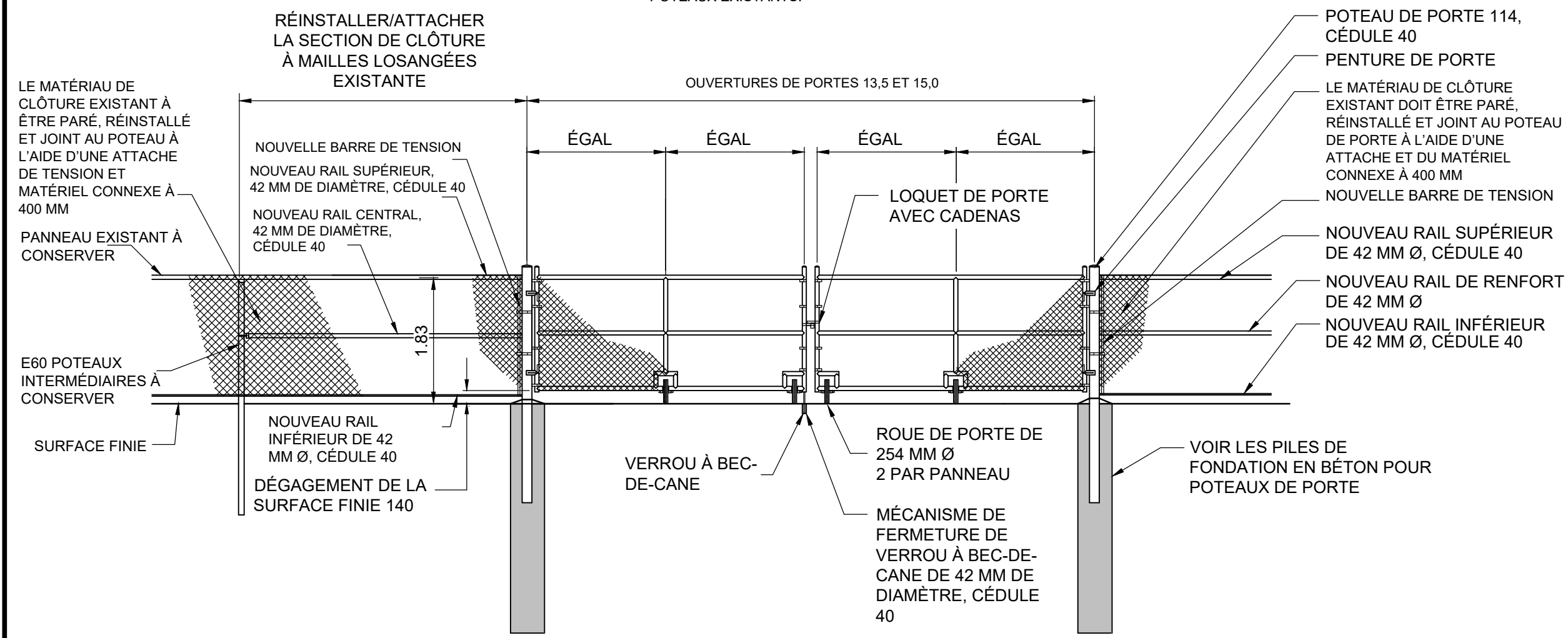

1 NOUVELLES PORTES ET CONNEXION À LA CLÔTURE EXISTANTE 1,83 M
 1 : 50

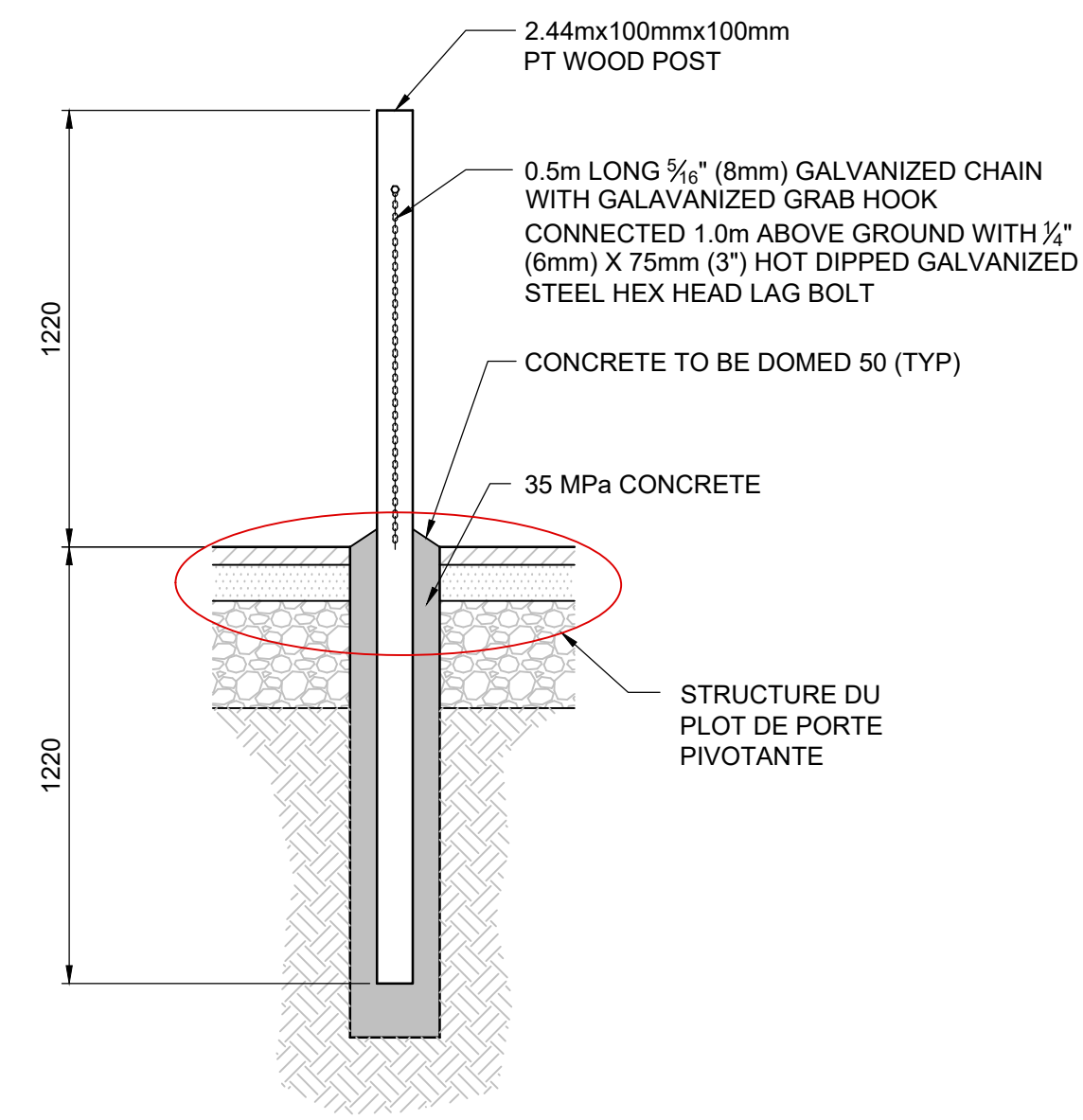

2 DÉTAIL D'INSTALLATION DU POTEAU DE PORTE
 1 : 20

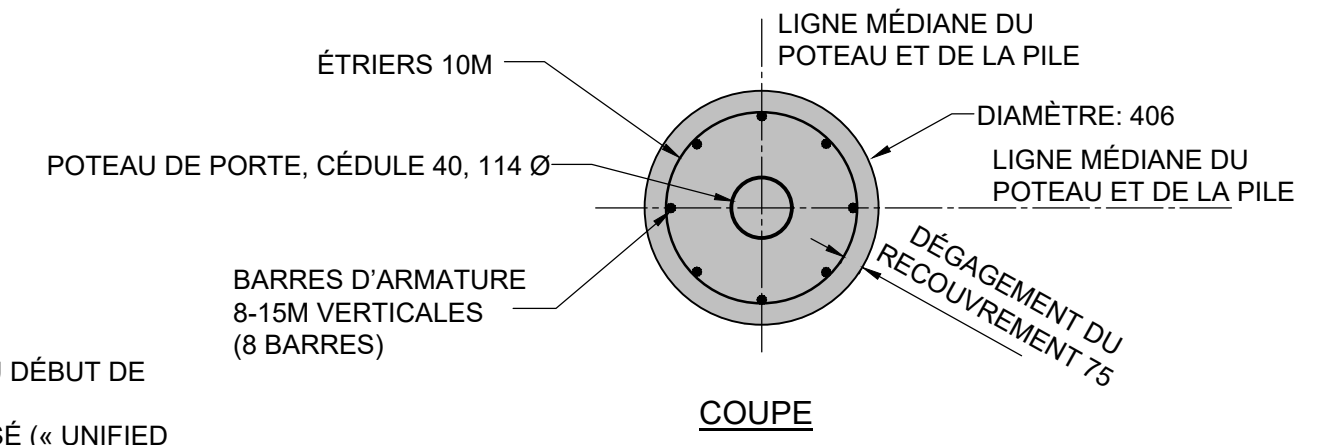
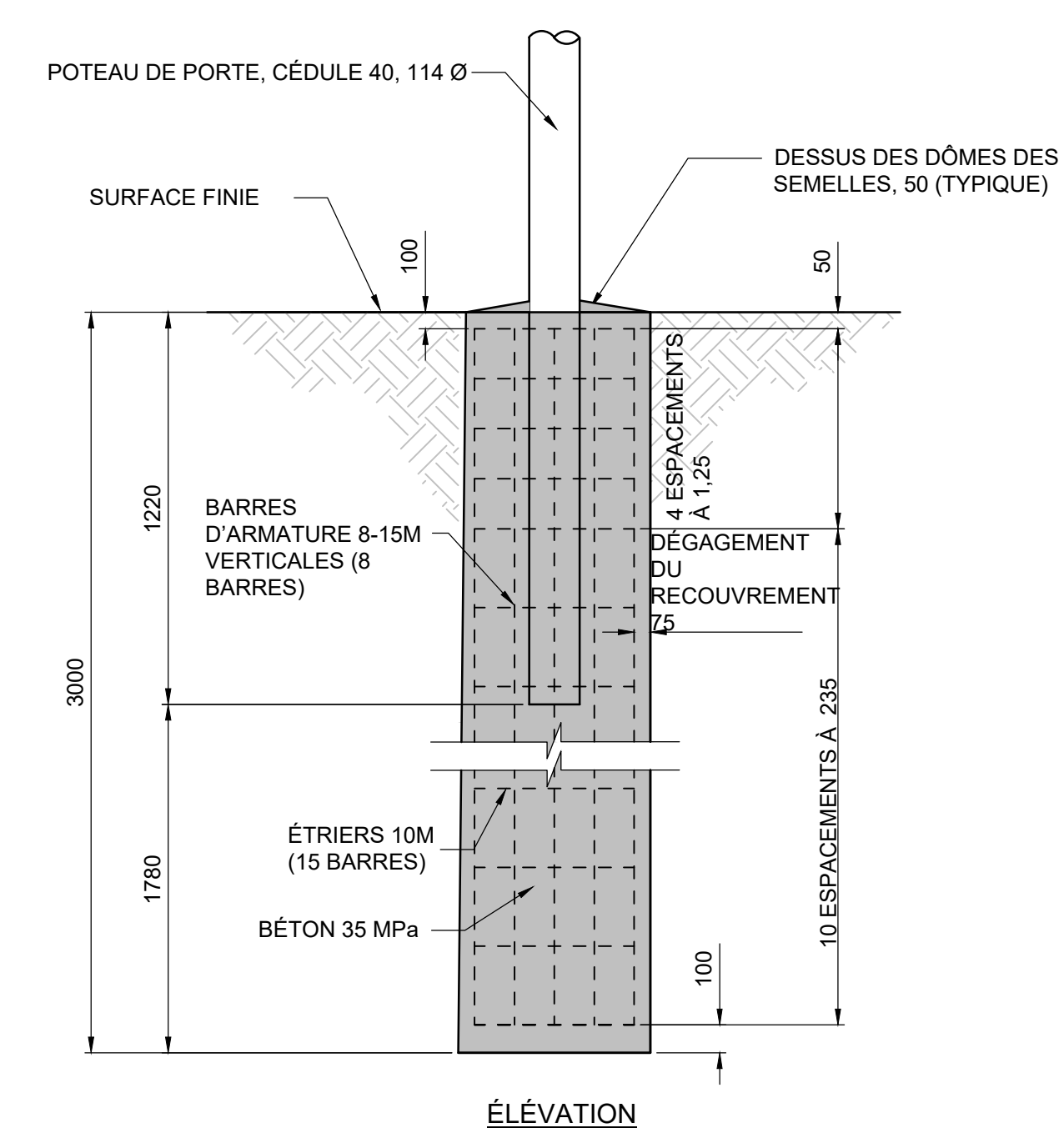

3 PILE DE FONDATION EN BÉTON POUR POTEAU DE PORTE
 NTS

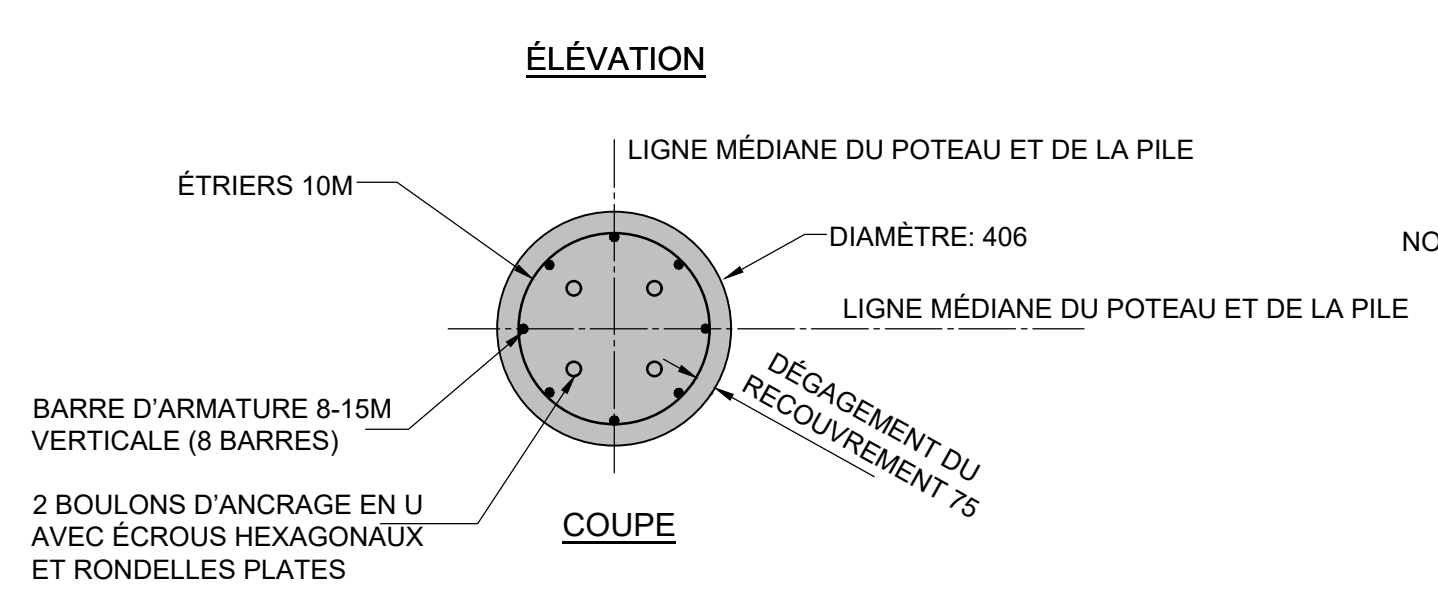
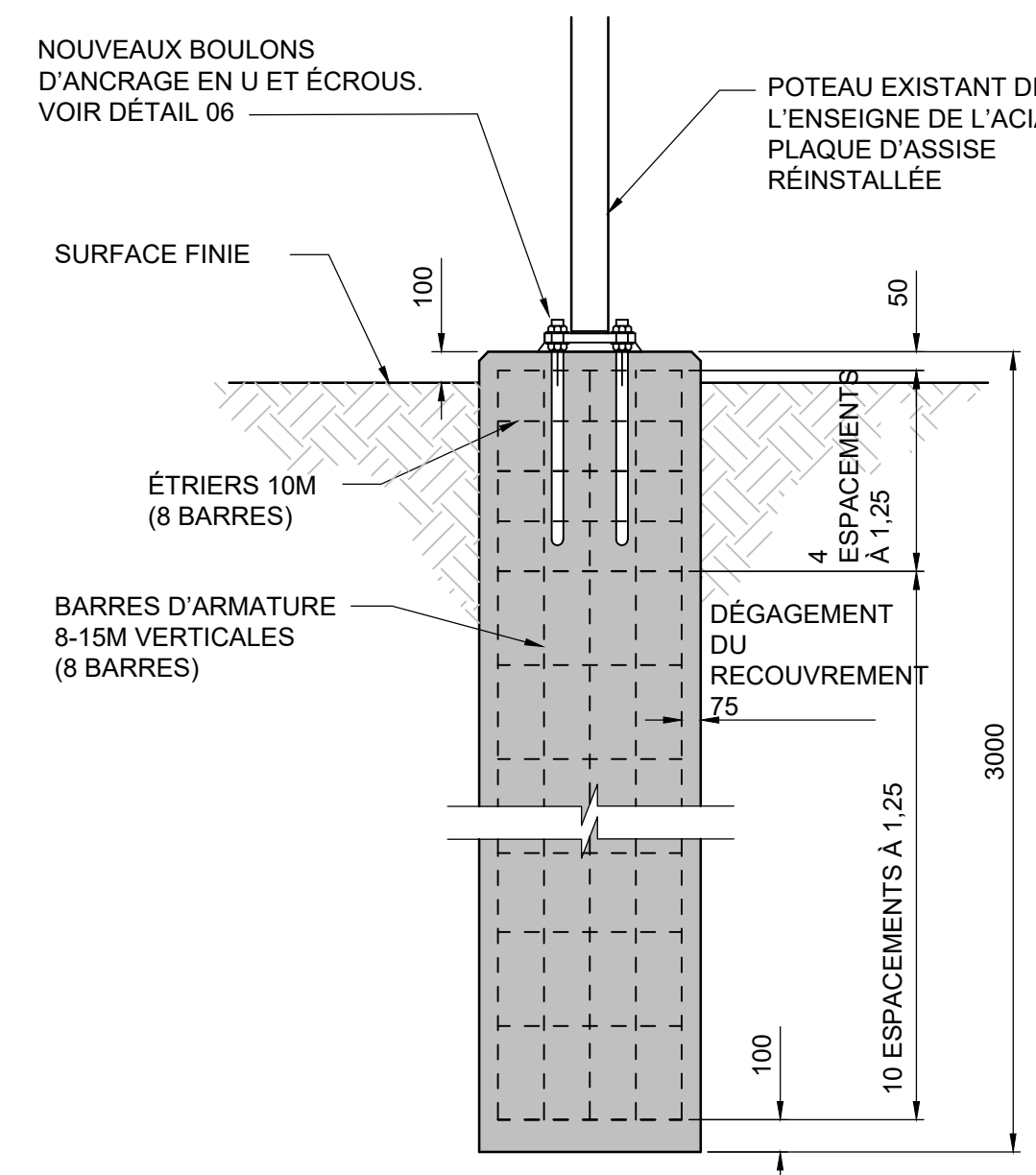

4 PILE DE FONDATION EN BÉTON POUR ENSEIGNE
 NTS

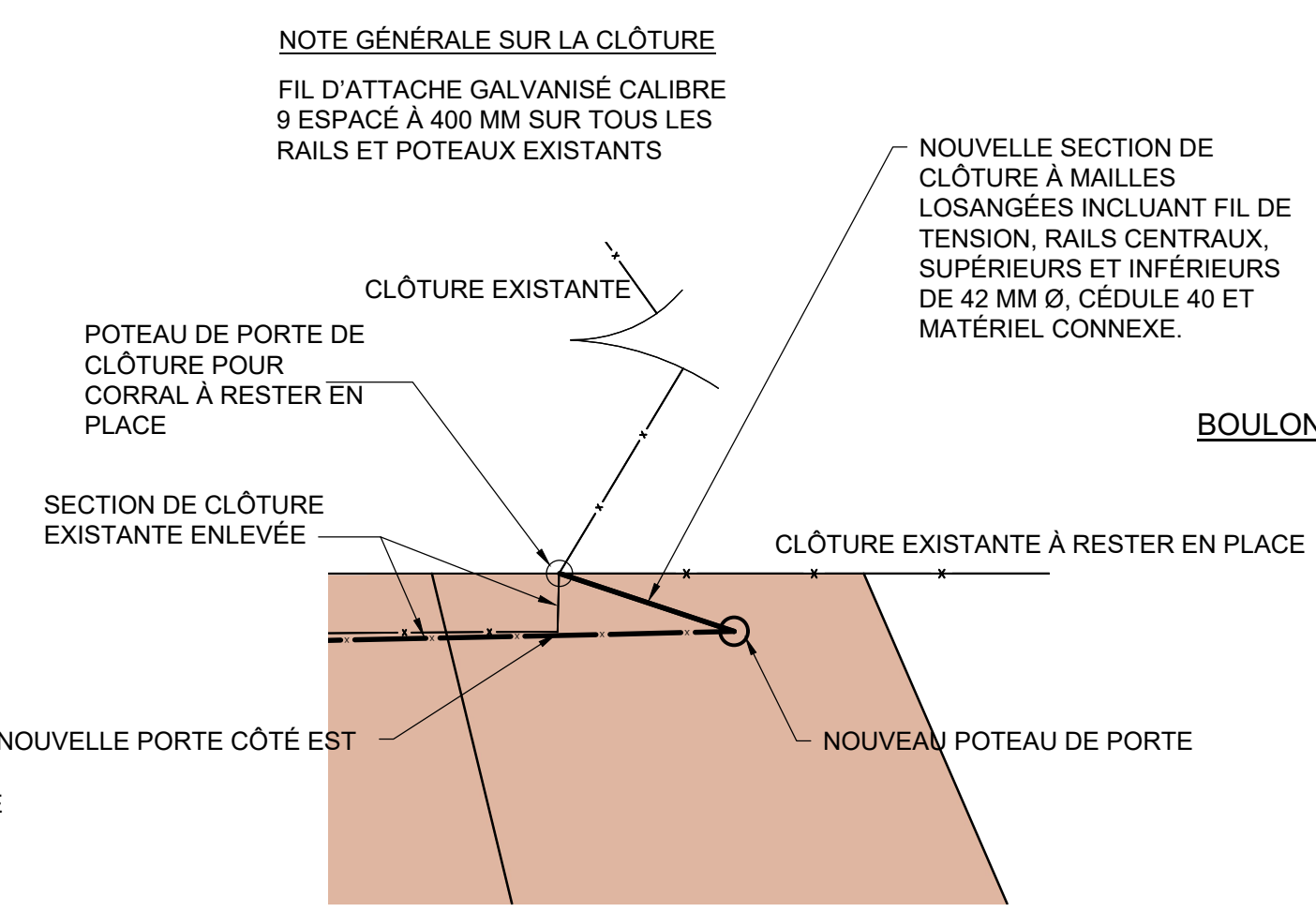

5 CONNEXION DU POTEAU DE CLÔTURE POUR CORRAL AU NOUVEAU POTEAU DE PORTE
 1 : 50

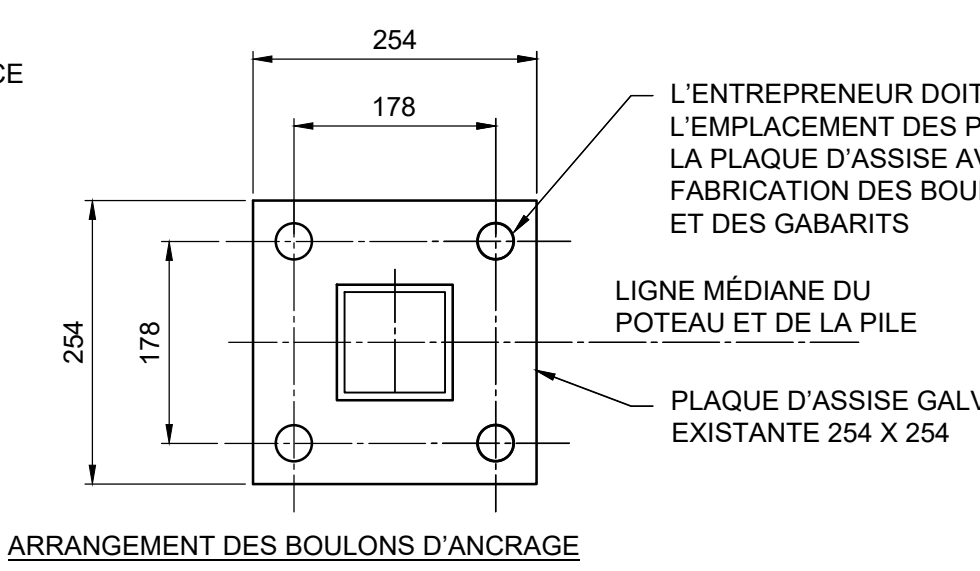
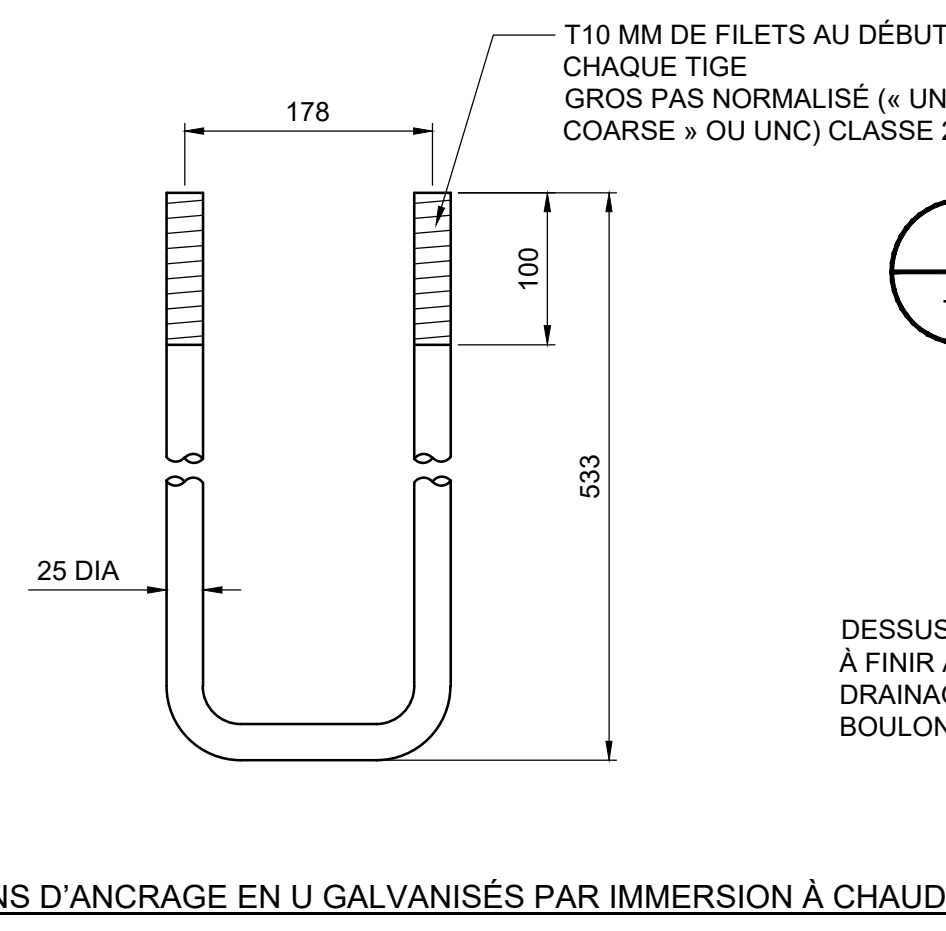

6 ARRANGEMENT DES BOULONS D'ANCRAGE ET DÉTAIL
 NTS

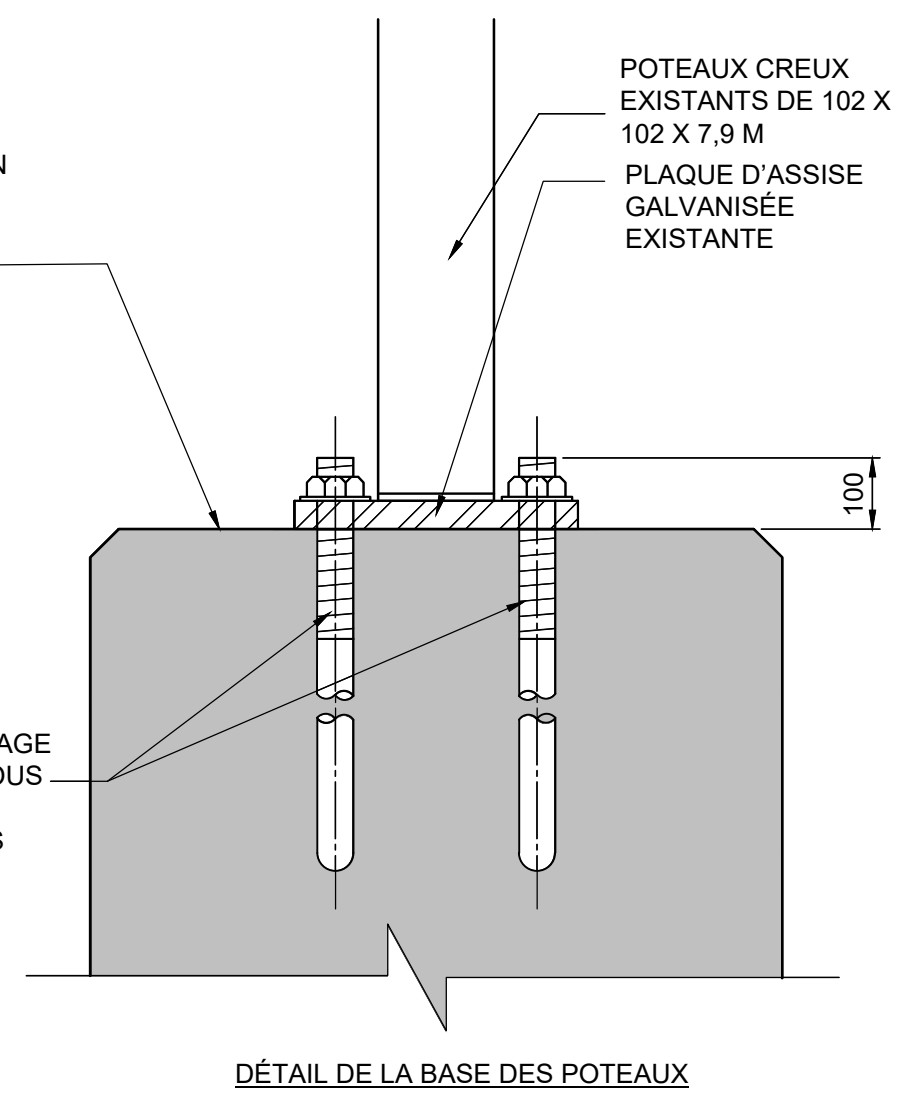

REMARQUES GÉNÉRALES

- UN CODE DES COULEURS S'APPLIQUE À CES DESSINS. ILS DOIVENT ÊTRE VUS ET IMPRIMÉS EN COULEUR.
- LIRE CONJOINTEMENT AVEC LES DEVIS ET LEURS ANNEXES.
- À MOINS D'INDICATIONS CONTRAIRES, TOUS LES MATÉRIAUX À FOURNIR SERONT NEUFS ET INSTALLÉS EN TANT QUE PARTIE INTÉGRANTE DE CE CONTRAT.
- NE PAS DIMENSIONNER À PARTIR DES DESSINS. TOUTES LES DIMENSIONS ET LES QUANTITÉS DOIVENT ÊTRE VÉRIFIÉES SUR PLACE AVANT DE COMMENCER TOUT TRAVAIL. TOUTE RÉCLAMATION POUR COMPENSATION SUPPLÉMENTAIRE DOIT AVOIR ÉTÉ RÉSOUE AVANT LE DÉBUT DE TOUT TRAVAIL.
- À MOINS D'INDICATIONS CONTRAIRES, TOUT LE MATÉRIEL ENLEVÉ ET INDICÉ COMME NE DEVANT PAS ÊTRE RÉINSTALLÉ DOIT ÊTRE TRANSPORTÉ ET DISPOSÉ HORS DU CHANTIER, ET CE, EN CONFORMITÉ AVEC LES RÉGLEMENTS MUNICIPAUX ET PROVINCIAUX. RÉFÉRER AU DEVIS SP.0 EN CE QUI A TRAIT AU PLAN DE GESTION DES DÉCHETS, CAR IL EXISTE UNE EXIGENCE SUR LA REDIRECTION, LE TRI ET LE RECYCLAGE DE TOUS LES DÉCHETS DANS LA MESURE DU POSSIBLE.
- LES ENTREPRENEURS SONT RESPONSABLES DE DEMANDER DES ÉCLAIRCISSEMENTS PENDANT L'APPEL D'OFFRES ET LA CONSTRUCTION.
- LES MESURES D'ATTÉNUATION ENVIRONNEMENTALES DOIVENT ÊTRE MISES EN PLACE EN TOUT TEMPS. RÉFÉRER AU DEVIS SP.2 SUR LA GESTION ENVIRONNEMENTALE POUR LES MESURES D'ATTÉNUATION QUE L'ENTREPRENEUR DOIT METTRE EN PLACE DANS LE CADRE DE CE PROJET.
- RÉFÉRER À LA LISTE DES DOCUMENTS À SOUMETTRE DE L'ANNEXE B DES DEVIS. RÉFÉRER AU DEVIS SP.0 POUR DES DÉTAILS SUR LA SOUMISSION DES DOCUMENTS/ÉCHANTILLONS ET DES ÉCHÉANCIERS. LES DOCUMENTS/ÉCHANTILLONS SOUMIS DOIVENT AVOIR ÉTÉ APPROUVÉS AVANT LE DÉBUT DES TRAVAUX.
- PROTÉGER ET MAINTENIR EN BON ÉTAT TOUS LES ESPACES ADJACENTS AUX ZONES DE TRAVAUX ET TOUTES LES PROPRIÉTÉS AVOISINANTES, INCLUANT LES ROUTES MUNICIPALES.
- NE PAS CIRCULER SUR LES ESPACES DES PROPRIÉTÉS PRIVÉES SITUÉES À L'OUEST OU LES UTILISER.
- IDENTIFIER LES EMPLACEMENTS DES SERVICES PUBLICS AVANT LE DÉBUT DES TRAVAUX. L'ENTREPRENEUR EST RESPONSABLE DE LA COORDINATION ET DES COÛTS.
- FOURNIR LES SERVICES D'UNE TIÈRE PARTIE INDÉPENDANTE POUR L'INSPECTION ET LES ESSAIS COMME SPÉCIFIÉ AU DEVIS SP.0. L'ENTREPRENEUR EST RESPONSABLE DE LA COORDINATION ET DES COÛTS.
- PLANIFIER ET EFFECTUER LES AUTRES OPÉRATIONS DE DÉMOLITION ET D'ENLEVEMENT NÉCESSAIRES POUR FACILITER LA NOUVELLE CONSTRUCTION.
- FOURNIR DES BARRIÈRES AUTOUR DES POINTS D'ACCÈS DE LA ZONE DE CONSTRUCTION, COMME REQUIS, À DES FINS DE SÉCURITÉ.
- RÉFÉRER AU DEVIS SP.0, SECTION 1.3, EN CE QUI A TRAIT AUX RESTRICTIONS EN LIEN AVEC LES TRAVAUX QUI S'APPLIQUENT À CE PROJET.
- FOURNIR DES PANNEAUX D'ENCEINTES TEMPORAIRES D'UNE HAUTEUR D'AU MOINS 2,0 M EN REMPLACEMENT DE LA CLÔTURE EXISTANTE DÉMOLIE PENDANT L'INSTALLATION DE LA NOUVELLE CLÔTURE ET DES PORTES. LES PANNEAUX TEMPORAIRES DOIVENT ÊTRE FIXÉS DANS LE HAUT ET DANS LA BASE ET À LA CLÔTURE EXISTANTE.

MÉTRIQUE
 LES NOMBRES ENTIERS SONT EN MILLIMÈTRES
 LES NOMBRES À VALEURS DÉCIMALES SONT EN MÈTRES

MARQUE DE PERMIS :				SCEAU :				CONÇU PAR :			DESSINÉ PAR :			REVISÉ PAR :			CLIENT :			NOM DU PROJET :		
				Dessin original, révision 0				DAL			GMD			MH			SERVICES PUBLICS ET APPROVISIONNEMENT CANADA			AGENCE CANADIENNE D'INSPECTION DES ALIMENTS EMERSON, MANITOBA. NOUVEL ACCÈS DES VÉHICULES		
				J.S. BETKE 2022.11.30				JW			2023-06-21			COMME INDICÉ						DESCRIPTION DU DESSIN :		
																	NOUVEAUX TRAVAUX DÉTAILS					
DESSIN NO :				NO :				DATE :			ÉCHELLE :			NO DE PROJET :			FEUILLET NO :			REV. :		
DESSIN DE RÉFÉRENCE				RÉVISION/ÉMISSION				DESSIN			INGÉNIEUR			C03			0					