



RETURN BIDS TO:

RETOURNER LES SOUMISSIONS À:

NWR_Procurement_bids@rcmp-grc.gc.ca

STANDARD REQUEST FOR BID

INVITATION À SOUMISSIONNER - STANDARD

The Bidder offers to provide to Canada the goods, services or both listed in the bid solicitation in accordance with the conditions set out in the bid solicitation and the prices set out in the bid.

This bid solicitation is issued in accordance with the conditions of the Supply Arrangement E60PQ-140003/PQ.

Le soumissionnaire offre de fournir au Canada les biens, services ou les deux énumérés dans la demande de soumissions aux conditions prévues dans la demande de soumissions et aux prix indiqués dans la soumission.

Cette demande de soumissions est émise conformément aux conditions de l'arrangement en matière d'approvisionnement E60PQ-140003/PQ.

Solicitation No. - N° de la demande M5000-23-6212/A	Amendment No. - N° de modification
Supplier SA No. - N° de l'AMA de fournisseur : E60PQ-140003/PQ	

Solicitation closes – La demande prend fin : 2023-08-08 at 14.00 CST	File No. - N° de dossier
---	--------------------------

1	No of Page/ N° de page	25
Date of Solicitation – Date de la demande 2023-07-27		
Address inquiries to – Adresser toute demande de renseignement à : Shailesh Rajgor at shaileshkumar.rajgor@rcmp-grc.gc.ca		
Destination RCMP F Division Kindersley Detachment. 610 – 9th Avenue, W. Kindersley, SK. S0L 0S0		
<p>Instructions:</p> <p>Municipal taxes are not applicable.</p> <p>Unless otherwise specified in the bid solicitation, all prices quoted must be net prices in Canadian funds including Canadian customs duties, excise taxes, must be FOB, including all delivery charges to destination(s) as indicated. The amount for Applicable Taxes is to be shown as a separate item.</p> <p>Instructions:</p> <p>Les taxes municipales ne s'appliquent pas.</p> <p>Sauf indication contraire dans la demande de soumissions, tous les prix indiqués doivent être des prix nets, en dollars canadiens, comprenant les droits de douane canadiens, la taxe d'accise et doivent être FAB, y compris tous frais de livraison à la (aux) destination(s) indiqué(s). Le montant des taxes applicables doit apparaître séparément.</p>		
Supplier Name and Address – Nom et adresse du fournisseur		
Telephone No. - N° de téléphone		
Facsimile No. - N° de télécopieur		
Name and title of person authorized to sign on behalf of supplier (type or print)		
Nom et titre de la personne autorisée à signer au nom du fournisseur (caractère d'impression)		
Signature : _____ Date : _____		



Section 1 – Invitation and Instructions to Bidders
Section 2 – Resulting Contract including a list of required goods and services

SECTION 1 – INVITATION AND INSTRUCTIONS TO BIDDERS

Step 1. For Tier 2 and Tier 3 only

Is this a Manufacturer Product Specific Procurement? No.

Step 2. Competitive or Non-Competitive

A bid must comply with the requirements of the bid solicitation and meet all mandatory technical evaluation criteria to be declared responsive. The responsive bid with the lowest evaluated price will be recommended for award of a contract.

Canada will assess bids and award contracts on a per category basis. For administrative purposes, in the event a same bidder wins more than one category, Canada may issue a single contract containing the categories won by the same bidder.

For Competitive Requirements when only one bid is received:

The Bidder must provide the following information AFTER bid closing, if requested to do so by Canada:

- One or more of the following price justifications:
 1. a current published price list indicating the percentage discount available to Canada; or
 2. a copy of paid invoices for the like quality and quantity of the goods, services or both sold to other customers; or
 3. a price breakdown showing the cost of direct labour, direct materials, purchased items, engineering and plant overheads, general and administrative overhead, transportation, etc., and profit; or
 4. any other supporting documentation as requested by Canada.

Step 3. General or PSIB



Terms of the RFB:

This RFB is issued pursuant to the Supplier's Furniture for Workspaces Supply Arrangement (SA) that forms part of the series of SAs issued by PWGSC with the number E60PQ-140003/PQ. The terms and conditions in the Supplier's SA apply to and form part of this RFB. Bidders who submit a bid agree to be bound by those terms and conditions as well as the terms and conditions in this RFB.

The WTCM is the Workspaces Terms and Conditions Manual that contains all terms and conditions in full text that form part of individual RFBs under this SA.

The Bidder must provide the following information WITH the bid:

- The information requested by Canada in Annex A herein.

The Bidder must also provide the information at article 4 below at the time indicated in article 3.

Security Requirement:

There is no security requirement associated with this requisition.

Bid Evaluation

An evaluation team composed of representatives of Canada will evaluate the bids.



RFB Issued by:	
Identified User's (IU) Department/Agency/Crown Corporation: Contact for this RFB:	See Section 2, article 4.1 below.
RFB Closing - Submit Bid: Bids must be submitted on the date and at the time indicated below.	
By no later than date and time:	2023-08-08 at 14.00 CST.
To e-mail address:	nwr_procurement_bids@rcmp-grc.gc.ca
RFB Enquiries:	
Unless a different period is listed in the adjacent column, Bidders may submit enquires about the RFB to the Contracting Authority two business days prior to the RFB closing date. Enquiries received after the timeline indicated may not be answered.	3 (Three) business days



SECTION 2 - RESULTING CONTRACT CLAUSES

1.	Terms and Conditions of the Contract	
	The terms and conditions of Parts 6B and 6C of the Supplier's SA within the series E60PQ-140003/PQ apply to and form part of this Contract.	
2.	Security Requirement (the checked article applies)	
2.1	The applicable security requirement(s) is (are) set out in the Security Requirement Check List attached as Annex B of this contract. The Contractor must fulfill the security requirements by meeting the terms below.	
a.	<input type="checkbox"/>	Contractor may be escorted; possession of security clearance not required. Contractor personnel MAY NOT ENTER NOR PERFORM WORK ON sites where PROTECTED or CLASSIFIED information or assets are kept, without an escort provided by the department or agency for which the work is being performed.
b.	<input type="checkbox"/>	Possession of security clearance(s) is required. The Contractor must meet the security clearance requirements contained in the clausing in Annex B herein.
c.	<input checked="" type="checkbox"/>	There is no security requirement associated with this contract.
3.	Requirement	
3.1	The Contractor must perform the Work listed in Annex A herein.	
4.	Authorities	
4.1	Contracting Authority (IU)	
	Name:	Shailesh Rajgor
	Title:	Procurement Officer
	Department/Agency/Crown Corporation:	RCMP Procurement and Contracting Services.
	Address:	10065 – Jasper Avenue, Edmonton, Alberta T5J 3B1
	Telephone No.:	780-670-8554
	E-mail address:	Shaileshkumar.rajgor@rcmp-grc.gc.ca
4.2	Project Authority [To be completed at contract award] <i>The Project Authority (PA) is the representative of the department or agency for whom the Work is being carried out under the Contract including the provision to approve the authority to proceed for delivery and installation and is responsible for all matters concerning the technical content of the Work under the Contract.</i> <i>In addition, the PA is also responsible for ensuring that the Supplier's employees and subcontractors requiring access to the site adhere to the allocated time for the Supplier to access the site to deliver and install the furniture in accordance with the master schedule held by the General Contractor (a representative of Canada or a service provider(s) under contract with the Government of Canada).</i>	
	Name:	
	Title:	
	Department/Agency/Crown Corporation:	
	Address:	
	Telephone No.:	
	E-mail address:	
4.3	Contractor's Representative	
	As set out in Annex A, Table 9 below.	



5.	Method of Payment	
	The checked box applies. If the Contractor's SA indicates acceptance for payment by credit card, that method may be used in conjunction with the following.	
	<input checked="" type="checkbox"/>	Single Payment
	<input type="checkbox"/>	Multiple Payment
6.	Invoicing	
	Further to the Invoicing terms of the WTCM document, the Contractor will deliver the original and one copy of the invoice to the following address for certification and payment:	
	Name of the organization and contact: <i>[To be completed at contract award]</i>	
	Address:	
7.	SACC Manual Clauses	
	A3002T (2022-05-12) Set –aside under the PSIB.	
	A3002C (2022-05-12) Indigenous business certification	
	B7500C (2006-06-16), Excess Goods	
	B4003T (2011-05-16), Canadian General Standards Board – Standards , B1501C (2018-06-21) Electrical Equipment.	
Supplemental General Conditions:		
4013 (2022-06-20) Compliance with on-site measures, standing orders, policies, and rules apply to and form part of the Contract.		
4014 (2022-06-20) Suspension of the work apply to and form part of the Contract		



**ANNEX A
REQUIREMENT and BASIS OF PAYMENT**

The requirement includes the following categories of work

a. Category 1 – Interconnecting Panels and Freestanding Systems

Category 1a – Interconnecting Panels (Refer to Annex C)

Category 1b – Supporting components and freestanding furniture

RULE: Metal Storage

Identified Users may procure metal storage products forming part of Category 1 when the metal storage products will be part of a requirement for a workstation(s)/work point(s). If this rule does not apply, Category 3 must be used for the metal storage products forming part of this category.

b. Category 2 – Freestanding Height Adjustable Desk / Table Products

c. Category 3 – Metal Filing and Storage Cabinets

Identifying the maximum height of the Personal Storage Towers, Wardrobes and Storage Cabinets is acceptable as per 6B. 4.1 of the SA (table 1 Additional product details)

d. Category 4 – Wood Veneer – Freestanding Products

e. Category 5 – Ancillary and Lighting Products

f. Category 6 - Support Space – Collaborative Furniture

RULE: Category 6 can be further subdivided by space or like product in order to increase or allow competition. Space is defined as a location available for a particular purpose such as a meeting room space or a collaborative space. Like products are defined as products with similar design and construction. If NSA products form part of the requirement, the IU must validate the 30% NSA prior to subdividing the category. NSA products can be added to any subdivide or in its own subdivide.

The IU must identify how Category 6 will be subdivided in the Product Table for Category

g. 6. NSA Product(s) – Categories : **1, 3, & 6**

2. Product and Pricing Tables

Site Inspection Date: To be coordinated with Project Authority after contract award. (Refer to Annex A article 4 of the SA for Site Inspection and Documentation instructions.)

INSTRUCTIONS TO BIDDERS: Bidders are to complete Sections B of the tables identified by the IU in this article as well as Tables 8 and 9. **Bidders must provide a complete product offering for each category, or CAT 6 sub-divide they wish to submit a bid in order to be compliant.**

Refer to article 6A.7 for instructions on how to submit products that are not approved in product listing.

In a resulting contract, the term “Bid” means the Supplier’s commitment, the term “Bidder” means “Contractor”.



Table 1 – Product Table

Section A - IU REQUIREMENT				Section B – SUPPLIER’S BID			
#	GoCUID	Description of Product <i>(Additional product details may be inserted, if required as per 6B. 4.1 of the SA)</i>	QTY	** Provide additional Information Yes/No	Supplier Part Number	Firm Unit Price \$	Extended Total [Qty x Price] \$
CATEGORY – 1A (Refer Annex - C for furniture plan)							
1	Base Height,	No Powered, Fabric,Fabric, Width – 610 mm (24 in / po)	08	Yes		\$	\$
2	Base Height	Powered Outlet(s), below worksurface, Cut out(s) for power and data, Fabric, Fabric, Width – 610 mm (24 in / po)	23	Yes		\$	\$
3	Base Height,	Non- Powered, Fabric, Fabric, Width-762 mm (30 in / po)	22	Yes		\$	\$
4	Base Height	Powered Outlet(s), below work surface, cut out(s) for power & data, Fabric, Fabric, Width-762 mm (30 in / po)	29	Yes		\$	\$
5	Base Height	Non- Powered, Fabric, Fabric, Width – 914 mm (36 in /po)	05	Yes		\$	\$
6	Base Height	Powered Outlet(s), below work surface, Cut out(s) for power & data, Fabric, Fabric, Width – 914 mm (36 in /po)	12	Yes		\$	\$
7	Seated Privacy Height Add on	Non- Powered, Fabric, Fabric, Tackable Surface, Fabric, 610 mm (24 in / po)	01	Yes		\$	\$
8	Seated Privacy Height Add on	Non- Powered, Fabric, Fabric, Tackable Surface, 762 mm (30 in / po)	03	Yes		\$	\$
**Provide additional information: Canada is requesting bidders: to provide drawings and/or pictures including descriptive literature for these products with your bid submission.							
Subtotal for Category – 1A							



Category – 1B							
Section A - IU REQUIREMENT				Section B – SUPPLIER’S BID			
#	GoCUID	Description of Product <i>(Additional product details may be inserted, if required as per 6B. 4.1 of the SA)</i>	QTY	** Provide additional Information Yes/No	Supplier Part Number	Firm Unit Price \$	Extended Total [Qty x Price] \$
1	1bFFHREN24L30W NOLNY	Free Standing Systems, Fixed Height Work Surfaces (Laminate), Rectangular, Panel Mounted, 24-30-29, Grommets	02	Yes		\$	\$
2	1bFFHREN24L36W NOLNY	Free Standing Systems, Fixed Height Work Surfaces (Laminate), Rectangular, Panel Mounted, 24-36-29, Grommets,	06	Yes		\$	\$
3	1bFFHREN24L54W NOLNY	Free Standing Systems, Fixed Height Work Surfaces (Laminate), Rectangular, Panel Mounted, 24-54-29, Grommets,	09	Yes		\$	\$
4	1bFFHREN24L60W NOLNY	Free Standing Systems, Fixed Height Work Surfaces (Laminate), Rectangular, Panel Mounted, 24-60-29, Grommets,	05	Yes		\$	\$
5	1bFFHREN30L66W NOLNY	Free Standing Systems, Fixed Height Work Surfaces (Laminate), Rectangular, Panel Mounted, 30-66-29, Grommets,	02	Yes		\$	\$
**Provide additional information: Canada is requesting bidders: to provide drawings and/or pictures including descriptive literature for these products with your bid submission.							
Subtotal for Category 1B							



Category – 2							
Section A - IU REQUIREMENT				Section B – SUPPLIER’S BID			
#	GoCUID	Description of Product <i>(Additional product details may be inserted, if required as per 6B. 4.1 of the SA)</i>	QTY	** Provide additional Information Yes/No	Supplier Part Number	Firm Unit Price \$	Extended Total [Qty x Price] \$
1	2WSSREXXL30L54 BELXX	Individual Height Adjustable Work Surfaces, sit stand, rectangular, laminate, 30-54- 23 to 48.7, electric,	07	Yes		\$	\$
2	2WSSREXXL30L66 BELXX	Individual Height Adjustable Work Surfaces, sit stand, rectangular, laminate, 30-66- 23 to 48.7, electric,	09	Yes		\$	\$
3	2WSSREXXL30L72 BELXX	Individual Height Adjustable Work Surfaces, sit stand, rectangular, laminate, 30-72- 23 to 48.7, electric,	01	Yes		\$	\$
**Provide additional information: Canada is requesting bidders: to provide drawings and/or pictures including descriptive literature for these products with your bid submission.							
Subtotal for Category 2							



Category – 3							
Section A - IU REQUIREMENT				Section B – SUPPLIER’S BID			
#	GoCUID	Description of Product <i>(Additional product details may be inserted, if required as per 6B. 4.1 of the SA)</i>	QTY	** Provide additional Information Yes/No	Supplier Part Number	Firm Unit Price \$	Extended Total [Qty x Price] \$
1	3FLT3DXXPM36D1 8XXXX	Filing Cabinet, Lateral, 3 Drawers, Painted Metal, 36-18, keyed	13	Yes		\$	\$
2	3FLT4DXXPM36D1 8XXXX	Filing Cabinet, Lateral, 4 Drawers, Painted Metal, 36-18, keyed	01	Yes		\$	\$
3	3PMOBFXXPM15D2 4XXYK	Pedestals, Mobile, box/file, painted, 15-24, upholstered cushion seat, keyed	17	Yes		\$	\$
4	3PMOBBXXPM15D2 4XXXX	Pedestals, Mobile, box/box /file, painted, 15-24, keyed	02	Yes		\$	\$
**Provide additional information: Canada is requesting bidders: to provide drawings and/or pictures including descriptive literature for these products with your bid submission.							
Subtotal for Category 3							



Category – 4							
Section A - IU REQUIREMENT				Section B – SUPPLIER’S BID			
#	GoCUID	Description of Product <i>(Additional product details may be inserted, if required as per 6B. 4.1 of the SA)</i>	QTY	** Provide additional Information Yes/No	Supplier Part Number	Firm Unit Price \$	Extended Total [Qty x Price] \$
1	4FSFHREWGWW24 L66WY	Free Standing Products, Fixed Height Work Surfaces, Rectangular, 1 work Surface Support, 1 Full Gable, Wood Veneer, modesty panels – wood veneer, 24-66-29, Grommets	01	Yes		\$	\$
2	4FSFHDTFGWVW36 L72WY	Free Standing Products, Fixed Height work surfaces, D-Top, 2 full Gables, Wood Veneer, modesty panels – wood veneer, 36-72-29, Grommets,	01	Yes		\$	\$
3	4FSBBFLGWV1524 29NKX	Filing and Storage, Pedestals, box/box/file, freestanding, leveling glides, wood veneer, 15-24-29, keyed.	01	Yes		\$	\$
**Provide additional information: Canada is requesting bidders: to provide drawings and/or pictures including descriptive literature for these products with your bid submission.							
Subtotal for Category 4							



Category – 5							
Section A - IU REQUIREMENT				Section B – SUPPLIER’S BID			
#	GoCUID	Description of Product <i>(Additional product details may be inserted, if required as per 6B. 4.1 of the SA)</i>	QTY	** Provide additional Information Yes/No	Supplier Part Number	Firm Unit Price \$	Extended Total [Qty x Price] \$
1	5KMSWGPSUF30WS XXXXX	Keyboards and Mouse Support Surfaces, with Gel Palm Support, for 30” work surface	12	Yes		\$	\$
2	5CPSUNWKSXXXXX XXXXX	Computer Processor Unit Support, under work surface mounted.	17	Yes		\$	\$
3	5MOADUARMCLPMT XXXXX	Monitor Arms, Dual Arm, clamp mount.	20	Yes		\$	\$
**Provide additional information: Canada is requesting bidders: to provide drawings and/or pictures including descriptive literature for these products with your bid submission.							
Subtotal for Category 5							



Category – 6							
Section A - IU REQUIREMENT				Section B – SUPPLIER’S BID			
#	GoCUID	Description of Product <i>(Additional product details may be inserted, if required as per 6B. 4.1 of the SA)</i>	QTY	** Provide additional Information Yes/No	Supplier Part Number	Firm Unit Price \$	Extended Total [Qty x Price] \$
1	6MMTMDREOL36L7 2WYNX	Meeting and Training Room Tables. Medium, Rectangular, Post-Legs-Column, Laminate, 36-72-29 , Power/Data.	02	Yes		\$	\$
2	6MMTLGREOL4812 0WYNX	Meeting and Training Room Tables, Medium, Rectangular, Post-Legs-Column, Laminate, 48-120-29, Power / data.	01	Yes		\$	\$
3	6KKCSAxxLY16XX XMIYX	Kitchenette Seating, Kitchenette Chairs, Standard Height, 4 legs, Polymer, Seat depth >16, Height – 17 to 20 with Armrest, cushions seat.	04	Yes		\$	\$
4	6KKCSAxxLY16XX XMINX	Kitchenette Seating, Kitchenette Chairs, Standard Height, 4 legs, Polymer, Seat depth >16, Height – 17 to 20 with Armrest.	06	Yes		\$	\$
**Provide additional information: Canada is requesting bidders: to provide drawings and/or pictures including descriptive literature for these products with your bid submission.							
Subtotal for Category 6							
Grand total of All categories (Category – 1A, 1B, 2, 3,4 5 plus 6)							



NSA products (Refer Annex C the furniture plan for Non-SA items)						
The Supplier signs, and certifies that all the NSA products offered will conform to all specifications and meet the testing requirements detailed at Annex D.						
Section A - IU REQUIREMENT			Section B – SUPPLIER'S BID			
#	NON-SA Product(s)	QTY	** Provide additional Information Yes/No	Supplier Part Number	Firm Unit Price \$	Extended Total [Qty x Price] \$
1	Worksurface, 24 x 24 (Category – 6)	01	Yes		\$	\$
2	Table 4 Post Leg, 36" x 42 " for Room # 119 (Category – 6)	01	Yes		\$	\$
3	1 open Shelf / 1 Drawer High lateral, under worksurface, 30" W for Room # 110 and Room 114 (Category – 3)	09	Yes		\$	\$
4	Panel Mounted work surface Support (Plan view and Isometric) for Room # 110 and Room # 114 ** Support Depth is to match work surface depth it is supporting. (Category-1A)	08	Yes		\$	\$
5	Frameless Glass Topper Panels, 12" High x 30" Wide for Room # 114 (Category -1A)	01	Yes		\$	\$
6	Frameless Glass Topper Panels, 12" High x 54" Wide for Room # 114 (Category-1A)	01	Yes		\$	\$
7	Frameless Glass Topper Panels, 12" High x 60" Wide for Room # 114. (Category-1A)	01	Yes		\$	\$
8	Frameless Glass Topper Panels, 12" High x 78" Wide for Room # 114. (Category-1A)	01	Yes		\$	\$



9	Frameless Glass Topper Panels, 12'' High x 90'' Wide for Room # 114. (Category-1A)	01	Yes		\$	\$
**Provide additional information: Canada is requesting bidders: to provide drawings and/or pictures including descriptive literature for these products with your bid submission.				NSA products Total		

Table 2 – Delivery

Section A - IU REQUIREMENT				Section B – SUPPLIER'S BID	
Product Item # from Table 1	Location	Desired Date** (YYYY-MM-DD)	Desired Time: Normal Business Hours Or Outside Normal Business Hours *	Supplier will supply and deliver as per below**	Firm Lot Price \$
1	RCMP F Division Kindersley Detachment 610 – 9 th Avenue, Kindersley, SK. SOL 050	2023-12-15	Normal Business Hours.	_____ : weeks <i>Standard Lead time is between 6-10 weeks for furniture delivery and installation.</i>	\$
*Normal Business Hours 8:00 – 17:00, as per SA, Annex A, article 5 **The Project Authority (PA) will provide the supplier the authority to proceed prior to the finalized delivery date taking into consideration the delivery time provided by the supplier. Canada will not be responsible if the supplier chooses to proceed without the PA authorization.				Delivery Total:	\$



Table 3 – Installation

Section A - IU REQUIREMENT				Section B – SUPPLIER'S BID	
Product Item # from Table 1	Location	Desired Date** (YYYY-MM-DD)	Desired Time: Normal Business Hours Or Outside Normal Business Hours *	Supplier will install as per below**	Firm Lot Price \$
1	RCMP F Division Kindersley Detachment 610 – 9 th Avenue, Kindersley, SK. SOL OSO	2024-01-15	Normal Business Hours	_____ : weeks from date of supply and delivery <i>Standard Lead time is between 6-10 weeks for furniture delivery and installation.</i>	\$
<p>*Normal Business Hours 8:00 – 17:00, as per SA, Annex A, article 5</p> <p>**The Project Authority (PA) will provide the supplier the authority to proceed prior to the finalized installation date taking into consideration the installation time provided by the supplier. Canada will not be responsible if the supplier chooses to proceed without the PA authorization.</p>				Installation Total:	\$

Table 4 – Optional Product

Not Applicable

Table 5 – Optional Delivery

Not Applicable

Table 6 – Optional Installation

Not Applicable



Table 7 – Standard Finishes and Canada’s Facilities to Accommodate the Delivery and Certifications

1.	Standard Finishes	
1.1	<p>IU is to consult the Supplier’s Website identified in Part 6A of the SA to view the available finishes.</p> <p>Within ten business days of the contract award, the Project Authority will provide the Contractor with a written notice of Canada’s finish choices for each of the product(s) in Annex A.</p> <p>The Contractor will deliver the products corresponding to Canada’s choice of specific finishes(s). No additional charge will be applied to Canada.</p>	
2.	Canada’s Facilities to Accommodate the Delivery	
	<p><i>The Supplier’s employees and subcontractors requiring access to the site must adhere to the health and safety plans established for the site, in addition to any laws in effect in the jurisdiction where the work is being performed.</i></p> <p><i>During the period of the contract, a representative of Canada or a service provider(s) under contract with the Government of Canada may request the list of employees and subcontractors requiring access to the site to perform the work and their security statuses. Information must be provided in the timeframe prescribed in order to ensure that the supply, delivery and installation of the furniture aligns with the master schedule.</i></p>	
2.1	Loading Dock/Location	
A	Location	RCMP F Div. Kindersley Detachment, 610 – 9th Avenue W. Kindersley, SK.
B	Dock	N/A
C	Lift	Not available
D	Door	36” x 84”
E	Freight Elevator	Not Available
F	Other (specify, if any)	
3.	Continuance of Certifications	
	<p>The Bidder certifies that by submitting a bid in response to the RFB, the Bidder, and any of the Bidder’s members if the Bidder is a Joint Venture, continues to comply with all of the following certifications listed in Parts 6A and 6B of the Bidder’s SA for Work Spaces.</p> <p>Canada may request copies of environmental certification(s) prior to contract award within a time period specified by the Identified User.</p>	
3.1	Integrity Provisions	
3.2	Federal Contractor’s Program for Employment Equity	
3.4	Product Conformance	
3.5	Price Certification (In accordance with the SA, Part 6B)	



Table 8 - Bid Evaluation and Contract Total

(Canada may complete if not completed by the Bidder)

1	Firm Product Total (Table 1)	\$
2	Firm Delivery Total (Table 2)	\$
3	Firm Installation Total (Table 3)	\$
4	Total Evaluated (Bid) Price* (1+2+3)	\$
5	Contract Price(1 + 2 + 3)	\$
6	Applicable Tax(es): <i>[applicable at contract award only]</i>	\$
7	Total Estimated cost.	\$

* Applicable taxes extra.

Table 9 – Bidder’s Authorized Representative

1.	Bidder’s Authorized Representative for the Bid and the Contract	
	Name:	Telephone:
		E-Mail:
		PBN:
	Ariba #:	



Royal Canadian Mounted Police
Gendarmerie royale du Canada

Solicitation # M5000-23-6212/A

**ANNEX B
SECURITY REQUIREMENTS**

There is no security requirement associated with this bid and requirements.



**ANNEX C
Furniture Plan.**

INSTRUCTIONS TO BIDDERS:

For Category 1a products, the Bidders must provide:

- a) *Completed floor plan(s) with proposed SA approved products;*
- b) *A product listing of proposed SA approved products offered at floor plan(s).
As a minimum the product listing must include the following information:*
 - *Supplier part numbers including NSA products forming part of this category;*
 - *brief product descriptions;*
 - *quantities;*
 - *firm unit prices*
- c) *Bidders must provide a stackable panel system that consists of a Base panel with the required add-on module(s) as defined in the panel matrix of this requirement.*

****** Products from categories other than Category 1a shown on floor plan are for information purposes only******

By submitting a bid, the Bidder certifies that their submission includes all components and quantities for Category 1a, in accordance with the floor plans, panel details, panel matrices and/or workstation layouts stipulated in Annex C.

****At contract award, "By submitting a bid, the Bidder" becomes "The Contractor".***

Category 1a Requirement:

1) Floor Plan(s)

******See attached pdf and/or AutoCAD floor plan******

2) Panel Details

****** See attached pdf and/ or AutoCAD floor plan ******

- a. All required panel heights: Base Height, Seated Privacy Add-on Height;
- b. When power is required, the power is located below work surface height; should a grouping of workstation types include shared panels and one side is identified as powered and the other side is non-powered, those panels affected must be powered.
- c. Type of power feed : Base feed
- d. Component System Accessories:
 - 1. Panel mounted accessories integrated into the panel frame will be shown on the floor plan Accessories attached to the panel separately must be specified. (**tackable surfaces,**)
 - 2. When Accessory rails are required, the accessories must be specified: N /A

3) Panel Matrix or Workstation Layout



****See attached Panel Matrix or Workstation Layout****

a. Panel Matrix

***** See attached pdf and/ or AutoCAD floor plan *****

b. Workstation Layout(s)

- The floor plan takes precedent over any discrepancies with the workstation layouts.
- When two or more typical workstation types share a common panel spine, the finishes of the interior side of the workstation panel as outlined in the Typical Data Sheets must be followed and **NO PANELS SHALL BE DOUBLED. Where no workstation exists adjacent to typical workstation, refer to Data Sheet for finish.**
- Should one typical workstation identify power and the other does not – power will be required for both. Include Workstation Layouts (in the form of Typical Data Sheets or 3 Dimensional drawings) here or as a separate attachment to this RFB.



ANNEX D

ADDITIONAL SPECIFICATIONS, CERTIFICATIONS

This Annex includes the additional Specifications, Certifications associated with NSA product *forming* part of the requirement.

1. Specifications

Attached the furniture plan for SA and Non- SA items with specification along with Annex –A

2. Certifications

2.1 NSA Product Conformance *(Required precedent to Issuance of a contract)*

The Supplier certifies that all the NSA products offered will conform to all specifications indicated in Annex A and D of the RFB, and meet the testing and performance requirements found at ANNEX A-1 and A-2 of the Supply Arrangement, as applicable.

Supplier’s Signature

Date

NSA Product Conformance Certification *(applies after contract award)*

The Supplier warrants that the NSA Product Conformance Certification submitted by the Supplier with its bid is accurate and complete. The Supplier must keep proper records and documentation relating to the NSA product conformance and the testing requirements in this Annex, as applicable. The Supplier must not, without obtaining the prior written consent of the SAA, dispose of any such records or documentation until the expiration of the Contract or the expiry date of the Warranty, whichever is later. All such records and documentation must at all times during the retention period be open to audit, inspection and examination by the representatives of Canada, who may make copies and take extracts.

In addition, the Supplier must provide representatives of the SAA access to all locations where any part of the Work is being performed at any time during working hours. Representatives of the SAA may examine and test the Work as they see fit. The Supplier must provide all assistance and access to facilities, test pieces, samples and documentation that the representatives of the SAA may reasonably require for the carrying out of the inspection, which may also include the submission of test reporting documentation as listed in Annex A and D. The Supplier must forward such test pieces, samples and/or documentation that may also include letters of certification from the laboratories to such person or location as the representatives of the SAA specifies.

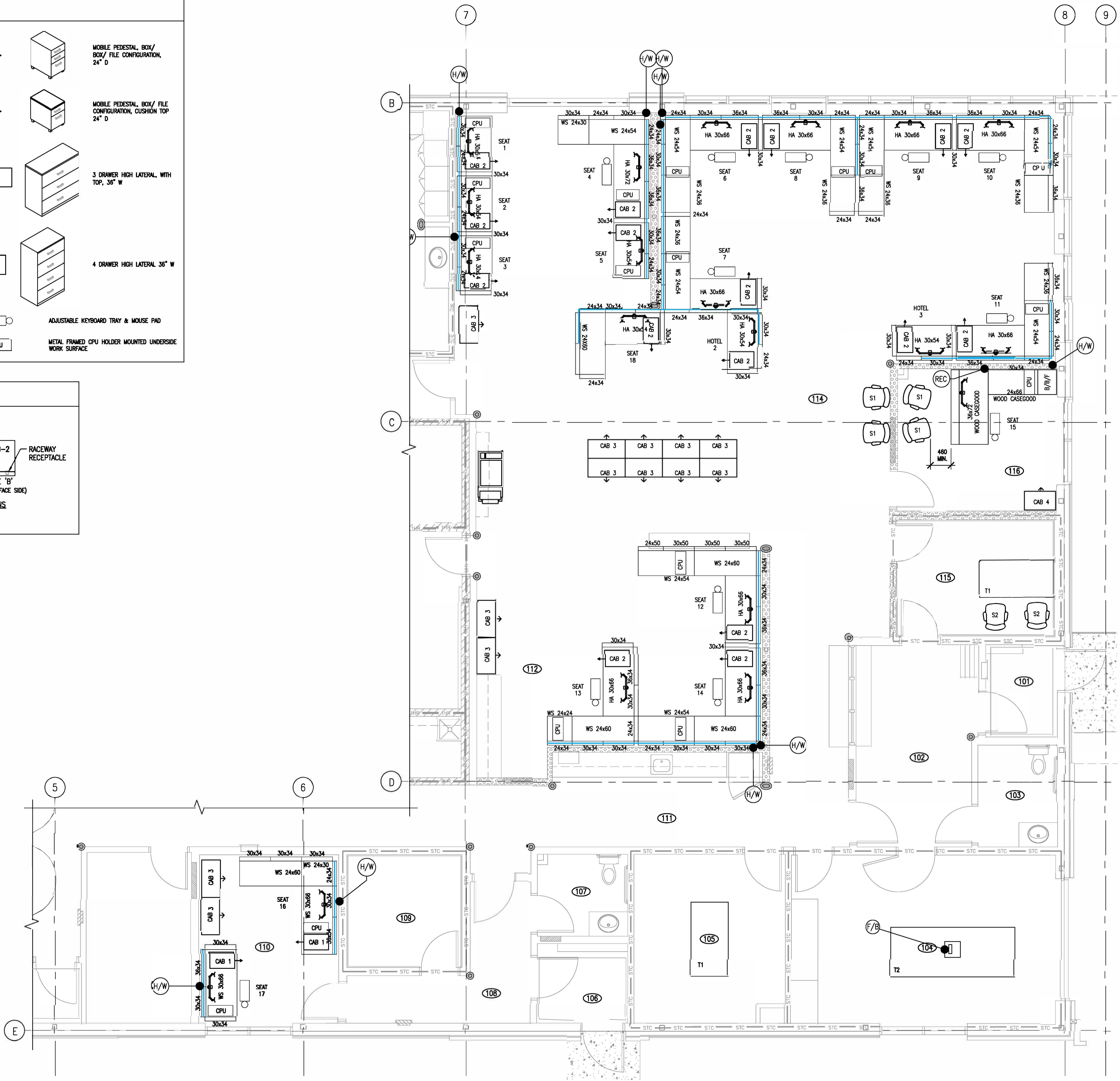
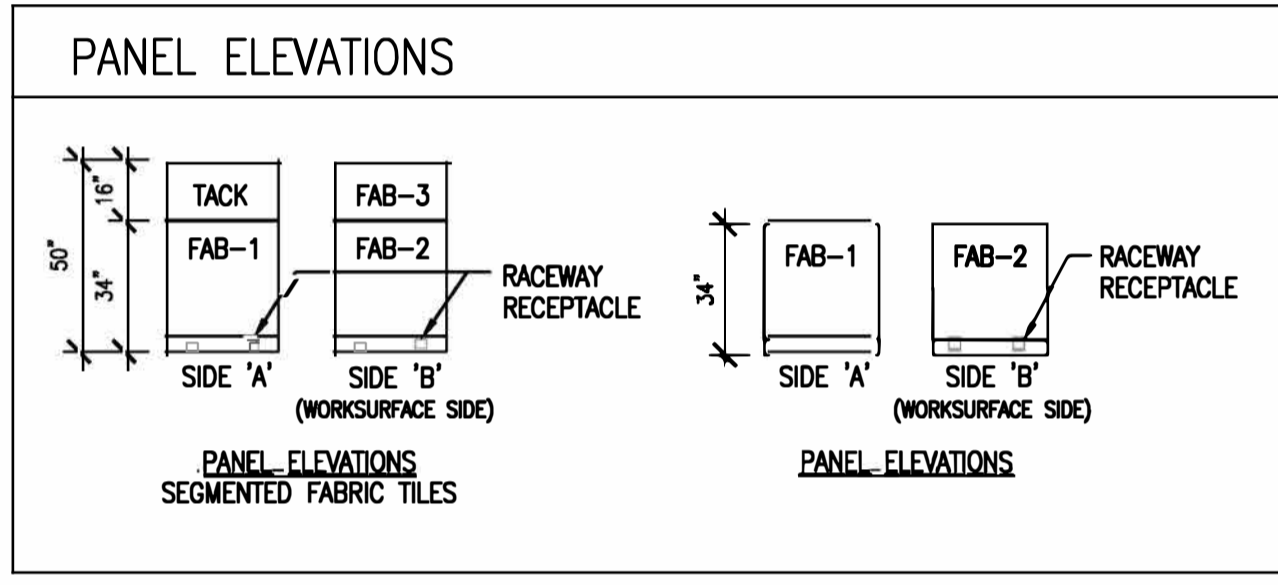
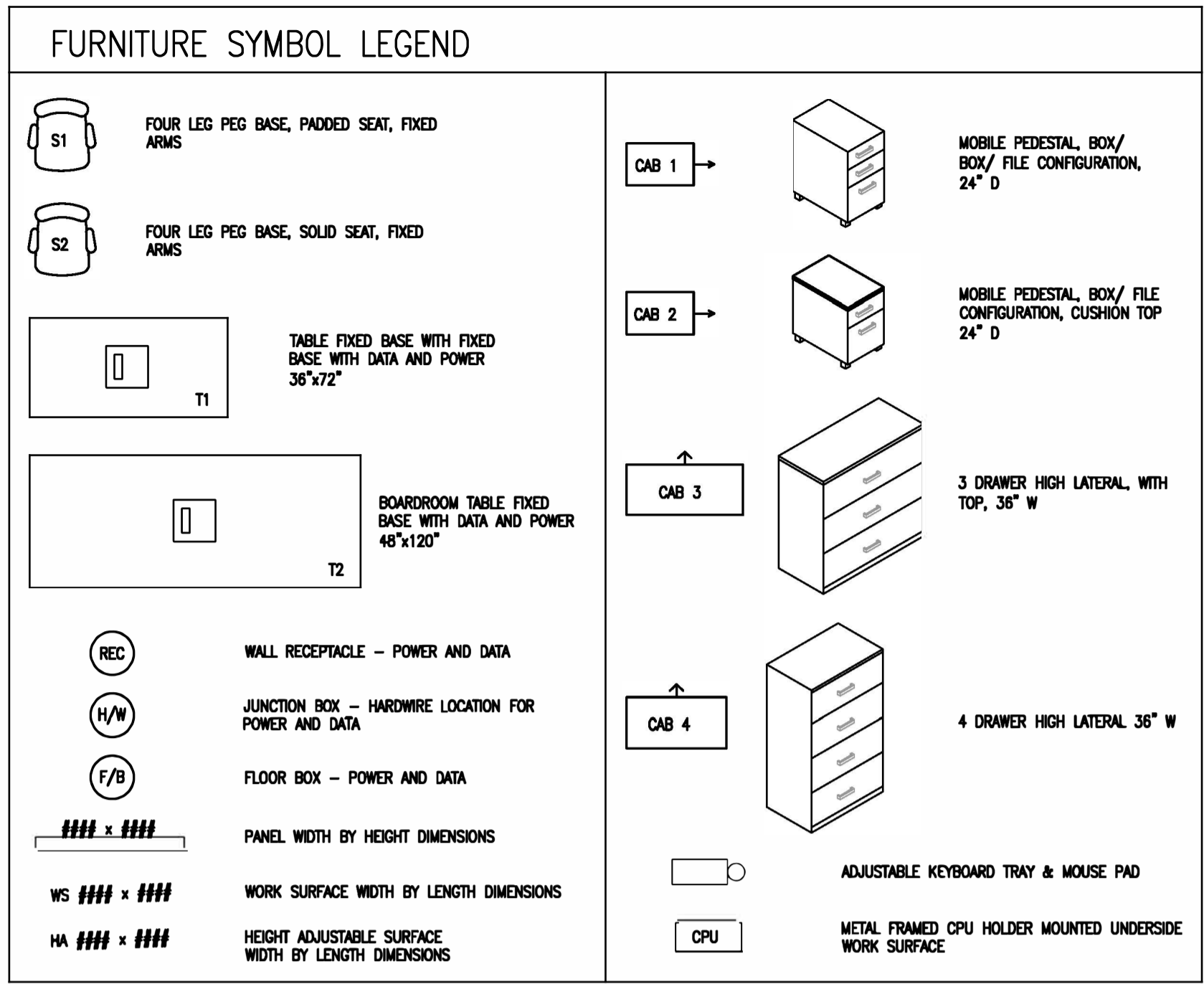

DO NOT SCALE DRAWINGS

5		
4		
3		
2		
1		
0	ISSUED FOR TENDER	21.12.23
Revision/Revisions	Description/Description	Date/Date
Client/client		

Project title/Titre du projet

**GOVERNMENT OF CANADA
KINDERSLEY,
SASKATCHEWAN**

Approved by/Approuvé par

Designed by/Concept par

Drawn by/Dessiné par

Project Manager/Administrateur de Projets

Architectural and Engineering Resources Manager/
Ressources Architectural et de Directeur d'ingénierie

Client/client

Drawing title/Titre du dessin
FURNITURE PLAN

Project No./No. du projet	Sheet/Fauille	Revision no./La Révision no.
S-07-2020	-	0

NON SUPPLY ITEMS

ATTACHMENT.# 2



WORKSURFACE
24"x24"

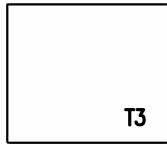
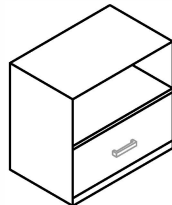
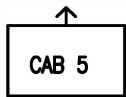

TABLE 4 POST LEG
36"x42"

ROOM 119 - QTY. 1



1 OPEN SHELF/ 1 DRAWER
HIGH LATERAL, UNDER
WORKSURFACE, 30" W

ROOM 110 - QTY. 1
ROOM 114 - QTY. 8

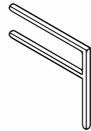

PANEL MOUNTED WORK SURFACE SUPPORT
(PLAN VIEW AND ISOMETRIC)
**SUPPORT DEPTH IS TO MATCH WORKSURFACE
DEPTH IT IS SUPPORTING

ROOM 110 - QTY. 2
ROOM 114 - QTY. 6

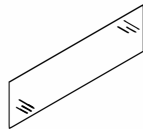
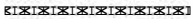

FRAMELESS GLASS TOPPER PANELS
12" HIGH x 30"WIDE

ROOM 114 - QTY. 1

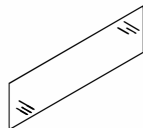
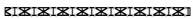

FRAMELESS GLASS TOPPER PANELS
12" HIGH x 54"WIDE

ROOM 114 - QTY. 1

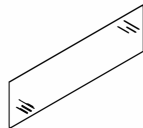

FRAMELESS GLASS TOPPER PANELS
12" HIGH x 60"WIDE

ROOM 114 - QTY. 1

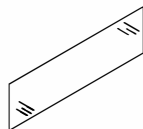
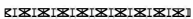

FRAMELESS GLASS TOPPER PANELS
12" HIGH x 78"WIDE

ROOM 114 - QTY. 1

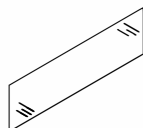

FRAMELESS GLASS TOPPER PANELS
12" HIGH x 90"WIDE

ROOM 114 - QTY. 1